

CFA ARCHAEOLOGY LTD

October 2008

Commissioned by Halcrow Yolles

This document has been prepared in accordance with CFA Archaeology Ltd standard operating procedures.

Author:	Date
Approved by:	Date
Draft/Final Report Stage:	Final

Phil Richardson BA MA FSA Scot AIFA
Illustrations: Karen Clarke BA MA MSc
Editor: Tim Neighbour BSc FSA Scot MIFA

CFA ARCHAEOLOGY LTD
The Old Engine House
Eskmills Business Park
Musselburgh EH21 7PQ

Tel: 0131-273 4380
Fax: 0131-273 4381
E-mail: cfa@cfa-archaeology.co.uk

**Sainsbury's, Balmakeith Industrial Estate,
Nairn: Archaeological Evaluation**

Data Structure Report

Report No. 1559

CONTENTS

1.	Introduction	3
2.	Working Methods	4
3.	Archaeological Results	5
4.	Conclusions and Recommendations	8
5.	References	10

Appendices

1.	Summary of Evaluation Trenches	12
2.	Context Register	12
3.	Photographic Register	14
4.	Field Drawings Register	15
5.	Samples Register	15
5.	Discovery and Excavation in Scotland Entry (2008)	17

Illustrations (bound at rear)

Fig. 1 Site and Trench Location

1. INTRODUCTION

1.1 General

1.1.1 This report presents the results of an archaeological evaluation undertaken by CFA Archaeology Ltd (CFA) in September 2008 at the proposed retail development and associated works at Balmakeith Industrial Estate, Nairn, Highland (centred on NGR NH89600 56110, Fig 1). The work was commissioned by Halcrow Yolles.

1.1.2 A Written Scheme of Investigation (WSI) was produced by CFA based upon information supplied by The Highland Council Archaeology Unit, and Halcrow Yolles.

1.2 Objectives

1.2.1 The objectives of the project were to establish the presence/absence, extent, condition, character, quality and date of any archaeological features or deposits within the proposed development area; to establish their vulnerability to the proposed development; and to propose mitigation measures.

1.3 Weather conditions

1.3.1 The weather throughout the evaluation was generally warm and dry.

2. WORKING METHODS

2.1 General

2.1.1 Work was conducted with regard to the Institute of Field Archaeologists' (IFA) *Standard and Guidance for an Archaeological Evaluation and Code of Conduct*.

2.2 Desk Based Assessment Strategy

2.2.1 Historic map coverage for the area was examined together with any other readily available cartographic information on pre-recent land use in the development area. The National Monuments Record of Scotland (NMRS), Highland Council Archaeology Unit Sites and Monuments Record (SMR) and bibliographic sources related to the area were also consulted.

2.3 Evaluation strategy (Fig. 1)

2.3.1 Trenching totalling 2500m² (c.7%) of the whole area (3.62ha) took place at the Balmakeith Industrial Estate. An extant farm building and hard standing in the south west of the development area were not evaluated.

2.3.2 A series of trial trenches were opened to examine a 7% sample of the area to be evaluated. Trenches were excavated so as to provide good overall coverage of the area.

2.3.3 Topsoil and modern deposits were removed by an earth-moving machine equipped with smooth-bladed ditching bucket, to reveal either the subsoil surface or the surface of the first significant archaeological horizon. This activity was conducted under constant archaeological supervision, with other members of field staff engaged in rapid cleaning of all appropriate areas for the identification of archaeological remains.

2.3.4 Samples of any features of archaeological interest were excavated in order to establish their likely date, nature, extent and condition. All such sample excavation was conducted by hand. The samples were limited to remove only such deposits as necessary to achieve the evaluation objectives.

2.3.5 All excavation and on-site recording was carried out according to standard CFA procedures, principally by drawing, by photography and by completing standard CFA record forms. Trenches were backfilled on completion of excavation. Trench locations were surveyed using industry standard electronic surveying equipment.

3 ARCHAEOLOGICAL RESULTS

3.1 General

3.1.1 Appendix 1 contains a tabulated summary of trench dimensions and topsoil and trench depths, and gives a brief summary of the features encountered. Only trenches in which significant features were identified are discussed below; all others are summarised in Appendix 1. Context numbers appear in bold, and a full list of contexts can be found in Appendix 2.

3.2 Desk-Based Assessment

3.2.1 The NMRS (National Monuments Record of Scotland) and the Highland SMR (Sites and Monuments Record) hold records for a number of archaeological sites within the vicinity of the study area. Aerial photography has revealed a number of sites in the surrounding fields. To the SE of the development area lies a ring ditch of about 10m in diameter and some cultivation remains (NMRS NH85NE 44; SMR MHG6929, MHG39717). Further cultivation remains are present to the SW of the site where a drain, pit, rig and furrow and some geological cropmarks have been identified (NMRS NH85NE 61). The Highland SMR notes that there is also a pit cluster at this location (MHG7277). Slightly further to the SW there is a field boundary, geological cropmark, pit and pit alignment (NMRS NH85NE 42; SMR MHG6931). Two houses of significance also appear in the NMRS; 'Balmaceardach' (NH85NE 17) to W of the development area and 12 Macrae Avenue (NH85NE 225) to the NW. Nairn cemetery lies to the W of the study area (NMRS NH85NE 431, SMR MHG28429). A barbed and tanged arrow head was found in a garden to the NW of the site (NH85NE 30; SMR MHG6943). The Highland Council also holds records on an early Bronze Age cist burial to the NW of the site (SMR MHG14335; MFH42101). No Scheduled Ancient Monuments were noted within or close to the development area.

3.2.2 The earliest maps of Scotland do not depict Nairn at all (for example Forlani's *Regno di Scotia* 1558-1566, Porcacchi's *Scotia Venetia* 1530-1585 and Leslie's *Scotiae Regni Antiquissimi Accurata Descriptio* 1527-1596). Some maps show a town marked as 'Nardyn', (Ortelius 1573) or 'Narden', (Speed 1624), in the approximate location of Nairn which may have been an earlier name for the town. Nairn does appear on some later maps such as Blaeu 1654, Morden 1703, Carel 1697, Moll 1701, Cowley 1734, Roy 1747-1755, Campbell 1794, Cary, 1801, Thomson 1832, and Stanford 1882. However, it is not shown in insufficient detail to be able to identify the study area.

3.2.3 The 1st edition Ordnance Survey is the first map which allows the study area to be identified. The Ordnance survey 1st, 2nd, 3rd (sheet 84) and 'popular edition' (sheet 28) maps all depict 'Balmakeith' farmhouse and Nairn cemetery which lie to the immediate W of the planned development area. The site itself appears to be within open land. This is also suggested by Bartholomew's Survey Atlas of Scotland 1912.

3.3 Archaeological potential

3.3.1 There are no sites of archaeological significance within the development area recorded in the NMRS, Highland SMR or appearing on any historic maps. However, the proximity of a number of crop marks, pit clusters and prehistoric finds close to the study area suggested that there is the potential for there to be similar remains within the development area.

3.4 The Evaluation (Figure 1)

3.4.1 Twenty-five trenches totalling 2500m² (c.7%) were excavated within the development area.

3.4.2 Subsoil across the site was a pale silty sand. Topsoil depth ranged between 0.2m and 0.5m.

3.4.3 The excavation of nine trenches (Trenches 10, 11, 12, 13, 14, 15, 16, 17 and 21) revealed the remains of linear features. It is possible that these features are traces of agricultural activity such as rig-and-furrow cultivation within the area. Excavation of three trenches (Trenches 10, 11 and 14) revealed the remains of pits

3.4.4 In Trench 10 a linear feature (**003**) and two pits (**005** and **008**) were identified. The linear feature (**003**) ran approximately North to South across the trench. It was 0.5m wide by 0.7m deep with sloping sides and a flat base. It was filled by a single fill (**004**), which was a homogeneous loose brown, sandy silt containing sub-angular stone inclusions. The pit (**005**) was circular in plan measuring 0.32m in diameter by 0.11m deep. It contained two fills; a black sandy silt upper fill (**006**) and a mixed brown silty sand basal fill (**007**). The pit (**008**) was also circular in plan and measured 0.57m in diameter and was 0.13m deep. It contained a single mid brown silty sand fill (**009**).

3.4.5 In Trench 11 three linear features (**013**, **015**, and **017**) and a pit (**010**) were identified. Linear (**013**) ran approximately north to south across the trench. It was 0.25m wide and contained a loose brown silty sand fill (**014**). Linear feature (**015**) also ran approximately north to south across the trench. It was 0.5m wide and contained a loose brown silty sand fill (**016**). Linear feature (**017**) ran approximately north north east to south south west across the trench. It was 0.65m wide and contained a loose brown silty sand fill (**018**). Linear features (**015** and **017**) merged at the southern trench baulk and may have inter-cut. The pit (**010**) was circular in plan measuring 0.42m in diameter by 0.1m deep. It contained two fills; a black sandy silt upper fill (**011**) and a mixed brown silty sand basal fill (**012**).

3.4.6 In Trench 12 three linear features (**020**, **047**, and **048**) were identified. One (**020**) ran approximately North north west to South south east across the trench. It was 0.80m wide by 0.62m deep. It had steep sides with a flat base and contained a loose topsoil derived grey sandy silt fill (**055**). Another (**047**) also ran approximately north north west to south south east across the trench. It was 0.78m wide and contained a loose topsoil derived grey sandy silt fill (**056**). The third (**048**) also ran approximately north north west to south south east across the trench. It was 0.8m wide and contained a loose brown silty sand fill (**057**).

- 3.4.7 In Trench 13 three linear features (**021**, **023**, and **049**) were identified. Linear feature (**021**) ran approximately north north east to south south west across the trench. It was 0.6m wide by 0.36m deep. It had steep sides with a flattish base and contained a dark grey sandy silt fill (**022**). Linear feature (**023**) also ran approximately north north east to south south west across the trench. It was 1m wide and contained a dark grey sandy silt fill (**024**). Linear feature (**049**) ran approximately north to south across the trench. It was 0.6m wide and contained a loose brown silty sand fill (**058**).
- 3.4.8 In Trench 14 a linear feature (**031**) and three pits were identified. The linear feature (**031**) running approximately north west to south east across the trench. It was 0.5m wide with steep sides and a flat base and was filled by a single dark grey topsoil derived fill (**032**). Pit (**033**) was recorded against the southern baulk of the trench. It measured 6.3m wide by 1.2m wide in the trench and was filled by dark grey sandy silt fill (**034**). A large pit (**035**) was recorded in the centre of the trench. It was sub-oval in plan and measured 5.30m wide by 3.30m wide by 0.45m deep. It was filled by dark grey sandy silt fill (**036**). Pit (**037**) was sub-circular in plan and measured 2.2m in diameter by 0.50m deep. It contained three fills, a dark grey-black sandy silt upper fill (**038**), a burnt orange silty sand fill (**039**) and a dark brown sandy silt basal fill (**040**).
- 3.4.9 In Trench 15 two linear features (**041** and **042**) were identified. Both ran approximately north west to south east across the trench. They both measured 0.80m wide and contained a loose mid brown silty sand fill (**050** and **051** respectively).
- 3.4.10 In Trench 16 three linear features (**043**, **044** and **046**) were identified together with an amorphous spread (**025**) in the north of the trench. Linear feature (**043**) ran approximately north west to south east across the trench. It was 0.5m wide and contained a mid brown silty sand fill (**052**). Linear feature (**023**) also ran approximately north west to south east across the trench. It was 0.7m wide and contained a mid brown silty sand fill (**053**). Linear feature (**046**) ran north south along the trench terminating in feature (**025**). It was 0.5m wide and filled with (**055**) a loosely compacted, mid-grey to yellow sandy silt the same as (**026**). The amorphous spread (**025**) was 7m wide by 12m long by 0.4m deep in the trench. It had shallow sloping sides and a flat base and was filled by a mid grey to yellow sandy silt fill (**026**) and had a shallow lens of whitish yellow sand at its base (**027**). This spread of material was also seen in Trench 17 (see fig.2).
- 3.4.11 In Trench 21 a linear feature (**045**) was identified. It ran approximately north north west to south south east across the trench. It measured 0.8m wide and contained a loose mid brown silty sand fill (**054**).

The Finds, by Sue Anderson

- 3.4.13 One iron object (57g) and one fragment of pottery were recovered from context (038). The iron object was heavily corroded and is unidentifiable without an x-ray. The pottery comprised a frilled base fragment from a Scottish post-medieval oxidised ware jug of probable 15th/16th-century date.

4. CONCLUSIONS AND RECOMMENDATIONS

4.1 Twenty-four trial trenches were excavated across the development area at Balmakeith Industrial Estate, Nairn totalling 2500m².

4.2 The results of the evaluation included:

- A number of undated linear ditched features, which may be related to rig and furrow cultivation, field drainage or other agricultural activities.
- A series of undated pits in Trenches 10, 11 and 14.
- An amorphous spread was recorded in Trenches 16 and 17 are likely to be two parts of the same feature.

4.3 With the exception of **(021 and 023)**, the other linear features shared similar characteristics in their fills, dimensions and orientations. Features **(021 and 023)** were orientated south east to north west, and were deeper than the other linear features excavated, although they were not found in adjacent trenches. There were no artefacts recovered from any of these linear features and their dates remain undetermined. There are at least three possible explanations for these linear features, drainage, cultivation remains or enclosure ditches. If they are related to drainage then they are the remains of either open field drainage ditches or early under-drainage characterised by trenches filled with gorse, bracken or small alder or ash branches (Beckett 1990: 20-1) prior to the adoption of clay tile pipes after 1840 (Tarlow 2007: 60-61). However it seems unlikely that drainage was needed on this free draining sand subsoil. It is possible that they are the remains of cultivation, all but two of the linear features **(021 and 023)** were orientated in the same direction, suggestive of ploughing, and rig and furrow cultivation. The fills within these features were loosely compacted brown silty sand similar to the topsoil, indicative of a relatively recent date for the infilling of these features. If these linear features are parts of enclosures then there is no discernible pattern within these features in plan which is indicative of enclosures.

4.4 Six pits were excavated (Trenches 10, 11 and 14). The pits varied in size, form and fills. The function of these pits was not determined through excavation. The pits show no spatial patterning indicative of structures. A fragment of post medieval pottery was recovered from pit **(037)**.

4.5 An amorphous deposit **(025)** of sandy material was recorded in Trench 16 and 17. Although it appeared to have a cut, it was irregular in shape. The purpose of this pit could not be established through excavation. The linear features **(046 and 028)** had very similar fills to the deposit within **(025)** with **(046)** either terminating or originating from this deposit **(025)**.

4.6 The project archive, comprising all CFA record sheets, maps and reports will be deposited with the National Monuments Record of Scotland (NMRS) and copies of reports will be lodged with The Highland Council Archaeology Unit.

- 4.7 A summary statement of the results of this evaluation will be submitted for publication in *Discovery and Excavation in Scotland 2008* (Appendix 5).

5. REFERENCES

Cartographic References

Bartholomew, J G 1912 *Survey Atlas of Scotland*

Blaeu, Joan 1654 *Atlas of Scotland*

Campbell, Robert 1794 *A new and correct map of Scotland or North Britain, drawn from the most approved surveys*

Carel, Allard 1697 *Novissima Regni Scotiae septentrionalis et meridionalis tabula, divisae in ducatus, comitatus, vice-comitatus, provincias, praefecturas, dominia et insulas*

Cary, John 1801 *A new map of Scotland, from the latest authorities*

Cowley 1734 *A New Map of North Britain with the Islands thereunto belonging*

Forlani, Paolo, 1558 and 1566 *Regno di Scotia*

Leslie, John, 1527-1596 *Scotiae Regni Antiquissimi Accurata Descriptio*

Moll, Herman 1701, *Scotland*

Morden, Robert 1703 *Scotland*

Ordnance Survey, *One-inch to the mile maps of Scotland* 1st Edition - 1856-1891, sheet 84, Nairn 1866-1872

Ordnance Survey, *One-inch to the mile maps of Scotland* 2nd Edition - 1885-1900, sheet 84, 1894-1896

Ordnance Survey, *One-inch to the mile maps of Scotland* 3rd Edition - 1903-1912, sheet 84, 1908-1909

Ordnance Survey Maps *One-inch "Popular" edition, Scotland*, 1921-1930, sheet 28, Nairn and Cromarty

Ortelius, Abraham, 1527-1598 *Scotiae tabula*

Porcacchi, Thomaso, 1572 *Scotia Venetia : Galignani & Porro*

Roy *Military Survey of Scotland* 1747-1755

Speed, John, 1552?-1629 *The Kingdome of Scotland*

Stanford 1882 *Stanford's map of Scotland*

Thomson 1832, *Atlas of Scotland*

Bibliographic References

Beckett, J. 1990 *The Agricultural Revolution*. Oxford: Blackwell

Tarlow, S. 2007 *The Archaeology of Improvement in Britain, 1750-1850*. Cambridge: Cambridge University Press.

APPENDIX 1

Summary of evaluation trenches

Trench No.	Dimensions (m)	Total Area (m ²)	Topsoil Depth (m)	Comments
1	60 x 2	120	0.23	No archaeology
2	50 x 2	100	0.2	No archaeology
3	50 x 2	100	0.22	No archaeology
4	50 x 2	100	0.25	No archaeology
5	50 x 2	100	0.26	No archaeology
6	50 x 2	100	0.2	No archaeology
7	50 x 2	100	0.25	No archaeology
8	50 x 2	100	0.2	No archaeology
9	50 x 2	100	0.3	No archaeology
10	50 x 2	100	0.25	1 linear feature (003), a pit (005) and a pit (008).
11	50 x 2	100	0.31	3 possible linear features (013, 015 and 017) and a possible pit (010).
12	50 x 2	100	0.32	3 possible linear features (046, 047 and 048)
13	50 x 2	100	0.38	3 possible linear features (021, 023 and 049)
14	50 x 2	100	0.3	1 possible linear feature (031) and 3 possible pits (033, 035 and 037)
15	50 x 2	100	0.36	2 possible linear features (041 and 042)
16	50 x 2	100	0.37	3 possible linear features (025, 043 and 044)
17	50 x 2	100	0.39	1 possible linear feature (028) and an amorphous spread (025)
18	50 x 2	100	0.3	No archaeology
19	50 x 2	100	0.25	No archaeology
20	50 x 2	100	0.27	No archaeology
21	50 x 2	100	0.32	1 possible linear feature (045)
22	50 x 2	100	0.30	No archaeology
23	50 x 2	100	0.4	No archaeology
24	50 x 2	100	0.5	No archaeology

APPENDIX 2

Context Register

Context No.	Trench . No.	Context type	Description of Context
001	All	Top Soil	Top Soil
002	All	Sub-soil	Sub-soil
003	10	Cut of linear feature	Shallow sided, concave base, linear feature orientated NW
004	10	Fill of linear feature [003]	Loosely compacted mid-brown sand with small stone inclusions. Same as (018)
005	10	Cut of possible pit	Steep sided, concave base, circular feature
006	10	Upper fill of pit [005]	Loosely compacted black sandy silt with small stone inclusions
007	10	Lower fill of pit [005]	Loosely compacted brown silty sand
008	10	Cut of pit	Medium sloping sides, concave base, circular feature
009	10	Fill of pit [008]	Loosely compacted mid-brown silty sand with small stone

			inclusions
010	11	Cut of pit	Medium sloping sides, concave base, circular feature
011	11	Upper fill of pit [010]	Loosely compacted black sandy silt with lots of small stone inclusions
012	11	Lower fill of pit [010]	loosely compacted mid-brown silty sand
013	11	Cut of linear feature	End of linear feature orientated N
014	11	Fill of linear feature [013]	Loosely compacted mid-brown sand with small stone inclusions. Same as (018)
015	11	Cut of linear feature	Linear feature, orientated NW, which converges with another [017]
016	11	Fill of linear feature [015]	Loosely compacted mid-brown sand with small stone inclusions. Same as (018)
017	11	Cut of linear feature	Linear feature, orientated NE, which converges with another [013]
018	11	Fill of linear feature [017]	Loosely compacted mid-brown sand with small stone inclusions.
019	12	Fill of linear feature [020]	Loosely compacted grey sand sandy silt with small stone inclusions.
020	12	Cut of linear feature	Shallow sided, concave base, linear feature orientated NW
021	13	Cut of linear feature	Steep sided, concave base, linear feature orientated NE
022	13	Fill of linear feature [021]	Loosely compacted dark grey sandy silt with flecks of charcoal
023	13	Cut of linear feature	Medium sloping sides, concave base, linear feature orientated NE
024	13	Fill of linear feature [023]	Loosely compacted dark grey sandy silt with flecks of charcoal. Same as (022)
025	16 & 17	Cut of amorphous spread	Gently sloping
026	16 & 17	Fill of amorphous spread	Loosely compacted, mid-grey to yellow sandy silt
027	17	Fill contained within bulk of amorphous spread (026)	Lens of loosely compacted, white/yellow sand
028	17	Cut of linear feature	Steep sided, flat based linear feature orientated N with a Service Pipe at the bottom
029	17	Fill of linear feature (028)	Loosely compacted, yellow/orange re-deposited natural sand
030	17	Metal encased service pipe	Metal encased service pipe
031	14	Cut of linear feature	Shallow sided, concave base, linear feature orientated NW
032	14	Fill of linear feature (031)	Loosely compacted mid-brown sand with small stone inclusions. Same as (018)
033	14	Cut of pit	Irregular shape and incomplete as it disappears out of the trench
034	14	Fill of pit (033)	Loosely compacted dark grey

			sand with small stone inclusions
035	14	Cut of large pit	shallow sided, flat base, sub-rectangular feature orientated NE
036	14	Fill of large pit (035)	Loosely compacted, dark grey silty sand with small and medium sized stone inclusions
037	14	Cut of pit	gentle to medium sloping sides, flat base, sub-circular feature orientated NW
038	14	Upper fill of pit (037)	Loosely compacted, dark grey/black sand with small stone inclusions
039	14	Middle fill of pit (037)	Loosely compacted, burnt orange sand
040	14	Lower fill of pit (037)	Loosely compacted, dark brown sand
041	15	Cut of linear feature	Unexcavated
042	15	Cut of linear feature	Unexcavated
043	16	Cut of linear feature	Unexcavated
044	16	Cut of linear feature	Unexcavated
045	21	Cut of linear feature	Unexcavated
046	16	Cut of linear feature	Unexcavated
047	12	Cut of linear feature	Unexcavated
048	12	Cut of linear feature	Unexcavated
049	13	Cut of linear feature	Unexcavated
050	15	Fill of linear feature (041)	Loosely compacted mid-brown sand with small stone inclusions.
051	15	Fill of linear feature (042)	Loosely compacted mid-brown sand with small stone inclusions.
052	16	Fill of linear feature (043)	Loosely compacted mid-brown sand with small stone inclusions.
053	16	Fill of linear feature (044)	Loosely compacted mid-brown sand with small stone inclusions.
054	21	Fill of linear feature (045)	Loosely compacted mid-brown sand with small stone inclusions.
055	16	Fill of linear feature (046)	Loosely compacted, mid-grey to yellow sandy silt
056	12	Fill of linear feature (047)	Loosely compacted mid-brown sand with small stone inclusions.
057	12	Fill of linear feature (048)	Loosely compacted mid-brown sand with small stone inclusions.
058	13	Fill of linear feature (049)	Loosely compacted mid-brown sand with small stone inclusions.

APPENDIX 3

Photographic Register

Film 1

Shot	Description	From	Condition
2-4	Overview/ Registration shots	S	O/C
5-6	Plan of pits [008] and [005] at E end of Tr10	S	Rain
7-8	Plan of linear feature [003] at E end of Tr10	S	Rain
9-10	E facing section of possible pit [005] at E end of Tr10	E	Rain
11-12	NW facing section of linear feature [003] at E end of Tr10	NW	Rain

13-14	UNUSED		
15-16	SE facing section of pit [008] at E end of Tr10	SE	Rain
17-18	Plan of possible pit [010] and end of linear feature [013] in centre of trench 11	N	Rain
19-20	Plan of pit in centre of Tr11 - Modern, DISCARD	S	Rain
21-22	S facing section of pit [010] in centre of Tr11	S	O/C
23-24	Plan of converging linear features [015] & [017] in Tr11	N	O/C
25-26	S facing section of western linear feature [021] in Tr12	S	O/C
27-28	NE facing section of linear feature [021] in Tr12	NE	O/C
29-30	Plan of eastern linear feature [023] in Tr13	NE	O/C
31-32	NE facing section of western linear feature [023] in Tr13	NE	O/C

Film 2

Shot	Description	From	Condition
1-3	Overview/ Registration shots	S	O/C
4-5	South end of W facing section of [025]	W	O/C
6-7	North end of W facing section of [025]	W	O/C
8-9	Plan of linear feature and spread [025]	S	O/C
10-11	Plan of large pit [035] in centre of Tr14	NE	Rain
12-13	Plan of pit [037] in centre of Tr14	SE	Rain
14-15	Service Track in Tr17	S	O/C
16-17	S facing section of service track	S	O/C
18-19	Plan of amorphous spread [025] in Tr17	S	O/C
20-21	Plan of linear feature [031] at E end of Tr14	NW	O/C
22-23	Plan of E end of large pit [033] at E end of Tr14	N	O/C
24-25	Plan of W end of large pit [033] at E end of Tr14	N	O/C
26-27	Plan of linear feature in Tr15	S	O/C
28-29	NE facing section of pit [037] in centre of Tr14	NE	O/C
30-31	SE facing section of pit [037] in centre of Tr14	SE	O/C
32-33	NE & NW facing section of pit [035] in centre of Tr14	NE & NW	O/C

APPENDIX 4

Field Drawings Register

Drawing Number	Scale	Section /Plan	Contexts/Description
1	01:50	P	Linear feature [003], pit [005] pit [008] at E end of Tr10
2	01:10	S	NW facing section of linear feature [003] at E end of Tr10
3	01:10	S	E facing section of possible pit [005] at E end of Tr10
4	01:10	S	SE facing section of pit [008] at E end of Tr10
5	01:50	P	Linear features [013], [015], [017] and pit [010] in centre of Tr11
6	01:10	S	S facing section of possible pit [010] in centre of Tr11
7	01:10	S	S facing section through western linear feature [020] in Tr12
8	01:10	S	SW facing section of eastern linear feature [023] in Tr13
9	01:20	S	W facing section of amorphous spread [025] in Tr17
10	01:10	S	SW facing section of western linear feature [021] in Tr13
11	01:20	S	S facing section of linear feature [028] in Tr17
12	01:10	S	SE facing section of pit [037] in centre of Tr14
13	01:10	S	NE facing section of pit [037] in centre of Tr14
14	01:10	S	N facing section of linear feature [031] to E of Tr14
15	01:20	S	Section drawings of pit [035] in centre of Tr14

16	01:50	P	Linear feature [031] & pit [033] to E end of Tr14
17	01:50	P	Pits [035] & [037] in centre of Tr14

APPENDIX 5

Sample Register

Sample No.	Trench	Context	Description	Quantity (L)
1	14	039	Fill of pit 037	6

APPENDIX 6

Discovery & Excavation 2006 Entry

LOCAL AUTHORITY:	Highland Council
PROJECT TITLE/SITE NAME:	Sainsbury's Nairn
PROJECT CODE:	SAIN
PARISH:	Nairn
NAME OF CONTRIBUTOR:	Philip Richardson
NAME OF ORGANISATION:	CFA Archaeology Ltd
TYPE(S) OF PROJECT:	Evaluation
NMRS NO(S):	
SITE/MONUMENT TYPE(S):	Cultivation remains and pits
NGR (2 letters, 6 figures)	NH89600 56110
START DATE (this season)	15/09/2008
END DATE (this season)	18/09/2008
PREVIOUS WORK (incl. DES ref.)	
MAIN (NARRATIVE) DESCRIPTION: (May include information from other fields)	An archaeological evaluation was undertaken by CFA Archaeology Ltd in September 2008 at the proposed retail development and associated works at Balmakeith Industrial Estate, Nairn, Highland. The work was commissioned by Halcrow Yolles. Twenty four trial trenches were excavated, amounting to 2500m ² (c.7%). A number of pits and a series of undated linear features thought to be cultivation remains, probably furrows from rig-and-furrow cultivation were identified.
PROPOSED FUTURE WORK:	N/A
CAPTION(S) FOR ILLUSTRS:	
SPONSOR OR FUNDING BODY:	Halcrow Yolles
ADDRESS OF MAIN CONTRIBUTOR:	The Old Engine House, Eskmills Park, Musselburgh, East Lothian EH21 7PQ
EMAIL ADDRESS:	prichardson@cfa-archaeology.co.uk
ARCHIVE LOCATION (intended/deposited)	Report to be submitted to NMRS and Highland SMR Archive to be submitted to NMRS

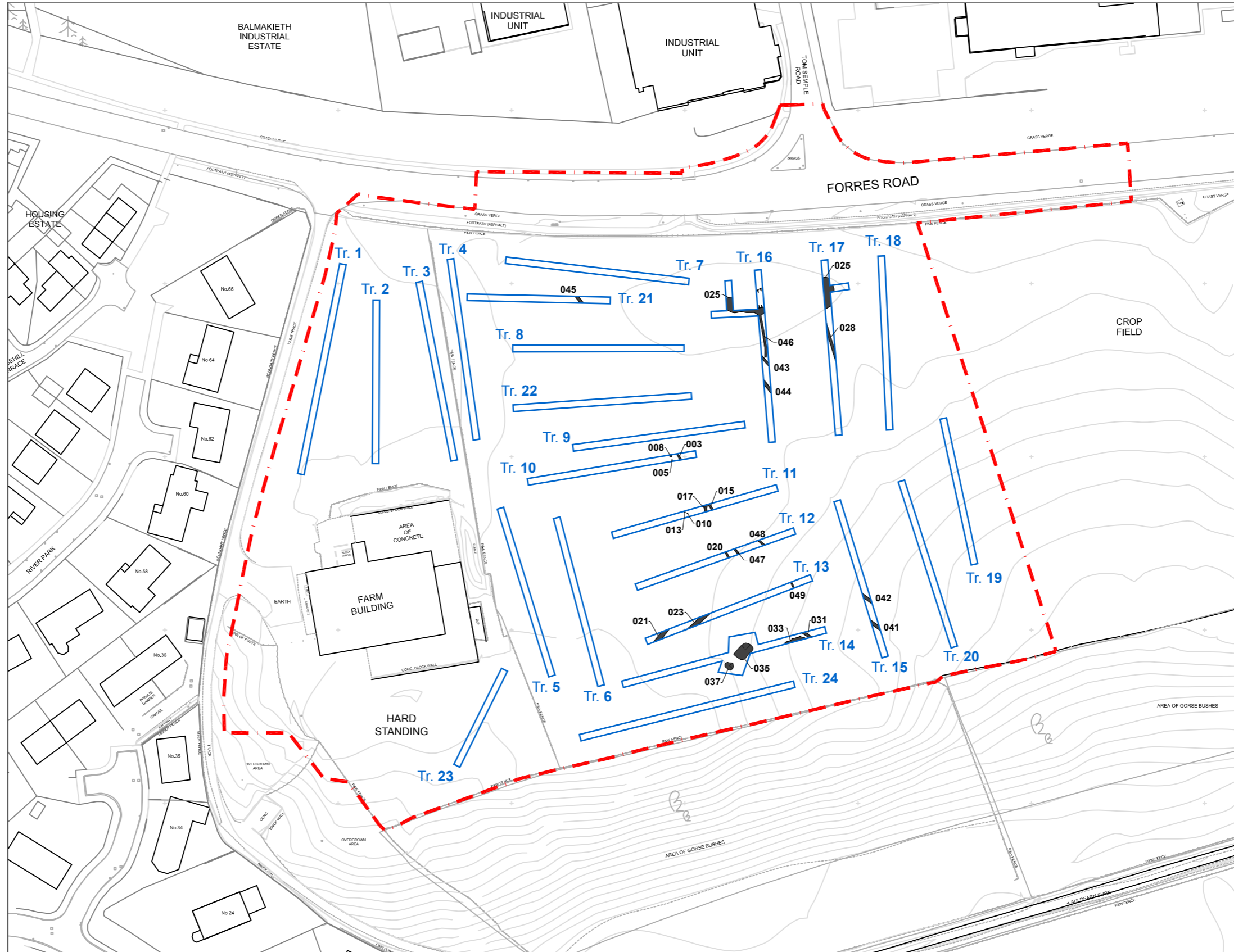

Key:

- Trench
- Site Boundary

CFA
ARCHAEOLOGY LTD

CFA ARCHAEOLOGY LTD
The Old Engine House
Eskmills Park
Musselburgh
East Lothian, EH21 7PQ
t: 0131 273 4380
f: 0131 273 4381
e: info@cfa-archaeology.co.uk
w: www.cfa-archaeology.co.uk

Fig. No:	1	Revision:	0
----------	---	-----------	---

Title:
Site and Trench Location

Project:
Sainsbury's, Nairn (SAIN)

Scale:
1: 1250

Client:
HALCROW YOLLES

Drawn by: **KC** Page No: **0**