

An Archaeological Evaluation at 128 Mill Road, Stock, Essex

July 2015



by Pip Parmenter and Ben Holloway

on behalf of Mr Alan Campbell

CAT project ref.: 15/07b

HER project code: SKMR15

NGR: TQ 6948 9875

Chelmsford Museum accession code: 2015.177



Colchester Archaeological Trust

Roman Circus House,
Roman Circus Walk,
Colchester,
Essex CO2 7GZ

tel.: 01206 501785

email: archaeologists@catuk.org

CAT Report 854
September 2015

Contents

1	Summary	1
2	Introduction	1
3	Archaeological background	1
4	Results	1
5	Finds	2
6	Discussion	2
7	Acknowledgements	2
8	References	2
9	Abbreviations and glossary	3
10	Contents of archive	3
11	Archive deposition	3

Figures

after p4

List of plates, figures and tables

Cover: general site shot

- Fig 1 Site location
- Fig 2 Representative trench section
- Fig 3 Evaluation results

1 Summary

An archaeological evaluation by trial-trenching on land at 128 Mill Road, Stock, revealed no significant archaeological features or finds. The only features seen were two modern drains. Other minor modern disturbance was identified by fragments of modern brick and plastic. Modern topsoil directly sealed natural geological deposits.

2 Introduction (Figs 1 - 3)

This report presents the results of an archaeological evaluation by trial-trenching on land at 128 Mill Road, Stock, Essex, carried out by Colchester Archaeological Trust (CAT) on 22nd July 2015. The work was commissioned by Alan Campbell, in advance of the demolition of an existing dwelling and construction of a new dwelling.

In response to consultation with Essex County Council Place Services (ECCPS), Essex County Council Historic Environment monitor Alison Bennett advised that in order to establish the archaeological implications of this application, the applicant should be required to commission a scheme of archaeological investigation in accordance with paragraphs 128, 129 and 132 of the *National Planning Policy Framework* (DCLG 2012).

All archaeological work was carried out in accordance with a *Brief for archaeological evaluation*, detailing the required archaeological work, written by Alison Bennett (ECCPS 2015), and a written scheme of investigation (WSI) prepared by CAT in response to the brief and agreed with ECCPS (CAT 2015)

In addition to the brief and WSI, all fieldwork and reporting was done in accordance with English Heritage's *Management of Research Projects in the Historic Environment (MoRPHE)* (English Heritage 2006), and with *Standards for field archaeology in the East of England* (EAA 14 and 24). This report mirrors standards and practices contained in the Institute for Archaeologists' *Standard and guidance for archaeological field evaluation* (ClfA 2014a) and *Standard and guidance for the collection, documentation, conservation and research of archaeological materials* (ClfA 2014b).

3 Archaeological background

The following archaeological background draws on the Essex Historic Environment Record (EHER) held at Essex County Council, County Hall, Chelmsford, Essex.

Pottery manufacture was an important industry in Stock from the 16th to the 19th centuries. This has been shown by the finding of post-medieval pottery kilns to the north-west of the site at Stock Bowling Club (EHER 5507). Medieval pottery and kiln waste has also been recovered from a sewer trench alongside Common Lane (EHER 5391). Recent excavations at 10 The Paddock (CAT Report 704) revealed large quantities of post-medieval pottery, thought to indicate a nearby kiln (EHER 48334). Historical evidence shows that Stock Common, to the north of the site, was dug for clay for pottery manufacture. Earlier evidence of occupation in Stock comes from a site just to the north of Mill Road (EHER 46565) where Late Bronze Age/Early Iron Age features were found.

4 Results

The evaluation trench was excavated under archaeological supervision using a tracked excavator. Two layers were identified; a modern topsoil (L1), which directly sealed natural geological deposits (L2). The natural geological deposits (L2) consisted of clean yellow/grey clay.

The single evaluation trench was located in the northern part of the footprint of the proposed new house. The trench contained no archaeological features, though some minor modern disturbance comprising a modern drain crossed the trench, and modern plastic and brick was observed.

5 Finds

Fragments of modern brick and plastic were recovered from the topsoil (L1) and had been compressed into the underlying geological horizon (L2). None of this material was retained. No archaeological material was recovered from the evaluation.

6 Discussion

No significant archaeological features or finds were revealed by this evaluation. It is evident that this site has been levelled, probably when the existing dwelling was constructed. If that is so, any evidence of a kiln or local pottery production may already have been removed.

7 Acknowledgements

CAT thanks Mr Alan Campbell for commissioning and funding the work. The project was managed by B Holloway, fieldwork was carried out by B Holloway and E Sanford. Site plans and sections prepared by C Lister. The project was monitored for the ECCPS by Alison Bennett.

8 References

Note: all CAT reports, except for DBAs, are available online in PDF format at <http://cat.essex.ac.uk>

CAT	2015	<i>Written Scheme of Investigation for an archaeological evaluation at 128 Mill Road, Stock, Essex</i>
CAT Report 704	2013	<i>An archaeological evaluation by trial-trenching at 10 The Paddock, Stock, Essex by Adam Wightman and Howard Brooks</i>
CIfA	2014a	<i>Standard and guidance for archaeological field evaluation</i>
CIfA	2014b	<i>Standard and guidance for the collection, documentation, conservation and research of archaeological materials</i>
DCLG	2012	<i>National Planning Policy Framework</i> . Dept of Communities and Local Government.
EAA 14	2003	<i>Standards for field archaeology in the East of England</i> , East Anglian Archaeology, Occasional Papers, 14 . Ed. D Gurney
EAA 24	2011	<i>Research and archaeology revisited: A revised framework for the East of England</i> , East Anglian Archaeology Occasional Papers 24 , by Maria Medlycott
ECCPS	2015	<i>Brief for Archaeological Evaluation at 128 Mill Road, Stock</i>
English Heritage	2006	<i>Management of Research Projects in the Historic Environment</i> (English Heritage)

9 Abbreviations and glossary

CAT	Colchester Archaeological Trust
CIfA	Chartered Institute for Archaeologists
context	specific location of finds on an archaeological site
EIA	Early Iron Age (<i>circa</i> 700 - 400 BC)
feature (F)	an identifiable thing like a pit, a wall, a drain: can contain 'contexts'
LBA	Late Bronze Age (<i>circa</i> 1,000 - 700 BC)
layer (L)	distinct or distinguishable deposit of soil
medieval	period from AD 1066 to Henry VIII
modern	period from <i>c</i> AD 1800 to the present
natural	geological deposit undisturbed by human activity
NGR	National Grid Reference
post-medieval	from Henry VIII to <i>c</i> AD1800
prehistoric	pre-Roman
residual	something out of its original context, eg a Roman coin in a modern pit
ECCPS	Essex County Council Place Services
EHER	Essex Historic Environment Record
section	(abbreviation sx or Sx) vertical slice through feature/s or layer/s
WSI	Written Scheme of Investigation

10 Contents of archive

Paper and digital record

One A4 document wallet containing:
The report (CAT Report 854)
ECCPS Evaluation Brief
CAT Written Scheme of Investigation
Original site record (Feature and layer sheets, Finds record)
Site digital photographic log
Architectural Plans
Attendance register
Trench record sheet
Finds register
Original Plans
Risk assessment

11 Archive deposition

The paper and digital archive is currently held by the Colchester Archaeological Trust at Roman Circus House, Roman Circus Walk, Colchester, Essex CO2 7GZ, but will be permanently deposited with Chelmsford Museum under accession code: 2015.117.

© Colchester Archaeological Trust 2015

Mr Alan Campbell
Alison Bennett Essex County Council Place Services
Essex Historic Environment Record, Essex County Council



Colchester Archaeological Trust

Roman Circus House
Roman Circus Walk,
Colchester,
Essex CO2 7GZ

tel.: 01206 501785

email: archaeologists@catuk.org

Checked by: *Howard Brooks*

Date: 03.09.15

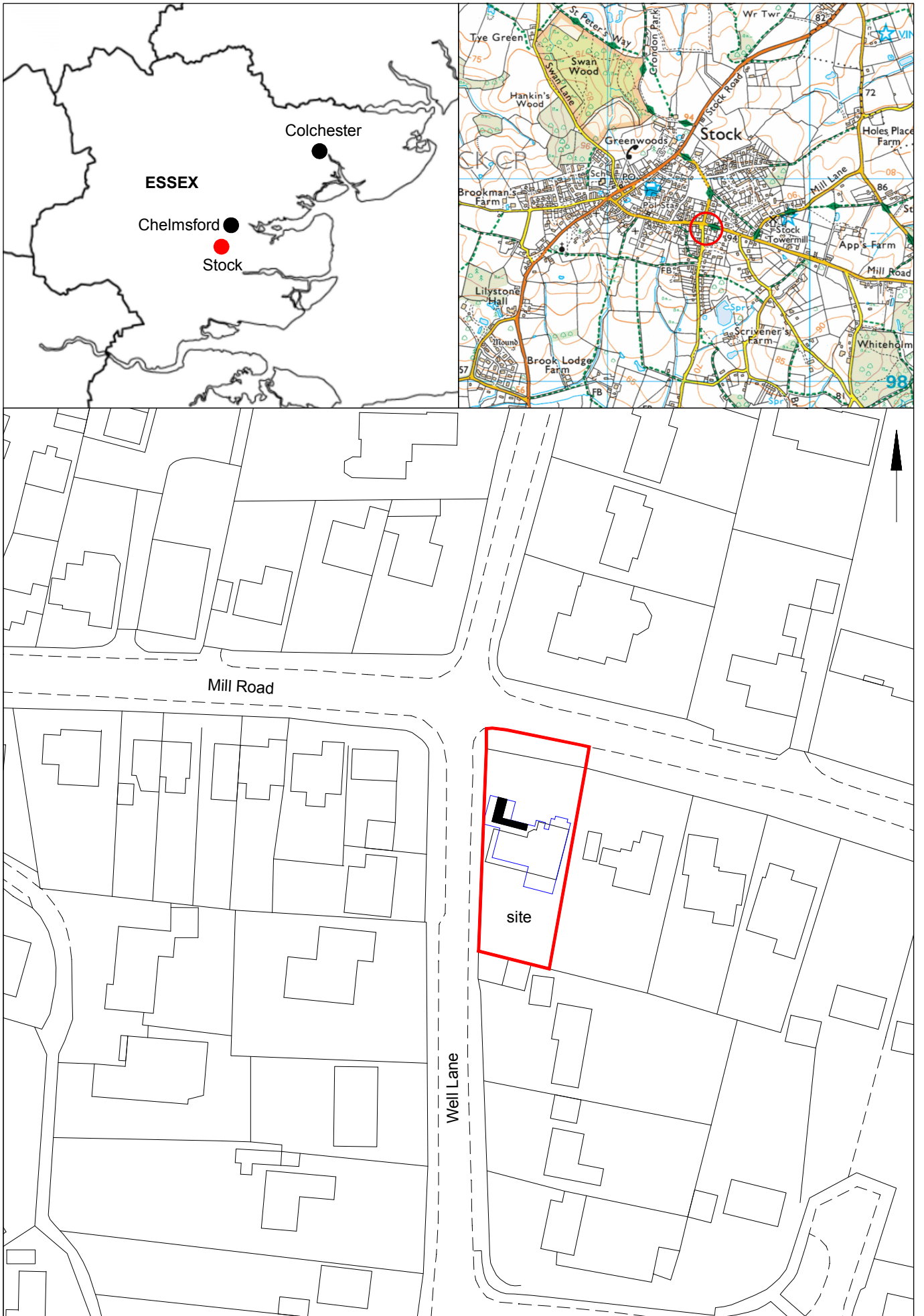

© Crown copyright. All rights reserved. Licence number 100039294.

Fig 1 Site location.

0 50 m

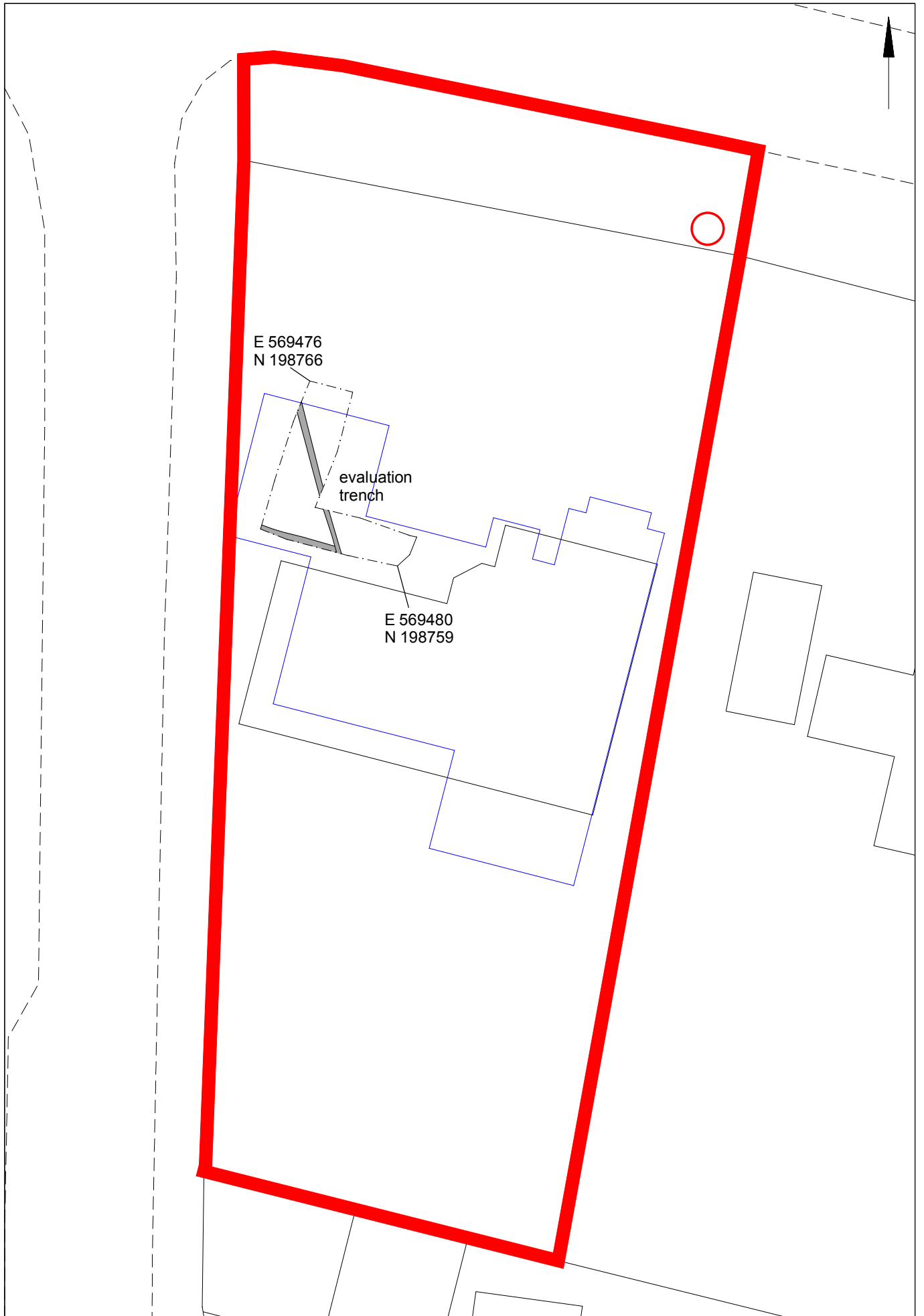

Fig 2 Evaluation results. Proposed development shown in blue.

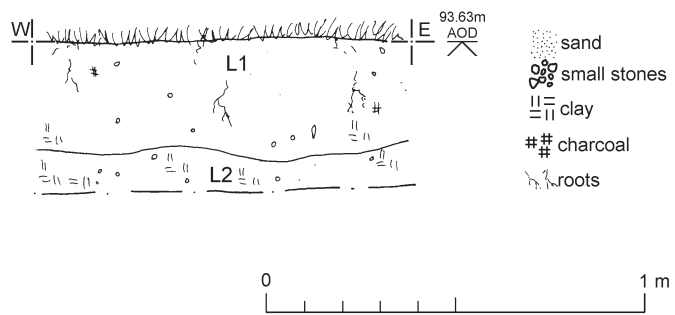

Fig 3 Representative trench section.

Essex Historic Environment Record/ Essex Archaeology and History

Summary sheet

Address: 128 Mill Road, Stock, Essex	
Parish: Stock	District: Chelmsford
NGR: TQ 6948 9875	Site code: CAT project ref.: 15/07b HER project code: SKMR15
Type of work: Evaluation	Site director/group: Colchester Archaeological Trust
Date of work: 22nd July 2015	Size of area investigated: C 20m2
Location of curating museum: Chelmsford Museum accession code : 2015.117	Funding source: Developer
Further seasons anticipated? no	Related EHER number: EHER 5507, 5391, 48334, 46565
Final report: CAT Report 854	
Periods represented: modern	
Summary of fieldwork results: <i>An archaeological evaluation by trial-trenching on land at 128 Mill Road, Stock, revealed no significant archaeological features or finds. The only features seen were two modern drains. Other minor modern disturbance was identified by fragments of modern brick and plastic. Modern topsoil directly sealed natural geological deposits.</i>	
Previous summaries/reports: None	
ECC Monitor: Alison Bennett	
Keywords:	Significance: -
Author of summary: Pip Parmenter	Date of summary: August 2015