

Huntercombe Manor Burnham, Buckinghamshire

Historic Building Analysis of Wall Fragment



September 2002

Client: Fairhursts

Issue No: 1

OA Job No: 1528

Historic Buildings Assessment

Client Name: Fairhurst

Document Title: Huntercombe Manor, Burnham, Buckinghamshire

Document Type: Historic Building Assessment
Issue Number: 1

National Grid Reference: SU93129 80677

OA Job Number: 1528
Invoice Code: HUMWBS

Archive Location: Buckinghamshire County Museum
Accession Number: AYBCM 2002.122

Prepared by: BMJ
Position: Supervisor (Buildings)
Date:

Checked by: Julian Munby
Position: Head Of Buildings Archaeology
Date:

Approved by: Julian Munby
Position: Head Of Buildings Archaeology
Date:

Document File Location
Graphics File Location
Illustrated by

Disclaimer:

This document has been prepared for the titled project or named part thereof and should not be relied upon or used for any other project without an independent check being carried out as to its suitability and prior written authority of Oxford Archaeology being obtained. Oxford Archaeology accepts no responsibility or liability for the consequences of this document being used for a purpose other than the purposes for which it was commissioned. Any person/party using or relying on the document for such other purposes agrees, and will by such use or reliance be taken to confirm their agreement to indemnify Oxford Archaeology for all loss or damage resulting therefrom. Oxford Archaeology accepts no responsibility or liability for this document to any party other than the person/party by whom it was commissioned.

© Oxford Archaeological Unit Ltd 2001

Oxford Archaeology

Janus House
Osney Mead

Oxford OX2 0ES

t: (0044) 1865 263800

f: (0044) 1865 793496

e: info@oxfordarch.co.uk

w: www.oxfordarch.co.uk

Oxford Archaeological Unit Limited is a Registered Charity No: 285627

HUNTERCOMBE MANOR, BUCKINGHAMSHIRE

HISTORIC BUILDING ANALYSIS

CONTENTS

1	Introduction	1
1.1	Location and scope of work.....	1
1.2	Archaeological and historical background.....	1
2	Objectives	2
2.1	The objectives were:.....	2
2.1.1	Investigation of the walls fabric.....	2
2.1.2	Investigation of the walls location.....	2
3	Methodology	3
3.1	Scope of Analysis.....	3
3.2	Fieldwork methods and recording.....	3
3.2.1	The Base Survey.....	3
3.2.2	The Drawn Record.....	3
3.2.3	The Photographic Record.....	3
3.2.4	The Written Record.....	3
4	Description	4
4.1	General Form.....	4
4.1.1	Primary Material.....	4
4.1.2	Material A.....	4
4.1.3	Material B.....	4
4.2	Conclusion.....	4
5	Plates	5
6	Summary of Site Details	7

LIST OF FIGURES

- Fig. 1 Site location map
Fig 2 Wall location plan
Fig 3 Wall elevation



HUNTERCOMBE MANOR, BUCKINGHAMSHIRE

HISTORIC BUILDING ANALYSIS

SUMMARY

Oxford Archaeology (OA) carried out archaeological and historical analysis of a small section of wall to the west of Huntercombe manor. The wall was found to be significantly altered and containing only a single blocked entrance. All distinguishing features of the walls form were proved to be of later date to the primary construction, the materials of which date the fabric to before 1700.

1 INTRODUCTION

1.1 LOCATION AND SCOPE OF WORK

- 1.1.1 This report focuses upon a single small length of wall to the north-west corner of Huntercombe Manor main house (now Huntercombe Hospital), partially overbuilt by a small late extension of the main building.
- 1.1.2 Huntercombe Manor is a Grade I listed building and the current work relates to the granting of planning permission and listed building consent for the demolition and replacement of a section of service wall to the service yard at the site (ref: 02/00819/LBC). The permission was granted in 2002 by South Bucks Council and the works have also included the insertion of double doors.
- 1.1.3 The wall is at present some way out of plumb, leaning to the east, and is to be dismantled and rebuilt on its present foundations utilising the existing bricks. The rebuilt wall will include a new service door, but will infill the present void to the north.

1.2 ARCHAEOLOGICAL AND HISTORICAL BACKGROUND

- 1.1.4 Huntercombe manor is a grade one listed building on the border between Berkshire and Buckinghamshire and it is presently occupied as a specialist hospital. The building comprises a largely Victorian and later exterior with sections of 17th and medieval timber and masonry internally.
- 1.1.5 There are four considerable phases of works to the main building
- Works associated with C14th Burnham Abbey ownership.
 - Works associated with the George Evelyn ownership of the mid to late C17th, including the east end and an admired reworking of the large grounds.
 - Works associated with the 1887 constructions and garden works by Mrs Eleanor Vere Boyle, who constructed the west wing.
 - Works associated with the present owners.



2 OBJECTIVES

2.1 THE OBJECTIVES WERE:

2.1.1 INVESTIGATION OF THE WALLS FABRIC

- Record fabric
- Ascertain dating and phasing evidence

2.1.2 INVESTIGATION OF THE WALLS LOCATION

- Brief historic map research
- Link wall into framework of house

3 METHODOLOGY

3.1 SCOPE OF ANALYSIS

The analysis was undertaken on a single approximately 7m length of wall external but attached to the Huntercombe buildings. The analysis did not include any sections of the building other than those directly adjacent to the section of wall.

3.2 FIELDWORK METHODS AND RECORDING

3.2.1 THE BASE SURVEY

The base survey for the present programme of archaeological recording was conducted at 1:20 using level and hand-tapes, measurements within this survey is accurate to plus or minus 5cm, although it is intended solely for archaeological use.

3.2.2 THE DRAWN RECORD

A series of annotations were made to the survey drawings, with additional details added to allow the reconstruction of basic elevations and brickwork construction.

3.2.3 THE PHOTOGRAPHIC RECORD

A full black and white negative and colour slide photographic record was made by OA of all features and details.

3.2.4 THE WRITTEN RECORD

Written descriptions of the structure were made as part of the annotated drawings, additional notes were taken as appropriate.



4 DESCRIPTION

4.1 GENERAL FORM

1.1.6 The wall is formed in three phases

4.1.1 PRIMARY MATERIAL

The primary phase of construction is formed to the full height of the wall from soft handmade red brickwork and coarse white lime mortar. The bricks are generally 210mm by 100mm by 60mm thick, and are consistent with a date somewhere in the later 17th century. It is believed that this phase of the wall is related to the late 17th century garden works by George Evelyn, although no map evidence was found during the brief historic survey.

4.1.2 MATERIAL A

Material A shown on figure 3, is formed from similar bricks to the primary build, with the inclusion of considerable number of later high fired orange bricks of a larger size. The mortar in this phase is a sandy light brown semi hydraulic lime or poor cement based mortar. This phase is consistent with a late 19th century or early 20th century build and it is believed that this element relates to the structure directly adjacent to the wall.

The decorative string seems to belong to this phase and was certainly inserted after the construction of the wall. This material and its location close to the Eleanor Vere Boyle extension of 1887 suggests it may be part of her works to this end of the building, though it could be later.

4.1.3 MATERIAL B

This reuses a mixture of Primary and phase A brickwork, and a cement based mortar. This phase is certainly post 1940 and is probably considerably more recent.

4.2 CONCLUSION

1.1.7 The wall is a simple 17th century brick wall, which may have had some decorative string work, however the present stringcourse is a far more modern confection. The considerable rebuild and interference with the walls structure greatly reduce its historic significance, and the work to the decoration is only of interest as a possible part of the Eleanor Vere Boyle works of 1887.

1.1.8 More map evidence has been sourced but was not available in time for inclusion in this issue, although it is felt that this would be unlikely to provide a narrower date that has been suggested here.



5 PLATES



Plate 1 : North end of Elevation



Plate 2 : South end of Elevation



Plate 3 : Detail Close-up

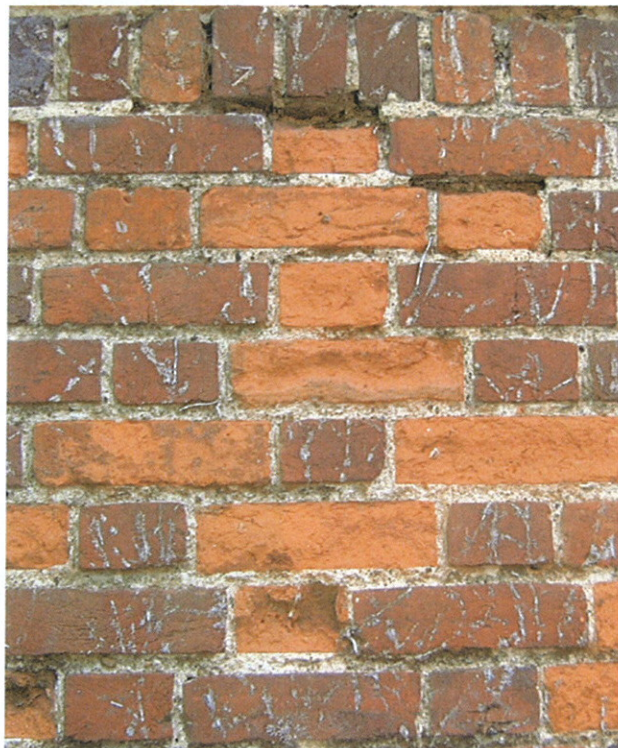

Plate 4 : Brickwork Detail



6 SUMMARY OF SITE DETAILS

Site name: Huntercombe Manor

Site code: HUMWBS

Type of evaluation: Building Analysis

Date and duration of project:

Summary of results: Short length of 17th century wall with later additions and alterations.

Location of archive: The archive is currently held at OA,
Janus House, Osney Mead, Oxford, OX2 0ES.



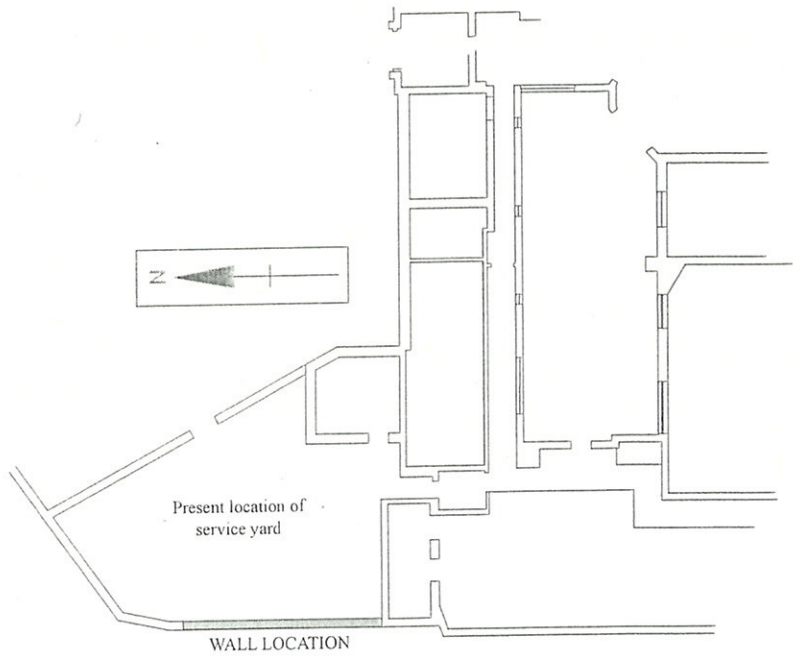
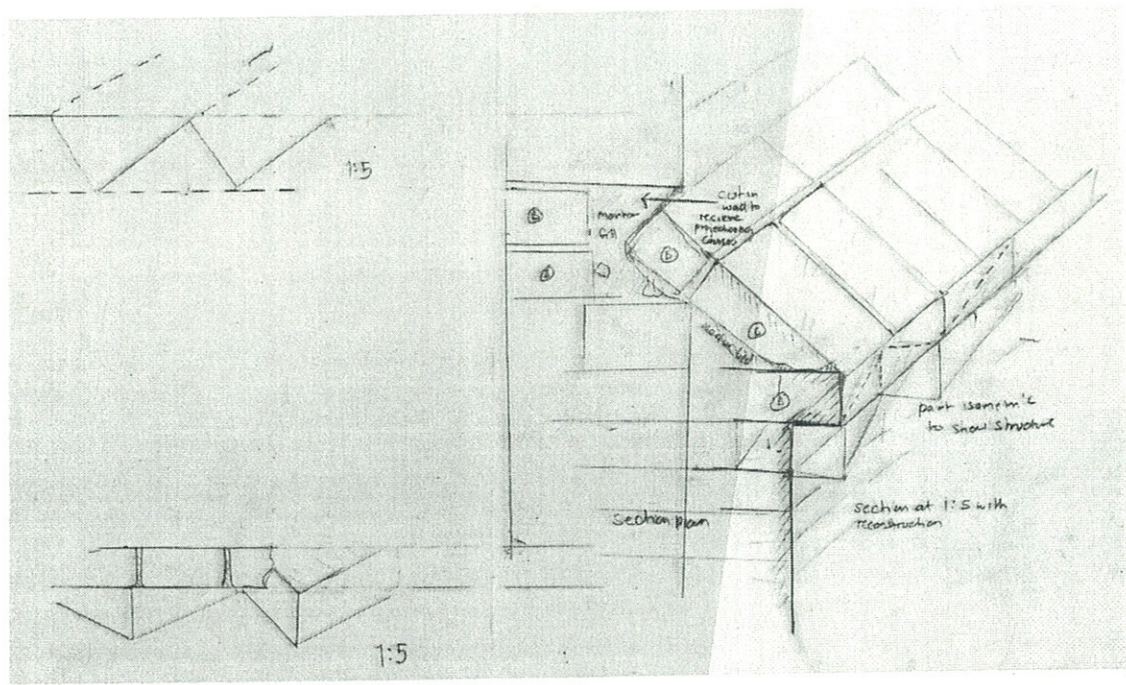

FIG 1: LOCATION OF WALL SECTION WITHIN HUNTERCOOMBE



WALL DETAILING

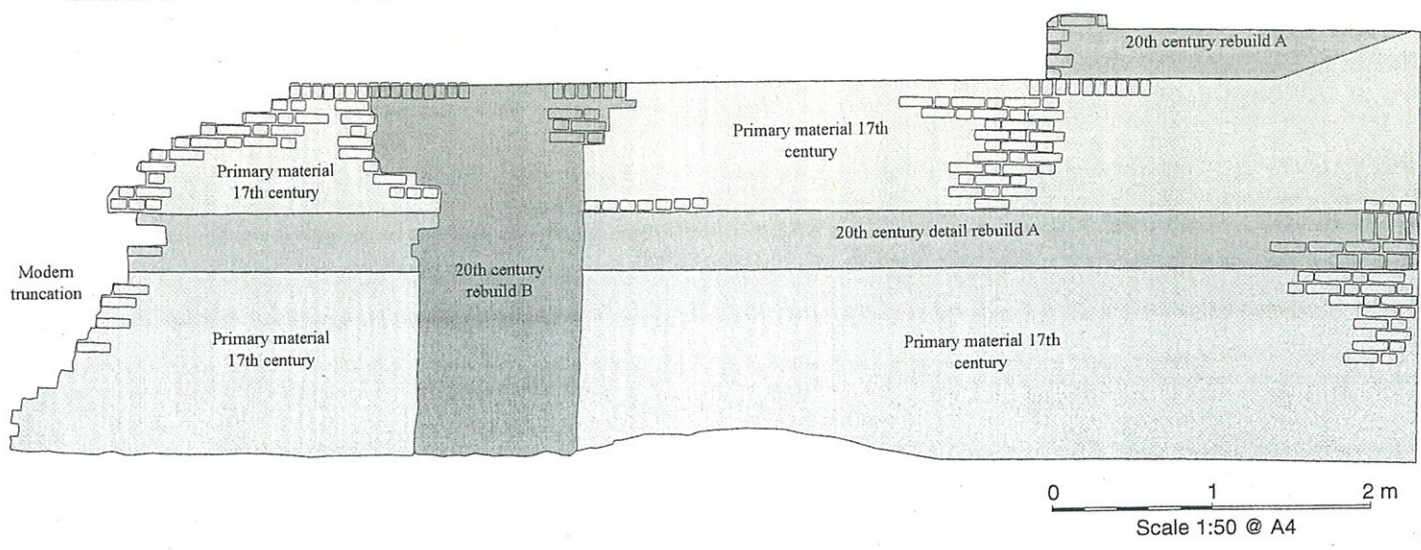

FIG 3: WESTERN ELEVATION OF WALL SHOWING PHASING



Oxford Archaeology

Janus House
Osney Mead
Oxford OX2 0ES

t: (0044) 01865 263800
f: (0044) 01865 793496
e: info@oxfordarch.co.uk
w: www.oxfordarch.co.uk



Oxford Archaeology North

Storey Institute
Meeting House Lane
Lancaster LA1 1TF

t: (0044) 01524 541000
f: (0044) 01524 848606
e: lancinfo@oxfordarch.co.uk
w: www.oxfordarch.co.uk



Director: David Jennings, BA MIFA FSA

Oxford Archaeological Unit is a
Private Limited Company, N^o: 1618597
and a Registered Charity, N^o: 285627

Registered Office:

Oxford Archaeological Unit
Janus House, Osney Mead, Oxford OX2 0ES