

# Land North-East of Bridgwater Somerset



## Archaeological Evaluation Report

oxfordarchaeology



southsouthsouth

January 2010

**Client: CgMs on behalf of Hallam  
Land Management Ltd**

Issue No: Final  
OA Job No: 4607  
NGR: ST 313 389



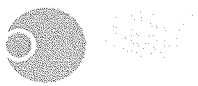

Client Name: CgMs on behalf of Hallam Land Management Ltd  
Client Ref No:  
Document Title: Land North-East of Bridgwater, Somerset  
Document Type: Evaluation Report  
Issue/Version Number: Final  
Grid Reference: NGR: ST 313 389  
Planning Reference:  
OA Job Number: 4607  
Site Code: TTNCM:247/2009  
Invoice Code: BRNELEV  
Receiving Museum: Somerset  
Museum Accession No: 28324  
Event No:

Issue	Prepared by	Checked by	Approved by	Signature
1	Gerry Thacker Project Officer	Stuart Foreman Senior Project Manager	Dan Poore Head of Fieldwork	

Document File Location Server 1:\Projects\Bridgwater Somerset  
Graphics File Location Servergo:\B-invoice codes\BRNELEV  
Illustrated by Mark Dunkley

**Disclaimer:**

*This document has been prepared for the titled project or named part thereof and should not be relied upon or used for any other project without an independent check being carried out as to its suitability and prior written authority of Oxford Archaeology being obtained. Oxford Archaeology accepts no responsibility or liability for the consequences of this document being used for a purpose other than the purposes for which it was commissioned. Any person/party using or relying on the document for such other purposes agrees, and will by such use or reliance be taken to confirm their agreement to indemnify Oxford Archaeology for all loss or damage resulting therefrom. Oxford Archaeology accepts no responsibility or liability for this document to any party other than the person/party by whom it was commissioned.*

© Oxford Archaeological Unit Ltd 2010

Janus House

Osney Mead

Oxford OX2 0ES

t: +44 (0) 1865 263800

e: oasouth@thehumanjourney.net

f: +44 (0) 1865 793496

w: oasouth.thehumanjourney.net

Oxford Archaeological Unit Limited is a Registered Charity No: 285627





## **Land North-East of Bridgwater**

### *Archaeological Evaluation Report*

*Written by Gerry Thacker and illustrated by Mark Dunkley*

### **Table of Contents**

<b>Summary.....</b>	<b>3</b>
<b>1 Introduction.....</b>	<b>4</b>
1.1 Location and scope of work.....	4
1.2 Geology and topography.....	4
1.3 Archaeological and historical background.....	4
1.4 Acknowledgements.....	5
<b>2 Evaluation Aims and Methodology.....</b>	<b>6</b>
2.1 Aims.....	6
2.2 Methodology.....	6
<b>3 Results.....</b>	<b>8</b>
3.1 Introduction and presentation of results.....	8
3.2 General soils and ground conditions.....	8
3.3 Finds summary.....	8
<b>4 Discussion.....</b>	<b>9</b>
4.1 Reliability of field investigation.....	9
4.2 Interpretation.....	9
4.3 Significance.....	9
<b>Appendix A. Trench Descriptions and Context Inventory.....</b>	<b>10</b>
<b>Appendix B. Bibliography and References.....</b>	<b>26</b>
<b>Appendix C. Summary of Site Details.....</b>	<b>27</b>



### List of Figures

- Fig. 1 Site location
- Fig. 2 Trench location
- Fig. 3 Representative trench sections
- Fig. 4 Representative images of trenches



### **Summary**

*During December 2009 to January 2010 Oxford Archaeology (OA) carried out a field evaluation on land to the north-east of Bridgwater, Somerset. The evaluation consisted of the machine excavation of 48 trenches measuring 50 m by 1.9 m, with a maximum depth of 1 m. No archaeological features were identified. No artefacts or ecofacts were recovered. Access to the trenches was restricted due to the wet ground conditions and consequently unstable trench sides. Nevertheless, visibility was good.*



## 1 INTRODUCTION

### 1.1 Location and scope of work

- 1.1.1 Between the 14<sup>th</sup> of December 2009 and the 7<sup>th</sup> of January 2010 Oxford Archaeology (OA) carried out a field evaluation on land at Little Sydenham Farm, near Bridgwater, Somerset, centred on NGR: ST 313 389 (Fig.1). The evaluation was undertaken on behalf of CgMs for Hallam Land Management Ltd. The area evaluated was c 26.7 hectares.
- 1.1.2 The evaluation consisted of 48 trenches measuring 1.9 m in width and 50 m in length, except where these were shortened to avoid buried or overhead services. All trenches were machine excavated to a maximum safe working depth of 1 m.

### 1.2 Geology and topography

- 1.2.1 The site lies in the valley of the river Parrett, within the Somerset Levels at heights of between c 6 m to 8 m OD. The site is bordered to the east by the M5 motorway, and to the west by the Penzance to Bristol railway. Current land use is pastoral to the north and arable to the south of the site.
- 1.2.2 The underlying geology is identified as deposits of Upper Keuper Marl, overlain by bands of riverine alluvium interspersed with isolated peat deposits. This alluvial sequence is up to 22 m in depth below current ground level (OA 2008).

### 1.3 Archaeological and historical background

- 1.3.1 There are no records of archaeological features or finds from the earlier or later prehistoric periods within the site, and there is only limited evidence from the vicinity of the site. Previous archaeological investigations within the Somerset levels have revealed significant evidence for occupation and exploitation of the wetland resources from the Mesolithic to Iron Age periods. The paucity of known evidence from the area of the site may be a function of its proximity to the tidal floodplain of the river Parrett, with seasonal inundations not conducive to settlement. Any such prehistoric evidence that is present would however have been sealed by later episodes of alluvial deposition (CgMs 2009).
- 1.3.2 There are no Roman remains recorded within the site, although remains of this date have been recorded within a 1 km radius of the site. These comprise a major settlement (and possible port) on the former course of the river Parratt on the Crandon Bridge to Puriton road and a large linear settlement at Down end and Chilton Trinity, to the west of the application area. Roman roads and salterns have also been recorded in the vicinity of the site.
- 1.3.3 The site appears to have been in agricultural use from the Saxon to the post-medieval periods, with only a few medieval finds recovered. The deserted medieval village of Horsey, a Scheduled Monument (SAM No. 33729), lies to the east of the site, on the opposite side of the M5.
- 1.3.4 To further examine the potential of the site, a geoarchaeological assessment of the application area was undertaken (OA 2008). This involved a geophysical survey (combined with LIDAR data), and a programme of boreholes and test pits.
- 1.3.5 The geoarchaeological assessment revealed four zones of sedimentation. Two of these (zones A and C) represented large channel systems, one a channel edge environment (zone B) and one an area of alluvial floodplain undisturbed by former channel activity





(zone D). The channel systems contained localised peat deposits located between 2 m and -2.5 m OD. These deposits have the potential to contain waterlogged structures from the Neolithic and Bronze Ages. They are overlain by considerable depths of later alluvial deposits which have the potential to contain remains of Roman, Saxon, medieval or post-medieval date. The evaluation was situated on the area of zone B, the former channel edge environment (OA, 2008).

## **1.4 Acknowledgements**

- 1.4.1 The evaluation was commissioned by Rob Bourn of CgMs on behalf of Hallam Land Management Ltd. The fieldwork was managed for OA by Stuart Foreman and conducted by Gerry Thacker and Neil Lambert, with the assistance of Chris Pickard, Michael Harris, Paul Clarke and Rowan McAlley.



## 2 EVALUATION AIMS AND METHODOLOGY

### 2.1 Aims

#### ***General***

2.1.1 The aims of the evaluation were to determine the location, extent, date, character and state of preservation of any archaeological remains surviving within the study area. Attention was to be given to remains of all periods including evidence for past environments, with provision for environmental sampling included. However the depth of the evaluation trenches was limited to the depth of the main zone of construction impact, the top 1 m of the sediment sequence, within which Roman and later sediments might be present. Prehistoric remains were expected to be at greater depth.

#### ***Detailed aims and objectives***

- 2.1.2
- (i) To determine or confirm the general nature of any remains present.
  - (ii) To determine or confirm the approximate date or date range of any remains, by means of artefactual or other evidence.
  - (iii) To determine or confirm the approximate extent of any remains.
  - (iv) To determine the condition and state of preservation of any remains.
  - (v) To determine the degree of complexity of the horizontal and/or vertical stratigraphy present.
  - (vi) To determine or confirm the likely range, quality and quantity of any artefactual evidence present.
  - (vii) To determine the potential of the site to provide palaeo-environmental and/or economic evidence.

### 2.2 Methodology

- 2.2.1 All trenches were laid out by a surveyor using a GPS system tied into the Ordnance Survey grid. All levels were related to Ordnance Survey datum level.
- 2.2.2 All trenches were scanned with a Cable Avoidance Tool prior to excavation. Where buried or overhead services were present, trenches were moved or shortened to allow a safe exclusion zone, and the new locations recorded (see Fig. 2). All plant was fitted with boom height restriction, and was banked when traversing below overhead cables.
- 2.2.3 Trenches were machine-excavated using a toothless ditching bucket under close archaeological supervision. Topsoil and subsoil were stored separately and reinstated in reverse order of excavation.
- 2.2.4 Trenches were excavated to a safe working depth of no greater than 1 m.
- 2.2.5 A representative section was cleaned, photographed and recorded in all trenches. All trenches were photographed with black and white 35 mm film. A digital photographic record was also maintained. All trenches had Ordnance Datum levels recorded at ground level at both ends and at three points along the base.
- 2.2.6 Due to flooding, trenches were backfilled soon after they had been recorded with the prior agreement of the Somerset County Council Archaeological Officer.



- 2.2.7 The excavation and backfilling of all trenches were monitored for the presence of great crested newts by an ecologist from FCPR Ecology.



### 3 RESULTS

#### 3.1 Introduction and presentation of results

3.1.1 No archaeological features were identified during the course of the evaluation. Descriptions of all deposits and details of trenches are tabulated in Appendix 1.

#### 3.2 General soils and ground conditions

3.2.1 All trenches were sealed by an upper layer of topsoil which had a depth of between 0.15 m (Trench 44) and 0.37 m (Trench 26). The majority of trenches contained a subsoil (a buried ploughsoil, essentially re-worked alluvium), which measured between 0.1 m (Trench 26) and 0.4 m (Trench 34) in depth (Figs 3 and 4). This subsoil was generally not present towards the centre of the evaluated area (Trenches 14 to 32). This is likely to be a function of recent agricultural practices, and is closely reflected by the current field boundaries.

3.2.2 All trenches contained alluvial deposits which were generally mid to light brown silty clays becoming grayer and with a greater manganese component with depth (Figs 3 and 4). In a minority of trenches, especially towards the extreme south of the evaluated area, the alluvium had a more yellow tinge suggestive of a more oxidised sequence. Very occasional charcoal fragments were present in the alluvial deposits to the extreme north.

3.2.3 Manganese flecks were present in the alluvium in the majority of trenches. It is thought that these are post-depositional and caused by fluctuations in the water table.

#### 3.3 Finds summary

3.3.1 No artefactual or ecofactual evidence was recovered.



## 4 DISCUSSION

### 4.1 Reliability of field investigation

- 4.1.1 Ground conditions were reasonable, although trench flooding was an issue. The bases of all trenches were visible in plan prior to any flooding, and any archaeological features present would have been identified.

### 4.2 Interpretation

- 4.2.1 It seems likely that the evaluated area has, during the historic period, remained agricultural. The likelihood of flooding from the tidal river Parratt appears to have precluded any settlement within the flood plain. No evidence for salt production was uncovered. No features relating to the deserted medieval settlement at Horsey were uncovered.

### 4.3 Significance

- 4.3.1 No significant archaeological features or deposits are present within the uppermost metre of the evaluated area.



## APPENDIX A. TRENCH DESCRIPTIONS AND CONTEXT INVENTORY

Trench 1						
<b>General description</b>				<b>Orientation</b>		N-S
Trench devoid of archaeology. Consists of topsoil and subsoil overlying alluvium.				<b>Avg. depth (m)</b>		1
				<b>Width (m)</b>		1.9
				<b>Length (m)</b>		50
Contexts						
context no	type	Width (m)	Depth (m)	comment	finds	date
101	Layer	-	0.2	Topsoil	-	-
102	Layer	-	0.2	Subsoil	-	-
103	Layer	-	>0.6	Alluvium	-	-

Trench 2						
<b>General description</b>				<b>Orientation</b>		E-W
Trench devoid of archaeology. Consists of topsoil and subsoil overlying alluvium.				<b>Avg. depth (m)</b>		1
				<b>Width (m)</b>		1.9
				<b>Length (m)</b>		50
Contexts						
context no	type	Width (m)	Depth (m)	comment	finds	date
201	Layer	-	0.2	Topsoil	-	-
202	Layer	-	0.22	Subsoil	-	-
203	Layer	-	>0.6	Alluvium	-	-

Trench 3						
<b>General description</b>				<b>Orientation</b>		E-W
Trench devoid of archaeology. Consists of topsoil and subsoil overlying alluvium.				<b>Avg. depth (m)</b>		1
				<b>Width (m)</b>		1.9
				<b>Length (m)</b>		50
Contexts						
context no	type	Width (m)	Depth (m)	comment	finds	date
301	Layer	-	0.2	Topsoil	-	-
302	Layer	-	0.25	Subsoil	-	-
303	Layer	-	>0.55	Alluvium	-	-



Trench 4						
<b>General description</b>				<b>Orientation</b>		N-S
Trench devoid of archaeology. Consists of topsoil and subsoil overlying alluvium.				<b>Avg. depth (m)</b>		1
				<b>Width (m)</b>		1.9
				<b>Length (m)</b>		50
Contexts						
context no	type	Width (m)	Depth (m)	comment	finds	date
401	Layer	-	0.2	Topsoil	-	-
402	Layer	-	0.22	Subsoil	-	-
403	Layer	-	>0.6	Alluvium	-	-

Trench 5						
<b>General description</b>				<b>Orientation</b>		E-W
Trench devoid of archaeology. Consists of topsoil and subsoil overlying alluvium which has increasing manganese inclusions with depth. Manganese was noticeable at 0.7 m below ground level. Trench shortened to east by 13 m due to presence of buried service.				<b>Avg. depth (m)</b>		1
				<b>Width (m)</b>		1.9
				<b>Length (m)</b>		37
Contexts						
context no	type	Width (m)	Depth (m)	comment	finds	date
501	Layer	-	0.29	Topsoil	-	-
502	Layer	-	0.16	Subsoil	-	-
503	Layer	-	> 0.55	Alluvium	-	-

Trench 6						
<b>General description</b>				<b>Orientation</b>		N-S
Trench devoid of archaeology. Consists of topsoil and subsoil overlying alluvium.				<b>Avg. depth (m)</b>		1
				<b>Width (m)</b>		1.9
				<b>Length (m)</b>		50
Contexts						
context no	type	Width (m)	Depth (m)	comment	finds	date
601	Layer	-	0.23	Topsoil	-	-
602	Layer	-	0.3	Subsoil	-	-
603	Layer	-	> 0.45	Alluvium	-	-

Trench 7		
<b>General description</b>		<b>Orientation</b>
		NE-SW



Trench devoid of archaeology. Consists of topsoil and subsoil overlying alluvium. Trench shortened to west by 10 m due to proximity to pylon.		<b>Avg. depth (m)</b>	1			
		<b>Width (m)</b>	1.9			
		<b>Length (m)</b>	40			
<b>Contexts</b>						
<b>context no</b>	<b>type</b>	<b>Width (m)</b>	<b>Depth (m)</b>	<b>comment</b>	<b>finds</b>	<b>date</b>
701	Layer	-	0.25	Topsoil	-	-
702	Layer	-	0.3	Subsoil	-	-
703	Layer	-	> 0.45	Alluvium	-	-

<b>Trench 8</b>						
<b>General description</b>				<b>Orientation</b>	E-W	
Trench devoid of archaeology. Consists of topsoil and subsoil overlying alluvium.				<b>Avg. depth (m)</b>	1	
				<b>Width (m)</b>	1.9	
				<b>Length (m)</b>	50	
<b>Contexts</b>						
<b>context no</b>	<b>type</b>	<b>Width (m)</b>	<b>Depth (m)</b>	<b>comment</b>	<b>finds</b>	<b>date</b>
801	Layer	-	0.2	Topsoil	-	-
802	Layer	-	0.25	Subsoil	-	-
803	Layer	-	> 0.55	Alluvium	-	-

<b>Trench 9</b>						
<b>General description</b>				<b>Orientation</b>	N-S	
Trench devoid of archaeology. Consists of topsoil and subsoil overlying alluvium. Alluvium contains increasing manganese inclusions with depth. Manganese starts to appear 0.8 m below ground level.				<b>Avg. depth (m)</b>	1	
				<b>Width (m)</b>	1.9	
				<b>Length (m)</b>	50	
<b>Contexts</b>						
<b>context no</b>	<b>type</b>	<b>Width (m)</b>	<b>Depth (m)</b>	<b>comment</b>	<b>finds</b>	<b>date</b>
901	Layer	-	0.23	Topsoil	-	-
902	Layer	-	0.2	Subsoil	-	-
903	Layer	-	> 0.55	Alluvium	-	-

<b>Trench 10</b>						
<b>General description</b>				<b>Orientation</b>	N-S	
Trench devoid of archaeology. Consists of topsoil and subsoil overlying alluvium.				<b>Avg. depth (m)</b>	1	
				<b>Width (m)</b>	1.9	
				<b>Length (m)</b>	50	
<b>Contexts</b>						





context no	type	Width (m)	Depth (m)	comment	finds	date
1001	Layer	-	0.25	Topsoil	-	-
1002	Layer	-	0.22	Subsoil	-	-
1003	Layer	-	> 0.55	Alluvium	-	-

Trench 11						
<b>General description</b>				<b>Orientation</b>		E-W
Trench devoid of archaeology. Consists of topsoil and subsoil overlying alluvium which contains manganese inclusions noticeable at 0.9 m below ground level.				<b>Avg. depth (m)</b>		1
				<b>Width (m)</b>		1.9
				<b>Length (m)</b>		50
<b>Contexts</b>						
context no	type	Width (m)	Depth (m)	comment	finds	date
1101	Layer	-	0.28	Topsoil	-	-
1102	Layer	-	0.22	Subsoil	-	-
1103	Layer	-	> 0.6	Alluvium	-	-

Trench 12						
<b>General description</b>				<b>Orientation</b>		N-S
Trench devoid of archaeology. Consists of topsoil and subsoil overlying alluvium.				<b>Avg. depth (m)</b>		1
				<b>Width (m)</b>		1.9
				<b>Length (m)</b>		50
<b>Contexts</b>						
context no	type	Width (m)	Depth (m)	comment	finds	date
1201	Layer	-	0.25	Topsoil	-	-
1202	Layer	-	0.3	Subsoil	-	-
1203	Layer	-	> 0.55	Alluvium	-	-

Trench 13						
<b>General description</b>				<b>Orientation</b>		E-W
Trench devoid of archaeology. Consists of soil and subsoil overlying alluvium.				<b>Avg. depth (m)</b>		1
				<b>Width (m)</b>		1.9
				<b>Length (m)</b>		50
<b>Contexts</b>						
context no	type	Width (m)	Depth (m)	comment	finds	date
1301	Layer	-	0.25	Topsoil	-	-
1302	Layer	-	0.28	Subsoil	-	-
1303	Layer	-	> 0.5	Natural	-	-



<b>Trench 14</b>							
<b>General description</b>					<b>Orientation</b>		
Trench devoid of archaeology. Consists of topsoil overlying alluvium which contained manganese inclusions noticeable at 0.55 m below ground level. Trench was shortened by 3 m from southern end due to excessive flooding.					N-S		
					<b>Avg. depth (m)</b>		1
					<b>Width (m)</b>		1.9
					<b>Length (m)</b>		
					47		
<b>Contexts</b>							
<b>context no</b>	<b>type</b>	<b>Width (m)</b>	<b>Depth (m)</b>	<b>comment</b>	<b>finds</b>	<b>date</b>	
1401	Layer	-	0.29	Topsoil	-	-	
1402	Layer	-	> 0.7	Alluvium	-	-	

<b>Trench 15</b>							
<b>General description</b>					<b>Orientation</b>		
Trench devoid of archaeology. Consists of topsoil overlying alluvium which contained manganese inclusions noticeable at 0.88 m below ground level.					E-W		
					<b>Avg. depth (m)</b>		1
					<b>Width (m)</b>		1.9
					<b>Length (m)</b>		
					50		
<b>Contexts</b>							
<b>context no</b>	<b>type</b>	<b>Width (m)</b>	<b>Depth (m)</b>	<b>comment</b>	<b>finds</b>	<b>date</b>	
1501	Layer	-	0.24	Topsoil	-	-	
1502	Layer	-	> 0.75	Alluvium	-	-	

<b>Trench 16</b>							
<b>General description</b>					<b>Orientation</b>		
Trench devoid of archaeology. Consists of topsoil overlying alluvium which contained manganese inclusions noticeable at 1 m below ground level.					E-W		
					<b>Avg. depth (m)</b>		1
					<b>Width (m)</b>		1.9
					<b>Length (m)</b>		
					50		
<b>Contexts</b>							
<b>context no</b>	<b>type</b>	<b>Width (m)</b>	<b>Depth (m)</b>	<b>comment</b>	<b>finds</b>	<b>date</b>	
1601	Layer	-	0.3	Topsoil	-	-	
1602	Layer	-	> 0.7	Alluvium	-	-	

<b>Trench 17</b>							
<b>General description</b>					<b>Orientation</b>		
Trench devoid of archaeology. Consists of topsoil overlying natural alluvium.					E-W		
					<b>Avg. depth (m)</b>		1
					<b>Width (m)</b>		1.9
					<b>Length (m)</b>		
					50		
<b>Contexts</b>							



context no	type	Width (m)	Depth (m)	comment	finds	date
1701	Layer	-	0.35	Topsoil	-	-
1702	Layer	-	> 0.65	Alluvium	-	-

Trench 18						
<b>General description</b>				<b>Orientation</b>		E-W
Trench devoid of archaeology. Consists of topsoil and subsoil overlying alluvium. Alluvium contains manganese inclusions noticeable at 0.64 m below ground level.				<b>Avg. depth (m)</b>		1
				<b>Width (m)</b>		1.9
				<b>Length (m)</b>		50
<b>Contexts</b>						
context no	type	Width (m)	Depth (m)	comment	finds	date
1801	Layer	-	0.23	Topsoil	-	-
1802	Layer	-	0.13	Subsoil	-	-
1803	Layer	-	> 0.65	Alluvium	-	-

Trench 19						
<b>General description</b>				<b>Orientation</b>		N-S
Trench devoid of archaeology. Consists of topsoil overlying alluvium which contains occasional manganese inclusions throughout.				<b>Avg. depth (m)</b>		1
				<b>Width (m)</b>		1.9
				<b>Length (m)</b>		50
<b>Contexts</b>						
context no	type	Width (m)	Depth (m)	comment	finds	date
1901	Layer	-	0.3	Topsoil	-	-
1902	Layer	-	> 0.7	Alluvium	-	-

Trench 20						
<b>General description</b>				<b>Orientation</b>		N-S
Trench devoid of archaeology. Consists of topsoil overlying alluvium.				<b>Avg. depth (m)</b>		1
				<b>Width (m)</b>		1.9
				<b>Length (m)</b>		50
<b>Contexts</b>						
context no	type	Width (m)	Depth (m)	comment	finds	date
2001	Layer	-	0.25	Topsoil	-	-
2002	Layer	-	> 0.75	Alluvium	-	-

Trench 21						
<b>General description</b>				<b>Orientation</b>		E-W



Trench devoid of archaeology. Consists of topsoil overlying alluvium which contained manganese inclusions noticeable 0.8 m below ground level.					<b>Avg. depth (m)</b>	1
					<b>Width (m)</b>	1.9
					<b>Length (m)</b>	50
<b>Contexts</b>						
<b>context no</b>	<b>type</b>	<b>Width (m)</b>	<b>Depth (m)</b>	<b>comment</b>	<b>finds</b>	<b>date</b>
2101	Layer	-	0.3	Topsoil	-	-
2102	Layer	-	> 0.7	Alluvium	-	-

<b>Trench 22</b>						
<b>General description</b>					<b>Orientation</b>	N-S
Trench devoid of archaeology. Consists of topsoil overlying alluvium which contained manganese inclusions throughout, but increasing in frequency with depth.					<b>Avg. depth (m)</b>	1
					<b>Width (m)</b>	1.9
					<b>Length (m)</b>	50
<b>Contexts</b>						
<b>context no</b>	<b>type</b>	<b>Width (m)</b>	<b>Depth (m)</b>	<b>comment</b>	<b>finds</b>	<b>date</b>
2201	Layer	-	0.26	Topsoil	-	-
2202	Layer	-	> 0.75	Alluvium	-	-

<b>Trench 23</b>						
<b>General description</b>					<b>Orientation</b>	E-W
Trench devoid of archaeology. Consists of topsoil and subsoil overlying alluvium which contained occasional manganese inclusions throughout.					<b>Avg. depth (m)</b>	1
					<b>Width (m)</b>	1.9
					<b>Length (m)</b>	50
<b>Contexts</b>						
<b>context no</b>	<b>type</b>	<b>Width (m)</b>	<b>Depth (m)</b>	<b>comment</b>	<b>finds</b>	<b>date</b>
2301	Layer	-	0.33	Topsoil	-	-
2302	Layer	-	0.24	Subsoil	-	-
2303	Layer	-	> 0.45	Alluvium	-	-

<b>Trench 24</b>						
<b>General description</b>					<b>Orientation</b>	N-S
Trench devoid of archaeology. Consists of topsoil overlying alluvium which contained manganese inclusions noticeable at 0.84 m below ground level.					<b>Avg. depth (m)</b>	1
					<b>Width (m)</b>	1.9
					<b>Length (m)</b>	50
<b>Contexts</b>						
<b>context no</b>	<b>type</b>	<b>Width (m)</b>	<b>Depth (m)</b>	<b>comment</b>	<b>finds</b>	<b>date</b>
2401	Layer	-	0.25	Topsoil	-	-



2402	Layer	-	> 0.75	Alluvium	-	-
------	-------	---	--------	----------	---	---

Trench 25						
<b>General description</b>				<b>Orientation</b>		E-W
Trench devoid of archaeology. Consists of topsoil overlying alluvium.				<b>Avg. depth (m)</b>		1
				<b>Width (m)</b>		1.9
				<b>Length (m)</b>		50
Contexts						
context no	type	Width (m)	Depth (m)	comment	finds	date
2501	Layer	-	0.24	Topsoil	-	-
2502	Layer	-	> 0.76	Alluvium	-	-

Trench 26						
<b>General description</b>				<b>Orientation</b>		E-W
Trench devoid of archaeology. Consists of topsoil and subsoil overlying alluvium which contained occasional manganese inclusions noticeable at 0.98 m below ground level. Trench was moved 9 m to the east of its original position to create a safe exclusion zone from overhead power cables.				<b>Avg. depth (m)</b>		1
				<b>Width (m)</b>		1.9
				<b>Length (m)</b>		50
Contexts						
context no	type	Width (m)	Depth (m)	comment	finds	date
2601	Layer	-	0.37	Topsoil	-	-
2602	Layer	-	0.1	Subsoil	-	-
2603	Layer	-	> 0.55	Alluvium	-	-

Trench 27						
<b>General description</b>				<b>Orientation</b>		E-W
Trench devoid of archaeology. Consists of topsoil overlying alluvium.				<b>Avg. depth (m)</b>		1
				<b>Width (m)</b>		1.9
				<b>Length (m)</b>		50
Contexts						
context no	type	Width (m)	Depth (m)	comment	finds	date
2701	Layer	-	0.3	Topsoil	-	-
2702	Layer	-	> 0.7	Alluvium	-	-

Trench 28						
<b>General description</b>				<b>Orientation</b>		N-S
Trench devoid of archaeology. Consists of soil and subsoil overlying alluvium which contained manganese inclusions				<b>Avg. depth (m)</b>		1
				<b>Width (m)</b>		1.9



noticeable at 0.84 m below ground level.					<b>Length (m)</b>	50
<b>Contexts</b>						
context no	type	Width (m)	Depth (m)	comment	finds	date
2801	Layer	-	0.28	Topsoil	-	-
2802	Layer	-	0.14	Subsoil	-	-
2803	Layer	-	> 0.65	Alluvium	-	-

<b>Trench 29</b>						
<b>General description</b>					<b>Orientation</b>	E-W
Trench devoid of archaeology. Consists of topsoil overlying alluvium which contained manganese inclusions which were noticeable 0.6 m below ground level.					<b>Avg. depth (m)</b>	1
					<b>Width (m)</b>	1.9
					<b>Length (m)</b>	50
<b>Contexts</b>						
context no	type	Width (m)	Depth (m)	comment	finds	date
2901	Layer	-	0.25	Topsoil	-	-
2902	Layer	-	> 0.75	Alluvium	-	-

<b>Trench 30</b>						
<b>General description</b>					<b>Orientation</b>	N-S
Trench devoid of archaeology. Consists of topsoil overlying alluvium which contained manganese inclusions which were noticeable 0.8 m below ground level.					<b>Avg. depth (m)</b>	1
					<b>Width (m)</b>	1.9
					<b>Length (m)</b>	50
<b>Contexts</b>						
context no	type	Width (m)	Depth (m)	comment	finds	date
3001	Layer	-	0.2	Topsoil	-	-
3002	Layer	-	> 0.8	Alluvium	-	-

<b>Trench 31</b>						
<b>General description</b>					<b>Orientation</b>	N-S
Trench devoid of archaeology. Consists of topsoil overlying alluvium which contained occasional manganese inclusions throughout. Trench was moved 8 m to the east of its original position to avoid overhead power cables. The southern end of the trench contained a dump of modern fencing material, concrete piping and rubble.					<b>Avg. depth (m)</b>	1
					<b>Width (m)</b>	1.9
					<b>Length (m)</b>	50
<b>Contexts</b>						
context no	type	Width (m)	Depth (m)	comment	finds	date
3101	Layer	-	0.3	Topsoil	-	-



3102	Layer	-	> 0.7	Alluvium	-	-
------	-------	---	-------	----------	---	---

Trench 32						
<b>General description</b>				<b>Orientation</b>		N-S
Trench devoid of archaeology. Consists of topsoil overlying alluvium which contained manganese inclusions noticeable at 0.6 m below ground level.				<b>Avg. depth (m)</b>		1
				<b>Width (m)</b>		1.9
				<b>Length (m)</b>		50
Contexts						
context no	type	Width (m)	Depth (m)	comment	finds	date
3201	Layer	-	0.22	Topsoil	-	-
3202	Layer	-	> 0.8	Alluvium	-	-

Trench 33						
<b>General description</b>				<b>Orientation</b>		E-W
Trench devoid of archaeology. Consists of topsoil and subsoil overlying alluvium which contained occasional manganese inclusions noticeable at 0.8 m below ground level. Trench was shortened by 7 m from the west to avoid overhead power lines.				<b>Avg. depth (m)</b>		1
				<b>Width (m)</b>		1.9
				<b>Length (m)</b>		43
Contexts						
context no	type	Width (m)	Depth (m)	comment	finds	date
3301	Layer	-	0.25	Topsoil	-	-
3302	Layer	-	0.3	Subsoil	-	-
3303	Layer	-	> 0.45	Alluvium	-	-

Trench 34						
<b>General description</b>				<b>Orientation</b>		E-W
Trench devoid of archaeology. Consists of topsoil and subsoil overlying alluvium which contained occasional manganese inclusions throughout.				<b>Avg. depth (m)</b>		1
				<b>Width (m)</b>		1.9
				<b>Length (m)</b>		50
Contexts						
context no	type	Width (m)	Depth (m)	comment	finds	date
3401	Layer	-	0.3	Topsoil	-	-
3402	Layer	-	0.4	Subsoil	-	-
3403	Layer	-	> 0.3	Alluvium	-	-

Trench 35						
<b>General description</b>				<b>Orientation</b>		N-S
Trench devoid of archaeology. Consists of topsoil and subsoil overlying alluvium which contained occasional manganese				<b>Avg. depth (m)</b>		1



inclusions throughout.		<b>Width (m)</b>	1.9			
		<b>Length (m)</b>	50			
<b>Contexts</b>						
<b>context no</b>	<b>type</b>	<b>Width (m)</b>	<b>Depth (m)</b>	<b>comment</b>	<b>finds</b>	<b>date</b>
3501	Layer	-	0.2	Topsoil	-	-
3502	Layer	-	0.3	Subsoil	-	-
3503	Layer	-	> 0.5	Alluvium	-	-

<b>Trench 36</b>						
<b>General description</b>					<b>Orientation</b>	E-W
Trench devoid of archaeology. Consists of topsoil and subsoil overlying alluvium which contained manganese inclusions throughout.					<b>Avg. depth (m)</b>	1
					<b>Width (m)</b>	1.9
					<b>Length (m)</b>	50
<b>Contexts</b>						
<b>context no</b>	<b>type</b>	<b>Width (m)</b>	<b>Depth (m)</b>	<b>comment</b>	<b>finds</b>	<b>date</b>
3601	Layer	-	0.24	Topsoil	-	-
3602	Layer	-	0.3	Subsoil	-	-
3603	Layer	-	> 0.5	Alluvium	-	-

<b>Trench 37</b>						
<b>General description</b>					<b>Orientation</b>	N-S
Trench devoid of archaeology. Consists of topsoil and subsoil overlying alluvium which contained manganese inclusions noticeable at 0.8 m below ground level.					<b>Avg. depth (m)</b>	1
					<b>Width (m)</b>	1.9
					<b>Length (m)</b>	50
<b>Contexts</b>						
<b>context no</b>	<b>type</b>	<b>Width (m)</b>	<b>Depth (m)</b>	<b>comment</b>	<b>finds</b>	<b>date</b>
3701	Layer	-	0.3	Topsoil	-	-
3702	Layer	-	0.3	Subsoil	-	-
3703	Layer	-	> 0.4	Alluvium	-	-

<b>Trench 38</b>						
<b>General description</b>					<b>Orientation</b>	N-S
Trench devoid of archaeology. Consists of topsoil and subsoil overlying alluvium which contained manganese inclusions throughout.					<b>Avg. depth (m)</b>	1
					<b>Width (m)</b>	1.9
					<b>Length (m)</b>	50
<b>Contexts</b>						
<b>context no</b>	<b>type</b>	<b>Width (m)</b>	<b>Depth (m)</b>	<b>comment</b>	<b>finds</b>	<b>date</b>





3801	Layer	-	0.24	Topsoil	-	-
3802	Layer	-	0.32	Subsoil	-	-
3803	Layer	-	> 0.45	Alluvium	-	-

Trench 39						
<b>General description</b>				<b>Orientation</b>		E-W
Trench devoid of archaeology. Consists of topsoil and subsoil overlying alluvium which contained manganese inclusions noticeable at 0.9 m below ground level.				<b>Avg. depth (m)</b>		1
				<b>Width (m)</b>		1.9
				<b>Length (m)</b>		50
Contexts						
context no	type	Width (m)	Depth (m)	comment	finds	date
3901	Layer	-	0.24	Topsoil	-	-
3902	Layer	-	0.18	Subsoil	-	-
3903	Layer	-	> 0.6	Alluvium	-	-

Trench 40						
<b>General description</b>				<b>Orientation</b>		N-S
Trench devoid of archaeology. Consists of topsoil and subsoil overlying alluvium which contained manganese inclusions noticeable at 0.75 m below ground level.				<b>Avg. depth (m)</b>		1
				<b>Width (m)</b>		1.9
				<b>Length (m)</b>		50
Contexts						
context no	type	Width (m)	Depth (m)	comment	finds	date
4001	Layer	-	0.2	Topsoil	-	-
4002	Layer	-	0.3	Subsoil	-	-
4003	Layer	-	> 0.5	Alluvium	-	-

Trench 41						
<b>General description</b>				<b>Orientation</b>		NE-SW
Trench devoid of archaeology. Consists of topsoil and subsoil overlying alluvium which contained very occasional charcoal flecks. Trench was shortened by 14 m to avoid a buried electric cable.				<b>Avg. depth (m)</b>		1
				<b>Width (m)</b>		1.9
				<b>Length (m)</b>		36
Contexts						
context no	type	Width (m)	Depth (m)	comment	finds	date
4101	Layer	-	0.25	Topsoil	-	-
4102	Layer	-	0.3	Subsoil	-	-
4103	Layer	-	> 0.45	Alluvium	-	-



<b>Trench 42</b>						
<b>General description</b>				<b>Orientation</b>		N-S
Trench devoid of archaeology. Consists of topsoil and subsoil overlying alluvium which contained manganese inclusions noticeable at 0.92 m below ground level.				<b>Avg. depth (m)</b>		1
				<b>Width (m)</b>		1.9
				<b>Length (m)</b>		50
<b>Contexts</b>						
context no	type	Width (m)	Depth (m)	comment	finds	date
4201	Layer	-	0.24	Topsoil	-	-
4202	Layer	-	0.25	Subsoil	-	-
4203	Layer	-	> 0.5	Alluvium	-	-

<b>Trench 43</b>						
<b>General description</b>				<b>Orientation</b>		NW-SE
Trench devoid of archaeology. Consists of topsoil and subsoil overlying alluvium which contained manganese inclusions throughout.				<b>Avg. depth (m)</b>		1
				<b>Width (m)</b>		1.9
				<b>Length (m)</b>		50
<b>Contexts</b>						
context no	type	Width (m)	Depth (m)	comment	finds	date
4301	Layer	-	0.24	Topsoil	-	-
4302	Layer	-	0.19	Subsoil	-	-
4303	Layer	-	> 0.55	Alluvium	-	-

<b>Trench 44</b>						
<b>General description</b>				<b>Orientation</b>		N-S
Trench devoid of archaeology. Consists of topsoil and subsoil overlying alluvium. Trench shortened by 8 m at south end due to buried service.				<b>Avg. depth (m)</b>		1
				<b>Width (m)</b>		1.9
				<b>Length (m)</b>		42
<b>Contexts</b>						
context no	type	Width (m)	Depth (m)	comment	finds	date
4401	Layer	-	0.15	Topsoil	-	-
4402	Layer	-	0.34	Subsoil	-	-
4403	Layer	-	> 0.5	Alluvium	-	-

<b>Trench 45</b>						
<b>General description</b>				<b>Orientation</b>		NW-SE
Trench devoid of archaeology. Consists of topsoil and subsoil overlying alluvium which contained manganese inclusions noticeable at 0.9 m below ground level.				<b>Avg. depth (m)</b>		1
				<b>Width (m)</b>		1.9



					<b>Length (m)</b>	50
<b>Contexts</b>						
context no	type	Width (m)	Depth (m)	comment	finds	date
4501	Layer	-	0.25	Topsoil	-	-
4502	Layer	-	0.2	Subsoil	-	-
4503	Layer	-	> 0.55	Alluvium	-	-

<b>Trench 46</b>						
<b>General description</b>					<b>Orientation</b>	E-W
Trench devoid of archaeology. Consists of topsoil and subsoil overlying alluvium which contained manganese inclusions noticeable at 0.8 m below ground level.					<b>Avg. depth (m)</b>	1
					<b>Width (m)</b>	1.9
					<b>Length (m)</b>	50
<b>Contexts</b>						
context no	type	Width (m)	Depth (m)	comment	finds	date
4601	Layer	-	0.25	Topsoil	-	-
4602	Layer	-	0.25	Subsoil	-	-
4603	Layer	-	> 0.5	Alluvium	-	-

<b>Trench 47</b>						
<b>General description</b>					<b>Orientation</b>	E-W
Trench devoid of archaeology. Consists of topsoil and subsoil overlying alluvium which contained very occasional charcoal flecks.					<b>Avg. depth (m)</b>	1
					<b>Width (m)</b>	1.9
					<b>Length (m)</b>	50
<b>Contexts</b>						
context no	type	Width (m)	Depth (m)	comment	finds	date
4701	Layer	-	0.2	Topsoil	-	-
4702	Layer	-	0.3	Subsoil	-	-
4703	Layer	-	> 0.5	Alluvium	-	-

<b>Trench 48</b>						
<b>General description</b>					<b>Orientation</b>	N-S
Trench devoid of archaeology. Consists of topsoil and subsoil overlying alluvium.					<b>Avg. depth (m)</b>	1
					<b>Width (m)</b>	1.9
					<b>Length (m)</b>	50
<b>Contexts</b>						
context no	type	Width (m)	Depth (m)	comment	finds	date
4801	Layer	-	0.25	Topsoil	-	-



Land North-East of Bridgwater EVALUATION REPORT

---

4802	Layer	-	0.35	Subsoil	-	-
4803	Layer	-	> 0.4	Alluvium	-	-



## APPENDIX B. BIBLIOGRAPHY AND REFERENCES

CgMs, 2009 Archaeological Evaluation/Strip Map and Sample. Land North East Of Bridgwater, Somerset.

OA, 2008, Little Sydenham Farm, near Bridgwater, Somerset. Geoarchaeological Assessment Report, Oxford Archaeology unpublished report.



## APPENDIX C. SUMMARY OF SITE DETAILS

<b>Site name:</b>	Land north-east of Bridgwater, Somerset
<b>Site code:</b>	TTNCM:247/2009
<b>Grid reference:</b>	ST 313 389
<b>Type:</b>	48 trench evaluation
<b>Date and duration:</b>	14 <sup>th</sup> December 2009 to 7 <sup>th</sup> January 2010
<b>Area of site:</b>	26.7 ha
<b>Summary of results:</b>	No archaeological deposits or features were identified
<b>Location of archive:</b>	The archive is currently held at Oxford Archaeology, Janus House, Osney Mead, Oxford, OX2 0ES, and will be deposited with the Somerset County Museum in due course, under the following accession number: 28324

Servergo/oupubs1\_AtoH\*BRLISYGE\*Bridgwater\*.jrn\*15.11.07

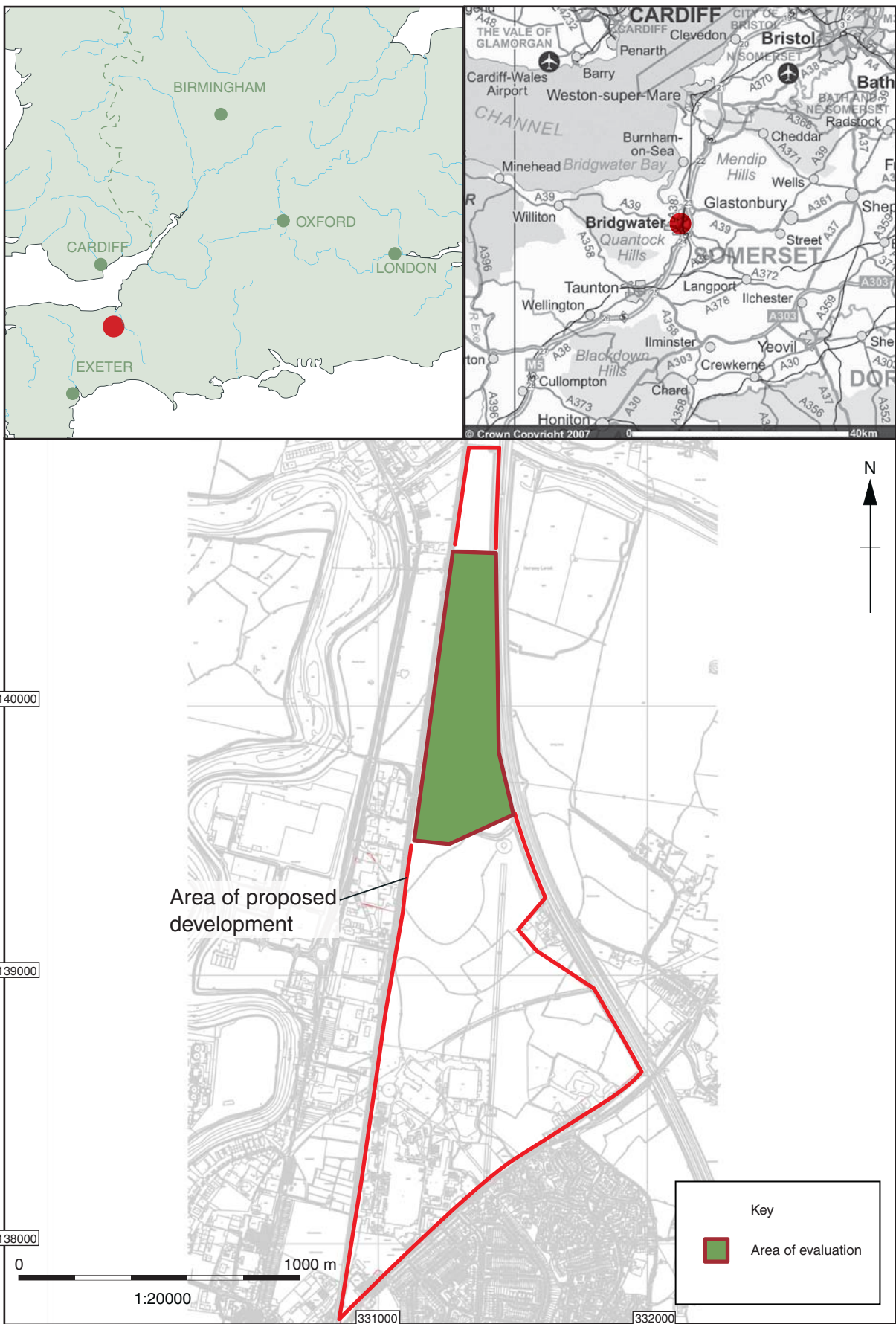

Reproduced using OS data by permission of the Ordnance Survey on behalf of The Controller of Her Majesty's Stationery Office © Crown Copyright 1974. All rights reserved. Licence No. AL 100005569

Figure 1: Site location

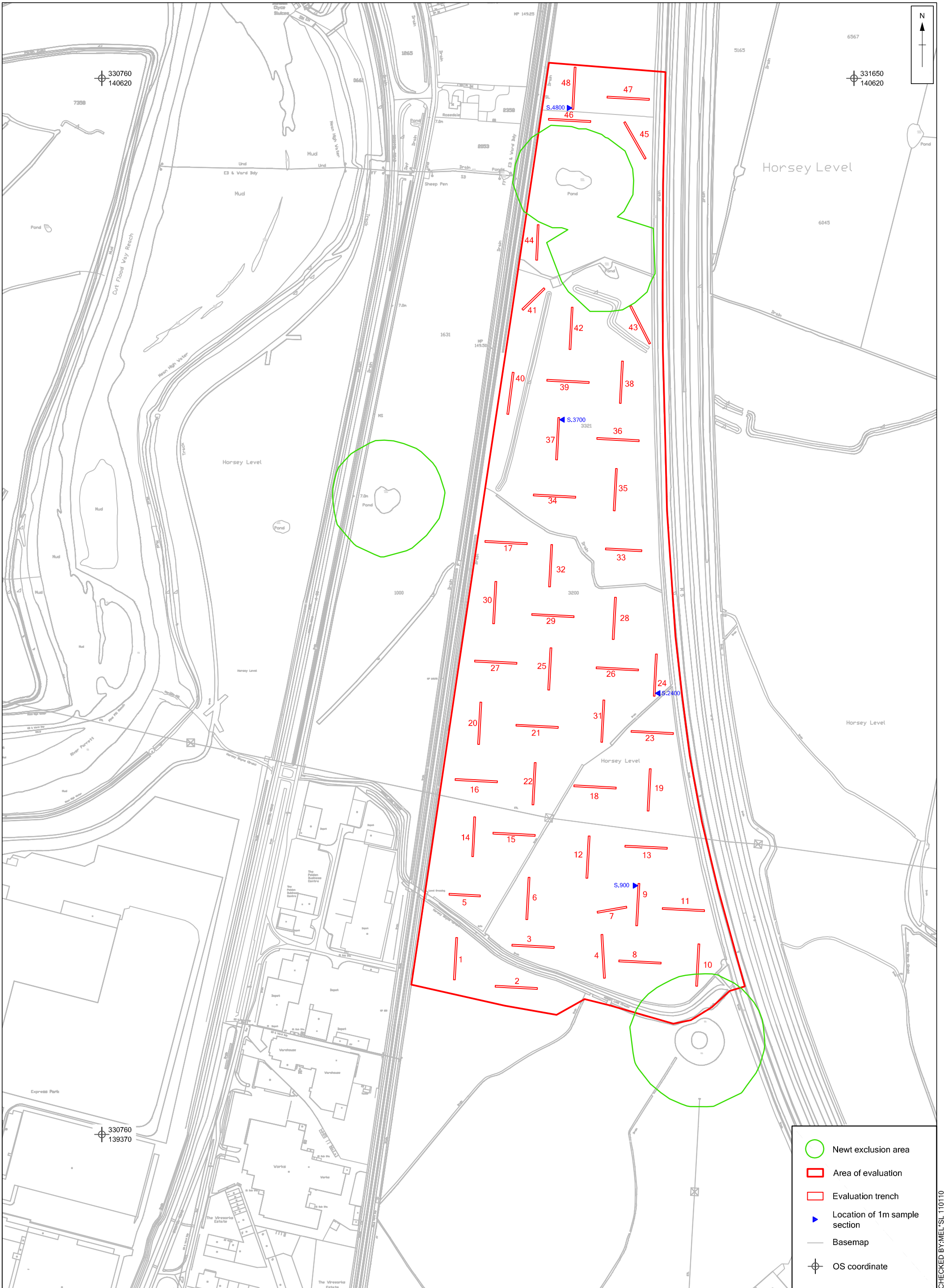
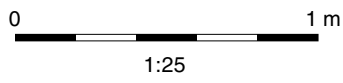
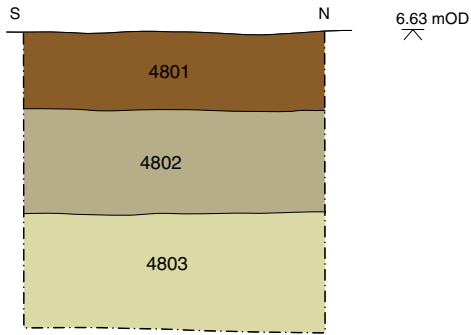

Figure 2: trench location map



### Section 4800



### Section 2400

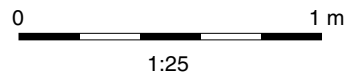
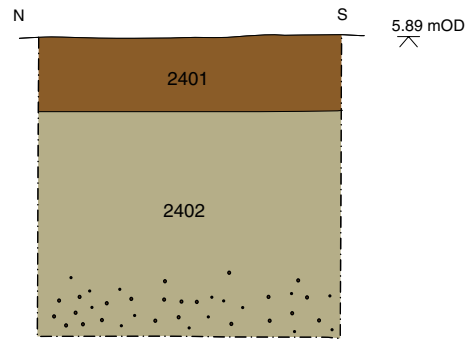

### Section 900

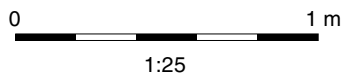
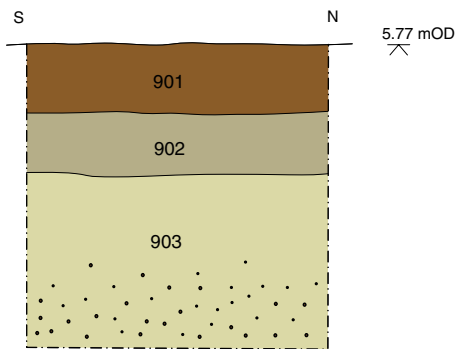

### Section 3700

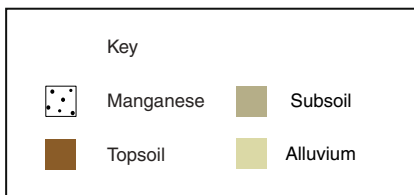
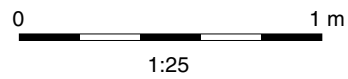
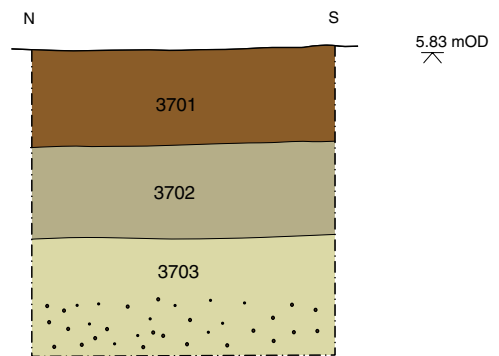

Figure 3: Representative trench sections



Trench 16



Trench 34, Section 1



Trench 44



Trench 44, Section 1

Figure 4: Representative images of trenches



#### **OA East**

15 Trafalgar Way  
Bar Hill  
Cambridgeshire  
CB23 8SQ

t: +44 (0) 1223 850500  
f: +44 (0) 1223 850599  
e: oaeast@thehumanjourney.net  
w: <http://thehumanjourney.net>

#### **OA North**

Mill 3  
Moor Lane Mills  
Moor Lane  
Lancaster LA1 1GF

t: +44 (0) 1524 541 000  
f: +44 (0) 1524 848 606  
e: oanorth@thehumanjourney.net  
w: <http://thehumanjourney.net>

#### **OA South**

Janus House  
Osney Mead  
Oxford OX2 0ES

t: +44 (0) 1865 263 800  
f: +44 (0) 1865 793 496  
e: info@oxfordarch.co.uk  
w: <http://thehumanjourney.net>

#### **OA Grand Ouest**

7 Rue des Monderaines  
ZI - Ouest  
14650 Carpiquet  
France

t: +33 (0) 249 88 01 01  
f: +33 (0) 249 88 01 02  
e: info@oago.fr  
w: <http://oago.fr>

#### **OA Méditerranée**

115 Rue Merlot  
ZAC La Louvade  
34 130 Maugeio  
France

t: +33 (0) 4.67.57.86.92  
f: +33 (0) 4.67.42.65.93  
e: oamed@thehumanjourney.net  
w: <http://oamed.fr/>

**Director:** David Jennings, BA MIFA FSA



*The Oxford Archaeological Unit Ltd is a Private Limited Company, N<sup>o</sup>: 1618597 and a Registered Charity, No: 285627  
Head Office: Janus House, Osney Mead, Oxford, OX2 0ES, t: +44 (0) 1865 263 800*