

# Hampton Court Palace Stone Ramps

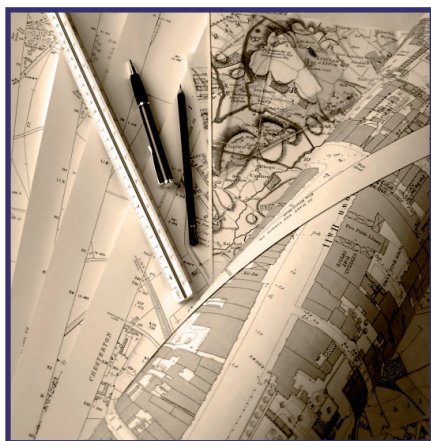

## Archaeological Watching Brief Report

oxfordarchaeology



southsouthsouth

November 2010

**Client: Historic Royal Palaces**

Issue No:1

OA Job No: 23347

NGR: TQ 1560 6870



Client Name: Historic Royal Palaces  
Client Ref No: 23347  
Document Title: Hampton Court Palace, Stone Ramps  
Document Type: Watching Brief Report  
Issue/Version Number: 1  
Grid Reference: TQ 1560 6870  
Planning Reference:  
OA Job Number: 4372  
Site Code: HCP68  
Invoice Code: HCP68WB  
Receiving Museum: Historic Royal Palaces (Hampton Court)  
Museum Accession No: TBC  
Event No:

Issue	Prepared by	Checked by	Approved by	Signature
1	Rebecca Griffin Assistant Supervisor	David Wilkinson Senior Project Manager	David Wilkinson Senior Project Manager	

Document File Location Restricted  
Graphics File Location Restricted  
Illustrated by Markus Dylewski; Julia Collins

**Disclaimer:**

*This document has been prepared for the titled project or named part thereof and should not be relied upon or used for any other project without an independent check being carried out as to its suitability and prior written authority of Oxford Archaeology being obtained. Oxford Archaeology accepts no responsibility or liability for the consequences of this document being used for a purpose other than the purposes for which it was commissioned. Any person/party using or relying on the document for such other purposes agrees, and will by such use or reliance be taken to confirm their agreement to indemnify Oxford Archaeology for all loss or damage resulting therefrom. Oxford Archaeology accepts no responsibility or liability for this document to any party other than the person/party by whom it was commissioned.*

© Oxford Archaeological Unit Ltd 2010

Janus House

Osney Mead

Oxford OX2 0ES

t: +44 (0) 1865 263800

e: oasouth@thehumanjourney.net

f: +44 (0) 1865 793496

w: oasouth.thehumanjourney.net

Oxford Archaeological Unit Limited is a Registered Charity No: 285627





# Hampton Court Palace, Stone Ramps

*Archaeological Watching Brief Report*

*Written by Rebecca Griffin*

*Illustrated by Markus Dylewski and Julia Collins*

## Table of Contents

<b>Summary</b> .....	<b>3</b>
<b>1 Introduction</b> .....	<b>4</b>
1.1 Location and scope of work.....	4
1.2 Geology and topography.....	4
1.3 Archaeological and historical background.....	4
1.4 Acknowledgements.....	4
<b>2 Watching Brief Aims and Methodology</b> .....	<b>5</b>
2.1 Aims.....	5
2.2 Methodology.....	5
<b>3 Results</b> .....	<b>6</b>
3.1 Description of deposits.....	6
3.2 Finds summary.....	6
<b>4 Discussion And Conclusions</b> .....	<b>7</b>
<b>Appendix A. Bibliography and References</b> .....	<b>8</b>
<b>Appendix B. Summary of Site Details</b> .....	<b>9</b>



## List of Figures

- Fig. 1      Site location map
- Fig. 2      Trench locations and plan with recorded sections
- Fig. 3      Trench 3 - Plan and Sections 100, 101



## **Summary**

*In July 2009, Oxford Archaeology (OA) carried out an archaeological watching brief at Hampton Court Palace, Surrey (NGR TQ 1560 6870). The work was commissioned by Historic Royal Palaces in advance of the installation of the new stone access ramps at the entrances to buildings on the south side of Tennis Court Lane. The watching brief revealed overburden relating to live services within the buildings, service trenches and 19th-century brick-built drains.*



## 1 INTRODUCTION

### 1.1 Location and scope of work

- 1.1.1 In July 2009, Oxford Archaeology (OA) carried out an archaeological watching brief at Hampton Court Palace, Surrey (NGR TQ 1560 6870). The work was commissioned by Julia Grinham, Project Surveyor, and the watching brief was a condition of Scheduled Monument Clearance for installation of new stone access ramps to doorways onto Tennis Court Lane.
- 1.1.2 A single trench was excavated outside of each doorway, within the footprint of the former stone steps, in order to accommodate the new ramps and their associated drainage systems.

### 1.2 Geology

- 1.2.1 The site lies on the first Terrace drift geology of the river Thames, which overlies London Clay at c.9 m OD.

### 1.3 Archaeological and historical background

- 1.3.1 Hampton Court Palace is a Scheduled Ancient Monument (Surrey No. 83). The palace, gardens and grounds form a archaeological and historical site of national importance.
- 1.3.2 Given the limited nature of the project and the results, the well-documented historical and archaeological background to Hampton Court is not reproduced here.

### 1.4 Acknowledgements

- 1.4.1 OA extends its thanks to Julia Grinham, Project Surveyor, Hampton Court Palace and Peter Dillamore of Cathedral Works Organisation for providing help throughout the project.



## 2 WATCHING BRIEF AIMS AND METHODOLOGY

### 2.1 Aims

- 2.1.1 To identify and record the presence or absence, extent, condition, quality and date of archaeological remains in the impacted area.
- 2.1.2 To preserve by record any archaeological remains (if present) that the works may remove or damage within the impacted area.
- 2.1.3 To make available the results of archaeological investigation.

### 2.2 Methodology

- 2.2.1 An assistant supervisor was in attendance to monitor the excavation of the two trenches for the stone ramps. These were excavated by hand.
- 2.2.2 Two rectangular trenches, one outside of each doorway, were excavated (Fig. 2). Trench 3 measured 2.4 x 2.1m, and was excavated to a maximum depth of 0.7m below the current tarmac surface. Trench 4, measured 2.4 x 1.2m, and was excavated to a maximum depth of 0.6m below the tarmac surface.
- 2.2.3 A digital CAD plan showing the extent and location of both trenches was prepared (Fig. 2), based on hand-drawn plans at a scale of 1:100. Plans showing the extent of archaeology in the trenches, and all recorded sections, were drawn at a scale of 1:20. A detailed digital photographic record was made. Recording procedures are as detailed in the *OAU Fieldwork Manual* (ed. Dave Wilkinson, 1992)



### 3 RESULTS

#### 3.1 Description of deposits

- 3.1.1 Below the existing flag stones within both trenches a compacted layer of mixed clay and sand (0.04m thick) was revealed, serving as a bedding layer for the stones. The bedding overlaid a construction cut for a live service pipes in both trenches. The general levelling deposits 102 and 119 consisted of a pinkish-grey sand, containing a large amount of crushed brick rubble and mortar; they were heavily truncated by modern services. The service construction cuts 109, 115 and 120 were backfilled with a coarse orange sand deposit (between 0.26m and 0.35m thick).
- 3.1.2 Drain 103, in Trench 3, was constructed within cut 112, and backfilled by dark-brown tenacious silty-clay (0.28m thick). The drain structure itself, heavily stained and almost completely silted up, was constructed of Victorian yellow London standard brick. Structure 111, which may have been the drain run connecting to drain 103, was also constructed from yellow London standard brick. It was only visible in the west facing section.
- 3.1.3 Drain 118, in the north-west corner of Trench 4, was of similar construction to 112 and was silted up in the same way. No construction cut was visible.
- 3.1.4 In the south-east corner of Trench 4, a red brick structure (101) was revealed at a depth of 0.35m. This was a layer of bricks over an in-filled void. One side of the void was formed by a red brick wall - only a very small segment of this was seen and the bricks could not be investigated further. Stratigraphically this was the earliest feature seen in either trench.
- 3.1.5 In Trench 3, some structural additions to the Privy Kitchen doorway foundations were revealed in section 101 (Fig. 4). Original foundation 106 had been truncated by the addition of services running beneath the threshold, and yellow London standard bricks (114) had been laid to provide support to the threshold.

#### 3.2 Finds summary

- 3.2.1 No dating evidence or artefacts were recovered during the course of the watching brief.
- 3.2.2 No deposits suitable for palaeo-environmental sampling were observed during the course of the watching brief.



## 4 DISCUSSION AND CONCLUSIONS

- 4.1.1 The excavation of the two trenches revealed Victorian drainage features and concrete, sand and rubble levelling deposits. These latter were the result of the construction of new mains added as recently as 2005. Trench 3 revealed some structural reworking of the Privy Kitchen doorway to accommodate these new services.



## APPENDIX A. BIBLIOGRAPHY AND REFERENCES

IFA, 2008 *Standards and Guidelines for Archaeological Watching Briefs*.

OAU, 1992, *Fieldwork Manual*, (Ed. D Wilkinson, first edition, August 1992)



## APPENDIX B. SUMMARY OF SITE DETAILS

<b>Site name:</b>	Hampton Court Palace, Stone Ramps
<b>Site code:</b>	HCP68
<b>Grid reference:</b>	NGR TQ 1560 6870
<b>Type:</b>	Watching Brief
<b>Date and duration:</b>	21 <sup>st</sup> - 22 <sup>nd</sup> July 2009, 2 <sup>nd</sup> November 2009
<b>Area of site:</b>	Two small trenches: 2.4 x 1.2 m; 2.4 x 2.1 m
<b>Summary of results:</b>	A number of service runs were revealed and their associated deposits recorded.
<b>Location of archive:</b>	The archive is currently held at OA, Janus House, Osney Mead, Oxford, OX2 0ES, and will be deposited with Historic Royal Palaces at Hampton Court Palace, Surrey, KT8 9AU in due course.



Scale 1:25,000

Reproduced from the Landranger 1:50,000 scale by permission of the Ordnance Survey on behalf of The Controller of Her Majesty's Stationery Office  
© Crown Copyright 1996. All rights reserved. Licence No. AL 10005569

Figure 1: Site location

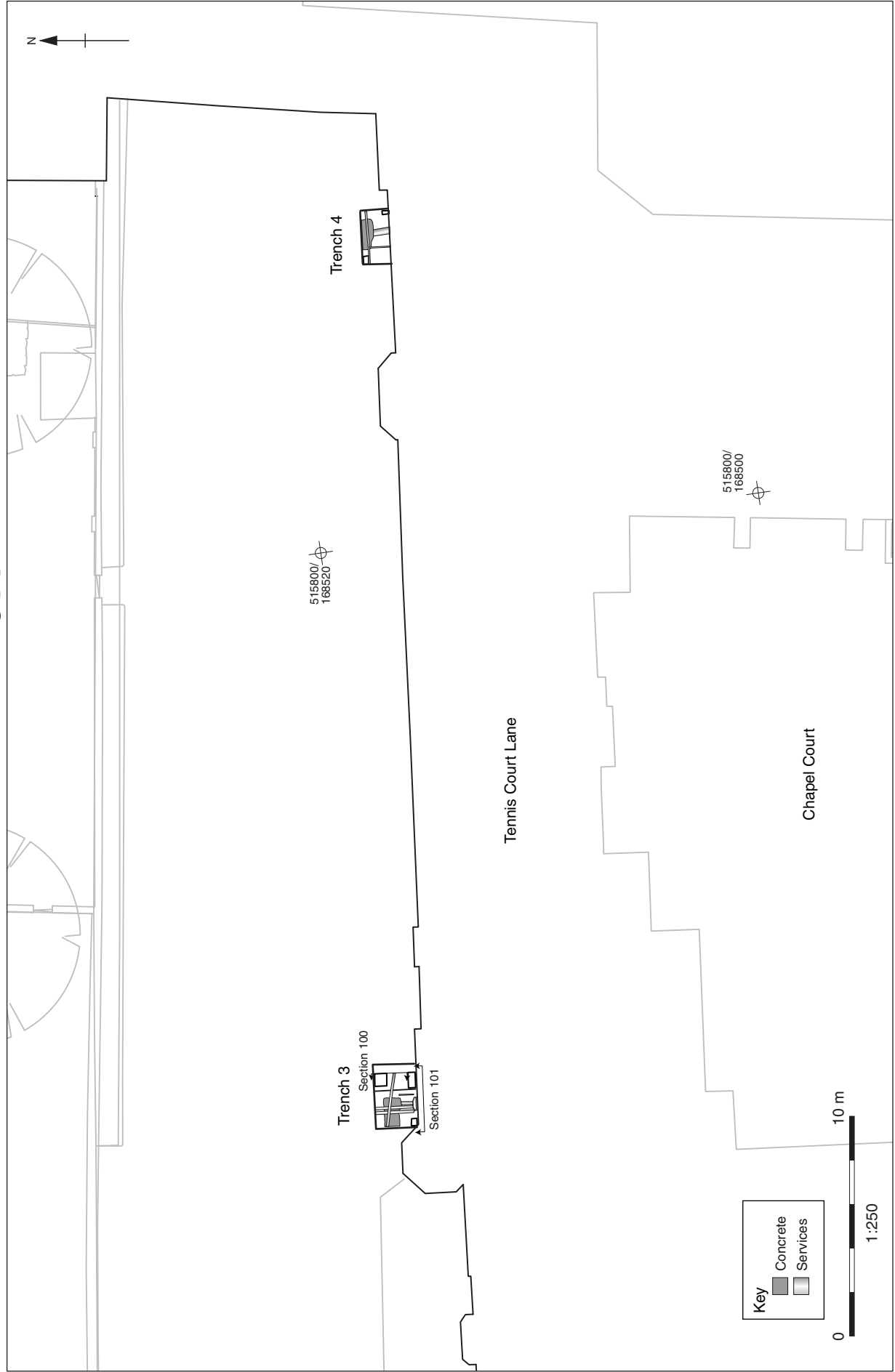

Figure 2: Trench plan

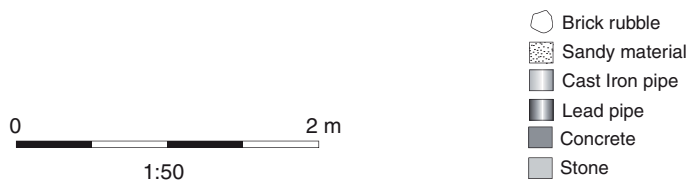
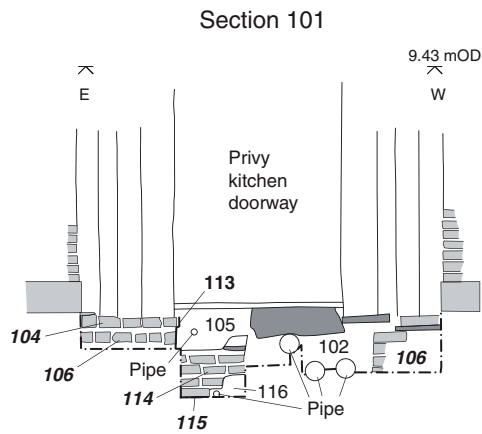
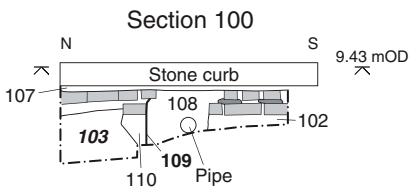
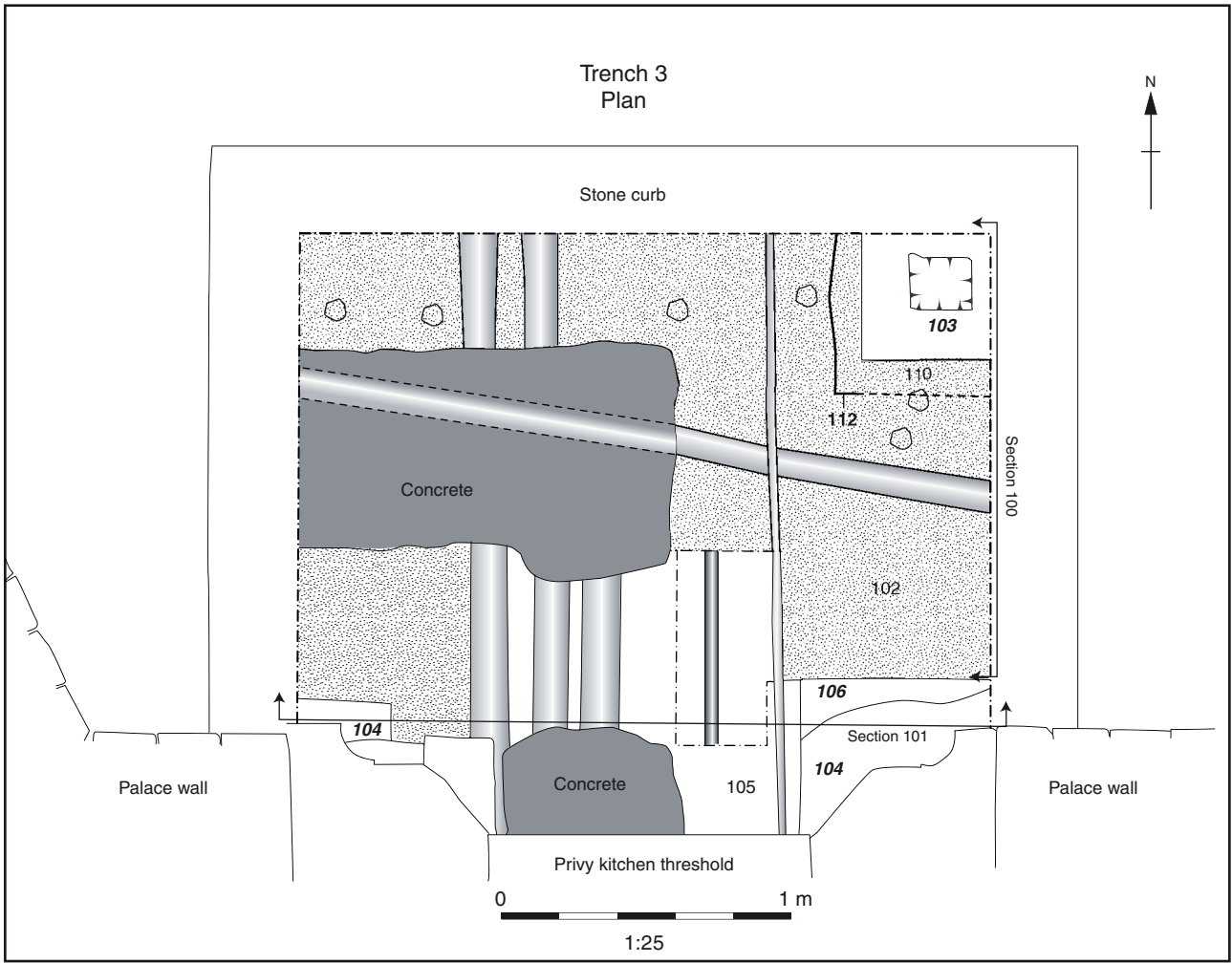

Figure 3: Trench 3 Plan and Sections 100 and 101







### **Head Office/Registered Office/ OA South**

Janus House  
Osney Mead  
Oxford OX2 0ES

t: +44 (0) 1865 263 800  
f: +44 (0) 1865 793 496  
e: [info@oxfordarch.co.uk](mailto:info@oxfordarch.co.uk)  
w: <http://thehumanjourney.net>

### **OA North**

Mill 3  
Moor Lane  
Lancaster LA1 1GF

t: +44 (0) 1524 541 000  
f: +44 (0) 1524 848 606  
e: [oanorth@thehumanjourney.net](mailto: oanorth@thehumanjourney.net)  
w: <http://thehumanjourney.net>

### **OA East**

15 Trafalgar Way  
Bar Hill  
Cambridgeshire  
CB23 8SQ

t: +44 (0) 1223 850500  
f: +44 (0) 1223 850599  
e: [oaeast@thehumanjourney.net](mailto: oaeast@thehumanjourney.net)  
w: <http://thehumanjourney.net>

### **OA Méditerranée**

115 Rue Merlot  
ZAC La Louvade  
34 130 Mauguio  
France

t: +33 (0) 4.67.57.86.92  
f: +33 (0) 4.67.42.65.93  
e: [oamed@thehumanjourney.net](mailto: oamed@thehumanjourney.net)  
w: <http://oamed.fr/>

### **OA Grand Ouest**

7 Rue des Monderaines  
ZI - Ouest  
14650 Carpiquet  
France

t: +33 (0) 249 88 01 01  
f: +33 (0) 249 88 01 02  
e: [info@oago.fr](mailto: info@oago.fr)  
w: <http://oago.fr>



**Director:** David Jennings, BA MIFA FSA

*Oxford Archaeology Ltd is a  
Private Limited Company, N<sup>o</sup>: 1618597  
and a Registered Charity, N<sup>o</sup>: 285627*