

Wallingford RFC Wallingford



Archaeological Watching Brief Report

oxfordarchaeology



May 2009

Client: RLF Birmingham

Issue No: 1

OA Job No: 10160

NGR: SU 5933 8938



Client Name: RLF Birmingham
Client Ref No: 10160
Document Title: OAS Watching Brief Report
Document Type: Watching Brief Report
Issue/Version Number: 1
Grid Reference: NGR SU 5933 8938
Planning Reference: P08/W0711
OA Job Number: 4270
Site Code: WAFLOD08
Invoice Code: WAFLODWB
Receiving Museum: Oxford County Museum Service
Museum Accession No: OXCMS 2008.141
Event No:

Issue	Prepared by	Checked by	Approved by	Signature
1	Laura Piper Fieldwork Supervisor	Alan Hardy Senior Project Manager	Dan Poore Head of Fieldwork	

Document File Location
Graphics File Location
Illustrated by

Disclaimer:

This document has been prepared for the titled project or named part thereof and should not be relied upon or used for any other project without an independent check being carried out as to its suitability and prior written authority of Oxford Archaeology being obtained. Oxford Archaeology accepts no responsibility or liability for the consequences of this document being used for a purpose other than the purposes for which it was commissioned. Any person/party using or relying on the document for such other purposes agrees, and will by such use or reliance be taken to confirm their agreement to indemnify Oxford Archaeology for all loss or damage resulting therefrom. Oxford Archaeology accepts no responsibility or liability for this document to any party other than the person/party by whom it was commissioned.

© Oxford Archaeological Unit Ltd 2009

Janus House
Osney Mead
Oxford OX2 0ES

t: +44 (0) 1865 263800

e: oasouth@thehumanjourney.net

f: +44 (0) 1865 793496

w: oasouth.thehumanjourney.net

Oxford Archaeological Unit Limited is a Registered Charity No: 285627



New Flood Lighting, Wallingford RFC, Hithercroft Rd, Wallingford, Oxfordshire

Archaeological Watching Brief Report

Written by Laura Piper and Daniel Dodds

and illustrated by Amy Hemingway

Table of Contents

Summary.....	3
1 Introduction.....	4
1.1 Location and scope of work.....	4
1.2 Geology and topography.....	4
1.3 Archaeological and historical background.....	4
2 Project Aims and Methodology.....	5
2.1 Aims.....	5
2.2 Methodology.....	5
3 Results.....	6
3.1 Description of deposits.....	6
3.2 Finds.....	6
4 Discussion and Conclusions.....	7
Appendix A. Context Inventory.....	8
Appendix B. Bibliography and References.....	9
Appendix C. Summary of Site Details.....	10



List of Figures

- Fig. 1 Site location map
- Fig. 2 Site Plan
- Fig. 3 Section 1



Summary

On the 24th and 25th November 2008 Oxford Archaeology (OA) carried out an archaeological watching brief at Wallingford RFC, Wallingford, Oxfordshire (NGR: SU 5933 8938). The work was commissioned by RLF Birmingham acting on behalf of Wallingford RFC in advance of the construction of six floodlights. No archaeology was identified.



1 INTRODUCTION

1.1 Location and scope of work

- 1.1.1 On the 24th and 25th November 2008 Oxford Archaeology (OA) carried out an archaeological watching brief at Wallingford RFC, Hithercroft Road, Wallingford, Oxfordshire (Fig. 1). The work was commissioned by Andrew Rasin of RLF Birmingham in respect of a planning application for the construction of six new floodlights (Planning Reference: P08/W0711).
- 1.1.2 A project brief was set by Richard Oram of Oxfordshire County Archaeological Services. This laid down the minimum requirements of the watching brief.
- 1.1.3 OA prepared a Written Scheme of Investigation detailing how it would meet the requirements of the brief.

1.2 Geology and topography

- 1.2.1 The site is located on the western side of Wallingford, north-west of the Hithercroft Industrial Estate at NGR: SU 5933 8938. The site is currently in use as a sports pitch and lies at approximately 45 m above OD.
- 1.2.2 The underlying geology is 1st (Flood Plain) Gravel Terrace Deposits.

1.3 Archaeological and historical background

- 1.3.1 The archaeological background to the watching brief was prepared for the WSI for the project (OA, 2008) and is reproduced below.
- 1.3.2 The site is located in an area of archaeological potential immediately adjacent to a prehistoric or Roman settlement (PRN 15383) (SU 5900 8950). These features consist of a large trackway oriented NW-SE and a series of small field systems and enclosures. These features are visible on aerial photographs and show the features running under the A4130, and it is likely that these continue into the application area.



2 PROJECT AIMS AND METHODOLOGY

2.1 Aims

- 2.1.1 To preserve by record any archaeological remains (if present) that the contractor's works may remove or damage within the area of site being investigated.
- 2.1.2 To signal, before the destruction of the material in question, the discovery of a significant archaeological find, for which the resources allocated are not sufficient to support a treatment to a satisfactory and proper standard. All groundworks will be halted until the remains have been suitably investigated and dealt with by the attending archaeologist.
- 2.1.3 To make available the results of the investigation.

2.2 Methodology

- 2.2.1 Six floodlight foundation pits measuring 1.2 m x 1.2 m x 1.2 m (Fig. 2) were excavated under archaeological supervision using a 360° mechanical excavator.
- 2.2.2 A continuous watching brief was maintained during the period of excavation, and details of all the stratigraphy encountered within the pits was recorded and sample sections drawn at a scale of 1:20.

3 RESULTS

3.1 Description of deposits

3.1.1 A series of four deposits were identified in each foundation pit (Fig. 3). The earliest deposit, which was identified between 0.9 and 1.2 m below current ground level comprised an orange sandy gravel (4). This was overlain by a 0.2 m thick grey sandy gravel (3), which was in turn overlain by an orangey brown, silty clay subsoil (2) and a silty loam topsoil (1).

3.2 Finds

3.2.1 No finds were recovered during the course of the watching brief.



4 DISCUSSION AND CONCLUSIONS

- 4.1.1 The watching brief revealed no evidence for archaeological deposits, the sandy gravels identified are consistent within the underlying geology of flood plain gravel terraces.
- 4.1.2 Although field systems and enclosures have been identified through aerial photography, none were observed during the course of the watching brief. However given the limited size of the foundation pits it is still possible that these features exist between pits.



APPENDIX A. CONTEXT INVENTORY

Context Inventory						
context no	type	Width (m)	Depth (m)	comment	finds	date
1	Layer	-	0.30	Topsoil	-	-
2	Layer	-	0.40	Subsoil	-	-
3	Layer	-	0.20	Gravel Layer	-	-
4	Layer	-	0.30	Gravel Layer	-	-



APPENDIX B. BIBLIOGRAPHY AND REFERENCES

English Heritage, 1991, Management of Archaeological Projects.

Hey, G. and Lacey, M. 2001, Evaluation of Archaeological Decision-making Processes and Sampling Strategies.

Oxford Archaeology, 1992, Fieldwork Manual, (Ed. D Wilkinson, first edition, August 1992)

Oxford Archaeology, 2000, OA Environmental Sampling Guidelines and Instruction, Manual.

Oxford Archaeology, 2008, WSI for an Archaeological Watching Brief, Wallingford RFC, Wallingford, Oxfordshire



APPENDIX C. SUMMARY OF SITE DETAILS

Site name: OAS Watching Brief Report

Site code: WAFLOD08

Grid reference: NGR: SU 5933 8938

Type: Watching Brief

Date and duration: 24th and 25th November 2008

Area of site:

Summary of results: Six foundation pits measuring 1.2 m x 1.2 m x 1.2 m were excavated. No archaeology was identified.

Location of archive: The archive is currently held at OA, Janus House, Osney Mead, Oxford, OX2 0ES, and will be deposited with the Oxfordshire County Museum in due course, under the following accession number: OXCMS 2008.141

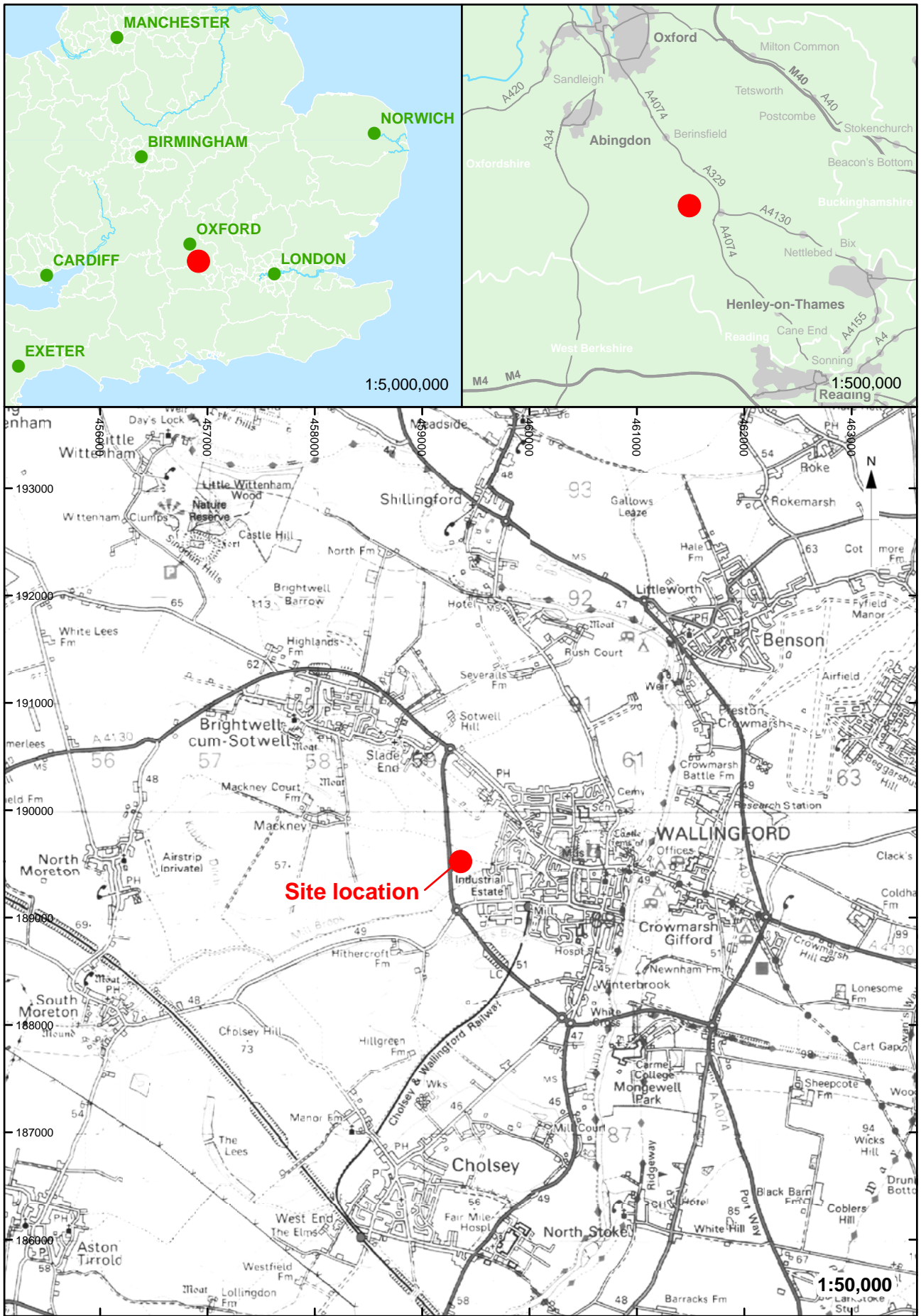

Reproduced by permission of the Ordnance Survey on behalf of The Controller of Her Majesty's Stationary Office (c) Crown Copyright. 1996 All rights reserved. License No. AL 100005569

Figure 1: Site location

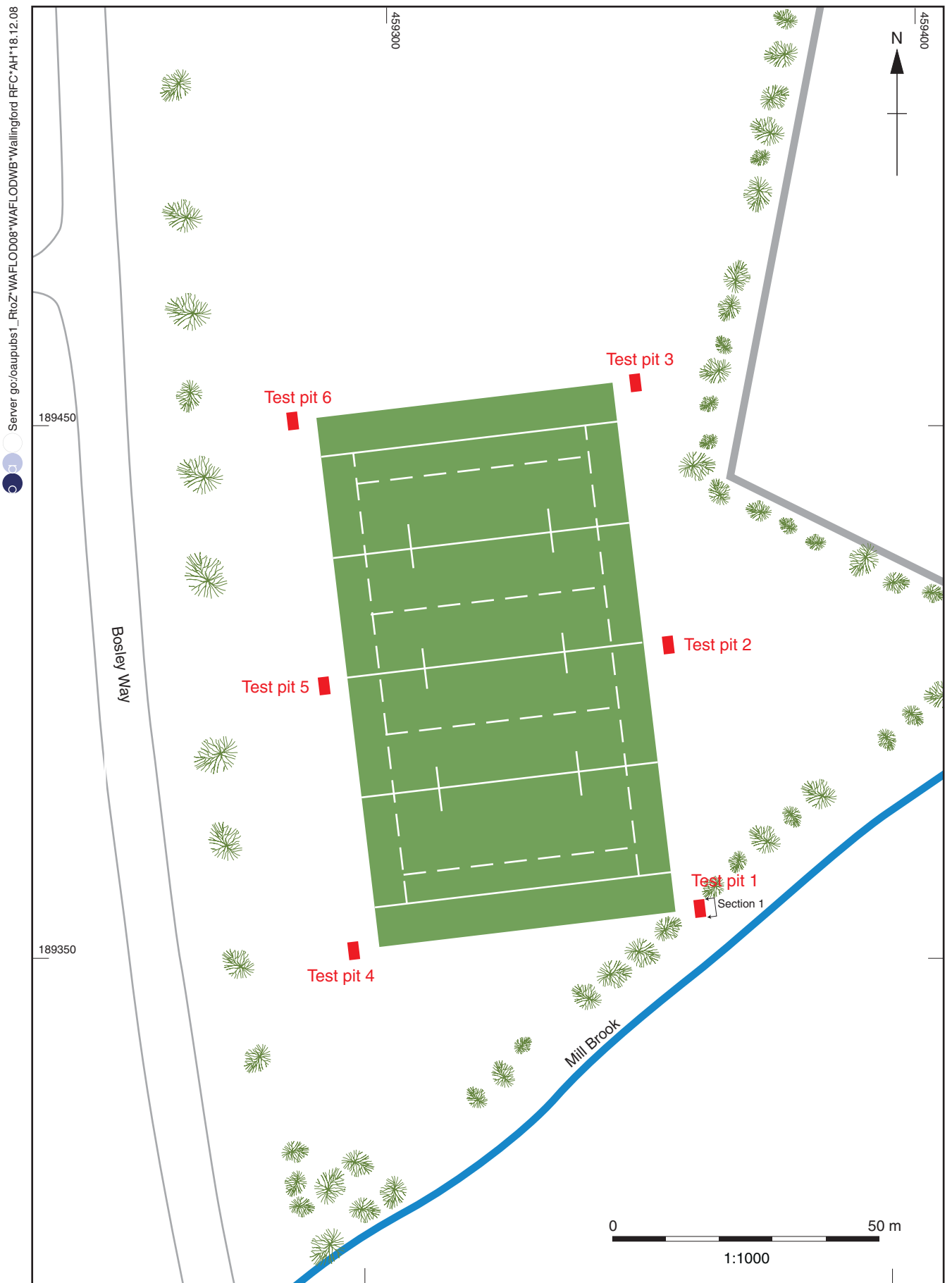

Figure 2 : Site plan

Sample Section

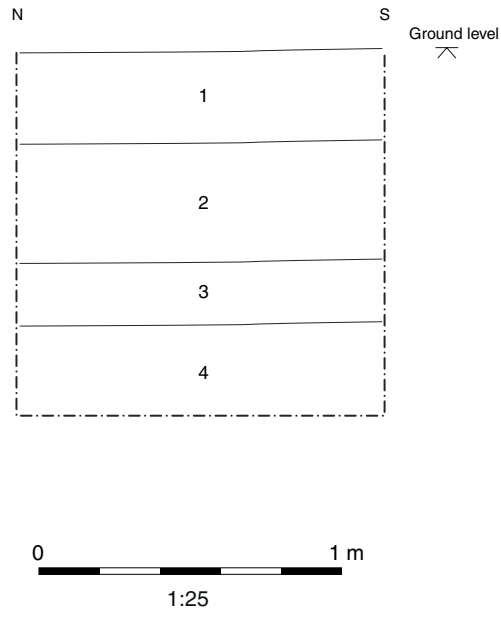

Figure 3 : Section 1 (sample section)



OA South

Janus House
Osney Mead
Oxford OX2 0ES

t: +44 (0) 1865 263 800
f: +44 (0) 1865 793 496
e: info@oxfordarch.co.uk
w: <http://thehumanjourney.net>

OA North

Mill 3
Moor Lane Mills
Moor Lane
Lancaster LA1 1GF

t: +44 (0) 1524 541 000
f: +44 (0) 1524 848 606
e: [oanorth@thehumanjourney.net](mailto: oanorth@thehumanjourney.net)
w: <http://thehumanjourney.net>

OA East

15 Trafalgar Way
Bar Hill
Cambridgeshire
CB23 8SQ

t: +44 (0) 1223 850500
f: +44 (0) 1223 850599
e: [oaeast@thehumanjourney.net](mailto: oaeast@thehumanjourney.net)
w: <http://thehumanjourney.net>

OA Méditerranée

115 Rue Merlot
ZAC La Louvade
34 130 Maugeio
France

t: +33 (0) 4.67.57.86.92
f: +33 (0) 4.67.42.65.93
e: [oamed@thehumanjourney.net](mailto: oamed@thehumanjourney.net)
w: <http://oamed.fr/>

Director: David Jennings, BA MIFA FSA



*The Oxford Archaeological Unit Ltd is a Private Limited Company, N^o: 1618597 and a Registered Charity, No: 285627
Registered Office: Janus House,
Osney Mead, Oxford, OX2 0ES*