

Redundant Garage Site Station Road Goring-on-Thames Oxfordshire



Archaeological Watching Brief Report



January 2006

Client: Mc Adden Properties

Issue N^o: 1

OA Job N^o: 2874

Planning Ref N^o: PO5/W0243/CA and
PO5/W0254

NGR: SU 5991 8064

Client Name: McAdden Properties

Client Ref No:

Document Title: Redundant Garage Site, Station Road, Goring-on-Thames,
Oxfordshire

Document Type: Watching Brief

Issue Number: 1

National Grid Reference: SU 5991 8064
Planning Reference: PO5/W0243/CA and PO5/W0254

OA Job Number: 2874
Site Code: GOSTR 05
Invoice Code: GOSTRWB
Receiving Museum: Oxfordshire County Museums Service
Museum Accession No: OXCMS:2005.103

Prepared by: Mike Sims
Position: SWD Project Supervisor
Date: 10th January 2006

Checked by: Dan Dodds
Position: Head of Small Works
Date: 13th January 2006

Approved by: Nick Shepherd
Position: Head of Fieldwork
Date: 16th January 2006

Signed.....

Document File Location H:\PROJECTS\Oxfordshire OX\South Oxfordshire
SO\6266 Station Road Goring WB\wbREP.doc

Graphics File Location Servergo:/oaupubs 1_A bthru
H*GOSTR05*GOSTRWB*Station Roiad, Goring-on-
Thames*eam*10.01.06

Illustrated by Elin Sundman

Disclaimer:

This document has been prepared for the titled project or named part thereof and should not be relied upon or used for any other project without an independent check being carried out as to its suitability and prior written authority of Oxford Archaeology being obtained. Oxford Archaeology accepts no responsibility or liability for the consequences of this document being used for a purpose other than the purposes for which it was commissioned. Any person/party using or relying on the document for such other purposes agrees, and will by such use or reliance be taken to confirm their agreement to indemnify Oxford Archaeology for all loss or damage resulting therefrom. Oxford Archaeology accepts no responsibility or liability for this document to any party other than the person/party by whom it was commissioned.

Oxford Archaeology

© Oxford Archaeological Unit Ltd 2006

Janus House
Osney Mead
Oxford OX2 0ES

t: (0044) 01865 263800
f: (0044) 01865 793496

e: info@oxfordarch.co.uk
w: www.oxfordarch.co.uk

Oxford Archaeological Unit Limited is a Registered Charity No: 285627

Redundant Garage Site, Station Road, Goring on Thames, Oxfordshire

ARCHAEOLOGICAL WATCHING BRIEF REPORT

CONTENTS

Summary.....	1
1 Introduction.....	1
1.1 Scope of work.....	1
1.2 Location, geology and topography.....	1
1.3 Archaeological and historical background.....	1
2 Project Aims and Methodology.....	2
2.1 Aims.....	2
2.2 Methodology.....	2
3 Results.....	2
3.1 Description of deposits.....	2
3.2 Finds.....	3
3.3 Palaeo-environmental remains.....	3
4 Discussion and Conclusions.....	3
Appendix 1 Archaeological Context Inventory.....	4
Appendix 2 Bibliography and References	4
Appendix 3 Summary of Site Details.....	4

LIST OF FIGURES

- Fig. 1 Site location
Fig. 2 Site plan
Fig. 3 Sections 1-3

SUMMARY

Between 13th and 16th October 2005 Oxford Archaeology (OA) carried out an archaeological watching brief at the redundant garage site, Station Road, Goring on Thame, Oxfordshire (NGR: SU 5991 8064). The work was commissioned by McAdden Properties in advance of demolition of the existing buildings and construction of nine new residential apartments. The watching brief revealed that the area had been severely truncated and disturbed, probably during the construction of the now demolished garage, with no earlier significant stratigraphy or archaeology surviving.

1 INTRODUCTION

1.1 Scope of work

- 1.1.1 Between 13th and 16th October 2005 Oxford Archaeology (OA) carried out an archaeological watching brief at the redundant garage site, Station Road, Goring on Thames, Oxfordshire (NGR: SU 5991 8064). The work was commissioned by McAdden Properties in respect of a planning application for the demolition of existing buildings, clearance and removal of underground tanks and construction of nine new residential apartments and associated parking. (Planning Application No. PO5/W0243/CA)
- 1.1.2 A project brief was set by Paul Smith, the Oxfordshire County Archaeological Officer outlining the requirements of an archaeological monitoring and recording action (watching brief) to be conducted as part of the planning consent (OCAS, 2005).
- 1.1.3 OA prepared a Written Scheme of Investigation detailing how it would meet the requirements of the brief (OA, 2005).

1.2 Location, geology and topography

- 1.1.4 The site comprised a redundant garage with associated buildings, areas of concrete hard standing underground fuel tanks and petroleum pipelines. It is located on the north side of Station Road, Goring-on-Thames, east of the junction with Manor Road and Ferry Lane. The site is bounded to the south by Station Road and to the east, west and north by residential and commercial properties.
- 1.1.5 The site has been terraced into a gentle south facing slope, the base of which lies at approximately 45 m OD and occupies an area of 0.1 hectares. The underlying geology is Thames River Gravels.

1.3 Archaeological and historical background

- 1.1.6 The archaeological background to the watching brief was prepared for the WSI for the

project (OA, 2005) and is reproduced below.

- 1.1.7 The development site lies within the historic core of Goring-on-Thames, which is designated as a Conservation Area. Several Listed Buildings are located at this western end of Station Road, including Vine Cottage and The Catherine Wheel public house, both of which date to the 17th century. In addition, a find of 3rd and 4th century Roman coins was recorded in 1962 from 67 Station Road.
- 1.1.8 Ferry Lane, which forms the western continuation of Station Road, leads to a probable Roman crossing point on the Thames, where Roman pottery has been recovered from the river. There is therefore potential for evidence as early as the Roman period existing within the development area, but the greatest level of evidence is likely to be associated with the later medieval and post medieval evolution of the historic core of Goring.

2 PROJECT AIMS AND METHODOLOGY

2.1 Aims

- 1.1.9 To identify and record the presence or absence, extent, condition, quality and date of archaeological remains in the areas affected by the development.
- 1.1.10 To preserve by record any archaeological deposits or features that may be disturbed or destroyed during the development.
- 1.1.11 To make available the results of the archaeological investigation.

2.2 Methodology

- 1.1.12 The watching brief was conducted as a series of site visits during works likely to disturb archaeological deposits. These included the machine clearance of the site and machine digging of foundation and service trenches.
- 1.1.13 A plan was maintained of these works at a scale of 1:100 (Fig. 2) and any recorded sections drawn at a scale of 1:20. All excavations and sections were photographed using colour slide and black and white print film. A general photographic record of the work was also made. Recording followed procedures detailed in the *OA Field Manual* (ed. D Wilkinson, 1992).

3 RESULTS

3.1 Description of deposits

- 1.1.14 A large part of the site had been heavily disturbed during the installation (and removal) of the underground fuel tanks and pipework, principally the eastern and south-eastern area of the site. The western and south-western edge of the site was least disturbed and recording concentrated in that area.
- 1.1.15 The stratigraphy exposed was similar throughout the recorded area, and the following

description will apply for all the sections.

- 1.1.16 The underlying natural, a coarse gravel and grey clay silt mix (5) was exposed within the centre of the site, appearing at between 1.0 m and 1.3 m below ground level (Fig. 3, sections 1 and 3). This was overlaid by a layer of grey-brown silt clay (4) measuring between 0.3 m and 0.4 m in depth (Fig. 3, sections 1, 2 and 3). This layer contained occasional gravels and some chalk flecking and represents an alluvial deposit.
- 1.1.17 Overlying this layer was a 0.3 m thick layer of orange-brown clay silt (3). This produced occasional chalk flecking and also represents an alluvial deposit. This was sealed by a layer of dark brown clay loam (2). This measured 0.2 m deep along the lower, southern edge of the site, rising to 0.7 m deep along the higher, northern edge. This deposit contained much charcoal flecking and fragments of 19th century clay pipe stem and transfer printed creamware suggesting it was an occupation layer, or garden topsoil, probably associated with the use of the site before it became a garage.
- 1.1.18 A 0.1 m to 0.2 m thick layer of demolition debris (1), composed of crushed concrete, brick and tile had been deposited over the topsoil during the demolition of the standing structures.

3.2 Finds

- 1.1.19 All the finds recovered were dated between the 19th and 20th centuries and consisted of fragments of transfer printed creamware and glazed earthenware, bottle glass, clay pipe stem and brick. These were all collected from Layer 2 and were evaluated on site, but were not retained.

3.3 Palaeo-environmental remains

- 1.1.20 No deposits suitable for palaeo-environmental sampling were encountered during the course of the watching brief.

4 DISCUSSION AND CONCLUSIONS

- 1.1.21 The watching brief showed that the area had been subject to large scale truncation and disturbance, probably occurring during the development of the site as a garage over the preceding years. The layer of topsoil, 2, is indicative of the use of the site as a kitchen garden during the 19th and 20th centuries and is possibly related to the nearby houses, but more likely to a dwelling which originally fronted Station Road. The installation of the underground fuel tanks and pipework would have removed any evidence for this structure.
- 1.1.22 The topsoil was encountered directly above the alluvial deposits with no evidence for earlier occupation layers or activity (including residual finds) observed.

APPENDICES

APPENDIX 1 ARCHAEOLOGICAL CONTEXT INVENTORY

<i>Context</i>	<i>Type</i>	<i>Depth</i>	<i>Comments</i>	<i>Finds</i>	<i>Date</i>
1	Layer	0.2 m - 0.3 m	Demolition debris	Brick and tile	C21st
2	Layer	0.2 m - 0.7 m	Topsoil, occupation layer	Pottery, glass, clay pipe stem	C19th/ C20th
3	Layer	0.3 m	Alluvial deposit	-	-
4	Layer	0.2 m - 0.4 m	Alluvial deposit	-	-
5	Layer	> 0.15 m	River terrace gravels	-	-

APPENDIX 2 BIBLIOGRAPHY AND REFERENCES

IFA 2001 *Standard and Guidance for Archaeological Evaluations*

OA 1992 *Fieldwork Manual* (ed. D Wilkinson, first edition, August 1992)

OA 2005 *Redundant Garage Site, Station Road, Goring-on-Thames, Oxfordshire : Written Scheme of Investigation for an Archaeological Watching Brief*

OCAS 2005 PO5/W0243/CA & PO5/W0254 - *Redundant Garage Site, Station Road, Goring-on-Thames, Oxfordshire : Design Brief for an Archaeological Watching Brief*

APPENDIX 3 SUMMARY OF SITE DETAILS

Site name: Station Road, Goring-on-Thames, Oxfordshire

Site code: GOSTR 05

Grid reference: SU 5991 8064

Type of watching brief: Machine excavation of service and foundation trenches and ground reduction.

Date and duration of project: 13th to 16th October 2005, 4 days

Area of site: 0.1 hectare

Summary of results: Severe post-medieval truncation and disturbance throughout the site with no earlier archaeology encountered.

Location of archive: The archive is currently held at OA, Janus House, Osney Mead, Oxford, OX2 0ES, and will be deposited with Oxfordshire County Museums Service in due course, under the following accession number: OXCMS:2005.103

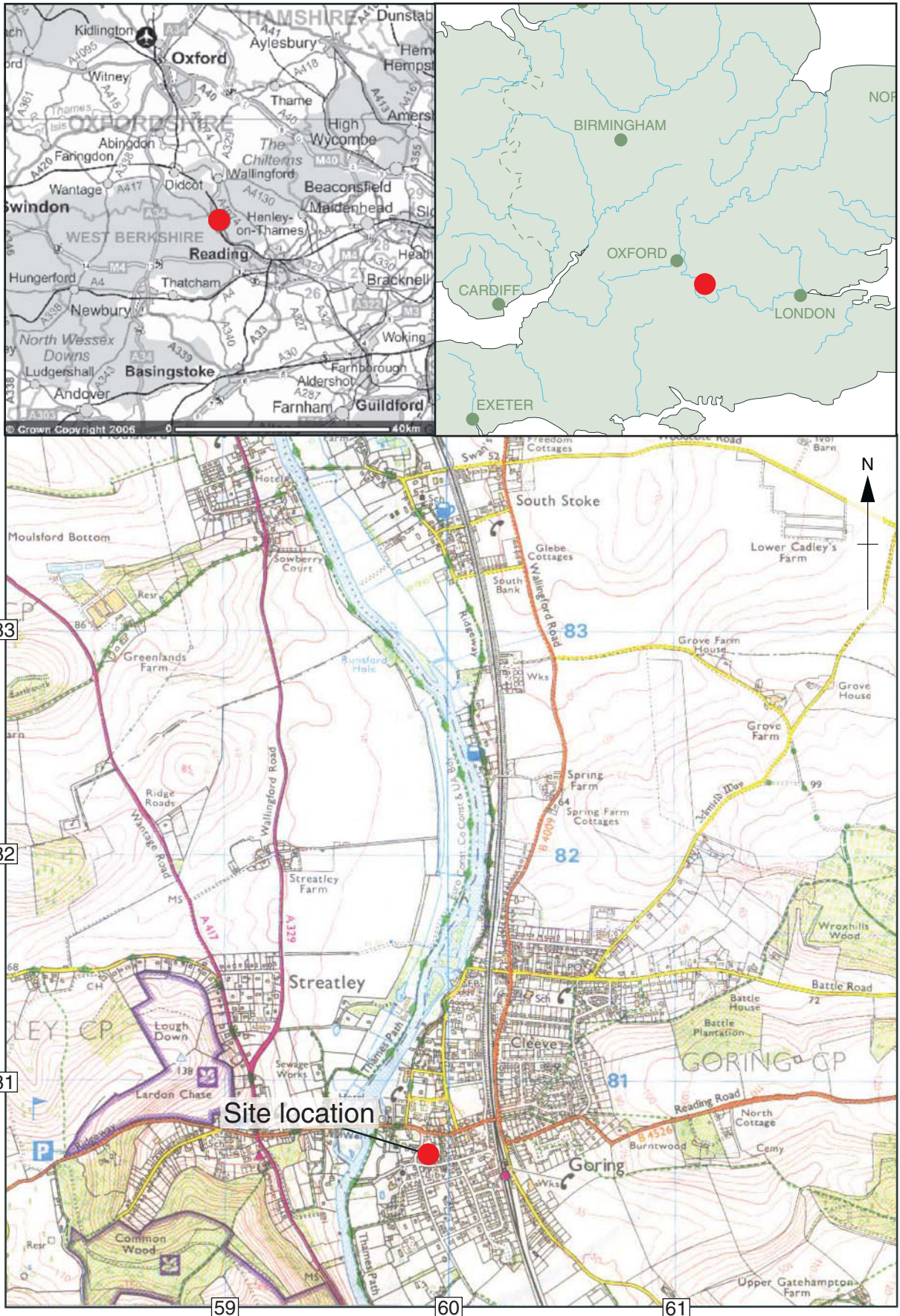

Scale 1:25,000

Reproduced from the Explorer 1:25,000 scale by permission of the Ordnance Survey on behalf of The Controller of Her Majesty's Stationery Office © Crown Copyright 1999. All rights reserved. Licence No. AL 10005569

Figure 1: Site location

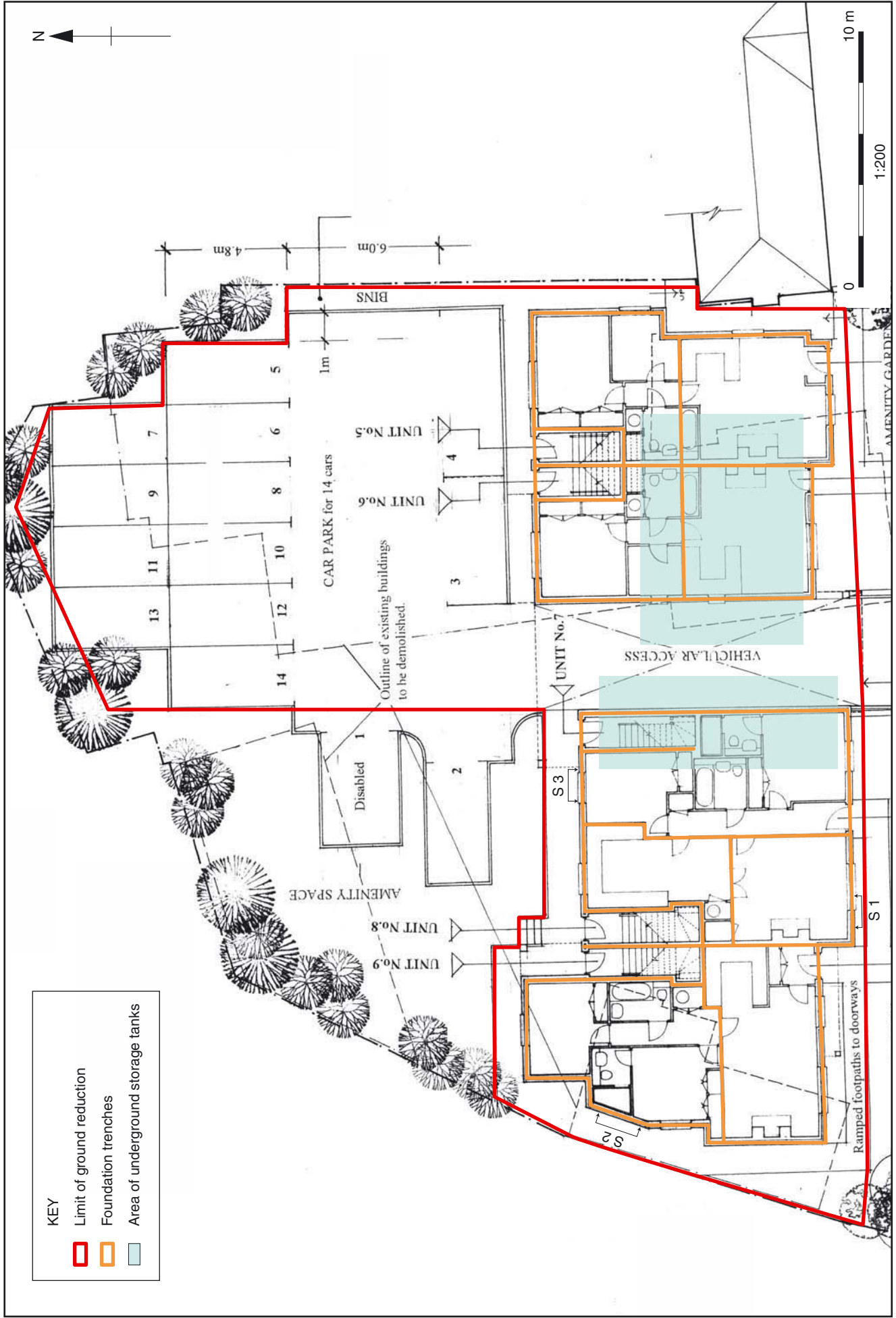
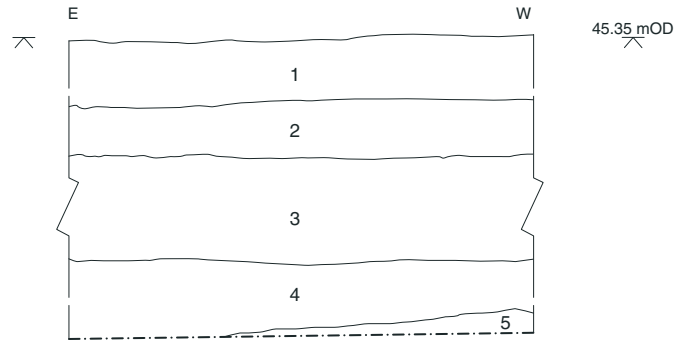

Figure 2: Site plan



Section 1



Section 2

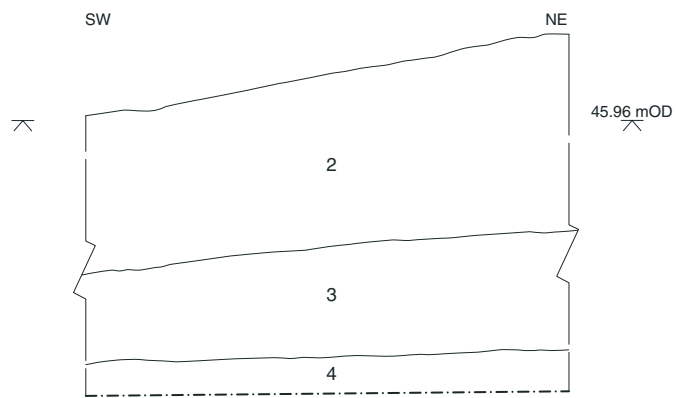

Section 3

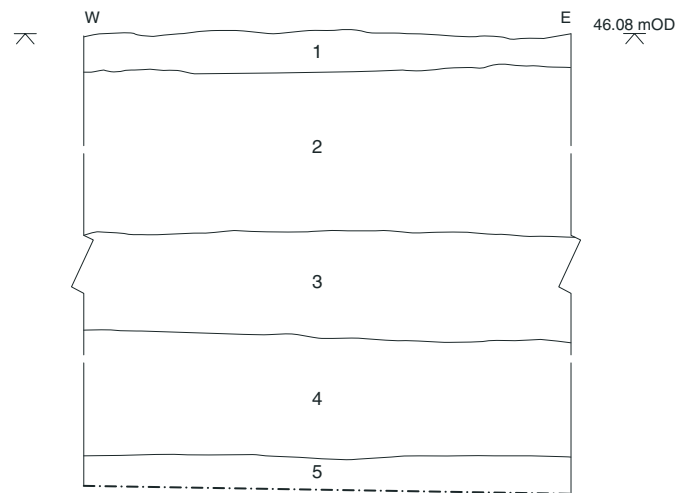

Figure 3: Sections 1-3



Head Office/Registered Office

Janus House
Osney Mead
Oxford OX2 0ES

t: +44 (0) 1865 263 800
f: +44 (0) 1865 793 496
e: info@thehumanjourney.net
w: <http://thehumanjourney.net>

OA North

Mill 3
Moor Lane
Lancaster LA1 1GF

t: +44 (0) 1524 541 000
f: +44 (0) 1524 848 606
e: [oanorth@thehumanjourney.net](mailto: oanorth@thehumanjourney.net)
w: <http://thehumanjourney.net>

OA East

15 Trafalgar Way
Bar Hill
Cambridgeshire
CB23 8SQ

t: +44 (0) 1223 850500
f: +44 (0) 1223 850599
e: [oaeast@thehumanjourney.net](mailto: oaeast@thehumanjourney.net)
w: <http://thehumanjourney.net/oaeast>

OA Méditerranée

115 Rue Merlot
ZAC La Louvade
34 130 Manguio
France

t: +33 (0) 4.67.57.86.92
f: +33 (0) 4.67.42.65.93
e: [oamed@oamed.fr](mailto: oamed@oamed.fr)
w: <http://oamed.fr/>



Director: David Jennings, BA MIFA FSA

*Oxford Archaeological Unit is a
Private Limited Company, N^o: 1618597
and a Registered Charity, N^o: 285627*