

BARN AT CINDER HILL
DENHOLME GATE ROAD
HIPPERHOLME, WEST YORKSHIRE
(NGR: SE 1230926850)
HISTORIC BUILDING RECORD

FIGURE 3:
SITE PLAN

SCALE: 1:500

DATE OF SURVEY: JUNE 2011

STEPHEN HAIGH
Buildings Archaeologist



Figure 4: Tracing from map of 1836

Plan of the township of Hipperholme cum Brighouse in the parish of Halifax... 1836
West Yorkshire Archive Service Calderdale BRI 63



Figure 5: Tracing from map of 1849

Plan of the township of Hipperholme cum Brighouse in the parish of Halifax... 1849
West Yorkshire Archive Service Calderdale MISC 666

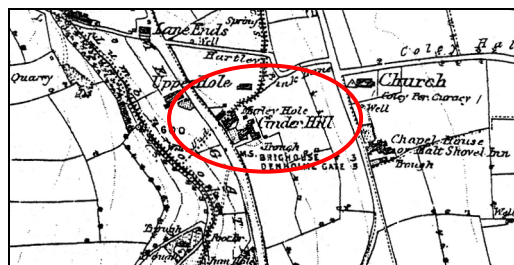

Figure 6: Ordnance Survey 1:10,560 map, published 1854 (surveyed 1849-50)
Sheet no: Yorkshire 231; lower extract enlarged to approx 1:2500



Figure 7: Ordnance Survey 1:2500 map, published 1893 (surveyed 1891-2)
Sheet no: Yorkshire 231.2

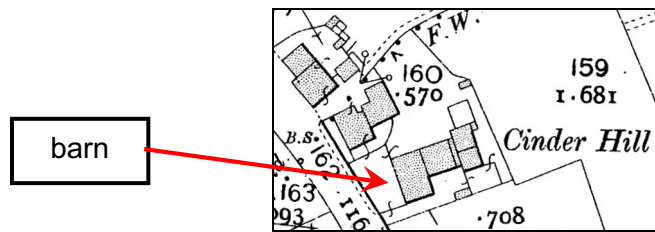

Figure 8: Ordnance Survey 1:2500 map, published 1908 (revised 1905)
Sheet no: Yorkshire 231.2

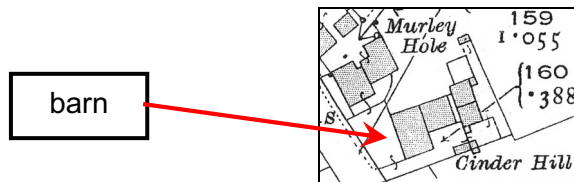
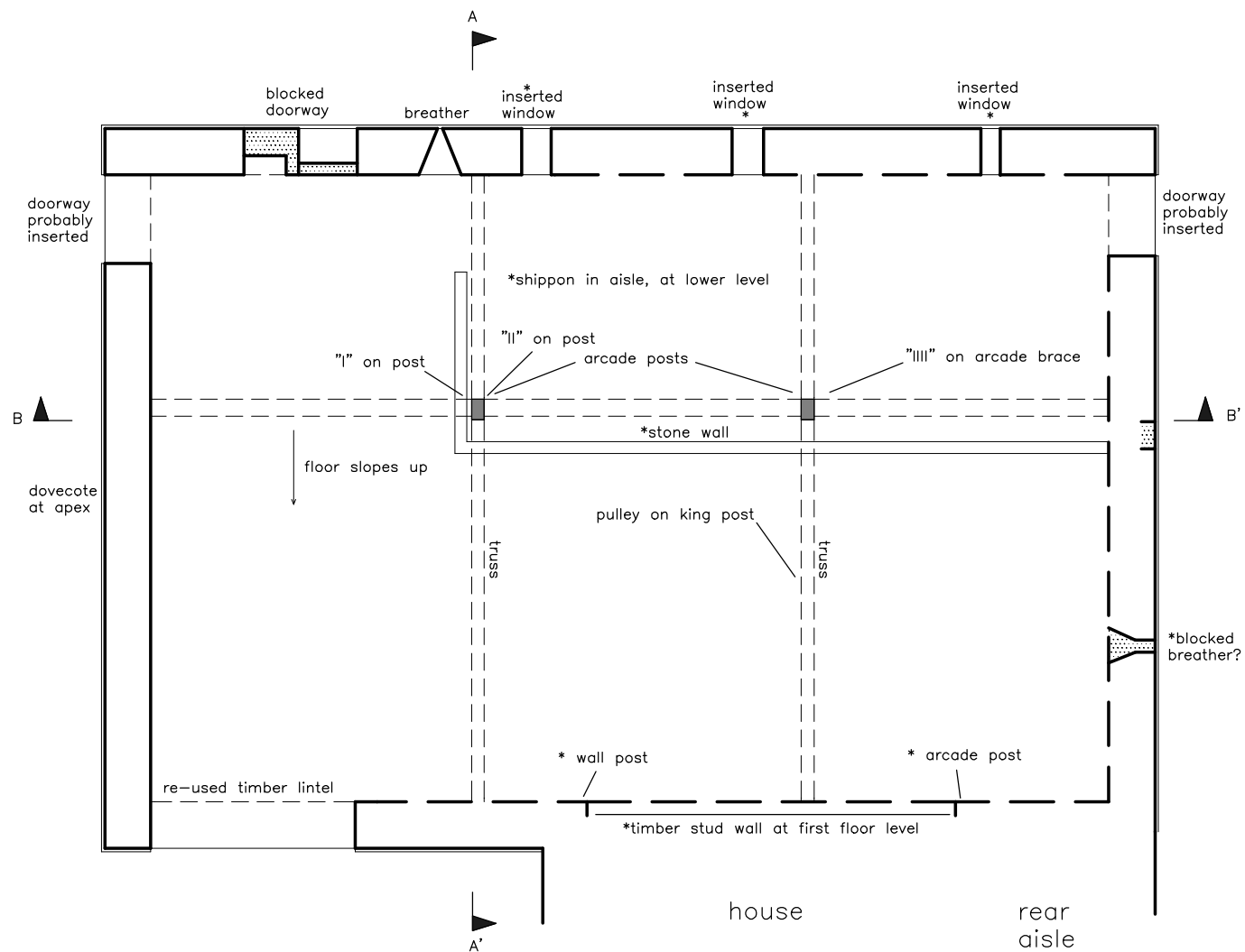

Figure 9: Ordnance Survey 1:2500 map, published 1922 (revised 1914-15)
Sheet no: Yorkshire 231.2



Figure 10: Ordnance Survey 1:2500 map, published 1933 (revised 1930)
Sheet no: Yorkshire 231.2



* feature interpolated from earlier records
(no longer extant/visible)

— wall face now hidden

blocking or infill

10m

BARN AT CINDER HILL
DENHOLME GATE ROAD
HIPPERHOLME, WEST YORKSHIRE
(NGR: SE 1230926850)
HISTORIC BUILDING RECORD

FIGURE 11:
GROUND FLOOR PLAN

SCALE: 1:100

DATE OF SURVEY: JUNE 2011

STEPHEN HAIGH
Buildings Archaeologist

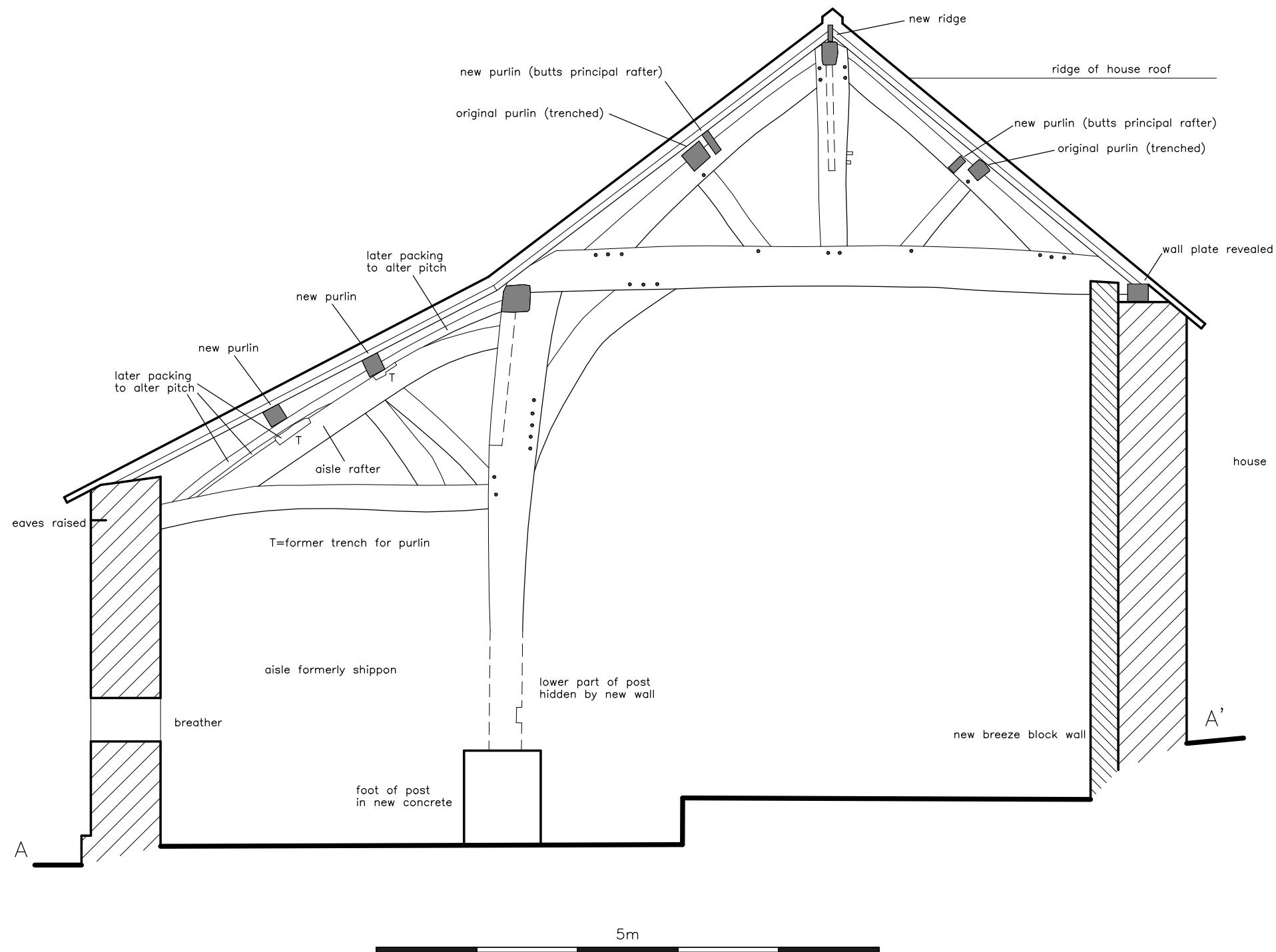

BARN AT CINDER HILL
DENHOLME GATE ROAD
HIPPERHOLME, WEST YORKSHIRE
(NGR: SE 1230926850)
HISTORIC BUILDING RECORD

FIGURE 12:
CROSS-SECTION

SCALE: 1:50

DATE OF SURVEY: JUNE 2011

STEPHEN HAIGH
Buildings Archaeologist

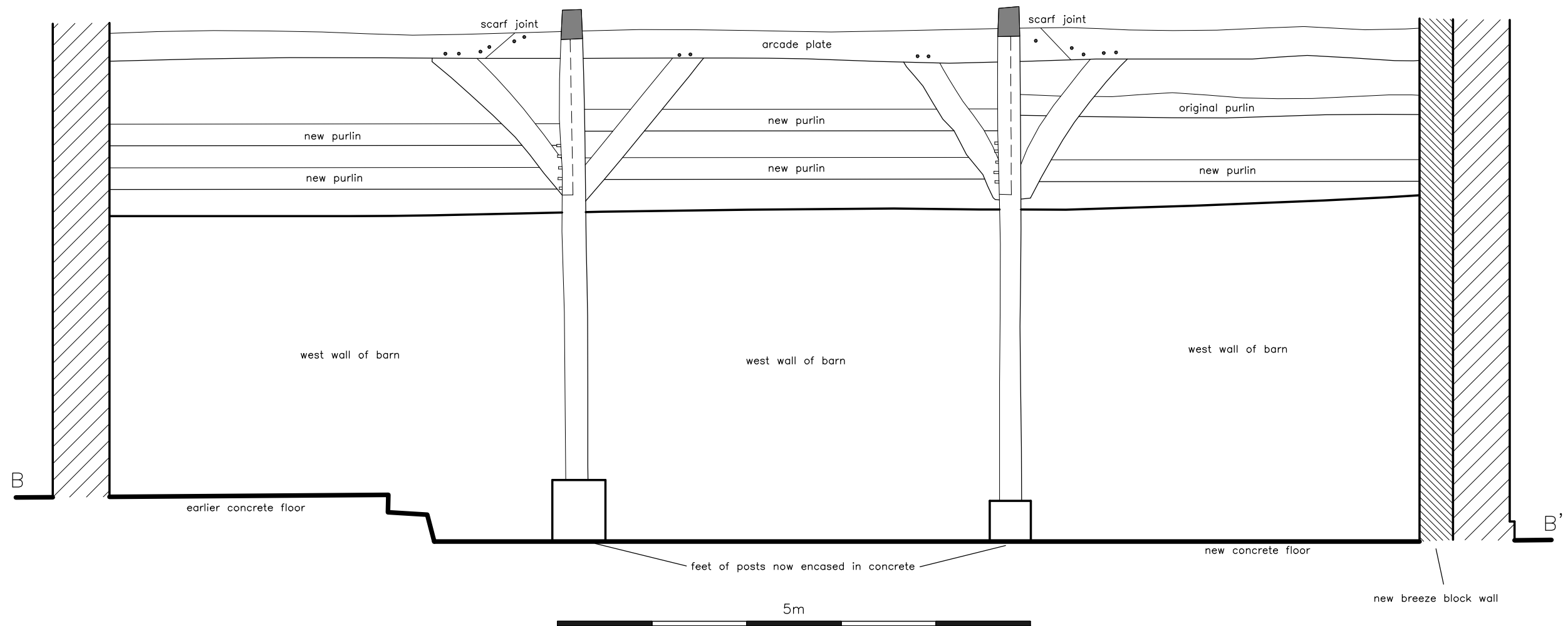

| |
|--|
| BARN AT CINDER HILL DENHOLME GATE ROAD HIPPERHOLME, WEST YORKSHIRE (NGR: SE 1230926850) HISTORIC BUILDING RECORD |
| FIGURE 13: LONG SECTION |
| SCALE: 1:50 |
| DATE OF SURVEY: JUNE 2011 |
| STEPHEN HAIGH Buildings Archaeologist |

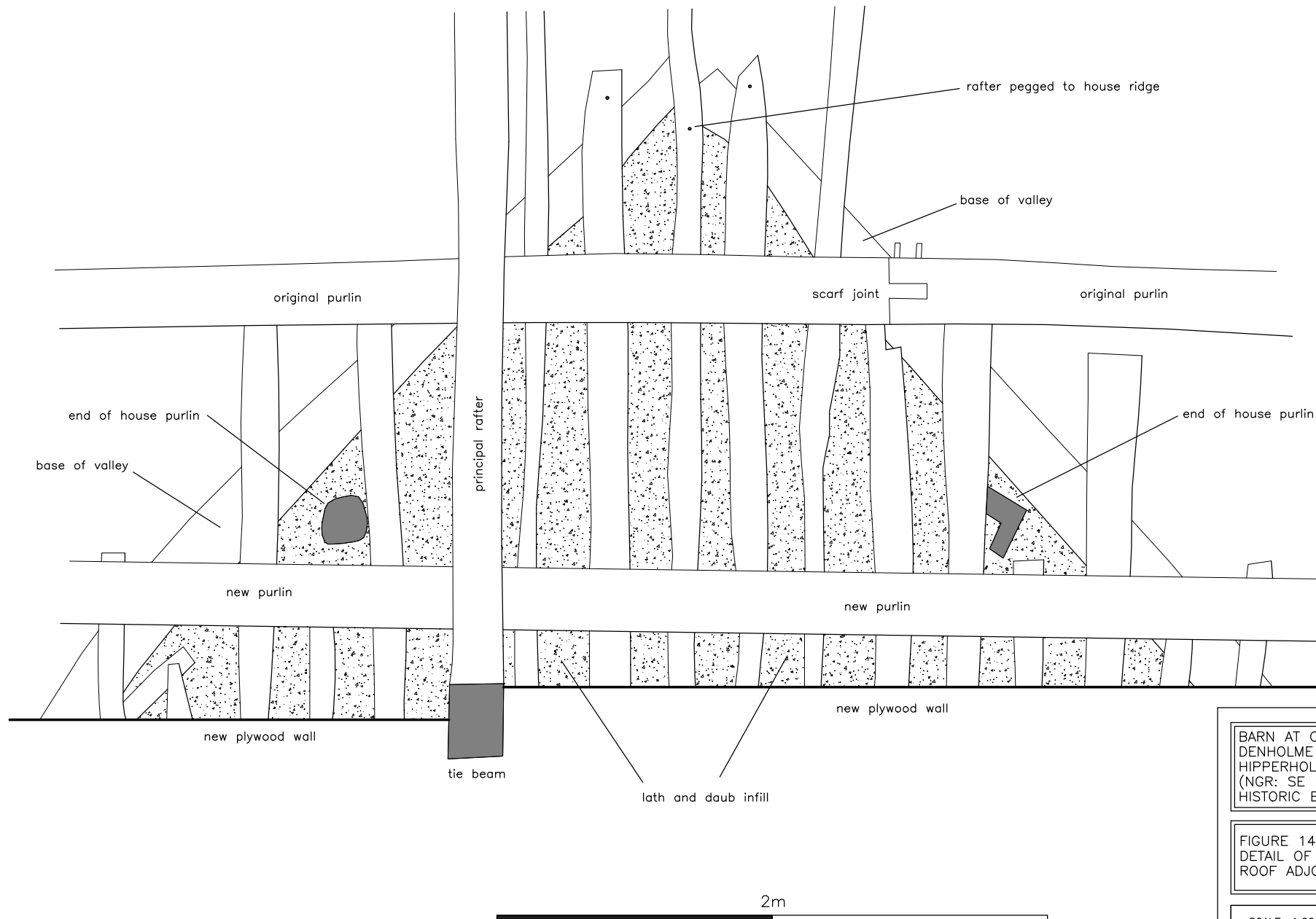

BARN AT CINDER HILL
DENHOLME GATE ROAD
HIPPERHOLME, WEST YORKSHIRE
(NGR: SE 1230926850)
HISTORIC BUILDING RECORD

FIGURE 14:
DETAIL OF UNDERSIDE OF STUDDED
ROOF ADJOINING HOUSE

SCALE: 1:20

DATE OF SURVEY: JUNE 2011

STEPHEN HAIGH
Buildings Archaeologist

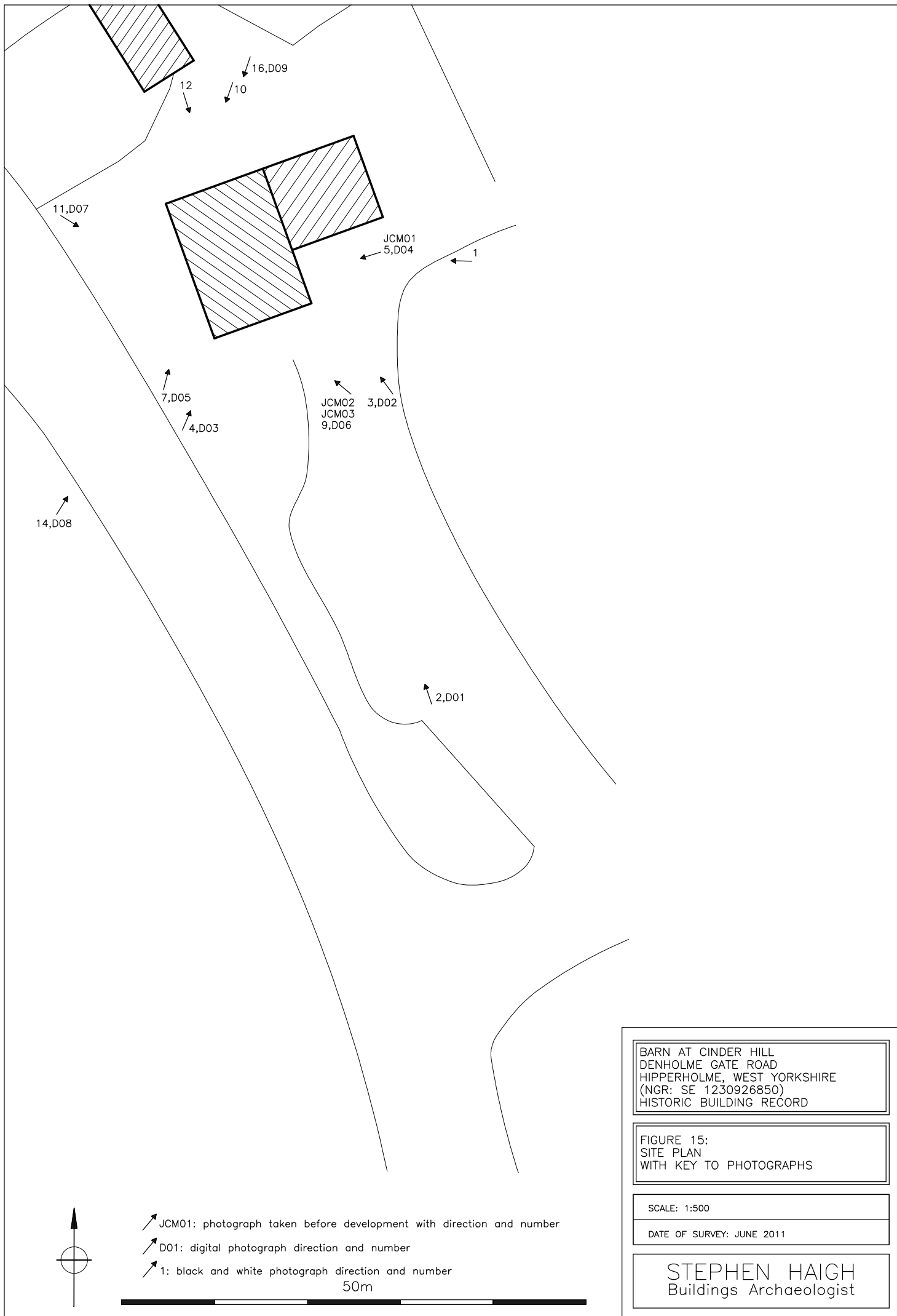

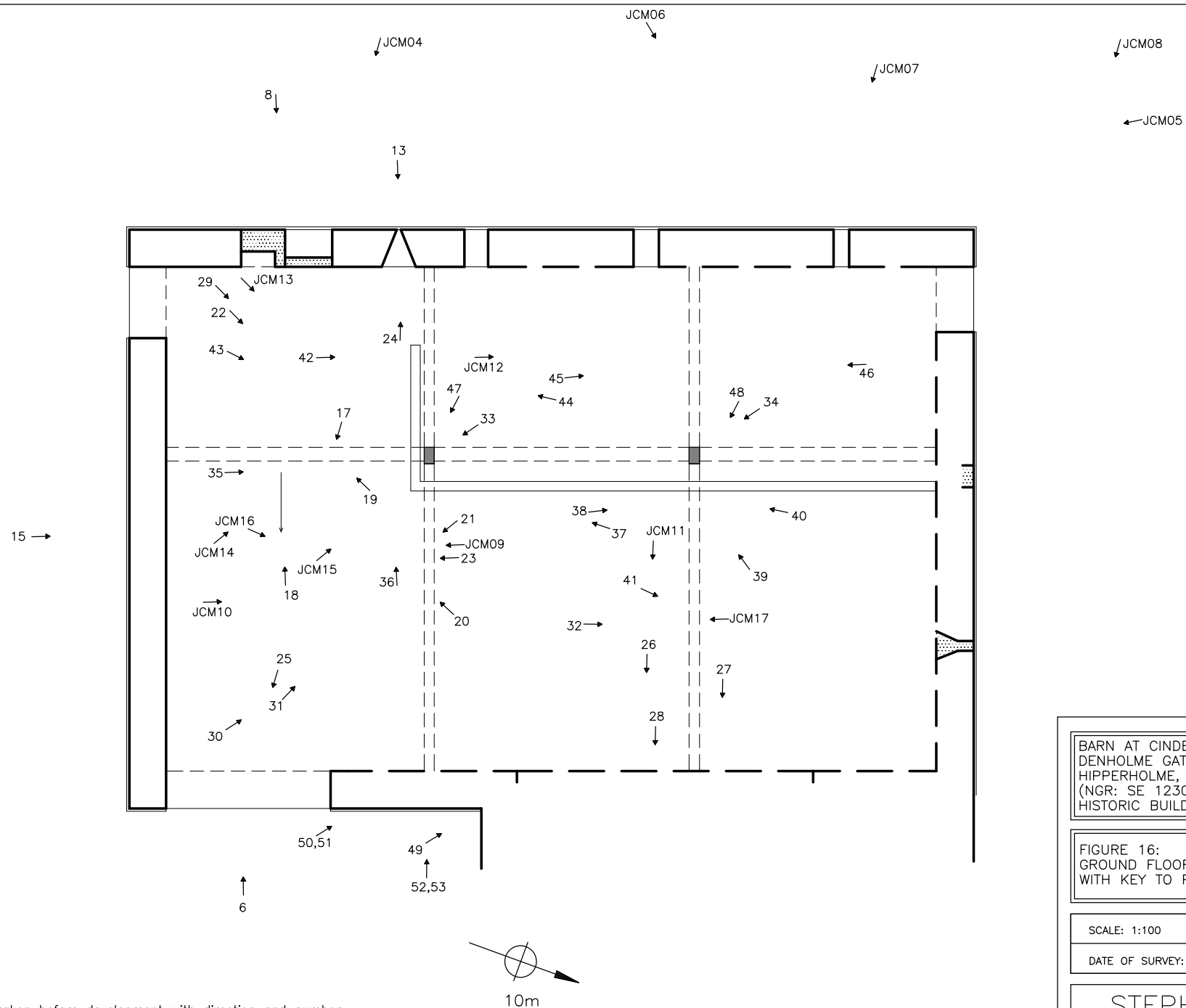

BARN AT CINDER HILL
DENHOLME GATE ROAD
HIPPERHOLME, WEST YORKSHIRE
(NGR: SE 1230926850)
HISTORIC BUILDING RECORD

FIGURE 16:
GROUND FLOOR PLAN
WITH KEY TO PHOTOGRAPHS

SCALE: 1:100

DATE OF SURVEY: JUNE 2011

STEPHEN HAIGH
Buildings Archaeologist



Photo JCM01: East elevation



Photo JCM02: South gable



Photo JCM03: South gable



Photo JCM04: Blocked doorway in west elevation



Photo JCM05: West elevation, from the north



Photo JCM06: West elevation (north part)



Photo JCM07: West elevation (north part)



Photo JCM08: North gable



Photo JCM09: South gable (interior)



Photo JCM10: Barn interior, from the south



Photo JCM11: Close studding at upper level, adjoining house



Photo JCM12: Shippon in west end, from the south



Photo JCM13: South truss, from the south-west



Photo JCM14: South truss, over aisle, from the south



Photo JCM15: South truss: arcade post, from the south



Photo JCM16: South truss, from the south-west



Photo JCM17: South truss, from the north