

# Clerkhill, Salt Lane, Winterbourne Gunner, Wiltshire:

Results of an archaeological watching brief

NGR SU 18313 357175

---

Prepared by:  
Steve Robinson

On behalf of:  
Mr and Mrs Eveleigh

Document No: ACW1071/2/0

Date: December 2017

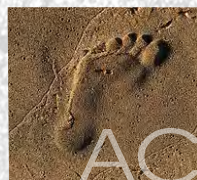

AC archaeology

---

# CLERKHILL, SALT LANE, WINTERBOURNE GUNNER, WILTSHIRE:

## Results of an archaeological watching brief

**NGR SU 18313 35174**

---

### SUMMARY

*Archaeological monitoring was undertaken on the 30th November 2017 by AC archaeology Ltd. during groundworks relating to a bungalow extension at Clerkhill, Salt Lane, Winterbourne Gunner, Wiltshire, NGR SU 18313 35174. The monitoring involved the recording of footing trenches excavated at the rear northeast side of the existing bungalow and in an area, where previous archaeological works have taken place on properties along Salt Lane. These previous investigations have revealed evidence for an extensive Anglo-Saxon cemetery. No evidence for any burials or other archaeological deposits were revealed in any of the footings trenches.*

#### 1. INTRODUCTION

**1.1** This document sets out the results of archaeological monitoring undertaken during groundworks associated with a bungalow extension at the rear of Clerkhill, Salt Lane, Winterbourne Gunner, Wiltshire NGR SU 18313 35174.

**1.2** The monitoring was undertaken by AC archaeology Ltd. on behalf of the site owners, Mr and Mrs Eveleigh. Wiltshire Council has granted permission for planning application 16/06651/FUL, subject to a number of conditions. Condition 3 of the consent requires that:

*No development shall commence within the area indicated (proposed development site) until: A written programme of archaeological investigation, which should include on-site work and off-site work such as the analysis, publishing and archiving of the results, has been submitted to and approved by the Local Planning Authority; and the approved programme of archaeological work has been carried out in accordance with the approved details.*

**1.3** The application area is situated on lawn and comprises approximately 31m<sup>2</sup> within the rear garden of the bungalow. The underlying solid geology comprises the Seaford Chalk Formation - Chalk. Sedimentary bedrock formed between 89.8 and 83.6 million years ago during the Cretaceous period.

## **2. ARCHAEOLOGICAL BACKGROUND**

- 2.1** There has been a series of archaeological investigations along Salt Lane following the first discovery of 6th century Anglo-Saxon graves in the garden of *Shiralee*, which were excavated by Musty in 1960. Further excavations and watching briefs in properties along Salt Lane have revealed an extensive cemetery dating between 6th and 8th centuries AD that may have been focused around pre-existing Bronze Age barrows; see Fig. 1 (AC archaeology in prep). Clerkhill may lie beyond the SE extent of the cemetery, but the known layout of burials becomes more irregular to the south and it is reasonable to consider the possibility that outliers may exist in this vicinity.
- 2.2** The nearby property, Sachbar, includes the site of a pond barrow that may have acted as the principal focus of the early cemetery. This monument is protected as a Scheduled Monument (no. 26264).

## **3. METHODOLOGY**

- 3.1** The principal aims of the archaeological watching brief were;
- To record any archaeological features and finds which may be revealed or disturbed by the groundworks and;
  - To provide an interpretive report on the results of the monitoring that may provide additional information regarding the extent of the Anglo-Saxon cemetery.
- 3.2** The site works were undertaken in accordance with a written scheme of investigation (Cox 2017) approved by the Wiltshire Council Assistant County Archaeologist (WCACA). Attendance by the site archaeologist was comprehensive, i.e. *present during all relevant ground disturbance*.
- 3.3** Site observations were recorded using the standard AC archaeology *pro forma* recording system, comprising written and graphic records and in accordance with AC archaeology's *General Site Recording Manual, Version 2*. A digital photographic record was also made.
- 3.4** The archive has been prepared using the unique site code ACW1071.

## **4. RESULTS**

- 4.1** The groundworks comprised the machine excavation of a series of footing trenches, measuring 6m and 5.25m long, each 1m in width. The trenches were excavated through turf/topsoil to a maximum depth of 0.3m before the natural Upper Chalk bedrock was exposed. The trenches were then cleaned by hand to determine whether any archaeological deposits were present.
- 4.2** No evidence for cut archaeological features or pre-modern artefacts was recovered.





**Plate 1: Footings trench from the northeast. 1m scale**



**Plate 2: Footings trench from the northwest. 1m scale**

## 5. COMMENT

- 5.1 The results of the watching brief were wholly negative, with no archaeological features or finds present. This evidence is useful however, as it assists in understanding the southeast extent of the former Anglo-Saxon cemetery.

## 6. REFERENCES

British Geological Survey online viewer, accessed 30/01/2017.

<http://mapapps.bgs.ac.uk/geologyofbritain/home.html>.

Cox, P.W. 2017, '*Clerkhill, Salt Lane, Winterbourne Gunner, Wiltshire: Written Scheme of Investigation for archaeological watching brief*. AC archaeology Ltd. Doc. No. ACW1071/1/0

Chartered Institute for Archaeologists, 2014. *Standard and guidance for an archaeological watching brief*. Professional guidance

English Heritage, 1991. *The Management of Archaeological Projects. Second Edition* (MAP2). Historic England: professional guidance

Wiltshire Historic Environment Record online, visited 30/01/2017.

<http://www.wiltshire.gov.uk/artshéritageandlibraries/museumhistoryheritage/wiltshireandswindonhistoricenvironmentrecord/wshemap.htm>

---



- Graves with grave goods
- Graves without grave goods
- Unexcavated graves

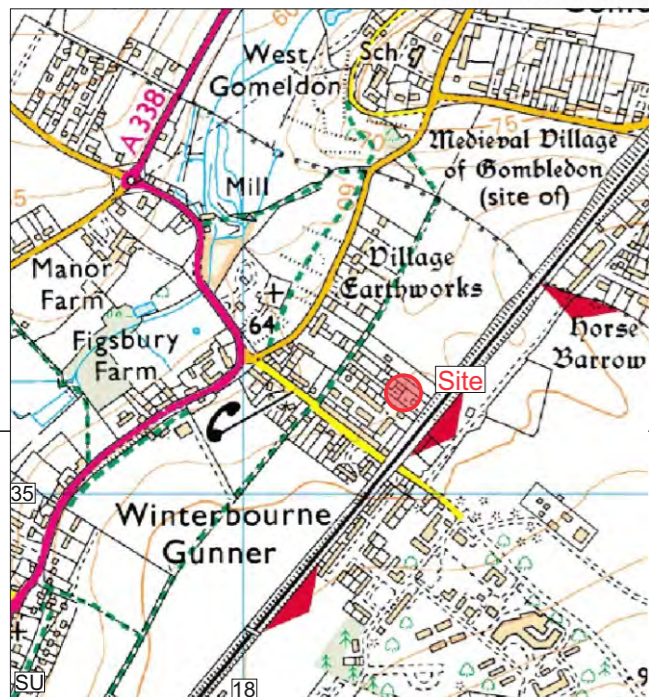
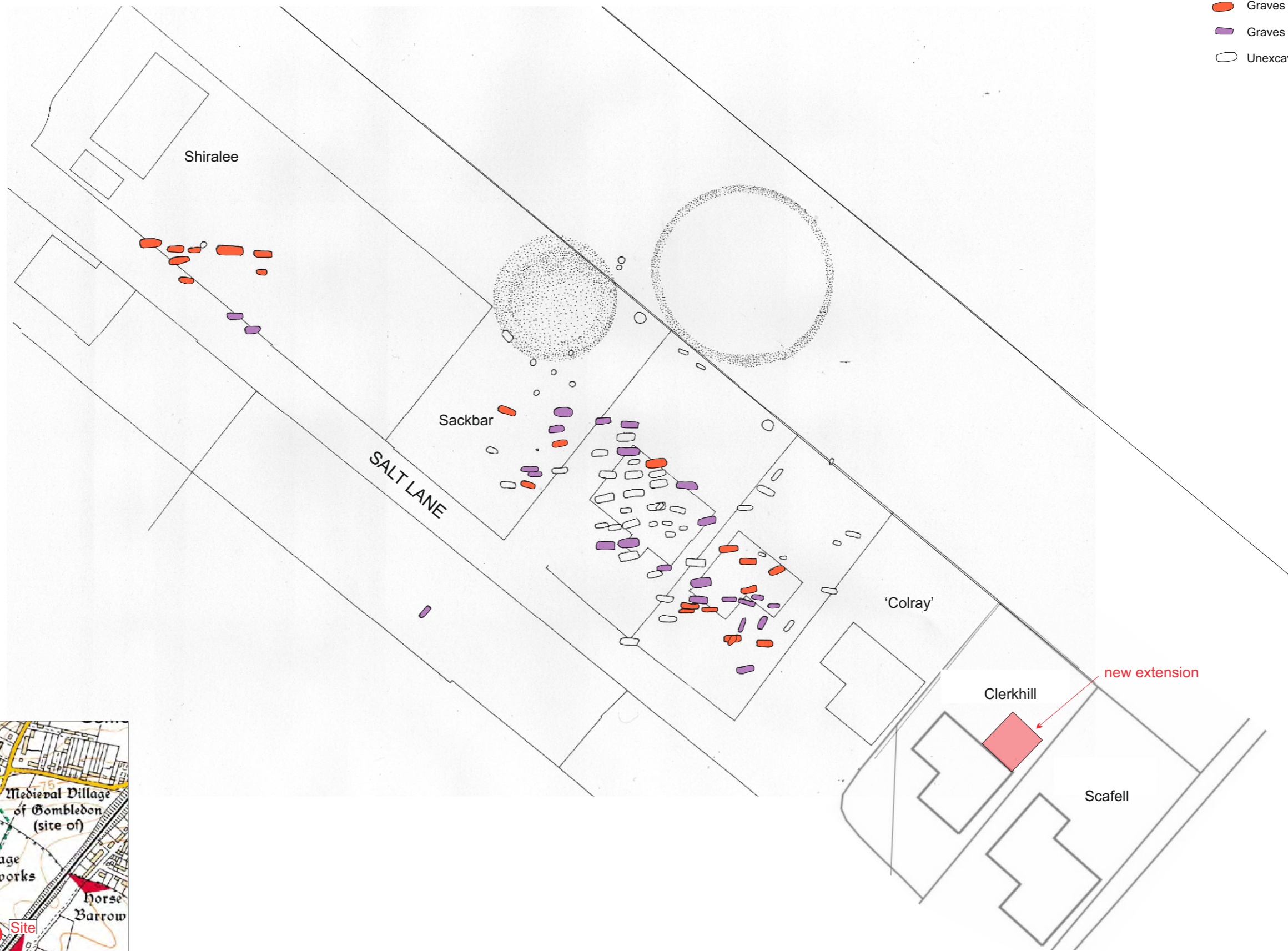

Ordnance Survey © Crown Copyright 2015. All rights reserved.  
Licence number 100022432

### Wiltshire Office

AC archaeology Ltd  
Manor Farm Stables  
Chicklade  
Hindon  
Nr Salisbury  
Wiltshire  
SP3 5SU

Telephone: 01747 820581  
Fax: 01747 820440

### Devon Office

AC archaeology Ltd  
Unit 4, Halthaies Workshops  
Bradninch  
Nr Exeter  
Devon  
EX5 4LQ

Telephone/Fax: 01392 882410

[www.acarchaeology.co.uk](http://www.acarchaeology.co.uk)