

A proposed new 132kv overhead electricity cable between Landulph and Milehouse, near Botusfleming, Cornwall

NGR SX4126660784 to SX4095362626

Archaeology and cultural heritage assessment

Prepared by:

John Valentin, John Chandler
and Peter Cox

On behalf of:

Devon Wildlife Consultants

Document No: ACD35/1/0

Date: January 2009

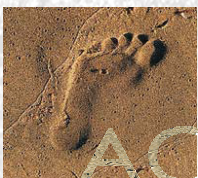

archaeology

A PROPOSED NEW 132KV OVERHEAD ELECTRICITY CABLE BETWEEN LANDULPH AND MILEHOUSE, NEAR BOTUSFLEMING, CORNWALL

(NGR SX 4126660784 TO SX4095362626):

ARCHAEOLOGY AND CULTURAL HERITAGE ASSESSMENT

CONTENTS

	Summary	
1.	Introduction	1
2.	Methodology	1
3.	Legislation and guidance.....	2
4.	Archaeological background	3
5.	Historic building records	4
6.	Historical development of the area.....	5
7.	Aerial photographic evidence.....	5
8.	Site inspection.....	5
10.	Comments.....	6
11.	Conclusion.....	7
12.	Acknowledgements.....	7
13.	Sources consulted.....	7

List of figures

Fig. 1: Site location

Fig. 2: Location of plot numbers, recorded and newly identified archaeological sites and historic buildings

Fig. 3: Extract from John Norden's manuscript maps of Cornwall, c. 1597. Reproduced in Ravenhill 1972

Fig. 4: Extract from Joel Gascoyne's map of Cornwall, 1699

Fig. 5: Extract from Thomas Martyn's map of Cornwall, 1748

Fig. 6: Extract from Thomas Martyn's map of Cornwall, 1827

Fig. 7: Extract from the Ordnance Survey one-inch map sheet 25, 1809

Fig. 8: Extract from the Landulph parish tithe map, 1840s

Fig. 9: Extract from the Botus Fleming parish tithe map, 1840s

Fig. 10: Extract from the St Stephen's, Saltash parish tithe map, 1841

Fig. 11: Extract from the Ordnance Survey first edition six-inch map, published 1883

Fig. 12: Extract from the Ordnance Survey second edition six-inch map, published 1907

Fig. 13: Extract from the Ordnance Survey six-inch map, published 1954

List of plates

Plate 1: North Lodge and gate pier (Site B6) to Moditonham Park

Plate 2: South Lodge and gate pier (Site B6) to Moditonham Park

Plate 3: View of Plots 11 and 12 along route. Looking to SE

Appendix 1: Catalogue of previously recorded and additional archaeological sites and historic buildings/structures

Appendix 2: Fieldname data derived from tithe apportionments

Appendix 3: List of consulted aerial photographs held by the NMR

Summary

An archaeology and cultural heritage assessment of a proposed 132KV overhead power cable on land between Landulph and Milehouse, near Botusfleming, Cornwall, has been prepared by AC archaeology during December 2008 and January 2009. The cable route extends over a distance of approximately 1.9km and passes through an undulating agricultural landscape dominated by pasture, and characterised by a pattern of fields and woodland that has changed little since the middle ages. Most field boundaries are formed by vegetated earthen hedgebanks or stream courses.

While there are no known archaeological sites directly affected by the scheme, in one field crossed by the route shattered pebbles possibly of prehistoric date have been previously found. Possibly of more significance are a series of field names transcribed from the various parish tithes apportionments. These include a 'Barn Field', a 'Brick Field' and 'Blackhavens'. The two former names are self-explanatory, but the element 'Black' within a field name often indicates settlement or industrial activity in the area.

The cable will be supported by a number of wooden poles and therefore the impact on any hitherto unrecorded buried archaeological remains is likely to be minor and highly localised. One of the supports is located near to Moditonham House lodges and gate piers; these are Grade II listed buildings.

1. INTRODUCTION

1.1 This archaeology and cultural heritage assessment for a proposed new 132KV overhead electricity cable between Landulph and Milehouse, near Botusfleming, Cornwall, has been prepared by AC archaeology during December 2008 and January 2009. The location of the route is shown on Fig. 1.

1.2 The study has been prepared on behalf of Devon Wildlife Consultants in order to establish the cultural heritage and archaeological implications of the proposal. The cable route extends over a distance of approximately 1.9km in a mainly north to south direction. It is located on the east side of Botusfleming and passes through an undulating agricultural landscape, deeply incised by streams feeding into Kingsmill Lake on the west side of the Lower Tamar Valley. The area is characterised by a pattern of fields and woodland that has changed little since the middle ages. It is crossed by a number of sunken lanes giving access to fields off the principal public thoroughfares. Most field boundaries are formed by vegetated earthen hedgebanks or stream courses. The underlying natural solid geology of the area is composed of shales of the Upper Devonian period.

2. METHODOLOGY

2.1 The study has comprised a desk-based assessment, as defined by the Institute for Archaeologists *Standards and Guidance for desk-based assessment* (published 1994, revised 2001), of the archaeological and cultural heritage resource of the site. In addition, relevant other recorded information close by is included in order to provide setting/context.

2.2 The scope of the study has included archaeological sites and finds (including Scheduled Monuments), historic buildings (including Listed Buildings), historic landscape features (including Registered Parks and Gardens, Battlefields etc.), or other locally-designated features, or areas, of cultural heritage importance.

2.3 The following data sources have been examined:

- Archaeological data, historic building information and aerial photographs held by Cornwall County Council's Historic Environment Record (CCHER);
- Cornwall County Council Historic Landscape Characterisation (HLC) map;

- Historical cartographic and documentary information held by Cornwall Record Office (CRO), in Truro and Cornish Studies Library (CSL) in Redruth;
- Historic aerial photographs held at the National Monuments Record (NMR), Swindon;
- English Heritage website Listed Buildings online, and;
- Other published or unpublished information.

2.4 A walkover survey of the site has also been undertaken in order to assess the condition of known sites, to identify any new sites and to determine how the land-use might have affected the survival of any hitherto unrecorded sites.

3. LEGISLATION AND GUIDANCE

Relevant protection, guidance and policies relating to the protection, maintenance and enhancement of archaeological sites and other aspects of cultural heritage may be summarised as follows:

3.1 Planning guidance for archaeology

General policy and advice for best practice in the management of archaeological remains under development plan and control systems has been set out in the Department of the Environment Planning Policy Guidance note 16 (PPG 16, November 1990), relevant extracts of which follow:

A6: Archaeological remains should be seen as a finite, and non-renewable resource, in many cases highly fragile and vulnerable to damage and destruction. Appropriate management is therefore essential to ensure that they survive in good condition. In particular, care must be taken to ensure that archaeological remains are not needlessly or thoughtlessly destroyed. They can contain irreplaceable information about our past and potential for an increase in future knowledge. They are part of our national identity and valuable both for their own sake and for their role in education, leisure, and tourism.

A13: If physical preservation in situ is not feasible, an archaeological excavation for the purposes of 'preservation by record' may be an acceptable alternative. From the archaeological point of view this should be regarded as a second best option.

3.2 Listed buildings/structures

Buildings of national, regional, or local historical and architectural importance are protected by the Planning (Listed Buildings and Conservation Areas) Act, 1990. Buildings designated as 'Listed' are afforded protection from physical alteration or effects on their historical setting.

3.3 Planning guidance for the historic environment

Department of the Environment Planning Policy Guidance Note 15 (1994) provides general policy and advice for the best practice in the management of Listed Buildings, conservation areas and historic parks and gardens under development plan and control systems. This Guidance Note is intended to encompass all previous legislation concerning Listed Buildings, Conservation Areas, Historic Parks and Gardens and Historic Battlefields.

3.4 Local authority plan policies

Relevant extracts from policies for the management of archaeology and cultural heritage are set out in the *Caradon Local Plan* (first alteration), adopted August 2007.

Policy CL18: Areas of Great Historic Value (AGHVs)

In considering proposals for development in Areas of Great Historic Value, high priority will be attached to the need to avoid disturbance to features of archaeological or historic significance, and to the need to conserve the particular character of the areas. Planning permission will not be granted for developments which would adversely affect the archaeological or historic character of the areas.

Policy CL19: Buildings of archaeological significance

High priority will be given to the protection, preservation and enhancement of nationally important scheduled and unscheduled monuments and other sites and buildings of archaeological and historic significance in the plan area through the following measures:

- (i) development proposals which would prejudice the preservation of nationally important archaeological remains, whether scheduled or not, and their settings, will not be allowed unless the development is also of national importance and there is no alternative site;*
- (ii) if there is evidence to suggest that significant remains may exist on the site of a proposed development, the extent and importance of which are unknown, the Local Planning Authority will request the developer to arrange for an archaeological evaluation to be carried out before the planning application is determined, thus enabling an informed planning decision to be made;*
- (iii) where preservation in situ is not possible the Local Authority will not allow development to take place until satisfactory provision has been made for a programme of archaeological investigation and recording prior to the commencement of the development.*

Policy CL20: Protection of archaeological sites

Where proposed development is likely to significantly affect sites of county or local archaeological importance, they should be protected in situ, unless the significance of the remains is not sufficient, when weighed against the need for development, to justify their physical preservation. Where retention of remains is not possible, the Council may impose conditions or seek planning obligations to ensure that adequate archaeological records are prepared before development commences.

Policy EV3: Listed buildings & redevelopment in Conservation Areas

All proposals for works (including demolition) which would directly affect the fabric or setting of a listed building must have special regard to the desirability of preserving the building or its setting or any features of architectural or historic interest which it possesses. This will be the primary consideration in determining applications for the adaptation of listed buildings to new uses, subject only to there being no overriding serious environmental harm.

4. ARCHAEOLOGICAL BACKGROUND

- 4.1** Previously recorded archaeological sites nearby are described in Appendix 1 and shown on Fig. 2 (Sites A1 – A14). The archaeology and history of the Tamar and Lynher Valleys have been described in detail in previous reports (eg Thomas and Buck 1994, Buck 1998 and Herring and Tapper 2002). This area of Cornwall contains evidence for occupation from the Neolithic period through to the present day. There is a Neolithic henge monument at Castlewich and a long barrow on Kit Hill, c. 6k and 9km to the north of the present site. There are numerous Bronze Age barrows in the area and Cadson Bury hillfort is located near Callington. Prehistoric activity close to the proposed cable route comprises finds of worked flint and pebbles (A1 and A2) There are also many Iron Age or Romano-British rounds in the area, including possible examples close to the present site at Carkeel and at Kingsmill Park (A13).
- 4.2** During the medieval period the area is likely to have been a largely rural farmed landscape, characterised by settlements being generally located in the valleys and lower ground and the hillside and marginal areas being used for open grazing (Thomas and Buck 1994). Site A14 is a possible field system of this date. The village of Botusfleming is a typical Cornish churchtown of this period and a settlement at Moditonham (B7) is first recorded in 1284. Possible small scale industrial activity in the area is suggested by a mill being recorded at Kings Mill in 1018 (A12).
- 4.3** This area is likely to have remained a largely rural landscape during the post-medieval period, with a number of larger estates established, including Moditonham. Industrial activity of this date in the vicinity of the route is confirmed by a limekiln (A9) and two quays (B9 and B10) at Kingsmill Farm cornmill, a horse engine house at Marraborough (A69) and a quarry to the east of the proposed route (A8). Wheal Fortune Mine, thought to be operating in the 1850s, is thought to be located somewhere in the vicinity (A10).

4.4 Historic Landscape Characterisation (HLC) mapping provided by CCHER describes most of the land crossed by the route as 'Medieval Farmland', with a small area close to Ziggerson Wood as 'Post-medieval Farmland'.

5. HISTORIC BUILDING RECORDS

5.1 Historic buildings and structures close to the cable route are described in Appendix 1 and shown on Fig. 2. The nearest listed historic structures are the late 18th century gate piers and lodges at the entrance to Moditonham House (B6; Plates 1 and 2). Other buildings part of this estate include the manor house itself (B7), which was rebuilt in 1760 on the site of an earlier building, as well a dovecot or folly (B8). A medieval holy well is located at Botusfleming (B3) and to the northeast of this there is tomb and obelisk (B4) in a field dedicated to William Martyn, who died in 1762 and preferred to be buried in unconsecrated ground.



Plate 1: North Lodge and gate pier (Site B6) to Moditonham Park



Plate 2: South Lodge and gate pier (Site B6) to Moditonham Park

6. HISTORICAL DEVELOPMENT OF THE AREA

- 6.1 There is a good series of large scale historic maps for the area dating from the 1840s through to the 1950s. There is a number of pre-19th century maps which depict the area, but are of insufficient detail to provide relevant information about the proposed cable route. Copies of historic maps are included as Figs 3 to 13, and on these the proposed cable route has been annotated. The most useful secondary historical source for present purposes is an archaeological appraisal of the area undertaken by the Cornwall Archaeological Unit in 1994 (Thomas and Buck 1994) and there is also a competent local history of Botus Fleming (Middleton 1982) and the standard older parish histories (Polsue 1867-72).
- 6.2 The area through which the proposed cable route passes was characterised by a long-established pattern of principally arable farming, with apple- and cherry-orchards, some pasture and waste in the lower-lying areas subject to flooding from the Tamar, and coppice woodland. The farmsteads to which individual fields belonged in the 1840s are noted in the fieldnames (Appendix 2). Several of these are ancient, including Elbridge (a Domesday settlement), Carkeel, Marraborough, Church Town and Moditonham. Kingsmill, of which remains are extant, is claimed to be a mill of pre-Domesday origin. Several fieldnames recorded in the 1840s are of much earlier origin, and occur in glebe terriers of the 17th century, including Zegeson (spelled in various ways), Sladeland and Dog's Hole. A number of names along or close to the route have possible archaeological significance, including Burrow Hill (Site A15 on Fig. 2 and in Appendix 1), perhaps indicating early defended settlement on the hill, Barn Field (A16), Brick Field (A17) and Blackhavens (A18). The black element to this latter name can often indicate early settlement or industrial activity. Burial Field almost certainly relates to a mausoleum, presumably that referred to by Polsue (vol 1, 113) as the tomb of Dr William Martyn (Site B4). The route appears to pass through or close to a designed landscape of gardens and pleasure grounds surrounding the mansion house of Moditonham. The names Plumploads and Great and Little Butter Bread are unexplained, though may refer to the productivity of the land.
- 6.3 Later large-scale Ordnance Survey maps (Figs 11-13) show little alteration to the pattern of fields crossed by the route from that of the various tithe maps and what is still present today

7. AERIAL PHOTOGRAPHIC EVIDENCE

- 7.1 A number of aerial photographs providing vertical coverage of the proposed route was consulted for this assessment. These are held at the National Monuments Records Office in Swindon (Appendix 3). No additional areas of archaeological interest were identified along the route.

8. SITE INSPECTION

- 8.1 The route of the proposed cable was examined on 12 January 2009 in order to establish the presence of unrecorded archaeological features along the route, to review the locations of previously recorded features that may be affected by construction and to consider the general archaeological potential of the area. Each land parcel (other than roads or tracks) was given a plot number (see Fig. 2) and observations have been recorded using this notation.
- 8.2 The following provides a commentary of the route:

Plot 1 Pasture. Slopes down to southeast and steeply to east. Boundary to lane is formed by hedgebank. No surface indications of archaeological features.

Plot 2 Pasture. Slopes steeply down to south to stream. Northern boundary to lane is formed by hedgebank. No surface indications of archaeological features.

Plot 3 Pasture. Slopes steeply down to north to stream. Southern boundary to lane is formed by hedgebank. No surface indications of archaeological features.

Plot 4 Pasture. Domed topography. North and south boundaries to lanes are formed by hedgebanks. No surface indications of archaeological features.

Plot 5 Pasture. Northern boundary to land formed by hedgebank. Southern boundary not examined. Field name Blackhavens (A18). No surface indications of archaeological features.

Plot 6 Pasture. Plot has been arable in recent years. Northern boundary not examined. Southern boundary formed by hedgebank. No surface indications of archaeological features.

Plot 7 Pasture. East and south boundaries formed by hedgebanks. Route crosses land at south end of field. Modern barn to SW. A barn shown on modern OS map, adjacent to route as it crosses lane at south end of plot, is no longer extant.

Plot 8 Pasture. North and south boundaries are formed by hedgebanks. No surface indications of archaeological features.

Plot 9 Pasture. Northern boundary formed by hedgebank. No surface indications of archaeological features. Slopes steeply into stream at southern end.

Plot 10 Pasture. Slopes steeply down to west to stream. Southern boundary to lane is formed by hedgebank. No surface indications of archaeological features.

Plot 11 Pasture (Plate 3). Slopes down steeply to south. Southern boundary (parish boundary) formed by hedgebank. Listed structures B6 to northeast of this plot. No surface indications of archaeological features.

Plot 12 Pasture (Plate 3). Domed field with steep slopes down to N and S into stream courses. Context of findspot A2 uncertain. North and south boundaries are formed by hedgebanks. No surface indications of archaeological features.

Plot 13 Pasture. Slopes down to northwest into stream course. Northwest and southeast boundaries are formed by hedgebanks. No surface indications of archaeological features.

Plot 14 Pasture. Slopes down to northwest. The northwest and southeast boundaries are formed by hedgebanks. No surface indications of archaeological features.

Plot 15 Pasture. Horses in field Slopes down to northwest. The northwest and southeast boundaries are formed by hedgebanks. No surface indications of archaeological features.



Plate 3: View of Plots 11 and 12 along route. Looking to SE

9. COMMENTS

9.1 The proposed cable route crosses through an undulating agricultural landscape, characterised by mainly pasture fields bounded by ancient hedgebanks. This landscape is likely to have remained largely unaltered probably since at least the medieval period, with therefore any buried archaeological sites possibly affected by works likely to be earlier in date.

9.2 While there are no known archaeological sites directly affected by the scheme, this assessment has established that in one field crossed by the route shattered pebbles possibly of prehistoric

date have been previously found (Site A2). Possibly of more significance are a series of field names transcribed from the various parish title apportionments. These include a 'Barn Field' (Plot 7, Site A16), a 'Brick Field' (Plot 6, A17) and 'Blackhavens' (Plot 5, A18). The former two names are self-explanatory, but the element 'Black' within a field name often indicates settlement or industrial activity in the area.

- 9.3** The walkover survey has not identified any significant, previously unrecorded, archaeological features. The current land use of the proposed route corridor does not allow recovery of surface artefacts to assess local evidence for buried remains. There are no special topographic locations identified that might have provided favourable locations for prehistoric settlement.
- 9.4** The cable route does not lie within an AGHV and there are no Scheduled Monuments or other statutorily protected heritage resources directly impacted upon by the scheme. There is a number of Listed Buildings within 500m of the route, the nearest c. 50m to the east and comprising the gate piers and lodges (B6) to Moditonham House. A supporting wooden pole is proposed close to the lodges, but it is considered that this will only have a minor impact on the setting of these structures.
- 9.5** Most of the boundaries crossed by the route are ancient hedgebanks, and their depiction on early maps means they are considered to be important hedgerows under criterion 5a of Schedule 1, Part II of the Hedgerow Regulations of 1997, as they are recorded *in a document held at the relevant date at a Record Office as an integral part of a field system pre-dating the Inclosure Act*. Throughout the route a number of wooden pole cable supports are proposed close to some of these boundaries and care should therefore be taken during groundworks to avoid damage to the upstanding historic fabric of the boundaries. Depending on the extent and depth of any groundworks in these areas, it is possible that parts of associated internal and external now-infilled ditches might be exposed.

10. CONCLUSION

- 10.1** As the scheme is an overhead cable route, the principal impact on any buried archaeology will be during groundworks associated with construction. As the groundworks for the wooden cable supports are likely to be minor, then it is unlikely that there will be any significant or extensive exposures of any hitherto unrecorded buried archaeological remains. If more extensive groundworks are proposed (eg topsoil stripping for compounds, access tracks etc), then it is possible that below ground archaeological deposits might be revealed.

11. ACKNOWLEDGEMENTS

The assessment was commissioned on behalf of Devon Wildlife Consultants by Carly Ireland. We are grateful to the staff of the NMR, CRO and CSL for their help and assistance when providing the historical data. Jane Powning of CCHER kindly provided the archaeological information. The illustrations for this report were prepared by Sarah Cottam.

12. SOURCES CONSULTED

Bond, Chris, *An index to the historical place names of Cornwall*, 2 vols 2007
Gascoyne, Joel, *A map of the county of Cornwall newly surveyed* (facsimile ed, Devon & Cornwall Record Soc, ns, 34, 1991)
Buck, C., 1998, Preliminary assessment of industrial sites of archaeological importance in the Tamar Valley. Cornwall County Council report ref. 1998.R074
Herring, P. and Tapper, B.P., 2002, The Lynher Valley, Cornwall: Historical and archaeological appraisal. Cornwall County Council report ref. 2002.R062
Martyn, Thomas, *New and accurate map of the county of Cornwall from an actual survey*, 1748 ed (small scale); and 1827 2nd ed, at 1-inch scale.
Middleton, R A, *The cherry gardens of yesterday: a history of Botus Fleming*, 2nd ed, 1989 (1st 1982)
Ordnance Survey 1-inch map, sheet 25, 1809

Ordnance Survey 6-inch map, sheet Cornwall 37SE, revised 1905, published 1907
Ordnance Survey 6-inch map, sheet SX46SW, revised 1951, published 1954; revised 1991, published 1992
Ordnance Survey 25-inch map, sheet Cornwall 37.12, surveyed 1865/1882, published 1883; revised 1905, published 1907
Ordnance Survey 25-inch map, sheet Cornwall 37.16, surveyed 1865, published 1881; revised 1905, published 1907
Padel, O J, *Cornish place-name elements*, 1985 (EPNS 56/57)
Polsue, Joseph, *Lake's parochial history of the county of Cornwall*, reprint of 1867-73 ed, 4 vols (vol. 1, 1867; 2, 1868; 4, 1872)
Ravenhill, W (ed), *John Norden's manuscript maps of Cornwall and its nine hundreds*, Exeter, 1972
Stuart, Elisabeth, *Lost landscapes of Plymouth: maps, charts and plans to 1800*, Stroud 1991
Thomas, Nigel and Buck, Colin, *A rapid identification survey of parishes adjoining the Tamar Valley, Cornwall*, 1994 (Cornwall Archaeological Unit)
Thorn, C and F (ed), *Domesday Book 10: Cornwall*, 1979
Tithe Map: Botus Fleming (nd) [TNA IR 29/6/13- app; IR30/6/13 – map]
Tithe Map: Landulph (nd) [TNA IR29/6/94 – app; IR30/6/94 – map]
Tithe Map: St Stephens, Saltash 1841 [TNA IR29/6/177 – app; IR30/6/177 – map]

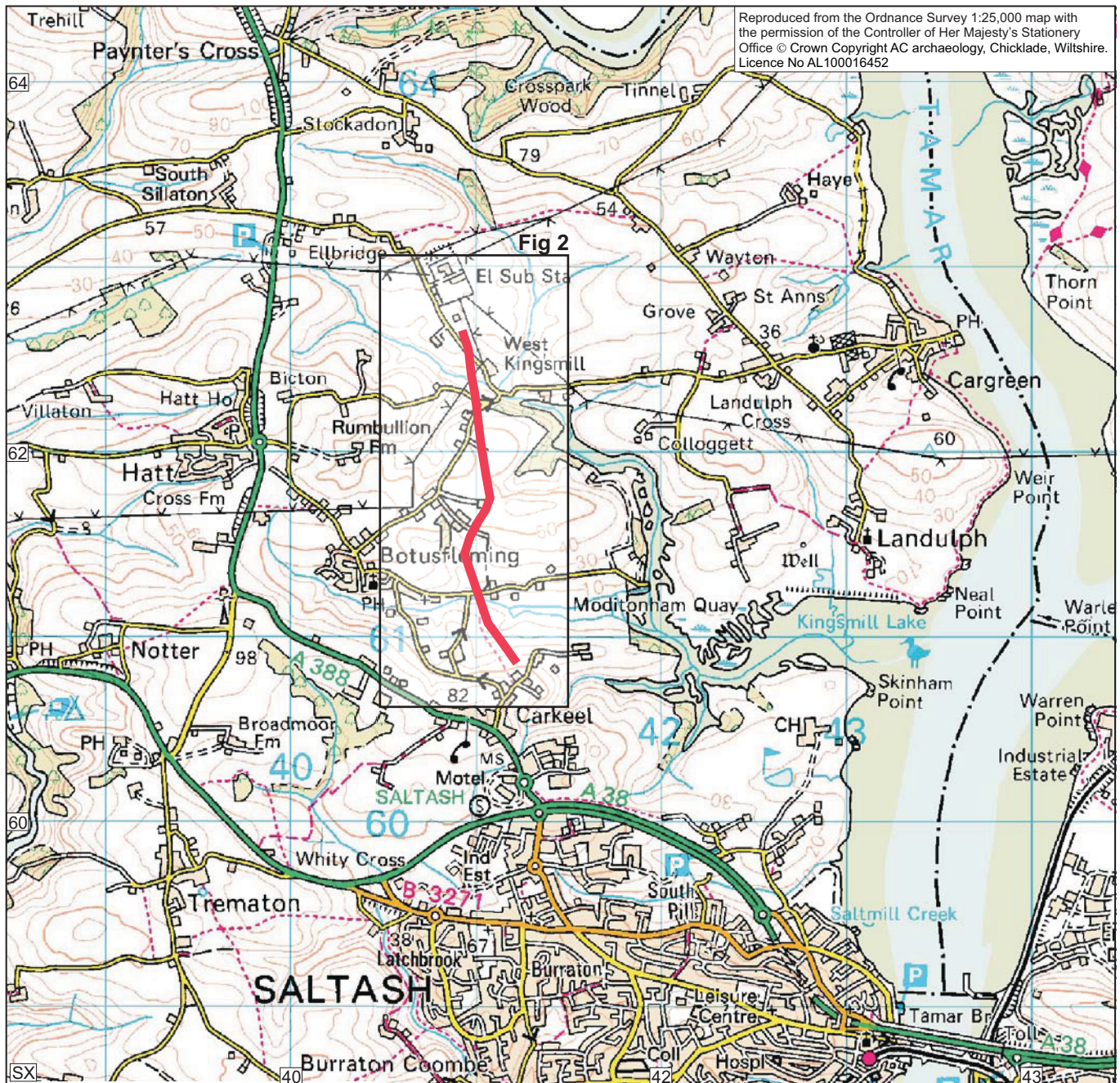
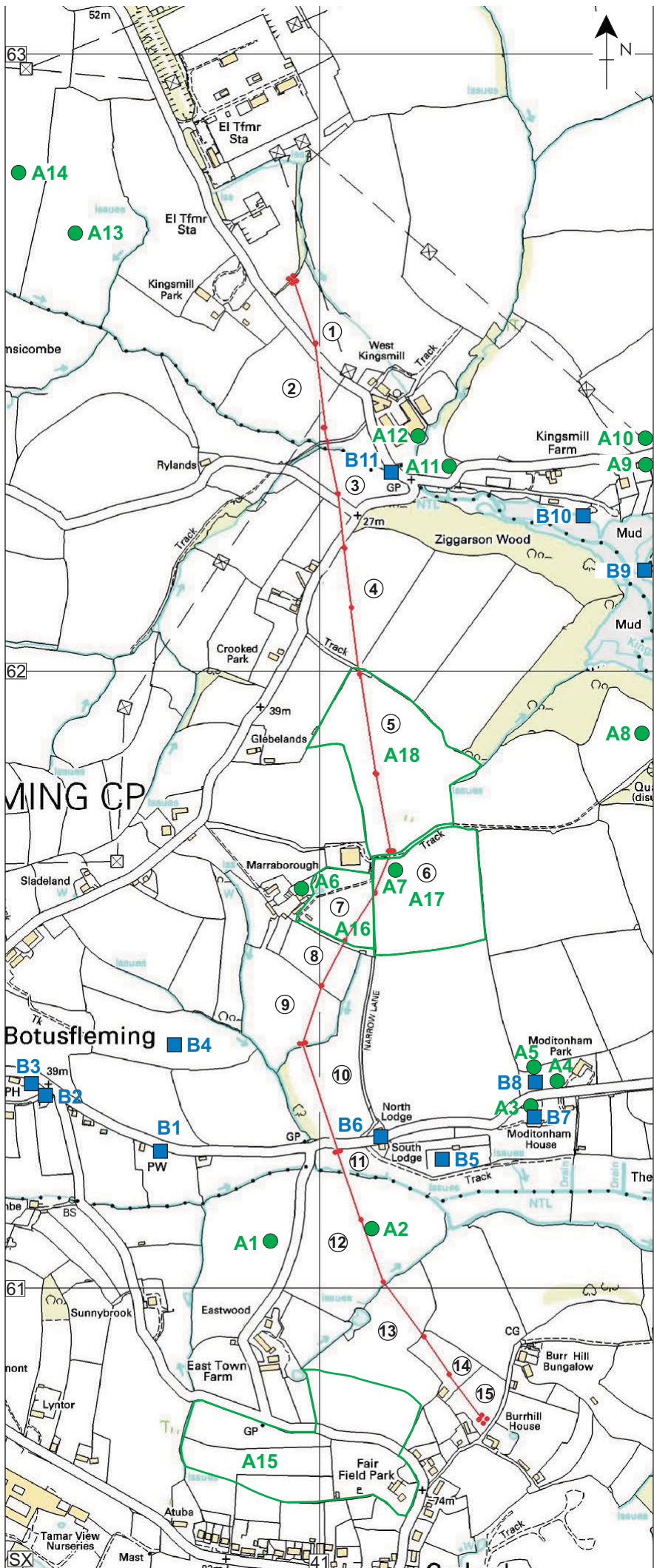

Fig. 1: Site Location







-  Proposed cable route
-  Plot number
-  Recorded or recently identified archaeological site
-  Listed or historic building

Fig. 2: Location of plot numbers, recorded and newly identified archaeological sites and historic buildings



Fig. 3: Extract from John Norden's manuscript maps of Cornwall, c. 1597. Reproduced in Ravenhill 1972



Fig. 4: Extract from Joel Gascoyne's map of Cornwall, 1699



Fig. 5: Extract from Thomas Martyn's map of Cornwall, 1748



Fig. 6: Extract from Thomas Martyn's map of Cornwall, 1827

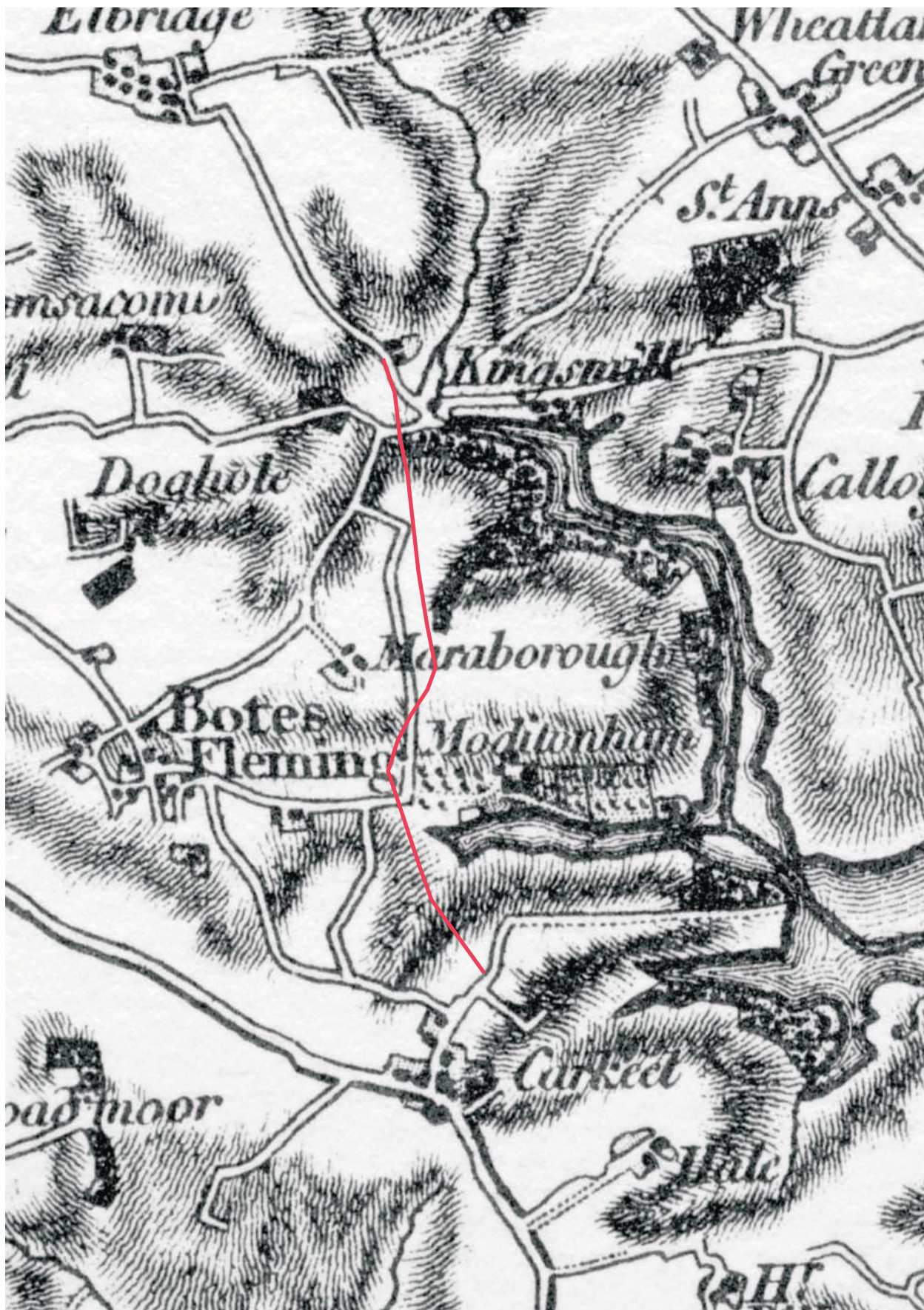

Fig. 7: Extract from the Ordnance Survey one-inch map sheet 25, 1809

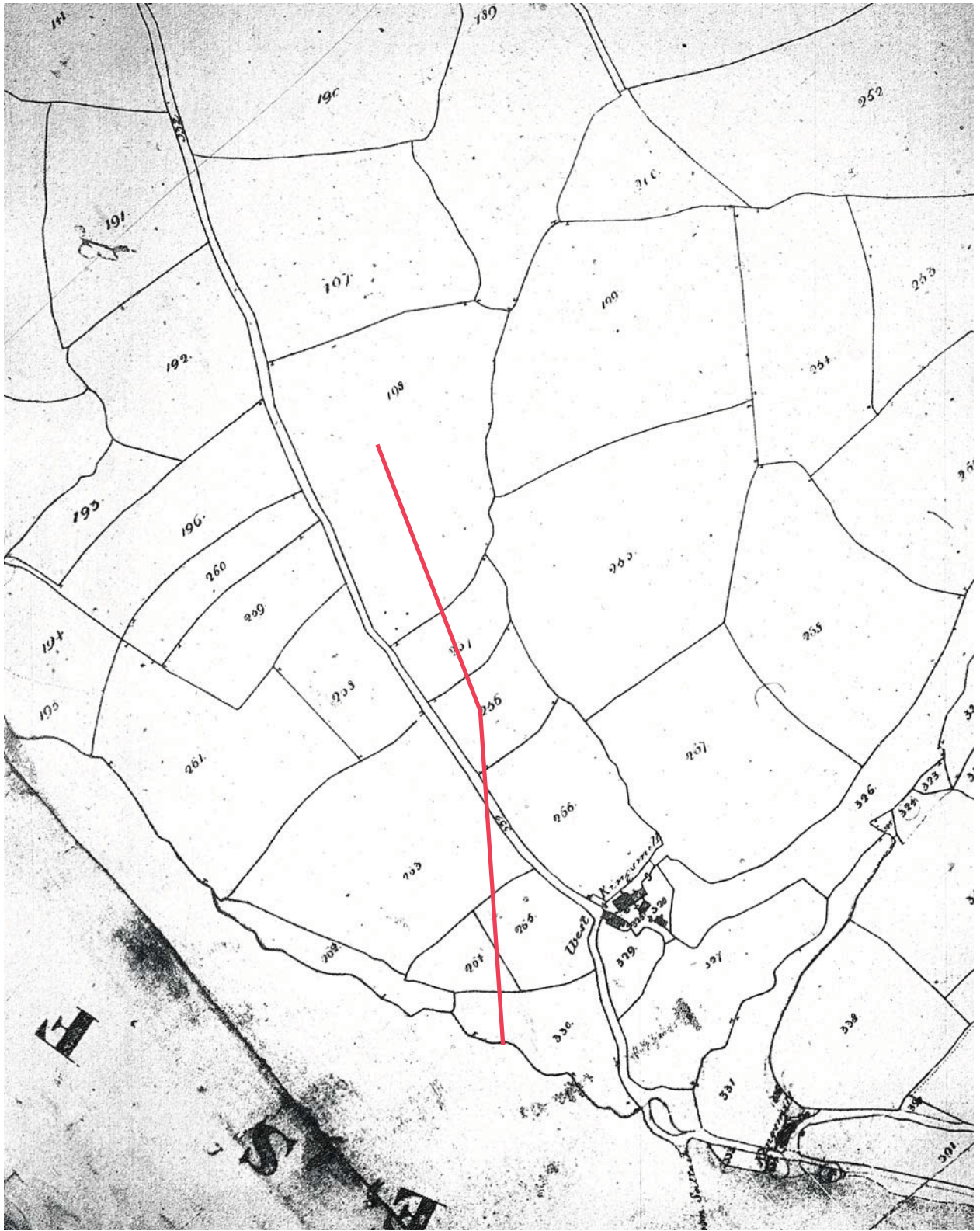

Fig. 8: Extract from the Landulph parish tithe map, 1840s

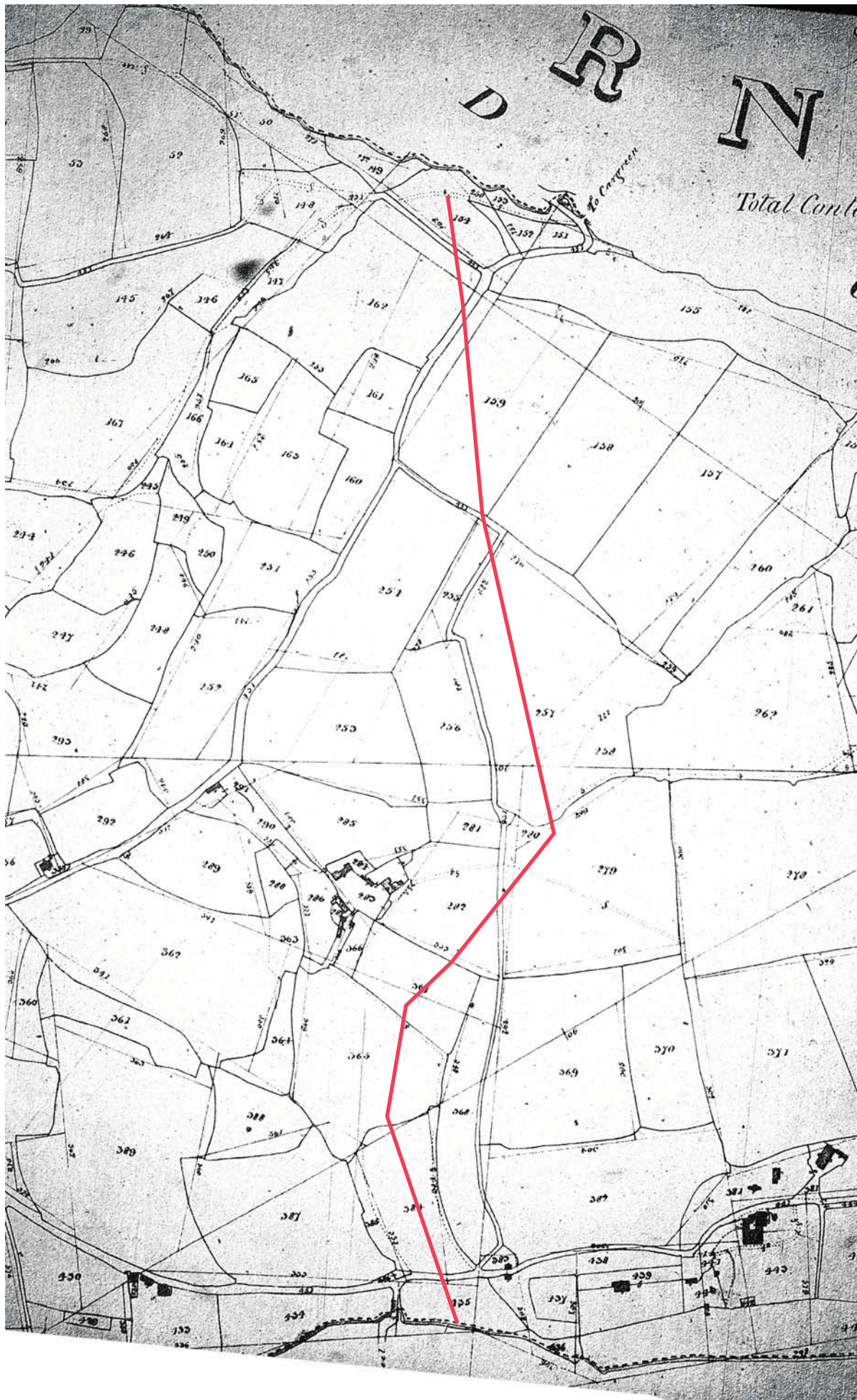

Fig. 9: Extract from the Botus Fleming parish tithe map, 1840s



Fig. 10: Extract from the St Stephen's, Saltash parish tithe map, 1841

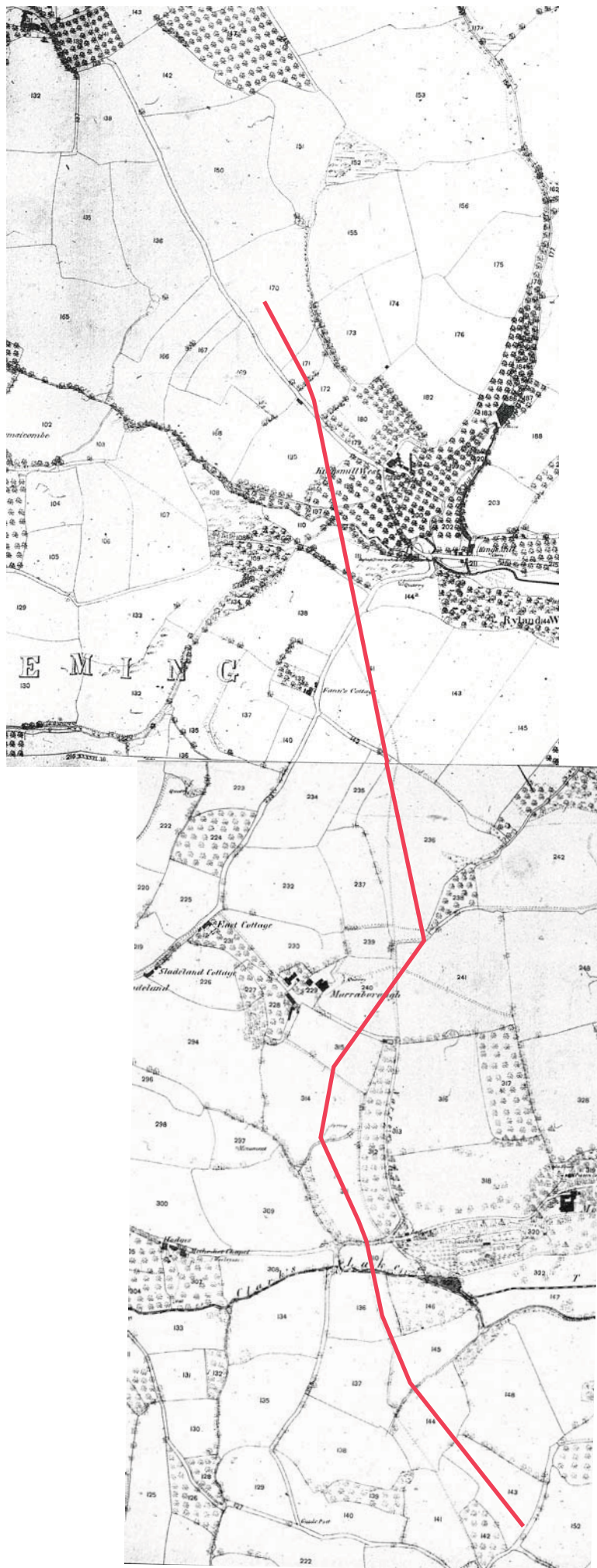

Fig. 11: Reduced extract from the Ordnance Survey first edition 25-inch map, published 1883



Fig. 12: Extract from the Ordnance Survey second edition six-inch map, published 1907

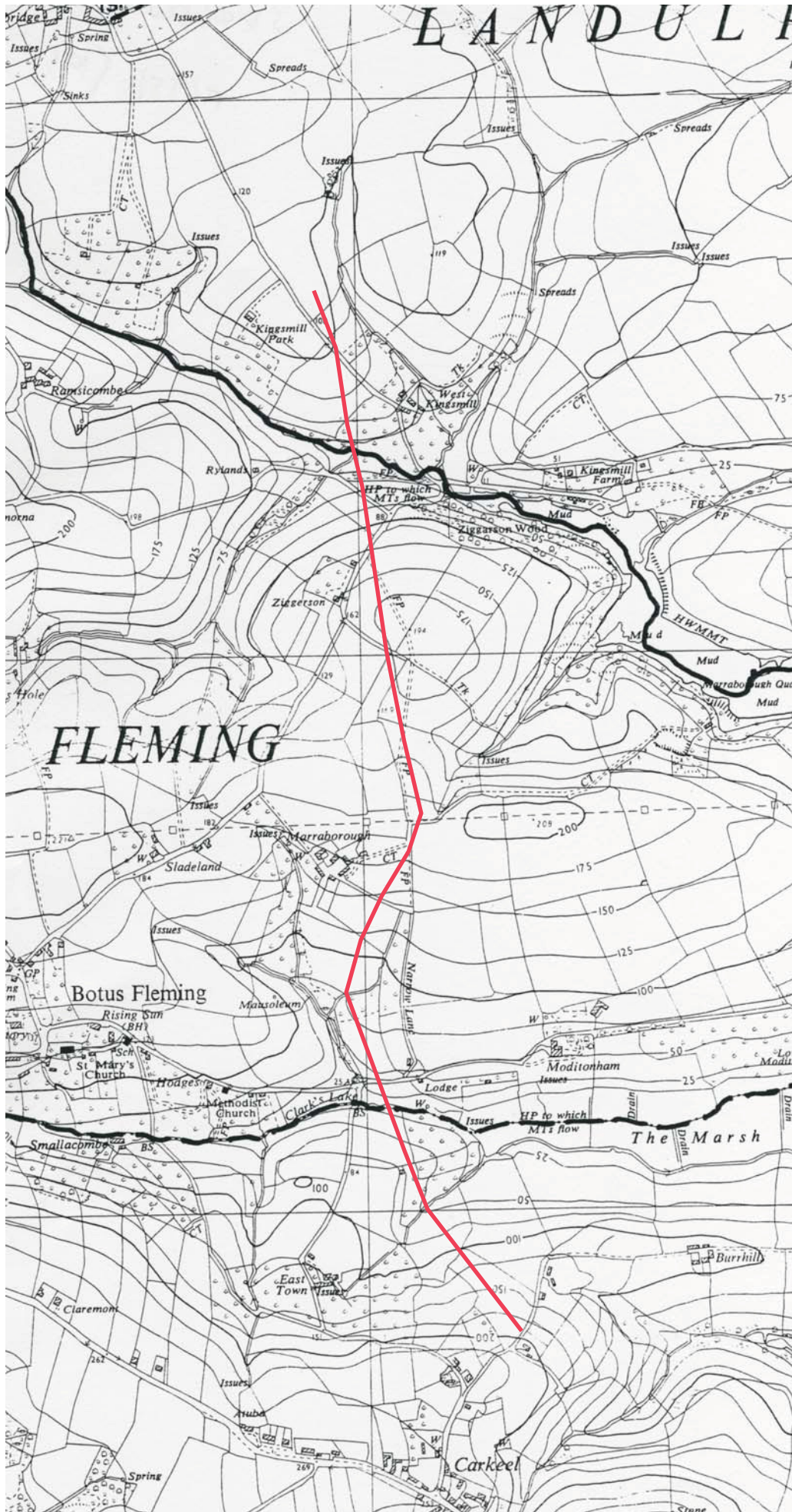

Fig. 13: Extract from the Ordnance Survey six-inch map, published 1954

APPENDIX 1:
CATALOGUE OF PREVIOUSLY RECORDED AND NEW ARCHAEOLOGICAL SITES AND HISTORIC BUILDINGS/STRUCTURES

Site No.	CCHER ref.	NGR	Date	Site Type	Form	Description
A1	60119	SX4090061050	Prehistoric	Findspot	Artefact	A flint core was found.
A2	60120	SX4090061080	Prehistoric	Findspot	Artefact	A number of shattered flint pebbles (probably added to the field by liming) clay pipes, glass and pottery was found in this field that was used as a market garden.
A3	23020.1	SX4134061280	Medieval	Chapel	Documentary	A licence was granted for a chapel at Moditonham in 1308.
A4	60122	SX4138161315	Medieval	Settlement	Documentary	The settlement of Moditonham is first recorded in 1284.
A5	171938	SX4135761346	Medieval	Earthwork	Extant	An area of slight earthworks.
A6	171998	SX4098061634	Post medieval	Horse engine house	Extant	A building platform is all that survives of a horse engine house at Marraborough.
A7	50028	SX4114061636	Undated	Field system	Extant	Two conjoined rectangular enclosures are visible on aerial photographs.
A8	171940	SX4156961836	Post medieval	Quarry	Extant	A field called "Quarry Park" is recorded in the Tithe Award c.1840.
A9	42065	SX4144162258	19th century	Lime kiln	Documentary	A limekiln at Kingsmill Farm.
A10	42087	SX4150062300	19th century	Mine	Site of	Wheal Fortune was operating in the 1850s and it is thought to be somewhere in the locality.
A11	54975	SX4122062320	Post medieval	Corn mill	Documentary	Kingsmill was recorded on the Tithe award of 1841.
A12	60111	SX4116662386	Early medieval	Settlement	Documentary	Kings Mill is recorded in 1018. Kings Mill now forms two sub-settlements.
A13	50024	SX4060062732	Iron Age	Round	Cropmark	Polygonal enclosure appearing as a single cropmark ditch on aerial photographs.
A14	50025	SX4051662783	Undated	Field system	Cropmark	Two conjoined sub-rectangular enclosures appearing as single ditch crop marks on aerial photographs.
A15	-	SX4105860765	Undated	Field name	Documentary	Series of three adjoining fields named on St Stephen's-by-Saltash parish tithe apportionment of 1841 as 'Burrow Hill'.
A16	-	SX4105061600	Undated	Field name	Documentary	Field named on Botus Fleming parish tithe apportionment of c.1840 as 'Barn Field', presumably as it once contained a structure of this type.
A17	-	SX4118561634	Undated	Field name	Documentary	Field named on Botus Fleming parish tithe apportionment of c.1840 as 'Brick Field', perhaps indicating early brick or tile manufacture in this location.
A18	-	SX4110061873	Undated	Field name	Documentary	Two fields named on Botus Fleming parish tithe apportionment of c.1840 as 'Blackhavens', perhaps indicating that evidence for early settlement or industry might be present.

Archaeological sites

APPENDIX 1:
CATALOGUE OF PREVIOUSLY RECORDED AND NEW ARCHAEOLOGICAL SITES AND HISTORIC BUILDINGS/STRUCTURES

Site No.	CCHER ref.	Listed Building ref.	NGR	Status	Date	Site Type	Description
B1	137845	-	SX4074461223	-	19th century	Non-conformist chapel	A Wesleyan chapel survives at Botus Fleming.
B2	171934	-	SX4056561316	-	19th century	School	National School, c1850, enlarged 1910. Recorded on the OS 1st and 2nd Edition 1:2500 1880 and 1907 maps. In 1994 the school was converted to a house.
B3	32155	60769	SX4055561325	Grade II	Medieval	Holy well	The Bidwell. The holy well of St Mary the Virgin at Botus Fleming. Probably 15th century, but repaired in the 20th century.
B4	-	60759	SX407—613--	Grade II	Post medieval	Chest tomb with obelisk	Martyn Monument. A stone monument to William Martyn, died 1762. He preferred to be buried in unconsecrated ground rather than the churchyard. The parish title appointment of c. 1840 names the field as 'Burial Field' presumably because of the presence of the monument.
B5	171937	-	SX4122161209	-	Post medieval	Walled garden	A walled garden located to the south west of Moditonham House.
B6	171936	60761	SX4109761241	Grade II	Late 18th century	Lodge and gate piers	Ornate granite gate piers and a pair of lodges form an impressive entrance into the former Moditonham estate.
B7	23020	60760	SX4134061280	Grade II*	Post medieval	Manor	The present house of Moditonham is a small country house rebuilt in 1760, incorporating fabric from an earlier building on the site.
B8	170056	60755	SX4135261329	Grade II	18th century	Folly	A dovecot and folly at Moditonham, built in the form of an octagonal tower.
B9	54974	-	SX4152962152	-	Post medieval	Quay	A small quay is visible at this location on aerial photographs.
B10	171943	-	SX4145662230	-	Post medieval	Quay	A ruined quay is situated close to a limekiln at Kingsmill.
B11	171942	-	SX4111962327	-	19th century	Bridge	A granite lintel bridge carries the road over a stream south west of West Kingsmill.

Buildings/Structures

APPENDIX 2

Appendix

Fieldname Data derived from tithe apportionments.

Data are presented thus: parcel no.; owner; occupier; fieldname; land use (a = arable, m = meadow, o= orchard, occ = occasionally, p = pasture, w = wood); acreage (acres.rods.perches); farstead or estate.

Botus Fleming

50	Wm Stephens	Wm Stephens	Wood	timber & coppice	1.0.30	B
51	Wm Stephens	Wm Stephens	Wood Park	p	1.0.14	Great Ramsicombe
52	Wm Stephens	Wm Stephens	East Down	a	5.3.28	Great Ramsicombe
145	Wm Symons esq	Jn Budge	Little Butter Bread	a	4.2.24	Dog's Hole
146	Wm Symons esq	Jn Budge	Wood	timber & p	0.2.14	Dog's Hole
147	Wm Symons esq	Jn Budge	Furzely Marsh	p & coppice	0.2.22	Dog's Hole
148	Wm Symons esq	Wm Stephens	Ryland Wood	timber, Coppice & p	1.3.6	Little Ramsicombe
149	Wm Stephens	Wm Stephens	Eighteen Acres	p	0.2.30	Great Ramsicombe
150	Wm Stephens	Wm Stephens	Waste		0.0.4	Great Ramsicombe
151	Wm Stephens	Wm Stephens	Part King's Mill Park	furze	0.1.0	Great Ramsicombe
152	Wm Stephens	Wm Stephens	Part King's Mill Park	a	0.1.26	Great Ramsicombe
153	Wm Stephens	Wm Stephens	Wood	timber, coppice & p	0.1.30	Great Ramsicombe
154	Wm Stephens	Wm Stephens	King's Mill Park	a (occ)	1.1.26	Great Ramsicombe
155	Rev Wm Spry	himself & Wm Spry jun	Zeggardon Wood	oak coppice & timber	6.3.12	glebe
156	Rev Wm Spry	himself & Wm Spry jun	Zeggardon Orchard		0.3.32	glebe
157	Rev Wm Spry	himself & Wm Spry jun	Eastern Zeggardon	a	9.0.5	glebe
158	Rev Wm Spry	himself & Wm Spry jun	Middle Zeggardon	a	7.0.10	glebe
159	Rev Wm Spry	himself & Wm Spry jun	West Zeggardon	a	6.2.34	glebe
160	Chas Carpenter esq	Jn Broad	Crooked Park	a	1.2.24	Marrowborough
161	Nicholas May	Wm Lee	Fan's Field	a	1.0.21	Sladeland
162	Wm Symons esq	Jn Budge	Great Butter Bread	a	6.0.13	Dog's Hole
163	Wm Symons esq	Jn Budge	Furzely Field	a	3.1.3	Dog's Hole
164	Wm Symons esq	Jn Budge	Coppice	timber & coppice	0.3.20	Dog's Hole
165	Wm Symons esq	Jn Budge	Nursery	nursery & coppice	1.0.4	Dog's Hole
166	Wm Symons esq	Jn Budge	Furzely Marsh	p	1.0.8	Dog's Hole
167	Wm Symons esq	Jn Budge	Gratton	a & waste	5.0.5	Dog's Hole
245	Wm Symons esq	Jn Budge	Marsh	coarse p	0.1.0	Dog's Hole
246	Wm Symons esq	Jn Budge	Lower Jericho	a & coppice	1.3.32	Dog's Hole
247	Wm Symons esq	Jn Budge	Higher Jericho	a	1.3.36	Dog's Hole
248	Chas Bertil Symons	Francis Wright	Lower Jericho	a	2.0.12	Dog's Hole
249	Chas Bertil Symons	Francis Wright	Jericho Hill	a	0.2.15	Dog's Hole
250	Chas Bertil Symons	Francis Wright	Coppice	coppice & timber	0.2.5	Dog's Hole
251	Wm Symons esq	Jn Budge	Alder Park	a	2.1.30	Dog's Hole
252	Nicholas May	Wm Spry jun	Sladeland	a & marsh	4.1.12	Sladeland
253	Chas Carpenter esq	Jn Broad	Great Down	a	4.3.5	Marrowborough
254	Rev Wm Spry	himself & Wm Spry jun	Sladeland	a	5.0.13	glebe
255	Chas Carpenter esq	Jn Broad	Little Ziggason	a	0.3.24	Marrowborough
256	Chas Carpenter esq	Jn Broad	Little Down	a	2.3.0	Marrowborough
257	Chas Carpenter esq et al	Jn Broad	Blackhavens	a	7.3.27	Blackhavens
258	Chas Carpenter esq et al	Jn Broad	Coppice	coppice & furze	1.1.10	Blackhavens
259	Rev Wm Spry	himself & Wm Spry jun	Waste		0.0.15	glebe
260	Rev Wm Spry	himself & Wm Spry jun	Zeggardon Coppice	timber & coppice	3.1.18	glebe
261	Chas Carpenter esq	Chas Carpenter esq	Old Orchard coppice	timber & coppice	1.0.10	Marrowborough Woods
262	Chas Carpenter esq	Jn Broad	Old Orchard	a	7.0.8	Marrowborough
278	Chas Carpenter esq	Jn Broad	Higher Gratton	a	10.2.17	Marrowborough
279	Chas Carpenter esq	Jn Broad	Brick Field	a & waste	7.0.17	Marrowborough
280	Chas Carpenter esq	Jn Broad	Waste		0.1.35	Marrowborough
281	Chas Carpenter esq	Jn Broad	Calves Meadow	p	0.3.3	Marrowborough
282	Chas Carpenter esq	Jn Broad	Barn Field	a (occ)	2.3.38	Marrowborough
283	Chas Carpenter esq	Jn Broad	Houses & Yards		1.0.0	Marrowborough
284	Chas Carpenter esq	Jn Broad	Orchard		0.0.26	Marrowborough
285	Chas Carpenter esq	Jn Broad	West Park	a & rd	2.2.36	Marrowborough
286	Chas Carpenter esq	Jn Broad	Orchard		0.3.24	Marrowborough
287	Chas Carpenter esq	Jn Broad	Garden		0.0.8	Marrowborough
288	Nicholas May	Wm Wymond	Jack's Orchard	o	0.1.28	Sladeland
289	Nicholas May	Wm Wymond	Jack's Field	p	2.2.17	Sladeland
290	Chas Carpenter esq	Jos Gadgcombe	Willow Plot	willow garden	0.2.28	East Cottage
291	Chas Carpenter esq	Jos Gadgcombe	House & garden		0.1.10	East Cottage
362	Jane & Johanna Martin	Stephen May	Hollow Park	a	7.2.15	Church Town
363	Jane & Johanna Martin	Stephen May	Timber, Furze & coppice	timber & furze	0.2.7	Church Town
364	Jane & Johanna Martin	Stephen May	Coppice	coppice	0.3.32	Church Town
365	Chas Carpenter esq	Jn Broad	Middle Park	a, coarse p. & rd	5.0.4	Marrowborough
366	Chas Carpenter esq	Jn Broad	Garden		0.1.8	Marrowborough
367	Chas Carpenter esq	Jn Broad	Higher Park	p	2.0.31	Marrowborough

368	Chas Carpenter esq	Jn Broad	Long Orchard		2.2.25	Marrowborough
369	Chas Carpenter esq	Jn Broad	Way Field	a	6.0.4	Marrowborough
370	Chas Carpenter esq	Jn Broad	Cherry Garden		2.3.24	Marrowborough
371	Chas Carpenter esq	Jn Broad	Lower Gratton	a (occ)	6.2.14	Marrowborough
381	Chas Carpenter	Fredk Creswell	Houses, yard & Plantation		1.3.10	Moditonham
382	Chas Carpenter	Fredk Creswell	Ham Park	m & trees	6.0.10	Moditonham
383	Chas Carpenter	Fredk Creswell	Plantation		0.0.23	Moditonham
384	Chas Carpenter esq	Jn Broad	Lower South Park	a	2.2.37	Marrowborough
385	Chas Carpenter esq	Chas Carpenter esq	Coppice	timber & coppice	0.1.28	Marrowborough Woods
386	Chas Carpenter	Fredk Creswell	Plantation		0.0.10	Moditonham
387	Jane & Johanna Martin	Stephen May	East Park	a	5.3.5	Church Town
388	Jane & Johanna Martin	Stephen May	Burial Field	a	1.2.21	Church Town
389	Jane & Johanna Martin	Stephen May	Boat Park	a	9.0.25	Church Town
433	Mary Bennett	herself	Orchard		1.3.16	Hodges
434	Jane & Johanna Martin	Stephen May	Ham Meadow	p	2.0.4	Church Town
435	Chas Carpenter	Fredk Creswell	Lodge Meadow	p	1.0.38	Moditonham
436	Chas Carpenter	Fredk Creswell	Pond		0.1.6	Moditonham
437	Chas Carpenter esq	Fredk Creswell	Garden & Waste		0.2.3	Moditonham
438	Chas Carpenter esq	Fredk Creswell	Pleasure Ground		1.1.4	Moditonham
439	Chas Carpenter esq	Fredk Creswell	Garden		1.1.34	Moditonham
440	Chas Carpenter esq	Fredk Creswell	Pleasure Ground		0.1.12	Moditonham
441	Chas Carpenter esq	Fredk Creswell	House, Yards & Pleasure Ground			1.0.6 Moditonham
442	Chas Carpenter esq	Fredk Creswell	Nursery		0.0.5	Moditonham
443	Chas Carpenter esq	Fredk Creswell	Lawn	p & trees	1.2.7	Moditonham
444	Chas Carpenter esq	Fredk Creswell	Lane		0.0.30	Moditonham
445	Chas Carpenter esq	Fredk Creswell	Old Lawn	a (occ)	2.0.0	Moditonham
446	Chas Carpenter esq	Jn Broad	Marsh	p & trees	5.2.36	Marrowborough

Landulph

191	Wm Wymond	Wm Creber	Home Broad Park	a	2.3.25	Elbridge
192	Wm Wymond	Wm Creber	Lower Churchway Park	a	2.2.30	Elbridge
193	Wm Wymond	Wm Creber	Little South Down	a	0.3.28	Elbridge
194	Wm Nanscawen	Wm Nanscawen	Lower Plumloads	a	1.0.24	Elbridge
195	Wm Nanscawen	Wm Nanscawen	Plumloads Orchard	o	0.2.37	Elbridge
196	Wm Nanscawen	Wm Nanscawen	Higher Plumloads	a	2.0.33	Elbridge
197	Wm Wymond	Wm Creber	Slate Park ?	a	1.1.0	Elbridge
198	Wm Nanscawen	Wm Nanscawen	Great Kingsmill Park	a	5.2.13	Elbridge
199	Catherine Neal	Julius Roberts	Alan Park	a	3.2.10	West Kings Mill
255	Catherine Neal	Julius Roberts	Higher Down	a	3.2.20	West Kings Mill
256	Wm Nanscawen	Wm Nanscawen	Lower Kingsmill Park	a	1.0.0	Elbridge
257	Catherine Neal	Julius Roberts	Kings Mill Park	a	0.3.22	West Kings Mill
258	Wm Nanscawen	Wm Nanscawen	Middle Kingsmill Park	a	1.1.22	Elbridge
259	Wm Nanscawen	Wm Nanscawen	Plumload	a	1.1.32	Elbridge
260	Catherine Neal	Julius Roberts	Bar Field	a	0.3.37	West Kings Mill
261	Catherine Neal	Julius Roberts	Hilly Field	a	3.3.9	West Kings Mill
262	Catherine Neal	Julius Roberts	Coppice	coppice	0.2.36	West Kings Mill
263	Catherine Neal	Julius Roberts	Square Field	a	4.0.32	West Kings Mill
264	Catherine Neal	Julius Roberts	Grandfathers Orchard	p	0.2.3	West Kings Mill
265	Catherine Neal	Julius Roberts	Higher Grandfathers Moor	p	1.0.8	West Kings Mill
266	Catherine Neal	Julius Roberts	Orchard	o	2.1.10	West Kings Mill
267	Catherine Neal	Julius Roberts	Corner Park	a	0.3.37	West Kings Mill
268	Catherine Neal	Julius Roberts	Lower Down	a	1.0.25	West Kings Mill
326	Catherine Neal	Julius Roberts	Hill Orchard	o	2.1.0	West Kings Mill
327	Catherine Neal	Julius Roberts	Lower Meadow	p	2.0.4	West Kings Mill
328	Catherine Neal	Julius Roberts	House & Courtlage	hmstd	0.1.21	West Kings Mill
329	Catherine Neal	Julius Roberts	Little Orchard	o	0.1.29	West Kings Mill
330	Catherine Neal	Julius Roberts	Lower Grandfathers Moor	p	1.1.9	West Kings Mill
331	Duchy of Cornwall & Thos Roberts		Wm See ?	Mill Meadow	p	1.1.12 Kings Mill
332			Rd from Kingsmill to Punters Cross ?			

St Stephen's-by-Saltash

1278	Wm Eales esq	Chas Rundle	Hogshier Meadow	a (occ)	0.2.11	Carkeel
1279	Jn Beer esq	Thos Breen	Carkeel Orchard	o	0.1.38	Burrow Hill
1280	Wm Eales esq	Chas Rundle	Kellaways Meadow	a (occ)	1.2.15	Carkeel
1281	Jn Beer esq	Thos Breen	Carkeel Meadow	a	1.2.16	Burrow Hill
1290	Thos Edwards esq	Thos Batten	Hollow Coombe	a	1.2.39	South Down
1291	Wm Eales esq	Chas Rundle	Furze Park	a	1.0.17	Carkeel
1292	Jn Beer esq	Thos Breen	Horse Land	a	3.3.26	Burrow Hill
1293	Jn Beer esq	Thos Breen	Orchard	o	2.1.8	Burrow Hill
1294	Jn Beer esq	Thos Breen	Toms Field	a (occasionally)	4.1.19	Burrow Hill
1308	Fredk Creswell	Jn Broad	Marsh	p	9.0.12	Burrow Hill
1312	Jn Beer esq	Thos Breen	Great Hill	a	13.1.21	Burrow Hill
1313	Jn Beer esq	Thos Breen	Wood in Great Hill	timber & underwood	0.1.11	Burrow Hill
1314	Wm Eales esq	Chas Rundle	Sheep Park	a	2.2.28	Carkeel
1315	Wm Eales esq	Chas Rundle	New Orchard	o	2.0.24	Carkeel

1316	Wm Eales esq	Chas Rundle	Way Field	a	2.3.1	Carkeel
1317	Wm Eales esq	Chas Rundle	Barn Park	a	3.1.11	Carkeel
1318	Wm Eales esq	Chas Rundle	Wood Redland	a	3.1.10	Carkeel
1319	Wm Eales esq	Chas Rundle	Nursery	nursery	0.0.20	Carkeel
1320	Wm Eales esq	Chas Rundle	Wood	timber underwood	1.2.31	Carkeel
1321	Wm Eales esq	Chas Rundle	Lower Landulph Park	a	3.1.21	Carkeel
1322	Thos Edwards esq	Thos Batten	Thorn Park	a	2.0.4	South Down
1323	Wm Eales esq	Chas Rundle	Potatoe Garden Orchard	o	1.0.4	Carkeel
1324	Wm Eales esq	Chas Rundle	Higher Landulph Park	a	3.3.17	Carkeel
1325	Wm Eales esq	Chas Rundle	Higher Orchard	o	1.0.30	Carkeel
1326	Wm Eales esq	Chas Rundle	Burrow Hill	a	2.2.1	Carkeel
1327	Maria Edwards	Hen Batten	Burrow Hill	a	5.0.13	Carkeel
1328	Jn Beer esq	Thos Breen	Burrow ? Hill	a	3.0.26	Burrow Hill
1329	Jn Beer esq	Thos Breen	Quarry in do	stone quarry	0.0.22	Burrow Hill
1330	Jn Saunders Bowden	Wm Hore	Garden	g	0.0.29	Carkeel
1331	Maria Edwards	Hen Batten	Orchard	o	0.1.20	Carkeel
1332	Wm Eales esq	Chas Rundle	Long Meadow	a	0.1.37	Carkeel
1333	Jn Saunders Bowden	Wm Hore	House & Garden	h&g	0.3.18	Carkeel
1508	Fredk Creswell	Geo Pool	Higher Hedges Orchard	a	2.2.16	Hodges
1509	Wm Eales esq	Chas Rundle	Great Redland	a	4.0.29	Carkeel
1510	Wm Eales esq	Chas Rundle	Harris's Park	a	3.2.8	Carkeel
1511	Wm Eales esq	Chas Rundle	Brake Orchard	o & timber	0.2.21	Carkeel

NATIONAL
MONUMENTS
RECORD

ENGLISH HERITAGE : NATIONAL MONUMENTS RECORD

Appendix 3: Air Photographs consulted

Sortie number	Library number	Camera position	First frame	Last frame	Total frames per line	First frame (centre point)	Last frame (centre point)	Date	Scale 1:	Film details (in inches)
RAF/CPE/UJK/1890	543	FS	2322	2324	3	SX 414 624	SX 402 623	10 DEC 1946	9840	Black and White 8.25 x 7.5
RAF/CPE/UJK/2105	651	RS	4176	4176	1	SX 419 601	SX 419 601	28 MAY 1947	10000	Black and White 8.25 x
RAF/CPE/UJK/2149	673	RS	4088	4090	3	SX 406 626	SX 418 624	11 JUN 1947	9800	Black and White 8.25 x
RAF/540/483	1156	RP	3333	3334	2	SX 408 618	SX 415 618	24 APR 1951	10500	Black and White 8.25 x
RAF/540/483	1156	RS	4476	4478	3	SX 418 604	SX 404 604	24 APR 1951	10500	Black and White 8.25 x
RAF/540/493	1161	RS	4026	4027	2	SX 418 613	SX 411 613	12 MAY 1951	9960	Black and White 8.25 x
RAF/540/518	1182	RP	3273	3274	2	SX 407 622	SX 413 622	04 JUN 1951	10000	Black and White 8.25 x
RAF/540/518	1182	RS	4273	4275	3	SX 406 603	SX 418 603	04 JUN 1951	10000	Black and White 8.25 x
RAF/58/2775	1903	F21	92	93	2	SX 408 615	SX 414 615	30 APR 1959	10000	Black and White 8.25 x
RAF/58/5095	2070	F21	20	21	2	SX 412 601	SX 403 602	01 MAY 1962	10000	Black and White 9.0 x 9.0
RAF/58/5095	2070	F21	30	31	2	SX 409 599	SX 418 599	01 MAY 1962	10000	Black and White 9.0 x 9.0
RAF/58/5095	2070	F22	20	21	2	SX 414 620	SX 405 621	01 MAY 1962	10000	Black and White 9.0 x 9.0
RAF/58/5159	2088	F21	275	276	2	SX 418 622	SX 406 621	04 JUN 1962	10000	Black and White 8.25 x
RAF/58/5210	2089	V	40	41	2	SX 412 628	SX 404 629	25 JUN 1962	11000	Black and White 9.0 x 9.0
MAL/68040	5291	V	105	106	2	SX 415 609	SX 418 609	09 JUN 1968	3000	Black and White 9.0 x 9.0
MAL/68040	5291	V	114	115	2	SX 415 604	SX 418 604	09 JUN 1968	3000	Black and White 9.0 x 9.0
MAL/71005	5831	V	56	58	3	SX 414 605	SX 414 610	04 FEB 1971	3000	Black and White 9.0 x 9.0
RAF/58/6399	8079	F61	71	72	2	SX 413 618	SX 407 615	02 JUL 1964	10000	Black and White 8.25 x
RAF/58/6399	8079	F61	360	361	2	SX 406 630	SX 411 633	02 JUL 1964	10000	Black and White 8.25 x
RAF/58/6399	8079	F62	360	361	2	SX 414 608	SX 419 611	02 JUL 1964	10000	Black and White 8.25 x
RCUJ/CS/820502	9005B	V	2625	2626	2	SX 416 603	SX 414 606	02 MAY 1982	3000	Black and White 9.0 x 9.0
OS/84234	12661	V	160	162	3	SX 412 629	SX 412 608	13 APR 1984	5000	Black and White 9.0 x 9.0
OS/90094	13695	V	5	7	3	SX 420 607	SX 412 601	12 MAY 1990	5100	Black and White 9.0 x 9.0
OS/92108	15419	V	201	202	2	SX 414 604	SX 407 605	16 MAY 1992	8200	Black and White 9.0 x 9.0
OS/92108	15419	V	213	214	2	SX 408 618	SX 414 618	16 MAY 1992	8200	Black and White 9.0 x 9.0
OS/69081	20106	V	50	50	1	SX 414 637	SX 414 637	07 APR 1969	15000	Black and White 9.0 x 9.0
OS/69081	20106	V	61	61	1	SX 415 638	SX 415 638	07 APR 1969	15000	Black and White 9.0 x 9.0

Enquiry ref: 34658 - © English Heritage. NMIR



ENGLISH HERITAGE : NATIONAL MONUMENTS RECORD

Appendix 3: Air Photographs consulted

OS/69081	20106	V	74	74	1	SX 415 609	SX 415 609	07 APR 1969	15000	Black and White 9.0 x 9.0
OS/92109	20917	V	97	98	2	SX 414 627	SX 409 627	16 MAY 1992	8200	Black and White 9.0 x 9.0
MAL/62545	21166	V	103680	103680	2	SX 405 629	SX 411 631	29 SEP 1962	6000	Black and White 9.0 x 9.0
MAL/62542	21167	V	103152	103152	1	SX 417 623	SX 417 623	13 SEP 1962	12000	Black and White 9.0 x 9.0
MAL/62537	21177	V	102156	102156	1	SX 409 617	SX 409 617	24 JUL 1962	12000	Black and White 9.0 x 9.0
MAL/62536	21178	V	101916	101917	2	SX 411 624	SX 406 622	24 JUL 1962	5500	Black and White 9.0 x 9.0
MAL/62536	21178	V	101940	101942	3	SX 410 632	SX 400 627	24 JUL 1962	5500	Black and White 9.0 x 9.0
									Total sorties	23
									Total images	70

Wiltshire Office

AC archaeology Ltd
Manor Farm Stables
Chicklade
Hindon
Nr Salisbury
Wiltshire
SP3 5SU

Telephone: 01747 820581
Fax: 01747 820440

Devon Office

AC archaeology Ltd
Unit 4, Halthaies Workshops
Bradninch
Nr Exeter
Devon
EX5 4LQ

Telephone/Fax: 01392 882410

www.acarchaeology.co.uk