

Energy from Waste Plant, Grace Road South, Marsh Barton, Exeter

NGR SX 2926 0905

Results of an archaeological watching brief

Prepared by Kerry Kerr-Peterson

On behalf of AMEC

Document No: ACD407/2/0

Date: September 2012

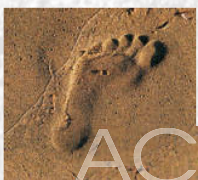

AC archaeology

Devon County Council Historic Environment Record

Civil Parish & District: Alphington, Exeter	National Grid Reference SX 2926 0905	Number: (Leave blank for HES to fill in)
Subject: Results of an archaeological watching brief at Energy from Waste Plant, Grace Road South, Marsh Barton, Exeter		Photo attached? N
Planning Application no: 07/0927/25	Recipient museum: Royal Albert Memorial Museum, Exeter	
OASIS ID: 128403	Museum Accession no: RAMM 109/2010	
Contractor's reference number/code: ACD407	Dates fieldwork undertaken: 11/06/2012 – 12/06/2012	
<p>An archaeological watching brief was undertaken by AC archaeology during the groundworks associated with the construction of a new energy from waste (EFW) plant at Grace Road South, Marsh Barton, Exeter (NGR SX 292620 90500; Fig. 1). The archaeological monitoring was required by Devon County Council as a condition of planning permission as advised by Devon County Council's Historic Environment Service (HES).</p> <p>The site covers an area of approximately 1 hectare and lies at 5m OD. It is located on Grace Road South within the Marsh Barton Industrial Estate, on the site of a former refuse incinerator.</p> <p>The site is situated on the floodplain of the River Exe, the overlying geology of which is Quaternary alluvium deposits. Previous developments on the floodplain of the River Exe have revealed palaeochannels – ancient river channels that have the potential to preserve organic remains.</p> <p>The monitoring was carried out in the area of the site that had the most potential for palaeoenvironmental evidence; this was the excavation of the main bunker located in the centre of the site that covered an area measuring 15m long by 10m wide. The rest of the groundworks did not go below modern make-up that had been deposited across the site when the refuse incinerator had been demolished. This modern make-up was between 1.5m–2m in depth. The sequence of deposits that were exposed within the bunker excavation consisted of modern make-up to a depth of 2m. Below this, a 1m thick layer of natural dark reddish-brown, compact, sand-clay was exposed. Directly below this were deposits of water-deposited gravel, silts and clay that were monitored to a depth of 4m from the surface. There were no palaeoenvironmental or archaeological features or deposits present, and no finds were recovered.</p>		
<p>A plan as well as any other relevant drawings must be attached showing the location and extent of site, areas investigated and features exposed.</p>		
Recorder: Kerry Kerr-Peterson, AC archaeology	Date sent to HER: 18 September 2012	

Please email completed form to: archaeol@devon.gov.uk or post to County Archaeology Service, Environment Directorate, Matford Lane Offices, County Hall, Topsham Road, Exeter EX2 4QW. Information recorded on this form will be added to the Historic Environment Record, and made available to all researchers. Any plans or photographs embedded within or attached to this form remain the copyright © of the recorder, and must not be reproduced in any publication without the explicit consent of the copyright holder.

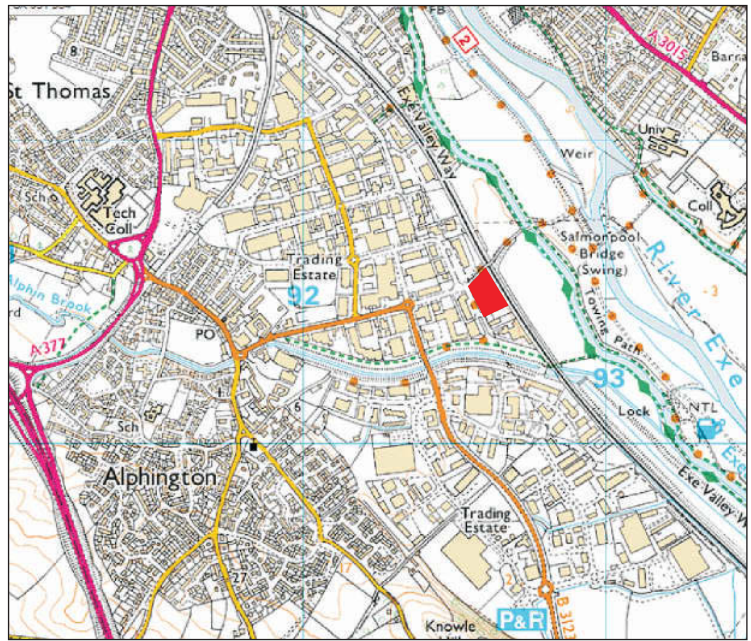

Reproduced from the Ordnance Survey mapping with the permission of the Controller of Her Majesty's Stationery Office © Crown Copyright AC archaeology, Chicklade, Wiltshire. Licence No AL100016452



SX

92

93

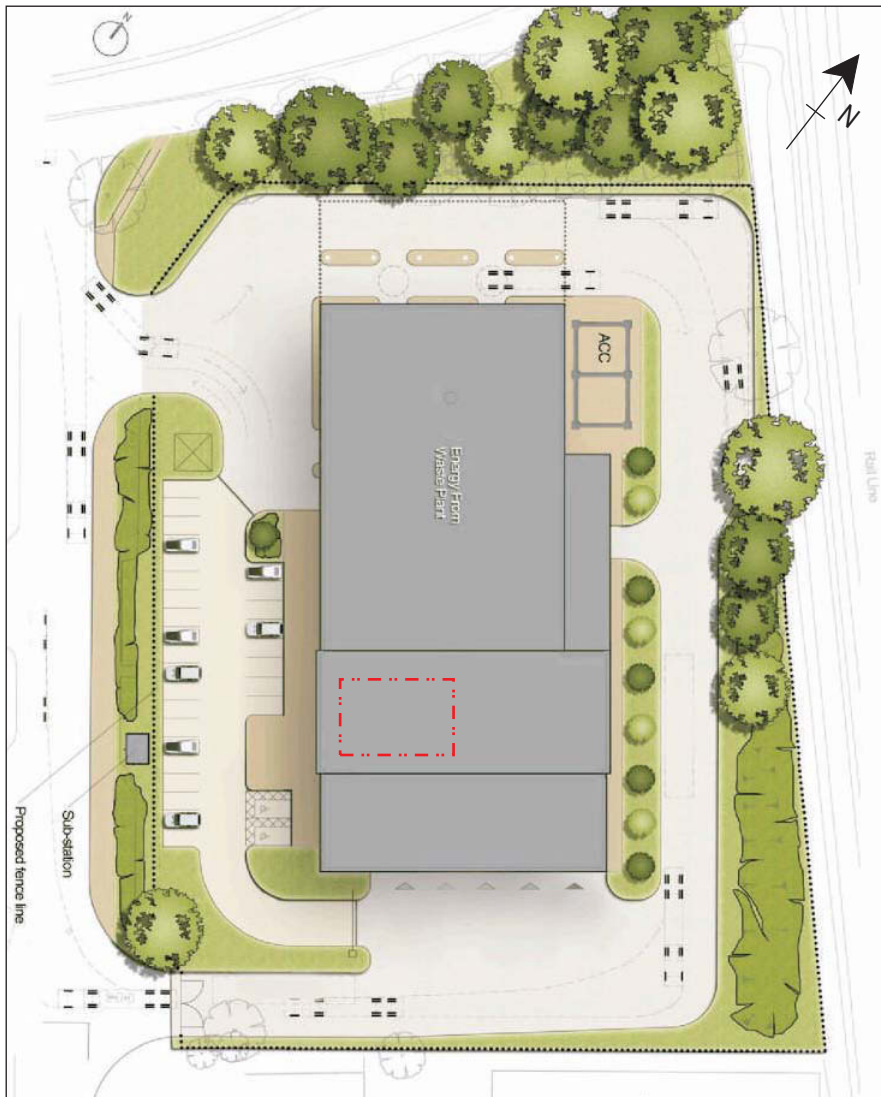

0 50m

 Area monitored

PROJECT

Grace Road South, Marsh Barton, Exeter

TITLE

Fig. 1: Location of monitored groundworks



Plan supplied by client

Devon Office

AC archaeology Ltd
Unit 4, Halthaies Workshops
Bradninch
Nr Exeter
Devon
EX5 4LQ

Telephone/Fax: 01392 882410

Wiltshire Office

AC archaeology Ltd
Manor Farm Stables
Chicklade
Hindon
Nr Salisbury
Wiltshire
SP3 5SU

Telephone: 01747 820581
Fax: 01747 820440

www.acarchaeology.co.uk