

JUNCTION OF TOPSHAM ROAD AND SOUTHBROOK ROAD, EXETER

(NGR SX 94287 90404)

Results of an archaeological watching brief

Prepared by:
Andrew Passmore BSc MIfA

On behalf of:
Devon County Council

Document No: ACD965/2/1

Date: October 2014

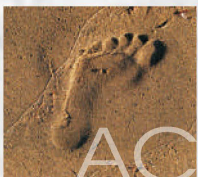

AC archaeology

Devon County Council Historic Environment Record

Civil Parish & District: Exeter	National Grid Reference SX 94287 90404	Number:
Subject: Junction of Topsham Road and Southbrook Road, Exeter: Results of an archaeological watching brief		Photo attached? Yes
Planning Ref no: N/A	Recipient museum: N/A	
OASIS ID: 194557	Museum Accession no: N/A	
Contractor's reference number/code: ACD965	Dates fieldwork undertaken: 01/08/2014 – 11/08/2014	
<p>Introduction (Fig. 1) A watching brief was carried out during widening of the exit from Southbrook Road onto Topsham Road the realignment of the adjacent footpaths as well as replacement of the existing pedestrian crossing with two 'Toucan' crossings. Topsham Road follows the alignment of the Roman Road from the Fortress and later town at Exeter to Topsham. Southbrook Road is a 1950s and 1960s housing development located on the north side of Countess Wear; the road itself has origins as a late 19th-/early 20-century track serving fields north of Topsham Road.</p> <p>Results (Fig. 2) A total of three test pits (1-3) were excavated within the pavement adjacent to Topsham Road to locate services. Natural river terrace sand and gravels were exposed at a depth of 500mm below the surface. Within the pavement the natural was overlain by numerous service pipes were present aligned parallel to Topsham Road, and extending below the top of the natural (Plate 1). The overlying deposits comprised backfill of the service trenches and concrete for the kerbs sealed the tarmac surface. Under the adjacent grass the natural was overlain by a 400mm thick light grey-red gravelly silty clay landscaping deposit sealed with 100mm dark brown stony sandy loam turf and topsoil (Plate 2).</p> <p>A fourth test pit was excavated adjacent to the service road on the north side of Southbrook Road. The natural was exposed at a depth of 500mm from the surface overlain by 300mm of orange-brown hard silty clay and 200mm of topsoil.</p> <p>On the north side of Southbrook Road the pavement was widened to a maximum width of 2.70m. No archaeological deposits were exposed, with a modern levelling deposit of gravel being present that continued under the adjacent grass.</p> <p>On the south side of Southbrook Road the western half of the modern bank on the grass was removed (Plate 3). It is 1m high and consists of dumps of gravels and sand retained by three courses of breccia walling. Ground reduction below the bank and towards the road junction was generally shallow, up to 400mm deep, exposing modern levelling deposits of light orange-brown silty clay containing gravel, charcoal and tarmac fragments. In addition to the service trenches along Topsham Road, this area was heavily disturbed by existing services associated with the late 20th-century traffic lights at the junction. Where deeper excavations were carried out, natural was exposed at a depth of 650mm from the surface.</p> <p>Comments No archaeological deposits or features were exposed and no finds were recovered. In general, the works were carried out within areas of existing 20th-century landscaping, and the deeper excavations demonstrated that there was extensive truncation by services, particularly below the pavement where major services have been routed alongside the highway.</p> <p>This report and the associated OASIS entry represent the archive for the project.</p>		
Recorder: Will Smith (AC archaeology)		Date sent to HER: 21 October 2014

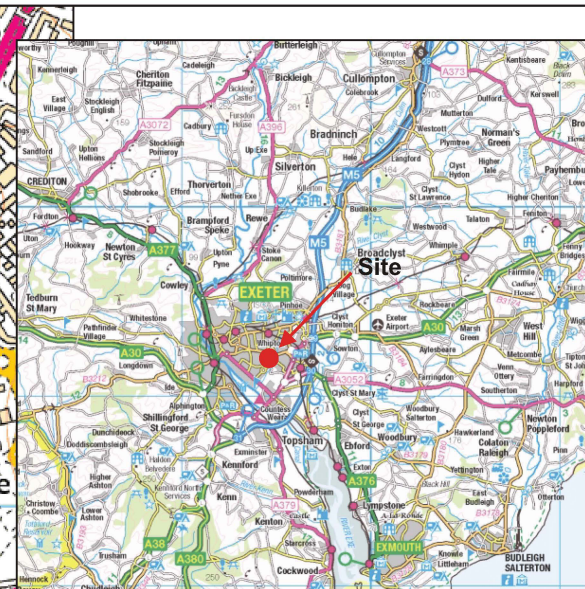

Ordnance Survey © Crown
 Copyright 2014. All rights reserved.
 Licence number 100022432



PROJECT
 Junction of Topsham Road
 and Southbrook Road,
 Exeter

TITLE
 Fig. 1: Location of site

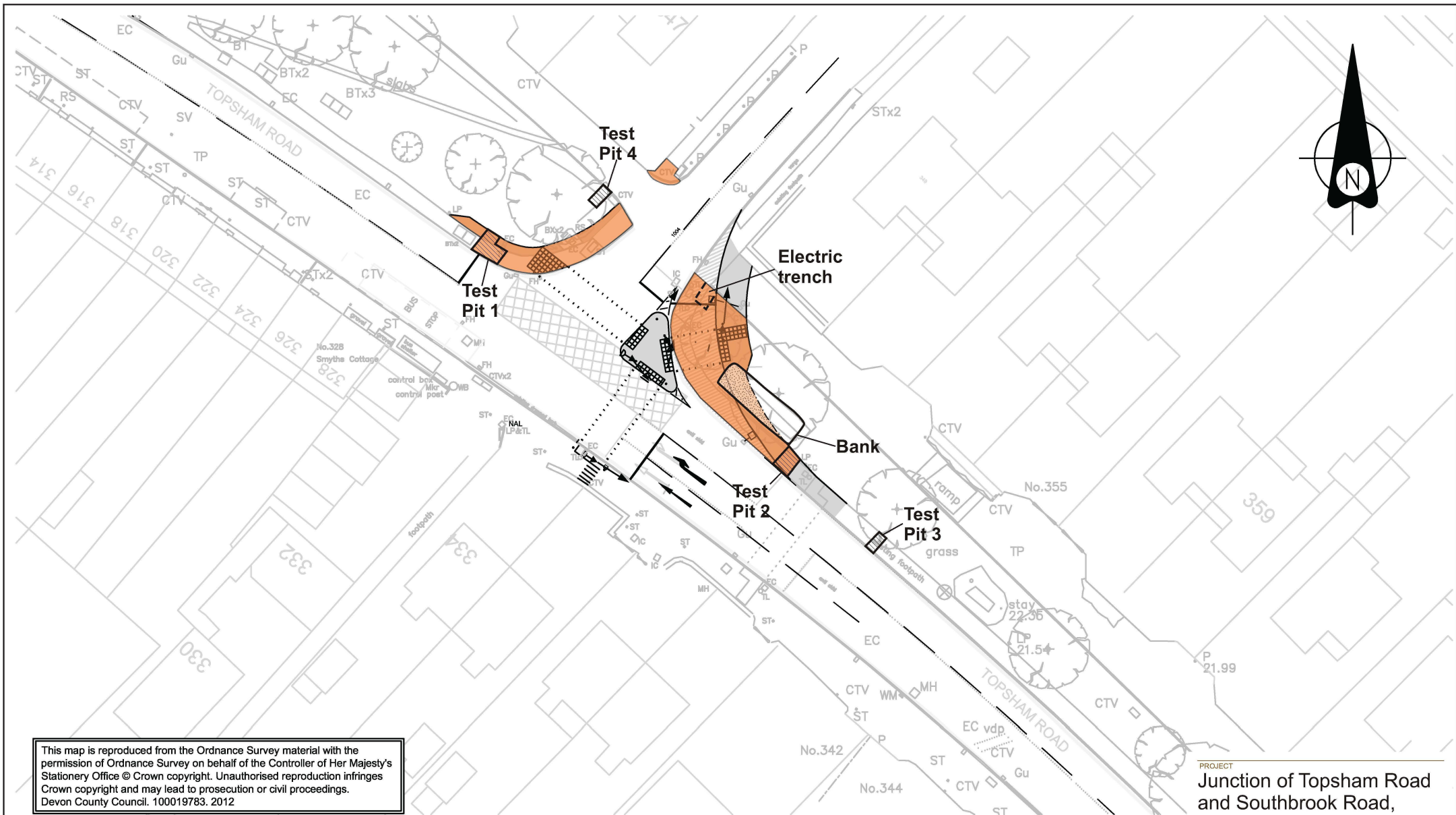



This map is reproduced from the Ordnance Survey material with the permission of Ordnance Survey on behalf of the Controller of Her Majesty's Stationery Office © Crown copyright. Unauthorised reproduction infringes Crown copyright and may lead to prosecution or civil proceedings. Devon County Council. 100019783. 2012

-  Observed excavations
-  Removed section of bank



PROJECT
Junction of Topsham Road and Southbrook Road, Exeter
 TITLE
Fig. 2: Location of monitored areas





Plate 1: Test pit 1, looking southeast. 2m scale



Plate 2: Test pit 1 showing extension into the grass, looking northeast. 1m scale



Plate 3: General view of south side of Southbrook Road showing removed bank, looking east. 2m scale

Devon Office

AC archaeology Ltd
Unit 4, Halthaies Workshops
Bradninch
Nr Exeter
Devon
EX5 4LQ

Telephone/Fax: 01392 882410

Wiltshire Office

AC archaeology Ltd
Manor Farm Stables
Chicklade
Hindon
Nr Salisbury
Wiltshire
SP3 5SU

Telephone: 01747 820581
Fax: 01747 820440

www.acarchaeology.co.uk