

CANONSLEIGH BARTON FARMHOUSE, BURLESCOMBE, TIVERTON, DEVON

NGR ST 06690 17368

Results of Archaeological Monitoring and Recording

Mid Devon District Council Planning Reference:
15/01310/FULL (Condition 3)

Prepared by:
Abigail Brown

On behalf of:
Mrs Hawkings

Report No: ACD1257/2/0

Date: March 2016

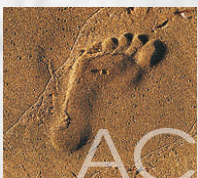

archaeology

Devon County Council Historic Environment Record

Civil Parish & District: Burlescombe, Mid Devon	National Grid Reference ST 06690 17368	Number:
Subject: Canonsleigh Barton Farmhouse, Burlescombe, Tiverton, Devon: Results of archaeological monitoring and recording		Photo attached? Yes
Planning Application no: 15/01310/FULL	Recipient museum: N/A	
OASIS ID: 242348	Museum Accession no: N/A	
Contractor's reference number/code: ACD1257	Dates fieldwork undertaken: 13 th January 2016	
<p>Introduction (Fig. 1) Archaeological monitoring and recording was carried out by AC archaeology during groundworks associated with the construction of an extension to Canonsleigh Barton Farmhouse, Burlescombe, Devon (ST 06690 17368).</p> <p>Canonsleigh is the site of an Augustinian Abbey founded in the 12th century. Surviving structures of the abbey consist of Grade I-listed 15th century gatehouse, and the Scheduled and Grade II-listed remains of a 14th to 15th-century probable <i>rere-dortar</i> or latrine block. Canonsleigh Barton Farmhouse lies within the former abbey precinct and is a Grade II-listed early 17th century four-roomed house (Heritage List for England no. 1106456).</p> <p>Description of Works The groundworks comprised the excavations of footings for the extension footprint (Fig. 1 and Plate 1). An area measuring 7m by 4m was machine-excavated to a depth of approximately 0.5m below existing levels, with footings trenches measuring 0.6m wide dug around the perimeter to a total depth of 1.2m.</p> <p>The excavations exposed a simple sequence of a 0.3m thick dark brown clayey-loam topsoil overlying a mid brownish-red sandy-clay natural subsoil (Plate 2).</p> <p>Comment No archaeological features or deposits were exposed and no finds were recovered during the course of the monitored groundworks.</p>		
Recorder: Abigail Brown, AC archaeology		Date sent to HER:

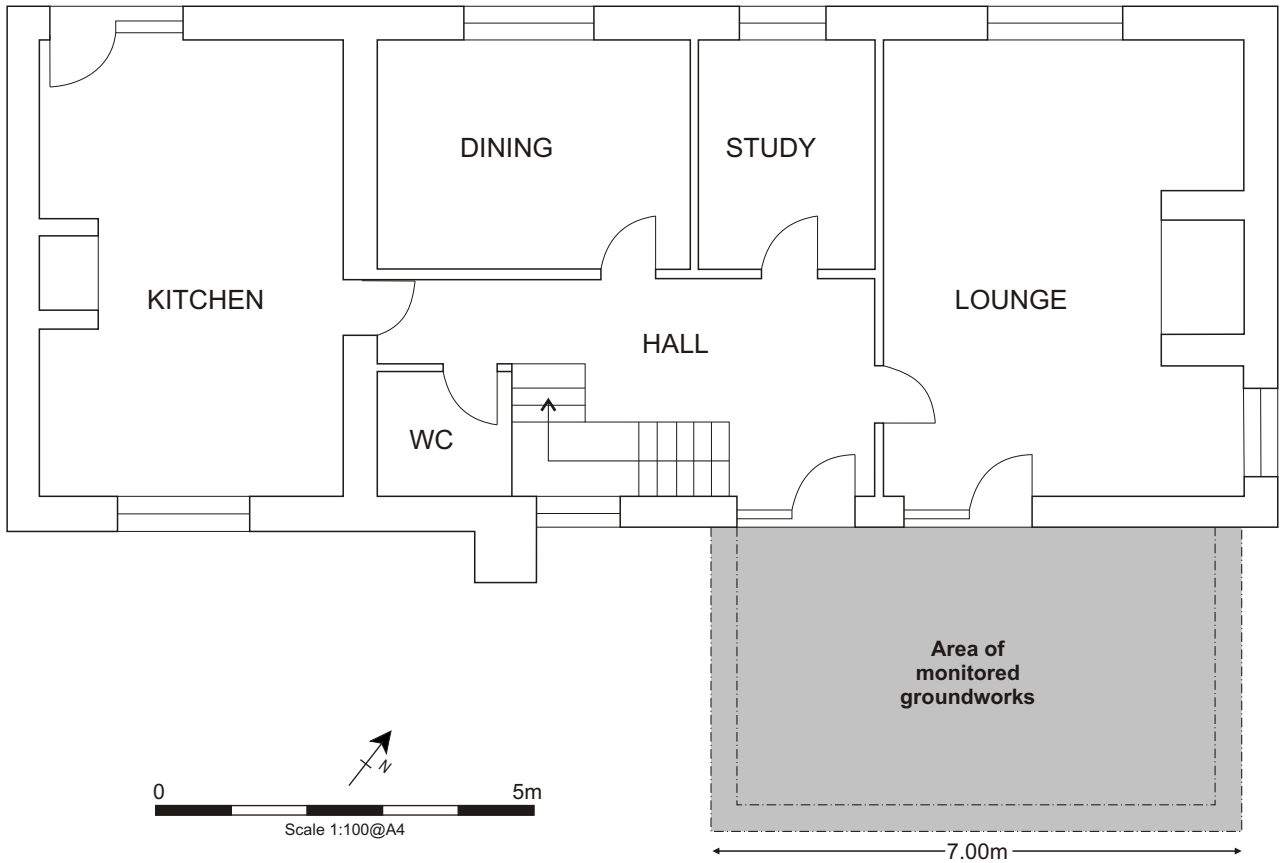
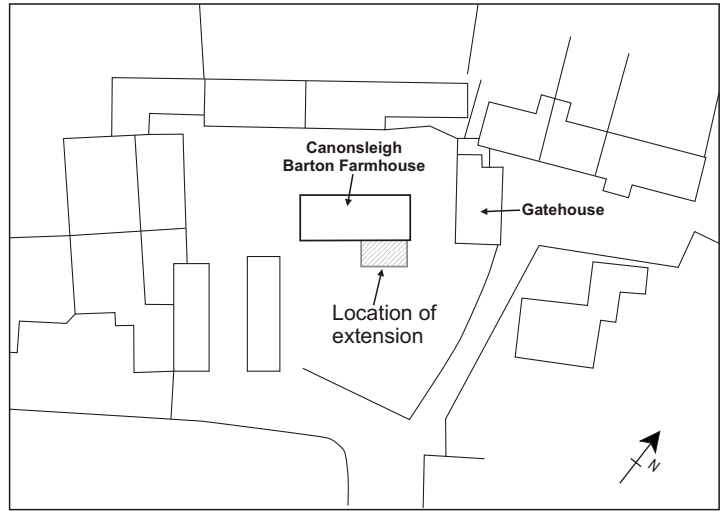
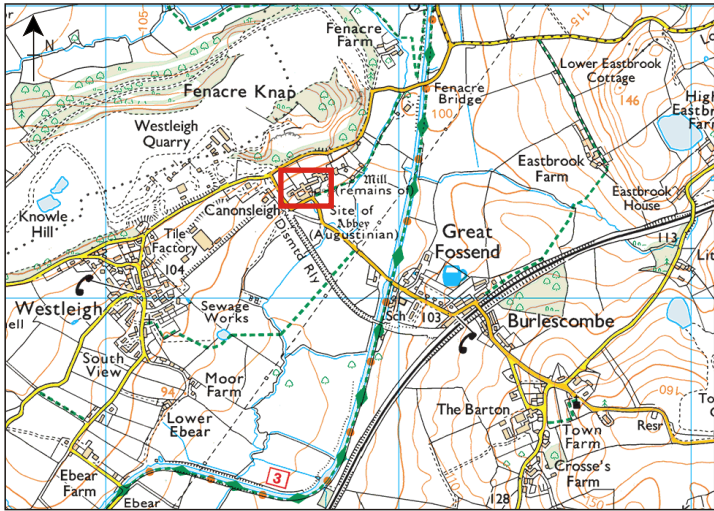

PROJECT

Canonsleigh Barton Farmhouse, Burlescombe, Devon

TITLE

Fig. 1: Location of site with monitored groundworks shown





Plate 1: General view of site with the Gatehouse in the background. Looking north (scale 1m)



Plate 2: Post-excitation view of foundation trenches, view to southwest (scale 1m)

Devon Office

AC archaeology Ltd
Unit 4, Halthaies Workshops
Bradninch
Nr Exeter
Devon
EX5 4LQ

Telephone/Fax: 01392 882410

Wiltshire Office

AC archaeology Ltd
Manor Farm Stables
Chicklade
Hindon
Nr Salisbury
Wiltshire
SP3 5SU

Telephone: 01747 820581

Fax: 01747 820440

www.acarchaeology.co.uk