

PIER HEAD, MAMHEAD VIEW, EXMOUTH, DEVON

(NGR SX 99407 80634)

Results of an archaeological watching brief

East Devon District Council planning reference 12/2163/MFUL

Prepared by:
Stella De-Villiers MA

On behalf of:
Eagle One Homes

Document No: ACD737/2/0

Date: September 2016

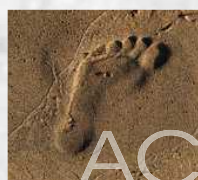

AC archaeology

Devon County Council Historic Environment Record

Civil Parish & District: Exmouth, East Devon	National Grid Reference SX 99407 80634	Number: (Leave blank for HES to fill in)
Subject: Pier Head, Mamhead View, Exmouth, Devon: Results of an archaeological watching brief.		Photo attached? Y
Planning Application no: 12/2163/MFUL	Recipient museum: N/A	
OASIS ID: 262327	Museum Accession no: N/A	
Contractor's reference number/code: ACD737	Dates fieldwork undertaken: 17 December 2014	
<p>Introduction (Fig. 1; plates 1-2) An archaeological watching brief was carried out by AC Archaeology during the excavation of test pits in advance of the main phase of construction at Pier Head, Mamhead View, Exmouth.</p> <p>The site is situated within the area of the former Exmouth Docks, now a marina surrounded by housing. The docks were constructed on a sand spit extending out into the Exe Estuary and opened in 1868. They were connected to the rail network via sidings from Exmouth Station (which opened in 1861). The 1888-9 1:500 Ordnance Survey town plan depicts the site as wharfs, open to the sea, but with a pier extending out over the foreshore adjacent to the dock entrance. Railway sidings led to the end of the pier. At the end of Mamhead View was a Custom House with integral boathouse.</p> <p>Description of Works (Fig. 1; Plates 3-5) The monitored groundworks consisted of the excavation of six test pits located adjacent to neighbouring modern buildings and associated walls to investigate the depths of foundations.</p> <p>Test pit 1 measured 1 x 1.10m and was excavated to a depth of 0.40m. This exposed a single modern made ground deposit (103) which consisted of a mixed light yellow-brown to dark black-brown sandy-silt with common modern rubble, brick, concrete and plastic inclusions.</p> <p>Test pit 2 measured 1.10 x 1.10m and was excavated to a depth of 0.50m. This exposed deposit (103) as seen in test pit 1.</p> <p>Test pit 3 measured 0.50 x 0.60m and was excavated to a depth of 1.10m. This exposed three deposits (100-102). The modern tarmac car park surface (100) measured 0.10m deep. Below this was 101, a made ground deposit consisting of a 0.60m deep dark black-brown sandy-silt with rare sub-rounded stones up to 50mm. The lower deposit (102) was another made ground layer consisting of a 0.50m deep light yellow sand with rare sub-rounded stones up to 40mm.</p> <p>Test pit 4 measured 0.80 x 1.30m and was excavated to a depth of 0.38m. Test pit 5 measured 1.10 x 1.10m and was excavated to a depth of 0.38m. Test pit 6 measured 0.60 x 0.80m and was excavated to a depth of 0.40m. In these three trenches no deposits were exposed, with the modern tarmac car park surface (100) overlying its associated hardcore make-up (104).</p> <p>Comments No archaeological deposits or features were exposed in any of the test pits, with entirely modern levelling deposits being present at shallow depths.</p> <p>This report and the associated OASIS entry represent the archive for the project.</p>		
Recorder: Stella De-Villiers, AC Archaeology	Date sent to HER: 12 September 2016	

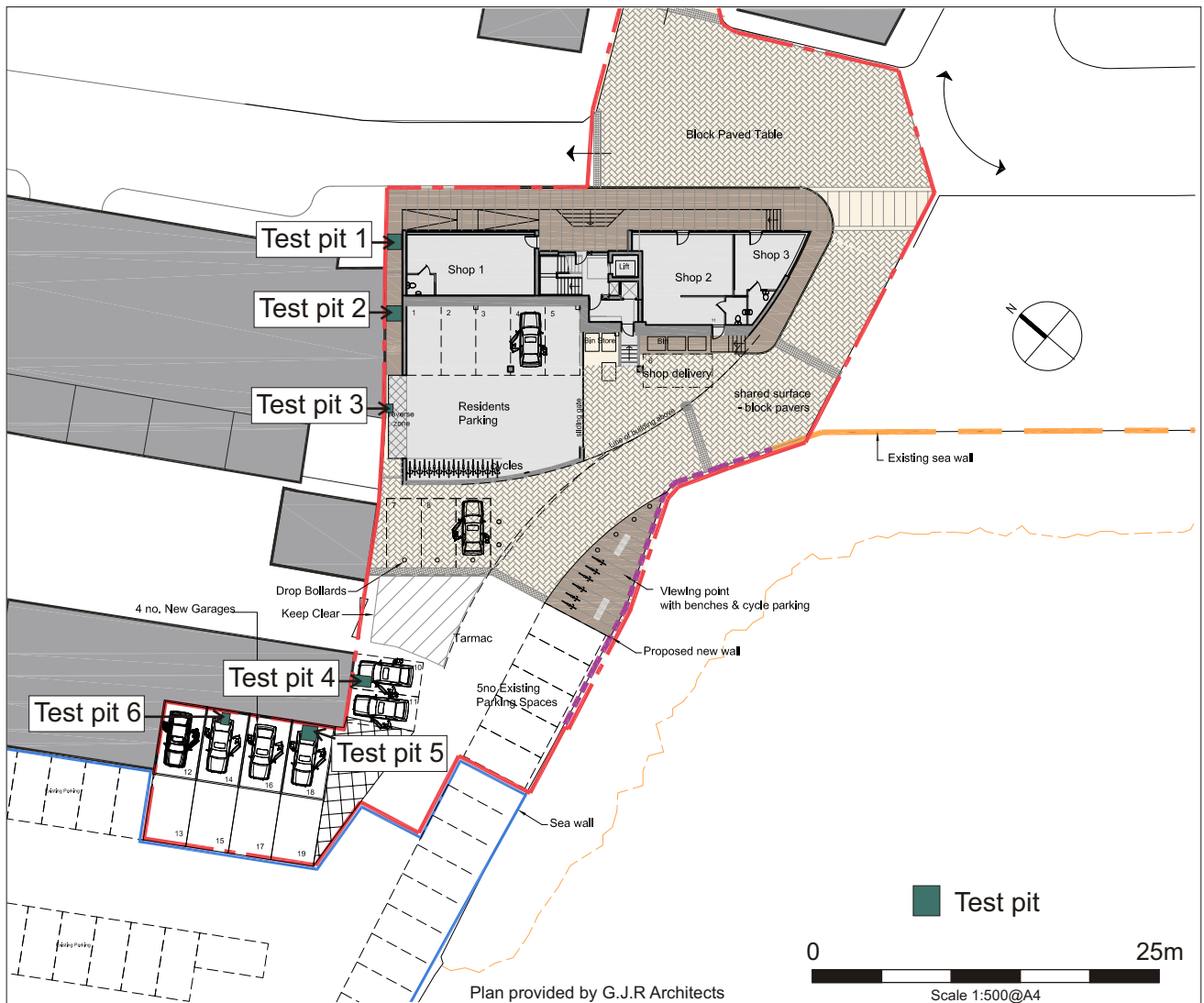
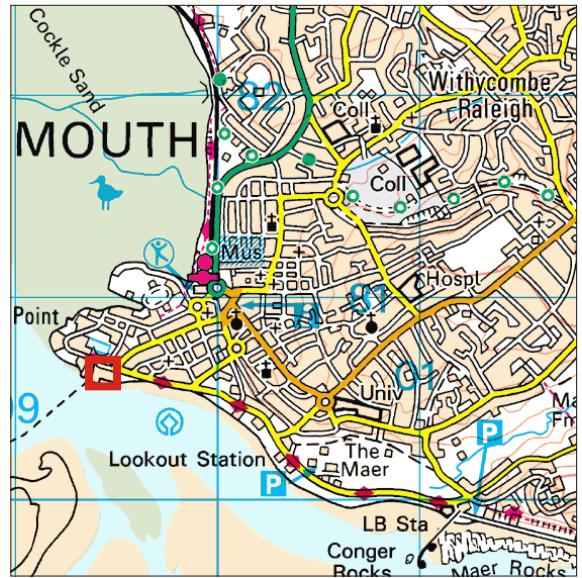
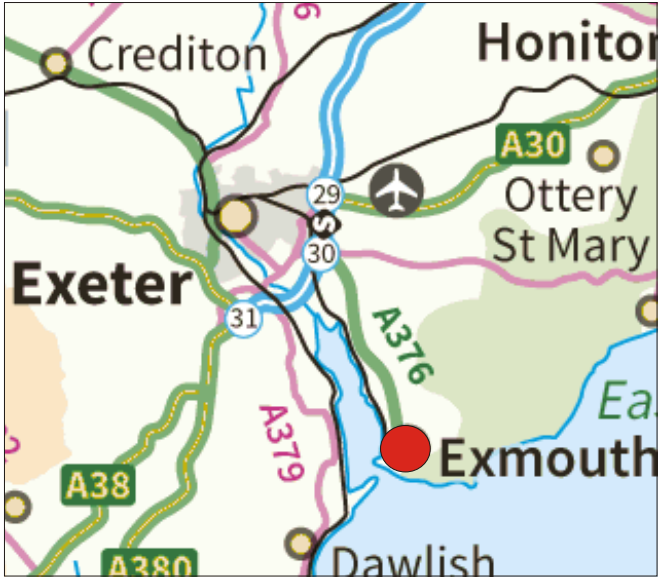

PROJECT

Pier Head, Mamhead View, Exmouth, Devon

TITLE

Fig. 1: Location of site and test pits monitored





Plate 1: General view of site, looking northwest



Plate 2: General view of site, looking southwest



Plate 3: General view of test pit 1 showing deposit (103) (1m scale)



Plate 4: General view of test pit 3 showing deposits (100) - (102) (1m scale)



Plate 5: General view of test pit 5 showing deposits (100) and (104) (1m scale)

Devon Office

AC archaeology Ltd
Unit 4, Halthaies Workshops
Bradninch
Nr Exeter
Devon
EX5 4LQ

Telephone/Fax: 01392 882410

Wiltshire Office

AC archaeology Ltd
Manor Farm Stables
Chicklade
Hindon
Nr Salisbury
Wiltshire
SP3 5SU

Telephone: 01747 820581
Fax: 01747 820440

www.acarchaeology.co.uk