

# LAND AT THE JUNCTION OF WEST HILL ROAD AND LOWER BROAD OAK ROAD, WEST HILL, OTTERY ST MARY, DEVON

(NGR SY 0747 9431)

## Results of archaeological monitoring and recording

---

Prepared by:  
Abigail Brown

On behalf of:  
Kier Integrated Services Ltd.

Report No: ACD1487/2/0

Date: February 2017

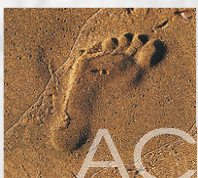

archaeology

---

# Devon County Council Historic Environment Record

<b>Civil Parish &amp; District:</b> Ottery St. Mary, East Devon	<b>National Grid Reference</b> SY 0747 9431	<b>Number:</b>
<b>Subject:</b> Land at the Junction of West Hill Road and Lower Broad Oak Road, West Hill, Ottery St. Mary, Devon : Results of archaeological monitoring and recording		<b>Photo attached</b> Plate 1
<b>Planning Application no:</b> N/A	<b>Recipient museum:</b> N/A	
<b>OASIS ID:</b> 264939	<b>Museum Accession no:</b> N/A	
<b>Contractor's reference number/code:</b> ACD1487	<b>Dates fieldwork undertaken:</b> 10 to 11 October, 2016	
<p><b>Introduction</b></p> <p>Archaeological monitoring and recording was during groundworks associated with the construction of a compound on land at the junction of West Hill Road and Lower Broad Oak Road, West Hill, Ottery St. Mary, Devon (Fig. 1). The site comprised part of a rectangular formally scrub-covered plot situated on flat ground at around 89aOD (above Ordnance Datum).</p> <p>The site lay to the north to Belbury Castle, a prehistoric oval enclosure with a single rampart, while to the west of this is a north to south aligned dyke that extends up to the junction with Lower Broad Oak road and West Hill Road opposite the site. This earthwork is considered to represent a sunken track of possible prehistoric origin and of which was documented during the c19th as having previously continued to the north for some distance.</p> <p><b>Results</b></p> <p>Monitored groundworks comprised the bulk-reduction of an area measuring approximately 38m by 18m using a tracked machine fitted with a toothless grading bucket.</p> <p>The area was excavated to a depth of 0.1m below existing levels onto a gravel-rich levelling or made ground layer, which contained modern brick fragments and 19th to 20th century ceramics and glass (not retained). The levelling layer was overlain by a dark brown silty-clay topsoil</p> <p><b>Summary</b></p> <p>The shallow nature of the groundworks only exposed modern deposits. Therefore, it was not established whether the projected route of the sunken trackway extending from the south did cross through the site.</p>		
<b>Recorder:</b>  Abigail Brown, AC archaeology	<b>Date sent to HER:</b>  February 2017	



Ordnance Survey © Crown Copyright 2015. All rights reserved. Licence number 100022432

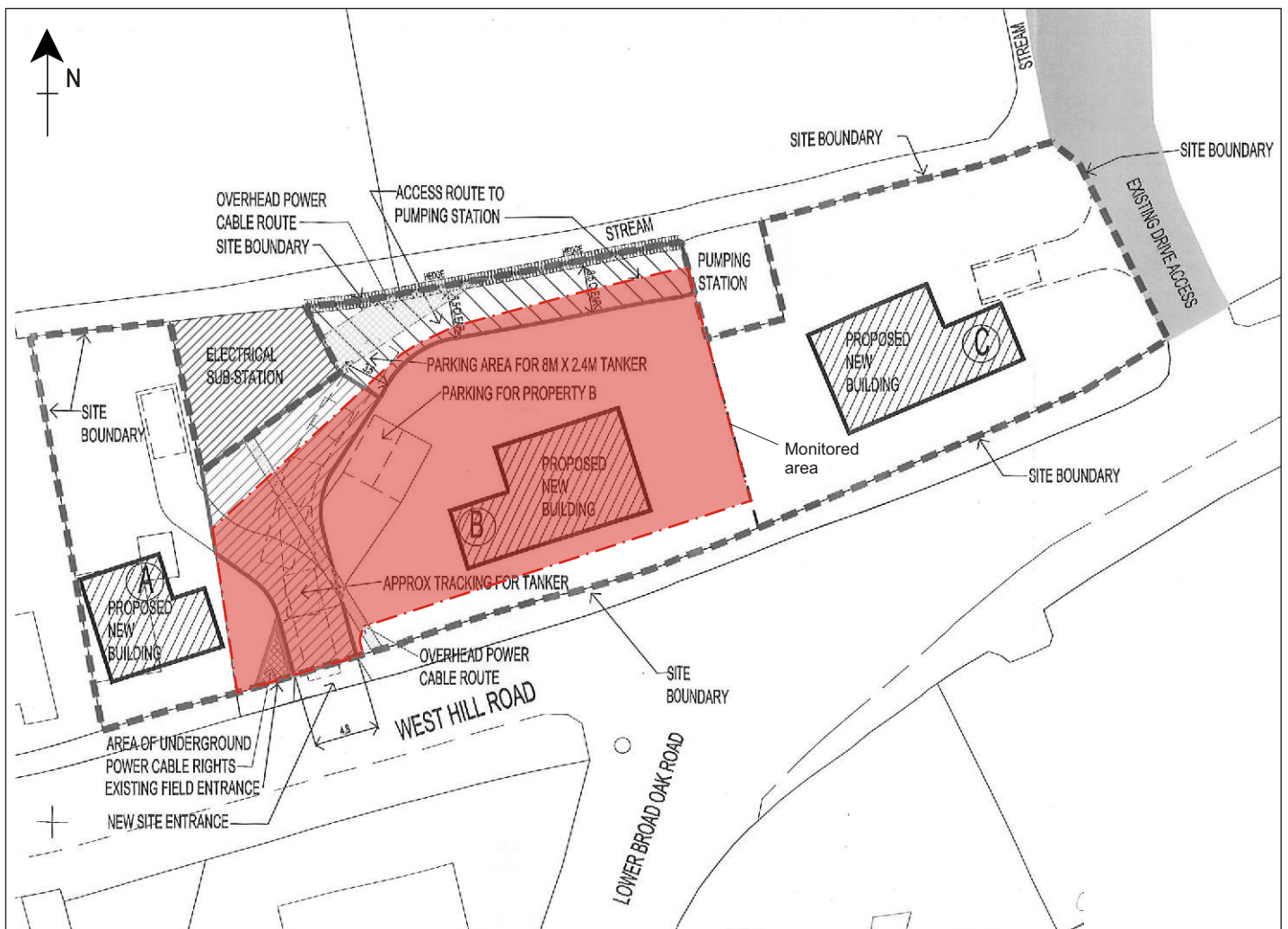

PROJECT  
 Land at the junction of West Hill Road and Lower Broad Oak Road, West Hill, Ottery St. Mary

TITLE  
 Fig. 1: Location of site and area monitored





Plate 1: General view of stripped area. looking west (scale 1m)

### Devon Office

AC archaeology Ltd  
Unit 4, Halthaies Workshops  
Bradninch  
Nr Exeter  
Devon  
EX5 4LQ

Telephone/Fax: 01392 882410

### Wiltshire Office

AC archaeology Ltd  
Manor Farm Stables  
Chicklade  
Hindon  
Nr Salisbury  
Wiltshire  
SP3 5SU

Telephone: 01747 820581  
Fax: 01747 820440

[www.acarchaeology.co.uk](http://www.acarchaeology.co.uk)