

# LAND AT DREW'S FORGE, HIGHER MILL LANE, CULLOMPTON, DEVON

(NGR SX 02153 07503)

Results of an archaeological trial trench evaluation

Mid Devon District Council planning ref 15/01414/FULL  
(Condition 3)

---

Prepared by:  
Chris Caine

On behalf of:  
Triway Construction Ltd.

Report No: ACD1514/2/0

Date: April 2017



archaeology

---

# Devon County Council Historic Environment Record

<b>Civil Parish &amp; District:</b> Cullompton, Mid Devon	<b>National Grid Reference</b> ST 02153 07503	<b>Number:</b>
<b>Subject:</b> Land at Drew's Forge, Higher Mill Lane, Cullompton, Devon: Results of an archaeological trial trench evaluation		<b>Photo attached</b> Plates 1 and 2
<b>Planning permission no:</b> 15/01414/FULL	<b>Recipient museum:</b> N/A	
<b>OASIS ID:</b> 296586	<b>Museum Accession no:</b> N/A	
<b>Contractor's reference number/code:</b> ACD1514	<b>Date fieldwork undertaken:</b> 5 April 2017	
<p><b>Introduction</b></p> <p>An archaeological trial trench evaluation forming part of a programme of archaeological work was undertaken by AC archaeology ahead of the construction of three dwellings on land at Drew's Forge, Higher Mill Lane, Cullompton, Devon (ST 02153 07503).</p> <p>The site lay on the north side of Cullompton at the junction between Forge Way and Higher Mill Lane, with this located to the rear of properties fronting the High Street (Fig. 1). It consisted of an approximately rectangular plot, which prior to the commencement of the development was occupied by a row of derelict single-story brick-built sheds that lined Higher Mill Lane and an associated yard.</p> <p>An estate map that dates from 1633 (DRO 26502/1) depicted the proposed development area within a possible orchard plot to the rear of the High Street. The 1841 Cullompton parish tithe map showed the site in more detail, with it positioned within a plot to the rear of a property fronting the High Street. It also depicted a building lining Higher Mill Lane, which corresponded with the location of the brick sheds that formerly occupied the site. The first-edition 25-inch Ordnance Survey map of 1887 showed the same arrangement as shown on the tithe map, and had the site annotated as 'Smithy'. Forge Lane was set out in late 20th century</p> <p><b>Results</b> (Fig. 1 and Plates 1 and 2).</p> <p>The work comprised the machine-excavation of three trenches totalling 11m in length, with each trench 1.5m wide. These were positioned to provide a sampled coverage the site. Natural subsoil was exposed at a depth of around 0.1m below existing levels and consisted of mid yellowish-red clays and sand with common river gravel inclusions. This was overlain by a levelling deposit of gravels mixed with demolition material derived from the former structures that previously occupied the site. No archaeological features or deposits were exposed and no pre-19th century finds were present in the overlying deposit.</p> <p><b>Comments</b></p> <p>The results from the trial trenching were negative, with only a consistent and thin layer of made ground mixed with recent demolition rubble exposed as overlying a natural subsoil. There was no surviving soil layers present suggesting that the site had been previously stripped, presumably in preparation for the structures and yard that previously occupied the site.</p> <p>This report represents the archive for the project. The paper and digital archive will be discarded.</p>		
<b>Recorder:</b>  Chris Caine, AC archaeology		<b>Date sent to HER:</b>  April 2017

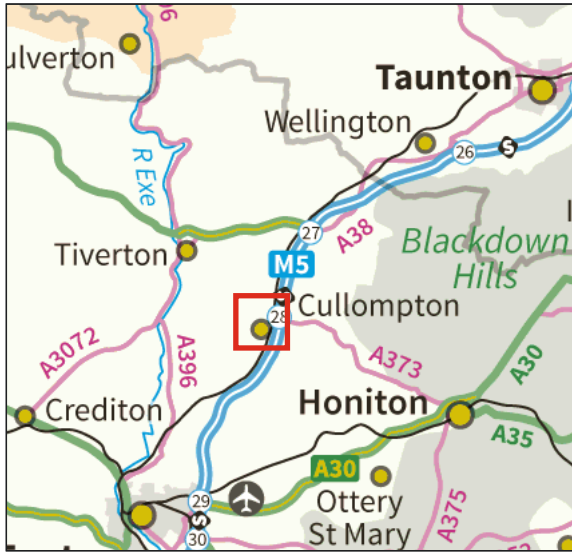

Ordnance Survey © Crown Copyright 2015. All rights reserved. Licence number 100022432

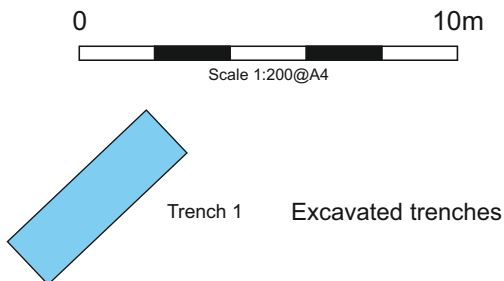
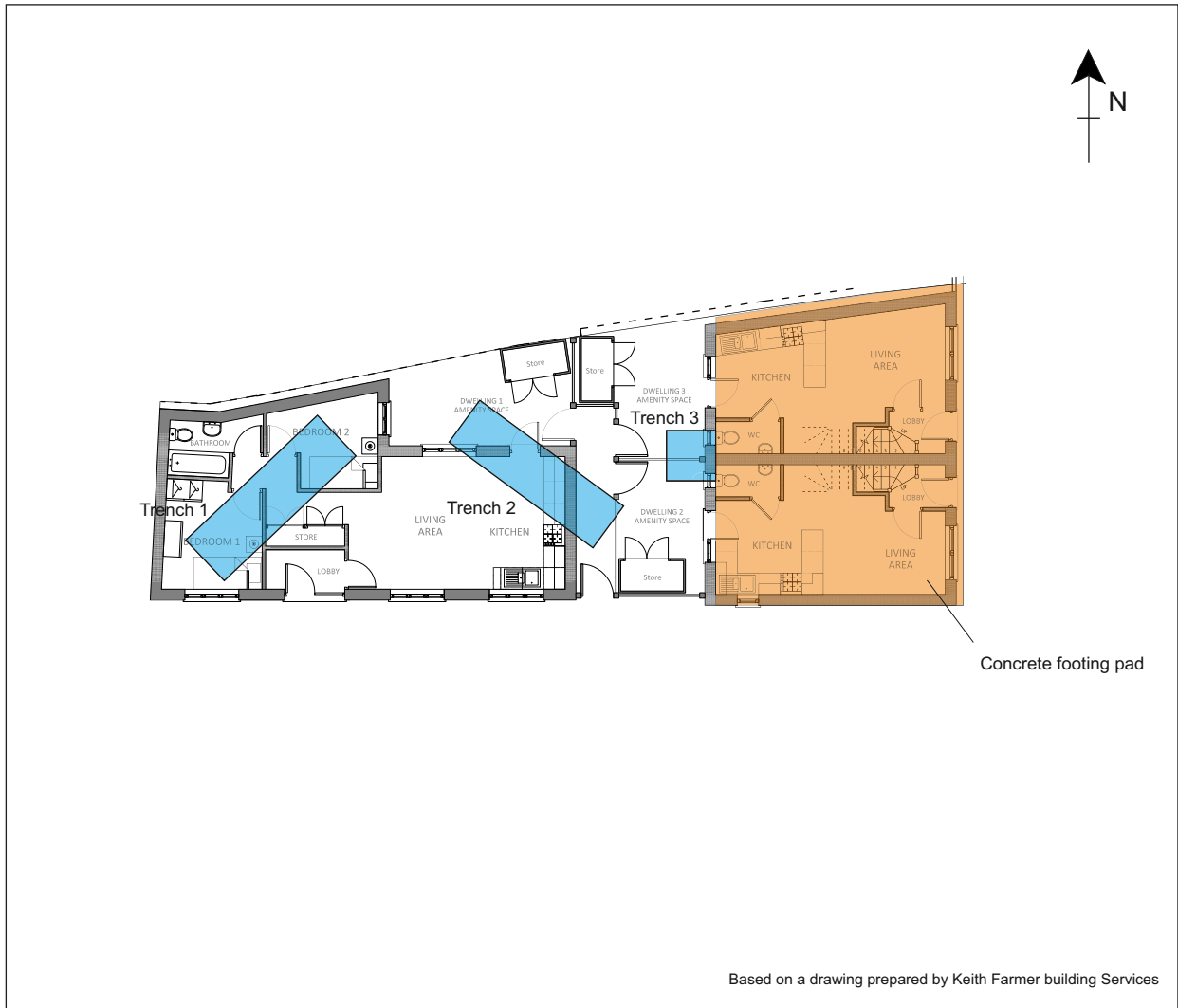

PROJECT

Land at Drew's Forge, Higher Mill Lane, Cullompton

TITLE

Fig. 1: Site location and trench plan overlain on proposed development plan





Plate 1: View of site looking east towards Forge way



Plate 2: Trench 1, view to southwest (scale 1m)

### Devon Office

AC archaeology Ltd  
Unit 4, Halthaies Workshops  
Bradninch  
Nr Exeter  
Devon  
EX5 4LQ

Telephone/Fax: 01392 882410

### Wiltshire Office

AC archaeology Ltd  
Manor Farm Stables  
Chicklade  
Hindon  
Nr Salisbury  
Wiltshire  
SP3 5SU

Telephone: 01747 820581  
Fax: 01747 820440

[www.acarchaeology.co.uk](http://www.acarchaeology.co.uk)