

THE FORMER SHIPPON, BUCKFAST ABBEY, DEVON

(NGR SX 74042 67371)

Results of archaeological monitoring and recording

Dartmoor National Park Authority planning ref. 0238/16

Prepared by:
Simon Hughes

On behalf of:
The Trustees of Buckfast Abbey

Report No: ACD1647/1/0

Date: August 2017

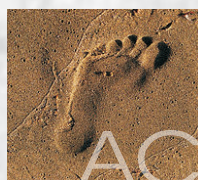

archaeology

Dartmoor National Park Historic Environment Record

Civil Parish & District: Buckfastleigh, Dartmoor	National Grid Reference SX 74042 67371	Number:
Subject: The Former Shippon, Buckfast Abbey, Devon: Results of archaeological monitoring and recording		Photo attached Plates 1-4
Planning permission no: 0238/16	Recipient museum: N/A	
OASIS ID: 293866	Museum Accession no: N/A	
Contractor's reference number/code: ACD1647	Dates fieldwork undertaken: 7 July 2017	
<p>Introduction (Fig. 1)</p> <p>Archaeological monitoring and recording was carried out by AC archaeology during groundworks associated with the upgrading of a drain and a sewer at the Former Shippon, Buckfast Abbey, Devon (SX 74042 67371). The Former Shippon is located some 50m to the west of the abbey church and lies within its precinct outer court. The two-story stone-built Former Shippon is terraced into a sloping bank allowing for access to first-floor level from the west. The work comprised the hand-excavation of a trench for a drain connection and a pit for a sewer inspection chamber; both of which were external to the structure.</p> <p>The Former Shippon lies within a scheduled monument that incorporates the North Gate and part of the precinct area of Buckfast Abbey (Heritage List for England number 1019607). Originally dating from the early 11th century, the Saxon monastery was briefly converted to Savignac Rule before becoming Cistercian in AD1174. It was following this later change that the monastery buildings were rebuilt, visible remains of which include exposed footings of former guest lodgings immediately to the east of the Former Shippon.</p> <p>Results (Fig. 1; Plates 1-4)</p> <p><i>New drain connection</i></p> <p>The trench for the new drain connection measured 0.3m wide and was excavated to a depth of 0.35m below existing levels. While natural subsoil was exposed on the base of the western portion of the trench, its majority was excavated into the backfill of the existing ceramic land drain. The natural subsoil overlain by a 0.1m thick layer of loose gravel, which was then sealed by topsoil.</p> <p><i>New inspection chamber</i></p> <p>The pit excavated for the inspection chamber measured approximately 1m across and was dug down against the north corner of the building. It was excavated to a depth of 1.2m below existing levels, with this through the trench backfill of an existing sewer pipe that was exposed in the base of the pit. A single sherd from a 19th century Staffordshire type transfer printed plate was recovered from the backfilled material.</p> <p>Comments</p> <p>No archaeological features or deposits were exposed during the monitored groundworks. Despite their location adjacent to medieval building remains, the limited excavations were largely positioned within trench backfills of an existing drain and sewer. No pre-modern finds were recovered.</p>		
Recorder: Simon Hughes, AC archaeology		Date sent to HER: August 2017

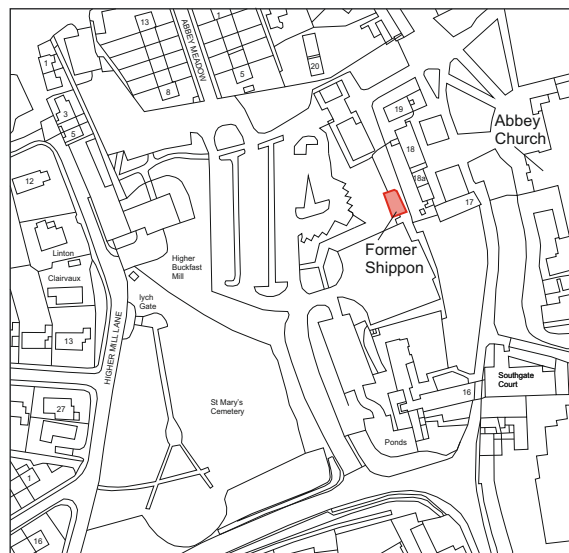

Ordnance Survey © Crown Copyright 2015. All rights reserved. Licence number 100022432

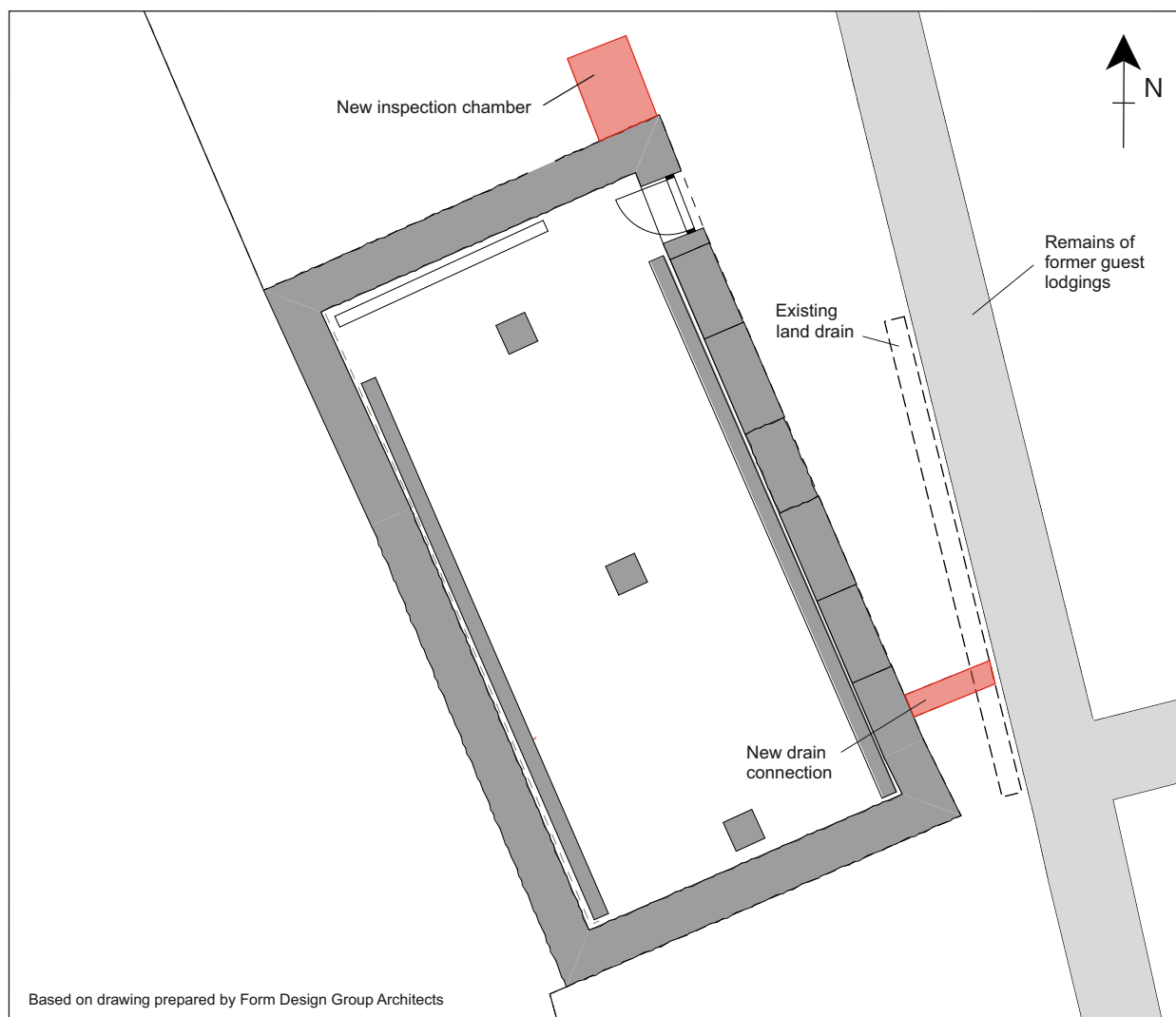

0 5m
Scale 1:100@A4

PROJECT

Former Shippon, Buckfast Abbey, Devon

TITLE

Fig. 1: Site location and position
of monitored groundworks



AC archaeology



Plate 1: Showing Former Shippon building with medieval building remains in foreground View to northwest

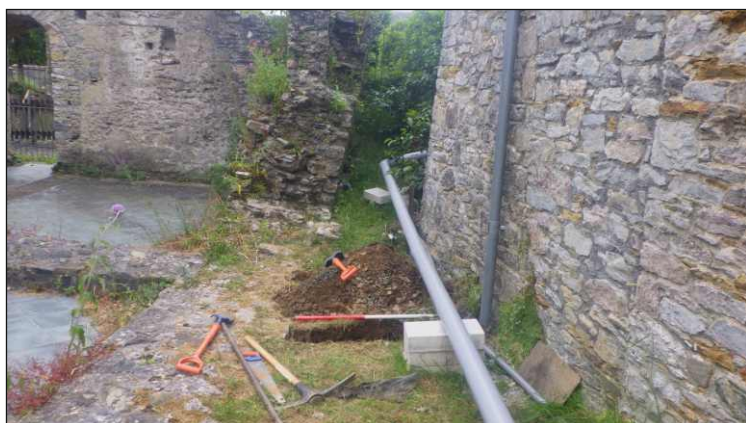

Plate 2: General view of new drain connection trench, looking south (scale 1m)



Plate 3: Showing detailed view of new drain connection trench. View to south (scale 1m)



Plate 4. Showing pit for new inspection chamber. View to west (scale 1m)

Devon Office

AC archaeology Ltd
Unit 4, Halthaies Workshops
Bradninch
Nr Exeter
Devon
EX5 4LQ

Telephone/Fax: 01392 882410

Wiltshire Office

AC archaeology Ltd
Manor Farm Stables
Chicklade
Hindon
Nr Salisbury
Wiltshire
SP3 5SU

Telephone: 01747 820581
Fax: 01747 820440

www.acarchaeology.co.uk