

LAND TO THE REAR OF FIVE ACRES, EXETER ROAD, TOPSHAM

(NGR SX 9609 8891)

Results of an Archaeological Trench Evaluation

Exeter City Council: Planning Permission Reference No.
16/0081/03 (Condition 4)

Prepared by:
Simon Hughes

On behalf of:
Heritage Developments SW Ltd

Report No: ACD1433/2/0

Date: April 2018

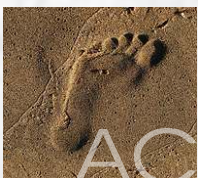

archaeology

Devon County Council Historic Environment Record

Civil Parish & District: Topsham, Exeter	National Grid Reference SX 9609 8891	Number:
Subject: Land to the rear of Five Acres, Exeter Road, Topsham		Photo attached: Plates 1-3
Planning Application no: 16/0081/03 (Condition 4)	Recipient museum: N/A	
OASIS ID: 313517	Museum Accession no: N/A	
Contractor's project code: ACD1433	Dates fieldwork undertaken: 5-6/09/2017 and 4/04/2018	
<p>Description of works</p> <p>An archaeological trench evaluation was undertaken by AC archaeology for Heritage Developments SW Ltd and Exeter Golf and Country Club ahead of the construction of a new golf driving range and associated facilities. The site is located on the northwest outskirts of Topsham on land to the northeast of Exeter Road and opposite residential streets comprising Wessex Close and Retreat Drive. It comprises an 'L' shaped parcel of arable land set back from the road on flat ground at around 10m above Ordnance Datum (Plate 1). The underlying solid geology comprises sandstone of the Dawlish Sandstone Formation beneath sand and gravel river terrace deposits.</p> <p>The Exeter/Topsham Road is close to the line of a Roman road extending from a probable port at Topsham to the legionary fortress at Exeter. The site lies in an area containing a number of archaeological sites, many of which have been recorded during recent developments of the adjacent plots. The southeast portion of the site that incorporates the positions of the new driving range building, parking and access drive site has been subject to a previous geophysical survey by Substrata Ltd. In this a small number of linear anomalies were interpreted, with these considered to represent ditches of former plot boundaries.</p> <p>The evaluation comprised nine machine-excavated trenches, each 1.8m wide and totalling 185m in length. Across the site, the recorded layer sequence comprised a topsoil of mid brown sandy loam, above a light yellowish-brown sandy loam subsoil. The natural subsoil largely comprised light reddish-brown sandy silty loam and was present at a depth of between 0.29m and 0.47m below the current ground surface.</p> <p>Results</p> <p>The locations of the trenches and archaeological features are shown on Fig. 1a. Three trenches contained archaeological features and the remaining trenches were negative. Trench 3 exposed a ditch (F303) aligned NE-SW and measuring 2.96m wide by 0.52m deep, with gradual sloping sides and a flat base (Fig. 1e). It contained three fills. The main fill (304) and an associated ploughed out bank (306) contained sherds of post-medieval pottery. In Trench 8, a small NE-SW aligned gully (F803), measuring 0.49m wide by 0.17m deep, contained a single fill and no finds (Fig. 1b; Plate 2). Trench 9 exposed two linear features: a NE-SW aligned ditch (F903, same as F303) measuring 2.32m wide by 0.55m deep with gradual sloping sides, a rounded base (Fig. 1d; Plate 3) and a single fill which contained post-medieval pottery and clay tobacco pipe; a NE-SW aligned gully (F905, same as F803) measuring 0.76m wide by 0.31m deep, with gradual sloping sides and a rounded base had a single fill with no finds (Fig. 1c).</p> <p>Comment</p> <p>Ditch F303/F903 is a former field boundary ditch of post-medieval date and was a clear anomaly identified by the geophysical survey. Gully F803/F905 is undated, but probably relates to post-medieval or modern agricultural activity on the site.</p>		
Recorder: Simon Hughes, AC archaeology Ltd		Date sent to HER: 17 April 2018

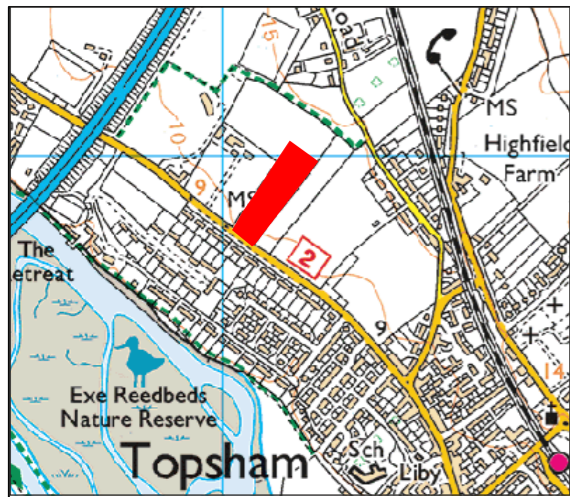

a) Plan

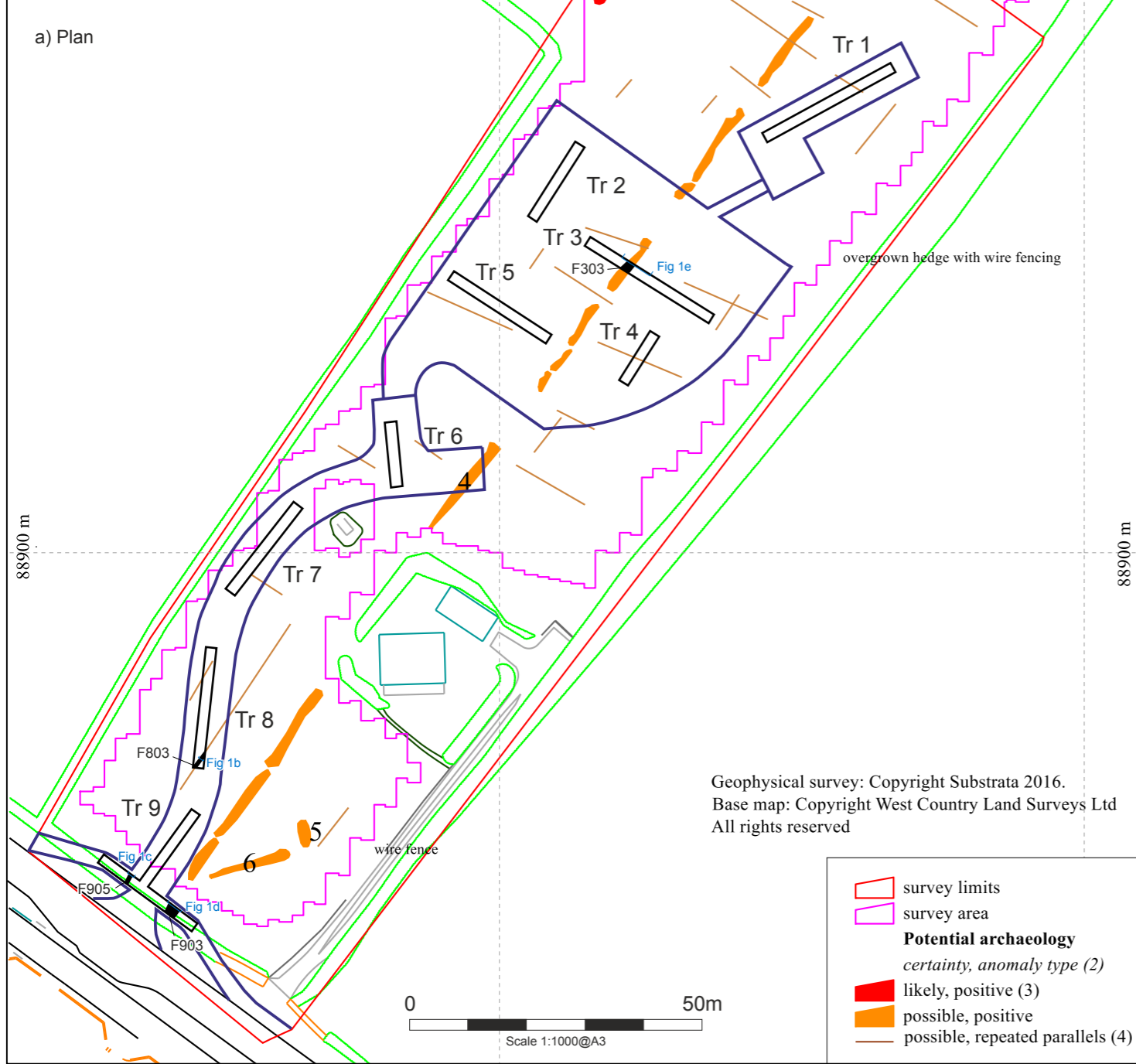

- survey limits
- survey area
- Potential archaeology**
- certainty, anomaly type (2)*
- likely, positive (3)
- possible, positive
- possible, repeated parallels (4)

- Excavated trenches with archaeological features shown
- Area affected by development

b) Section of gully F803

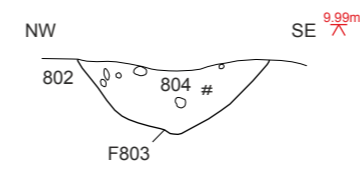

c) Section of gully F905

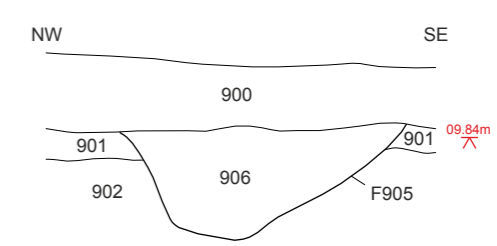

d) Section of ditch F903

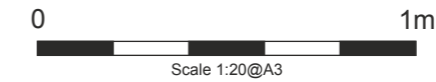
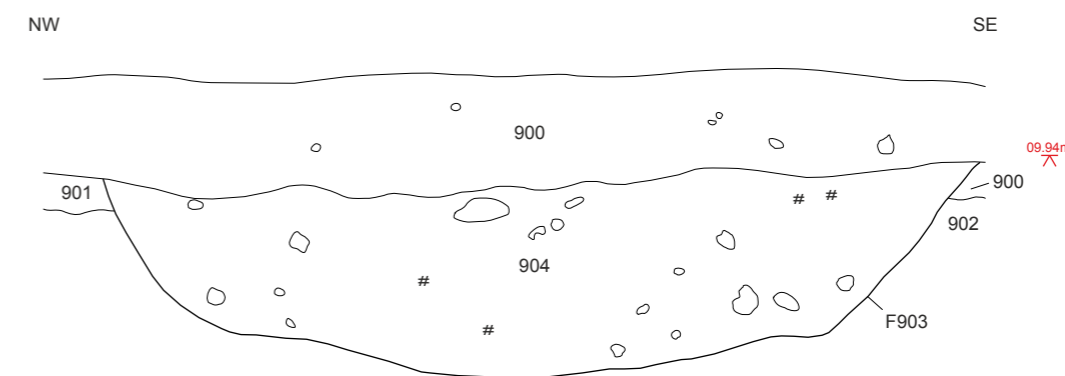

e) Section of ditch F303

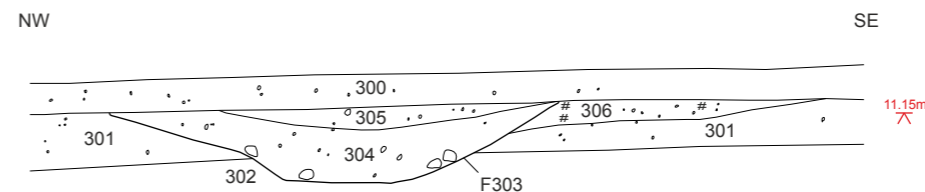

Key to all sections

- Stones
- Charcoal

PROJECT
Land to the rear of Five Acres,
Exeter Road, Topsham, Devon

TITLE
Fig. 1: Location of site and
trenches in relation to the
interpreted geophysics results,
as well as relevant sections



Plate 1: General view of the site, work in progress, looking southwest



Plate 2: Trench 8, southwest-facing section of gully F803 (0.5m scale)



Plate 3: Trench 9, southwest-facing section of ditch F903 (1m scale)

Devon Office

AC archaeology Ltd
Unit 4, Halthaies Workshops
Bradninch
Nr Exeter
Devon
EX5 4LQ

Telephone/Fax: 01392 882410

Wiltshire Office

AC archaeology Ltd
Manor Farm Stables
Chicklade
Hindon
Nr Salisbury
Wiltshire
SP3 5SU

Telephone: 01747 820581

Fax: 01747 820440

www.acarchaeology.co.uk