

PADDOCK WOOD, CHURSTON FERRERS, TORBAY

(NGR SX 90366 56455)

Results of an archaeological watching brief

Torbay Council planning reference P/2017/0429, condition 3

Prepared by:
Andrew Passmore BSc MCIfA

Document No: ACD1662/2/0

Date: January 2019

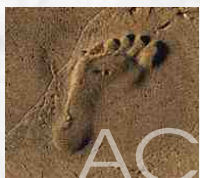

AC archaeology

Torbay Council Historic Environment Record

Civil Parish & District: Churston Ferrers	National Grid Reference SX 90366 56455	Number: (Leave blank for HES to fill in)
Subject: Paddock Wood, Churston Ferrers, Torbay: results of an archaeological watching brief		Photo attached? Y
Planning Application no: P/2017/0429	Recipient museum: Torquay	
OASIS ID: 338200	Museum Accession no: Pending	
Contractor's reference number/code: ACD1662	Dates fieldwork undertaken: 3 April 2018	
<p>Description of works.</p> <p>Introduction (Fig. 1) An archaeological watching brief was carried out during groundworks associated with the construction of extensions to Paddock Wood. The house is a late 20th-century detached two-storey building set centrally within a rectangular plot. Historically, the land formed part of the grounds of Churston Court (a mid to late 16th-century manor house located immediately to the south), along with part of an adjacent field to the west. The 1839 Churston Ferrers tithe map records three buildings within the current property, whilst later Ordnance Survey maps depict other, mainly agricultural buildings.</p> <p>Results (Fig. 2; Plates 1-4) The excavation of two 0.60m wide trenches was monitored – the eastern foundation trench (1), measuring up to 0.70m deep, and the southern foundation trench (2), measuring 0.80m deep. At the north end of trench 1 the following deposit sequence was exposed:</p> <ul style="list-style-type: none"> • 0-0.20m reddish-brown loose silty-loam topsoil (100); • 0.20-0.30m patchy layer of black ash and charcoal (101); • 0.30m-0.50m light grey-brown loose clayey silt with fragments of natural limestone that became more frequent at depth, oyster shell, lime mortar, and roof slate (102); and • 0.50m+ fracturing limestone bedrock (103). <p>At the south end of the trench, layer 102 decreased in depth to 0.10m and overlaid natural mid reddish-brown clay (104) that was not fully removed.</p> <p>The northwest extension to this trench was located within a former patio, and here the patio surface had been constructed onto a levelling layer (105) of roof slate and mortar fragments that extended below the depth of the trench.</p> <p>A similar, but deeper, sequence of deposits was exposed in trench 2:</p> <ul style="list-style-type: none"> • 0-0.30 reddish-brown loose silty-loam topsoil (100); • 0.30-0.60m light grey-brown loose clayey silt with fragments of natural limestone that became more frequent at depth, oyster shell, small lime mortar, charcoal, rare red sandstone, roof slate, and rare industrial china (102); and • 0.60m+ natural mid reddish-brown clay (104). <p>Services of various 20th-century dates were present in both trenches, but no archaeological features were exposed.</p> <p>A total of three sherds (120g) of pottery was recovered from a context 102. These comprised a faceted handle sherd from a jug in a buff micaceous and slightly gritty fabric that is probably late medieval or early post-medieval in date, a rim/handle sherd from a Totnes-type jug or chamber pot dating from c.1500-1750, and a base sherd of North Italian marbled ware pottery dating from c.1550-1650.</p>		

Comments

No archaeological features were exposed. The deep sequences of landscaping deposits contained quantities of historic building material, and are probably associated with the demolition of the buildings recorded on old maps, probably during the 19th century and in the later 20th century when Paddock Wood was constructed. The presence of residual earlier post-medieval pottery is not unexpected given the proximity of the site to Churston Court and the Church of St Mary the Virgin.

A plan as well as any other relevant drawings must be attached showing the location and extent of site, areas investigated and features exposed.

Recorder:

Andrew Passmore, AC archaeology

Date sent to HER:

7 January 2019



Ordnance Survey © Crown Copyright 2015. All rights reserved. Licence number 100022432

PROJECT

Paddock Wood, Churston Ferrers, Torbay

TITLE

Fig. 1: Site location



Key

- Existing buildings
- Exposed services

GREEN LANE

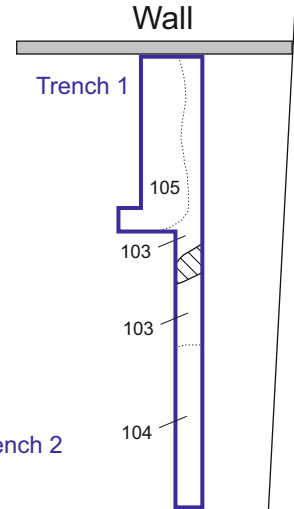
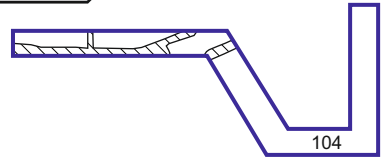
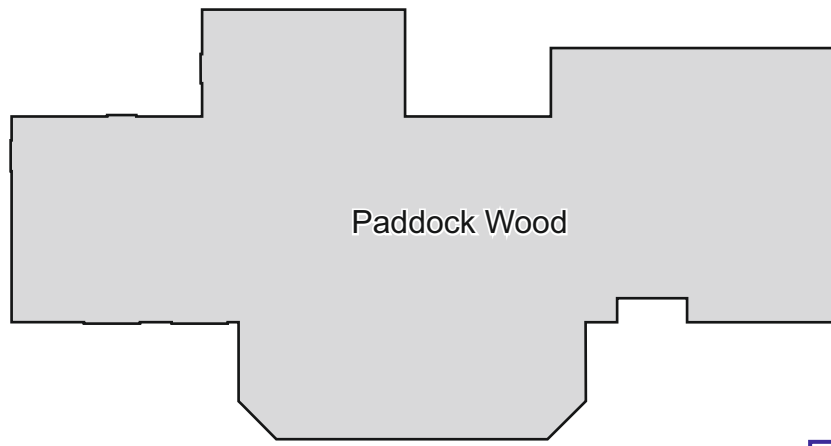

Scale 1:200@A4

Based on drawing prepared by inkPAD

PROJECT

Paddock Wood, Churston Ferrers, Torbay

TITLE

Fig. 2: Location of observations



AC archaeology



Plate 1: Trench 1, general view, looking northwest (1m scale)



Plate 2: Trench 1, typical section, looking northeast (0.50m scale)



Plate 3: Trench 2, general view, looking northeast (1m scale)



Plate 4: Trench 2, typical section, looking southwest (1m scale)

Devon Office

AC archaeology Ltd
Unit 4, Halthaies Workshops
Bradninch
Nr Exeter
Devon
EX5 4LQ

Telephone/Fax: 01392 882410

Wiltshire Office

AC archaeology Ltd
Manor Farm Stables
Chicklade
Hindon
Nr Salisbury
Wiltshire
SP3 5SU

Telephone: 01747 820581
Fax: 01747 820440

www.acarchaeology.co.uk