

# LAND AT EAST FARM COTTAGE, EAST CHARLETON, DEVON

(Centred on NGR SX 7620 4270)

Results of Archaeological Monitoring and Recording

Planning Reference: South Hams District Council  
2533/18/FUL (Condition 5)

---

Prepared by:  
Chris Caine

Report No: ACD2043/2/0

Date: June 2019

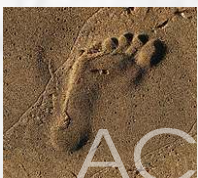

archaeology

---

# Devon Historic Environment Record

<b>Civil Parish:</b> Charleton	<b>National Grid Reference</b> SX 7620 4270	<b>Number:</b>																				
<b>Subject:</b> Land at East Farm Cottage, East Charleton, Devon: Results of archaeological monitoring and recording		<b>Photo attached?</b> Plates 1 - 3																				
<b>Planning Application no:</b> South Hams District Council 2533/18/FUL (Condition 5)		<b>Recipient museum:</b> N/A																				
<b>OASIS ID:</b> 350337		<b>Museum Accession no:</b> N/A																				
<b>Contractor's reference number/code:</b> ACD2043		<b>Dates fieldwork undertaken:</b> 12th June 2019																				
<p><b>Description of works</b></p> <p>Archaeological monitoring and recording was carried out by AC archaeology ahead of groundworks associated with the construction of a new 4-bed dwelling with private driveway and parking, on land at East Farm Cottage, East Charleton (<i>Fig. 1</i>). The works were required as a condition of planning consent. The site covers 0.06 hectares on currently grass-covered ground which is relatively flat but gently sloping down to the south to the access track to East Barn Cottage (<i>Plate 1</i>). The surrounding landscape, however, is steeply sloping between the access track and the A379. The site lies at around 38m above Ordnance Datum, with the underlying solid geology comprising slate, siltstone and sandstone of the Meadfoot Group (<a href="http://www.bgs.ac.uk">www.bgs.ac.uk</a>).</p> <p>The main archaeological interest for the site is that it is located to the east of a probable Bronze Age scheduled round barrow cemetery (DCC HER ref. MDV63930; National Heritage for England ref. 1019788). The Charleton tithe map of 1840 shows that the site was part of an orchard at that time.</p> <p>The archaeological work comprised one L-shaped machine-excavated trench measuring 1.4m wide and 13m long NW-SE and 8m NE-SW within the footprint of the proposed new building which was agreed with DCC HET to take place ahead of groundworks. Natural subsoil (102) was exposed at a depth of 0.84m below the ground level. The general deposit sequence observed was as follows:</p> <table border="1" data-bbox="228 1211 1401 1464"> <thead> <tr> <th>Context no.</th> <th>Description</th> <th>Depth b.g.s.</th> <th>Interpretation</th> </tr> </thead> <tbody> <tr> <td>100</td> <td>Mid greyish-brown silty clay</td> <td>0-0.16m</td> <td>Topsoil</td> </tr> <tr> <td>103</td> <td>Mid yellow to red silty clay with common to abundant shillet/shale fragments</td> <td>0.16-0.34m</td> <td>Redeposited natural</td> </tr> <tr> <td>101</td> <td>Mid yellowish-brown silty clay</td> <td>0.34-0.84m</td> <td>Subsoil</td> </tr> <tr> <td>102</td> <td>Mid reddish-brown silty clay with abundant shillet/shale fragments</td> <td>0.84m+</td> <td>Natural</td> </tr> </tbody> </table> <p>A dump of redeposited natural subsoil (103) was exposed across the majority of site, which perhaps indicates a levelling layer (<i>Plate 2</i>). There were no finds from any of the overlying deposits. In the NW corner of the trench a feature (F104) cutting the natural was exposed (<i>Plate 3</i>). This was only partially exposed in the trench and had minimum dimensions of 5.2m long by 2.2m wide. This was not excavated but had a fill (105) composed of dark greyish-brown silty clay. The top of the fill contained pieces of modern china.</p> <p><i>Comment</i></p> <p>One feature was exposed which may have been a hollow or wide ditch and was probably of late post-medieval or modern date. This late feature and the re-deposited natural levelling layer across the site indicates that there has been some excavation and levelling of the site in modern times. This may have involved works within the orchard, which was still present in the late 20th century according to mapping and aerial imagery.</p>			Context no.	Description	Depth b.g.s.	Interpretation	100	Mid greyish-brown silty clay	0-0.16m	Topsoil	103	Mid yellow to red silty clay with common to abundant shillet/shale fragments	0.16-0.34m	Redeposited natural	101	Mid yellowish-brown silty clay	0.34-0.84m	Subsoil	102	Mid reddish-brown silty clay with abundant shillet/shale fragments	0.84m+	Natural
Context no.	Description	Depth b.g.s.	Interpretation																			
100	Mid greyish-brown silty clay	0-0.16m	Topsoil																			
103	Mid yellow to red silty clay with common to abundant shillet/shale fragments	0.16-0.34m	Redeposited natural																			
101	Mid yellowish-brown silty clay	0.34-0.84m	Subsoil																			
102	Mid reddish-brown silty clay with abundant shillet/shale fragments	0.84m+	Natural																			
<b>Recorder:</b> Chris Caine, AC archaeology		<b>Date sent to HER:</b> June 2019																				

a) Site plan



b) Trench plan

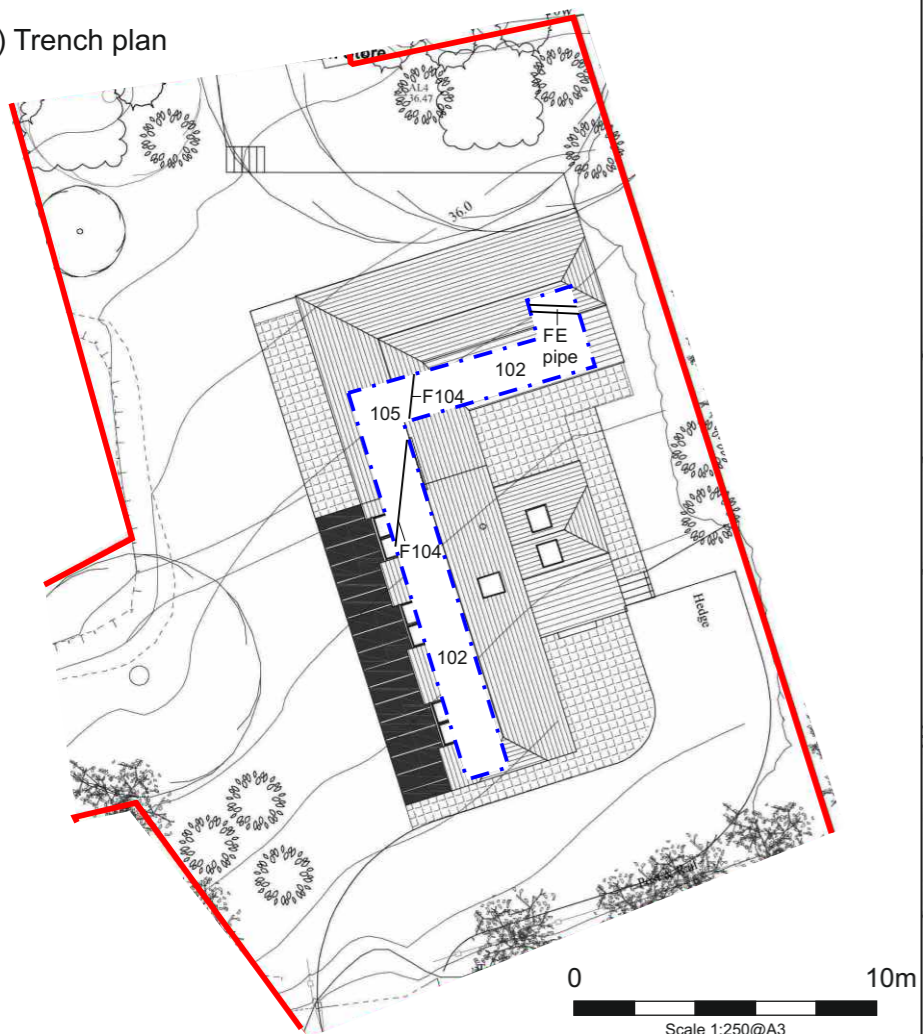

Legend

Site boundary

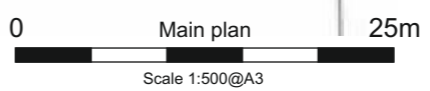

Ordnance Survey © Crown Copyright 2018. All rights reserved. Licence number 100022432

PROJECT



East Farm Cottage, East Charleton, Devon

TITLE

Fig. 1: Location of site and trench plan

ACD2043 - East Farm Cottage, East Charleton\_02-05-2019



Plate 1: General view of the site, looking east



Plate 2: Representative section, showing redeposited natural (103) beneath the topsoil (1m scale)



Plate 3: Location of feature F104, looking northwest (1m scale)

### Devon Office

AC archaeology Ltd  
Unit 4, Halthaies Workshops  
Bradninch  
Nr Exeter  
Devon  
EX5 4LQ

Telephone: 01392 882410

### Wiltshire Office

AC archaeology Ltd  
Manor Farm Stables  
Chicklade  
Hindon  
Nr Salisbury  
Wiltshire  
SP3 5SU

Telephone: 01747 820581

Fax: 01747 820440

[www.acarchaeology.co.uk](http://www.acarchaeology.co.uk)