

LAND AT BELLE VIEW, HOLSWORTHY, DEVON

(Centred on NGR SS 34414 03817)

Results of an Archaeological Trench Evaluation

Torrige District Council Planning Reference:
1/0255/2019/FUL (Condition 4)

Prepared by:
Chris Blatchford

On behalf of:
Howlett Investments Ltd

Document No: ACD2077/2/0

Date: September 2019

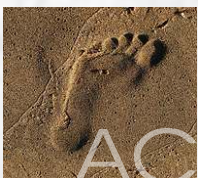

archaeology

Devon County Council Historic Environment Record

Civil Parish & District: Holsworthy, Torridge	National Grid Reference SS 34414 03817	Number:
Subject: Land at Belle View, Holsworthy: Results of an archaeological trench evaluation		Photo attached: Plates 1-3
Planning Application no: 1/0255/2019/FUL (Condition 4)	Recipient museum: N/A	
OASIS ID: 357256	Museum Accession no: N/A	
Contractor's reference number/code: ACD2077	Dates fieldwork undertaken: 3 September 2019	
<p>Introduction</p> <p>An archaeological trench evaluation was carried out by AC archaeology ahead of construction of four dwellings within the former Nat West Bank Car Park, Belle View, Holsworthy, Devon (Fig. 1; Plate 1). The site is located within the centre of Holsworthy, with Belle View to the south and Fore Street to the west. It was until recently an asphalt-covered former car park, lying on generally level ground at around 140m aOD (above Ordnance Datum). The underlying solid geology comprises sandstone of the Bude Formation (British Geological Survey Online Viewer 2019).</p> <p>The site is situated within the historic core of the town, with a settlement recorded at Holsworthy in the Domesday Survey of 1086, indicating pre-medieval origins. It is situated to the rear of what appear to be burgage plots fronting onto Fore Street, with therefore the potential for associated settlement and small-scale industrial activity in the form of buildings, rubbish pits, former property boundaries etc.</p> <p>Results</p> <p>The archaeological works consisted of the machine-excavation of three trial trenches, totalling 34m long by 1.5m wide, which were excavated across the footprint of the proposed terrace of buildings and the rear gardens (Fig. 1). Prior to the evaluation a stone-lined well with collapsed slate cap had been exposed during preparation of the site and its position was mapped and photographed although it could not be recorded in detail as it was deemed unsafe (Fig. 1; Plate 2).</p> <p>The evaluation trenches comprised:</p> <p><i>Trench 1</i> was aligned north-south and measured 14m long by 1.5m wide. It was excavated to a depth of 1m partly into natural (103) which was composed of light yellow clay. The overlying deposits were all modern comprising largely of made ground containing pieces of brick and modern china (not retained).</p> <p><i>Trench 2</i> was aligned northeast-southwest and measured 10m long by 1.5m wide. It was excavated to a depth of 0.9m partly into natural (202) which was composed of light yellow clay. The overlying deposits were all modern comprising of made ground containing pieces of brick and modern china (not retained).</p> <p><i>Trench 3</i> was aligned northeast-southwest and measured 10m long by 1.5m wide. It was excavated to a depth of 1.1m partly into natural (302) which was composed of light yellow clay. The overlying deposits were all modern comprising of made ground containing pieces of brick and modern china (not retained).</p> <p>Comments</p> <p>The results from the evaluation show that the site has been subject to significant levelling and filling to create hard standing in modern times, probably within the second half of the 20th century when the area was converted to car parking. With the exception of the deep well, it is probable that any archaeological remains that had been present were removed during this process. No finds of pre-modern date were present and the modern finds were not retained. The well is marked on the first edition Ordnance Survey map dated 1885.</p>		
Recorder: Chris Blatchford, AC archaeology		Date sent to HER: 4 September 2019

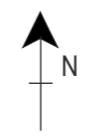
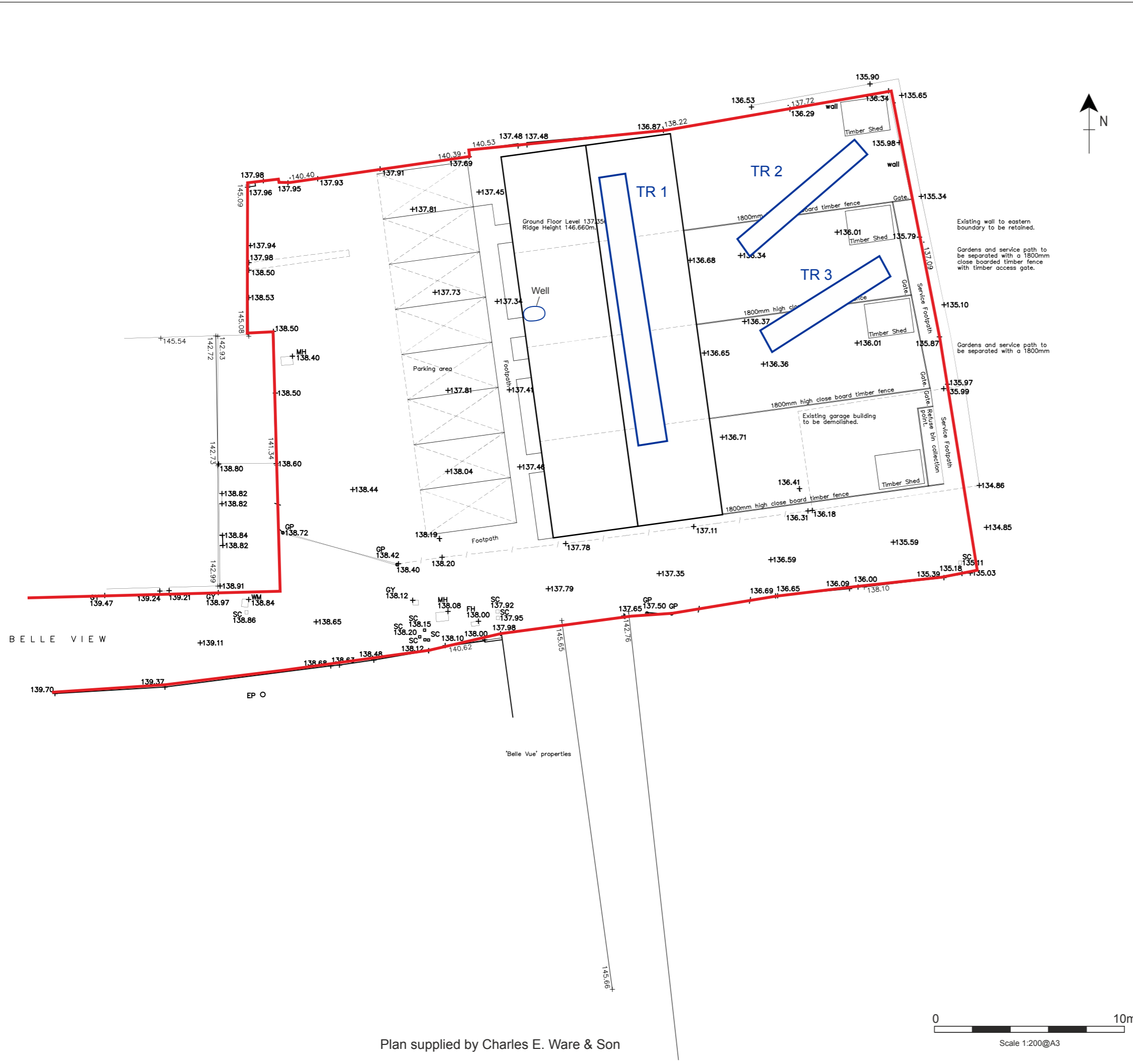

BELLE VIEW

EP O

'Belle Vue' properties

Plan supplied by Charles E. Ware & Son

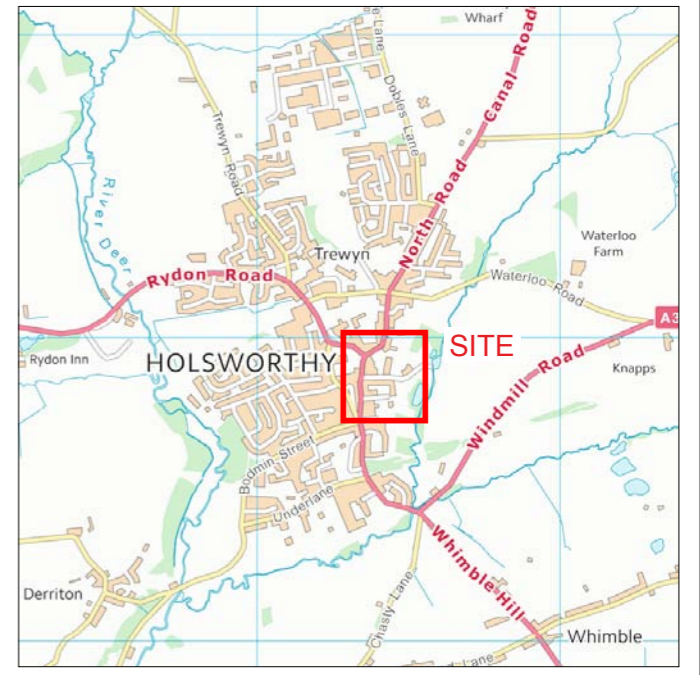

Ordnance Survey © Crown Copyright 2015. All rights reserved. Licence number 100022432

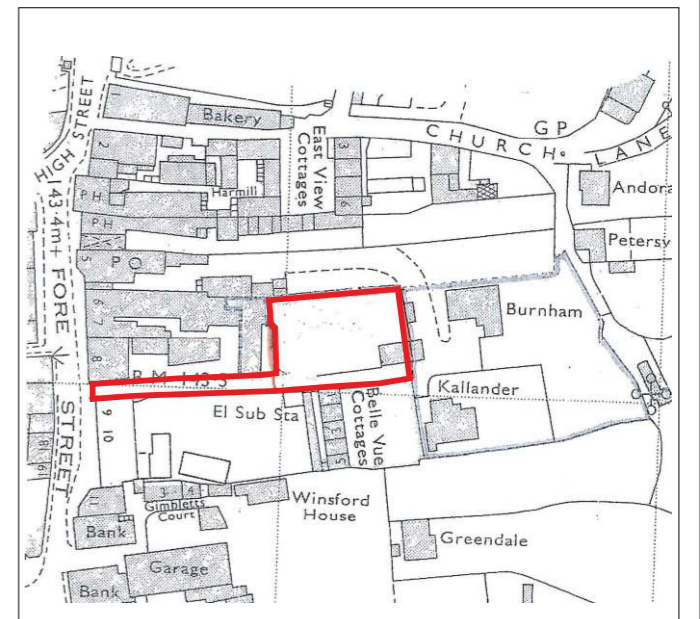

Map supplied by Charles E. Ware & Son

- Legend
- Site
 - Trenches 1-3



PROJECT
Land at Belle View, Holsworthy, Devon

TITLE
Fig. 1: Location of site, trenches and well



Plate 1: General view of the site looking east, with the well in the foreground (1m scale)



Plate 2: The well showing stone lining and collapsed slate covering, looking south



Plate 3: Trench 3, general view, looking southwest

Devon Office

AC archaeology Ltd
Unit 4, Halthaies Workshops
Bradninch
Nr Exeter
Devon
EX5 4LQ

Telephone: 01392 882410

Wiltshire Office

AC archaeology Ltd
Manor Farm Stables
Chicklade
Hindon
Nr Salisbury
Wiltshire
SP3 5SU

Telephone: 01747 820581

Fax: 01747 820440

www.acarchaeology.co.uk