

# LAND TO THE REAR OF 80 FORE STREET, CHUDLEIGH, DEVON

(NGR SX 86783 79553)

## Results of Archaeological Monitoring and Recording

Teignbridge District Council Planning Reference:  
14/01088/FUL (condition 4)

---

Prepared by:  
Simon Hughes

On behalf of:  
Darren Roche Builders Ltd

Report No: ACD1474/2/0

Date: November 2019



archaeology

---

# Devon County Council Historic Environment Record

<b>Civil Parish &amp; District:</b> Chudleigh, Teignbridge	<b>National Grid Reference:</b> SX 86783 79553	<b>Number:</b>
<b>Subject:</b> Land to the rear of 80 Fore Street, Chudleigh, Devon: Results of archaeological monitoring and recording		<b>Photo attached:</b> Plates 1-3
<b>Planning Application no:</b> 14/01088/FUL	<b>Recipient museum:</b> N/A	
<b>OASIS ID:</b> 373981	<b>Museum Accession no:</b> N/A	
<b>Contractor's reference number/code:</b>  ACD1474	<b>Dates fieldwork undertaken:</b>  28 to 29 January 2019	
<p><b>Introduction</b></p> <p>Archaeological monitoring and recording was undertaken by AC archaeology during groundworks associated with the construction of two semi-detached dwellings on land to the rear of 80 Fore Street, Chudleigh, Devon (SX 86783 79553). The site is situated towards the centre of Chudleigh and to the northeast of Fore Street. Prior to commencement the site comprised a level courtyard with lean-to structure to the rear of the street frontage property that is bounded by a lane to the southeast.</p> <p>The site lies within the historic core of the town. The earliest documentary reference to Chudleigh is in c. AD 1150. At the time of the Domesday Survey in 1086 it is believed to have been included in the manor of Bishopsteignton, belonging to the Bishop of Exeter. In 1308 it was described as 'new borough', which may indicate the date of the establishment of the settlement as a medieval planned town. The late 19th century Ordnance Survey map shows that the narrow strips of land, known as burgage plots and a typical feature of medieval planned towns, are well preserved by the property boundaries established along Fore Street. The town was severely damaged by fire in 1807 which destroyed nearly 200 houses, as well as the 16th century market houses. The 19th century parish tithe map and Ordnance Survey mapping show that the site was occupied by a building range that had abutted the street frontage property.</p> <p><b>Results</b> (Fig. 1; Plates 1-3)</p> <p>Monitored groundworks comprised the bulk reduction of the footprint for the new dwellings. This comprised the removal of modern surfaces and levelling material onto the natural subsoil (context 101), which comprised mixed weathered slate and yellowish-grey clay that was generally present at a depth of approximately 0.2m below existing levels. The removal of the retaining wall bounding the elevated lane to the southwest demonstrated that the courtyard had been terraced into the hillside.</p> <p>The groundworks exposed part of an approximately northwest to southeast aligned covered stone lined drain (S103), which extended from beneath the northeast plot boundary wall. It was exposed for a length of 4.5m and have had been previously cut away by terracing to the southeast. The drain was constructed from roughly faced stone blocks and rubble in a lime mortar bond within a 0.47m wide and 0.3m deep construction cut (F102). An intermittent hollow either side of the structure had been backfilled with yellow clay. The void within the drain, which measured 0.15m square, contained a thin dark brown silty loam (104) accumulation. No finds were recovered.</p> <p><b>Comments</b></p> <p>The groundworks exposed part of an undated covered stone drain. This would have extended down slope from the rear of the street frontage property. It was shown to have extended beneath the existing boundary wall, which would have formed part of a former range to the rear of the 80 Fore Street, and its southeast portion had been removed by the terracing for the courtyard. It therefore was likely to have pre-dated the 19th century, but as no finds were recovered from the structure, no closer date was possible.</p> <p>This report represents the archive for the project.</p>		
<b>Recorder:</b>  Simon Hughes, AC archaeology		<b>Date sent to HER:</b>  19 November 2019

a) Plan of monitored area

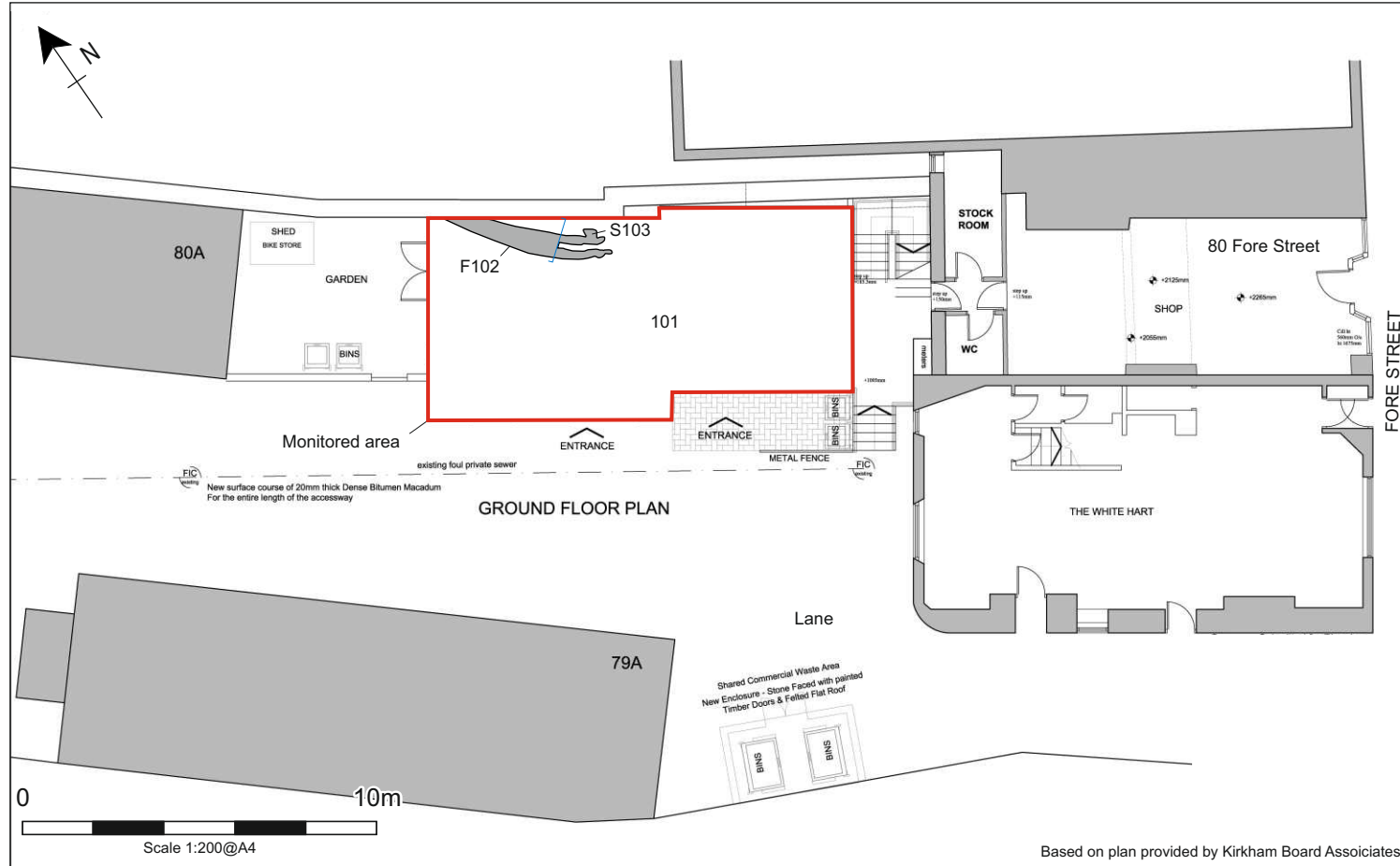

Ordnance Survey © Crown Copyright 2019. All rights reserved. Licence number 100022432

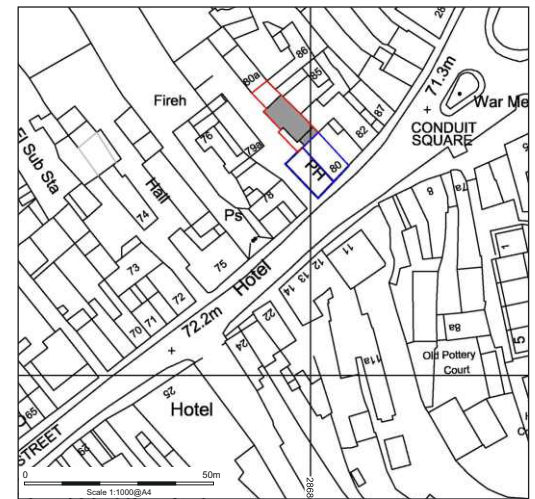
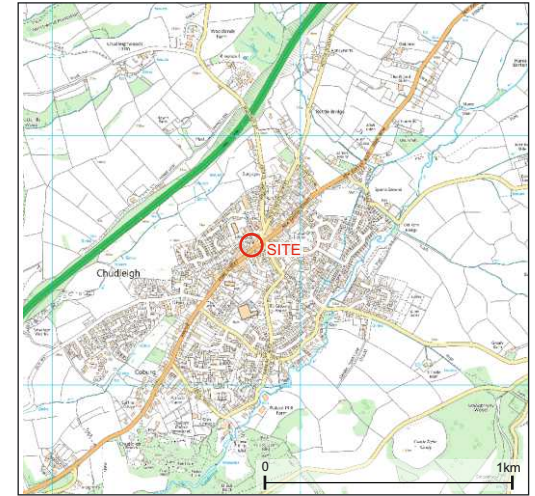

b) Section of drain S103

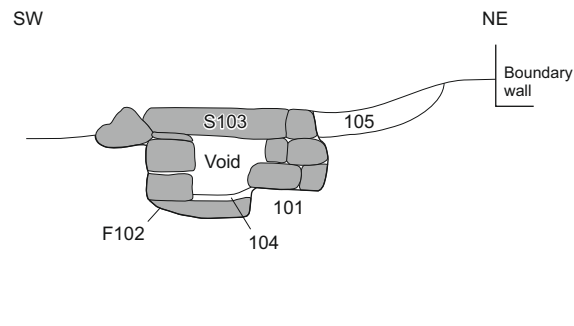

PROJECT

Land to the rear of 80 Fore Street,  
Chudleigh, Devon

TITLE

Fig. 1: Location of site and plan and  
section of drain S103



AC archaeology





Plate 1: General working view of site looking southeast towards 80 Fore Street



Plate 2: Showing stone drain S103. View to northwest (scale 0.5m)



Plate 3: Section of stone drain S103. View to northwest (scale 0.5m)

### Devon Office

AC archaeology Ltd  
Unit 4, Halthaies Workshops  
Bradninch  
Nr Exeter  
Devon  
EX5 4LQ

Telephone/Fax: 01392 882410

### Wiltshire Office

AC archaeology Ltd  
Manor Farm Stables  
Chicklade  
Hindon  
Nr Salisbury  
Wiltshire  
SP3 5SU

Telephone: 01747 820581  
Fax: 01747 820440

[www.acarchaeology.co.uk](http://www.acarchaeology.co.uk)