

LAND ADJACENT TO BOWDEN HILL, YEALMPTON, DEVON

(Centred on NGR SX 57775 51939)

Results of an Archaeological Trial Trench Evaluation

South Hams District Council Planning Reference
2556/19/FUL (condition 3)

Prepared by:
Simon Hughes

Report No: ACD2313/2/0

Date: October 2020

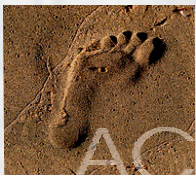

archaeology

Devon County Council Historic Environment Record

Civil Parish & District: Yealmpton, South Hams	National Grid Reference SX 57775 51939	Number:
Subject: Land adjacent to Bowden Hill, Yealmpton Devon: Results of an archaeological trial trench evaluation		Photo attached Plates 1-3
Planning Application no: 2556/19/FUL	Recipient museum: N/A	
OASIS ID: 399308	Museum Accession no: N/A	
Contractor's reference number/code: ACD2313	Dates fieldwork undertaken: 7 September 2020	
<p>Introduction (Fig. 1; Plate 1) An archaeological trial trench evaluation was carried out by AC archaeology ahead of a residential development on land at Bowden Hill, Yealmpton, Devon (SX 57775 51939). The site lies at the current northwest extent of Yealmpton. It comprises part of a wider pasture field to the rear of existing residential properties fronting Bowden Hill to the southeast. The site is situated in an elevated position at around 60m aOD (above Ordnance Datum) and on ground that slopes moderately steeply to the north.</p> <p>The principal archaeological interest in the site is that it lies immediately to the north of a possible enclosure. This has been interpreted as a projected 140m diameter round area, the north and east extent of which have been fossilised as the curving hedgebank bounding the site to the south and Yealmbury Hill road. These boundaries are also shown on the 1843 Yealmpton parish tithe map and within which several open plots are shown within the projected enclosure. Two of these (including the plot immediately to the south of the site) are named '<i>Yealmbury</i>' and '<i>Yealmbury Garden</i>' in the accompanying tithe apportionment; the bury element in the name suggests the presence of a settlement. No dating evidence is available for the potential enclosure and, despite the interior of the projected enclosure has since been developed with residential properties, no archaeological remains or find spots have been recorded on the Devon County Council Historic Environment Record.</p> <p>Results (Fig. 1; Plates 1-3) The evaluation comprised the machine excavation of three trial trenches measuring a total of 45m in length and with each trench 1.3m wide. These were positioned to target the footprint of the new dwelling, its associated drive, and an area of proposed landscaping/planting. Natural subsoil (context 102 in Trench 1), which consisted of a light brownish yellow silty clay, was exposed at a depth of between 0.24m to the south of the site and 1.04m downslope to the northwest. It was overlain by a light reddish-brown silty clay colluvial subsoil (101), which was then sealed by a mid to light brown silty loam topsoil (100). One archaeological feature was exposed in Trench 1, with this comprising a northwest to southeast aligned possible ditch (F103). Possible ditch F103 measured 0.8m wide and 0.08m deep with an irregular and shallow concave profile. It contained a deposit that was like the colluvial subsoil (101). No finds were recovered from the possible ditch. A single base sherd (35g) from an 18th to 19th century South Somerset type vessel was recovered from the topsoil in Trench 3.</p> <p>Comments The results from the trial trench evaluation were largely negative, with a single undated possible ditch comprising the only archaeological feature. Its alignment, as extending perpendicular from the curving boundary to the southeast, suggests that it potentially represented a former subdivision of the current pasture field. No evidence for activity or residual finds associated with the adjacent possible enclosure was exposed by the work.</p> <p>This report represents the archive for the project.</p>		
Recorder: Simon Hughes, AC archaeology	Date sent to HER: 7 October 2020	

a) Proposed development plan with location of trial trenches shown

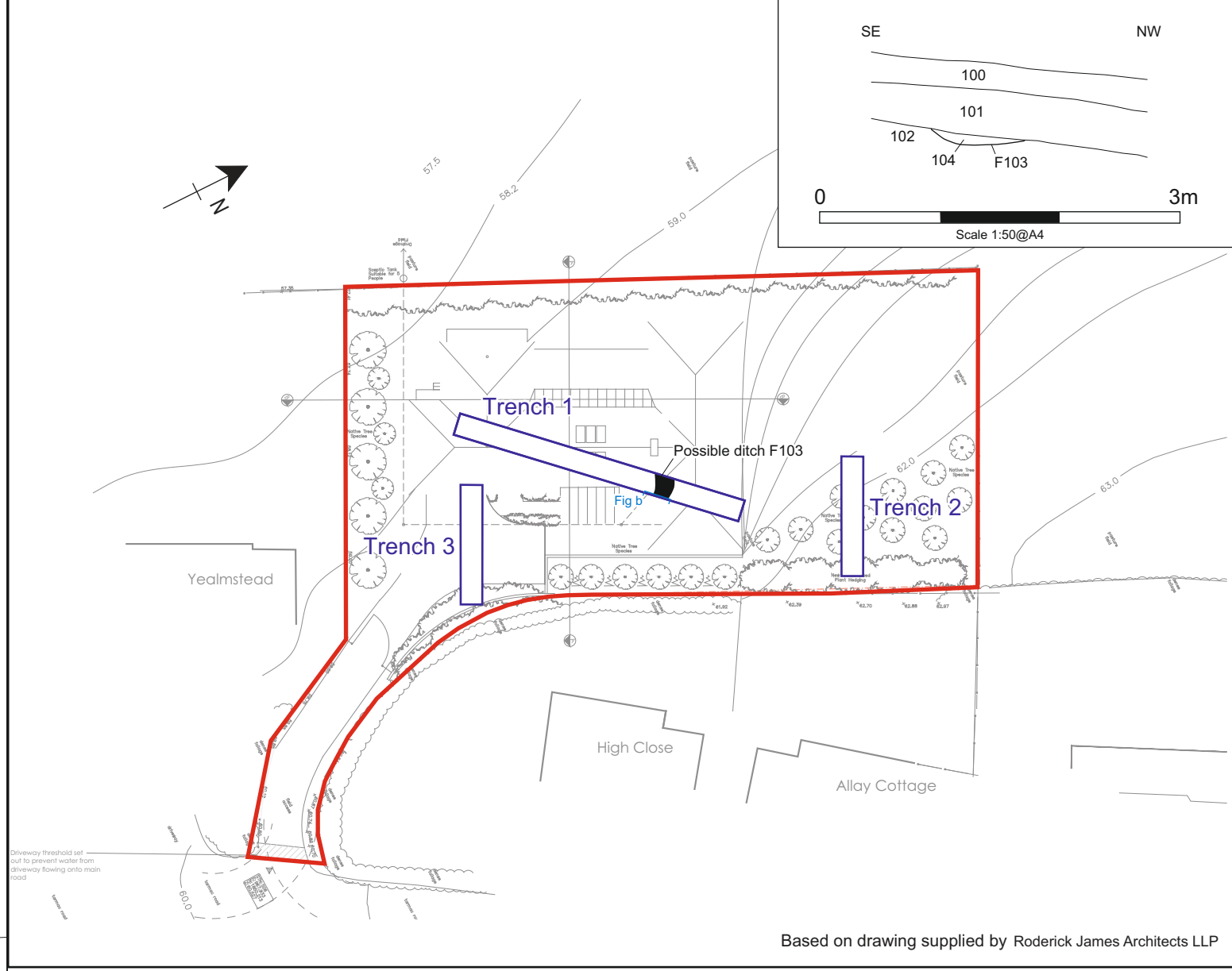
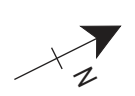

b) Section of possible ditch F103

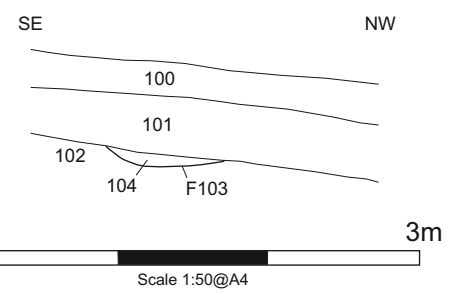

Based on drawing supplied by Roderick James Architects LLP

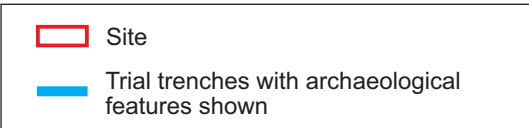

Contains Ordnance Survey data © Crown copyright and database right 2020



PROJECT  AC archaeology
Land adjacent to Bowden Hill, Yealmpton, Devon

TITLE
Fig. 1: Location of site, proposed development plan with location of trial trenches shown and section of possible ditch F103



Plate 1: General view of site, looking south with Trench 2 in foreground and historic boundary to left



Plate 2: Trench 1, view to southwest with possible ditch F103 (scale 1m)



Plate 3: Trench 1, possible ditch F103. View to southeast (scale 1m)

Devon Office

AC archaeology Ltd
Unit 4, Halthaies Workshops
Bradninch
Nr Exeter
Devon
EX5 4LQ

Telephone/Fax: 01392 882410

Wiltshire Office

AC archaeology Ltd
Manor Farm Stables
Chicklade
Hindon
Nr Salisbury
Wiltshire
SP3 5SU

Telephone: 01747 820581

Fax: 01747 820440

www.acarchaeology.co.uk