

9 NEW INN COURT, CULLOMPTON, DEVON

(NGR ST 01999 07171)

Results of an archaeological trench evaluation

Mid Devon District Council planning reference  
20/01736/FULL

---

Prepared by  
Tom Etheridge

On behalf of  
PC Milton Builders

Report No: ACD2468/2/0

Date: July 2021

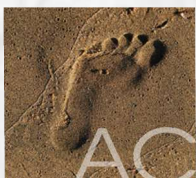

archaeology

---

# Devon County Council Historic Environment Record

<b>Civil Parish &amp; District:</b> Cullompton, Mid Devon District Council	<b>National Grid Reference</b> ST 01999 07171	<b>Number:</b>
<b>Subject:</b> Land at 9 New Inn Court, Cullompton, Devon: Results of an archaeological trench evaluation		<b>Photo attached:</b> Plates 1-3
<b>Planning Application no:</b> 20/01736/FULL	<b>Recipient museum:</b> N/A	
<b>OASIS ID:</b> 416761	<b>Museum Accession no:</b> N/A	
<b>Contractor's reference number/code:</b> ACD2468	<b>Dates fieldwork undertaken:</b> 01 June 2021	
<p><b>Introduction</b> (Fig. 1; Plate 1) An archaeological trench evaluation was carried out by AC archaeology on land at 9 New Inn Court, Cullompton, Devon (ST 01999 07171). The site is located in the centre of Cullompton and occupies a plot to the rear of properties fronting the west side of Fore Street. It is accessed from New Inn Court and comprises an area previously occupied by an industrial unit adjacent to No. 9. The site is situated at a height of approximately 60m above Ordnance Datum, with the underlying solid geology comprising permian sandstone of the Cadbury Breccia Formation overlain by Quaternary colluvium.</p> <p>The site is located at the rear of burgage plots of medieval origin that extending back from Fore Street, which historic maps depict as being undeveloped until the present properties were constructed in the later 20th century.</p> <p><b>Results</b> (Fig. 1; Plates 2-3) The archaeological work comprised the excavation of a single trench, which measured 14m long and 0.75m wide. Natural subsoil (context 104), which consisted of a light-yellow sandy clay, was present at a depth of around 0.7m below existing levels. It was overlain by two made ground layers (102 and 103), which were then sealed by a concrete surface (101). The trench contained a total of 17 pre-existing utilities, their accompanying service trenches and a concrete footing. No pre-modern archaeological features or deposits were exposed. Four sherds of post medieval pottery were recovered from the made ground layers.</p> <p><b>Note on finds</b> <i>by Naomi Payne</i> The only finds from the evaluation were four small sherds (8g) of 18th to 19th century pottery. The sherds included three pieces of Staffordshire-type white ware (a cup rim and two body sherds) and a very small body sherd of tin-glazed earthenware.</p> <p><b>Comments</b> The groundworks exposed an extensive sequence of modern interventions and 18th to 19th century made ground layers over the natural subsoil. No evidence for earlier activity was exposed.</p> <p>This report represents the archive for the project.</p>		
<b>Recorder:</b> Tom Etheridge, AC archaeology		<b>Date sent to HER:</b> 5 July 2021

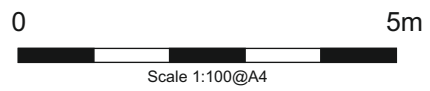
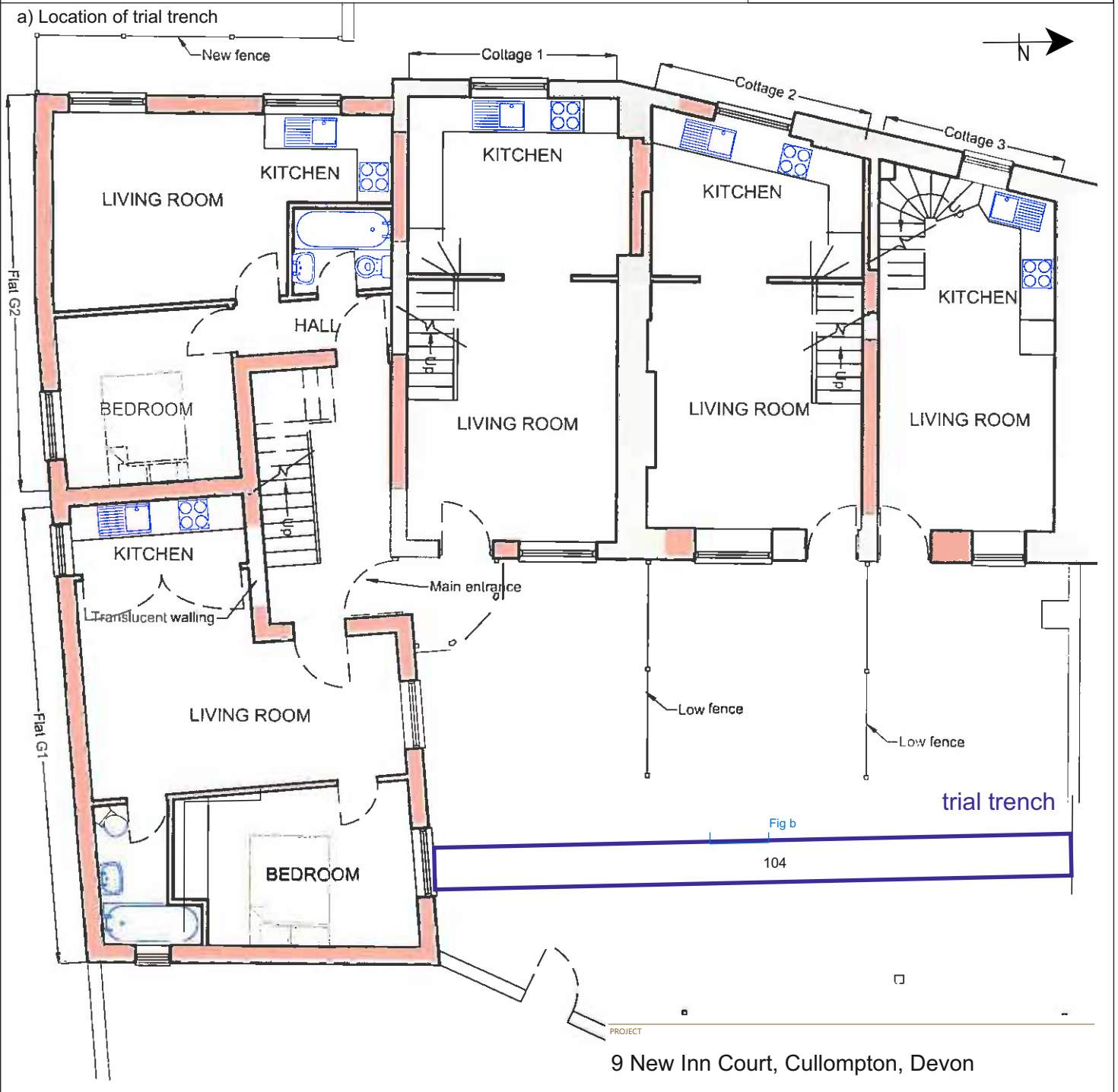
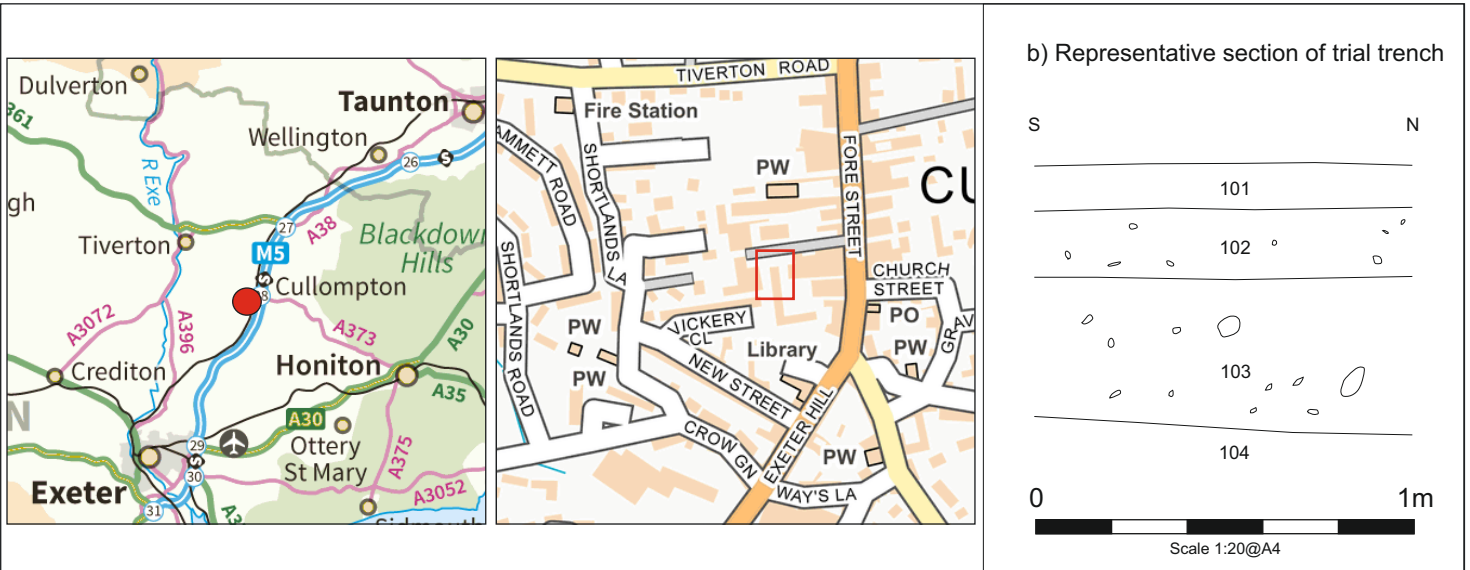





Plate 1: General view of the site looking northwest, 9 New Inn Court to the left



Plate 2: General view of trial trench, looking south



Plate 3: Representative section of trial trench, view to west (1m and 0.4m scales)

### Devon Office

AC archaeology Ltd  
Unit 4, Halthaies Workshops  
Bradninch  
Nr Exeter  
Devon  
EX5 4LQ

Telephone/Fax: 01392 882410

### Wiltshire Office

AC archaeology Ltd  
Manor Farm Stables  
Chicklade  
Hindon  
Nr Salisbury  
Wiltshire  
SP3 5SU

Telephone: 01747 820581

Fax: 01747 820440

[www.acarchaeology.co.uk](http://www.acarchaeology.co.uk)