

Land at The Old Parsonage, Woodland, near Ashburton, Devon

NGR SX7913868965

Results of an archaeological watching brief
Planning Ref. Teignbridge District Council 09/01068/FUL

Prepared by:
Chris Caine

On behalf of:
Mr Guy Rogers

Document No: ACD73/2/0

Date: January 2010

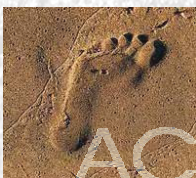

archaeology

Devon County Council Historic Environment Record

Civil Parish & District: Woodland, Teignbridge	National Grid Reference SX7913868965	Number:
Subject: An archaeological watching brief on land at the Old Parsonage, Woodland, Devon		Photo attached Plates 1 & 2
Planning Application no: 09/01068/FUL	Recipient museum: Royal Albert Memorial Museum, Exeter	
OASIS ID: 70350	Museum Accession no: 239/2009	
Contractor's reference number/code: ACD73	Date fieldwork undertaken: 30 July 2009	
<p>Introduction</p> <p>An archaeological watching brief was undertaken by AC archaeology on land at the Old Parsonage, Woodland near Ashburton, during groundworks associated with the construction of a new garage, workshop and parking area. The work was commissioned by the site owner Mr Guy Rogers.</p> <p>The site is located in an area where cropmarks recorded from aerial photographs indicate below-ground evidence for late prehistoric settlement. Immediately to the northwest of the site is a series of features that may be forming enclosures (eg. DCHER refs 24957 and 24958), as well as linear features indicating early land division (24959). To the northeast there is a further circular enclosure (59064).</p> <p>Results</p> <p>The site is located to the northeast of Old Parsonage house on the site of a former stable block (Fig 1a). The stable block had been demolished and removed from site prior to attendance. The areas for the new buildings were stripped of topsoil (Fig. 1b and Plate 1), but this was not to a sufficient depth to establish the presence/absence of buried archaeological features or deposits. Monitoring during the excavation of foundation trenches was subsequently undertaken. The trenches were 0.75m wide and dug by a mechanical excavator using a toothless bucket into the natural subsoil to depths between 0.80m and 1.05m.</p> <p>The recorded layer sequence is shown on Fig. 1c and Plate 2. The natural subsoil (102) was present at a depth of between 0.40m and 0.55m below ground level and was composed of friable light greyish-brown mixed clay and shale. This was below a 0.20m to 0.35m thick layer of mid reddish-brown clayey silt subsoil (101), which was in turn sealed by a 0.20m thick dark reddish-brown clayey silt topsoil (100). With the exception of a modern waste pipe service trench connecting to the main house, no evidence for archaeological features or deposits was identified and no finds were recovered.</p>		
Recorder: Chris Caine, AC archaeology		Date sent to HER: 18 January 2010

a) Site location

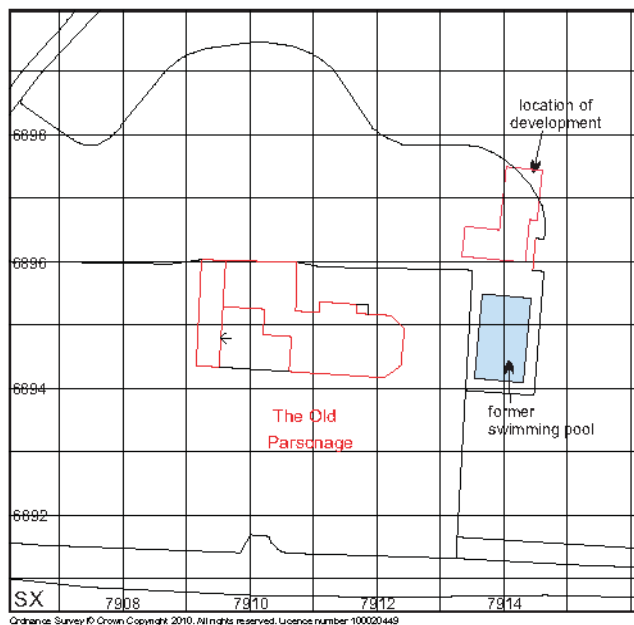

b) Detailed plan of site

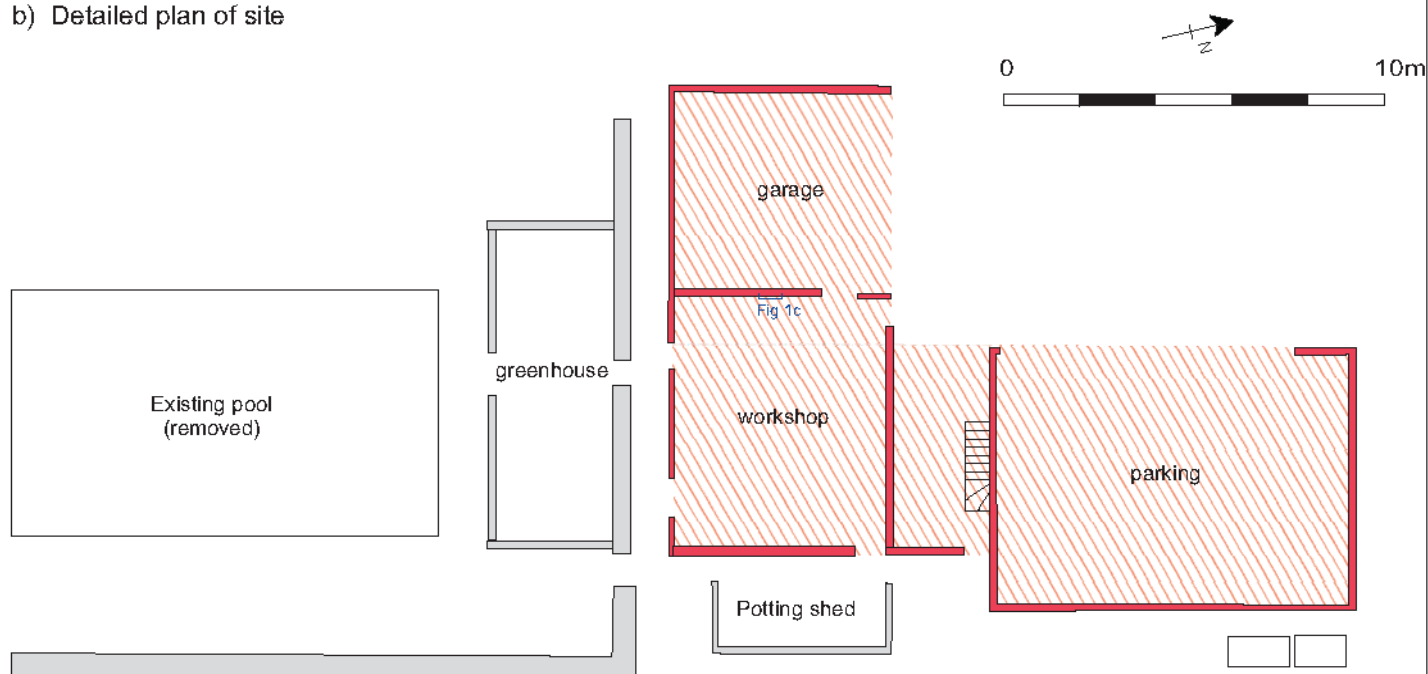

c) Representative section

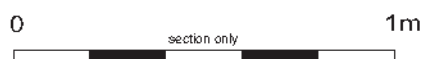
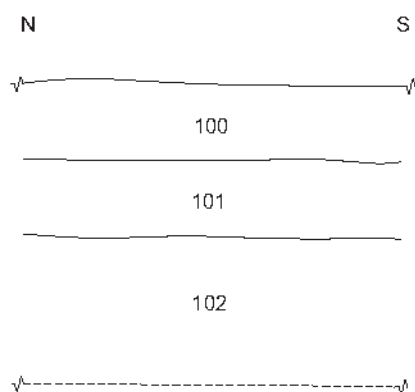

PROJECT

The Old Parsonage, Woodland

TITLE



Fig. 1: Location of site and areas/trenches recorded



Plate 1: General view of site from the west



Plate 2: Representative section, northeast end of site. Viewed from the west (scale 1m)

Wiltshire Office

AC archaeology Ltd
Manor Farm Stables
Chicklade
Hindon
Nr Salisbury
Wiltshire
SP3 5SU

Telephone: 01747 820581
Fax: 01747 820440

Devon Office

AC archaeology Ltd
Unit 4, Halthaies Workshops
Bradinch
Nr Exeter
Devon
EX5 4LQ

Telephone/Fax: 01392 882410

www.acarchaeology.co.uk