

# Land behind Linhay Close, Prescott Road, Culmstock, Devon

NGR ST1003613957

Results of an archaeological trench evaluation

Planning ref. Mid Devon District Council 10/00021/FULL

---

Prepared by:  
Simon Hughes

On behalf of:  
Pearce Construction Ltd

Document No: ACD154/2/0

Date: May 2010



archaeology

---



# Devon County Council Historic Environment Record

<b>Civil Parish &amp; District:</b> Culmstock, Mid Devon	<b>National Grid Reference</b> ST1003613957	<b>Number:</b>
<b>Subject:</b> Archaeological trench evaluation on land behind Linhay Close, Prescott Road		<b>Photo attached:</b> Plates 1 and 2
<b>Planning Application no:</b> 10/00021/FULL	<b>Recipient museum:</b> RAMM, Exeter	
<b>OASIS ID:</b> 77776	<b>Museum Accession no:</b> 96/2010	
<b>Contractor's reference number/code:</b> ACD154	<b>Dates fieldwork undertaken:</b> 20 April 2010	

## Introduction

An archaeological trench evaluation was undertaken by AC archaeology as a condition of planning permission for the erection of six dwellings and construction of new access, on land behind Linhay Close, Culmstock. The work was undertaken on behalf of Pearce Construction Ltd. The site occupies an area of around 0.25 hectares and is located on the NW side of the village in what is currently an agricultural field. It lies at around 103m OD and the underlying solid geology comprises Triassic Mercia Mudstone.

The main archaeological interest for the site is that it is situated c. 20m to the north of a small, single-ditched, possibly prehistoric enclosure, recorded as a cropmark from aerial photographs (DCHER ref. 60218).

## Results

The evaluation comprised the machine-excavation of one trench, with this located along the central footprint of the new houses (Fig. 1 & Plate 1). The trench was 35m long and 1.6m wide.

Excavation established that natural subsoil (layer 102), comprising a mid yellowish-brown sandy clay with occasional small to large gravels/pebbles, was present at a depth of 0.7m below ground level. This was below a 0.6m thick subsoil layer (101), of mid-brown sandy clay, with common small to medium sub-angular gravels, which in turn was beneath a 0.1m thick dark brown sandy clay topsoil (100). No archaeological features were present. A representative section and photograph showing the layer sequence are included on Fig. 2 and as Plate 2.

A small quantity of finds was recovered, with these summarised in Table 1. Two sherds of probable 16th to 17th-century pottery were recovered from subsoil layer 101, with both of these in a coarse orange sandy fabric. Both are body sherds and one piece has an internal green glaze. The later post-medieval/modern pottery ranges in date from the 18th century through to the 20th century, with these comprising mainly plain and glazed redwares. One piece has a trailed yellow slip. Also present are three sherds of industrial whiteware. The clay tobacco pipe fragment is from a stem, while the glass is from a green bottle.

Table 1. Finds summary (weight is in grams)

Context	Burnt flint		Early post-medieval pottery		Later post-medieval/modern pottery		Clay tobacco pipe		Glass	
	No	Wt	No	Wt	No	Wt	No	Wt	No	Wt
100					23	261	1	3	1	4
101	1	2	2	14						
<b>Totals</b>	<b>1</b>	<b>2</b>	<b>2</b>	<b>14</b>	<b>23</b>	<b>261</b>	<b>1</b>	<b>3</b>	<b>1</b>	<b>4</b>

## Comments

There was no *in situ* evidence for archaeological activity within the trench, with the finds recovered dating from the early post-medieval period through to the 20th century. The majority of pottery recovered is small abraded sherds and these are likely to relate to episodes of manuring of the field. No remains relating to the nearby prehistoric enclosure were recorded, with the only potential find of this period comprising the small piece of unworked and imported burnt flint, although this could conceivably have been scorched during more recent stubble clearance.

**Recorder:** Simon Hughes, AC archaeology

**Date sent to HER:** 25 May 2010



b) Trench location

a) Site location

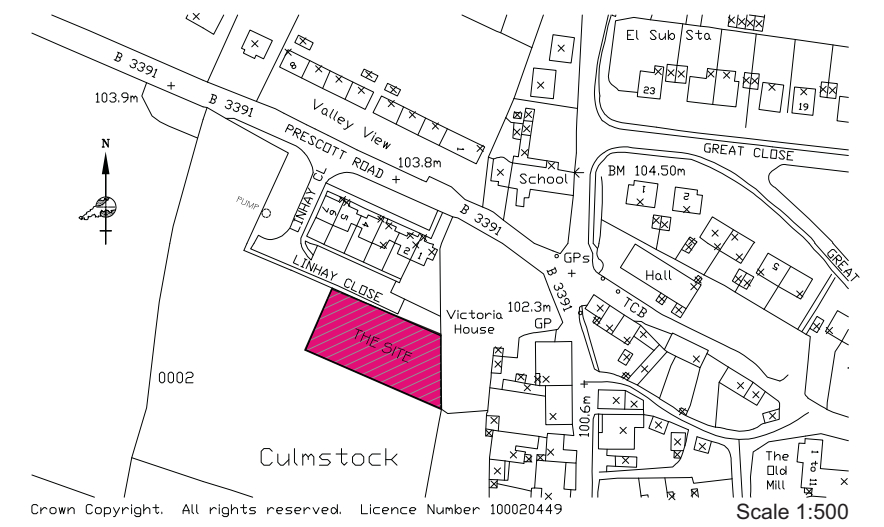

c) Representative section

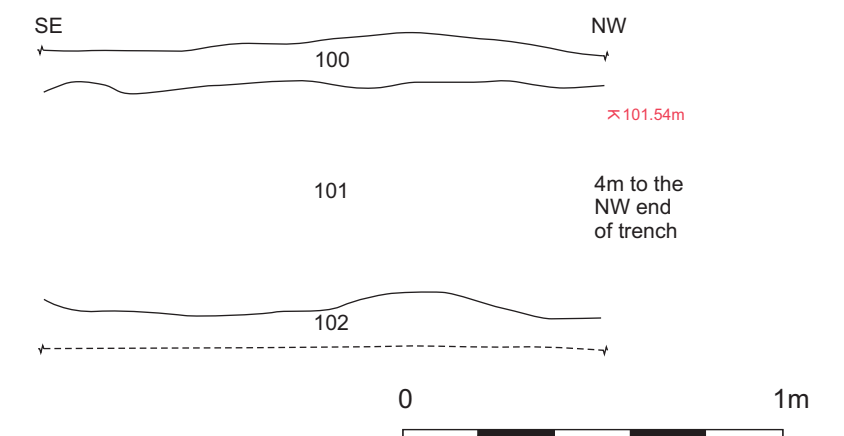

Linhay Close, Culmstock

Fig. 1:  
Site and trench location and  
representative section of trench





Plate 1:  
Recording northwest end of the trench.  
View from the southeast



Plate 2: The general layer sequence at northwest end of trench. View from northeast (scale 1m)

### Wiltshire Office

AC archaeology Ltd  
Manor Farm Stables  
Chicklade  
Hindon  
Nr Salisbury  
Wiltshire  
SP3 5SU

Telephone: 01747 820581  
Fax: 01747 820440

### Devon Office

AC archaeology Ltd  
Unit 4, Halthaies Workshops  
Bradninch  
Nr Exeter  
Devon  
EX5 4LQ

Telephone/Fax: 01392 882410

[www.acarchaeology.co.uk](http://www.acarchaeology.co.uk)