

# Vaughan Tapscott Glove Factory, White's Lane, Great Torrington

An Historic Building Recording Survey



© Context One Archaeological Services 2012

# Vaughan Tapscott Glove Factory, White's Lane, Great Torrington

An Historic Building Recording Survey

for

Colro-Green Developments Ltd

by



Brickfield Offices, Maperton, Wincanton, Somerset. BA9 8EG.

T: 01963 824696

F: 07092 259858

E: [mail@contextone.co.uk](mailto:mail@contextone.co.uk)

W: [www.contextone.co.uk](http://www.contextone.co.uk)

**COAS reference:** COAS/SBR/11/VTG

**Torrige District Council Planning Reference:** 1/1396/2003/COU

**OASIS ID:** contexto1-123821

**Museum accession no:** NDDMS 2011.55

**Historic Environment Service ref:** ARCH/DM/TO.6383

**National Grid Reference:** SS 4936 1915

**Project Director:** Richard McConnell

**Fieldwork Manager:** Stuart Milby

**Survey:** Tara Fairclough and Richard McConnell

**Post-Excavation Manager:** Richard Tabor

**Report:** Richard Tabor

**Graphics:** Tara Fairclough

September 2012

Context One Archaeological Services Ltd shall retain the copyright of any commissioned reports, tender documents or other projected documents, under the Copyright, Designs and Patents Act 1988 with all rights reserved, excepting that it hereby provides an exclusive licence to the client for the use of such documents by the client in all matters directly relating to the project as described in the Project Design/Specification/Written Scheme of Investigation.

Front cover image: Gloving mannequin (Richard McConnell) © Context One Archaeological Services 2012

## Contents

Non-technical Summary.....	i
1. Introduction .....	1
2. Site location, topography.....	1
3. Survey methodology.....	3
4. Historic background .....	5
5. Results.....	6
6. Archive .....	31
7. COAS Acknowledgements.....	32
8. Bibliography .....	32

### Illustrations

Figure 1. Site setting showing relevant HER information .....	2
Figure 2. Map regression 1822 - 1968/83.....	4
Figure 3. Detailed site setting showing exterior photographic locations and viewpoints .....	7
Figure 4. Ground floor plan showing photographic locations and viewpoints .....	13
Figure 5. First floor plan showing photographic locations and viewpoints.....	20
Figure 6. Second floor plan showing photographic locations and viewpoints .....	25

### Plates

Plate 1. The Site exterior (from SE; 2m scale).....	8
Plate 2. The Site exterior (from SW; 2m scale).....	8
Plate 3. The Site exterior (from SSE; 2m scale) .....	8
Plate 4. The Site exterior (from NW; 2m scale).....	9
Plate 5. The Site exterior (from NE; 2m scale) .....	9
Plate 6. The Site exterior, vent (from NNW; no scale) .....	10
Plate 7. The Site exterior, press emblem (from ENE; no scale).....	10
Plate 8. The Site exterior, gloving emblem (from ENE; no scale) .....	10
Plate 9. The Site exterior, front entrance (from ENE; 2m scale) .....	11
Plate 10. Groundfloor, front entrance (from WSW; 2m scale) .....	11
Plate 11. Area 1, office and safe (from SSE; 2m scale).....	14
Plate 12. Area 2, stairwell (from NNW; 2m scale).....	14
Plate 13. Area 2, stairwell, looking up (from NNW; no scale).....	15
Plate 14. Area 3, with Area 8 beyond (from NNW; 2m scale) .....	15
Plate 15. Area 4, access, Area 7 belt wheels (from NNW; 2m scale) .....	16
Plate 16. Area 4, access via sliding door (from NNW; 2m scale).....	16
Plate 17. Area 4 (from W; 2m scale).....	16
Plate 18. Area 6 (from NNW; 2m scale) .....	17
Plate 19. Area 7 showing cast iron columns (from ENE; 2m scale) .....	17
Plate 20. Area 7, column base (from SW; 2m scale) .....	17
Plate 21. Area 7, window and quatrefoil cornice (from S; no scale).....	17
Plate 22. Area 8, lean-to interior (from W; no scale) .....	18
Plate 23. Area 5, staircase and brick floor (from NNW; 2m scale) .....	18
Plate 24. Area 5, lean-to interior (from W; no scale) .....	21
Plate 25. First floor (from WSW; 2m scale).....	21
Plate 26. First floor (from NE; 2m scale).....	21
Plate 27. First floor, stairwell (from NNW; 2m scale) .....	22

Plate 28. First floor, west gable window (from WNW; 2m scale).....	22
Plate 29. First floor, column detail (from SW; part 2m scale) .....	23
Plate 30. First floor, Victorian Gothic staircase (from ESE; 2m scale).....	23
Plate 31. Second floor, bays (from ENE; 2m scale) .....	26
Plate 32. Second floor, west gable (from ENE; 2m scale).....	26
Plate 33. Second floor (from NE; 2m scale) .....	26
Plate 34. Second floor, hatch and cage (from SW; no scale).....	27
Plate 35. Second floor, east gable goods access (from WSW; 2m scale) .....	27
Plate 36. Second floor, east gable central window (from SW; 2m scale) .....	27
Plate 37. Air vent, Area 7 (from SSE; Figure 4) .....	28
Plate 38. Heat vent, Area 3 (from ENE; Figure 4) .....	28
Plate 39. Second floor, 'Playtime' poster .....	29
Plate 40. Second floor, posters .....	29
Plate 41. Second floor, 'Phrenology' poster.....	29
Plate 42. Second floor, political poster .....	29
Plate 43. 'Stan Davey October 2** 1926' .....	30
Plate 44. 'R. Allen Dec 20 <sup>th</sup> 1941' .....	30
Plate 45. 'Reginald Allen 1943' .....	30

## Tables

Table 1. Factory exterior features .....	6
Table 2. Ground floor features .....	12
Table 3. First floor features .....	19
Table 4. Second floor features.....	24

## **Non-technical Summary**

*Context One Archaeological Services Ltd carried out a photographic standing building recording at Vaughan Tapscott Glove Factory, White's Lane, Great Torrington (centred on SS 4936 1915). The project was commissioned by Colro-Green Developments Ltd and the work was carried out on the 4<sup>th</sup> January 2012.*

*Gloving in the Great Torrington area was established from at least the early 17<sup>th</sup> century. The success of the local industry culminated in the foundation of the factory in 1884, an event of great significance in the town as it would have greatly improved the efficiency of glove production. The building survived very well at the time of this survey although the machinery had been removed. Evidence in the form of posters and graffiti in the canteen area, some dating back to the earlier 20<sup>th</sup> century, illustrate that it had become central to the local community rather than merely a place of work.*

*Present expectation is that the Site will be sold as it stands. Groundworks undertaken in future will require monitoring and recording as set out above but as a further, discrete, stage in the archaeological programme.*

## 1. Introduction

1.1 Context One Archaeological Services Ltd (COAS) carried out a programme of archaeological works at Vaughan Tapscott Glove Factory, Whites Lane, Great Torrington, centred on SS 4936 1915 (hereafter referred to as the Site) on 4<sup>th</sup> January 2012. The project was commissioned by Colro-Green Developments Ltd.

1.2 The archaeological works were required by the Local Planning Authority (Torrige District Council (TDC)) as a condition of granting planning permission for the conversion of a redundant building to fourteen flats and the provision of car parking (**Planning Application No: 1/1396/2003/COU**). The planning condition requires that:

*‘No development shall take place until the applicant has secured the implementation of a programme of archaeological work in accordance with a written scheme of investigation which has been submitted by the applicant and approved by the Local Planning Authority.’*

1.3 The nature of the archaeological works required was determined by Ms Ann Dick (Archaeologist, Devon County Historic Environment Service (HES)) in a brief for historic building recording and archaeological monitoring and recording, dated 29<sup>th</sup> September 2011. In the brief Ms Dick stated that:

*‘The proposal site comprises the former William Vaughan & Sons’ Glove Factory, which was constructed in 1884. Glove making was formerly an important industry for Torrington, and this building therefore represents a significant element of the town’s historic environment.’*

*‘The site lies in an area of former burgage plots in the historic core of the settlement, within 150 metres of the Parish Church - which is of at least 14<sup>th</sup> century origin. Any ground disturbance in connection with groundworks for associated parking and/or landscaping has the potential to disturb evidence of medieval and later settlement.’*

1.4 Given the archaeological and historic significance of this building and the surrounding area, it was determined that a reasonable archaeological response in mitigation of the conversion works would be to carry out a programme of archaeological works comprising a desk-based appraisal, a Level 2 historic building recording survey and a programme of comprehensive monitoring and recording.

1.5 The requirement for the archaeological work follows advice given by Central Government as set out in Planning Policy Statement (PPS) 5: Planning for the Historic Environment (2010) and in the Local Development Framework Policy on Archaeology.

## 2. Site location, topography

2.1 Great Torrington is in the Torrige district of north Devon. It is c. 9km south-east of Bideford, its nearest neighbouring town, c. 14km south-south-west of Barnstaple and c. 25km north-north-west of Okehampton. The town is set on an east to west ridge effectively forming a cliff overlooking the River Torrige to the south. The Site (centred on NGR SS 4936 1915) is set on an area of level high ground at c. 105m above Ordnance Datum (aOD), c. 340m north of the river which is at c. 31m aOD. To the north of the Site the town lies on a gentler north-west facing dip slope. The former factory building which comprises the Site is west to east oriented, along the north side of Villa Road, where it joins the west side of White’s Lane.

2.2 The underlying geology consists of Bude Formation Carboniferous Sedimentary Sandstone (BGS 2012).

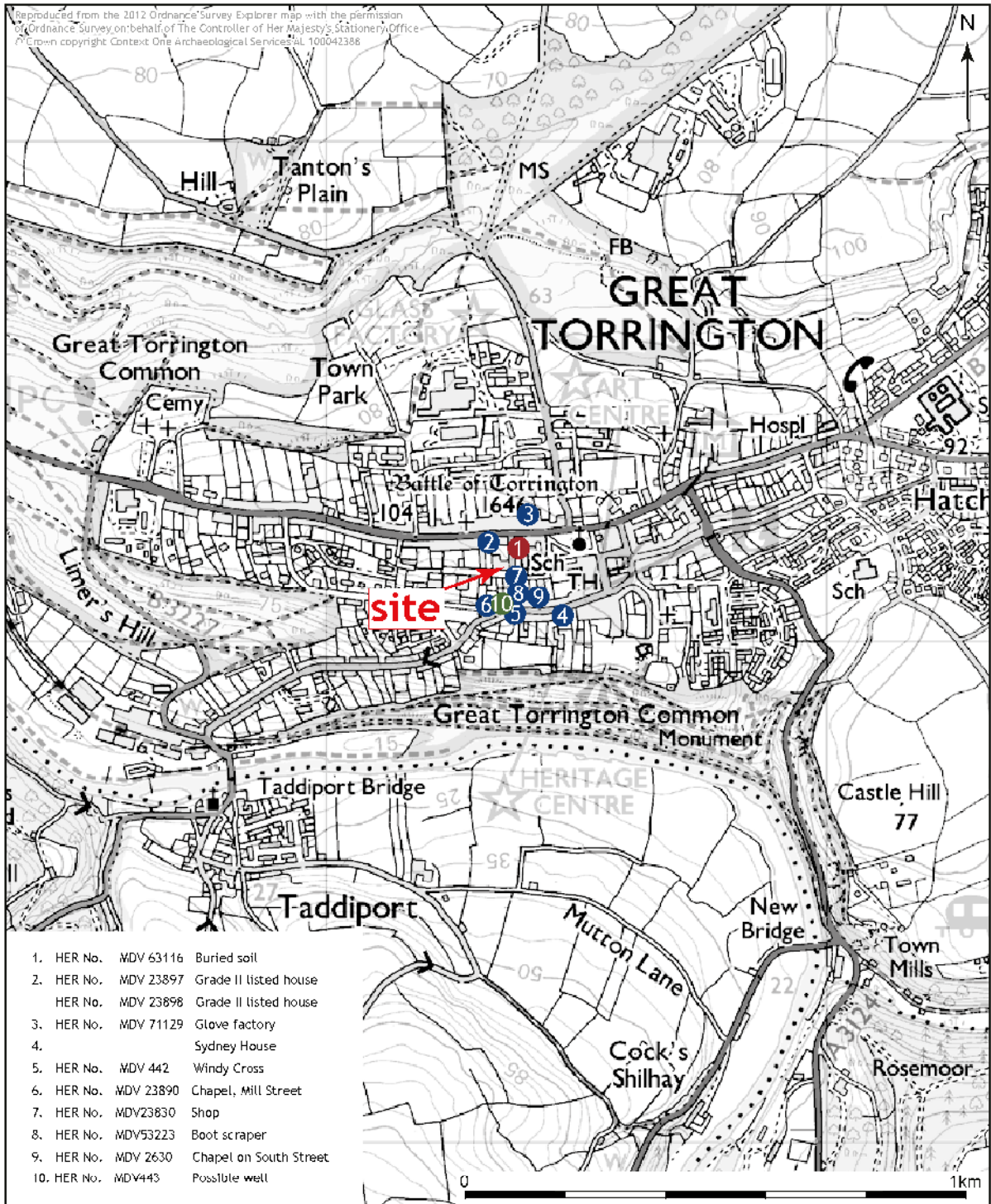

1. HER No. WDV 63116 Buried soil
2. HER No. MDV 23897 Grade II listed house
- HER No. MDV 23898 Grade II listed house
3. HER No. MDV 71129 Glove factory
4. Sydney House
5. HER No. WDV 442 Windy Cross
6. HER No. MDV 23890 Chapel, Mill Street
7. HER No. MDV23830 Shop
8. HER No. MDV53223 Boot scraper
9. HER No. MDV 2630 Chapel on South Street
10. HER No. MDV443 Possible well



- medieval
- post medieval
- undated

PROJECT TITLE		
Vaughan Tapscott Glove Factory, White's Lane, Great Torrington, Devon		
FIGURE TITLE		
Site setting showing relevant HER information		
SCALE	PROJECT CODE	FIGURE NO.
as shown	C1/SBR/11/VTG	1

### 3. Survey methodology

3.1 The principal objectives of the programme were to:

- i) investigate and record any historic building fabric or architectural detail that is obscured, removed or otherwise affected by the development and
- ii) monitor groundworks associated with the development to allow any exposed archaeological deposits to be investigated and recorded.

#### Historic Building Survey

3.2 The programme of archaeological works commenced with a desk-based appraisal to place the Site into its historic and archaeological context. This included map regression based on the Ordnance Survey maps and the Tithe Map(s) and Apportionments. An examination was also made of aerial photographs held by the Historic Environment Service.

3.3 The historic building survey was carried out on completion of the appraisal work. It conformed to a Level 2 survey as set out in *Understanding Historic Buildings - A guide to good recording practice* (English Heritage, 2006). This states that:

*'Level 2 is a descriptive record, made in circumstances similar to those of Level 1 but when more information is needed. It may be made of a building which is judged not to require any fuller record, or it may serve to gather data for a wider project. Both the exterior and the interior will be viewed, described and photographed. The record will present conclusions regarding the building's development and use, but will not discuss in detail the evidence on which these conclusions are based. A plan and sometimes other drawings may be made but the drawn record will normally not be comprehensive and may be tailored to the scope of a wider project.'*

3.4 Plans and sections provided by the Client's architect were used as a basis for the recording of any structural features of historic or architectural significance.

3.5 The photographic survey comprised the exterior and the interior of the former factory, including features of historic and architectural significance. The resulting archive consists of digital images from a digital SLR camera.



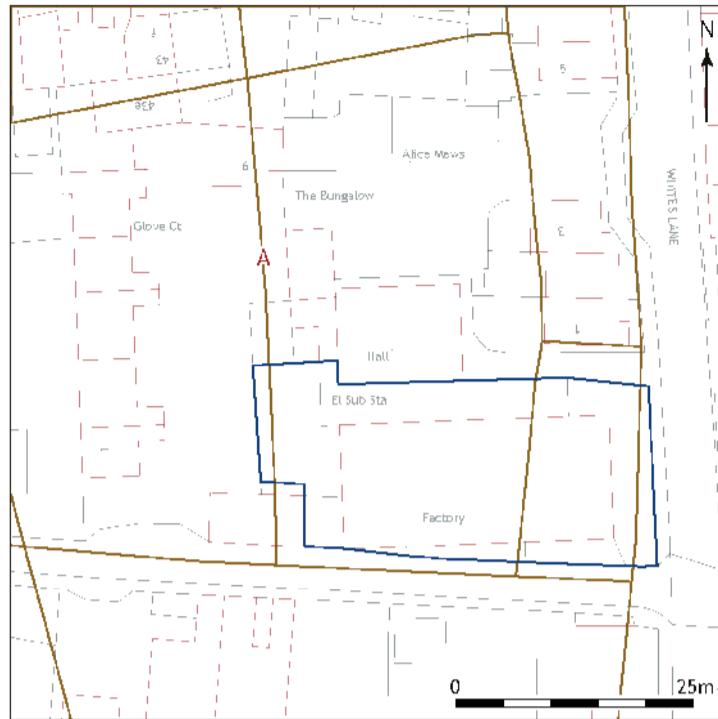

a) Transcription of 1822 Map



b) Transcription of 1843 Tithe Map

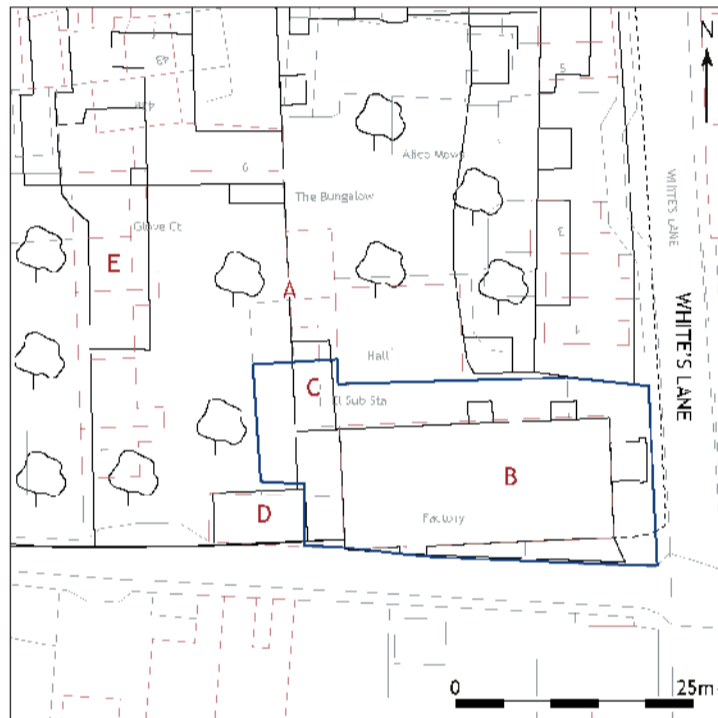

c) Ordnance Survey 25" map transcription, 1887

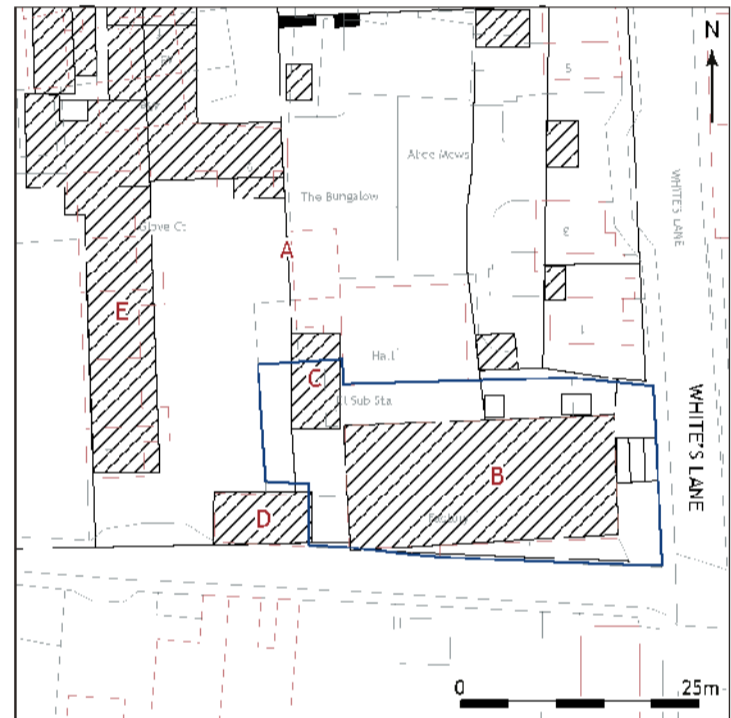

d) Ordnance Survey 25" map transcription, 1904

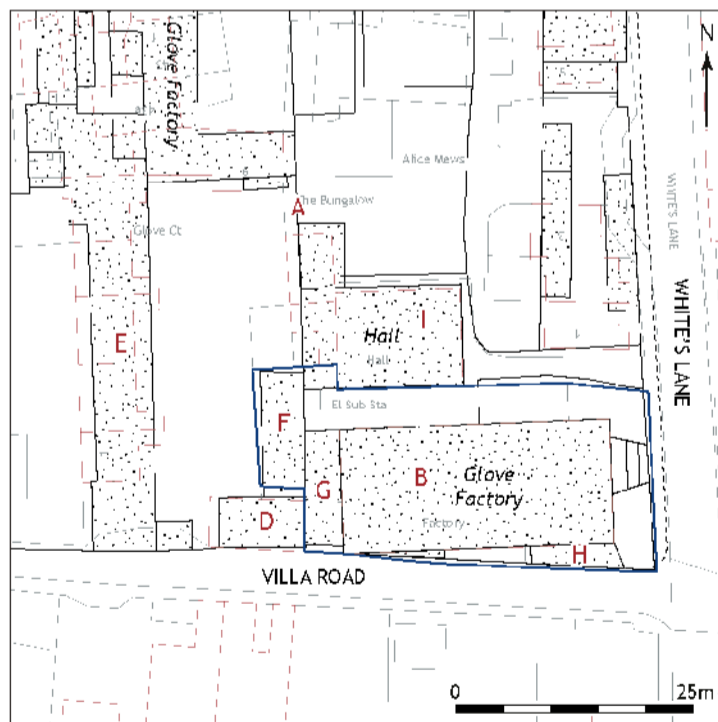

e) Ordnance Survey 25" map transcription, 1955



f) Ordnance Survey 1:2500 map transcription, 1968 - 1983

site extents  
X see text for details

PROJECT TITLE  
Vaughan Tapscott Glove Factory,  
White's Lane, Great Torrington, Devon

FIGURE TITLE

Map regression 1822 - 1968/83

SCALE	PROJECT CODE	FIGURE NO.
as shown	C1/SBR/11/VTG	2

## 4. Historic background

### Post Medieval and Modern (AD 1548 -)

- 4.1 Torrington was the arena of two battles during the English Civil War, a skirmish in 1643 and then a major battle in 1646, which brought to an end Royalist resistance in south west England, centred around 200m north-east of the Site. Earlier in the same century a local gloving industry had already developed as a by-product of wool production (GTI; TMa). By 1833 over 3000 women worked as glovers in the environs of Great Torrington and by 1850 there were no fewer than eleven glove factories in the area, some near the town centre (**Figure 1, 3**). The largest was built for William Vaughan and Sons (**Figure 1, The Site**) in 1884, to a design by W. C. Medland, housing a workforce of 600 in its early days (GTI).
- 4.2 William Vaughan was already in the gloving industry when he moved to Great Torrington from Worcester (TMb). He became an important benefactor to the town, and his strongly Bible Christian (Tmb) sensibility was reflected in the architecture of the factory, as well as in that of Sydney House which he built; the largest house in Great Torrington, this exemplifies how the town benefited from his endeavours (Evans et al. 2011, 6-7; **Figure 1, 4**). He would have been a member of the congregation at the church in South Street.
- Map regression**
- 4.3 The area of the Site is plainly visible opposite a house on the east side of White's Lane, apparently as an undeveloped enclosed area in a town map of 1822 (DRO; **Figure 2a**). A long north to south boundary **A** is plainly visible. This is unchanged in the more detailed setting provided by the Tithe Map of 1843 (**Figure 2b**), equating to plots 1054, owned by the Feoffees of the town, occupied by R. Hole but no use recorded, and 1053, house and Garden. To the south of Villa Road plot 1020, Cross field, is recorded as pasture.
- 4.4 The newly built glove factory (**Figure 2c, B**) appears first in 1887, as well as outbuildings **C** and **D** on either side of boundary **A** which are presumably associated with the factory. Another substantial, broadly rectangular building **E** stands to the west of the boundary, on either side of which trees indicate a wooded aspect. Nearly two decades later (**Figure 2d**) the trees are no longer marked and building **E** has extended southwards by almost 10m.
- 4.5 The following half-century saw further expansion and infilling. A substantial hall was built to the north of the factory (**Figure 2e, I**) and building **E** was extended as far south as Villa Road. An annexe, **G**, has been added to the full width of the west end of the factory, **B**, and a building **F** has been added within the crook of the L-shape it forms with **D**. A further trapezoidal annexe, **H**, has been added to the east end of the factory's south wall. The buildings appear to have remained unaltered until 1983, with the exception of the addition of an electricity substation, **J**, to the west end of the hall (**Figure 2f**). It is notable that building **E** is labelled also as 'Glove Factory' but is unclear whether that represented a change of use or whether it had always been so.

## 5. Results

5.1 The results have been divided into four sections, dealing with the exterior, ground floor, first floor, second floor, architectural features and informal treatment of surfaces. Tables for each section summarise the results of the survey, with relevant plate numbers emboldened and in brackets, under 'Observations'. The plate viewpoints are shown in **Figures 1 to 5**.

### The exterior

5.2 The results of the photographic survey of the exterior are summarised in **Table 1** with viewpoints shown on **Figure 3**. Full exterior elevations by Philip Price are shown in **Appendix 2**.

Element	Observations
Walls	White Marland brick in Flemish bond with red brick and stone dressing ( <b>3</b> )
Roof	Welsh Slate with coped gable-ends including finials at the apexes and corbelled brick eaves ( <b>1, 2</b> ). There is an axial brick chimney stack ( <b>4</b> )
Doors	Main entrance at east end, from White's Lane ( <b>1</b> ). Central recessed doorway with similar brick arch and colonnettes with carved foliage capitals and polished Devon marble shafts, semi-circular fanlight and stone hood-mould with corbel stops in form of crossed hands ( <b>9</b> )
Windows, east gable	Centre advanced, ground floor windows have shouldered stone arches in recesses with pointed brick arches with terracotta fish-scale tympana and stone sills and hood moulds continuing over narrow flanking lancets ( <b>1, 8, 9</b> ) with carved stone medallions. Above them the centre stands proud, with a large stone plate-tracery window with a pointed brick arch, louvered openings to left and right and flanking windows with terracotta fish-scale tympana under red brick pointed arches
Windows, west gable	Pointed brick arches to ground floor windows with terracotta tympana and continuous hood moulds ( <b>4</b> ), arcade of six lancets on first floor and attic lancet in gable with oculus on either side linked by hood mould ( <b>2, 4</b> ). Stone stringcourse at first floor window sill level ( <b>4, 5</b> )
Windows, north and south sides	10-bay north and south sides have continuous hood moulds over alternating pointed and segmental brick arches to ground floor windows ( <b>1, 5</b> ) and four of the first floor windows recessed with pointed brick arches to the attics in gables breaking the eaves ( <b>3</b> )
Medallions	Above the lancets, carved stone medallions above. On the left depicting a glove-press ( <b>7</b> ), on the right, crossed gloves ( <b>8</b> )
Lean-to	Outshot on south side might have been the engine house ( <b>1, 2</b> ). Victorian Gothic style
Other features	Ornate ceramic vents ( <b>6</b> )

Table 1. Factory exterior features

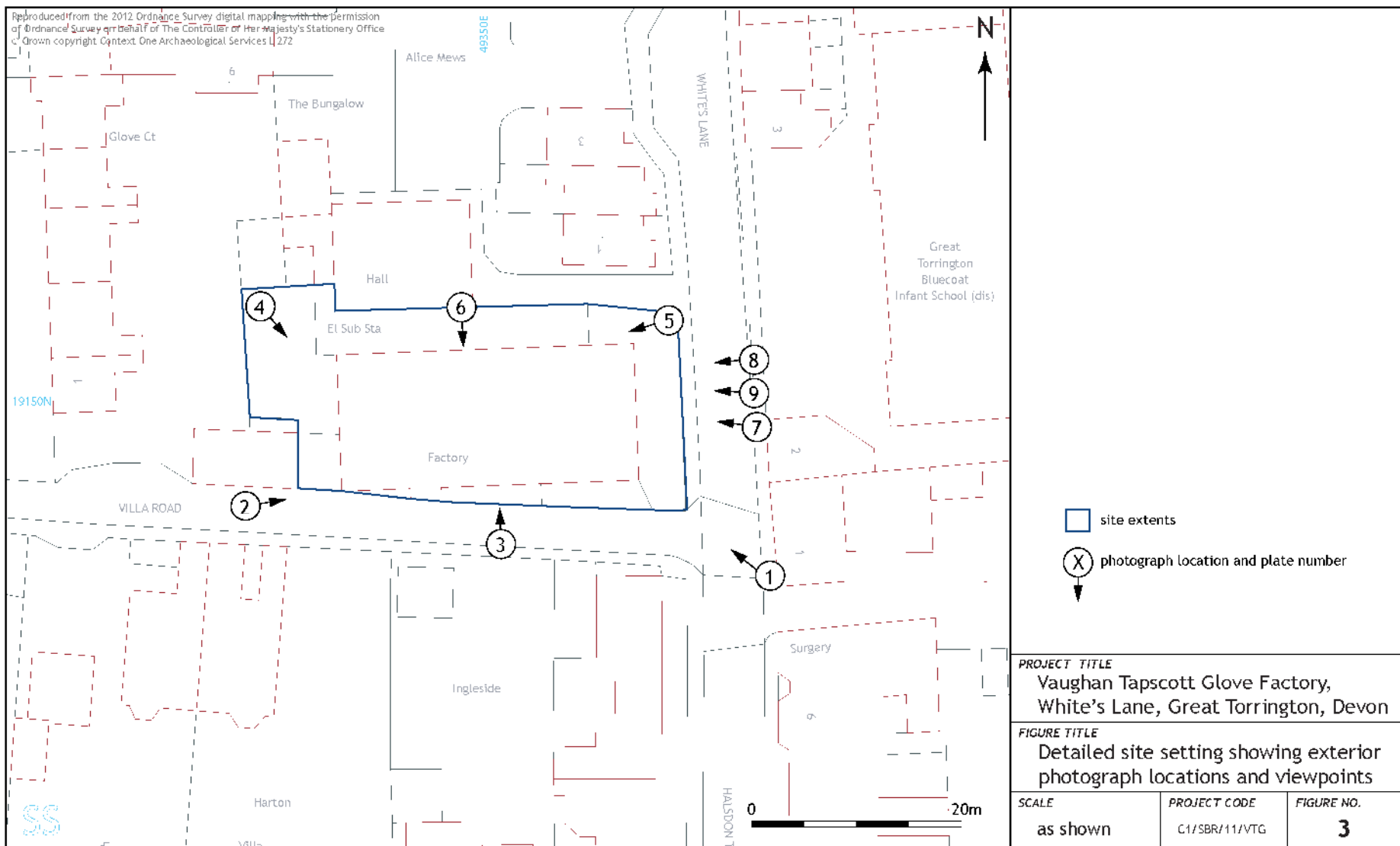



Plate 1. The Site exterior (from SE; 2m scale)



Plate 2. The Site exterior (from SW; 2m scale)



Plate 3. The Site exterior (from SSE; 2m scale)



Plate 4. The Site exterior (from NW; 2m scale)



Plate 5. The Site exterior (from NE; 2m scale)



Plate 6. The Site exterior, ceramic vent (from NNW; no scale)



Plate 7. The Site exterior, press emblem (from ENE; no scale)



Plate 8. The Site exterior, gloving emblem (from ENE; no scale)



Plate 9. The Site exterior, front entrance (from ENE; 2m scale)



Plate 10. Groundfloor, front entrance (from WSW; 2m scale)



### Ground Floor

- 5.3 The results of the photographic survey of the ground floor are summarised in **Table 2** with viewpoints shown on **Figure 4**
- 5.4 Access was via a central entrance (**Plate 10**) at the east end with an office on the right (**Figure 4**, Area 1) defined by later partition walls and a staircase on the left (**Figure 4**, Area 2). In effect, a line of cast iron columns and the north partition walls of Areas 3 and 4 formed an aisled, ten-bay ground floor with a central axial passage. There was a second staircase towards the rear left, Area 5. The ground floor axial passage had a glazed timber screen on the north side and belt drive wheels for machinery.
- 5.5 Access to the first floor is via the Victorian Gothic staircase in Area 5 (**23**).

Element	Observations
Area 1	Office space with safe ( <i>not in situ</i> ) ( <b>11</b> )
Area 2	Stair well ( <b>12, 13</b> ), Victorian Gothic staircase removed; toilet area; decorative floor tiling. Boarded ceiling with pierced quatrefoil cornices ( <b>12</b> )
Area 3	Access from Area 7 via pointed timber frame arch ( <b>14</b> ); allows access to Area 8 through later door. Heat vent high on west wall ( <b>38</b> )
Area 4	Access from Area 7 by either a hinged door, over which belt drives are fitted ( <b>P15</b> ), or a sliding door ( <b>16</b> ). Open space lit by natural and strip lighting, the latter biased towards windows suggesting craft areas on that side. Hinge door access to Area 8 at east end
Area 5	Staircase, Victorian Gothic, with arcaded balustrades and chamfered newels with finials ( <b>23, 24</b> ). Access via central opening from Area 7
Area 6	Access from Area 5 via single leave hinged central door. Space extends across full span of building, from north to south wall. At the time of the survey three modern work benches remained in the room, at least one <i>in situ</i> as it had been modified to fit round a support column. Boarded ceiling with pierced quatrefoil cornices
Area 7	The largest space on the ground floor, freely accessible from all others, including the main entrance. Belt drives fitted at east end to beams ( <b>15, 19</b> ). Offers fullest view of cast iron columns, some of which appear to have been remounted ( <b>20</b> ). Boarded ceiling with some remaining pierced quatrefoil cornices ( <b>21</b> ).
Area 8	Outside on south side ( <b>22</b> ). Tri-cameral, trapezoidal space accessed via hinged single leaf doors from Areas 3 and 4. Possible engine house

Table 2. Ground floor features

Based on client plan drawing number 126/04 Colro Green Dev Ltd

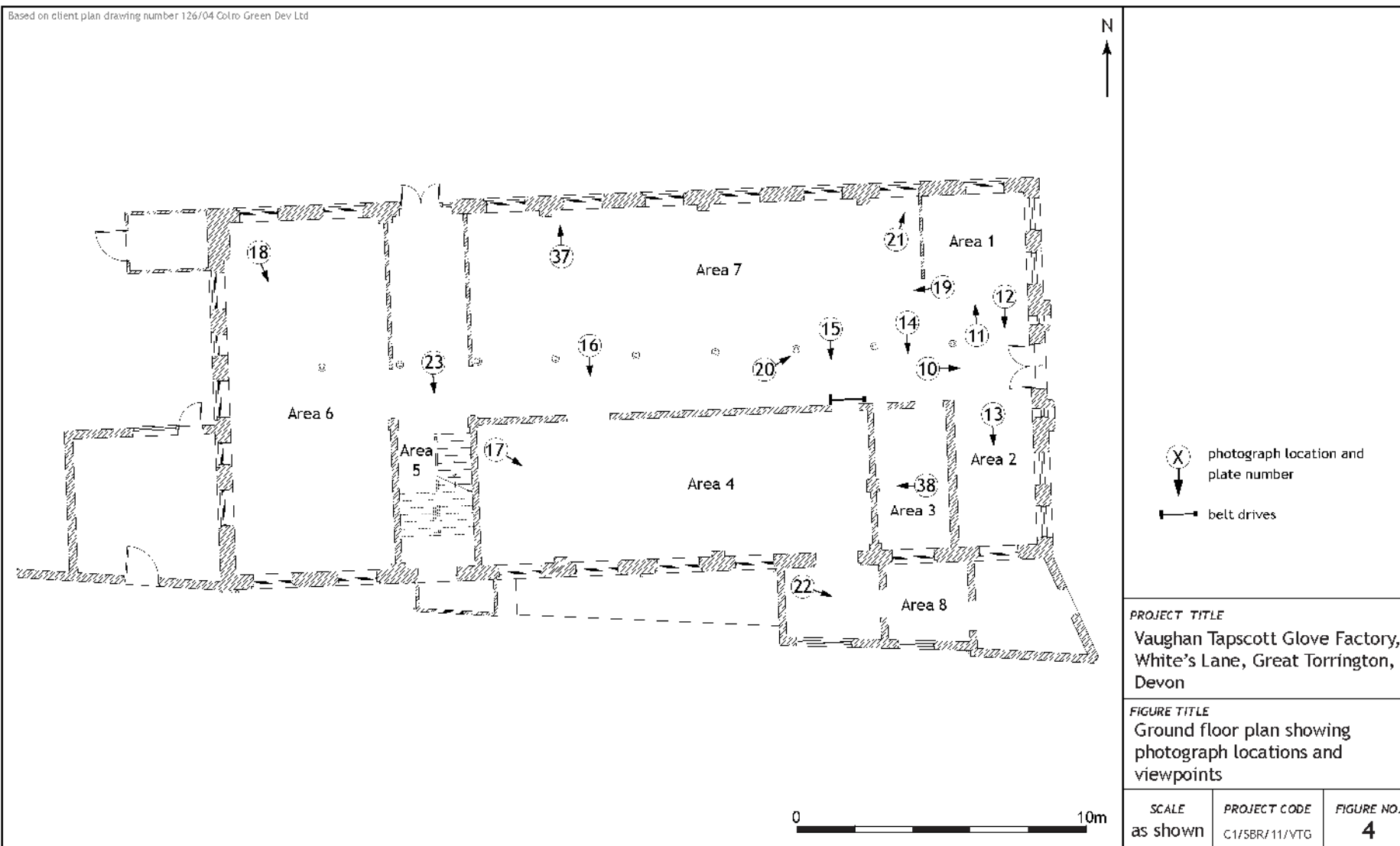

PROJECT TITLE  
 Vaughan Tapscott Glove Factory,  
 White's Lane, Great Torrington,  
 Devon

FIGURE TITLE  
 Ground floor plan showing  
 photograph locations and  
 viewpoints

SCALE as shown	PROJECT CODE C1/SBR/11/VTG	FIGURE NO. <b>4</b>
-------------------	-------------------------------	------------------------



Plate 11. Area 1, office and safe (from SSE; 2m scale)



Plate 12. Area 2, stairwell (from NNW; 2m scale)



Plate 13. Area 2, stairwell, looking up (from NNW; no scale)



Plate 14. Area 3, with Area 8 beyond (from NNW; 2m scale)



Plate 15. Area 4, access, Area 7 belt wheels (from NNW; 2m scale)



Plate 16. Area 4, access via sliding door (from NNW; 2m scale)



Plate 17. Area 4 (from W; 2m scale)



Plate 18. Area 6 (from NNW; 2m scale)



Plate 19. Area 7 showing cast iron columns (from ENE; 2m scale)



Plate 20. Area 7, column base (from SW; 2m scale)



Plate 21. Area 7, window and quatrefoil cornice (from S; no scale)



Plate 22. Area 8, lean-to interior (from W; no scale)



Plate 23. Area 5, staircase and brick floor (from NNW; 2m scale)

### First Floor

- 5.6 The results of the photographic survey of the first floor are summarised in **Table 3** with viewpoints shown on **Figure 5**.
- 5.7 Accessed via a staircase in Area 5 and, formerly, one in Area 2. The floor was supported on thin cast-iron columns over which a further row of columns support the second floor. Open plan, excepting for brick partition walls separating stair wells from the main body of the room. Light timber framed mesh is a recent addition around the hatches through the floor.

Element	Observations
Area 2 stair well	Stair well <b>(27)</b> , Victorian Gothic staircase removed
Area 5 stair well	Staircase, Victorian Gothic, with arcaded balustrades and chamfered newels with finials <b>(24, 30)</b>
Safety cages	Light timber framed mesh is a recent addition around hatches through the floor <b>(25, 26, 28)</b>
Columns	Thin, cast iron columns made by Abbott & Co., Bideford <b>(25, 26, 29)</b>
Windows	See Table 1 for descriptions. East gable arcade of six lancets <b>(25)</b> , west gable six pointed arched <b>(26)</b> , north and south sides, lancets

Table 3. First floor features



Based on client plan drawing number 126/04 Colro Green Dev Ltd

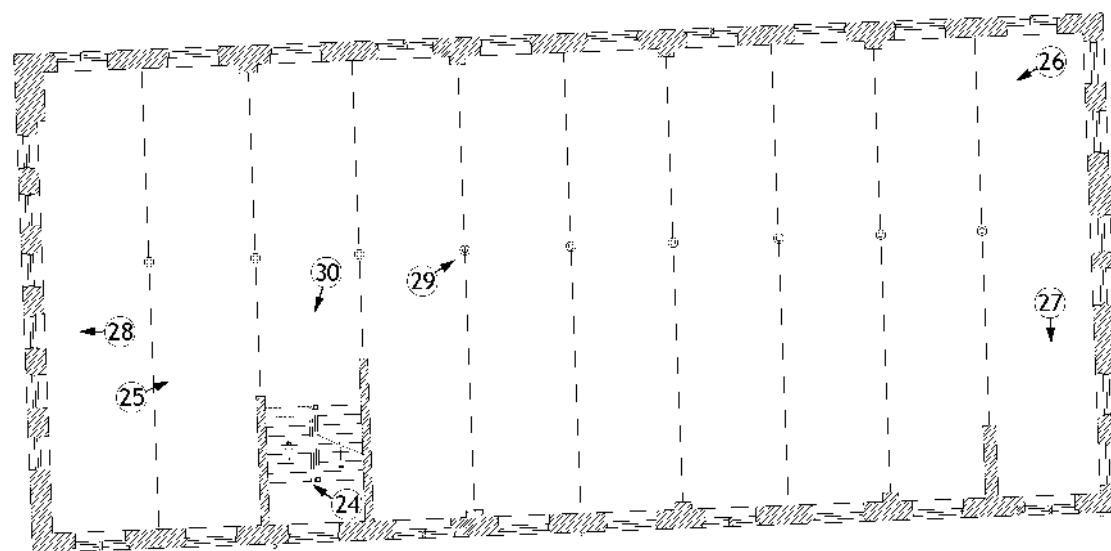

 photograph location and plate number

*PROJECT TITLE*  
 Vaughan Tapscott Glove Factory,  
 White's Lane, Great Torrington,  
 Devon

*FIGURE TITLE*  
 First floor plan showing  
 photograph locations and  
 viewpoints

0  10m

SCALE	PROJECT CODE	FIGURE NO.
as shown	C1/SBR/11/VTG	<b>5</b>



Plate 24. Area 5, detail from Victorian Gothic staircase (from W; no scale)



Plate 25. First floor (from WSW; 2m scale)



Plate 26. First floor (from NE; 2m scale)



Plate 27. First floor, stairwell (from NNW; 2m scale)



Plate 28. First floor, west gable window (from WNW; 2m scale)



Plate 29. First floor, column detail (from SW; part 2m scale)



Plate 30. First floor, Victorian Gothic staircase (from ESE; 2m scale)

## Second Floor

- 5.8 The results of the photographic survey of the ground floor are summarised in **Table 4** with viewpoints shown on **Figure 6**.
- 5.9 The second floor attic is accessed via a staircase in Area 5. Floor was supported from below on thin cast-iron columns, covered with a queen-post roof structure of rectangular section-timbers. The walls were whitewashed walls and as were some roof timbers, particular at the west end.

Element	Observations
Area 5 stair well	Staircase ( <b>23</b> )
Safety cage	Light timber framed mesh is a recent addition around hatch through the floor ( <b>34</b> )
Roof	Queen-post roof structure of rectangular-section timbers ( <b>31, 32, 33</b> )
Doors	Twin-leafed, hinged possible goods access via east gable ( <b>35</b> )
Floor hatch	Goods hatch between second and third upright timbers in north row ( <b>34</b> )
Windows	See <b>Table 1</b> for descriptions. Lit along sides by uppermost part of pointed arched windows ( <b>33</b> ). West gable oculus and lancet windows ( <b>32, 33</b> ), east gable stone plate-tracery window with a pointed brick arch ( <b>36</b> )

Table 4. Second floor features

Based on client plan drawing number 126/04 Colro Green Dev Ltd

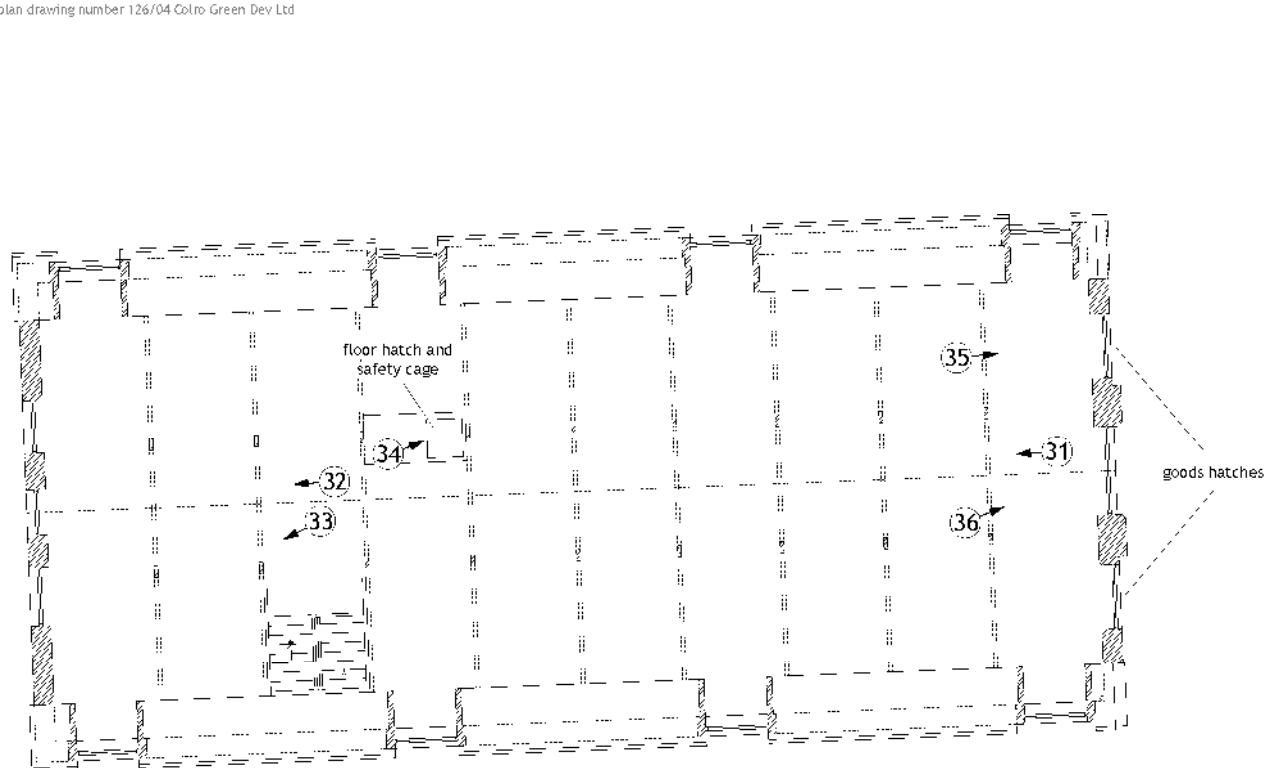

 photograph location and plate number

PROJECT TITLE  
 Vaughan Tapscott Glove Factory,  
 White's Lane, Great Torrington,  
 Devon

FIGURE TITLE  
 Second floor plan showing  
 photograph locations and  
 viewpoints

0  10m

SCALE	PROJECT CODE	FIGURE NO.
as shown	C1/SBR/11/VTG	<b>6</b>



Plate 31. Second floor, bays (from ENE; 2m scale)



Plate 32. Second floor, west gable (from ENE; 2m scale)



Plate 33. Second floor (from NE; 2m scale)



Plate 34. Second floor, hatch and cage (from SW; no scale)



Plate 35. Second floor, east gable goods access (from WSW; 2m scale)



Plate 36. Second floor, east gable central window (from SW; 2m scale)



### Fabric and fittings

- 5.10 The brick from which the factory was made was produced by the Marland Brick and Clay Works Ltd, founded in 1879 and thought to be the first ball clay company to be limited. The company was local, facilitating wider distribution by building its own light railway into Torrington (BCH). The cast iron columns were also relatively local, coming from Abbott & Co. of Bideford (**Plate 29**).
- 5.11 Original fittings appear to include external air vents (**Plate 6**) with brown glazed open-ended boxes and floral motif tubes set into a very gritty cement, and what are presumed to be corresponding iron vents on the inside walls (**Plate 37**). Scorching around a possibly more recent heat vent testifies to the high temperatures involved in some of the gloving processes (**Plate 38**).



Plate 37. Air vent, Area 7 (from SSE; **Figure 4**)



Plate 38. Heat vent, Area 3 (from ENE; **Figure 4**)

### Informal decoration

- 5.12 Several posters and graffiti adorned the west end of the second floor. Among the former, the lighter items included a 'Playtime' poster or magazine cover (**Plate 39**), apparently dated 'March 29 1956', and a group of apparently unrelated pictures (**Plate 40**) with legends 'Some Lovely Jam-Duff' and 'Electric wires falling on pedestrians in a Liverpool street...'. The composition of a third drawing is reminiscent of a 17<sup>th</sup> or 18<sup>th</sup> autopsy scene, although there is no legend to describe it.
- 5.13 More seriously intended is a poster advertising a talk by Prof. Morris on the relationship between phrenology and 'the Character, Talents, and Prospects, from the Head and Faces'. No year is recorded on the poster but a Prof. George Morris, linked to the Young Men's Christian Association, is recorded as a 'leading advocate of phrenology character building' in 1922 (Miller 1922, 216).
- 5.14 Underneath paint and other paper, and appearing to have lines scribbled across it, is a legal proclamation dated '8<sup>th</sup> Jan 1918' regarding the minimum wages for women in the Paper Box Trade. This was part of an ongoing process for establish minimum pay in trades which dated back to 1909.



Plate 39. Second floor, 'Playtime' poster



Plate 40. Second floor, posters

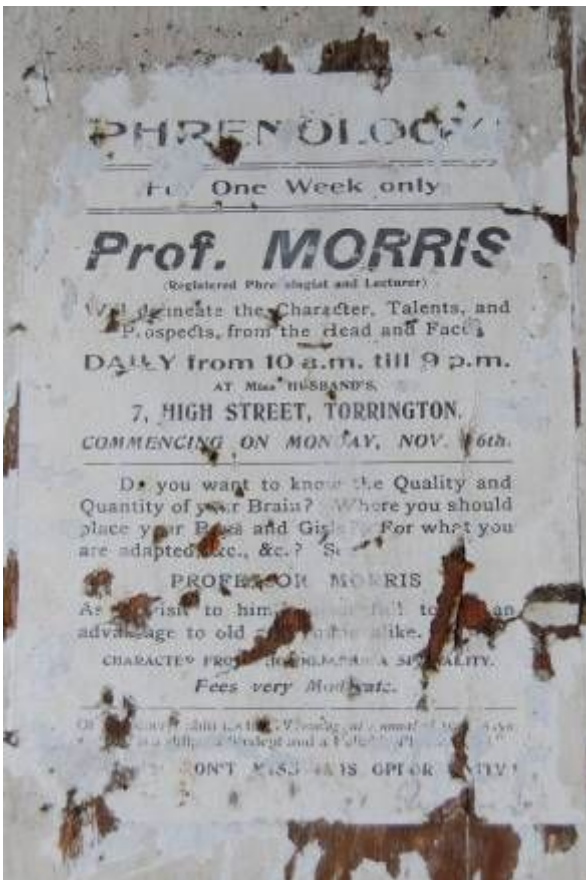

Plate 41. Second floor, 'Phrenology' poster



Plate 42. Second floor, political poster



Plate 43. 'Stan Davey October 2\*\* 1926'



Plate 45. 'Reginald Allen 1943'



Plate 44. 'R. Allen Dec 20<sup>th</sup> 1941'

- 5.15 The persistent desire of people to leave their personal marks is illustrated by names and initials variously pencilled onto, or cut into, whitewash or written on pieces of paper stuck to surfaces and upright timbers. The earliest recorded signature is by Stan Davey in 1926, and a much later 'S. Davey' or 'Dovey' occurs in blue pencil. In the meantime, Reg Allen had made his mark in 1941 and 1943. Perhaps, through all the smaller scale details and events of the factory's history, the two world wars were too big to allow comment or record.

### Discussion

- 5.16 Gloving in the Great Torrington area was established from at least the early 17<sup>th</sup> century. The proliferation of the local industry culminated in the foundation of William Vaughan's factory in 1884, an event of note in the town as it would have greatly improved the efficiency of glove production. Vaughan became the town's leading citizen, not only employing some 600 people, but playing a leading role in his church and in the town council.
- 5.17 The fabric of the building's shell survived very well at the time of this survey, although prior removal of machinery rendered full understanding of its working organisation obscure. However, broad speculative suggestions are possible. On entering from the east the room on the right (area 1) would have served as an office and reception area. Beyond it was the main machine room, served by the belt drives above the door to a small room (area 3). It seems likely that the annexe to its south (area 8) was a boiler room where power was generated to drive the belts.
- 5.18 Some fine work may have been carried out in the far room on the ground floor (area 6) but the well-lit first floor was surely better suited to fine work which may have been done by hand. From there the finished products would have been moved up to the loft for storage, either through the hatch or via the stairs.
- 5.19 The west end of the upper floor clearly served as a rest area. The bays along its north and west sides would have served as storage both for raw materials and for finished products. The former would have been brought into the building via one of the goods hatches through the east gable and the finished products may have been despatched via the same route. It is possible that one was for 'goods in', the other for 'goods out' which would have in part determined the distribution of materials stored.
- 5.20 Evidence from maps shows buildings designated as 'Glove Factory' to the west of the Site by the later 20<sup>th</sup> century, now replaced by recently built houses, perhaps implying expansion of the company within Great Torrington. It is unclear whether they had been purpose built or subsequently modified.
- 5.21 The factory's durability as a centre of the community is reflected in posters and graffiti remaining in the rest area. Some posters advertising local events, national political decisions and entertainment of the particular times, became part of the background as, for reasons of amusement or meaning, they were allowed to remain, periodically supplemented by personal graffiti on the walls.
- 5.22 The building itself is a significant part of the town's archaeological heritage. In addition, its central position within the town, relatively close to the church, should be taken into account when services are provided for the building, including the creation of car parking spaces.
- 5.23 Present expectation is that the Site will be sold as it stands. Groundworks undertaken in future will require monitoring and recording as set out above (section 1.3) but as a further, discrete, stage in the archaeological programme.

## 6. Archive

- 6.1 The archive will be prepared to comply with guidelines set out in Guidelines for the Preparation of Excavation Archives for Long-term Storage (UKIC 1990)/ Standards in the Museums Care of Archaeological Collections (Museum and Galleries Commission 1992)/ Management of Archaeological Projects 2 (English Heritage 1991).
- 6.2 Copies of this report in both printed and digital format will be deposited with:

Colro-Green Developments Ltd  
44 Well Way  
Newquay  
Cornwall  
TR7 3LS

Historic Environment Service  
Devon County Council  
Environment, Economy and Culture Directorate  
Matford Offices  
County Hall  
Exeter  
EX2 4QW

## 7. COAS Acknowledgements

- 7.1 Context One Archaeological Services Ltd would like to thank Colro-Green Developments Ltd for providing ground and floor plans of the Site and Ms Marrina Neophytou (Historic Environment Service, Devon County Council), for providing HER information. We are also very grateful to Mr Philip Price for permitting reproduction of his elevations in Appendix 2.

## 8. Bibliography

- |  |  |
|--|--|
| Ball Clay Heritage Society, The (BCH)                              | How the clay companies evolved (accessed 24 <sup>th</sup> April 2012)  |
| British Geological Survey (BGS), 2012                              | <a href="http://www.bgs.ac.uk">http://www.bgs.ac.uk</a> (accessed 20 <sup>th</sup> April 2012)   |
| British Listed Buildings (BLB), 2012                               | <i>Vaughan Tapscott Gloving Factory, Great Torrington.</i><br><a href="http://www.britishlistedbuildings.co.uk/en-490031-vaughan-tapscott-gloving-factory-great-t">http://www.britishlistedbuildings.co.uk/en-490031-vaughan-tapscott-gloving-factory-great-t</a> (accessed 20 <sup>th</sup> April 2012) |
| Department of the Environment, 2010                                | <i>Planning Policy Statement 5: Her Majesty's Stationery Office</i>  |
| Great Torrington Tourist Information (GTI)                         | <i>A Little Local History.</i> <a href="http://www.great-torrington.com/history/index.html">http://www.great-torrington.com/history/index.html</a> (accessed 20 <sup>th</sup> April 2012)  |
| Institute of Field Archaeologists (IfA), 1985 (rev. 2000)          | <i>Code of Conduct</i> , Reading: IfA  |
| Institute of Field Archaeologists (IfA), 1990 (rev. 2000)          | <i>Code of Approved Practice for the Regulation of Contractual Arrangements in Field Archaeology</i> , Reading: IfA  |
| Institute of Field Archaeologists (IfA), 1994 (rev. 2001 and 2008) | <i>Standard and Guidance for Standing Building Recording</i> , Reading: IfA  |
| Devon Record Office, 1822  | Map of Great Torrington (Ref: Q/S 113A/202/1)  |
| Devon Record Office, 1843  | Tithe Map (Ref: 2239/2/36)   |
| Evans, P., McConnell, R. and Tabor, R. 2011                        | <i>Sydney House Car Park, South Street, Great Torrington, Devon: An Archaeological Desk-based Assessment.</i> COAS, unpublished report   |
| Ordnance Survey, 1887  | 25" map  |

Ordnance Survey, 1904	25" map
Ordnance Survey, 1955	25" map
Ordnance Survey, 1983	1:2500 map
Miller, J. 1922	<i>Applied Character in Human Conversation</i> . Goram Press
Rance, H. 2010	<i>Devon Historic Environment Service: Brief for Historic Building Recording and monitoring of Groundworks</i>
Torrington Museum (TMa)	<i>Display of gloving artefacts in the Museum: Gloving</i> . <a href="http://www.explorenorthdevon.org/clcnres.aspx?cname=Torrington%20Museum&amp;cid">http://www.explorenorthdevon.org/clcnres.aspx?cname=Torrington%20Museum&amp;cid</a> (Accessed 27 <sup>th</sup> April 2012)
Torrington Museum (TMb)	<i>William Vaughan, Great Torrington Museum</i> . <a href="http://www.explorenorthdevon.org/clcnres.aspx?cname=Torrington%20Museum&amp;cid">http://www.explorenorthdevon.org/clcnres.aspx?cname=Torrington%20Museum&amp;cid</a> (Accessed 27 <sup>th</sup> April 2012)

Appendix 1. Devon Historic Environment Service report for archaeological events within the site and its immediate environs

HER No.	Description	NGR	Figure 1 ref.
<b>Medieval (AD1066 - AD1547)</b>			
MDV 63116	<b>Buried soil.</b> Dated to 13 <sup>th</sup> to 15 <sup>th</sup> centuries by pottery	SS 4938 1918	1
<b>Post-Medieval &amp; Modern (AD1547 – present)</b>			
MDV 72628	<b>Glove factory.</b> Grade II listed, built 1884	SS 4935 1914	The Site
MDV 71129	<b>Glove factory.</b>	SS 4940 1925	3
	<b>House.</b> Built for William Vaughan in 1887	SS 4947 1905	4
MDV 442	<b>Windy Cross:</b> Stone Cross. Grade II Listed, now site at pump house over possible well (MDV 443). Relocated	SS 4938 1906	5
MDV 23897	<b>House.</b> Grade II listed, probably early 19 <sup>th</sup> century	SS 4935 1920	2
MDV 23898	<b>House.</b> Grade II listed, early 19 <sup>th</sup> century, stucco	SS 4932 1920	2
MDV 23890	<b>Chapel, Mill Street:</b> Grade II listed, Methodist Chapel dated 1831	SS 4933 1907	6
MDV23830	<b>Shop.</b> Grade II listed, early to mid 19 <sup>th</sup> century, stucco	SS 4938 1913	7
MDV53223	<b>Boot scraper.</b> Decorated with human head, built into house front. 19 <sup>th</sup> century	SS 4938 1909	8
MDV 2630	<b>Chapel on South Street:</b> Bible Christian Chapel and School. Opened in 1866 and closed in 1936	SS 4943 1908	9
<b>Undated</b>			
MDV443	<b>Possible well.</b>	SS 4936 1907	10

© Devon County Council

## Appendix 2. Elevations of the factory exterior prior to development

The following elevations have been reproduced in this report with the permission of Philip Price Architectural and Topographical Surveyors, Old Post Office Chambers, 74a High Street, Bideford, Devon, EX39 2AA.



Vaughan Tapscott Glove Factory, south elevation





Vaughan Tapscott Glove Factory, east elevation



Vaughan Tapscott Glove Factory, west elevation



Vaughan Tapscott Glove Factory, north elevation