

Workshop, Kilkenny Lane, Englishcombe, Bath

A programme of Archaeological Monitoring and Recording



Workshop, Kilkenny Lane, Englishcombe, Bath

A programme of Archaeological Monitoring and Recording

for

Dave Fishlock Properties Ltd.

by



Brickfield Offices, Maperton, Wincanton, Somerset. BA9 8EG.

T: 01963 824696

E: mail@contextone.co.uk

W: www.contextone.co.uk

COAS reference: C1/AMR/13/WKE

National Grid Reference: centred on ST 72415 61566

Planning Application Reference: 12/02731/FUL

Roman Baths Museum & Pump Room Accession Number: BATRM 2013.31

OASIS reference: contexto1-166735

HER event no: EBN3685

COAS project team:

Project Director: Richard McConnell

Fieldwork Manager: Stuart Milby

Post-excavation Manager: Dr Cheryl Green

Fieldwork: Orlando Prestidge

Report: Orlando Prestidge

Illustration: Tara Fairclough

October 2014

Context One Archaeological Services Ltd shall retain the copyright of any commissioned reports, tender documents or other projected documents, under the Copyright, Designs and Patents Act 1988 with all rights reserved, excepting that it hereby provides an exclusive licence to the client for the use of such documents by the client in all matters directly relating to the project as described in the Project Design/Specification/Written Scheme of Investigation.

Contents

Non-technical summary.....	i
1. Introduction.....	1
2. Site location and topography.....	1
3. Methodology.....	3
4. Results.....	3
5. Discussion.....	4
6. Archive.....	4
7. COAS acknowledgements.....	4
8. Bibliography.....	4
Illustrations	
Figure 1. Site setting.....	2
Plates	
Plate 1. Excavations in progress (from S).....	3
Plate 2. NW facing profile (from SE; 1m scale).....	3
Plate 3. SE facing profile (from NW; 1m scale).....	4

Non-technical summary

Context One Archaeological Services Ltd (COAS) carried out a programme of archaeological monitoring and recording associated with the development of a workshop on Kilkenny Lane, Englishcombe, Bath over 1 day on 22 September 2014. The project was commissioned and funded by Dave Fishlock Properties Ltd.

The monitoring programme was advised by Mr Richard Sermon (Senior Archaeological Officer, Bath & North East Somerset Council (BaNES)), following a consultation request from Mr Daniel Stone (Planning Case Officer, Bath & North East Somerset Council (BaNES)). Mr Sermon recommended the implementation of a program of archaeological work due to the proximity of the projected location of the Wansdyke, a post-Roman linear earthwork of national importance.

Despite this, no visible archaeological features or deposits of archaeological interest were encountered during development excavations. No finds were collected or observed during the archaeological programme of works.

1. Introduction

- 1.1 Context One Archaeological Services Ltd (COAS) carried out a programme of archaeological monitoring and recording during groundworks associated with the development of a workshop at Kilkenny Lane, Englishcombe Bath (the 'Site'), over 1 day on 22 September 2014. The project was commissioned and funded by Dave Fishlock Properties Ltd.
- 1.2 The monitoring programme was advised by Mr Richard Sermon (Senior Archaeological Officer, Bath & North East Somerset Council (BaNES)), following a consultation request from Mr Daniel Stone (Planning Case Officer, Bath & North East Somerset Council (BaNES)). In a consultation email dated 14 August 2012 Mr Sermon stated the following:

“The proposed replacement workshop lies in very close proximity to the projected line of the Wansdyke (BANES Historic Environment Record MBN6034), a post-Roman linear earthwork which is of national importance with nearby sections of the monument designated as Scheduled Ancient Monuments (BA93). I would therefore recommend that the following watching brief condition is attached to any planning consent:

No development shall take place within the site until the applicant, or their agents or successors in title, has secured the implementation of a programme of archaeological work in accordance with a written scheme of investigation which has been submitted to and approved in writing by the Local Planning Authority. The programme of archaeological work should provide a controlled watching brief during ground works within the previously undeveloped areas of the site, with provision for excavation of any significant deposits or features encountered.

Reason: The site is within an area of potential archaeological interest and the Council will wish to examine and record items of interest discovered.”

- 1.3 The requirement followed advice by Central Government as set out in paragraph 141 of the *National Planning Policy Framework* (DCLG 2012).
- 1.4 The programme of archaeological works comprised four elements: the production of a Written Scheme of Investigation (WSI) which set out the project strategy; monitoring and recording during development groundworks; post-excavation and report production; and archive deposition. The WSI was approved by Mr Sermon on 16 December 2013.

2. Site location and topography

- 2.1 The Site (centred on NGR ST 72415 61566), was located on Kilkenny Lane, to the south-east of Englishcombe, on the south-western extent of the World Heritage Site of Bath (**Figure 1**). The development itself was situated on the south side of Kilkenny Lane, and directly north of the A367 'Fosse way' Roman road. The Site occupies land situated at c. 150m above Ordnance Datum (aOD).

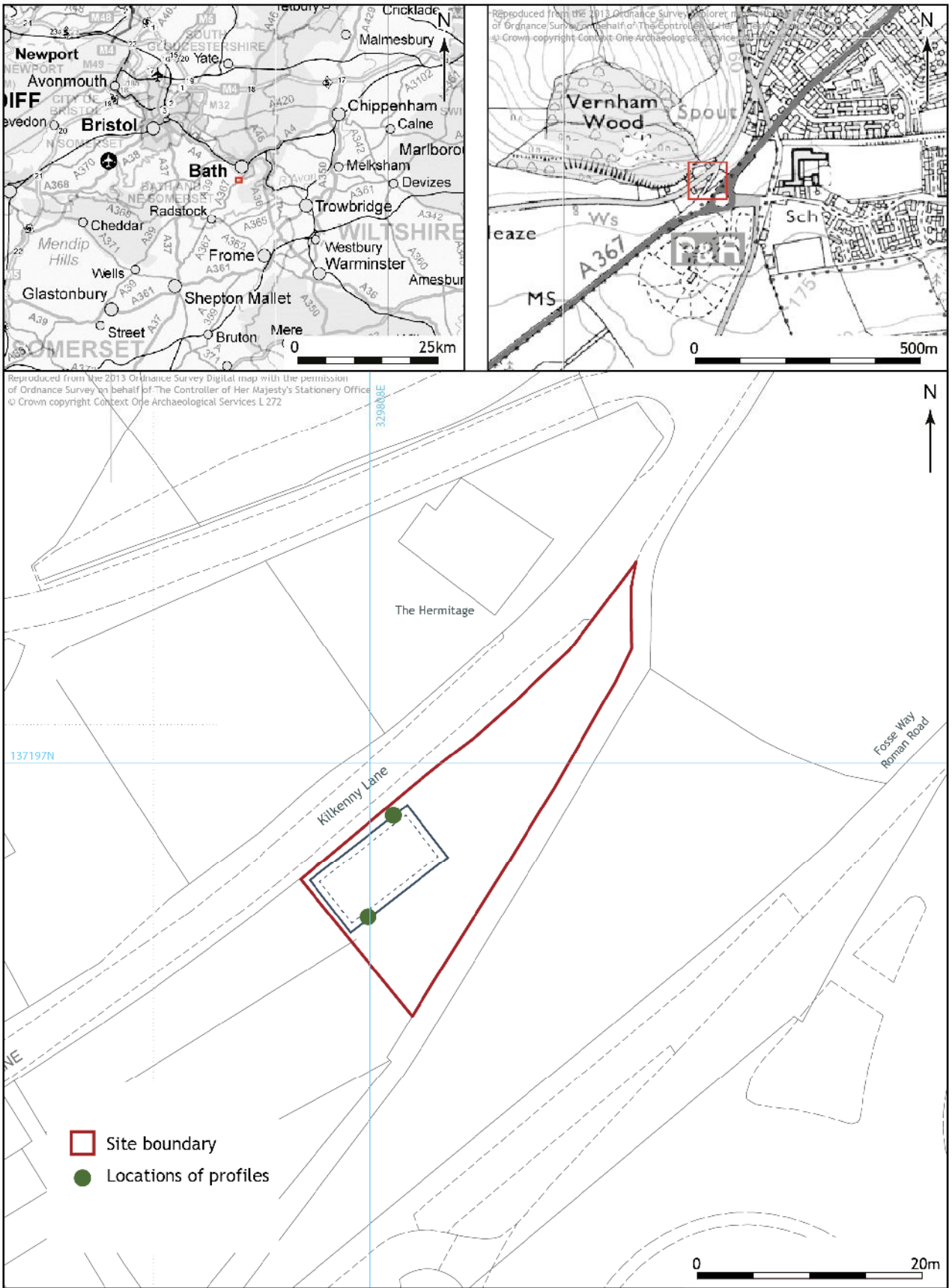

Figure 1. Site setting

Workshop, Kilkenny Lane, Englishcombe, Bath

3. Methodology

Groundworks Methodology

- 3.1 Foundation trenches (c. 11m long and c. 0.60m wide) were excavated down to natural to accept concrete footings for all load bearing walls including all external walls and selected internal partitions. A machine equipped with a 0.60m toothless bucket was used to excavate the trenches (Plate 1).

Archaeological methodology

- 3.2 The programme of archaeological work was carried out in accordance with the codes, standards and guidelines set out by the Institute for Archaeologists (IfA 1985, rev. 2012; 1990, rev. 2008; 1994, rev. 2008). Current Health and Safety legislation and guidelines were followed on Site.
- 3.3 In the absence of archaeological remains, profile sections of the deposit sequence within the trenches were recorded using standard COAS *pro forma* profile recording sheets to illustrate the soil morphology. The profiles were recorded as a graphical representation accompanied by a brief description. Photographs including a suitable scale were also taken and the locations were recorded (see Figure 1).
- 3.4 A photographic record of the fieldwork comprised digital images in .jpg format. As a minimum, the record included photographs of the profile sections, the Site setting and development works.

4. Results

- 4.1 No visible features or deposits of archaeological interest were encountered during the monitoring programme.
- 4.2 Development excavations reached a depth of 1.6m, exposing the natural (Plates 2 & 3). All the excavated deposits were modern comprising areas of root activity and a layer of highly disturbed backfill. This was consistent throughout the trenches, although the level of the natural indicated the presence of a south-east - north-west slope across the Site prior to the levelling of the development area.



Plate 1. Excavations in progress (from S)



Plate 2. NW facing profile (from SE; 1m scale)



Plate 3. SE facing profile (from NW; 1m scale)

5. Discussion

- 5.1 Despite the Site's location in the vicinity of the projected location of the Wansdyke post-Roman earthwork, development excavations did not reveal any evidence of archaeological activity from this period or any other. No visible features or deposits of archaeological interest were encountered during the monitoring programme and no finds were observed.

6. Archive

- 6.1 The project archive is currently held by COAS and consists of the following:

Item	Number	Format
Profile record sheets	1	Paper
Digital images	14	.JPG
Photographic Register	1	Paper

- 6.2 The paper archive has been scanned as a single file in .PDF format and will form part of the physical Site archive to be deposited with the Roman Baths Museum and Pump Room.
- 6.3 Copies of this report will be deposited with the client and included as part of the Bath & North East Somerset Historic Environment Record (HER).

7. COAS acknowledgements

- 7.1 We would like to thank Richard Sermon (Senior Archaeological Officer, BaNES) and Val King (Dave Fishlock Properties Ltd) for their contribution to the successful completion of this project.

8. Bibliography

Bath & North East Somerset Council	<i>Bath City-Wide Character Appraisal Supplementary Planning Document (SPD)</i>
Department for Communities and Local Government (DCLG) 2012	<i>National Planning Policy Framework</i> , London: Her Majesty's Stationery Office
Institute of Field Archaeologists (IfA), June 1985 (rev. November 2012)	<i>Code of Conduct</i> . Reading: IfA
Institute for Archaeologists (IfA), September 1990 (rev. October 2008)	<i>Code of Approved Practice for the Regulation of Contractual Arrangements in Field Archaeology</i> . Reading: IfA
Institute for Archaeologists (IfA), October 1994 (rev. October 2008)	<i>Standard and Guidance for an Archaeological Watching Brief</i> . Reading: IfA



Milby, S., 2013

Written Scheme of Investigation for a Programme of Archaeological Monitoring and Recording: Workshop, Kilkenny Lane, Englishcombe, Bath. Context One Archaeological Services Ltd, unpublished