

WEST MILL, ASKRIGG,  
NORTH YORKSHIRE

ARCHAEOLOGICAL AND  
ARCHITECTURAL SURVEY

VOLUME 2: FIGURES AND PLATES



Ed Dennison Archaeological Services Ltd  
18 Springdale Way  
Beverley  
East Yorkshire  
HU17 8NU

WEST MILL, ASKRIGG,  
NORTH YORKSHIRE

ARCHAEOLOGICAL AND  
ARCHITECTURAL SURVEY

VOLUME 2: FIGURES AND PLATES

Report no: 2010/388.R01  
Version: Final  
Date: September 2012  
Authors: Shaun Richardson & Ed Dennison

Ed Dennison Archaeological Services Ltd  
18 Springdale Way  
Beverley  
East Yorkshire  
HU17 8NU

On behalf of

Professor D Blake  
West Mill  
Askrigg  
Leyburn  
North Yorkshire DL8 3HR

**ARCHAEOLOGICAL AND ARCHITECTURAL SURVEY,  
WEST MILL, ASKRIGG, NORTH YORKSHIRE**

**CONTENTS OF VOLUME 2**

**List of Figures**

- 1 General location.
- 2 Areas of survey.
- 3 Turner's 1816 sketch.
- 4 1839 tithe map.
- 5 Ordnance Survey 1856 map.
- 6 Ordnance Survey 1856 map (detail).
- 7 Ordnance Survey 1893 map (detail).
- 8 Plan with 1908 conveyance.
- 9 Mill Gill power system.
- 10 Ordnance Survey 1912 map (detail).
- 11 1913 conveyance.
- 12 Plan with 1913 conveyance.
- 13 Receipts and invoices 1917-1922.
- 14 Account of work 1943.
- 15 Receipts and invoices 1944.
- 16 Receipts etc 1944-1957.
- 17 Photographs of 1979 and 1984.
- 18 Sketch of West Mill.
- 19 1980s repair works.
- 20 Leas House earthworks.
- 21 Mill Gill earthworks.
- 22 Mill water supply - plan.
- 23 Mill's water supply - section.
- 24 Key to elevations.
- 25 Mill complex - ground floor plan.
- 26 Mill complex - first floor plan.
- 27 Mill complex - second floor plan.
- 28 Mill - external elevations (elevations 1 to 4).
- 29 Mill - internal elevations (elevations 11 to 14).
- 30 Mill - internal elevations (elevations 15 and 16).
- 31 Mill complex - reflected ground floor ceiling plan.
- 32 Garage and kiln range - external elevations (elevations 5, 9 and 10).
- 33 Garage - internal elevations (elevations 17 to 21).
- 34 Kiln range - internal elevations (elevations 22 to 26).
- 35 Barn range - external elevations (elevations 6 to 8).
- 36 Mill - details of frame.
- 37 Power house - plan.
- 38 Poultry house - plan.
- 39 Cheese press.

## List of Plates

- 1 General view of Leas House survey area, looking SE (photo 4/964).
- 2 Leas House survey area, structure (Site 3a), looking N (photo 4/973).
- 3 Leas House survey area, possible kiln (Site 9), looking NE (photo 9/992).
- 4 Leas House survey area, field barn (Site 14), looking NW (photo 9/996).
- 5 Leas House survey area, 1908-10 collecting chamber and weir (Sites 8a and 8c), looking N (photo 9/998).
- 6 Leas House survey area, weir (Site 12a), looking W (photo 4/982).
- 7 Leas House survey area, interior of 1913 collecting chamber (Site 12d) (photo 4/999).
- 8 Leas House survey area, inspection pit on line of 1913 culvert (Site 12b), looking N (photo 4/980).
- 9 Leas House survey area, pond for 1913 scheme (Site 12c), looking SE (photo 4/991).
- 10 Leas House survey area, 1913 collecting chamber (Site 12d), looking E (photo 9/991).
- 11 Leas House survey area, 1913 collecting chamber and pond (Sites 12c and 12d), looking S (photo 9/973).
- 12 Mill Gill survey area, quarry (Site 23), looking E (photo 8/759).
- 13 Mill Gill survey area, track (Site 27) to and from quarry, looking E (photo 8/761).
- 14 Mill Gill survey area, ruined structure (Site 21), looking W (photo 8/764).
- 15 Mill Gill survey area, natural channel or pond (Site 22), looking SW (photo 8/770).
- 16 Mill Gill survey area, building east of the power house (Site 31), looking N (photo 8/815).
- 17 Mill Gill survey area, building east of the power house (Site 31) after repairs, looking NW (photo 9/005).
- 18 Mill Gill survey area, weir and sluice (Site 29a) next to power house, looking NE (photo 6/804).
- 19 Mill Gill survey area, sluice channel (Site 29a) next to power house, looking SE (photo 6/793).
- 20 Mill Gill survey area, mill race (Site 29b), looking E (photo 8/829).
- 21 Mill Gill survey area, mill pond (Site 29c), looking W (photo 7/814).
- 22 Mill Gill survey area, mill pond and sluice (Site 29c), looking SE (photo 9/016).
- 23 Mill Gill survey area, head race (Site 29e), looking N (photo 8/758).
- 24 Mill Gill survey area, sluice arrangement at south end of header tank (Site 29f), looking S (photo 8/753).
- 25 Mill Gill survey area, launder and sluice mechanism (Site 29h), looking SE (photo 8/757).
- 26 Mill Gill survey area, overflow from launder (Site 29g), looking N (photo 9/032).
- 27 Mill (Site 36a), south external elevation (1), looking N (photo 8/745).
- 28 Mill (Site 36a), north external elevation (3), looking S (photo 8/750).
- 29 Mill (Site 36a), west external elevation (2), looking NE (photo 5/553).
- 30 Mill (Site 36a), east external elevation (4), looking W (photo 5/540).
- 31 Mill (Site 36a), ground floor room G2, looking NE (photo 7/058).
- 32 Mill (Site 36a), east wall of ground floor room G4 (elevation 15), looking NE (photo 7/079).
- 33 Mill (Site 36a), daisy mark on south wall of ground floor room G4 (elevation 11), looking S (photo 7/087).
- 34 Mill (Site 36a), launder sluice control on south wall (elevation 11) of first floor room 1F10, looking S (photo 7/978).
- 35 Mill (Site 36a), door in south wall (elevation 11) of first floor room 1F10, looking S (photo 7/981).
- 36 Mill (Site 36a), graffiti on west wall of first floor room 1F11 (elevation 16), looking W (photo 7/969).
- 37 Mill (Site 36a), lathe in first floor room 1F11, looking E (photo 7/961).
- 38 Mill (Site 36a), north wall of second floor room 2F15 (elevation 13), showing stored hay-rake blanks, looking NW (photo 7/867).

- 39 Mill (Site 36a), window at east end of south wall (elevation 11) in second floor room 2F15, looking S (photo 7/887).
- 40 Mill (Site 36a), door in west wall (elevation 16) of second floor room 2F16, looking W (photo 7/889).
- 41 Mill (Site 36a), inscription 'JPA 1867' to central roof truss in second floor room 2F15, looking SW (photo 7/883).
- 42 Garage (Site 36b), west end of south external elevation (10), looking N (photo 5/567).
- 43 Garage (Site 36b), east external elevation (9), looking W (photo 5/569).
- 44 Garage (Site 36b), ground floor room G7, looking E (photo 7/089).
- 45 Garage (Site 36b), north wall of ground floor room G7 (elevation 19), looking NW (photo 7/100).
- 46 Garage (Site 36b), doorway at east end of north wall (elevation 19) of first floor room 1F12, looking N (photo 7/907).
- 47 Garage (Site 36b), south wall (elevation 21) of first floor room 1F12, looking S (photo 7/936).
- 48 Garage (Site 36b), bench structure lever etc, north wall (elevation 19) of first floor room 1F12, looking N (photo 7/916).
- 49 Kiln range (Site 36c), north external elevation (5), looking S (photo 5/544).
- 50 Kiln range (Site 36c), rear of door in west wall (elevation 22) of ground floor room G6, looking W (photo 7/116).
- 51 Kiln range (Site 36c), passage around kiln in ground floor room G6, looking E (photo 7/136).
- 52 Kiln range (Site 36c), west face of kiln (elevation 26) in ground floor room G6, looking E (photo 7/127).
- 53 Kiln range (Site 36c), perforated clay tiles stacked in ground floor room G6 (photo 7/122).
- 54 Barn range (Site 36d), south external elevation (8), looking NW (photo 5/573).
- 55 Barn range (Site 36d), cart entrance in south external elevation (8), looking NW (photo 5/571).
- 56 Barn range (Site 36d), north external elevation (6), looking S (photo 5/547).
- 57 Mill (Site 36a), waterwheel and launder in wheelhouse (G1), looking N (photo 7/174).
- 58 Mill (Site 36a), pit wheel in ground floor room G2, looking NW (photo 7/023).
- 59 Mill (Site 36a), north post of frame and related beams in ground floor room G2, looking W (photo 7/039).
- 60 Garage (Site 36b), pulley with wooden casing on line shaft in first floor room 1F12, looking NE (photo 7/925).
- 61 Power house (Site 32), south external elevation, looking NE (photo 6/800).
- 62 Power house (Site 32), east external elevation, looking W (photo 8/808).
- 63 Mill Gill survey area, bolts on route of pipeline to power house (Site 30b), looking N (photo 8/776).
- 64 Power house (Site 32), west window in south elevation, looking S (photo 8/780).
- 65 Power house (Site 32), isolator over east doorway, looking E (photo 6/758).
- 66 Power house (Site 32), west internal elevation, looking W (photo 8/784).
- 67 Power house (Site 32), east internal elevation, looking E (photo 8/782).
- 68 Power house (Site 32), 3-phase and neutral supply wiring to west of concrete base, looking E (photo 8/802).
- 69 Power house (Site 32), fitting to external east gable (photo 8/803).
- 70 Poultry house (Site 33), south external elevation, looking N (photo 3/722).
- 71 Poultry house (Site 33), north external elevation, looking SE (photo 3/717).
- 72 Poultry house (Site 33), doorway to central south, looking N (photo 3/724).
- 73 Poultry house (Site 33), flagged culvert of mill race, looking E (photo 8/836).
- 74 Mill Gill survey area, structure to south of poultry house (Site 33),
- 75 Mill Gill house cheese press, looking S (photo 6/808).
- 76 Mill Gill house cheese press, press section, looking S (photo 6/811).



Reproduced from the 1:25,000 scale map by permission of Ordnance Survey® on behalf of The Controller of Her Majesty's Stationary Office, © Crown copyright 1991. All rights reserved. Licence AL100013825

PROJECT	WEST MILL, ASKRIGG	
TITLE	GENERAL LOCATION	
SCALE	NTS	DATE SEPT 2012
	EDAS	FIGURE 1

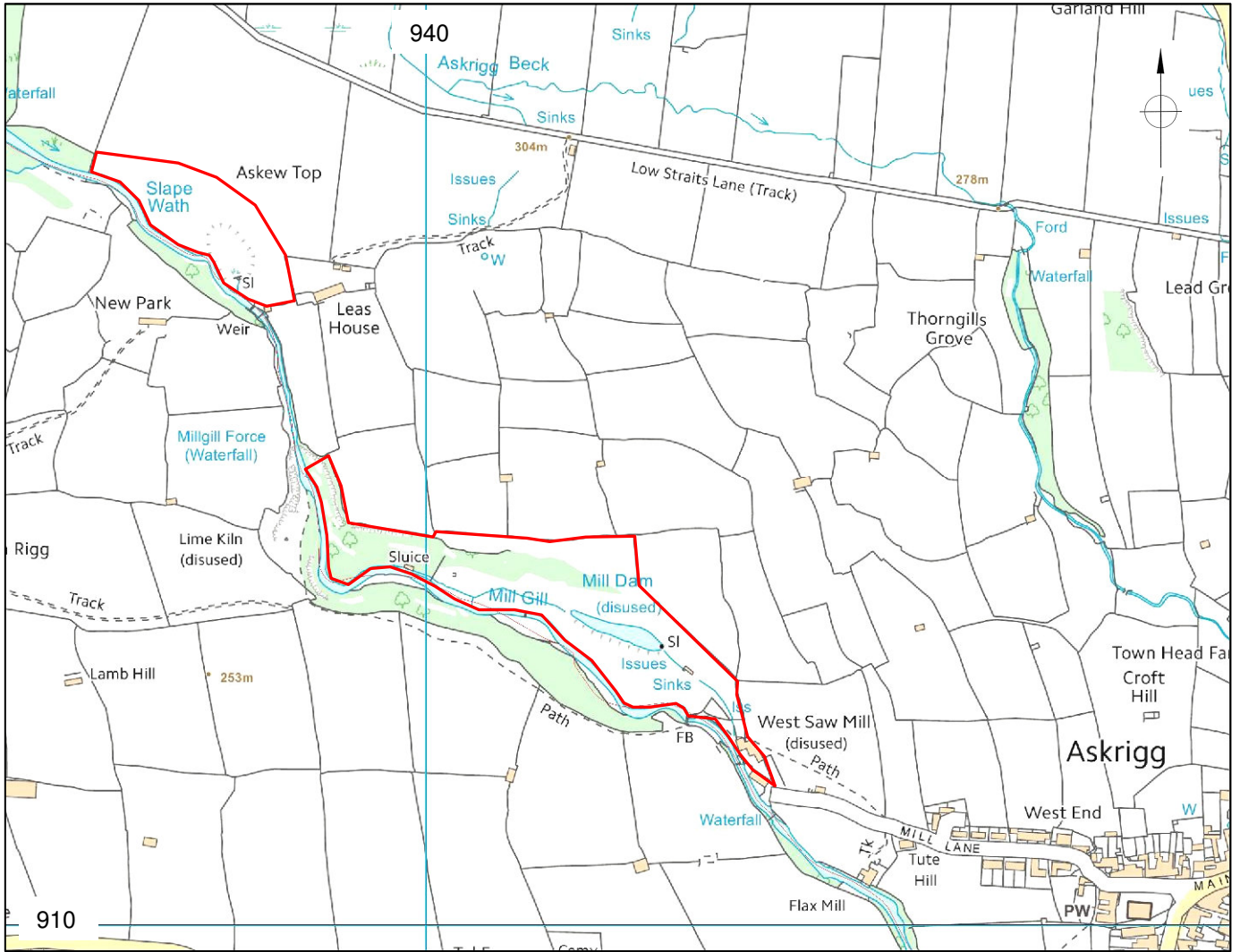

Map base provided by YDNPA.

PROJECT		WEST MILL, ASKRIGG	
TITLE		AREAS OF SURVEY	
SCALE	NTS	DATE	SEPT 2012
EDAS		FIGURE	2



Top: original scan.  
Bottom: enhanced image to show mill and laundry on left hand side with church tower behind.

Source: Blake collection.

PROJECT	WEST MILL, ASKRIGG	
TITLE	TURNER'S 1816 SKETCH	
SCALE	NTS	DATE SEPT 2012
	EDAS	FIGURE 3



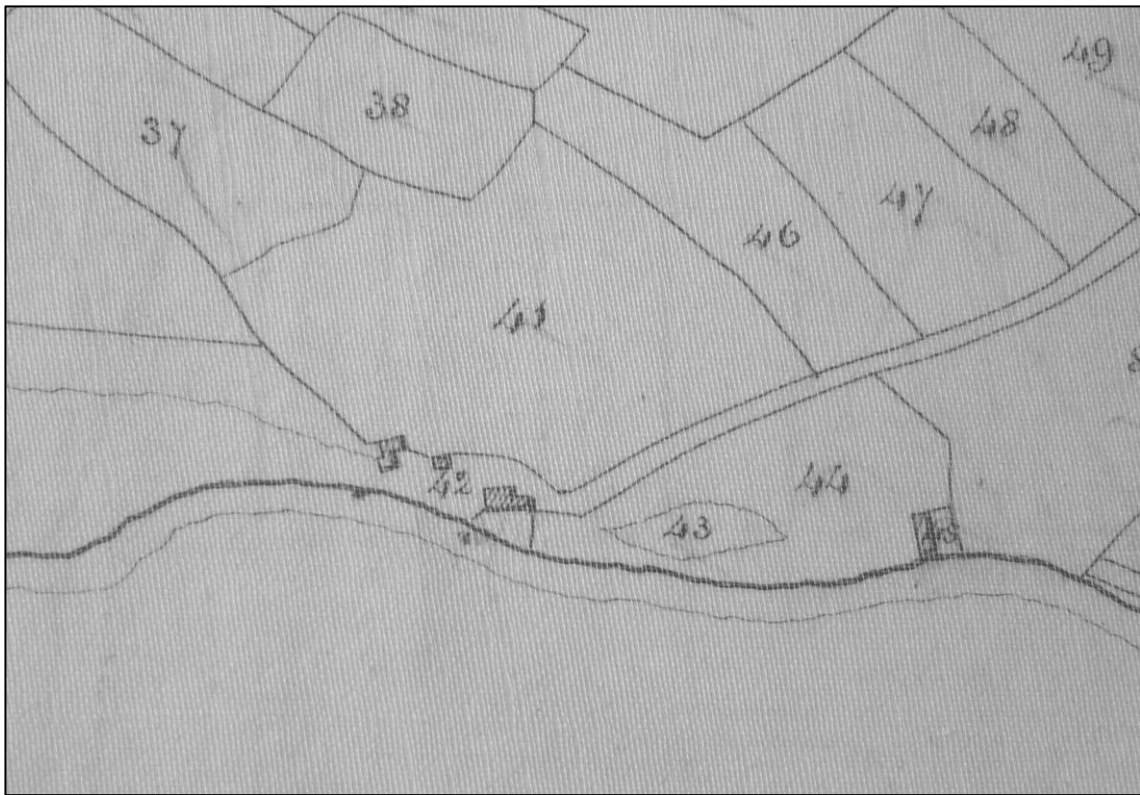

Source: 1839 Askrigg tithe map (WYL RD/RT 12).

PROJECT		WEST MILL, ASKRIGG	
TITLE		1839 TITHE MAP	
SCALE	NTS	DATE	SEPT 2012
EDAS		FIGURE	4

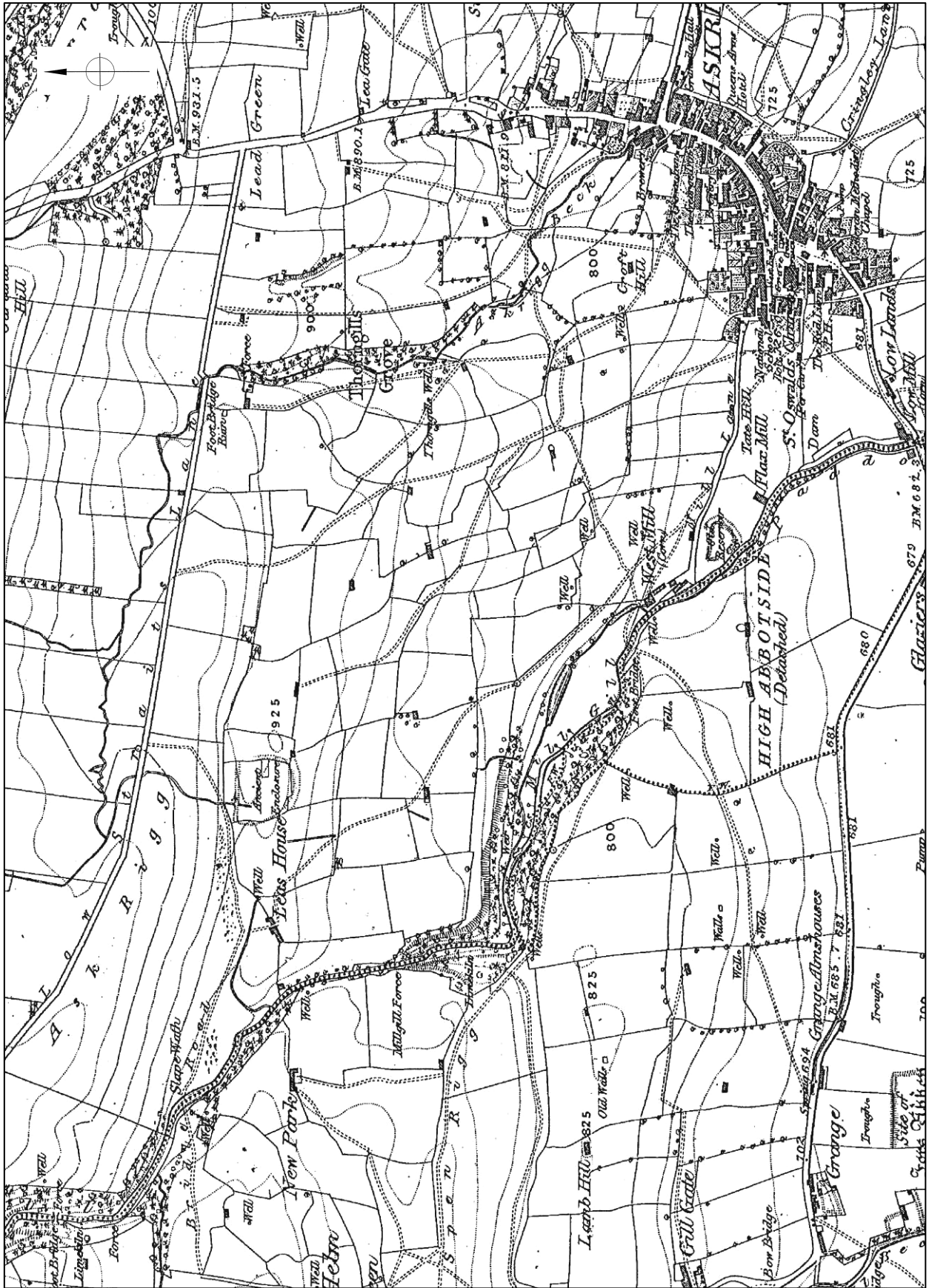

Source: Ordnance Survey 1856 6" map sheet 66 (surveyed 1854).

PROJECT		WEST MILL, ASKRIGG	
TITLE		ORDNANCE SURVEY 1856 MAP	
SCALE	NTS	DATE	SEPT 2012
EDAS		FIGURE	5

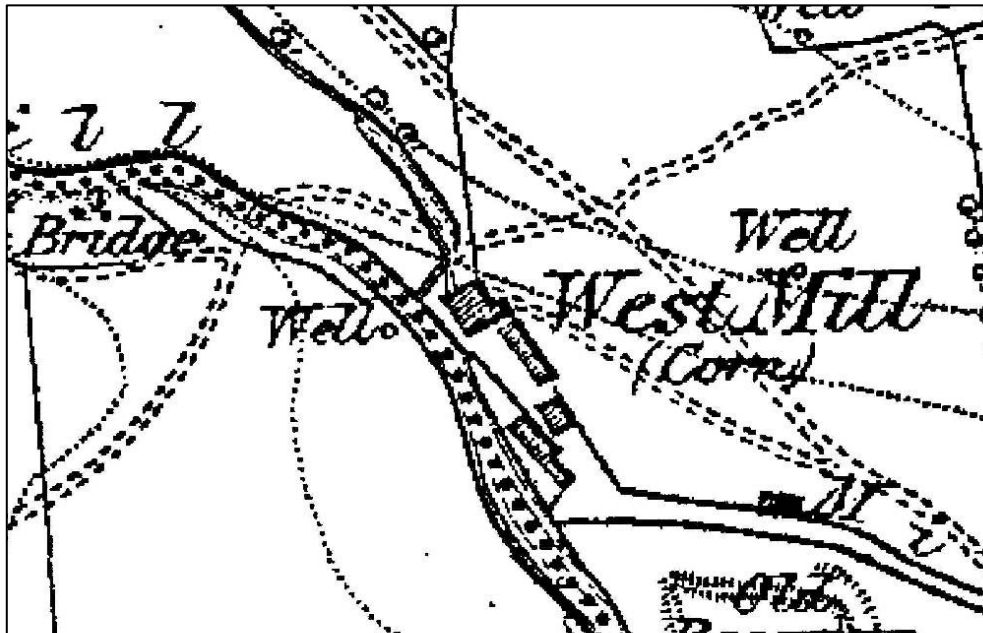
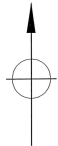
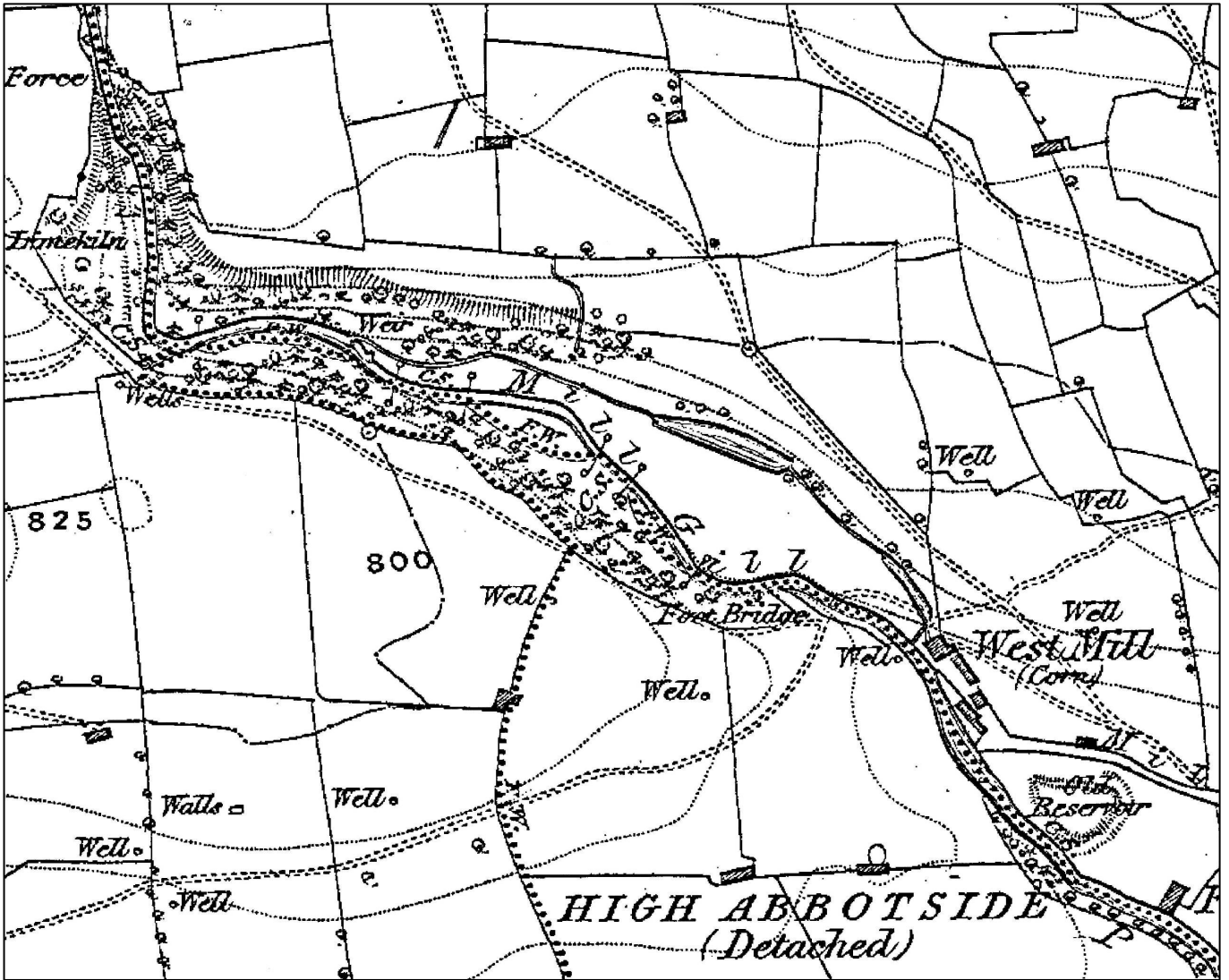

Source: Ordnance Survey 1856 6" map sheet 66 (surveyed 1854).

PROJECT	WEST MILL, ASKRIGG	
TITLE	ORDNANCE SURVEY 1856 MAP	
SCALE	NTS	DATE SEPT 2012
EDAS	FIGURE 6	

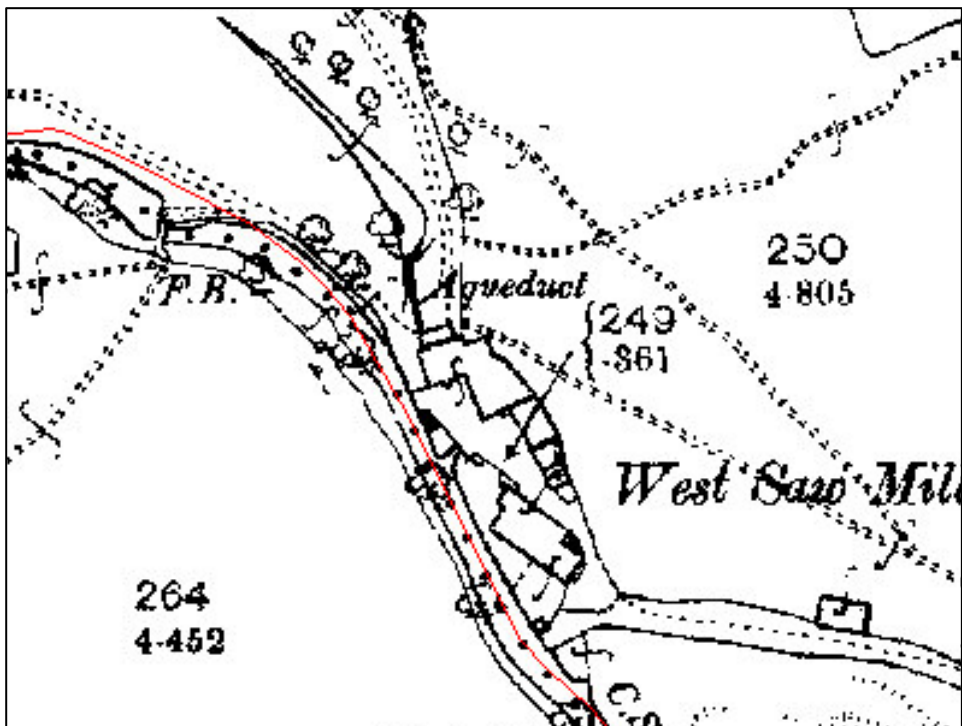
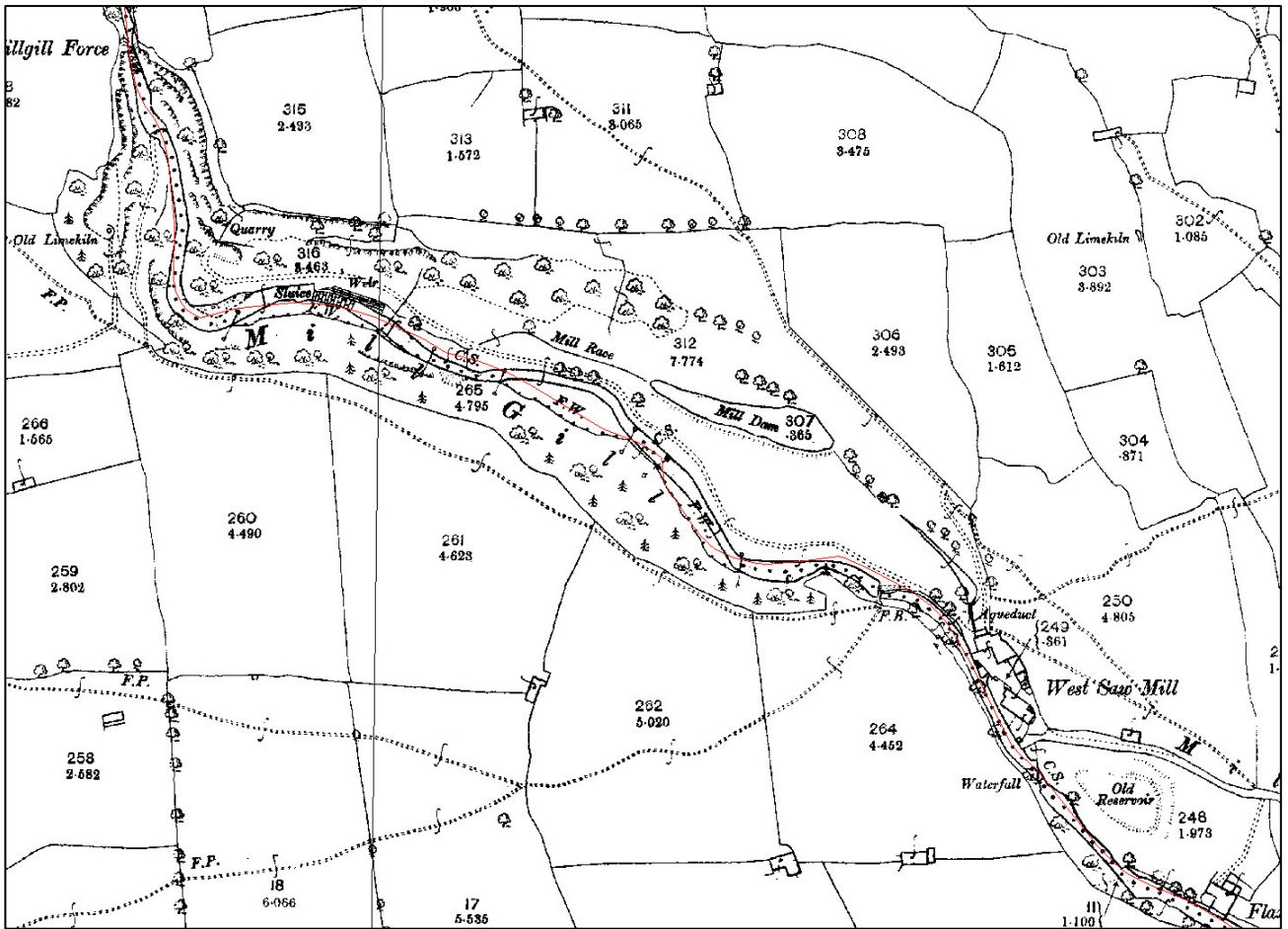

Source: Ordnance Survey 1893 25" map sheet 66/3 (surveyed 1892).

PROJECT		WEST MILL, ASKRIGG	
TITLE			
		ORDNANCE SURVEY 1893 MAP	
SCALE	NTS	DATE	SEPT 2012
EDAS		FIGURE	7

# Plan

REFERRED TO.

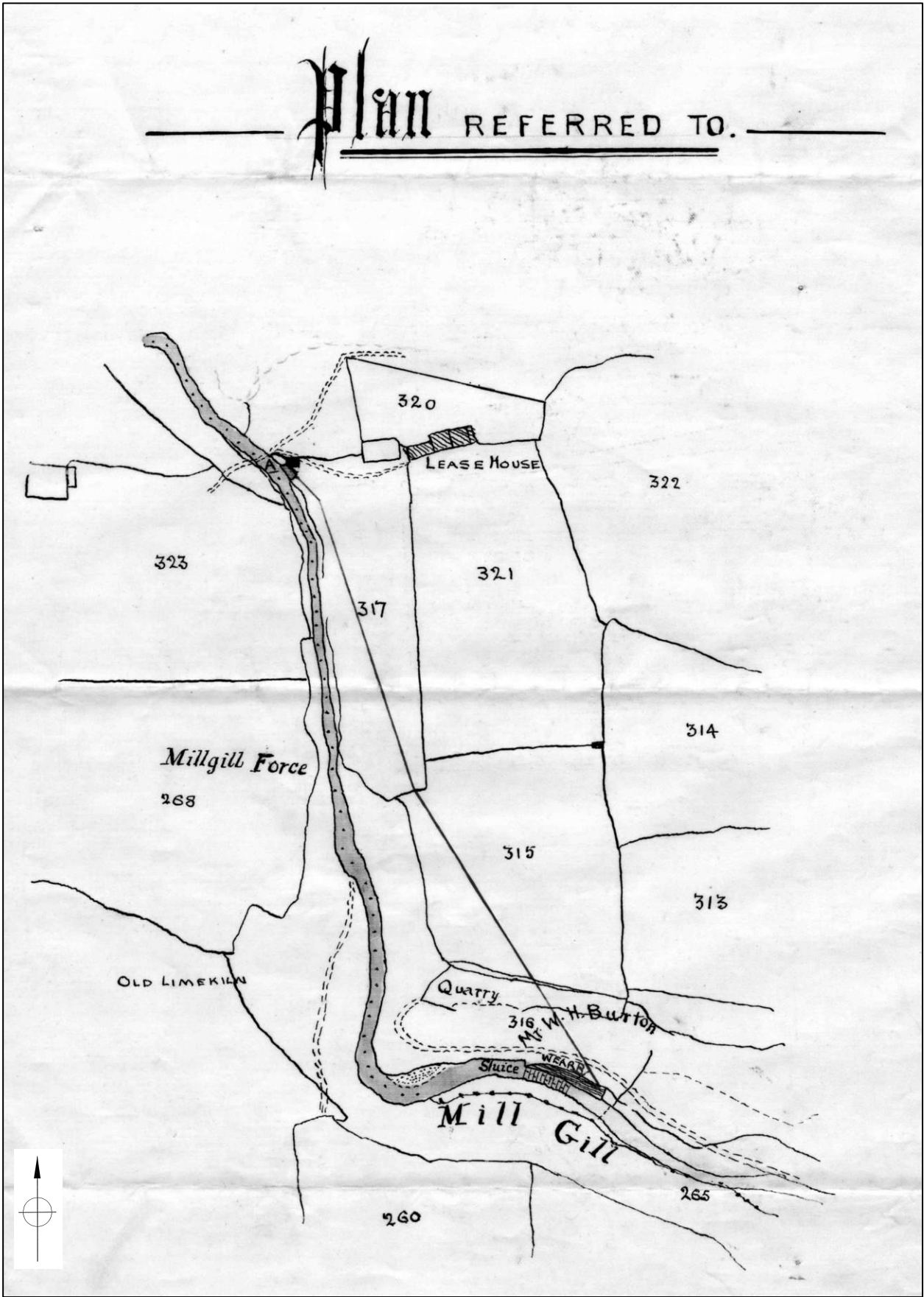

Conveyance of land and grant of easement from Mr Abram Scarr and one other to Mr W H Burton, 29th December 1908. Source: Blake collection.

PROJECT	WEST MILL, ASKRIGG	
TITLE	PLAN WITH 1908 CONVEYANCE	
SCALE	NTS	DATE SEPT 2012
	EDAS	FIGURE 8



Top left: early photograph of original Mill Gill power house before 1913 expansion.  
 Top right: pipeline to Mill Gill power house under construction.  
 Bottom: collection chamber above Mill Gill Force under construction, c.1910.  
 Source: Kershaw collection.

PROJECT		WEST MILL, ASKRIGG	
TITLE			
		MILL GILL POWER SYSTEM	
SCALE	DATE		
NTS	SEPT 2012		
EDAS		FIGURE	9

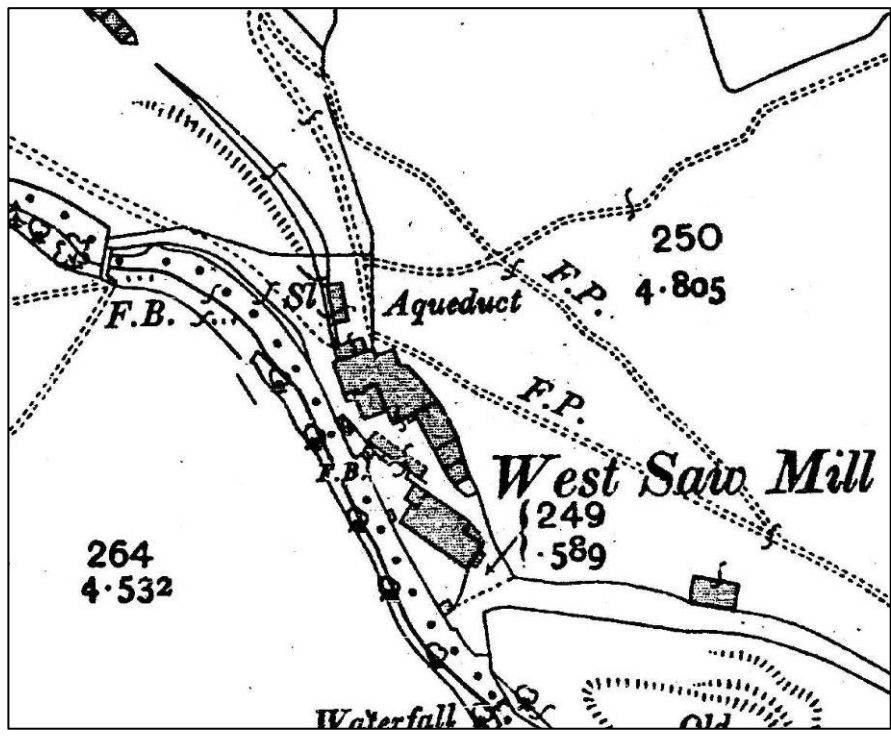
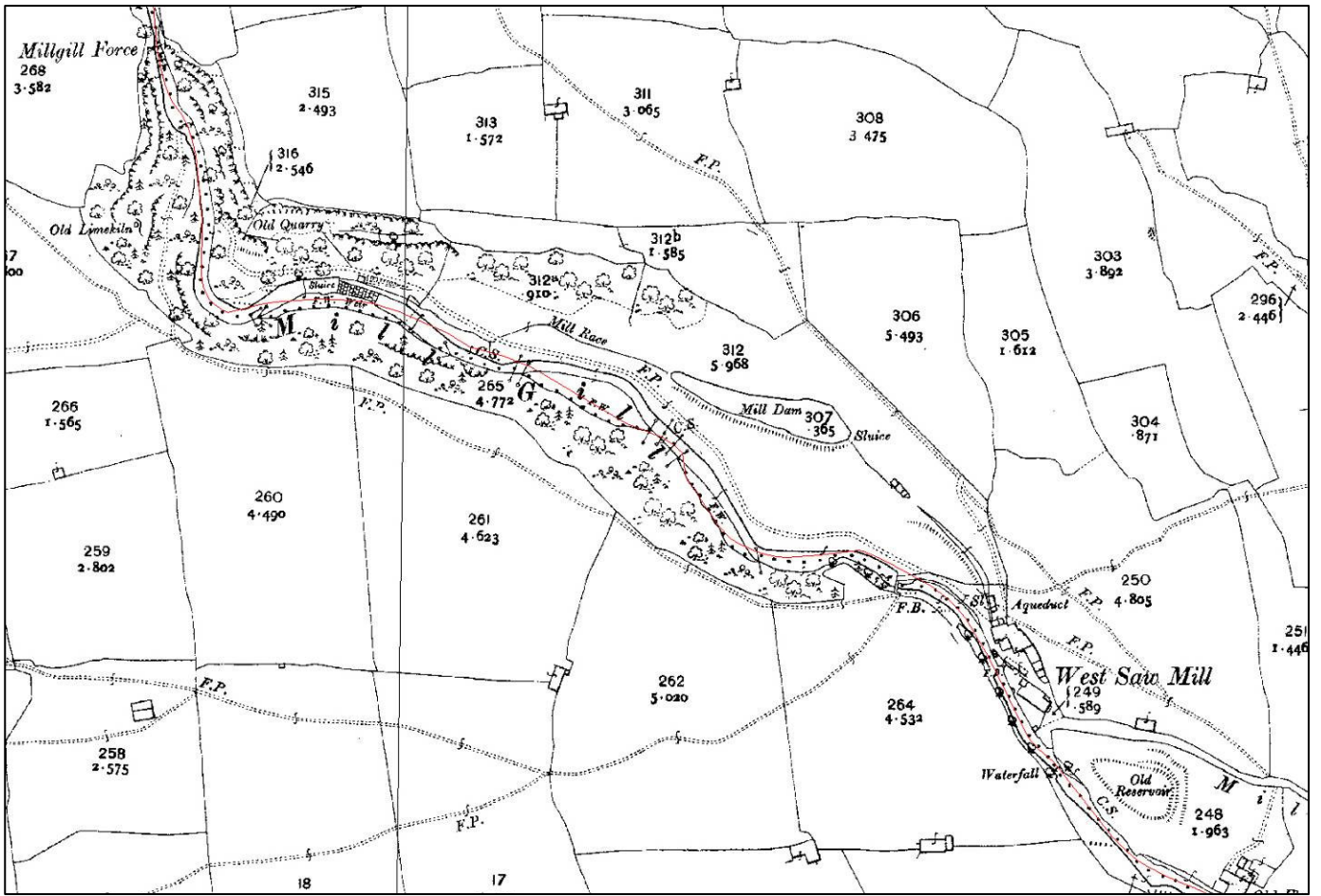

Source: Ordnance Survey 1912 25" map sheet 66/3 (revised 1910).

PROJECT	WEST MILL, ASKRIGG	
TITLE	ORDNANCE SURVEY 1912 MAP	
SCALE	NTS	DATE
		SEPT 2012
	EDAS	FIGURE
		10

P.D.S.



This Indenture made the Twenty ninth day of October  
 One thousand nine hundred and thirteen Between the within named William  
Handley Burton of the one part and Robert Charles De Grey Vyner of Newby Hall  
 Ripon in the County of York Esquire of the other part Witnesseth that in consideration  
 of the sum of Ten Shillings to the said William Handley Burton now paid by the  
 said Robert Charles De Grey Vyner (the receipt whereof the said William Handley Burton  
 hereby acknowledges) the said William Handley Burton as Beneficial Owner hereby  
 grants and conveys unto the said Robert Charles De Grey Vyner All the within  
 mentioned land and hereditaments with the rights liberties easements and appurtenances  
 thereby granted and conveyed To hold the same unto and to the use of the said  
 Robert Charles De Grey Vyner his heirs and assigns in fee simple subject nevertheless  
 to the within mentioned covenants on the part of the said William Handley Burton  
 to be observed and performed And the said Robert Charles De Grey Vyner hereby  
 covenants with the said William Handley Burton his heirs executors and  
 administrators that he the said Robert Charles De Grey Vyner his heirs and  
 assigns will henceforth observe and perform the within mentioned covenants so far  
 as the same are now subsisting and capable of taking effect and will at all times  
 hereafter keep the said William Handley Burton his heirs executors and  
 administrators indemnified against all proceedings costs claims and  
 demands whatsoever in respect thereof And it is hereby certified for the  
 purposes of the Finance Act 1910 that the transaction hereby effected does not  
 form part of a larger transaction or of a series of transactions in respect of  
 which the amount or value or the aggregate amount or value of the  
 consideration exceeds the sum of £500 In Witness whereof the said  
 parties to these presents have hereunto set their hands and seals the day  
 and year first hereinbefore written

Signed sealed and delivered by the said  
 William Handley Burton in the presence  
 of  
Arthur Wilkinson

W H Burton

S.W. Kaydon

Signed sealed and delivered by the said  
 Robert Charles De Grey Vyner in the presence  
 of  
John Harris  
 Newby Estate Office, Ripon.  
 Land agent.

Robert Charles de Grey Vyner



Conveyance between W H Burton and R D de  
 Grey Vyner Esq, 29th October 1913.  
 Source: Blake collection.

PROJECT		WEST MILL, ASKRIGG	
TITLE		1913 CONVEYANCE	
SCALE	NTS	DATE	SEPT 2012
EDAS		FIGURE	11



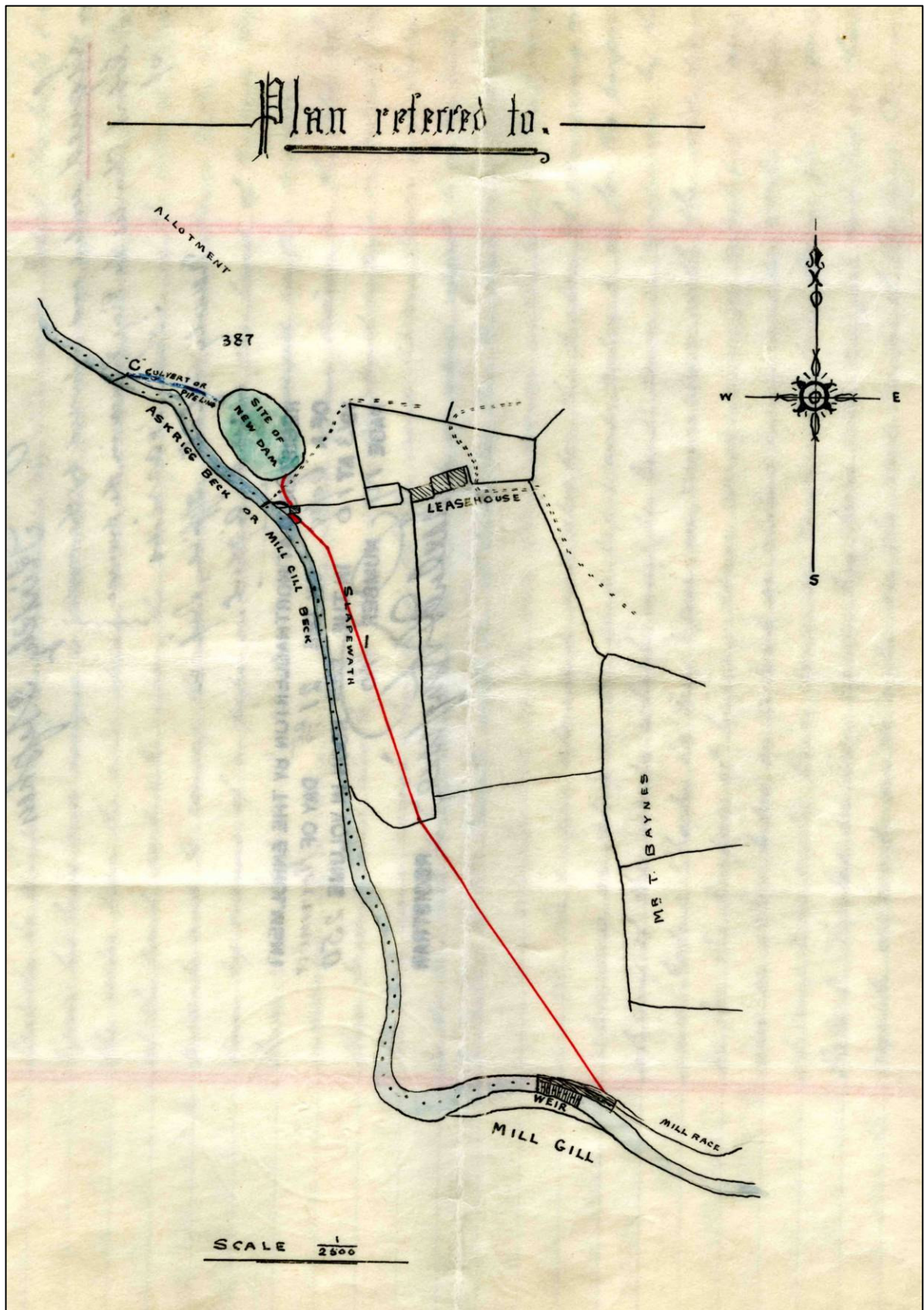

Conveyance of land and grant of easements from Mr Abram Scarr and one other to R C De Grey Vyner Esq, 30th October 1913.  
Source: Blake collection.

PROJECT		WEST MILL, ASKRIGG	
TITLE			
		PLAN WITH 1913 CONVEYANCE	
SCALE	DATE		
NTS	SEPT 2012		
EDAS		FIGURE	12

729

ASKRIGG, *Mayday* 1917  
S.O. YORKS.

*M. Rev F M Squibb*

DR. TO \_\_\_\_\_

## The Askrigg Electric Lighting Co.

677 Units <i>less 590</i>	2 10 9
Meter Rent	30
Lamps	2 13 9
Light as per Agreement	
<i>Part for</i>	
<i>1/17</i>	
<i>Cash</i>	2 6 6
<i>Bat</i>	7 11 3

### INVOICE.

**GARNET TUCKER & CO. LTD.**  
ELECTRICAL AND MECHANICAL ENGINEERS,  
133 WEST CAMPBELL STREET,  
GLASGOW.

SOLE TO \_\_\_\_\_

TELEPHONE: CHRYSLER 7181  
TELEGRAMS: "POLYVACAM, GLASGOW"

INV. No. \_\_\_\_\_

W. H. Burton, Esq.,  
Messrs. The Askrigg Electric Lighting Co.,  
Electrical Engineers,  
ASKRIGG.

LEN. POL. No. 415.

YOUR ORDER 2519 - 28/3/22. DATE 5th April 1922. TERMS NETT.

To Fitting Mavor & Coulson Dynamo No. 1264  
with 4 carbon brushes complete with  
brush holders and spindle.  
As quoted..... £8 0 0.

CLAIMS FOR REDUCTIONS MUST BE MADE WITHIN TEN DAYS OF DATE

TELEPHONE NO: \_\_\_\_\_

*Chertsey, 15th April 1920*

*M* The Askrigg Electric Lighting Co. Ltd. Askrigg, Yorkshire.

**Dr. to CHURCH BROTHERS,**  
**Electrical Engineers and Contractors.**

Lighting, Telephones, Bells, Power, Repairs, &c. Estimates Free.  
**48, EASTWORTH ROAD, CHERTSEY, SURREY.**

*In the event of Failure of your Installation, telephone the above address.*

For Electric Plant consisting of Engine, Dynamo, Switchboard and Battery	£275	0 0
Shafting Plummer Blocks, shafting, pulleys etc.,	5	0 0
	280	0 0
Cheque received on account	135	0 0
<i>Received in full</i> <i>for</i>	<b>Total</b>	<b>£145 0 0</b>

Top left: receipt dated Mayday 1917 to Rev F M Squibb for 677 units (less 590) of electricity.  
Top right: invoice dated 5th April 1922 from Garnet Tucker & Co. Ltd. for fitting dynamo.  
Bottom: invoice dated 15th April 1920 from Church Bros. for electric plant.  
Source: Blake collection.

PROJECT <b>WEST MILL, ASKRIGG</b>	
TITLE <b>RECEIPTS AND INVOICES 1917-1922</b>	
SCALE <b>NTS</b>	DATE <b>SEPT 2012</b>
<b>EDAS</b>	FIGURE <b>13</b>

February 1943

essrs Askrigg & Reeth  
Askrigg

Brought Forward	42-	0-	9
Nov 14 Two Men at top dam		14-	6
21 Getting Engine Block from the Station and up Gill		10-	6
22 23 24 Getting Engine into house and work on Engine etc	3-	3-	0
6 new lamps for power house		12-	0
4 new D.P. Swt and fuses for Reeth and Carr	1-	2-	0
Paid Gilks for new parts for Governor	2-	6	6
Paid Carriage on empty barrels		3-	3
Decm Carting oil up gill		7-	6
Pipes for Ruston Air Starter and for Air Compressor			
32 Ft 1 1/4" 9d	1-	4-	0
One Tee One Union and three bends		12-	6
25 Ft 3/4"		10-	7
7 fittings at 1/-		7-	0
One 3/4 union and 3 Fullway valves	1-	4-	0
One T and 2 Plugs		2-	6
46 ft of 7 X 2 1/2 Cost price 10 1/2	2-	0-	3
20 ft 1 X 1/2 10 1/2		17 1/2	6
103 ft 1 X 1 3 1/2	1-	7-	11
8 six inch bolts and 3 six inch coach screws		3-	4
9 Ft of 1 1/4 X 4 and one bag of cement		6-	9
		59-	16- 4

*Paid 17/2/43*  
*To Mr H B ...*  
*EB*



Account dated February 1943, documenting work undertaken at Mill Gill power house. Source: Blake collection.

PROJECT		WEST MILL, ASKRIGG	
TITLE			
		ACCOUNT OF WORK 1943	
SCALE	NTS	DATE	SEPT 2012
	EDAS	FIGURE	14

**The National Gas and Oil Engine Co. Ltd.,**  
 WELLINGTON WORKS, ASHTON-UNDER-LYNE, ENG.  
 17th January, 1944.  
 Date.....1944.  
 1861 ASHTon.  
 Telegrams: "NATIONAL" Ashton-under-Lyne.

Messrs. W. H. Burton & Sons,  
 Electrical Engineers & Contractors,  
 Askrigg,  
 Yorkshire.

**OFFICIAL RECEIPT.**

Received with thanks the sum of  
 nine pounds eight shillings and elevenpence.

by cheque £ 9 : 8 : 11

THE NATIONAL GAS AND OIL ENGINE CO. LTD.

Cashier. *NI*

**NO OTHER FORM OF RECEIPT WILL BE ACKNOWLEDGED.**

**STATEMENT**  
**STEPHENS BELTING CO. LTD**  
 (ASSOCIATED WITH BIRMINGHAM BELTING CO. LTD.)  
 (SUBSIDIARY COMPANY OF THOR HAMMER COMPANY)

TELEPHONE CENTRAL 8086 (3 LINES) 94 SNOW HILL BIRMINGHAM, 4  
 TELEGRAMS STEPHANUS BIRMINGHAM, 4

Messrs. W.H. Burton & Sons,  
 (Askrigg & Reeth Electric Supply Co., Ltd.),  
 Askrigg,  
 Yorks.

8 1 APR. 1944

DATE	REFERENCE	DEBIT	CREDIT	BALANCE
MAR.	A/RD.		BALANCE B/F	7. 3. 1

W.H. Burton & Sons  
 RECEIVED WITH THANKS  
 1661  
 G. J. Stephens Cashier

AMOUNT 7 3 1

TERMS - 2 1/2% FOR CASH IN 30 DAYS FROM DATE OF INVOICE  
 ACCOUNTS UNDER £1, NET

THE LAST AMOUNT IN THIS COLUMN IS THE AMOUNT DUE

Telegrams: "Burton, Askrigg."  
 Telephone: Bainsbridge 249.

**ASKRIGG,**  
 YORKS. 27/4/1944

*Mr. Capt. Whitehead Thornton Rust*  
~~Dr. to~~ **W. H. BURTON & SONS.**  
 (PARTNERS: E. BURTON, E. D. BURTON, I. BURTON.)

27/4/44	To one Second Hand Engine	300 0
	1/2 of spare atomiser block	1 15 0
		<u>31 15 0</u>

*Please sign & return*

27/4/44

Top right: receipt from the National Gas & Oil Engine Co. Ltd. of Ashton-under-Lyne, dated 17th January 1944.  
 Top left: statement from Stephens Belting Company Ltd. of Birmingham, dated 31st April 1944.  
 Bottom: payment to Capt. Whitehead of Thornton Rust for 'one second hand engine', dated 27th April 1944.  
 Source: Blake collection.

PROJECT	WEST MILL, ASKRIGG		
TITLE	RECEIPTS AND INVOICES 1944		
SCALE	NTS	DATE	SEPT 2012
	EDAS	FIGURE	15

messrs W H Burton Sons  
 the mill  
**ASKRIGG**

L.N.E.R. DEPT. *goods* **ASKRIGG** STATION  
*may* 1944 When remitting quote.

**Dr. to THE LONDON AND NORTH EASTERN RAILWAY COMPANY,**  
 For Carriage and other Charges.

The Company require carriage and other charges **TO BE PAID ON DELIVERY** of Merchandise unless a credit account has been opened, and they will not accept reference to Sender or Consignee, or to a Third Party, for payment.

Cheques and Postal Orders to be Crossed and made payable to the "London & North Eastern Railway Company."  
 The Company's Official Stamped form of receipt only should be accepted for payments of £2 and upwards.

Date	Invoice No.	From or To	Station	Sender or Consignee	Number of Articles and Description of Goods	Weight		Rate	Paid on	Cartage and Sundry Charges	Total Charges		£ s. d.	
						Tons	cwt. qrs. lbs.				£	s.	d.	
8/4/44	2	to	Bradford Valley	B. A. Winding Co	1 Dynamo	5	2 7/8	37/5				10 4		
9/5/44	1	✓	West Hartlepool	R. Launder	3800-6ft rake handles 285-4ft rake handles	5	18 2 0	19/11				<del>5 18 1</del>		
16/5/44	518	✓	Buckingham	Judot Recruit Battery	2 Rifle ranges 1125	3	4 47					<del>1 5</del>		

LNER 4701/8.43 3,000 pads of 100 RECEIVED PAYMENT FOR THE COMPANY

Telegrams: "Burton Askrigg."  
 Telephone: Bainbridge 249.

**ASKRIGG,**  
 YORKS. *May 23* 1947

Mr *J H Alderson*  
*West Borrins*

**W. H. BURTON & SONS**  
 (PARTNERS: E. BURTON, E. D. BURTON, I. BURTON.)

18 pullets @ 33/-	2 9 6
6 month olds @ 5/6	2-9-6
	1-13-0
	4 2 6



Top: LNER receipt dated May 1944 for sending a dynamo to the B A Winding Company, and 3,800 6ft rake handles and 285 4ft rake handles R Launder via West Hartlepool station.  
 Bottom: May 1957 sale of 18 pullets, 6 cocks etc to Mr Alderson of West Borrins.  
 Source: Blake collection.

PROJECT	WEST MILL, ASKRIGG	
TITLE	RECEIPTS ETC 1944-1957	
SCALE	NTS	DATE SEPT 2012
	EDAS	FIGURE 16



Top: 1979 aerial photograph of the West Mill complex and Mill Gill House.  
 Bottom: 1984 colour print of the West Mill complex.  
 Source: Blake collection.

PROJECT		WEST MILL, ASKRIGG	
TITLE			
		PHOTOGRAPHS 1979 AND 1984	
SCALE	DATE		
NTS	SEPT 2012		
EDAS		FIGURE	17



*Electricity was made in a Corn Mill*

Source: Pontefract, E & Hartley, M 1942 *Yorkshire Cottage*, p65.

PROJECT	WEST MILL, ASKRIGG	
TITLE	SKETCH OF WEST MILL	
SCALE	NTS	DATE SEPT 2012
EDAS	FIGURE 18	



Top: Rebuilding leat adjacent to the power house in 1986.

Bottom: Dredging the mill pond in the 1980s.

Source: Blake collection.

PROJECT		WEST MILL, ASKRIGG	
TITLE		1980S REPAIR WORKS	
SCALE	NTS	DATE	SEPT 2012
EDAS		FIGURE	19



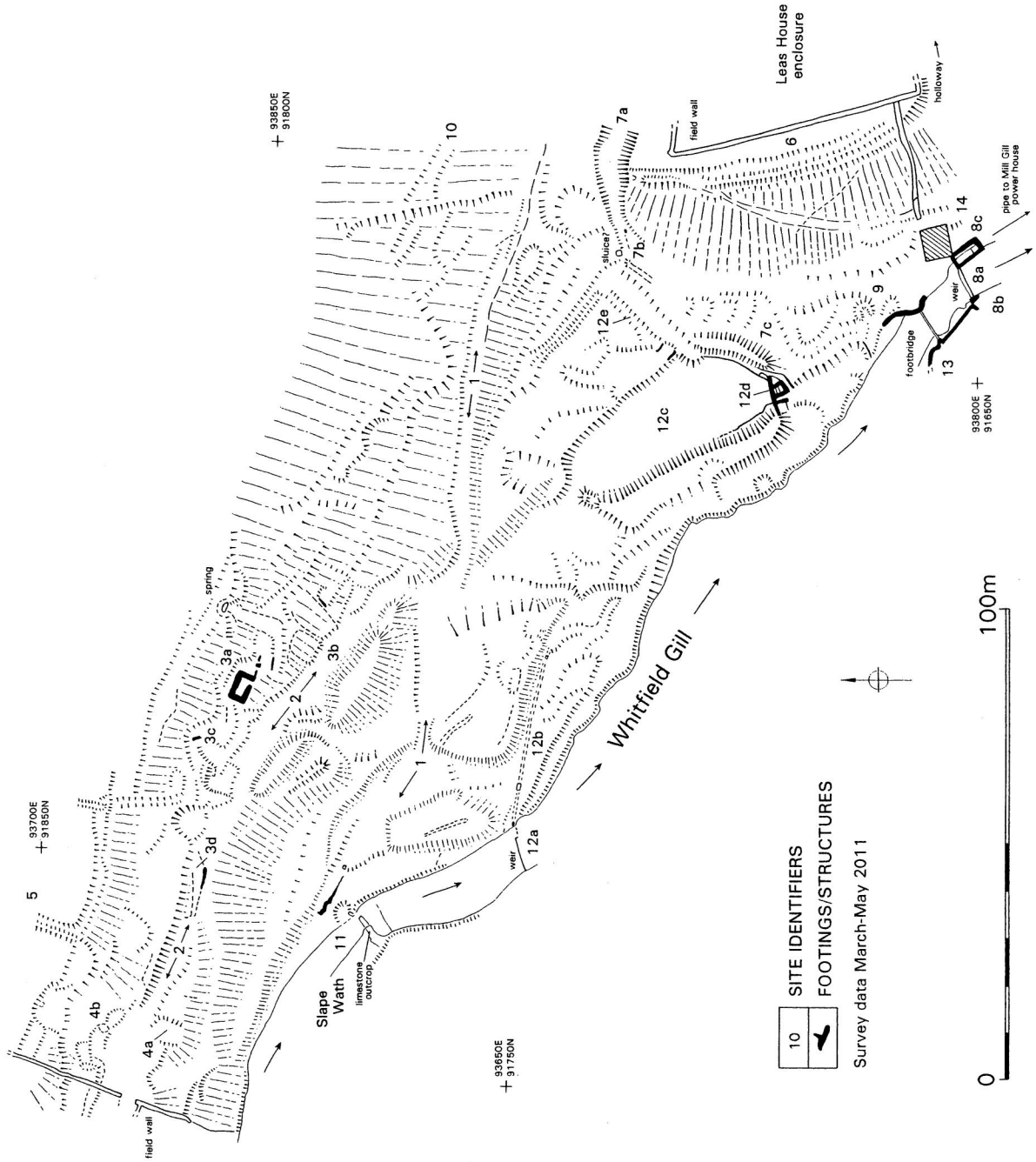

PROJECT	WEST MILL, ASKRIGG		
TITLE	LEAS HOUSE EARTHWORKS		
SCALE	AS SHOWN	DATE	SEPT 2012
	EDAS	FIGURE	20

PROJECT	WEST MILL, ASKRIGG		
TITLE	MILL GILL EARTHWORKS		
SCALE	AS SHOWN	DATE	SEPT 2012
EDAS	FIGURE	21	

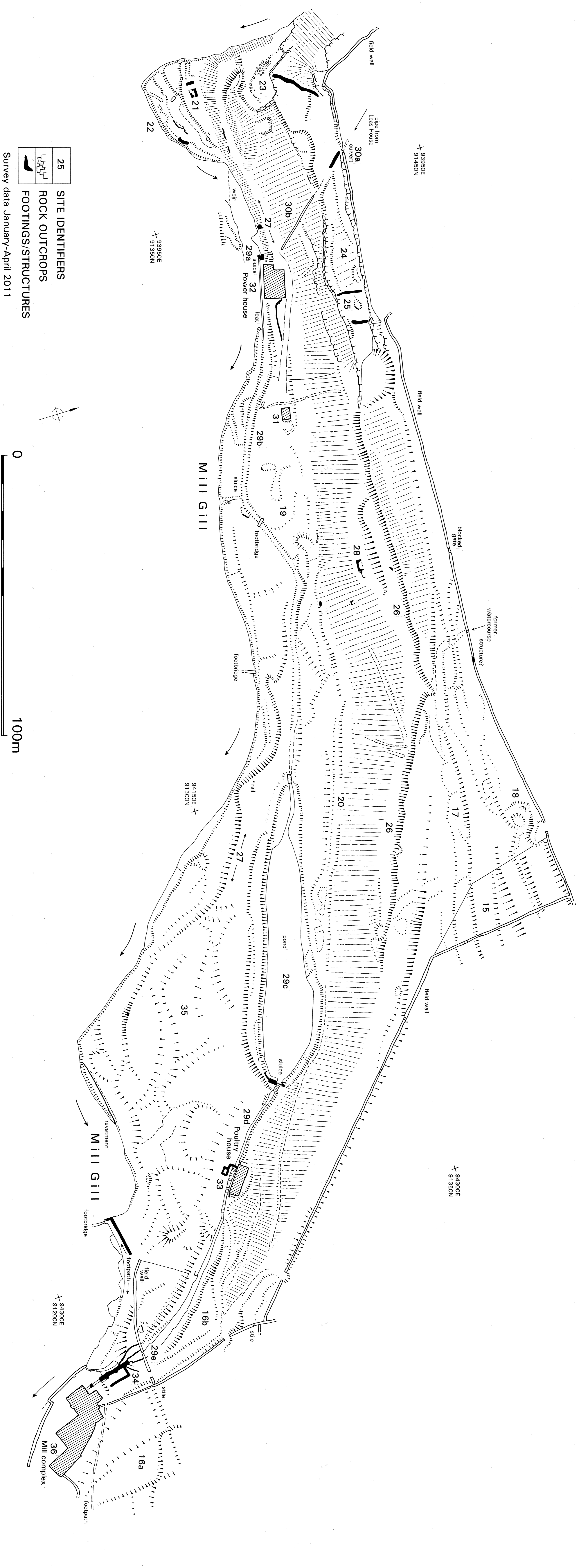

Survey data January-April 2011

PROJECT	WEST MILL, ASKRIGG		
TITLE	MILL WATER SUPPLY - PLAN		
SCALE	AS SHOWN	DATE	SEPT 2012
	EDAS	FIGURE	22

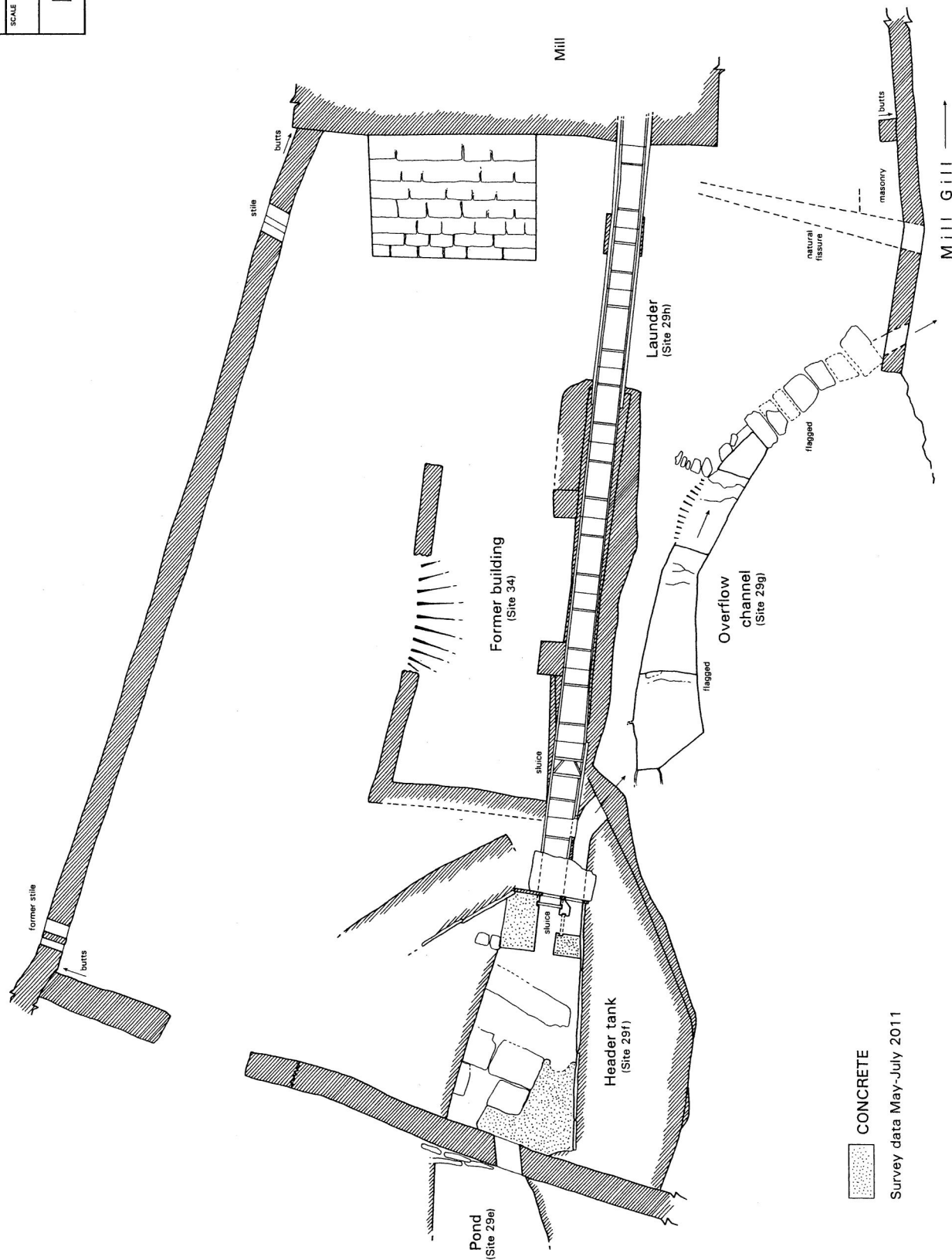

CONCRETE

Survey data May-July 2011



N

S

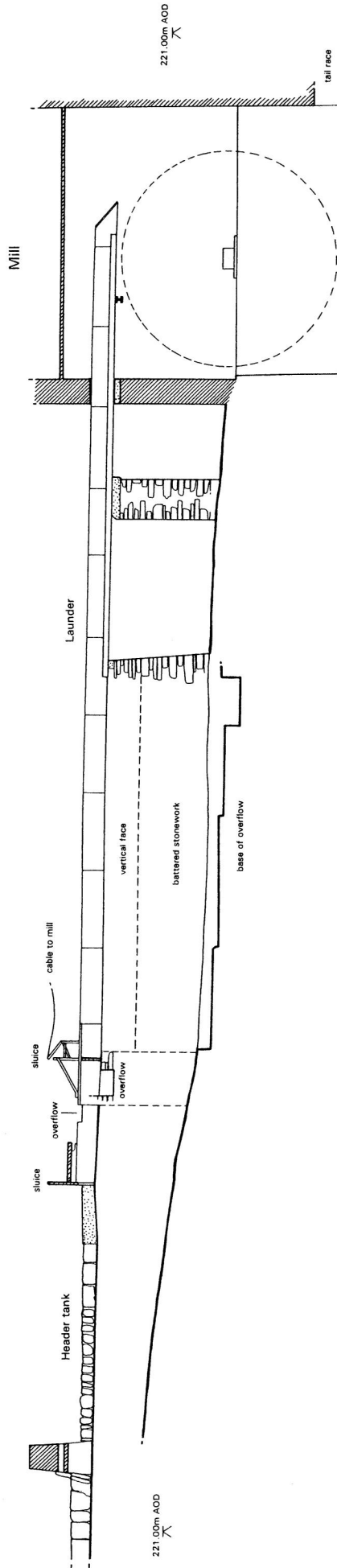

 CONCRETE

Survey data May-July 2011



PROJECT	WEST MILL, ASKRIGG		
TITLE	MILL WATER SUPPLY - SECTION		
SCALE	AS SHOWN	DATE	SEPT 2012
	EDAS	FIGURE	23

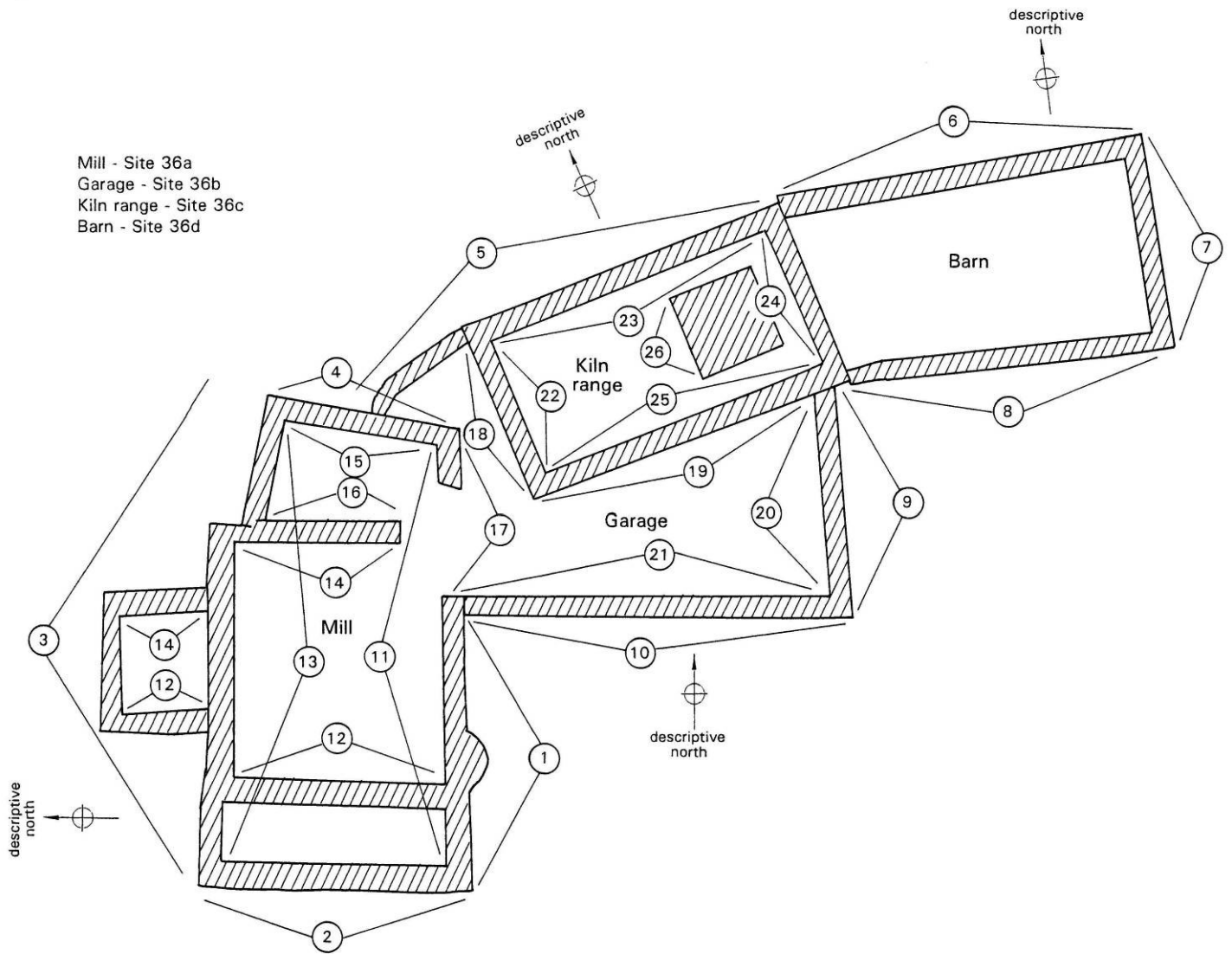

PROJECT		WEST MILL, ASKRIGG	
TITLE		KEY TO ELEVATIONS	
SCALE	NTS	DATE	SEPT 2012
EDAS		FIGURE	24

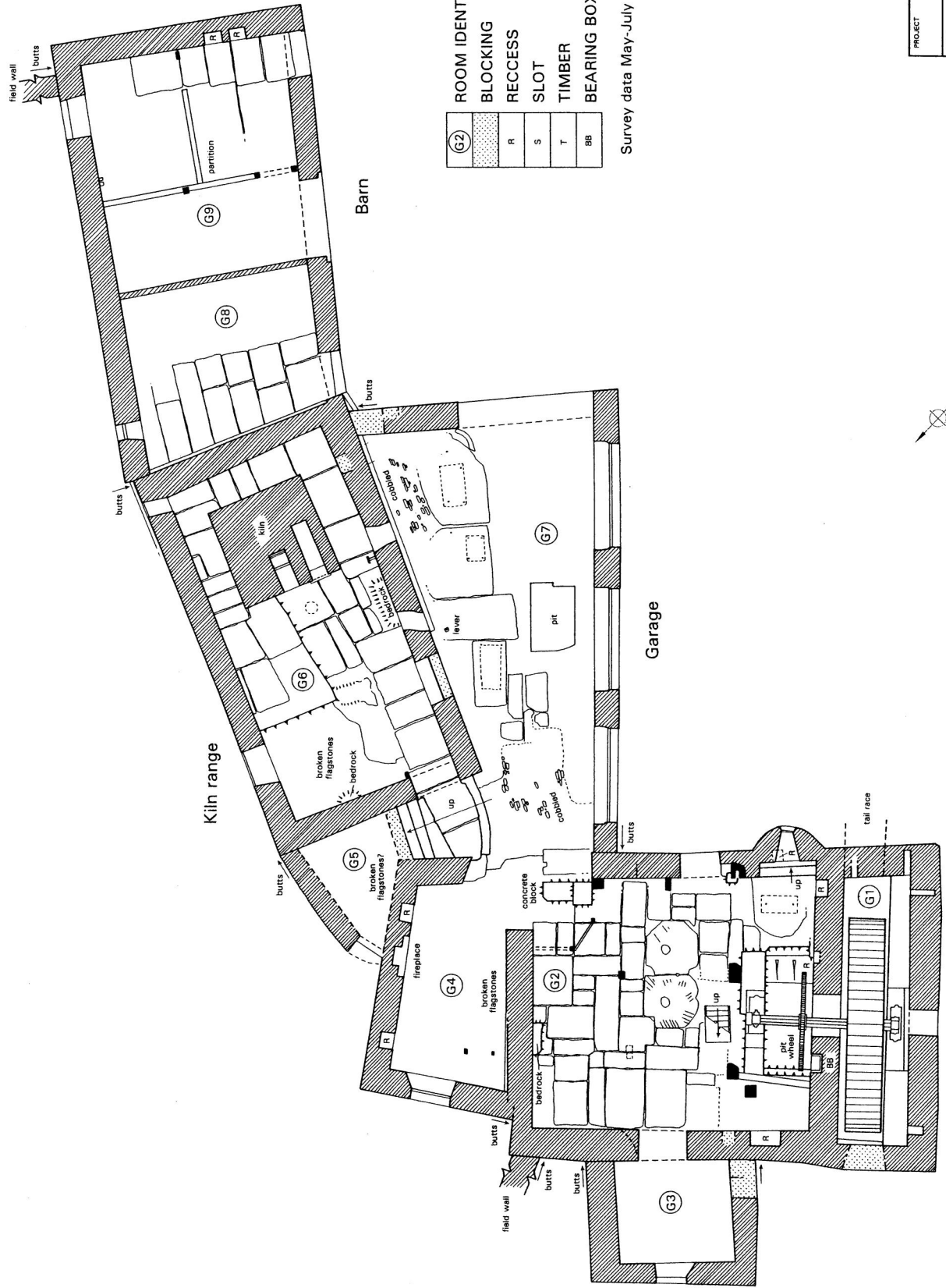

PROJECT	WEST MILL, ASKRIGG
TITLE	MILL COMPLEX - GROUND FLOOR PLAN
SCALE	AS SHOWN
DATE	SEPT 2012
FIGURE	25

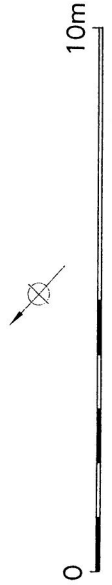

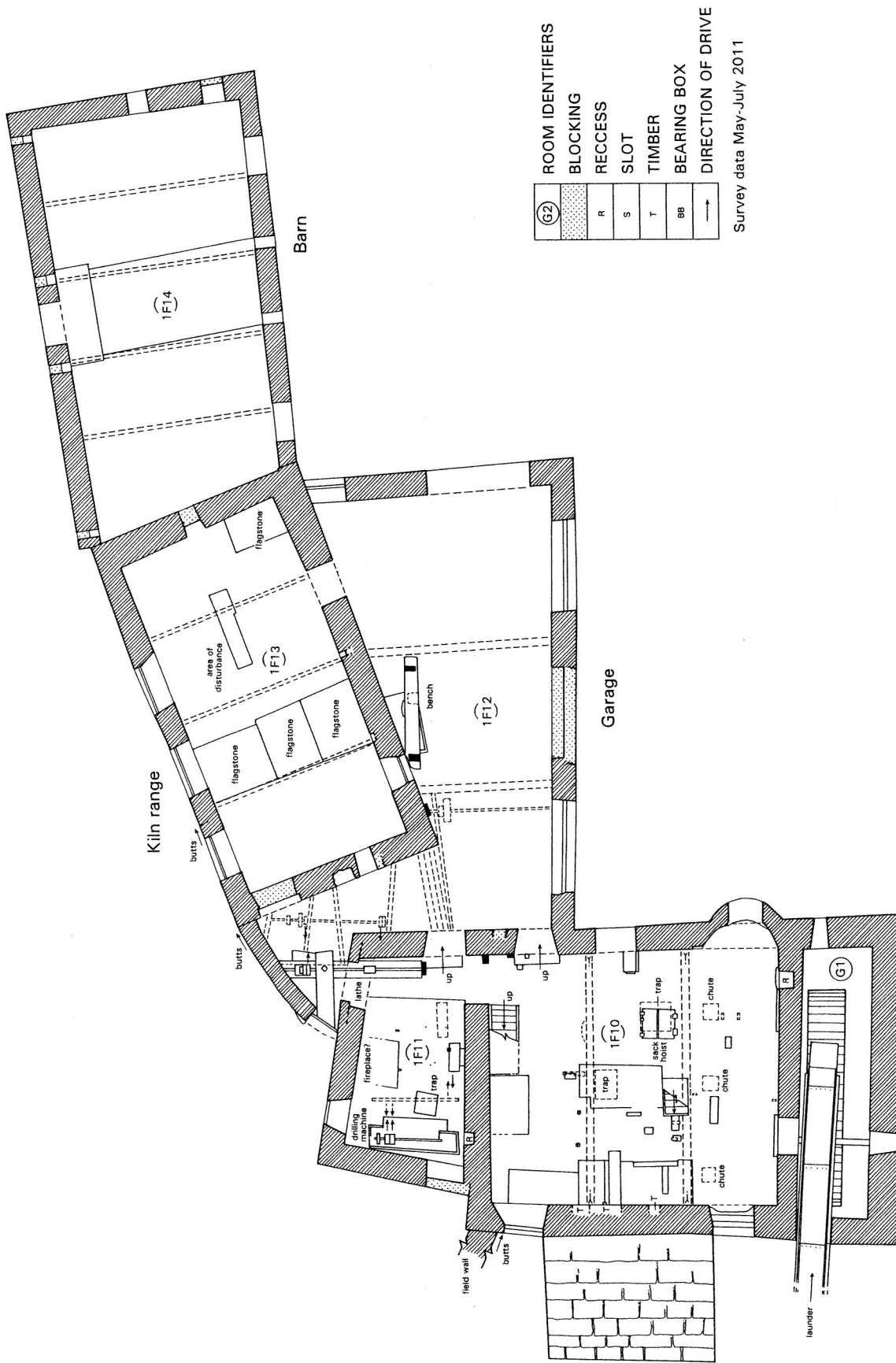

PROJECT	WEST MILL, ASKRIGG		
TITLE	MILL COMPLEX - FIRST FLOOR PLAN		
SCALE	AS SHOWN	DATE	SEPT 2012
	EDAS	FIGURE	26

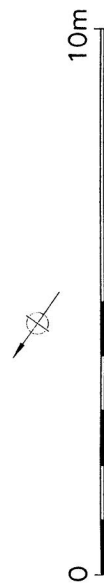

PROJECT WEST MILL, ASKRIGG	
TITLE MILL COMPLEX - SECOND FLOOR PLAN	
SCALE AS SHOWN	DATE SEPT 2012
EDAS	FIGURE 27

**(G2) ROOM IDENTIFIERS**  
Survey data May-July 2011

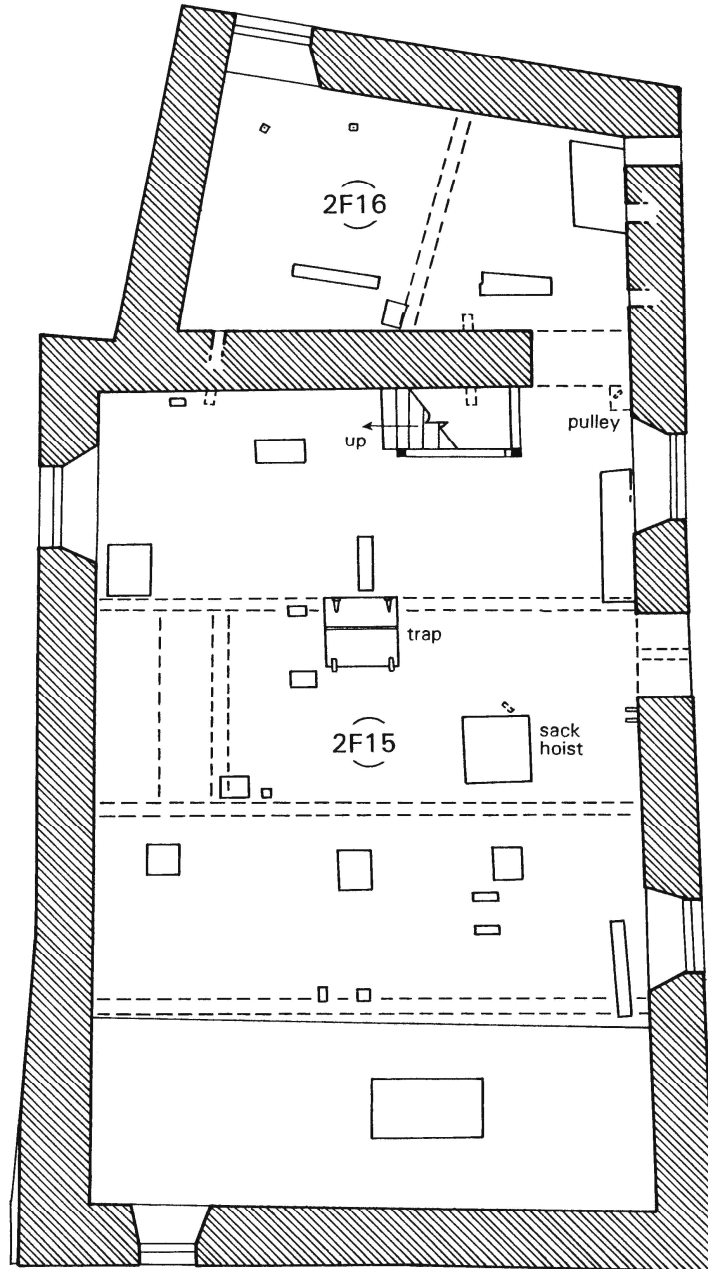



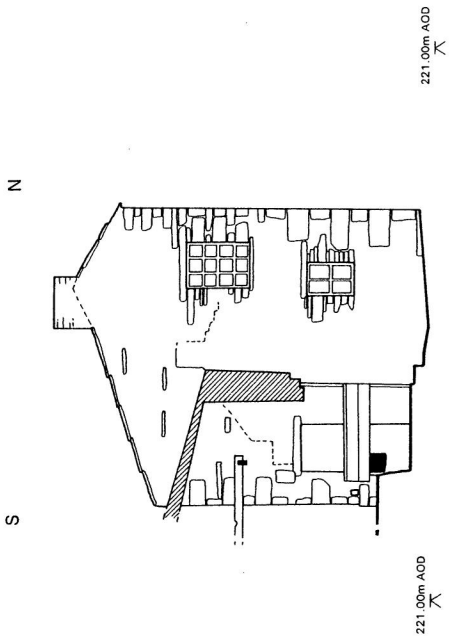

Elevation 4: east external elevation of mill

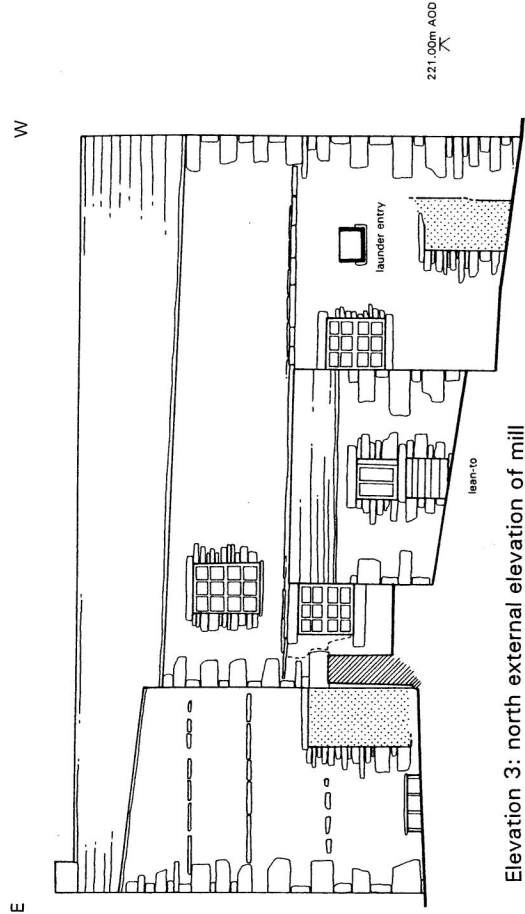

Elevation 3: north external elevation of mill

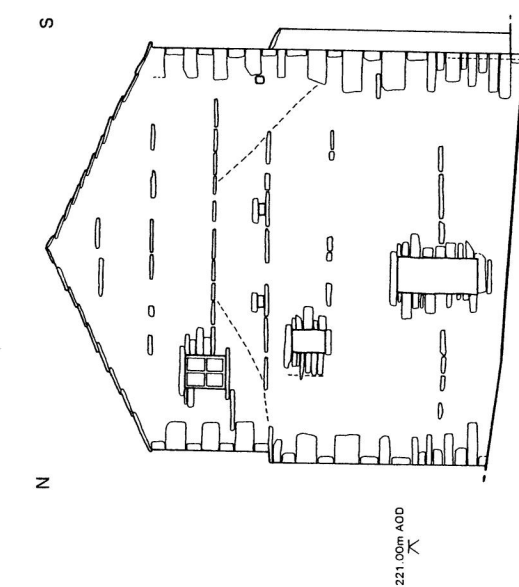

Elevation 2: west external elevation of mill

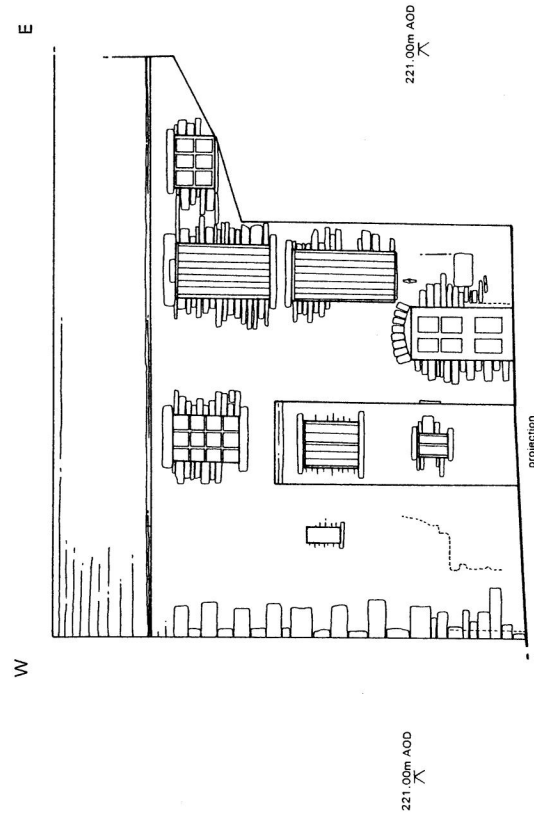

Elevation 1: south external elevation of mill

	BLOCKING
	RECESS
	TIMBER

Rainwater goods omitted  
Survey data May-July 2011

PROJECT	WEST MILL, ASKRIGG		
TITLE	MILL - EXTERNAL ELEVATIONS		
SCALE	AS SHOWN	DATE	SEPT 2012
	EDAS	FIGURE	28



PROJECT	WEST MILL, ASKRIGG		
TITLE	MILL - INTERNAL ELEVATIONS		
SCALE	AS SHOWN	DATE	SEPT 2012
	EDAS	FIGURE	29

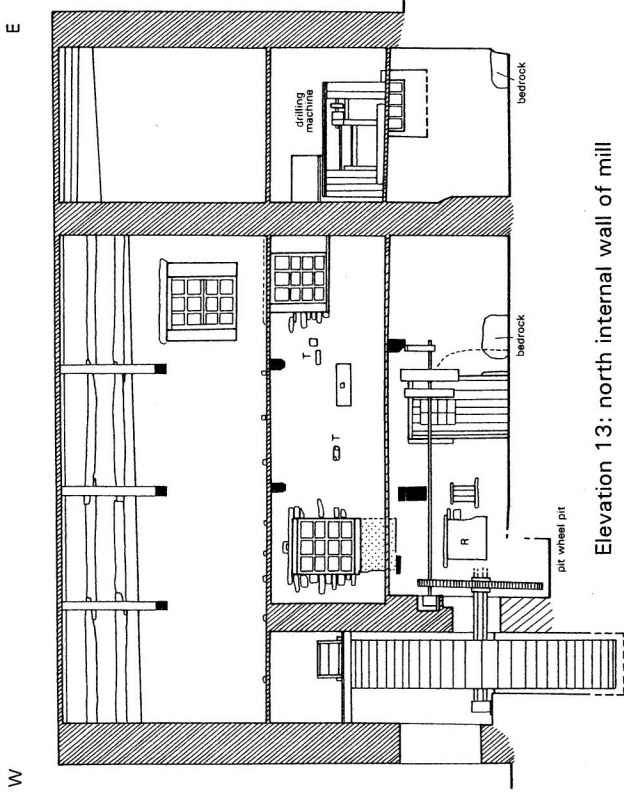

Elevation 13: north internal wall of mill

W

E

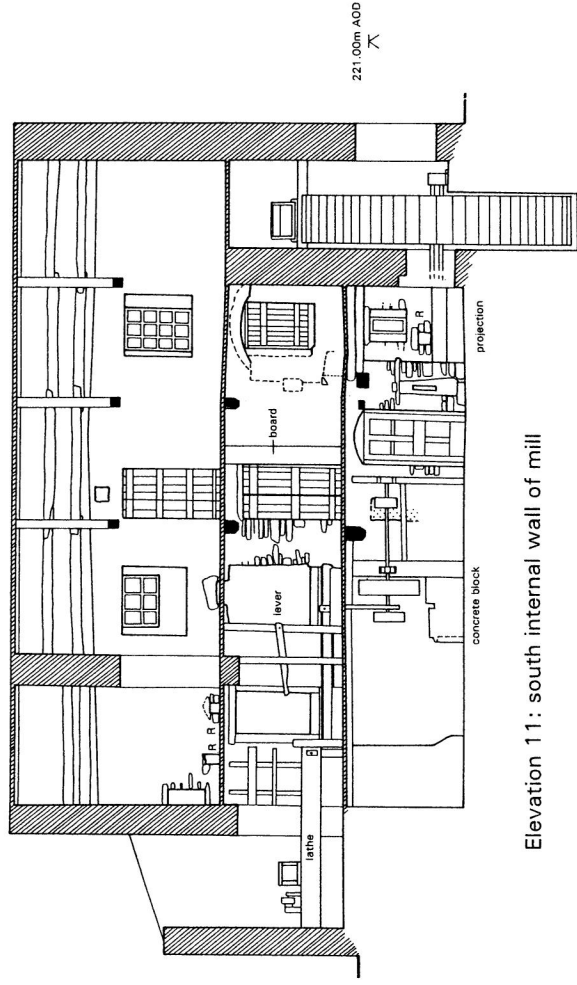

Elevation 11: south internal wall of mill

W

E

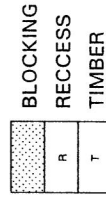

Survey data May-July 2011

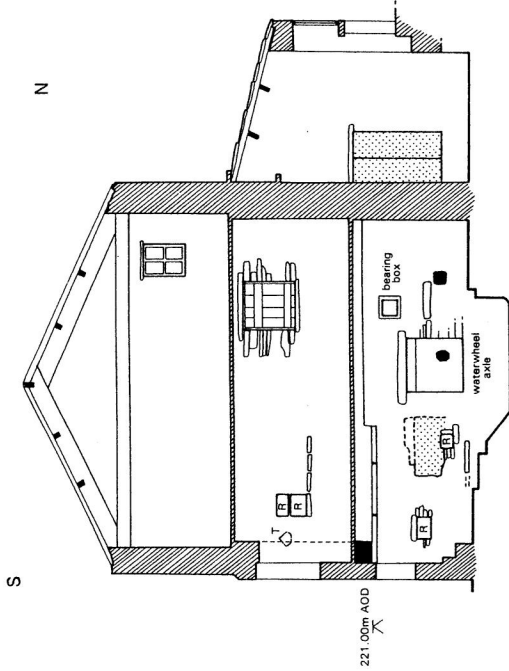

Elevation 12: west internal wall of mill

N

S

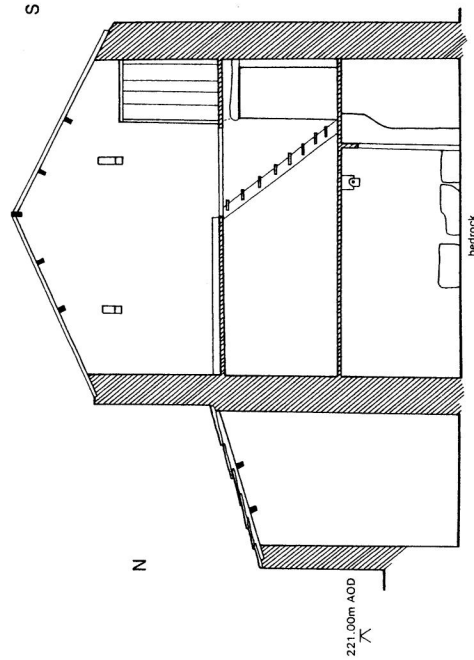

Elevation 14: east internal wall of mill

N

S



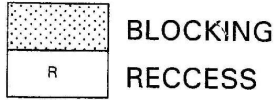

Survey data May-July 2011

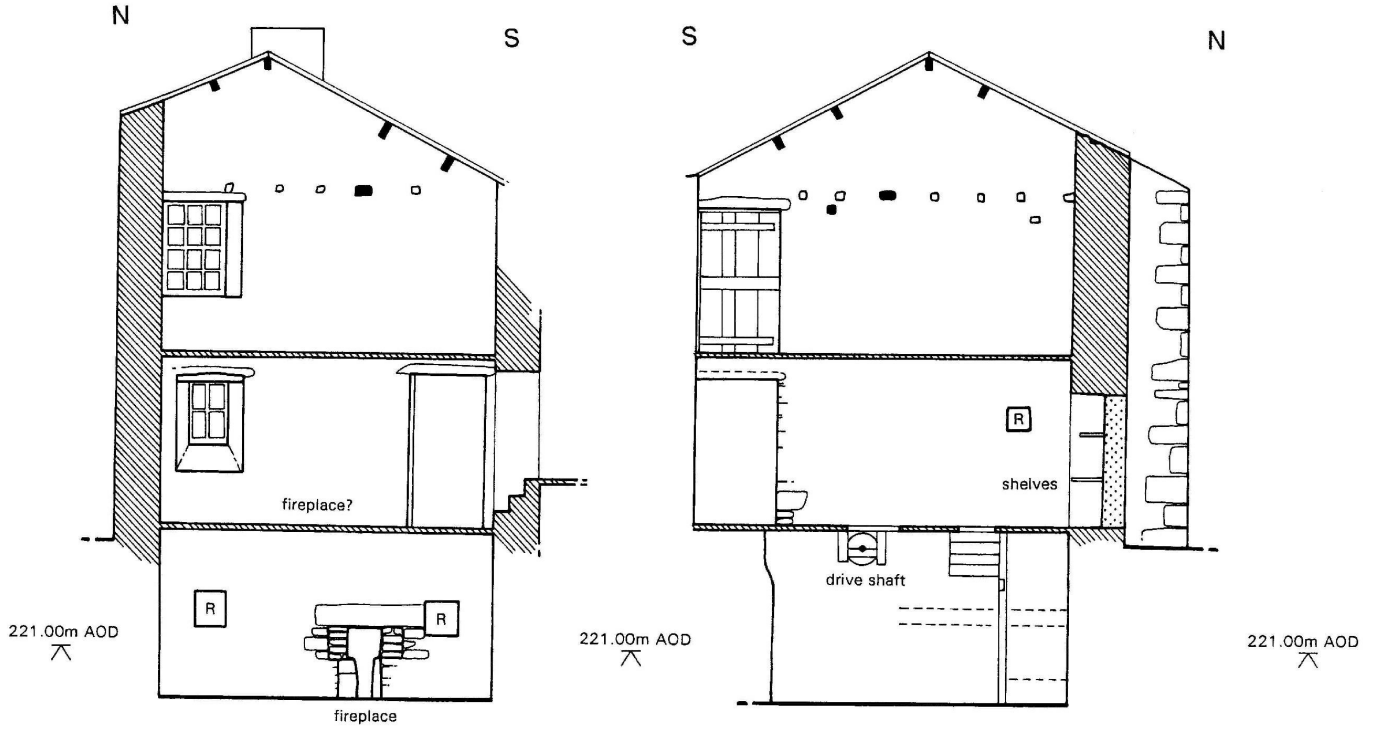

Elevation 15: east internal wall of 'domestic' end of mill

Elevation 16: west internal wall of 'domestic' end of mill



PROJECT		WEST MILL, ASKRIGG	
TITLE		MILL - INTERNAL ELEVATIONS	
SCALE	AS SHOWN	DATE	SEPT 2012
	EDAS	FIGURE	30

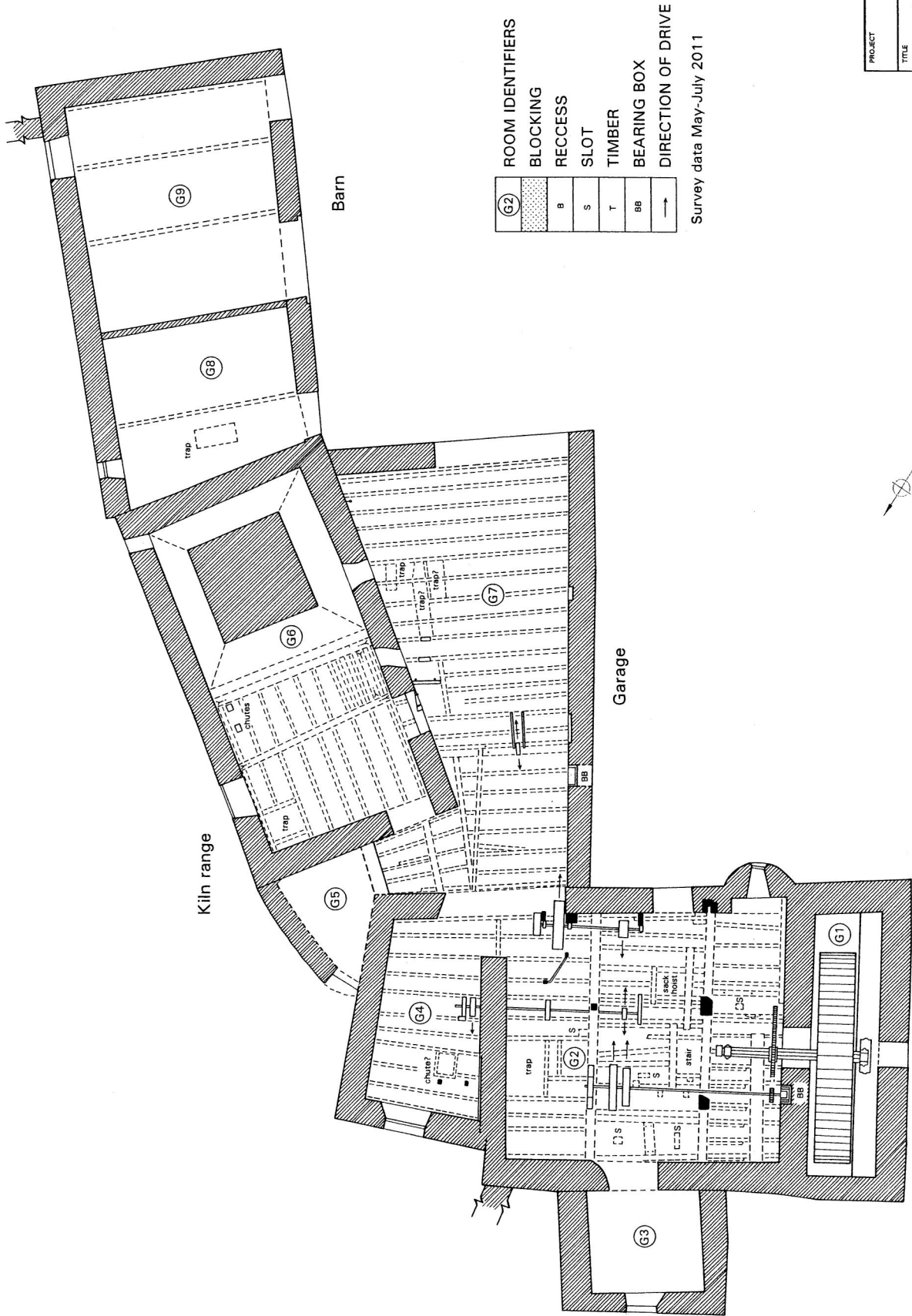

ROOM IDENTIFIERS	
G2	BLOCKING
B	RECESS
S	SLOT
T	TIMBER
BB	BEARING BOX
→	DIRECTION OF DRIVE

Survey data May-July 2011



PROJECT	WEST MILL, ASKRIGG
TITLE	MILL COMPLEX - REFLECTED GROUND FLOOR CEILING PLAN
SCALE	AS SHOWN
DATE	SEPT 2012
FIGURE	31

EDAS

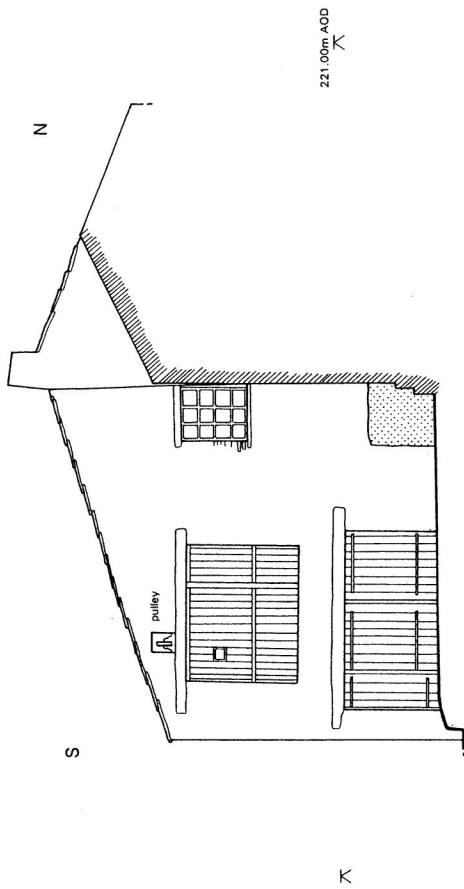

Elevation 9: east external elevation of garage  
(external stairs omitted)

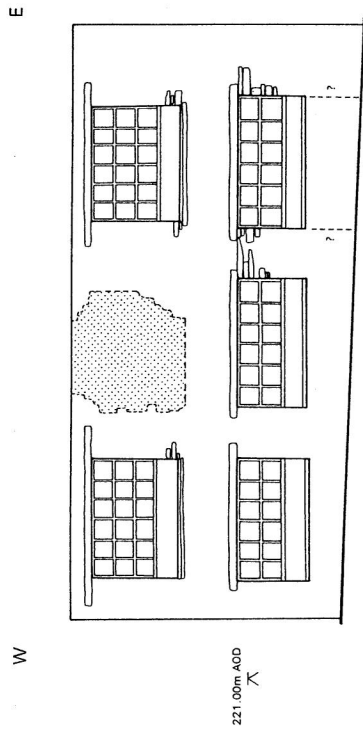

Elevation 10: south external wall of garage

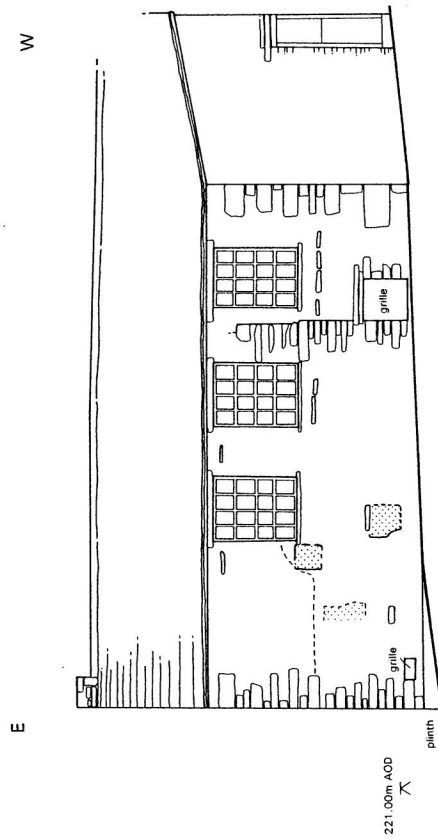

Elevation 5: north external elevation of kiln range

BLOCKING	
RECESS	R
TIMBER	T

Rainwater goods omitted  
Survey data May-July 2011

PROJECT	WEST MILL, ASKRIGG		
TITLE	GARAGE AND KILN RANGE - EXTERNAL ELEVATIONS		
SCALE	AS SHOWN	DATE	SEPT 2012
	EDAS	FIGURE	32



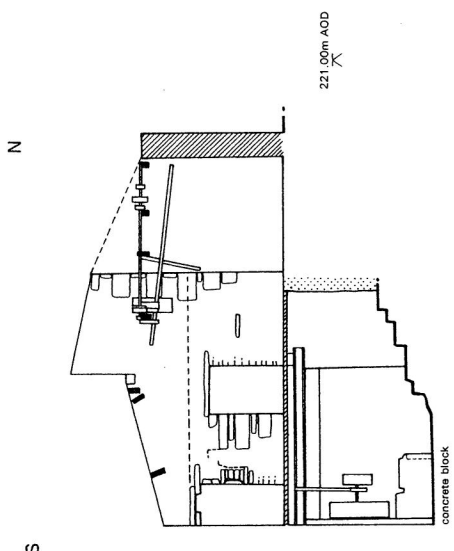

Elevation 17: west internal wall of garage

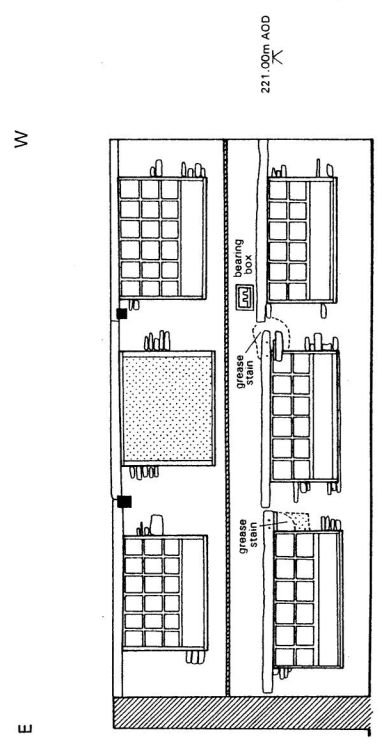

Elevation 21: south internal wall of garage

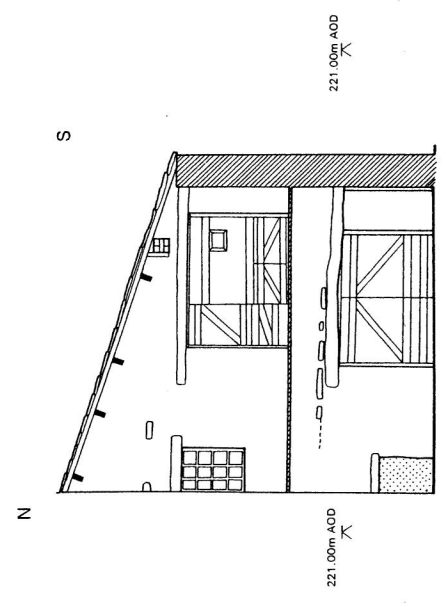

Elevation 20: east internal wall of garage

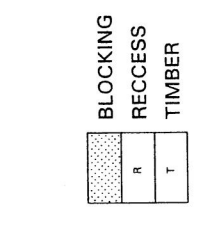

Rainwater goods omitted  
Survey data May-July 2011

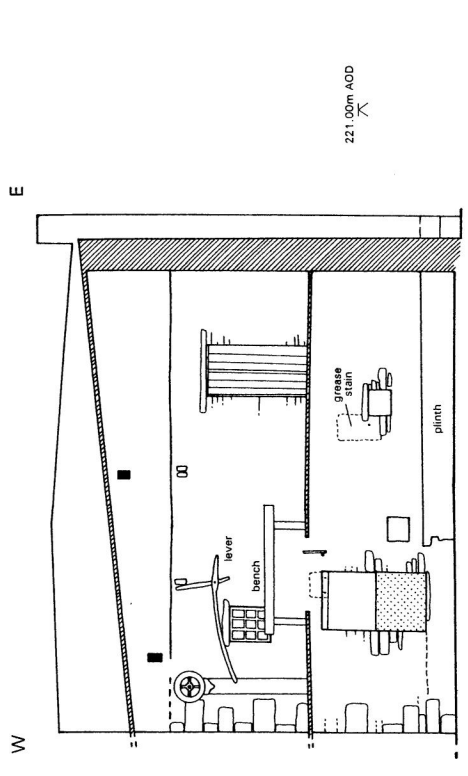

Elevation 19: south external wall of kiln range

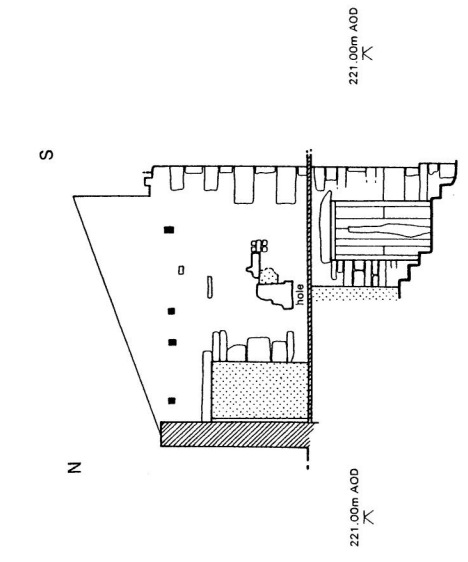

Elevation 18: west external wall of kiln range



PROJECT	WEST MILL, ASKRIGG		
TITLE	GARAGE - INTERNAL ELEVATIONS		
SCALE	AS SHOWN	DATE	SEPT 2012
	EDAS	FIGURE	33

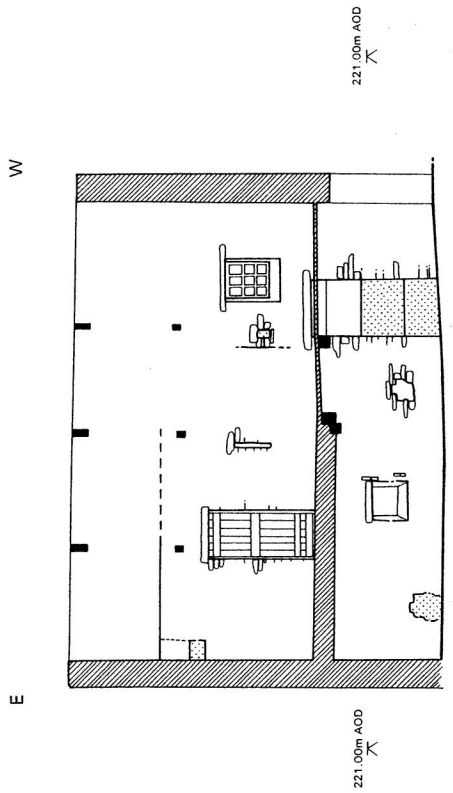

Elevation 25: south internal wall of kiln range

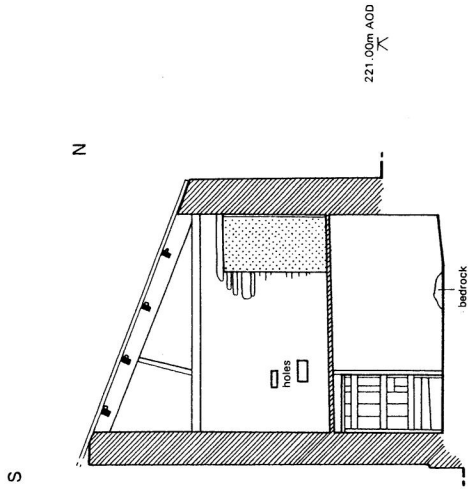

Elevation 22: west internal wall of kiln range

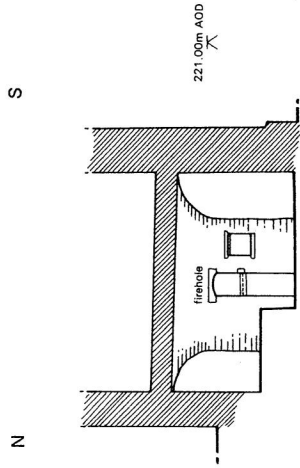

Elevation 26: west side of kiln

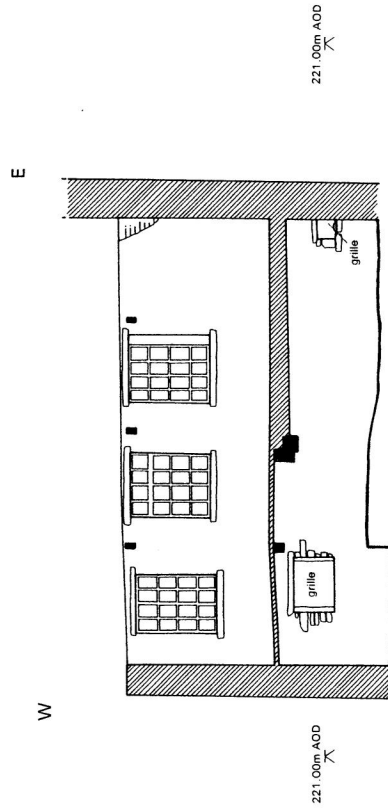

Elevation 23: north internal wall of kiln range

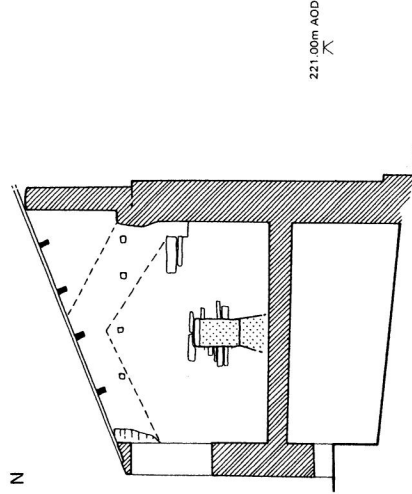

Elevation 24: east internal wall of kiln range

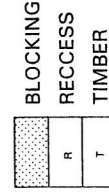

Survey data May-July 2011

PROJECT	WEST MILL, ASKRIGG		
TITLE	KILN RANGE - INTERNAL ELEVATIONS		
SCALE	AS SHOWN	DATE	SEPT 2012
	EDAS	FIGURE	34



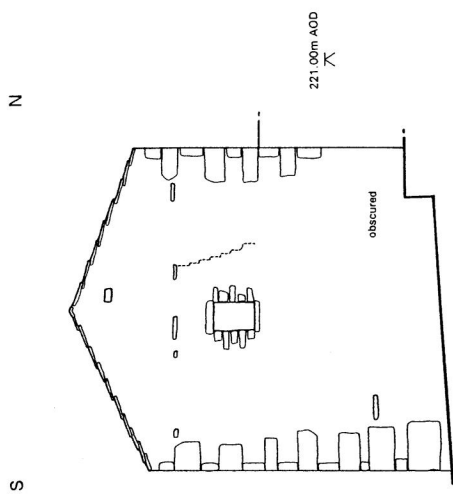

Elevation 7: east external wall of barn

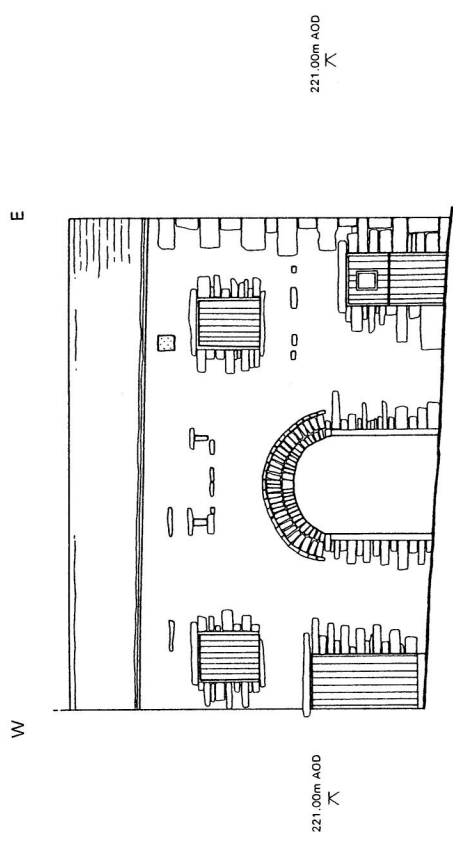

Elevation 8: south external wall of barn

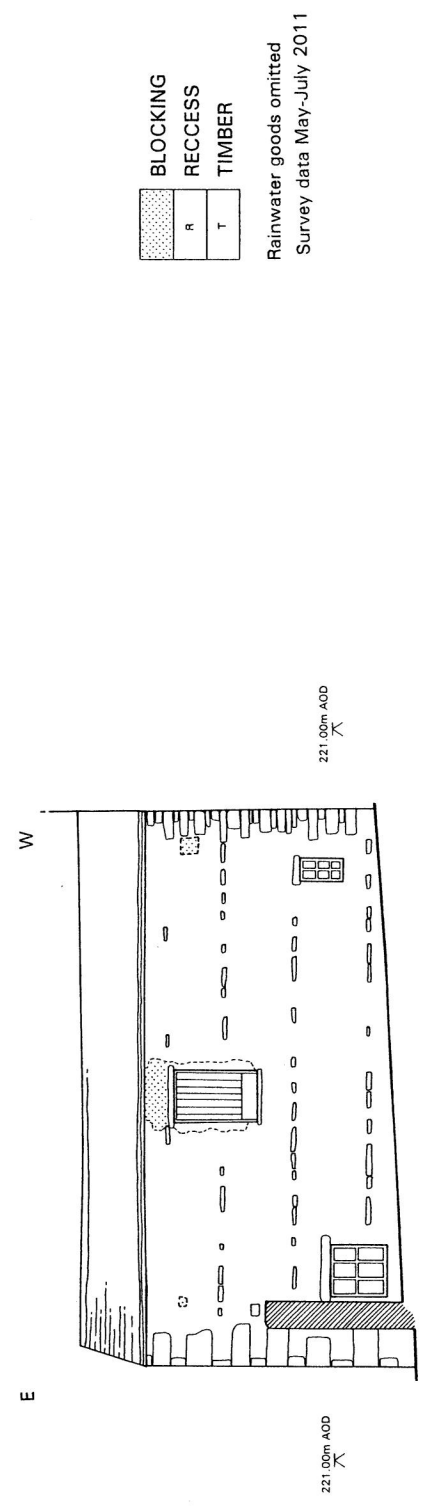

Elevation 6: north external wall of barn

BLOCKING
R
T

Rainwater goods omitted  
Survey data May-July 2011





PROJECT	WEST MILL, ASKRIGG		
TITLE	BARN RANGE - EXTERNAL ELEVATIONS		
SCALE	AS SHOWN	DATE	SEPT 2012
	EDAS	FIGURE	35

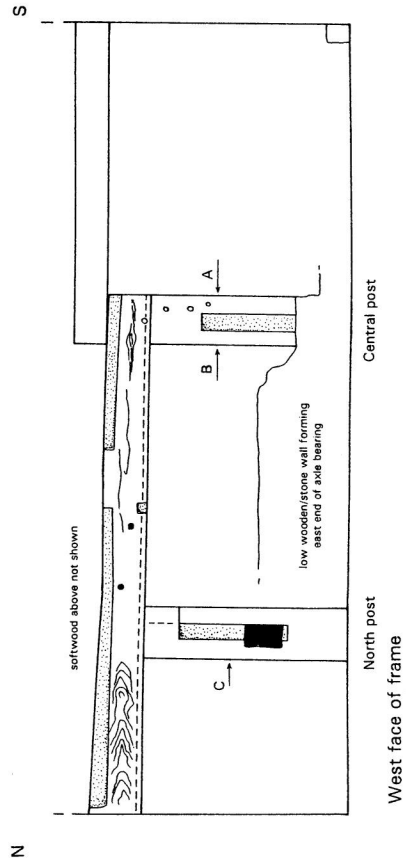
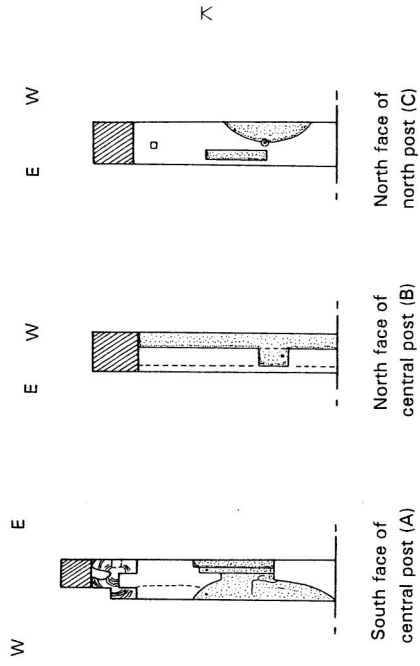
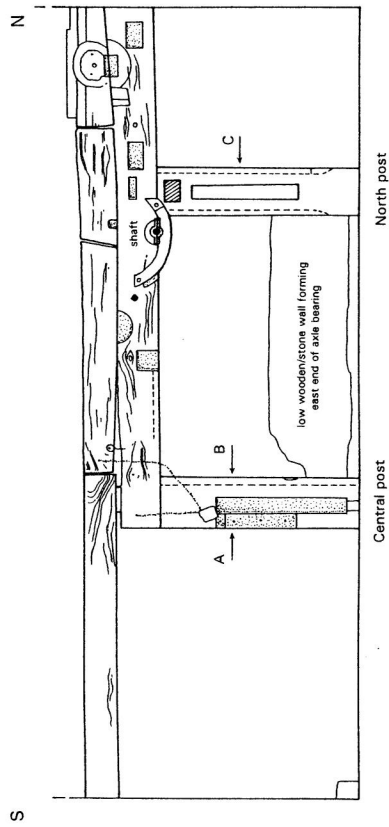



Survey data May-July 2011

PROJECT	WEST MILL, ASKRIGG		
TITLE	MILL - DETAILS OF FRAME		
SCALE	AS SHOWN	DATE	SEPT 2012
	EDAS	FIGURE	36

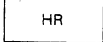
-  BLOCKING
-  CONCRETE BASES
-  HANDRAILS

Roof timbers omitted for clarity  
 Survey data May-July 2011

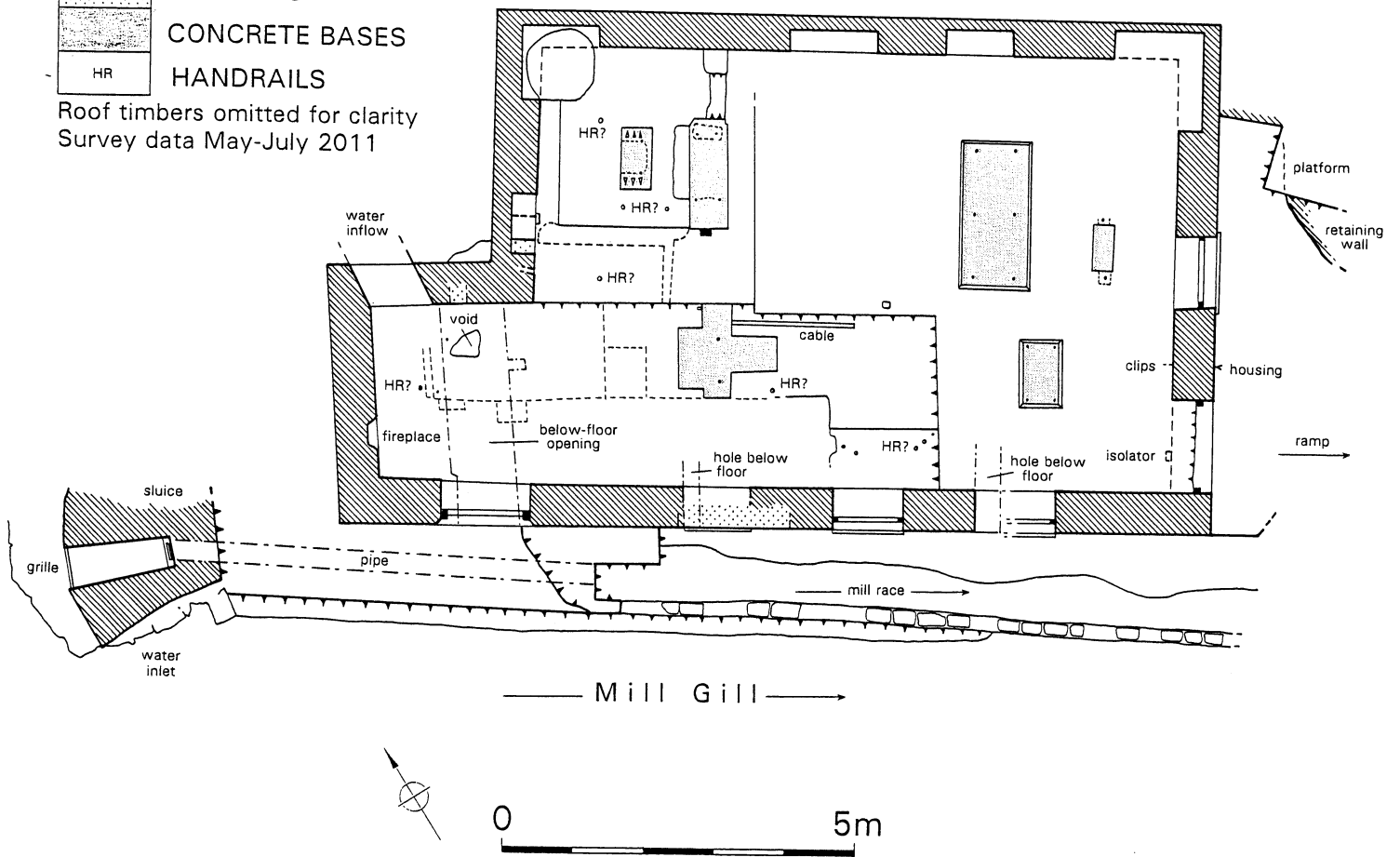

PROJECT		WEST MILL, ASKRIGG	
TITLE		POWER HOUSE - PLAN	
SCALE	AS SHOWN	DATE	SEPT 2012
EDAS		FIGURE	37

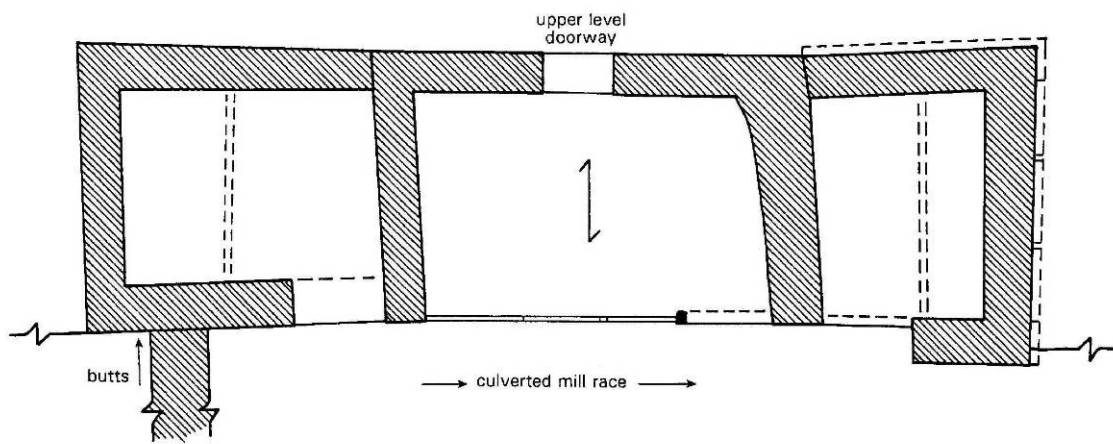

Survey data May-July 2011

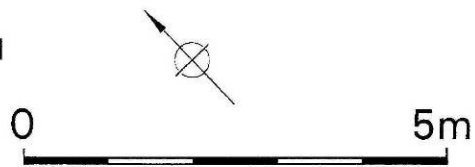

PROJECT		WEST MILL, ASKRIGG	
TITLE		POULTRY HOUSE - PLAN	
SCALE	AS SHOWN	DATE	SEPT 2012
EDAS		FIGURE	38

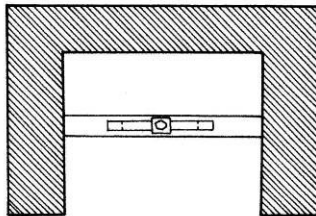

Handle/screw level

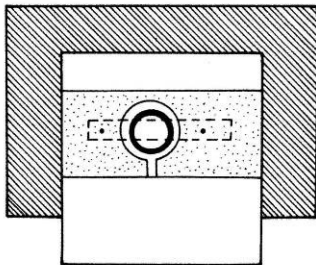

Press level

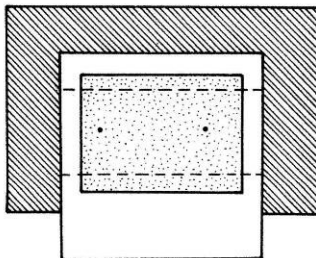

Weight level

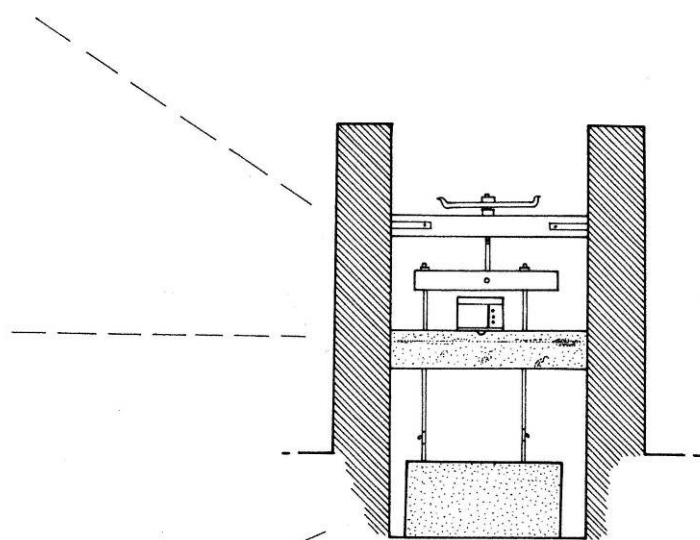

North face



PROJECT		WEST MILL, ASKRIGG	
TITLE		CHEESE PRESS	
SCALE	AS SHOWN	DATE	SEPT 2012
	EDAS	FIGURE	39



Plate 1: General view of Leas House survey area, looking SE (photo 4/964).



Plate 2: Leas House survey area, structure (Site 3a), looking N (photo 4/973).



Plate 3: Leas House survey area, possible kiln (Site 9), looking NE (photo 9/992).



Plate 4: Leas House survey area, field barn (Site 14), looking NW (photo 9/996).



Plate 5: Leas House survey area, 1908-10 collecting chamber and weir (Sites 8a and 8c), looking N (photo 9/998).

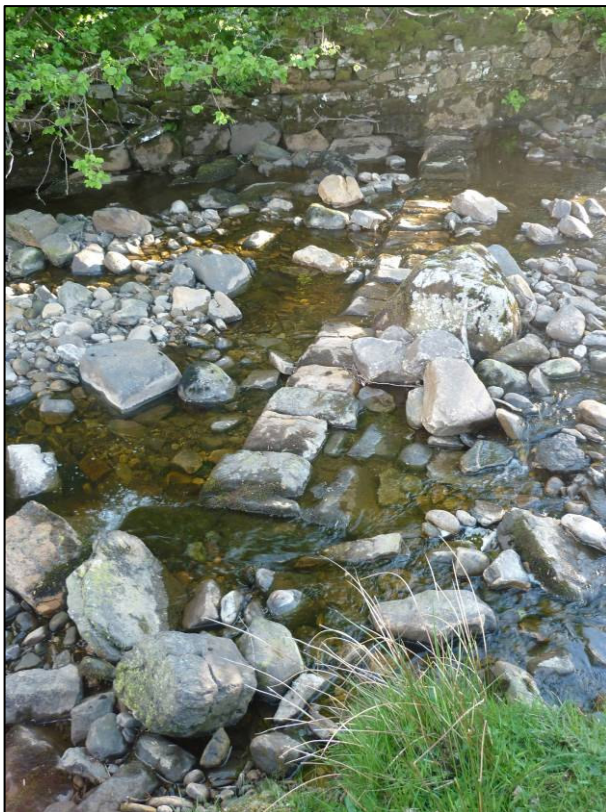

Plate 6: Leas House survey area, weir (Site 12a), looking W (photo 4/982).



Plate 7: Leas House survey area, interior of 1913 collecting chamber (Site 12d) (photo 4/999).



Plate 8: Leas House survey area, inspection pit on line of 1913 culvert (Site 12b), looking N (photo 4/980).



Plate 9: Leas House survey area, pond for 1913 scheme (Site 12c), looking SE (photo 4/991).





Plate 10: Leas House survey area, 1913 collecting chamber (Site 12d), looking E (photo 9/991).



Plate 11: Leas House survey area, 1913 collecting chamber and pond (Sites 12c and 12d), looking S (photo 9/973).



Plate 12: Mill Gill survey area, quarry (Site 23), looking E (photo 8/759).



Plate 13: Mill Gill survey area, track (Site 27) to and from quarry, looking E (photo 8/761).



Plate 14: Mill Gill survey area, ruined structure (Site 21), looking W (photo 8/764).



Plate 15: Mill Gill survey area, natural channel or pond (Site 22), looking SW (photo 8/770).



Plate 16: Mill Gill survey area, building east of the power house (Site 31), looking N (photo 8/815).



Plate 17: Mill Gill survey area, building east of the power house (Site 31) after repairs, looking NW (photo 9/005).

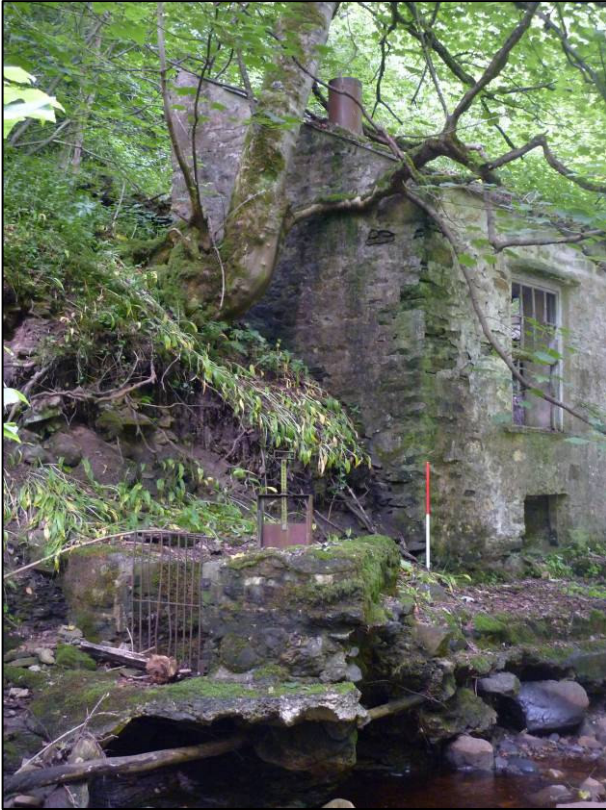

Plate 18: Mill Gill survey area, weir and sluice (Site 29a) next to power house, looking NE (photo 6/804).



Plate 19: Mill Gill survey area, sluice channel (Site 29a) next to power house, looking SE (photo 6/793).



Plate 20: Mill Gill survey area, mill race (Site 29b), looking E (photo 8/829).



Plate 21: Mill Gill survey area, mill pond (Site 29c), looking E (photo 8/865).



Plate 22: Mill Gill survey area, mill pond and sluice (Site 29c), looking SE (photo 9/016).



Plate 23: Mill Gill survey area, head race (Site 29e), looking N (photo 8/758).



Plate 24: Mill Gill survey area, sluice arrangement at south end of header tank (Site 29f), looking S (photo 8/753).



Plate 25: Mill Gill survey area, launder and sluice mechanism (Site 29h), looking SE (photo 8/757).



Plate 26: Mill Gill survey area, overflow from launder (Site 29g), looking N (photo 9/032).





Plate 27: Mill (Site 36a), south external elevation (1), looking N (photo 8/745).



Plate 28: Mill (Site 36a), north external elevation (3), looking S (photo 8/750).



Plate 29: Mill (Site 36a), west external elevation (2), looking NE (photo 5/553).



Plate 30: Mill (Site 36a), east external elevation (4), looking W (photo 5/540).



Plate 31: Mill (Site 36a), ground floor room G2, looking NE (photo 7/058).



Plate 32: Mill (Site 36a), east wall of ground floor room G4 (elevation 15), looking NE (photo 7/079).



Plate 33: Mill (Site 36a), daisy mark on south wall of ground floor room G4 (elevation 11), looking S (photo 7/087).



Plate 34: Mill (Site 36a), launder sluice control on south wall (elevation 11) of first floor room 1F10, looking S (photo 7/978).



Plate 35: Mill (Site 36a), door in south wall (elevation 11) of first floor room 1F10, looking S (photo 7/981).

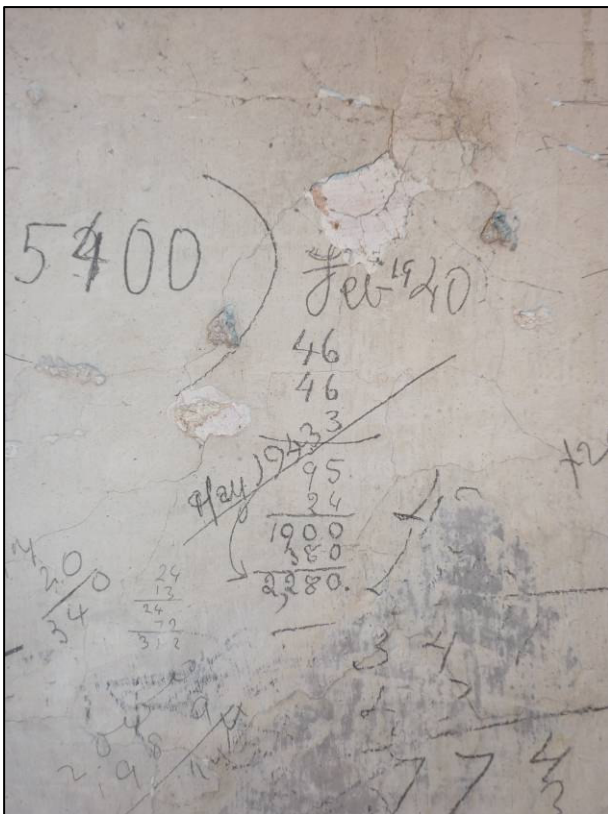

Plate 36: Mill (Site 36a), graffiti on west wall of first floor room 1F11 (elevation 16), looking W (photo 7/969).



Plate 37: Mill (Site 36a), lathe in first floor room 1F11, looking E (photo 7/961).



Plate 38: Mill (Site 36a), north wall of second floor room 2F15 (elevation 13), showing stored hay-rake blanks, looking NW (photo 7/867).



Plate 39: Mill (Site 36a), window at east end of south wall (elevation 11) in second floor room 2F15, looking S (photo 7/887).



Plate 40: Mill (Site 36a), door in west wall (elevation 16) of second floor room 2F16, looking W (photo 7/889).



Plate 41: Mill (Site 36a), inscription 'JPA 1867' to central roof truss in second floor room 2F15, looking SW (photo 7/883).



Plate 42: Garage (Site 36b), west end of south external elevation (10), looking N (photo 5/567).

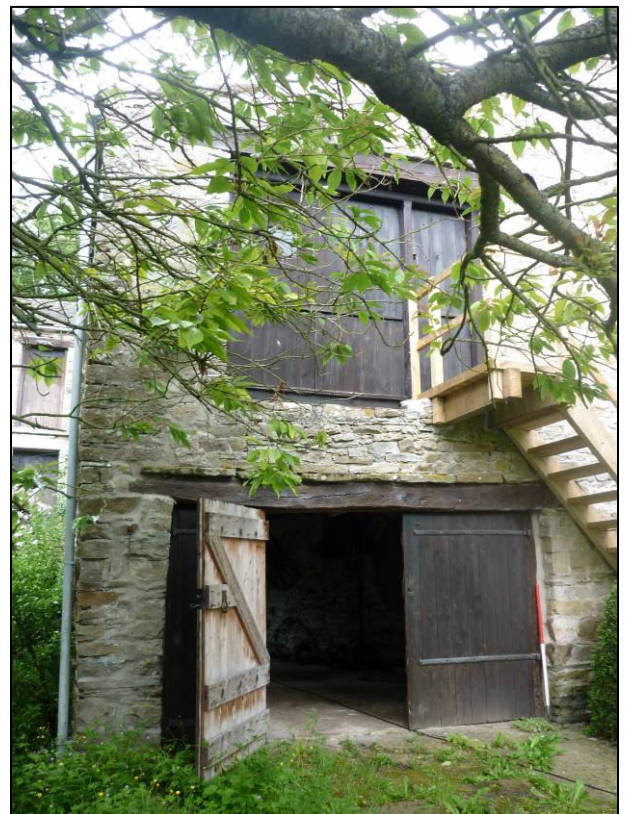

Plate 43: Garage (Site 36b), east external elevation (9), looking W (photo 5/569).



Plate 44: Garage (Site 36b), ground floor room G7, looking E (photo 7/089).



Plate 45: Garage (Site 36b), north wall of ground floor room G7 (elevation 19), looking NW (photo 7/100).



Plate 46: Garage (Site 36b), doorway at east end of north wall (elevation 19) of first floor room 1F12, looking N (photo 7/907).



Plate 47: Garage (Site 36b), south wall (elevation 21) of first floor room 1F12, looking S (photo 7/936).



Plate 48: Garage (Site 36b), bench structure lever etc, north wall (elevation 19) of first floor room 1F12, looking N (photo 7/916).





Plate 49: Kiln range (Site 36c), north external elevation (5), looking S (photo 5/544).



Plate 50: Kiln range (Site 36c), rear of door in west wall (elevation 22) of ground floor room G6, looking W (photo 7/116).



Plate 51: Kiln range (Site 36c), passage around kiln in ground floor room G6, looking E (photo 7/136).



Plate 52: Kiln range (Site 36c), west face of kiln (elevation 26) in ground floor room G6, looking E (photo 7/127).



Plate 53: Kiln range (Site 36c), perforated clay tiles stacked in ground floor room G6 (photo 7/122).



Plate 54: Barn range (Site 36d), south external elevation (8), looking NW (photo 5/573).

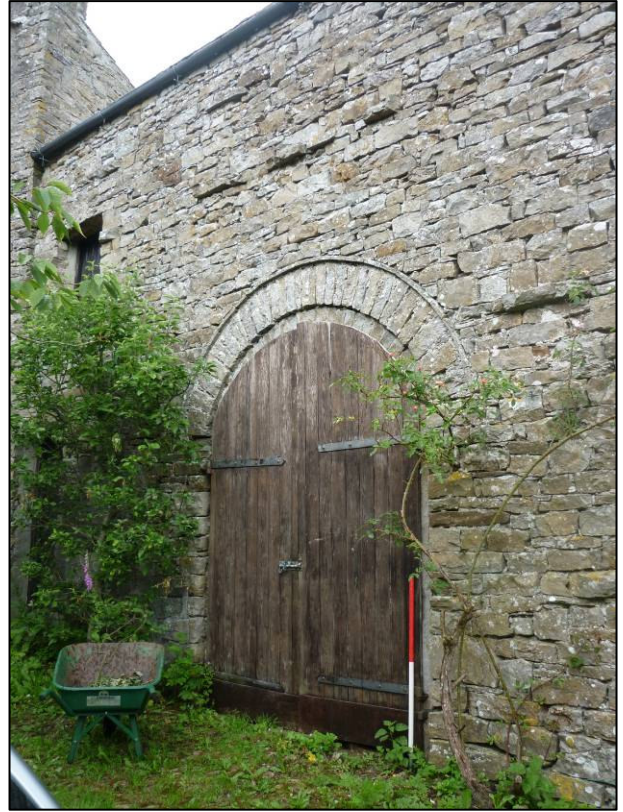

Plate 55: Barn range (Site 36d), cart entrance in south external elevation (8), looking NW (photo 5/571).



Plate 56: Barn range (Site 36d), north external elevation (6), looking S (photo 5/547).



Plate 57: Mill (Site 36a), waterwheel and launder in wheelhouse (G1), looking N (photo 7/174).



Plate 58: Mill (Site 36a), pit wheel in ground floor room G2, looking NW (photo 7/023).



Plate 59: Mill (Site 36a), north post of frame and related beams in ground floor room G2, looking W (photo 7/039).



Plate 60: Garage (Site 36b), pulley with wooden casing on line shaft in first floor room 1F12, looking NE (photo 7/925).



Plate 61: Power house (Site 32), south external elevation, looking NE (photo 6/800).



Plate 62: Power house (Site 32), east external elevation, looking W (photo 8/808).



Plate 63: Mill Gill survey area, bolts on route of pipeline to power house (Site 30b), looking N (photo 8/776).



Plate 64: Power house (Site 32), west window in south elevation, looking S (photo 8/780).



Plate 65: Power house (Site 32), isolator over east doorway, looking E (photo 6/758).



Plate 66: Power house (Site 32), west internal elevation, looking W (photo 8/784).



Plate 67: Power house (Site 32), east internal elevation, looking E (photo 8/782).



Plate 68: Power house (Site 32), 3-phase and neutral supply wiring to west of concrete base, looking E (photo 8/802).



Plate 69: Power house (Site 32), fitting to external east gable (photo 8/803).





Plate 70: Poultry house (Site 33), south external elevation, looking N (photo 3/722).



Plate 71: Poultry house (Site 33), north external elevation, looking SE (photo 3/717).



Plate 72: Poultry house (Site 33), doorway to central south, looking N (photo 3/724).



Plate 73: Poultry house (Site 33), flagged culvert of mill race, looking E (photo 8/836).



Plate 74: Mill Gill survey area, structure to south of poultry house (Site 33),



Plate 75: Mill Gill house cheese press, looking S (photo 6/808).



Plate 76: Mill Gill house cheese press, press section, looking S (photo 6/811).