

ARCHAEOLOGICAL EVALUATION STRATEGY  
FOR SHEFFIELD CASTLE,  
SHEFFIELD, SOUTH YORKSHIRE

VOLUME 1: DATA GATHERING,  
SYNTHESIS AND ASSESSMENT OF POTENTIAL

VOLUME 1B: FIGURES AND PLATES

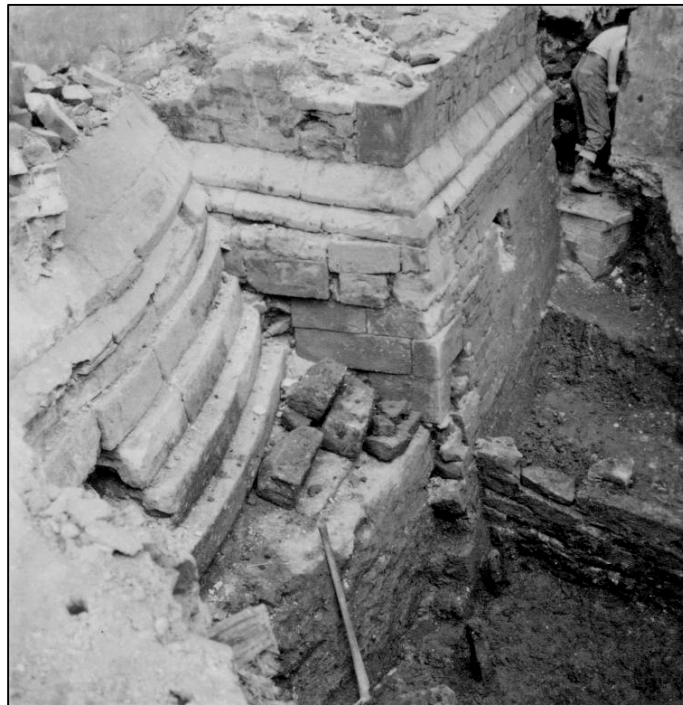

Ed Dennison Archaeological Services Ltd  
18 Springdale Way  
Beverley  
East Yorkshire  
HU17 8NU

ARCHAEOLOGICAL EVALUATION STRATEGY  
FOR SHEFFIELD CASTLE,  
SHEFFIELD, SOUTH YORKSHIRE

VOLUME 1: DATA GATHERING,  
SYNTHESIS AND ASSESSMENT OF POTENTIAL

VOLUME 1B: FIGURES AND PLATES

Report no: 2013/460.R01  
Version: Final  
Date: May 2014  
Author: Shaun Richardson & Ed Dennison

Ed Dennison Archaeological Services Ltd  
18 Springdale Way  
Beverley  
East Yorkshire  
HU17 8NU

On behalf of

Kier Asset Partnership Services Ltd  
on behalf of Sheffield City Council  
Town Hall  
Pinstone Street  
Sheffield S1 2HH



## LIST OF FIGURES

1	General Location
2	Detailed Location
3	Key Areas of Castle Markets
4	Known Castle Remains (2005)
5	2009 Reconstruction
6	Castle Area in c.1700
7	Castle Area in 1736
8	Castle Area in c.1760
9	Castle Area in 1771
10	Castle Area in c.1800
11	Castle Area in c.1853
12	Castle Area in 1905
13	c.1927 Pre-Development Plan
14	Davies' 1928 Section
15	c.1915 Plan for Sheaf Culvert
16	Post 1915 Improvements
17A	Co-Op Foundation Plan c.1927 (digitised)
17B	Co-Op Foundation Plan c.1927
18A	Castle Hill Market Foundations (digitised)
18B	Castle Hill Market Foundation Plan c.1928
19	Castle Area in 1930s
20	1958-61 Re-Development Scheme
21A	1958-61 Foundations (digitised)
21B	1958-61 Foundation Plan
22	Market Extension Plan
23	Market Extension Plan (Phase 5)
24A	Services (digitised)
24B	c.1930s Sewer Plan
25A	Armstrong's Published Plans
25B	Armstrong's Published Sections
26	Himsworth's 1930 Observations
27A	Butcher's Plan of Moat 1
27B	Butcher's Plan of Moat 1
28	Butcher's Field Drawings
29	Butcher's Reconstructions
30	Butcher's North-South Sections
31	Design for Gatehouse Chamber
32	1960s-1970s Photographs
33	Courtyard Buildings 1994
34	ARCUS 1999 Trench
35	ARCUS 2001 Trenches
36	Known Archaeology 1
37	Known Archaeology 2
38	Known Archaeology 3
39	Previous Developments
40	Sections through Site
41	Previous Castle Reconstructions
42	Interim Castle Reconstruction
43	Previous Assessments of Potential
44	Previous Developments and Known Archaeology
45	Archaeological Potential

## LIST OF PLATES

- 1 Aerial photograph of Sheffield Markets, 1st January 2010 (Google Earth).
- 2 Lady's Bridge in 1802, Wicker Tilt on right ([www.picturesheffield.com](http://www.picturesheffield.com), s07499).
- 3 Lady's Bridge and Wicker Tilt (Huntsman's Forge), No. 2, Wicker, before 1901 ([www.picturesheffield.com](http://www.picturesheffield.com), s07493).
- 4 Royal Hotel, Waingate (left) and corner of Exchange Street (right) ([www.picturesheffield.com](http://www.picturesheffield.com), y01611).
- 5 Retaining wall on west side of Castle Folds Lane, taken by J B Himsworth, September 1928 ([www.picturesheffield.com](http://www.picturesheffield.com), y00898).
- 6 Brick wall on Chandlers Row, taken by J B Himsworth, October 1928 ([www.picturesheffield.com](http://www.picturesheffield.com), y00887).
- 7 Overlooking Chandler's Row, taken by J B Himsworth, October 1928 ([www.picturesheffield.com](http://www.picturesheffield.com), y00884 - blurred).
- 8 Shambles Lane, Wholesale Meat Market and Slaughter Houses, taken 1900 ([www.picturesheffield.com](http://www.picturesheffield.com), s01744).
- 9 Demolition of Shambles Slaughter House, newly built sewer manhole (for a new road for the continuation of Bridge Street) right, Lady's Bridge Hotel and Exchange Brewery in background, taken by J B Himsworth, September 1929 ([www.picturesheffield.com](http://www.picturesheffield.com), y00890).
- 10 Remains of Shambles Slaughter House, showing ancient beams discovered in a horizontal position and newly built sewer manhole (for a new road for the continuation of Bridge Street) in background, taken by J B Himsworth, September 1929 ([www.picturesheffield.com](http://www.picturesheffield.com), y00892).
- 11 Shambles Lane approach, taken by J B Himsworth ([www.picturesheffield.com](http://www.picturesheffield.com), y00889).
- 12 Rear view of Alexandra Theatre, showing stilts over the combined flow of the rivers Don and Sheaf, from Exchange Street Bridge, taken 1900-1919 ([www.picturesheffield.com](http://www.picturesheffield.com), s12223).
- 13 "East wall of passage connected with the Sheffield Castle", off Castle Folds Lane, taken June 1918 (MSA: Sheffield Castle Project File) (photo 3/872).
- 14 "Part of Sheffield Castle wall, discovered while pulling down old house built in 1666 on the site of the Sheffield Castle moat", taken June 1918 (MSA Sheffield Castle Project File) (photo 3/881).
- 15 "West wall of passage, but East of Castle site", taken June 1918 (MSA: Sheffield Castle Project File) (photo 3/875).
- 16 Construction of Sheaf culvert, 1915-16 (photo IMG 6025 supplied by SCC).

- 17 Waingate, junction with Exchange Street, Haymarket and Castle Street, 1925-1939, showing single storey Brightside and Carbrook Co-operative Society building ([www.picturesheffield.com](http://www.picturesheffield.com), s20303).
- 18 Brightside and Carbrook Co-operative Society building, Exchange Street frontage, post 1936 as another three floors have been added ([www.picturesheffield.com](http://www.picturesheffield.com), s11206).
- 19 Brightside and Carbrook Co-operative Society building, Exchange Street frontage, after air raid on 12th/13th December 1940 ([www.picturesheffield.com](http://www.picturesheffield.com), s01212 - © Sheffield Newspapers).
- 20 Interior of Castle Hill Market showing the square acre meat market ([www.picturesheffield.com](http://www.picturesheffield.com), w00572).
- 21 Castle Hill Market, vehicle entrance from Waingate, taken 9th May 1930 ([www.picturesheffield.com](http://www.picturesheffield.com), y02887).
- 22 Scrivens Opticians, 36-40 Waingate, looking E (photo 4/382).
- 23 Bull and Mouth Public House (now Tap and Barrel), 42 Waingate, taken 10th February 1982 ([www.picturesheffield.com](http://www.picturesheffield.com), s21924 - © Sheffield Newspapers).
- 24 Alexandra Hotel, at the junction of Castlegate and Exchange Street, taken 25th January 1979 ([www.picturesheffield.com](http://www.picturesheffield.com), s22233 - © Sheffield Newspapers).
- 25 Former South Yorkshire Passenger Transport Office, Exchange Street (photo 4/367).
- 26 The Market Tavern and Mudfords Building, Exchange Street (photo 4/370).
- 27 Low Block, part of the 1958-61 redevelopment works (photo IMG 5532 supplied by SCC).
- 28 The 'High Block', part of the 1958-61 redevelopment works ([www.picturesheffield.com](http://www.picturesheffield.com), s02016).
- 29 East Loading Dock, looking NW (photo 4/348).
- 30 Former Sheffield Transport canteen building, Castlegate frontage (photo IMG 5552 supplied by SCC).
- 31 Buildings forming Phase 5 Market extension, looking N (photo 4/380).
- 32 Spiral ramp at north end of East Loading Dock, looking S (photo IMG 5550 supplied by SCC).
- 33 1972 retaining wall on south side of Castlegate, with North Loading Dock above (photo 4/388).
- 34 Western bastion tower and gatehouse structure (MSA Box file - Butcher 1976.1064 Sheffield Castle Notes/Photographs folder SC2/3)
- 35 Detail of gatehouse structure (MSA Box file - Butcher 1976.1064 Sheffield Castle Notes/Photographs folder SC2/3).

- 36 Detail of western bastion tower (MSA Box file - Butcher 1976.1064 Sheffield Castle Notes/Photographs folder SC2/3).
- 37 "H 2-4 from E. Drawbridge pier, ashlar face, E" (MSA Box file - Butcher 1976.1064 Sheffield Castle Notes/Photographs folder SC2/3).
- 38 Oldest Furnace in Sheffield, on site of Sheffield Castle, October 1928 ([www.picturesheffield.com](http://www.picturesheffield.com), s10000).
- 39 *Ex situ* masonry recorded behind Chandlers Row retaining wall, photographed by J B Himsworth, October 1930 ([www.picturesheffield.com](http://www.picturesheffield.com), y00900).
- 40 View taken after both Chandlers Row and Shambles Lane buildings had been demolished, leaving only the high south retaining wall to Chandlers Row still standing, looking W (photo 2/673).
- 41 Stepped bank on south side of Castlegate created by cutting back behind the former retaining wall to Chandlers Row (photo 2/683).
- 42 "Dry spars from moat A, 4 May 1958" (MSA 1995.88 Sheffield Castle 1958-63).
- 43 The 'comparatively late rough wall' built across the moat between the gate and drawbridge structures (MSA: Butcher b/w prints).
- 44 Subsidiary ditch or moat, revealed in section on north side of Exchange Street (MSA: Butcher b/w prints).
- 45 One of Butcher's isometric drawings of the gate structures (MSA: 1995.88 Sheffield Castle 1958-63 colour slide).
- 46 Collapsing paving covering the steep north-facing slope to Castlegate, photographed by Pauline Beswick, May 1972 (MSA Box file - Sheffield Castle Project File) (photo 3/884).
- 47 Revetment wall in steep north-facing slope to Castlegate, photographed by Pauline Beswick, May 1972 (MSA Box file - Sheffield Castle Project File) (photo 3/888).
- 48 Remains of gate structures in underground chamber, November 2013 (photo 5/645).
- 49 Remains of courtyard buildings in underground chamber, August 1975 ([www.picturesheffield.com](http://www.picturesheffield.com), s29251 - © Sheffield Newspapers).
- 50 Remains of courtyard buildings in underground chamber, October 2013 (photo 4/333).



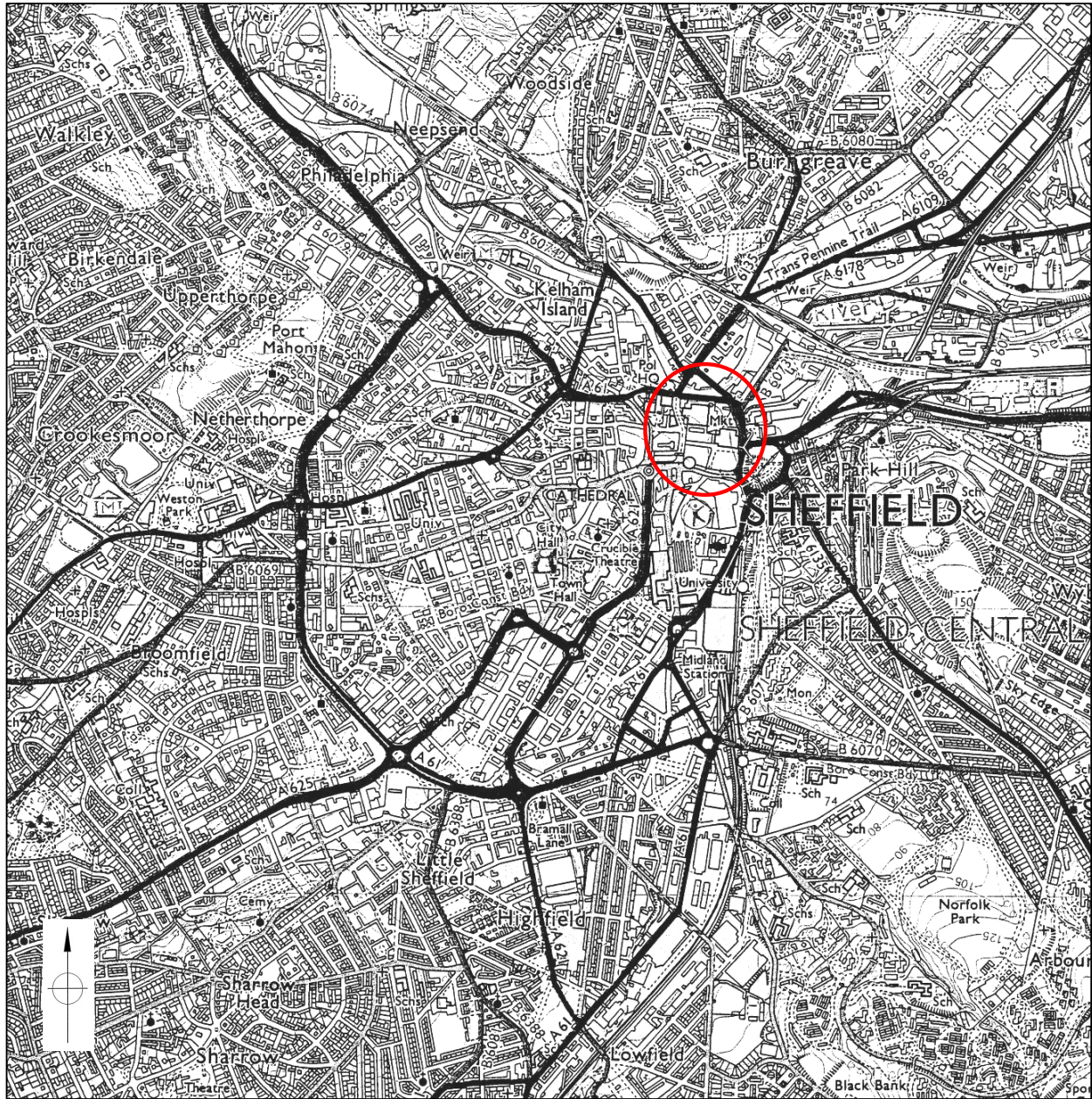



© Crown copyright and Database rights  
 Ordnance Survey Licence 100013825 (2014).

PROJECT		SHEFFIELD CASTLE STRATEGY	
TITLE		GENERAL LOCATION	
SCALE	DATE	NTS	MAY 2014
EDAS		FIGURE	1

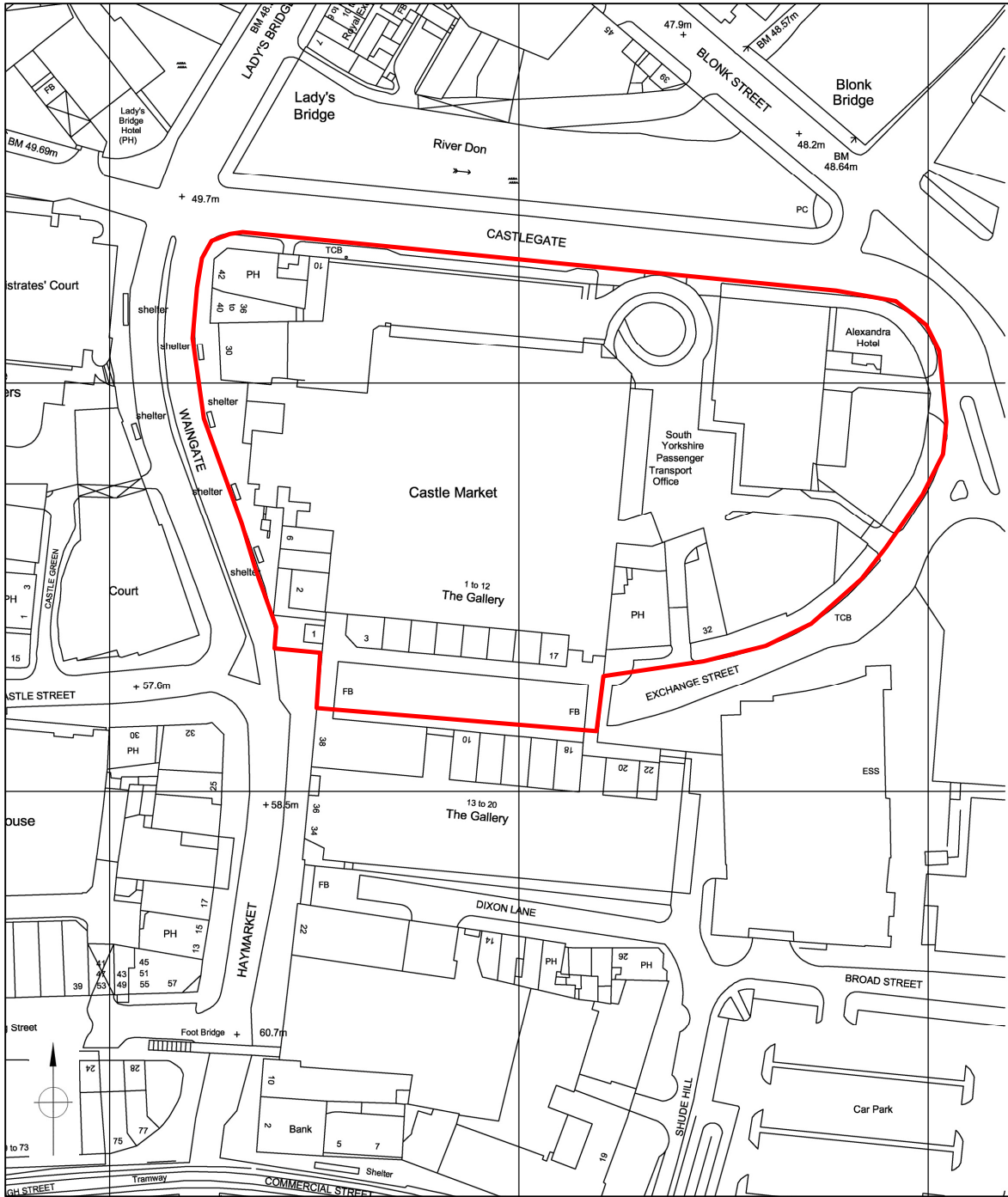



 STUDY AREA

Base plan provided by Kier Asset Partnership Services Ltd.

PROJECT		SHEFFIELD CASTLE STRATEGY	
TITLE		DETAILED LOCATION	
SCALE	DATE	NTS	MAY 2014
EDAS		FIGURE 2	

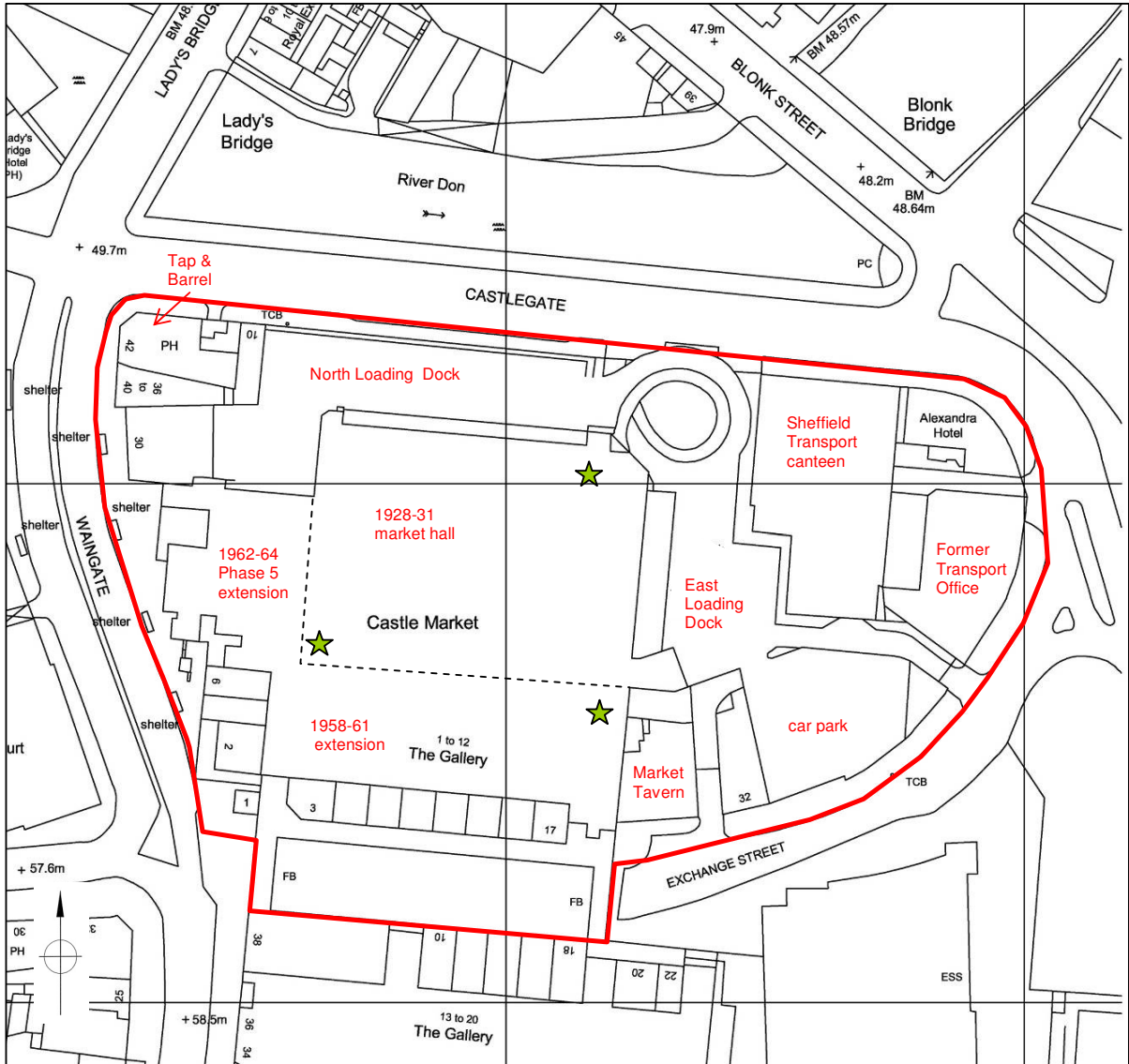

— STUDY AREA

★ LISTED BUILDINGS

Base plan provided by Kier Asset Partnership Services Ltd.

PROJECT		SHEFFIELD CASTLE STRATEGY	
TITLE		KEY AREAS OF CASTLE MARKETS	
SCALE	DATE	NTS	MAY 2014
EDAS		FIGURE	3

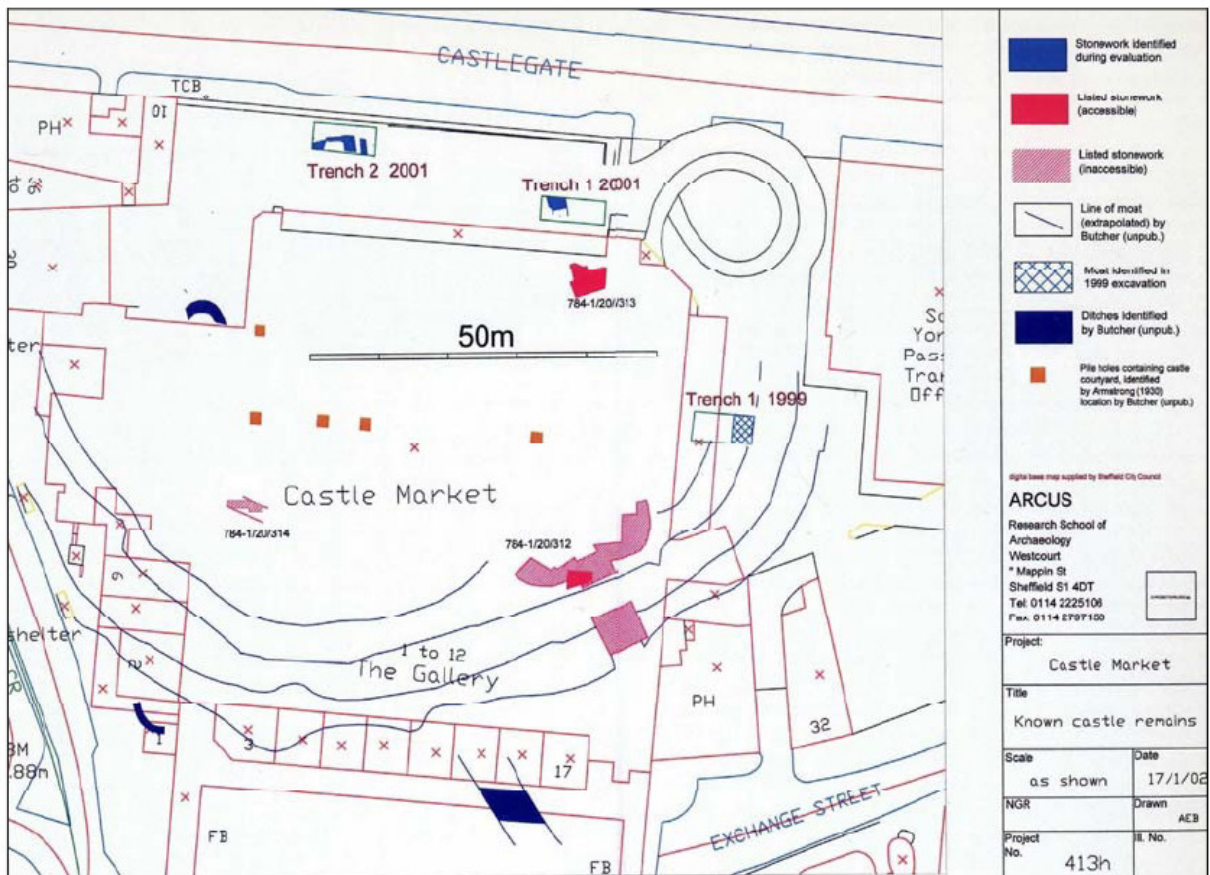

ARCUS plan of known archaeological remains produced in 2005.

Source: EDAS 2005 *Castlegate: Policy and Development Framework*, Appendix A.

PROJECT		SHEFFIELD CASTLE STRATEGY	
TITLE			
KNOWN CASTLE REMAINS (2005)			
SCALE	DATE		
AS SHOWN	MAY 2014		
EDAS		FIGURE	
		4	



## Identified elements and Layout of Sheffield Castle

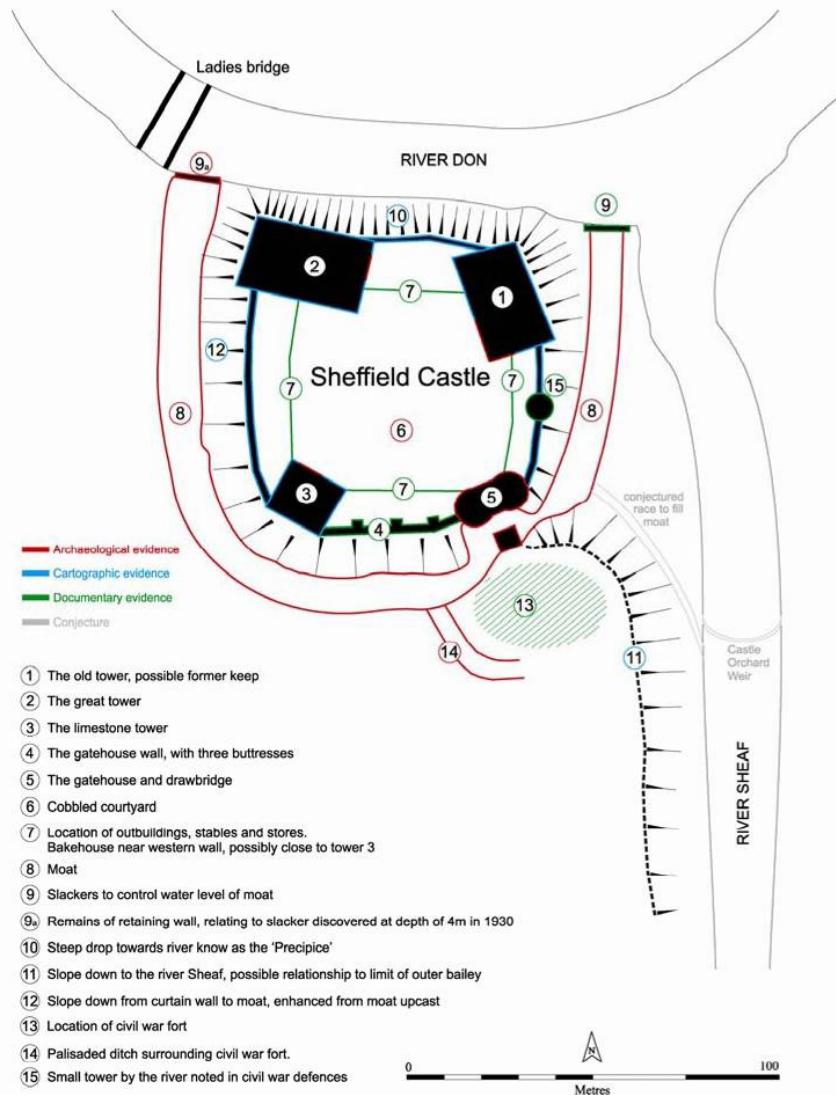

Source: McCoy, M & Stenton, M 2009 *Sheffield Castle, Sheffield: Archive Scoping Review* (unpublished ARCUS report 669b(1) for Sheffield City Council), figure 1.

PROJECT		SHEFFIELD CASTLE STRATEGY	
TITLE		2009 RECONSTRUCTION	
SCALE	AS SHOWN	DATE	MAY 2014
EDAS		FIGURE	5

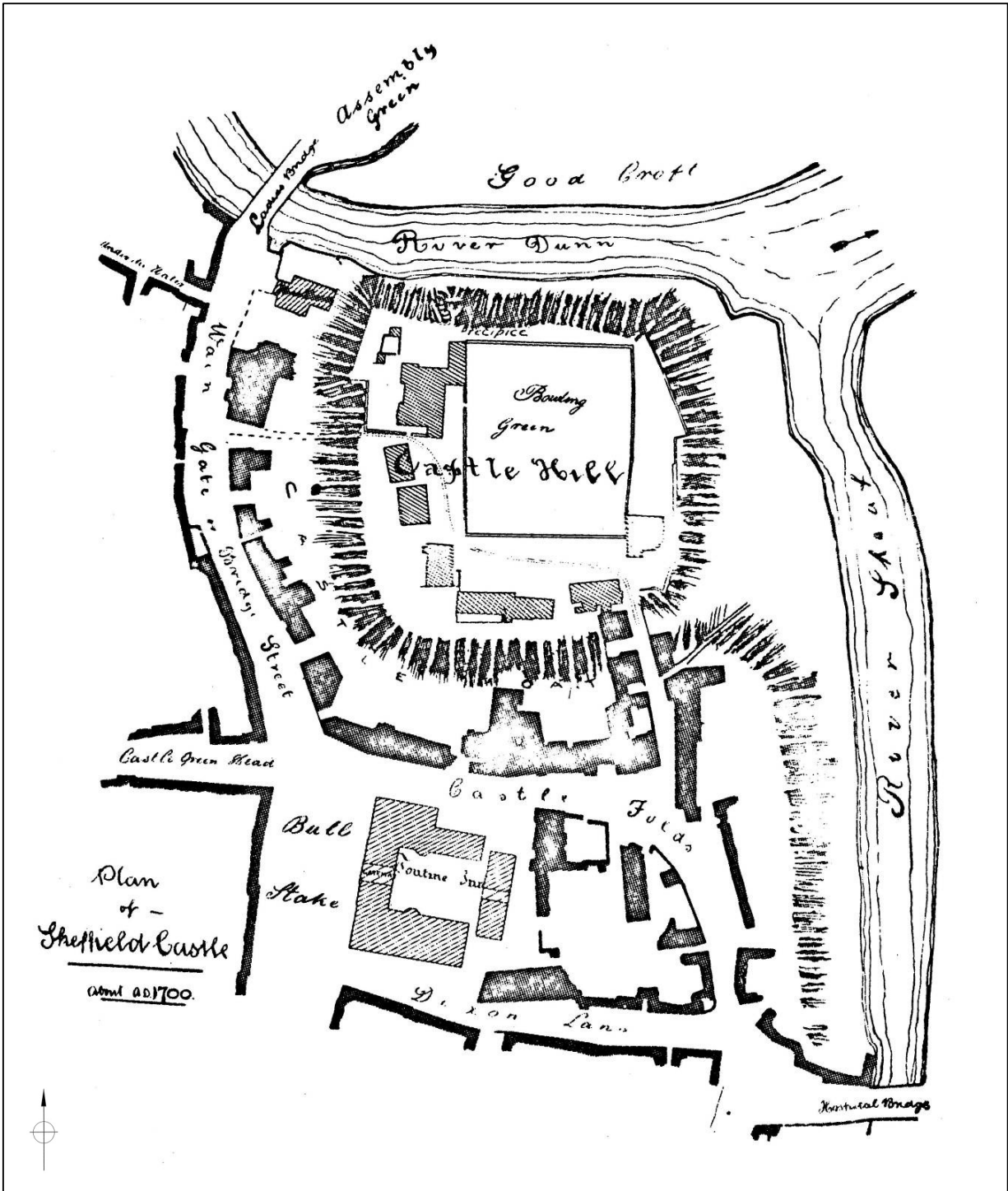

"Reconstruction of Sheffield Castle in about AD 1700" by Thomas Winder.

Source: Winder, T 1907 *T'heft an' Blades O'Sheffield*.

PROJECT		SHEFFIELD CASTLE STRATEGY	
TITLE		CASTLE AREA IN c. 1700	
SCALE	AS SHOWN	DATE	MAY 2014
EDAS		FIGURE	6

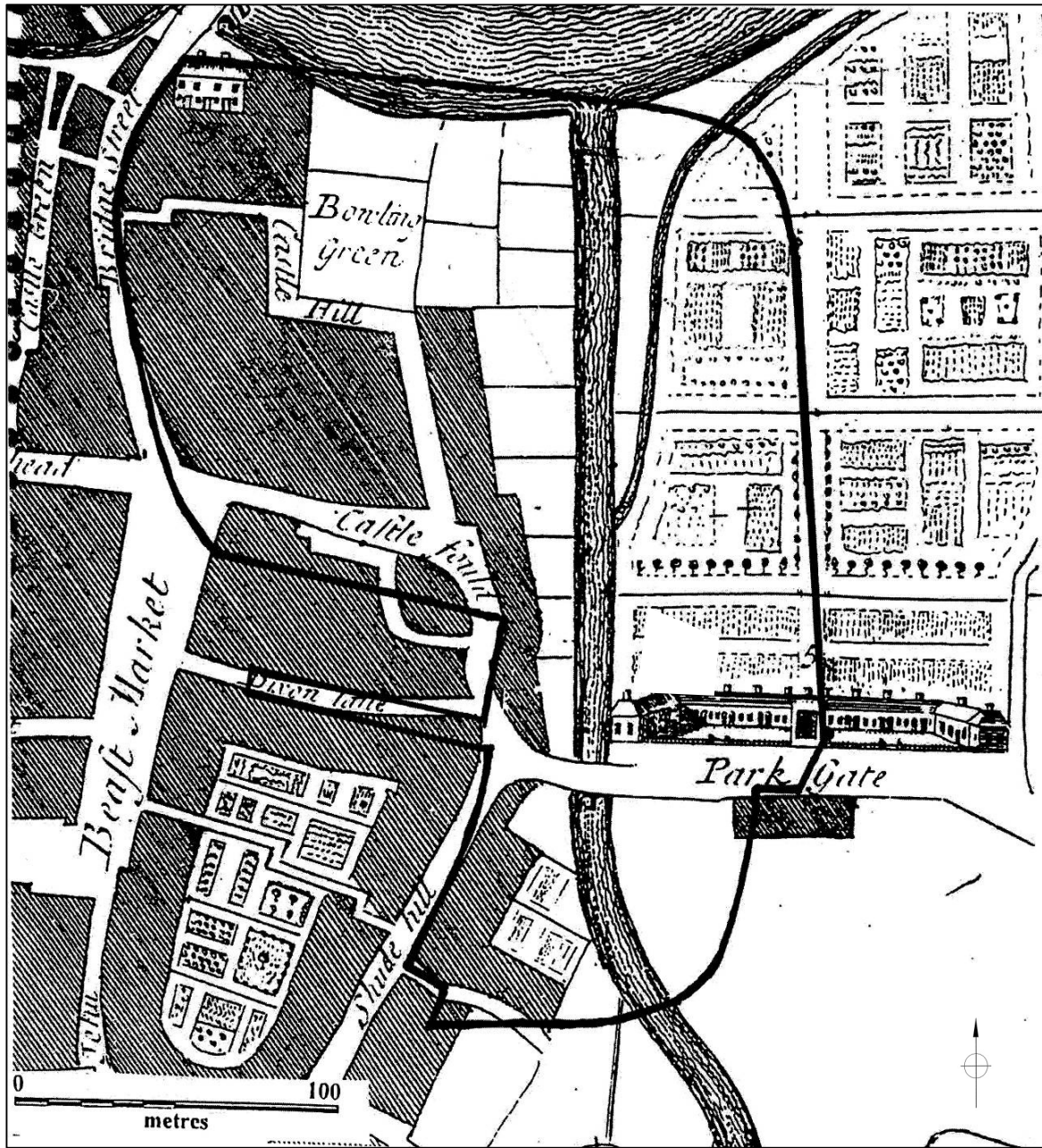

Extract from "A Plan of Sheffield from an Actual Survey by R Gosling 1736".

5: Talbot Earl of Shrewsbury's Hospital.  
15: Alms House.

Source: Belford, P 1998 *An Archaeological Desk-Based Assessment of the Sheffield Markets Site, Sheffield, South Yorkshire*, illustration 6 (unpublished ARCUS report 413).

Note: black line denotes Belford's 1998 study area.

PROJECT		SHEFFIELD CASTLE STRATEGY	
TITLE		CASTLE AREA IN 1736	
SCALE	AS SHOWN	DATE	MAY 2014
EDAS		FIGURE	7

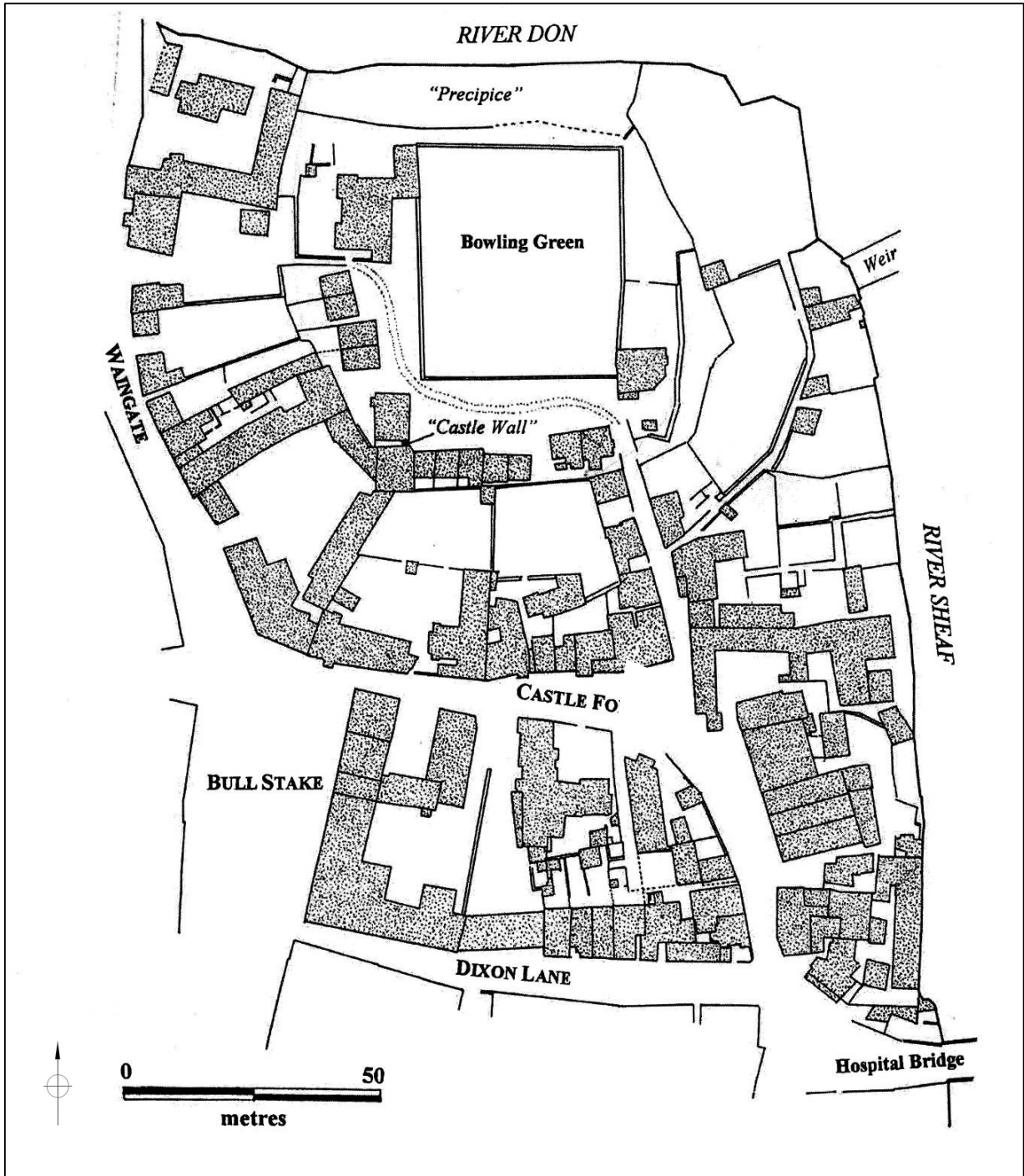

Composite plan produced from Fairbanks maps.

Source: Belford, P 1998 *An Archaeological Desk-Based Assessment of the Sheffield Markets Site, Sheffield, South Yorkshire*, illustration 7 (unpublished ARCUS report 413).

PROJECT		SHEFFIELD CASTLE STRATEGY	
TITLE		CASTLE AREA IN c. 1760	
SCALE	AS SHOWN	DATE	MAY 2014
EDAS		FIGURE	8



Extract from "A Correct Plan of the Town of Sheffield in the County of York drawn by Wm. Fairbank 1771.

Source:  
<http://www.picturesheffield.com/maps.php?file=010>.

PROJECT		SHEFFIELD CASTLE STRATEGY	
TITLE		CASTLE AREA IN 1771	
SCALE	DATE	NTS	MAY 2014
EDAS		FIGURE	9



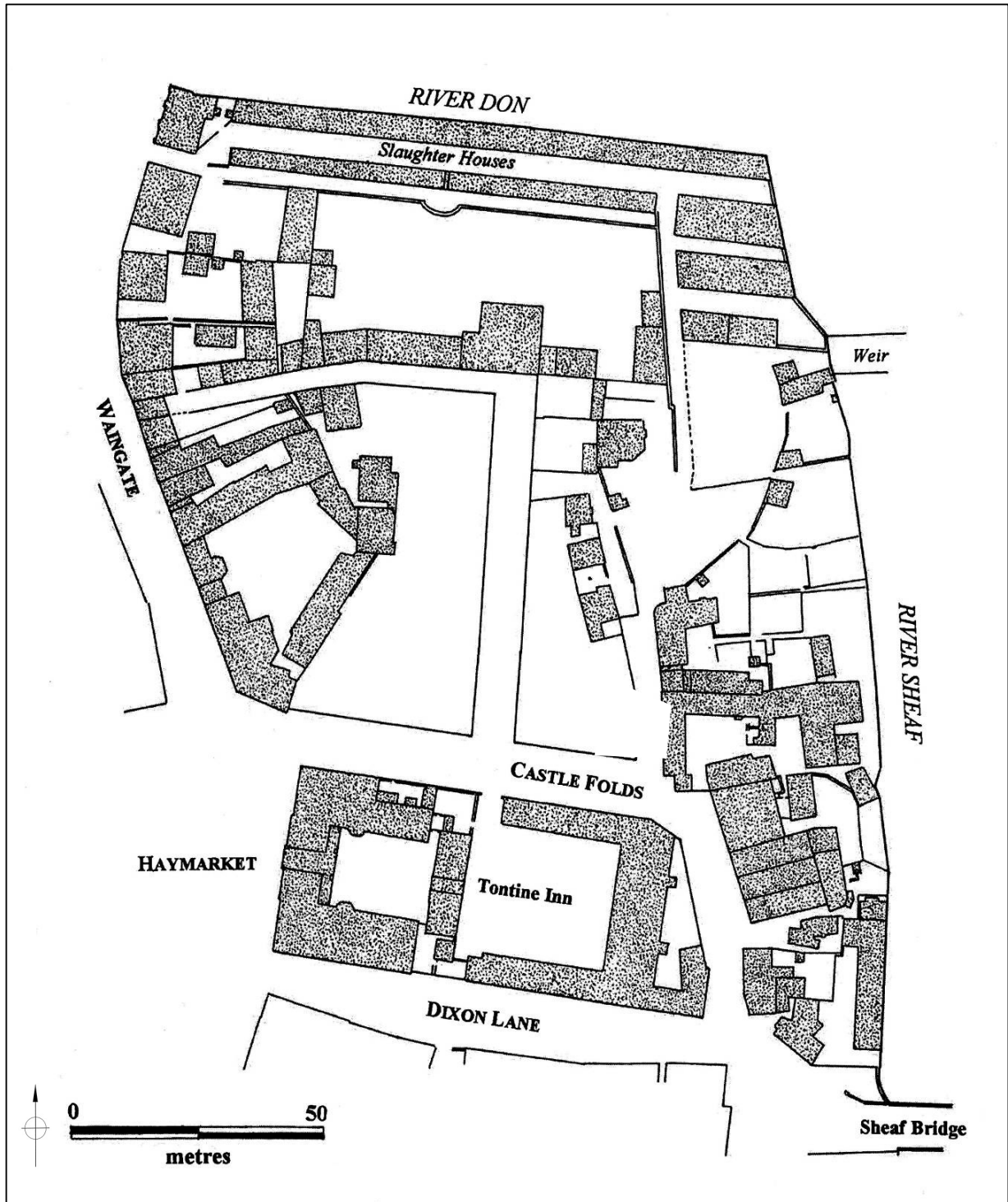

Composite plan produced from Fairbanks maps.

Source: Belford, P 1998 *An Archaeological Desk-Based Assessment of the Sheffield Markets Site, Sheffield, South Yorkshire*, illustration 8 (unpublished ARCUS report 413).

PROJECT		SHEFFIELD CASTLE STRATEGY	
TITLE		CASTLE AREA IN c. 1800	
SCALE	AS SHOWN	DATE	MAY 2014
	EDAS	FIGURE	10

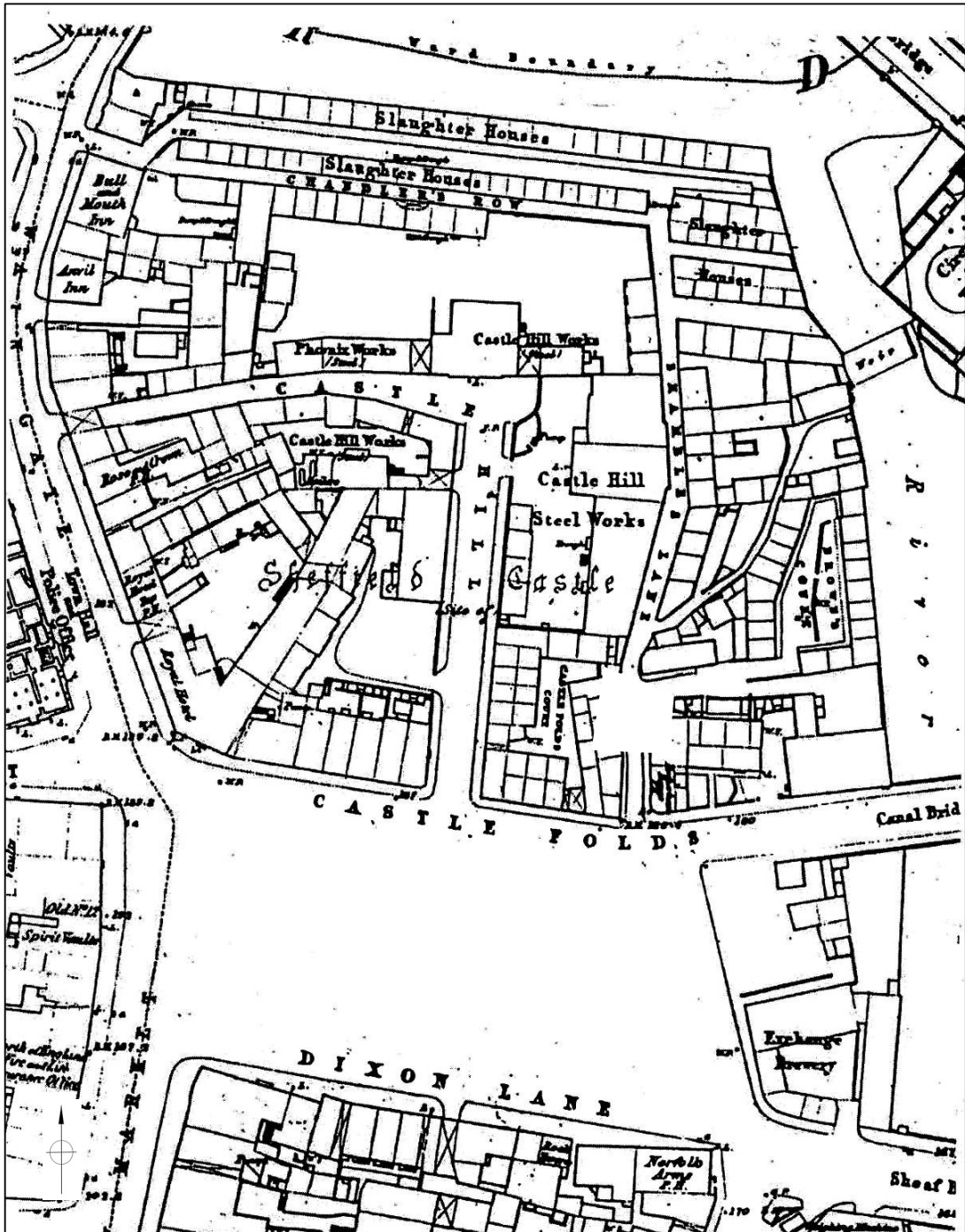

Detail from Ordnance Survey 1853 1:1056 scale map (5ft:1 mile) (sheet 20).

Source: Belford, P 1998 *An Archaeological Desk-Based Assessment of the Sheffield Markets Site, Sheffield, South Yorkshire*, illustration 9 (unpublished ARCUS report 413).

PROJECT		SHEFFIELD CASTLE STRATEGY	
TITLE		CASTLE AREA IN c.1853	
SCALE	DATE	NTS	MAY 2014
EDAS		FIGURE 11	

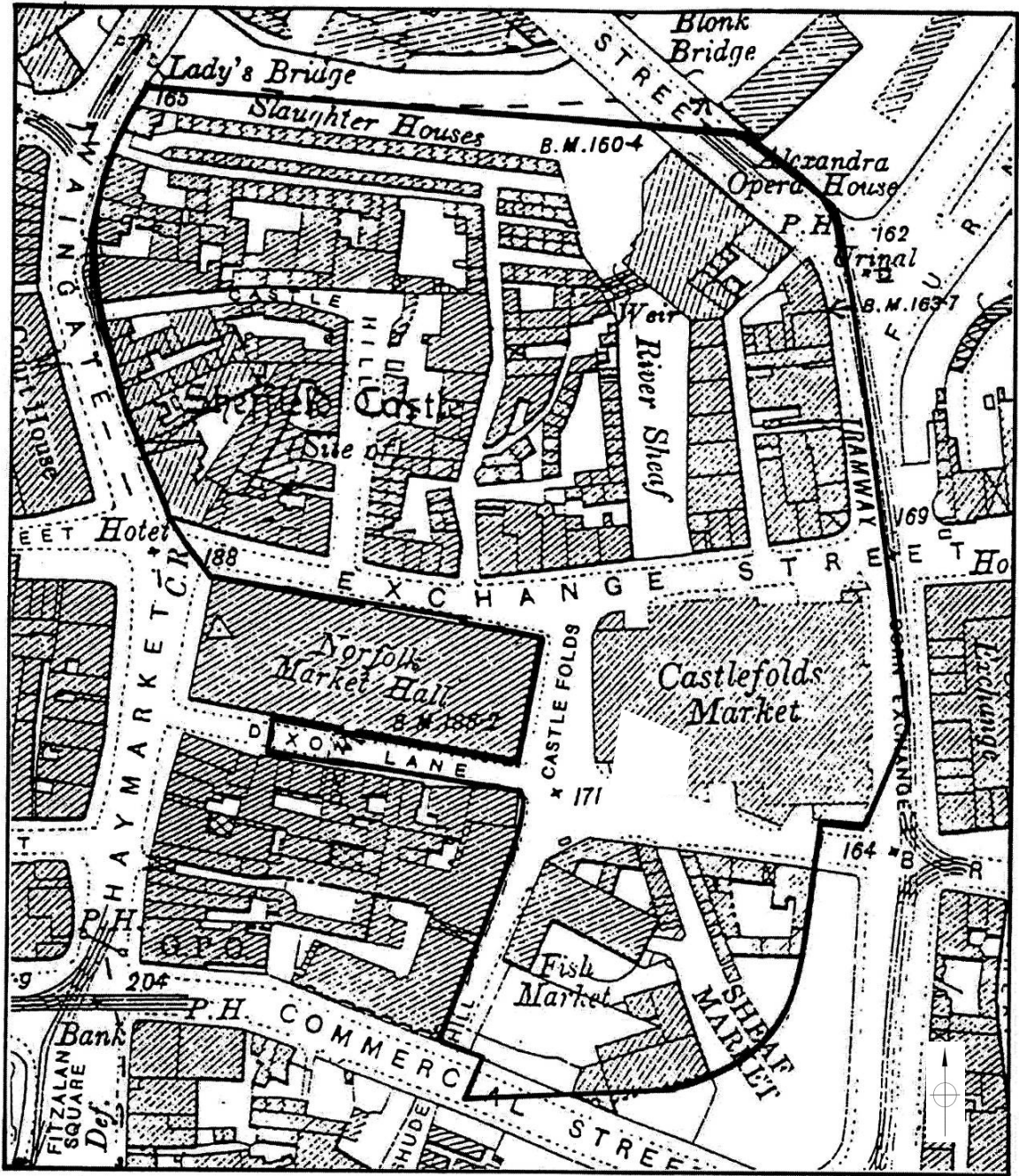

Detail from Ordnance Survey 1905 25" map (sheet 294/8), surveyed 1889-91, revised 1903.

Source: Belford, P 1998 *An Archaeological Desk-Based Assessment of the Sheffield Markets Site, Sheffield, South Yorkshire*, illustration 12 (unpublished ARCUS report 413).

Note: black line denotes Belford's 1998 study area.

PROJECT		SHEFFIELD CASTLE STRATEGY	
TITLE		CASTLE AREA IN 1905	
SCALE	AS SHOWN	DATE	MAY 2014
EDAS		FIGURE	12





Source: MSA Box file - Drawings Plans Maps.

PROJECT		SHEFFIELD CASTLE STRATEGY	
TITLE		c.1927 PRE-DEVELOPMENT PLAN	
SCALE	AS SHOWN	DATE	MAY 2014
EDAS		FIGURE	13



PROJECT		SHEFFIELD CASTLE STRATEGY	
TITLE		DAVIES' 1928 SECTION	
SCALE	NTS	DATE	MAY 2014
EDAS		FIGURE	14

CITY OF SHEFFIELD MARKETS COMMITTEE  
 PROPOSED NEW RETAIL MARKET CASTLE HILL  
 1/4" SCALE DETAIL CONTINUATION OF SECTION C.C. DWG. NO 7269.

DRAWING No 7525  
 W.G. Davies

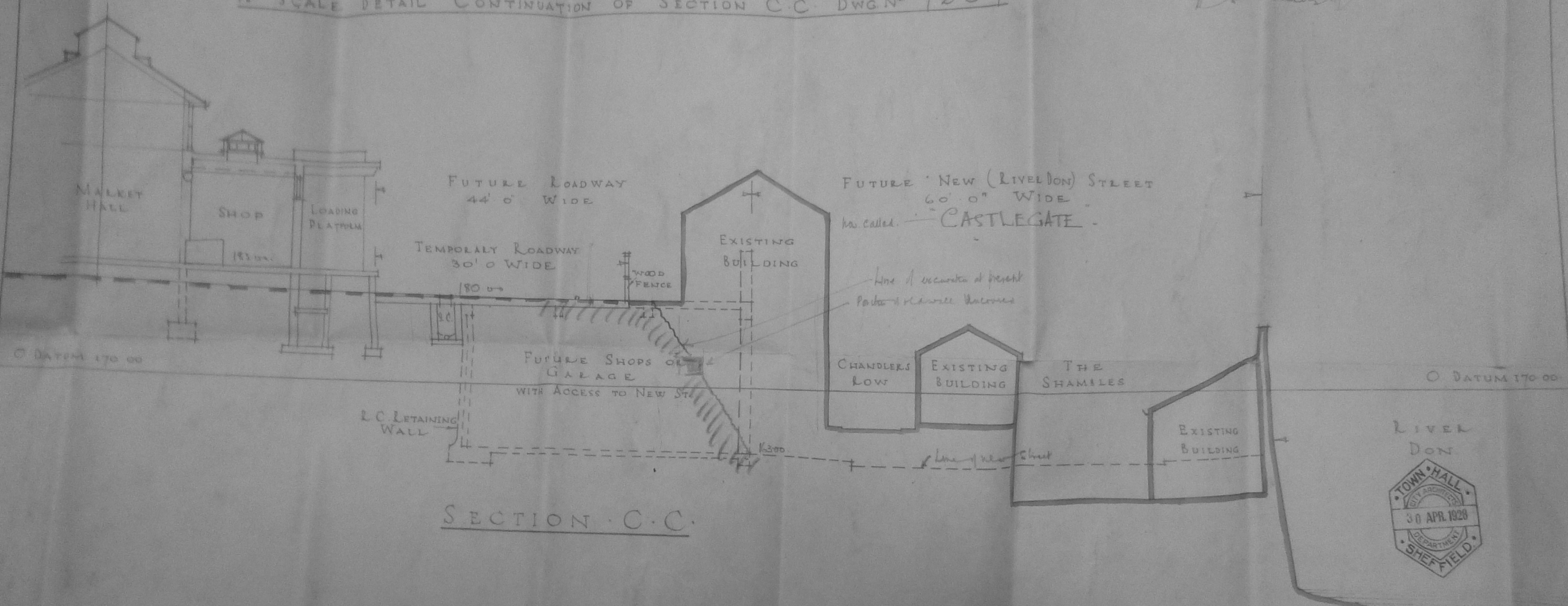

SECTION C.C.

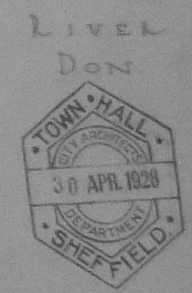

W. G. DAVIES F.R.I.B.A.  
 CITY ARCHITECT.



**CITY OF SHEFFIELD**  
**COVERING OF RIVER SHEAF — GENERAL PLAN & SECTION**

DRAWING No 173.

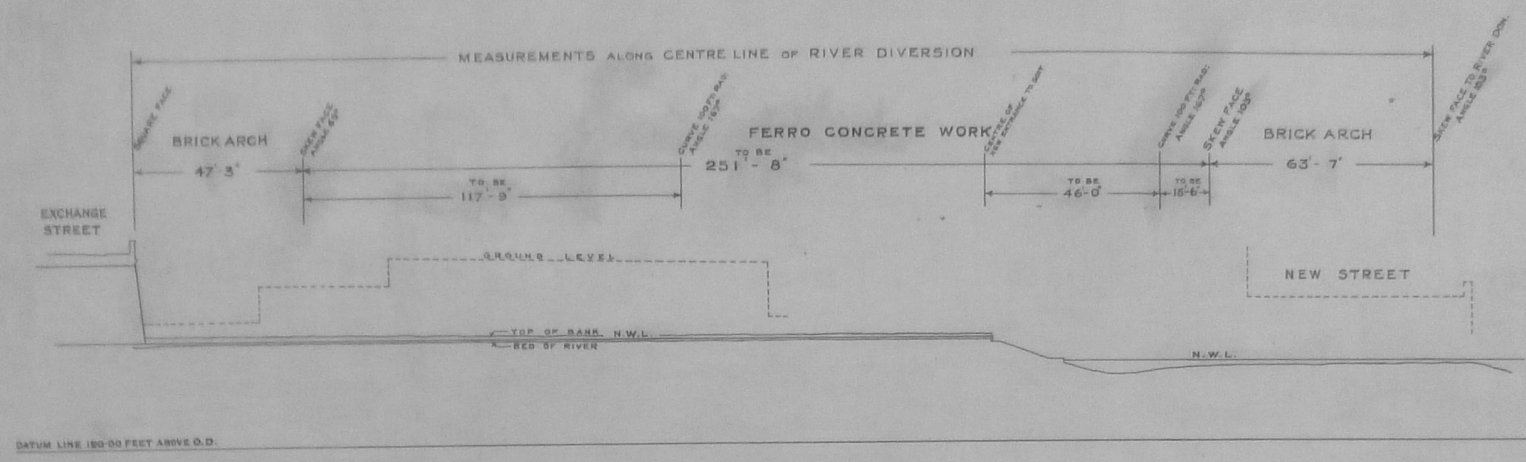

LONGITUDINAL SECTION A-B.

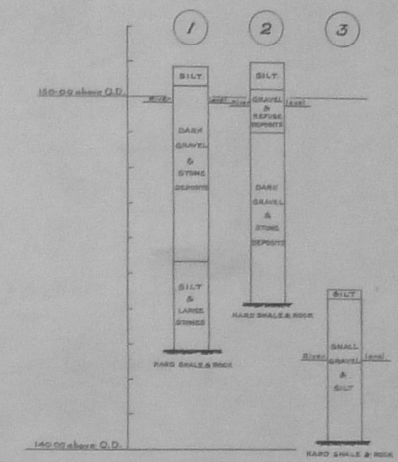

SECTIONS OF TRIAL HOLES.

**NOTE:**  
 The City Engineer accepts no responsibility for the accuracy of the information given in the above sections of trial holes. Contractors must satisfy themselves as to the precise nature of the strata they deal with.

**REFERENCE:**  
 LEVELS ABOVE ORDNANCE DATUM SHOWN THUS 150.00  
 SOUNDINGS BELOW WATER LEVEL SHOWN THUS @ 10.0'

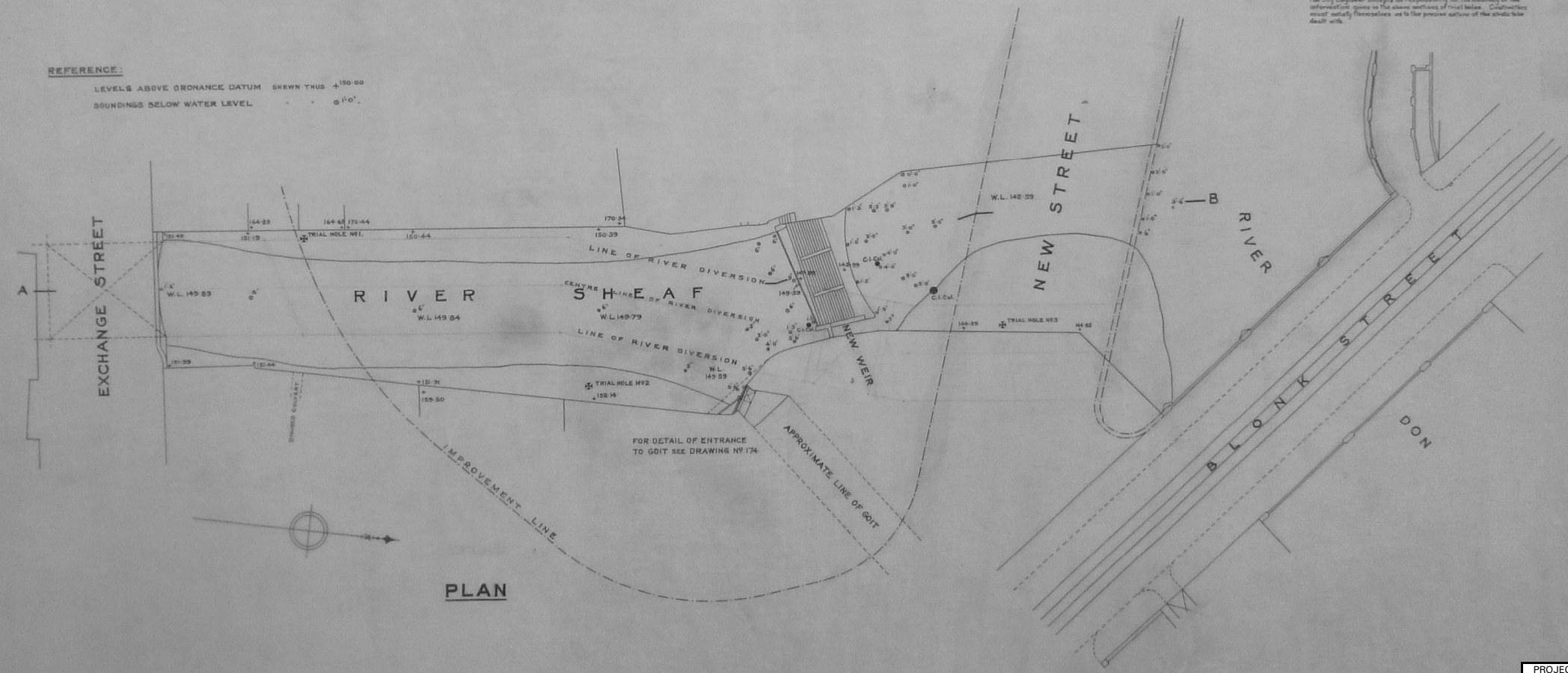

PLAN

D/424/20

DRAWING No 173.

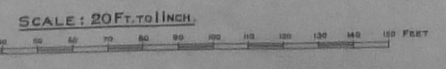

PROJECT		SHEFFIELD CASTLE STRATEGY	
TITLE		c.1915 PLAN FOR SHEAF CULVERT	
SCALE	AS SHOWN	DATE	MAY 2014
	EDAS	FIGURE	15



DRAWING NO 4927  
 TAKING FROM PLAN DATED 1915  
 IMPROVEMENT SURVEYOR 20/1/15

REFERENCE

- EXISTING WIDTH OF WAINGATE, EXCHANGE ST & BLONK ST (AS WIDENED) COLOURED BROWN
- ORIGINAL BOUNDARY OF MARKETS COMMITTEES LAND EDGED BLUE
- ORIGINAL BOUNDARY OF IMPROVEMENT COMMITTEES LAND EDGED GREEN
- PORTION OF MARKETS COMMITTEES LAND SOLD TO BRIGHTSIDE AND CARBROOK CO-OPERATIVE SOCIETY STRIPED BLUE
- LAND SOLD EDGED RED
- LAND WHICH WILL BE AVAILABLE FOR MARKETS COMMITTEE AT THE COMPLETION OF IMPROVEMENT COLOURED YELLOW
- PROPERTIES NOT YET ARRANGED FOR COLOURED GREY
- NEW ROAD BLONK STREET TO WAINGATE COLOURED PINK

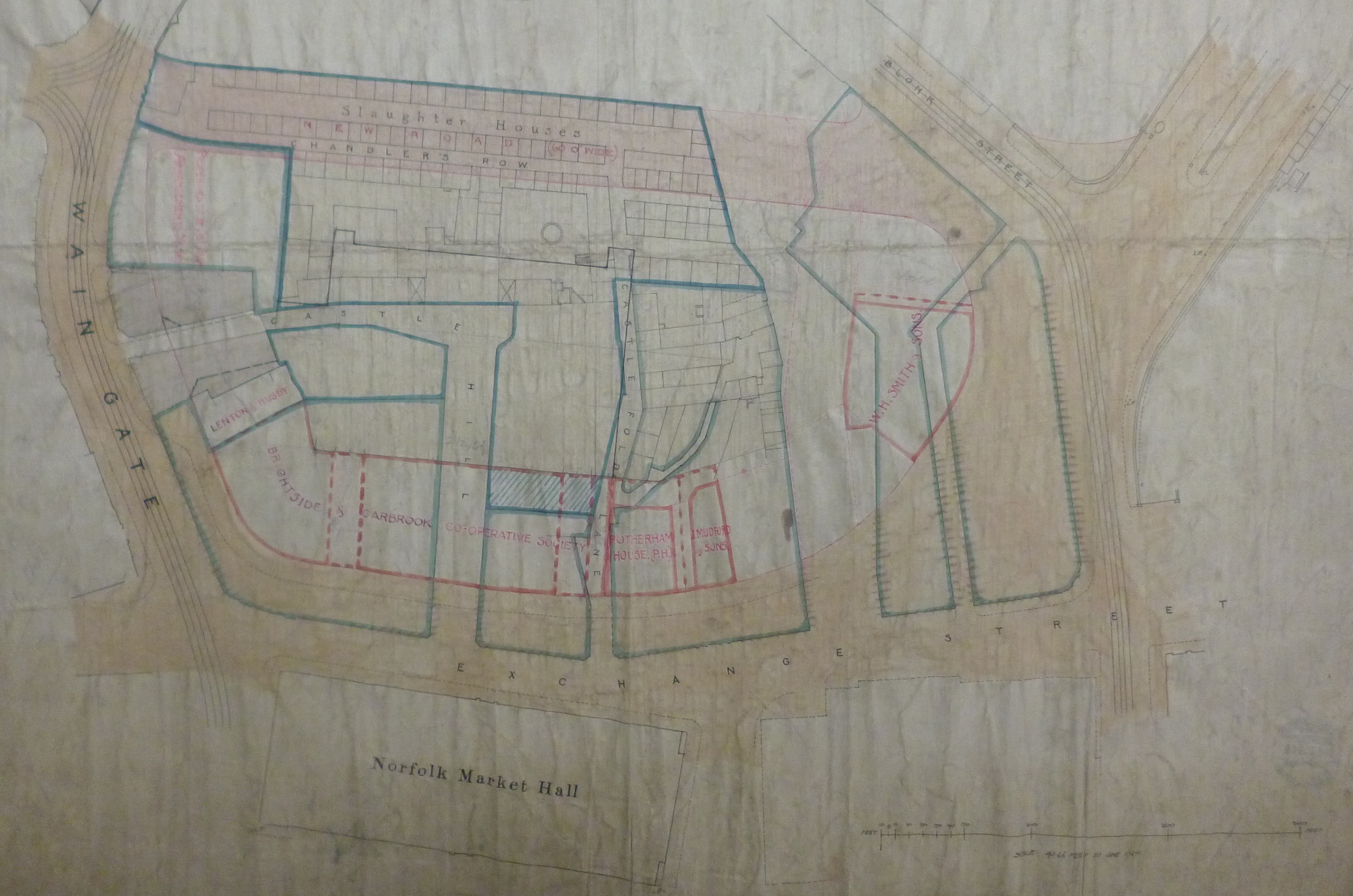
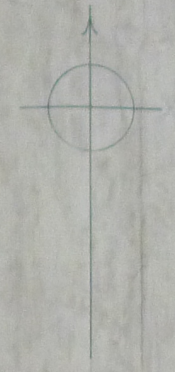

Source: MSA Drawer 9.

PROJECT		SHEFFIELD CASTLE STRATEGY	
TITLE		POST 1915 IMPROVEMENTS	
SCALE	AS SHOWN	DATE	MAY 2014
EDAS		FIGURE	16



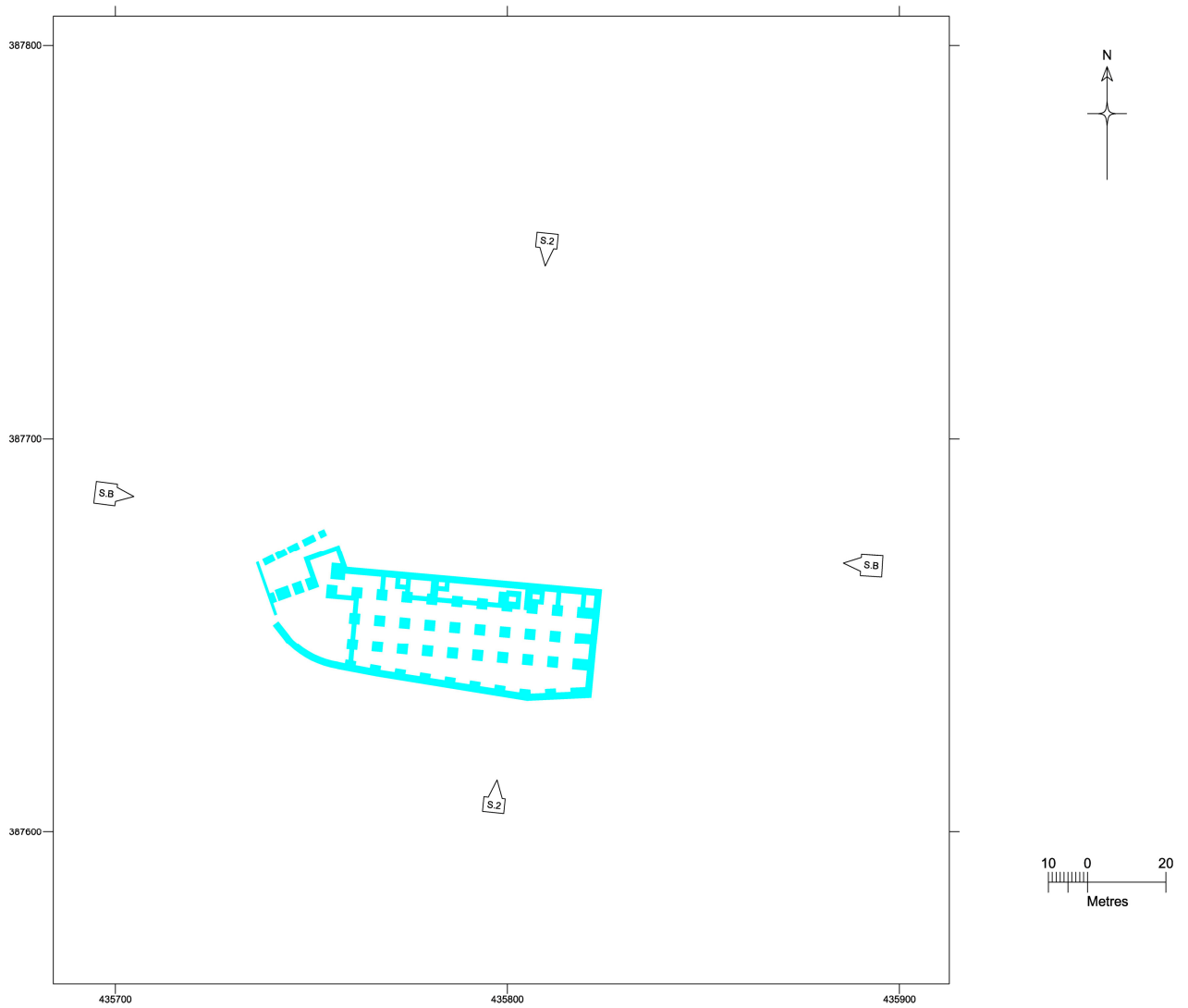

PROJECT		SHEFFIELD CASTLE STRATEGY	
TITLE		CO-OP FOUNDATION PLAN c.1927	
SCALE	AS SHOWN	DATE	MAY 2014
	EDAS	FIGURE	17A

Digitised foundations from c.1927 plan and Butcher's overlays.



PROJECT		SHEFFIELD CASTLE STRATEGY	
TITLE		CO-OP FOUNDATION PLAN c.1927	
SCALE	AS SHOWN	DATE	MAY 2014
	EDAS	FIGURE	17B

BRIGHTSIDE & CARBROOK CO-OPERATIVE SOCIETY LTD  
NEW CENTRAL PREMISES.

FOUNDATION PLAN.  
Scale 8 feet to an Inch.

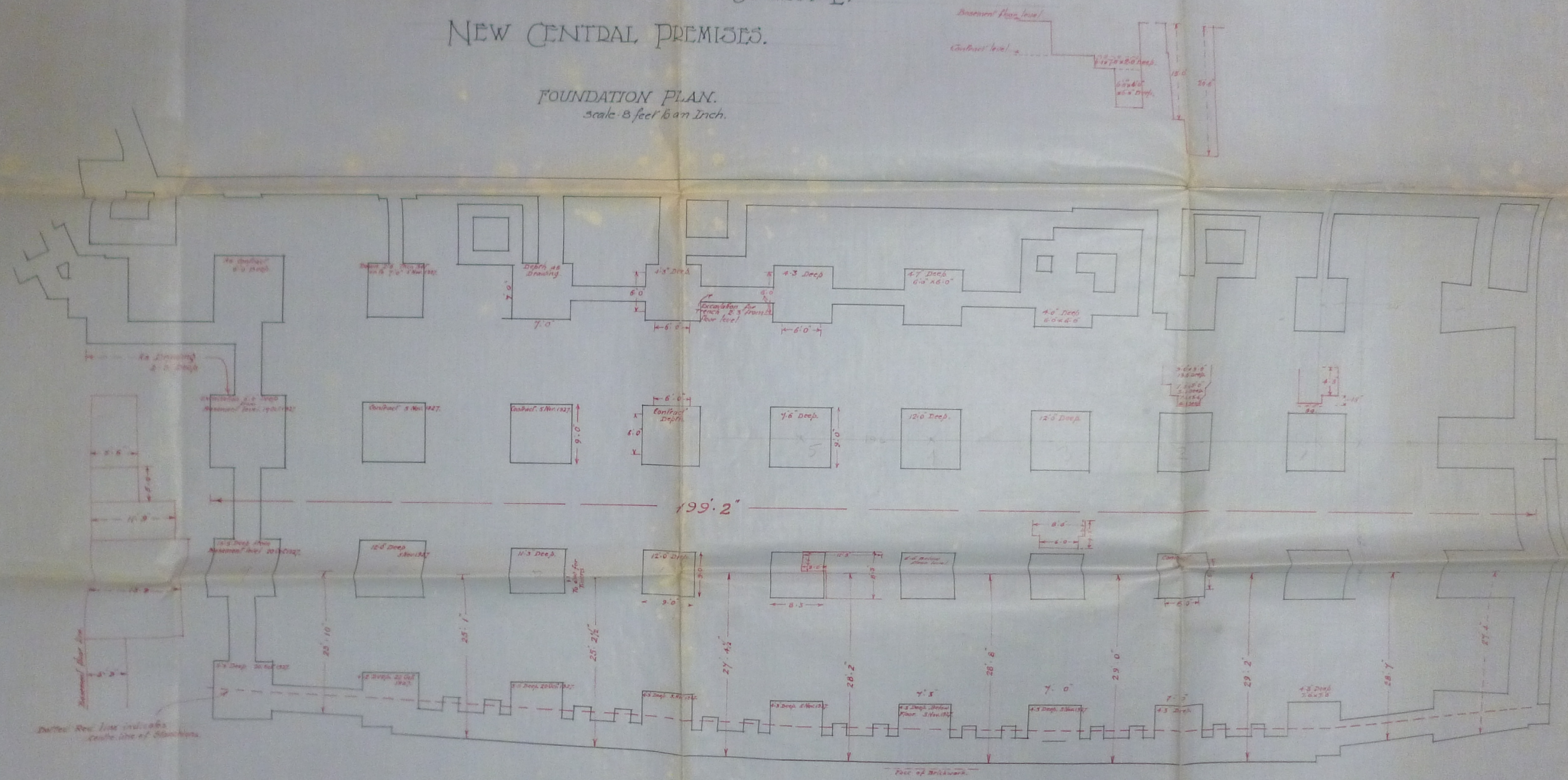



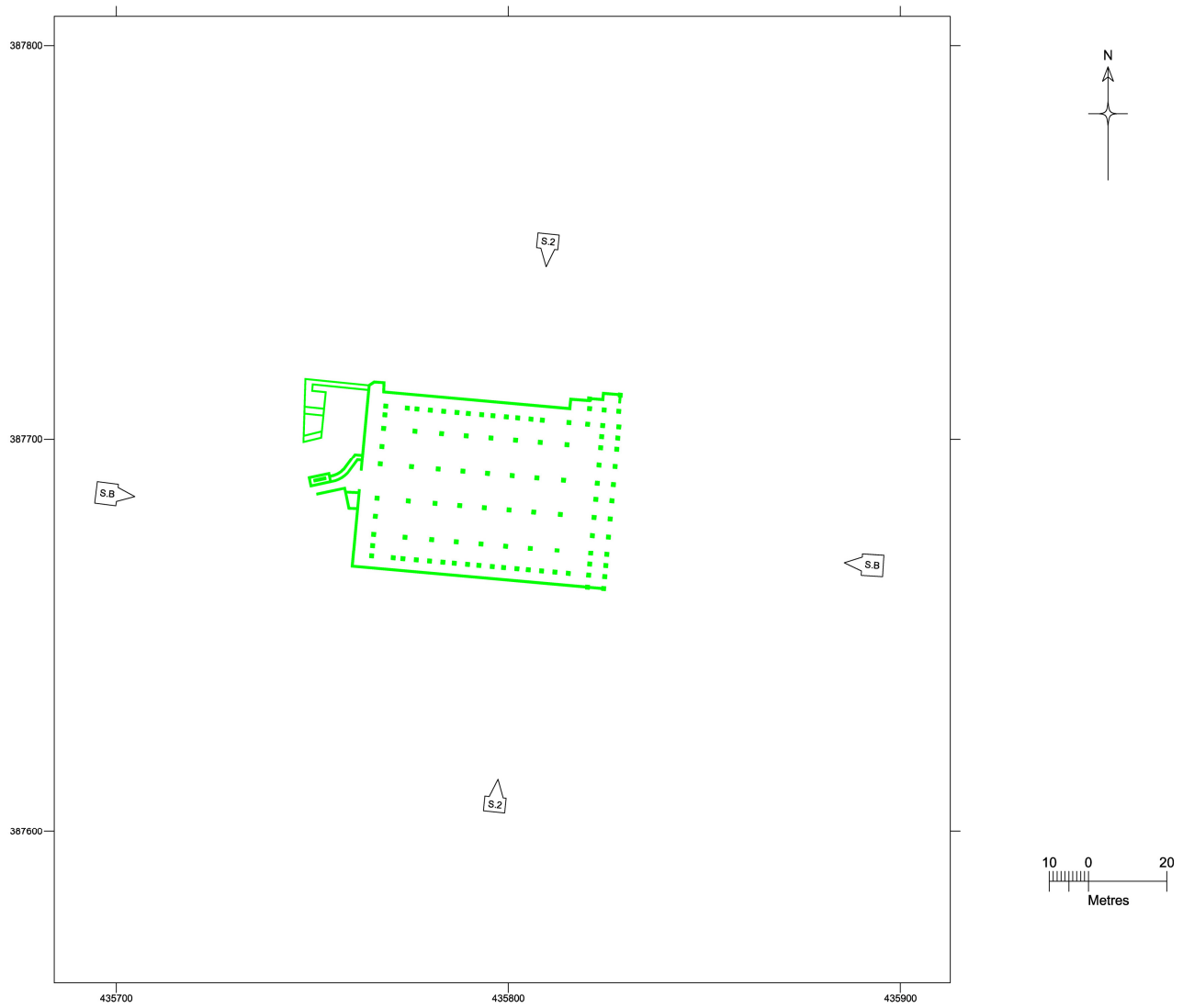

PROJECT SHEFFIELD CASTLE STRATEGY	
TITLE CASTLE HILL MARKET FOUNDATIONS	
SCALE AS SHOWN	DATE MAY 2014
EDAS	FIGURE 18A

Digitised foundations from c.1928 plan.

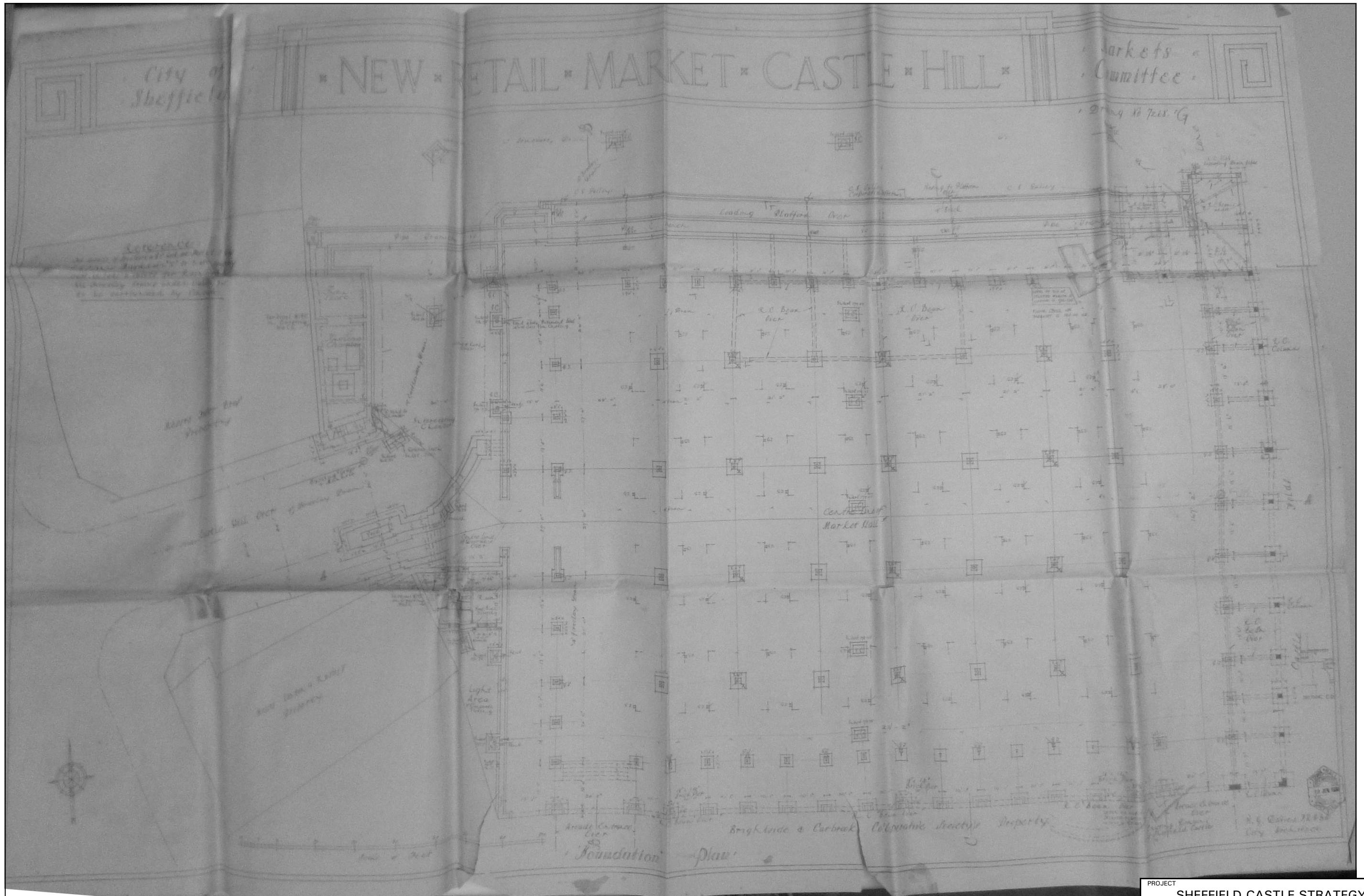

Source: MSA Box file - Drawings Plans Maps.

PROJECT		SHEFFIELD CASTLE STRATEGY	
TITLE		CASTLE HILL MARKET FOUNDATION PLAN c.1928	
SCALE	DATE	NTS	MAY 2014
FIGURE		EDAS 18B	



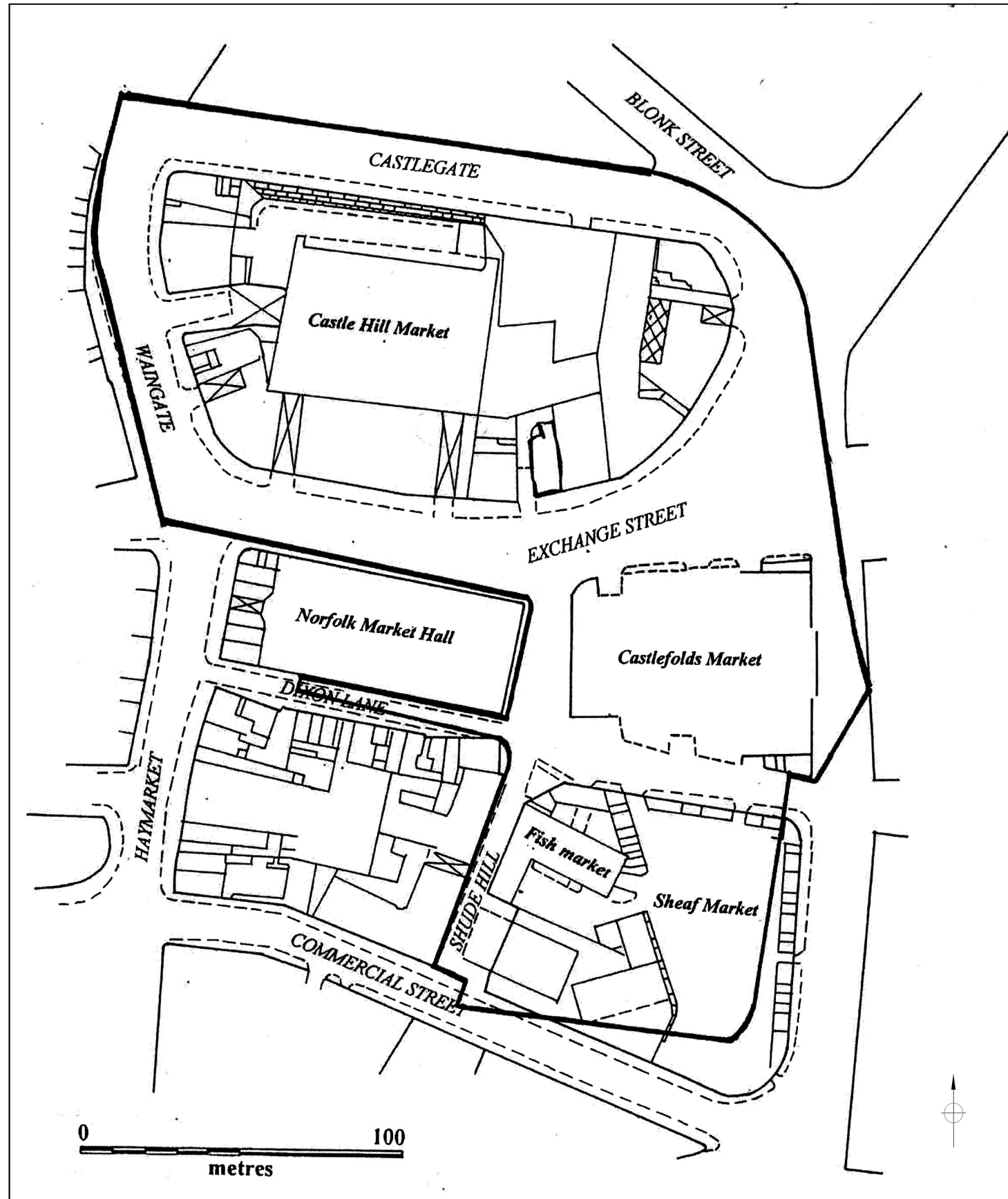

Redrawn detail from Ordnance Survey 1935 25" map.

Source: Belford, P 1998 *An Archaeological Desk-Based Assessment of the Sheffield Markets Site, Sheffield, South Yorkshire*, illustration 13 (unpublished ARCUS report 413).

Note: black line denotes Belford's 1998 study area.

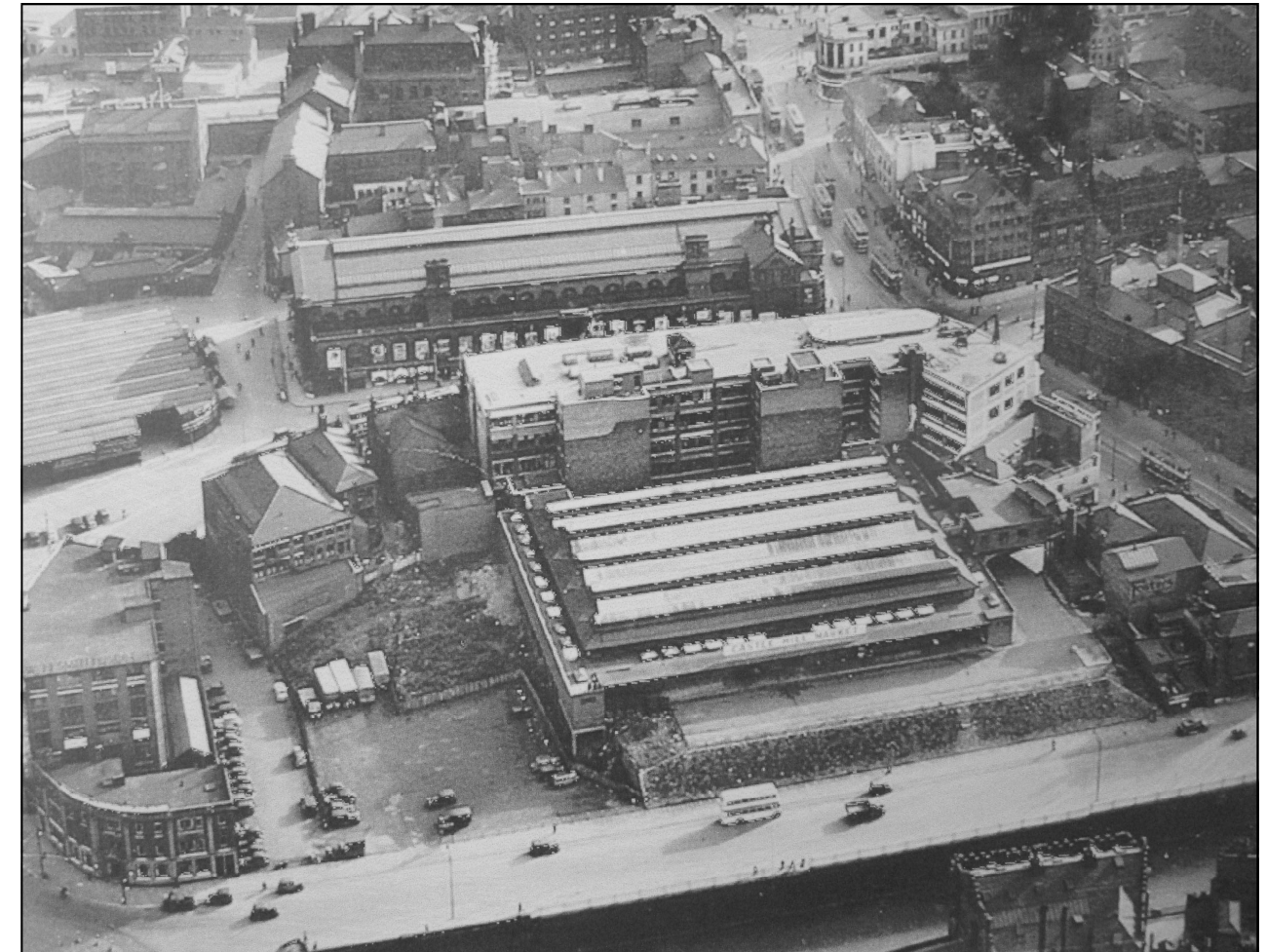

1930s aerial photograph, looking south (supplied by D Saich, SYAS).

PROJECT		SHEFFIELD CASTLE STRATEGY	
TITLE		CASTLE AREA IN 1930s	
SCALE	AS SHOWN	DATE	MAY 2014
EDAS		FIGURE	19

