

# Scotia Archaeology

REPORT  
TO  
CAMPBELL OF DOUNE  
AND  
AUCHINEDEN ESTATE

AUCHINEDEN  
HYDRO-ELECTRIC SCHEME  
BLANEFIELD, STIRLINGSHIRE

Walk-over survey  
January 2016

*Lismore  
Dollerie Terrace  
Crieff  
Perthshire  
Tel: 01764-652638  
email: [scotarc@btinternet.com](mailto:scotarc@btinternet.com)*

## INTRODUCTION

This report describes the results of a desk study of archaeological sites and monuments and a walk-over survey along the route of a proposed new hydro-electric scheme at Auchineden, near Blanefield, Stirlingshire. The survey was carried out by Scotia Archaeology at the request of Campbell of Doune, civil and structural engineers, and commissioned by Auchineden Estate.

A survey was undertaken in September 2014 when nothing of archaeological significance was identified although parts of the route were covered in bracken at that time, making it impossible to investigate large sections of it. Since that time, Stirling Council has granted planning consent for the construction of the new scheme subject to certain conditions. One of those conditions was to undertake a programme of archaeological works prior to the commencement of the development.

A Written Scheme of Investigation (WSI) was then produced, outlining measures to be taken to protect any structures, features or deposits of archaeological significance that might survive in those areas likely to be affected by the proposed development.

## THE SITE

The proposed hydro scheme will take water from the Auldmurroch Burn which runs off the east side of the Kilpatrick Hills, some 5km west of Blanefield and 5km north of Milngavie.

The intake will be at approximately NS 5040 7841, from where the penstock will run eastwards as far as the power house at NS 5150 7889, the outfall returning into the burn at NS 5151 7888. The overall length of the penstock will be approximately 1.4km.

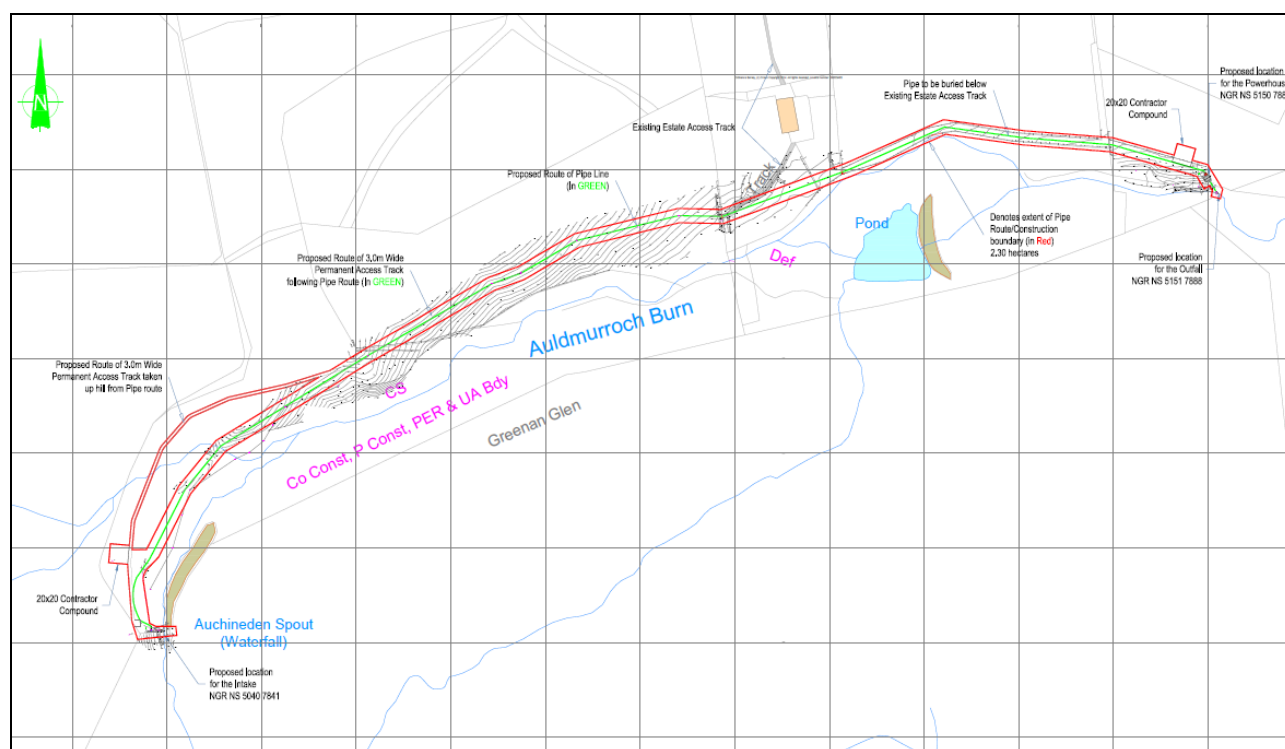

**Location of Auchineden hydro-electric scheme**

A location map, based on one supplied by Campbell of Doune and depicting the area of proposed development, is shown above.

### **THE DESK STUDY**

A desk study of readily available source material undertaken prior to the commencement of fieldwork revealed no known sites of archaeological or historical significance along or close to the route of the proposed pipeline.

### **THE WALK-OVER SURVEY**

Following the completion of the desk study a second walk-over survey was undertaken by John Lewis on 23 January 2016, a relatively mild, cloudy but dry day. At that time the area was clear of snow which had fallen the previous week and the bracken had died back.

The survey encompassed the area between the burn and a notional line some 100m north of the proposed route of the penstock. It also included the proposed course of a new access road from the contractor's compound near the west end of the penstock to a point some 300m along it.

From the intake, close to a waterfall known as Auchineden Spout, the route passes across ground sloping gently downwards to the east, through a small deciduous wood and coarse vegetation including grass, reeds and bracken. The course of the new access road will cut through part of a new forestry plantation.

No structures or features of archaeological or historical significance were encountered on any part of the survey route.

### **CONCLUSIONS**

The survey revealed nothing of archaeological interest along or close to any element of the proposed hydro scheme at Auchineden.