

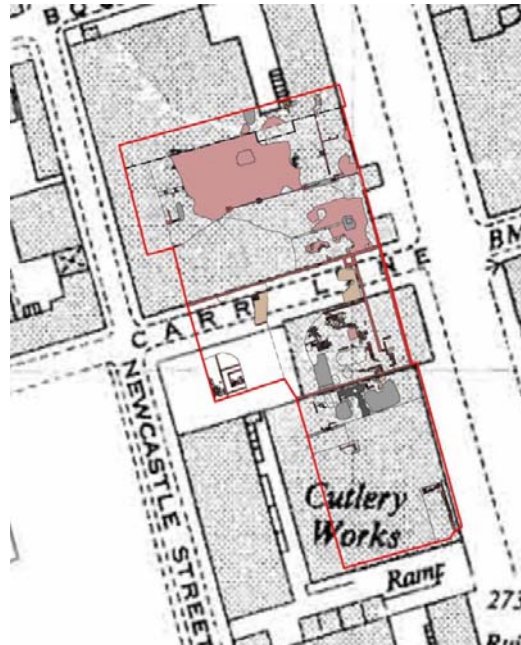

Archaeological Research & Consultancy at the University of Sheffield
Unit R6, Riverside Block
Sheaf Bank Business Park, Prospect Road
Sheffield, S2 3EN
Phone 0114 2225106 Fax 0114 2797158

Project Report 1142.1(1)

An Archaeological Watching Brief on land adjacent to Rockingham Street, Sheffield, South Yorkshire



December 2008

By Adam Tinsley & Matthew Copley

Prepared for:
Watkin Jones Construction Ltd,
Unit 2, Wellfield Business Park,
Preston Brook, Runcorn,
Cheshire,
WA73FR