



Archaeological Research & Consultancy at the University of Sheffield  
Unit R6, Riverside Block  
Sheaf Bank Business Park, Prospect Road  
Sheffield, S2 3EN  
Phone 0114 2225106 Fax 0114 2797158

Project Report 1142.1(2)

---

## An Archaeological Watching Brief on land adjacent to Rockingham Street, Sheffield, South Yorkshire

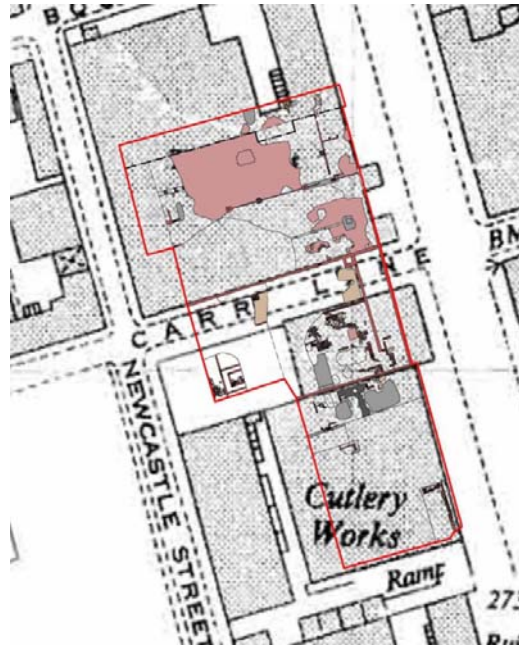

December 2008

---

By A Tinsley & M Copley

With contributions from Linzi Harvey, Dr Chris Cumberpatch, Ellen Simmons, Dr Rod MacKenzie and Ken Hawley

Prepared for:  
**Watkin Jones Construction,**  
**Unit 2, Wellfield Business Park,**  
**Preston Brook, Runcorn,**  
**Cheshire,**  
**WA73FR**