



# YORK ARCHAEOLOGICAL TRUST REPORT

<b>SITE</b>	7 Cumberland Street WB		
<b>CLIENT NAME</b>	Gary Rollinson of Streamline Taxis by York Archaeological Trust		
<b>YAT PROJECT #</b>	5985	<b>YAT REPORT #</b>	2017/63
<b>MUSEUM ACCESSION #</b>	N/A	<b>GRID REFERENCE</b>	SE 60308 51567
<b>PLANNING REFERENCE #</b>	16/01217/FUL	<b>AAI OPS NOTICE #</b>	N/A

## Introduction

Between the 16<sup>th</sup> and 19<sup>th</sup> June 2017 a watching brief took place to record deposits revealed during the excavation of a foundation trench at 7 Cumberland Street, York (Figure 1). The foundations were for a single storey rear extension to the rear of the building, within the area formerly used as a yard.



Figure 1 Site Location Contains Ordnance Survey data © Crown copyright and database right 2010

<b>COMPLETED BY</b>	Toby Kendall	<b>CHECKED BY</b>	Ian Milsted	<b>FINISHED</b>	19/06/17
<b>FINDS</b>	N/A	<b>SAMPLES</b>	N/A	<b>PHOTOS</b>	15 Digital
				<b>PAGE</b>	1 of 6

Registered Charity in England & Wales (509060) & Scotland (SCO42846)



Registered Office:  
47 Aldwark, York YO1 7BX  
Tel: 01904 663000 Fax: 01904 663024



A Company Limited by Guarantee  
Without Share Capital Registered  
in England No. 1430801



## YORK ARCHAEOLOGICAL TRUST REPORT

<b>SITE</b>	7 Cumberland Street WB		
<b>CLIENT NAME</b>	Gary Rollinson of Streamline Taxis by York Archaeological Trust		
<b>YAT PROJECT #</b>	5985	<b>YAT REPORT #</b>	2017/63
<b>MUSEUM ACCESSION #</b>	N/A	<b>GRID REFERENCE</b>	SE 60308 51567
<b>PLANNING REFERENCE #</b>	16/01217/FUL	<b>AAI OPS NOTICE #</b>	N/A

### Methodology

Work was started without arranging archaeological monitoring. A methodology was created to retrieve as much information as possible, including the provision for further excavation, if required. Once an initial site visit was undertaken it was clear that the open foundation trenches offered enough of a view to record a chronology for the site, as well as indicating that no archaeologically significant deposits had been disturbed.

See Figure 2 for works location.

Two separate sections were archaeologically cleaned and the deposits encountered were recorded in a notebook alongside sketch plans and representative sections where appropriate. Digital photographs were taken at intervals during the watching brief.

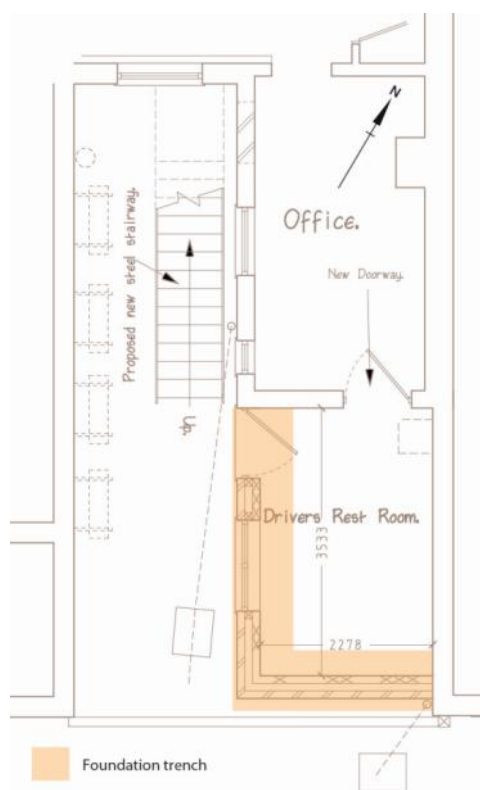

Figure 2 Works Location 1:100 (after drawing 16/01217/FUL 16-1141-2)

Finds such as pottery and ceramic building material were not retained as they were all clearly 18<sup>th</sup> century or later and related to the later post-medieval and modern activity across the site.

<b>COMPLETED BY</b>	Toby Kendall	<b>CHECKED BY</b>	Ian Milsted	<b>FINISHED</b>	19/06/17
<b>FINDS</b>	N/A	<b>SAMPLES</b>	N/A	<b>PHOTOS</b>	15 Digital
				<b>PAGE</b>	<b>2 of 6</b>

Registered Charity in England & Wales (509060) & Scotland (SCO42846)



Registered Office:  
47 Aldwark, York YO1 7BX  
Tel: 01904 663000 Fax: 01904 663024



A Company Limited by Guarantee  
Without Share Capital Registered  
in England No. 1430801



## YORK ARCHAEOLOGICAL TRUST REPORT

<b>SITE</b>	7 Cumberland Street WB		
<b>CLIENT NAME</b>	Gary Rollinson of Streamline Taxis by York Archaeological Trust		
<b>YAT PROJECT #</b>	5985	<b>YAT REPORT #</b>	2017/63
<b>MUSEUM ACCESSION #</b>	N/A	<b>GRID REFERENCE</b>	SE 60308 51567
<b>PLANNING REFERENCE #</b>	16/01217/FUL	<b>AAI OPS NOTICE #</b>	N/A

### Results

The location of images and other elements can be seen in Figure 3.

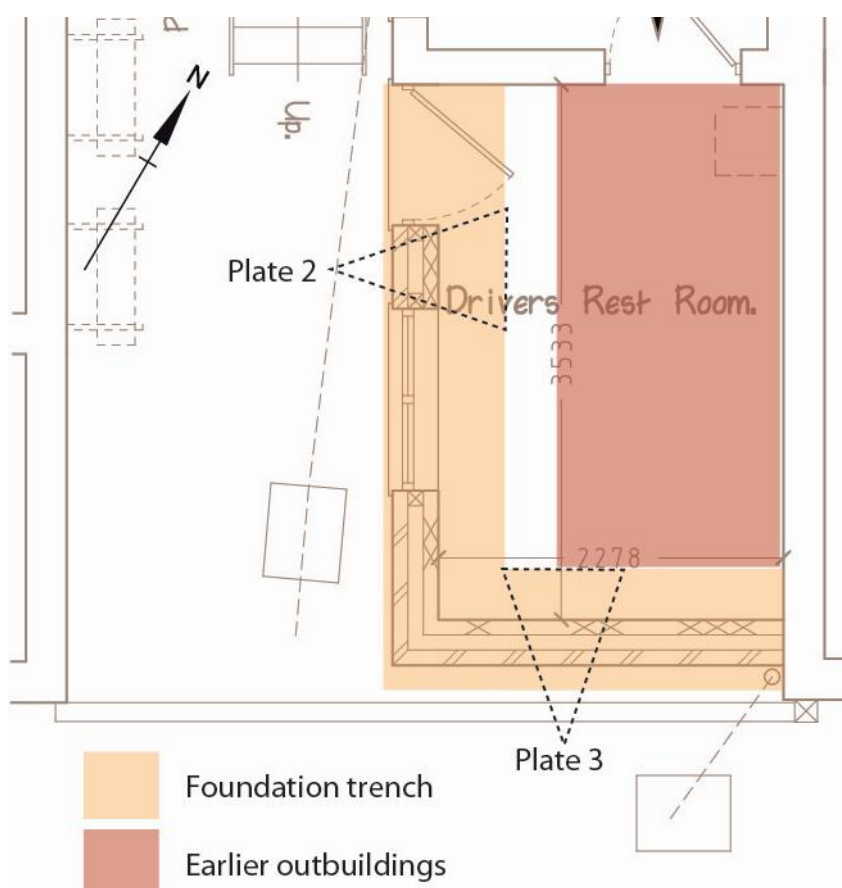

Figure 3 Results Location 1:50 (after drawing 16/01217/FUL 16-1141-2)

The foundation trench was approximately 800mm wide and 900mm deep (Plate 1). For the remainder of the development area ground reduction was only c.200mm, and therefore only penetrated into modern makeup deposits for the former yard.

As can be seen in Plate 1 there were also significant truncations from a rainwater and soil pipe entering an inspection chamber to the south-west of the trench.

The earliest deposit encountered was seen along the south-west foundation cut, between 900 and 500mm BGL. This was firm clay with mortar and rubble, becoming more frequent towards the top (Plates 2 & 3). This was interpreted as being ground formation linked to the construction of the original buildings in this area.

<b>COMPLETED BY</b>	Toby Kendall	<b>CHECKED BY</b>	Ian Milsted	<b>FINISHED</b>	19/06/17
<b>FINDS</b>	N/A	<b>SAMPLES</b>	N/A	<b>PHOTOS</b>	15 Digital
				<b>PAGE</b>	<b>3 of 6</b>

Registered Charity in England & Wales (509060) & Scotland (SCO42846)



Registered Office:  
47 Aldwark, York YO1 7BX  
Tel: 01904 663000 Fax: 01904 663024



A Company Limited by Guarantee  
Without Share Capital Registered  
in England No. 1430801



# YORK ARCHAEOLOGICAL TRUST REPORT

<b>SITE</b>	7 Cumberland Street WB		
<b>CLIENT NAME</b>	Gary Rollinson of Streamline Taxis by York Archaeological Trust		
<b>YAT PROJECT #</b>	5985	<b>YAT REPORT #</b>	2017/63
<b>MUSEUM ACCESSION #</b>	N/A	<b>GRID REFERENCE</b>	SE 60308 51567
<b>PLANNING REFERENCE #</b>	16/01217/FUL	<b>AAI OPS NOTICE #</b>	N/A



Plate 1 Foundations, facing north



Plate 2 South-west side of foundation trench, facing northeast, scale unit 100mm

<b>COMPLETED BY</b>	Toby Kendall	<b>CHECKED BY</b>	Ian Milsted	<b>FINISHED</b>	19/06/17
<b>FINDS</b>	N/A	<b>SAMPLES</b>	N/A	<b>PHOTOS</b>	15 Digital
				<b>PAGE</b>	<b>4 of 6</b>

Registered Charity in England & Wales (509060) & Scotland (SCO42846)



Registered Office:  
47 Aldwark, York YO1 7BX  
Tel: 01904 663000 Fax: 01904 663024



A Company Limited by Guarantee  
Without Share Capital Registered  
in England No. 1430801



## YORK ARCHAEOLOGICAL TRUST REPORT

<b>SITE</b>	7 Cumberland Street WB		
<b>CLIENT NAME</b>	Gary Rollinson of Streamline Taxis by York Archaeological Trust		
<b>YAT PROJECT #</b>	5985	<b>YAT REPORT #</b>	2017/63
<b>MUSEUM ACCESSION #</b>	N/A	<b>GRID REFERENCE</b>	SE 60308 51567
<b>PLANNING REFERENCE #</b>	16/01217/FUL	<b>AAI OPS NOTICE #</b>	N/A

At potentially the same time this was deposited, or at least very soon afterwards, a wall footing was built. This is visible in Plate 3 and appeared to run to the north-west, on the same alignment as the current buildings. To the north-east of this footing was rubble infilling, which may have acted as the makeup for flooring within any structure. The first edition Ordnance Survey mapping of 1852 indicates outhouses or similar in this location, which would correlate with the size of bricks used in this structure.



**Plate 3 South-east side of foundation trench, facing northwest, scale unit 100mm**

The next deposits are a rubble layer and black cinder floor up to 350mm BGL. Any previous structures were clearly demolished before this floor was created, with perhaps the rubble forming part of its base.

On the same alignment, and in a very similar position, as the earlier wall described above, another wall was then created. This can be clearly seen in Plate 3. Again this will have related to outhouse structure in the yard and a scar from the roofing can still be seen on the extant wall to the north-west.

Finally the later structures were demolished and the latest yard surfaces created.

The external stair element of the development was not observed as it was to be placed on top of a series of modern services. It was also clear from the results of the foundation trench that significant archaeological deposits would not be encountered.

<b>COMPLETED BY</b>	Toby Kendall	<b>CHECKED BY</b>	Ian Milsted	<b>FINISHED</b>	19/06/17
<b>FINDS</b>	N/A	<b>SAMPLES</b>	N/A	<b>PAGE</b>	<b>5 of 6</b>

Registered Charity in England & Wales (509060) & Scotland (SCO42846)



Registered Office:  
47 Aldwark, York YO1 7BX  
Tel: 01904 663000 Fax: 01904 663024



A Company Limited by Guarantee  
Without Share Capital Registered  
in England No. 1430801



## YORK ARCHAEOLOGICAL TRUST REPORT

<b>SITE</b>	7 Cumberland Street WB		
<b>CLIENT NAME</b>	Gary Rollinson of Streamline Taxis by York Archaeological Trust		
<b>YAT PROJECT #</b>	5985	<b>YAT REPORT #</b>	2017/63
<b>MUSEUM ACCESSION #</b>	N/A	<b>GRID REFERENCE</b>	SE 60308 51567
<b>PLANNING REFERENCE #</b>	16/01217/FUL	<b>AAI OPS NOTICE #</b>	N/A

### Discussion & Conclusions

At the rear of 7 Cumberland Street there is a clear deposit history for the site spanning the later post-medieval and modern periods.

Some structural remains for the buildings visible on the first edition Ordnance Survey mapping had survived later truncation. The more recent, standing, building of 7 Cumberland Street had an open cinder yard surface to the rear. Later an outbuilding had been constructed upon this, in an almost identical position to the earlier phase. Finally these were demolished before the latest yard was created.

No significant archaeology was encountered during these works. However, the good preservation of earlier buildings within 500mm of the current ground level indicates there is potential for good preservation lower down.

Many thanks to Gary Rollinson and the building team for taking appropriate action once the oversight regarding the archaeological condition was noticed. This allowed realistic amounts of time on site for observations and little disruption to the works as they progressed.

*This Report has been prepared solely for the person/party which commissioned it and for the specifically titled project or named part thereof referred to in the Report. The Report should not be relied upon or used for any other project by the commissioning person/party without first obtaining independent verification as to its suitability for such other project, and obtaining the prior written approval of York Archaeological Trust for Excavation & Research Limited ("YAT"). YAT accepts no responsibility or liability for the consequences of this Report being relied upon or used for any purpose other than the purpose for which it was specifically commissioned. Nobody is entitled to rely upon this Report other than the person/party which commissioned it. YAT accepts no responsibility or liability for any use of or reliance upon this Report by anybody other than the commissioning person/party.*

<b>COMPLETED BY</b>	Toby Kendall	<b>CHECKED BY</b>	Ian Milsted	<b>FINISHED</b>	19/06/17
<b>FINDS</b>	N/A	<b>SAMPLES</b>	N/A	<b>PHOTOS</b>	15 Digital
				<b>PAGE</b>	<b>6 of 6</b>

Registered Charity in England & Wales (509060) & Scotland (SCO42846)



Registered Office:  
47 Aldwark, York YO1 7BX  
Tel: 01904 663000 Fax: 01904 663024



A Company Limited by Guarantee  
Without Share Capital Registered  
in England No. 1430801