



YORK ARCHAEOLOGICAL TRUST

SITE	Palmer Lane, Hungate Development, York, YO1 7NZ		
CLIENT NAME	Hungate (York) Regeneration Ltd		
YAT PROJECT #	6128	YAT REPORT #	2019/56
MUSEUM ACCESSION #	N/A	GRID REFERENCE	SE 60741 51822
PLANNING REFERENCE #	17/03032/REMM	AAI OPS NOTICE #	N/A

INTRODUCTION

A watching brief on ground works for the installation of an attenuation sewer was carried out by York Archaeological Trust on behalf of Hungate Regeneration Ltd between 22nd March and 5th April 2019 at Palmer Lane, Hungate Development, York, YO1 7NZ NGR SE 60741 51822 (Figure 1). The objective of the watching brief was to record any archaeological deposits or structures exposed by the ground works.

METHODOLOGY

The works consisted of the excavation of three test pits, to locate existing services, and the excavation of a trench for a new attenuation drain (Figure 2). The test pits measured approximately 1.0m wide and to a maximum of 1.0m in depth, depending on the location of the existing services. The attenuation drain trench was excavated along the southern side of Palmer Lane (Figure 2), and measured approximately 3.0m in width by 2.0m in depth.

The test pits were excavated by a mini excavator equipped with a 0.8m wide bucket. The attenuation drain trench was excavated by a 21 tonne 360 excavator equipped with a 1.8m wide bucket.

Due to safety considerations trenches were inspected from the top. Recording was undertaken in the form of digital photographs, notes and sketch sections as per the WSI.

RESULTS

Within the test pits, modern make-up deposits and disturbance relating to previous services were encountered (Plate 4-6). The earliest deposit encountered was a horticultural soil at 0.4m BGL. The area to the west, along the front of the student accommodation block was too shallow to reach beyond modern made ground deposits.

Within the attenuation drain trench the earliest deposit encountered was light, brownish grey, sandy silt deposit (Plate 2). This was located at a depth of approximately 2.0m BGL at the base and towards the western end of the trench. This probably represents a leveling deposit.

Above the leveling deposit was a probable agricultural soil (Plate 1 and Plate 2 underneath concrete drain). This consisted of a friable, dark brown grey, sandy silt. The deposit contained inclusions of CBM fragments, charcoal and oyster shells as well as occasional animal bone. The top of this deposit was found at a depth of approximately 1.7m BGL, and was approximately 0.30m in thickness.

At the eastern side of the trench a brick structure was seen in the south facing section (Plate 1). This is possibly the remains of a structures along Palmer Lane depicted on the 1852 OS map.

The material above these deposits had been extensively disturbed by a variety of previous and current services, and consisted of modern made ground.

CONCLUSIONS

No significant archaeological deposits or structures were encountered during the course of the

COMPLETED BY	G Loffman	CHECKED BY	M. Slater	FINISHED	27/06/19
FINDS	0	SAMPLES	0	PHOTOS	60
				PAGE	1 of 9

Registered Charity in England & Wales (509060) & Scotland (SCO42846)



Registered Office:
47 Aldwark, York YO1 7BX
Tel: 01904 663000 Fax: 01904 663024



A Company Limited by Guarantee
Without Share Capital Registered
in England No. 1430801



YORK ARCHAEOLOGICAL TRUST

SITE	Palmer Lane, Hungate Development, York, YO1 7NZ		
CLIENT NAME	Hungate (York) Regeneration Ltd		
YAT PROJECT #	6128	YAT REPORT #	2019/56
MUSEUM ACCESSION #	N/A	GRID REFERENCE	SE 60741 51822
PLANNING REFERENCE #	17/03032/REMM	AAI OPS NOTICE #	N/A

watching brief.



Plate 1 Brick structure and horticultural soil, looking north-west.

COMPLETED BY	G Loffman	CHECKED BY	M. Slater	FINISHED	27/06/19
FINDS	0	SAMPLES	0	PHOTOS	60
				PAGE	2 of 9

Registered Charity in England & Wales (509060) & Scotland (SCO42846)



Registered Office:
47 Aldwark, York YO1 7BX
Tel: 01904 663000 Fax: 01904 663024



A Company Limited by Guarantee
Without Share Capital Registered
in England No. 1430801



YORK ARCHAEOLOGICAL TRUST

SITE	Palmer Lane, Hungate Development, York, YO1 7NZ		
CLIENT NAME	Hungate (York) Regeneration Ltd		
YAT PROJECT #	6128	YAT REPORT #	2019/56
MUSEUM ACCESSION #	N/A	GRID REFERENCE	SE 60741 51822
PLANNING REFERENCE #	17/03032/REMM	AAI OPS NOTICE #	N/A



Plate 2 South facing section of attenuation drain trench



Plate 3 Working shot looking west.

COMPLETED BY	G Loffman	CHECKED BY	M. Slater	FINISHED	27/06/19
FINDS	0	SAMPLES	0	PHOTOS	60
				PAGE	3 of 9

Registered Charity in England & Wales (509060) & Scotland (SCO42846)



Registered Office:
47 Aldwark, York YO1 7BX
Tel: 01904 663000 Fax: 01904 663024



A Company Limited by Guarantee
Without Share Capital Registered
in England No. 1430801



YORK ARCHAEOLOGICAL TRUST

SITE	Palmer Lane, Hungate Development, York, YO1 7NZ		
CLIENT NAME	Hungate (York) Regeneration Ltd		
YAT PROJECT #	6128	YAT REPORT #	2019/56
MUSEUM ACCESSION #	N/A	GRID REFERENCE	SE 60741 51822
PLANNING REFERENCE #	17/03032/REMM	AAI OPS NOTICE #	N/A



Plate 4 Trial pit 1 looking south-east. Scale unit 0.5m.

COMPLETED BY	G Loffman	CHECKED BY	M. Slater	FINISHED	27/06/19
FINDS	0	SAMPLES	0	PHOTOS	60
				PAGE	4 of 9

Registered Charity in England & Wales (509060) & Scotland (SCO42846)



Registered Office:
47 Aldwark, York YO1 7BX
Tel: 01904 663000 Fax: 01904 663024



A Company Limited by Guarantee
Without Share Capital Registered
in England No. 1430801



YORK ARCHAEOLOGICAL TRUST

SITE	Palmer Lane, Hungate Development, York, YO1 7NZ		
CLIENT NAME	Hungate (York) Regeneration Ltd		
YAT PROJECT #	6128	YAT REPORT #	2019/56
MUSEUM ACCESSION #	N/A	GRID REFERENCE	SE 60741 51822
PLANNING REFERENCE #	17/03032/REMM	AAI OPS NOTICE #	N/A



Plate 5 Trial pit 2 looking south east.

COMPLETED BY	G Loffman	CHECKED BY	M. Slater	FINISHED	27/06/19
FINDS	0	SAMPLES	0	PHOTOS	60
				PAGE	5 of 9

Registered Charity in England & Wales (509060) & Scotland (SCO42846)



Registered Office:
47 Aldwark, York YO1 7BX
Tel: 01904 663000 Fax: 01904 663024



A Company Limited by Guarantee
Without Share Capital Registered
in England No. 1430801



YORK ARCHAEOLOGICAL TRUST

SITE	Palmer Lane, Hungate Development, York, YO1 7NZ		
CLIENT NAME	Hungate (York) Regeneration Ltd		
YAT PROJECT #	6128	YAT REPORT #	2019/56
MUSEUM ACCESSION #	N/A	GRID REFERENCE	SE 60741 51822
PLANNING REFERENCE #	17/03032/REMM	AAI OPS NOTICE #	N/A



Plate 6 Trial pit 3 looking south. Scale Unit 0.5m.

COMPLETED BY	G Loffman	CHECKED BY	M. Slater	FINISHED	27/06/19
FINDS	0	SAMPLES	0	PHOTOS	60
				PAGE	6 of 9

Registered Charity in England & Wales (509060) & Scotland (SCO42846)



Registered Office:
47 Aldwark, York YO1 7BX
Tel: 01904 663000 Fax: 01904 663024



A Company Limited by Guarantee
Without Share Capital Registered
in England No. 1430801

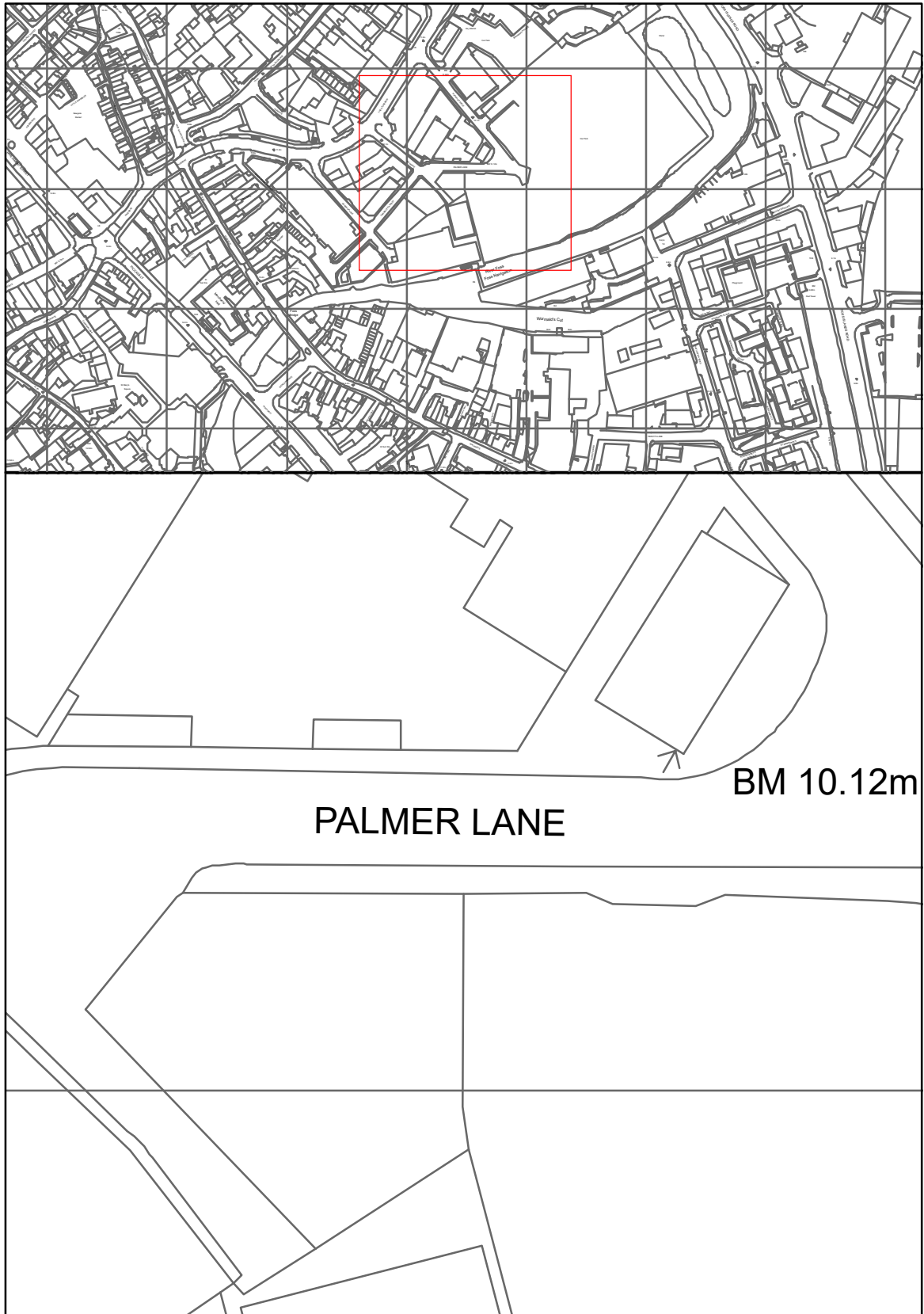
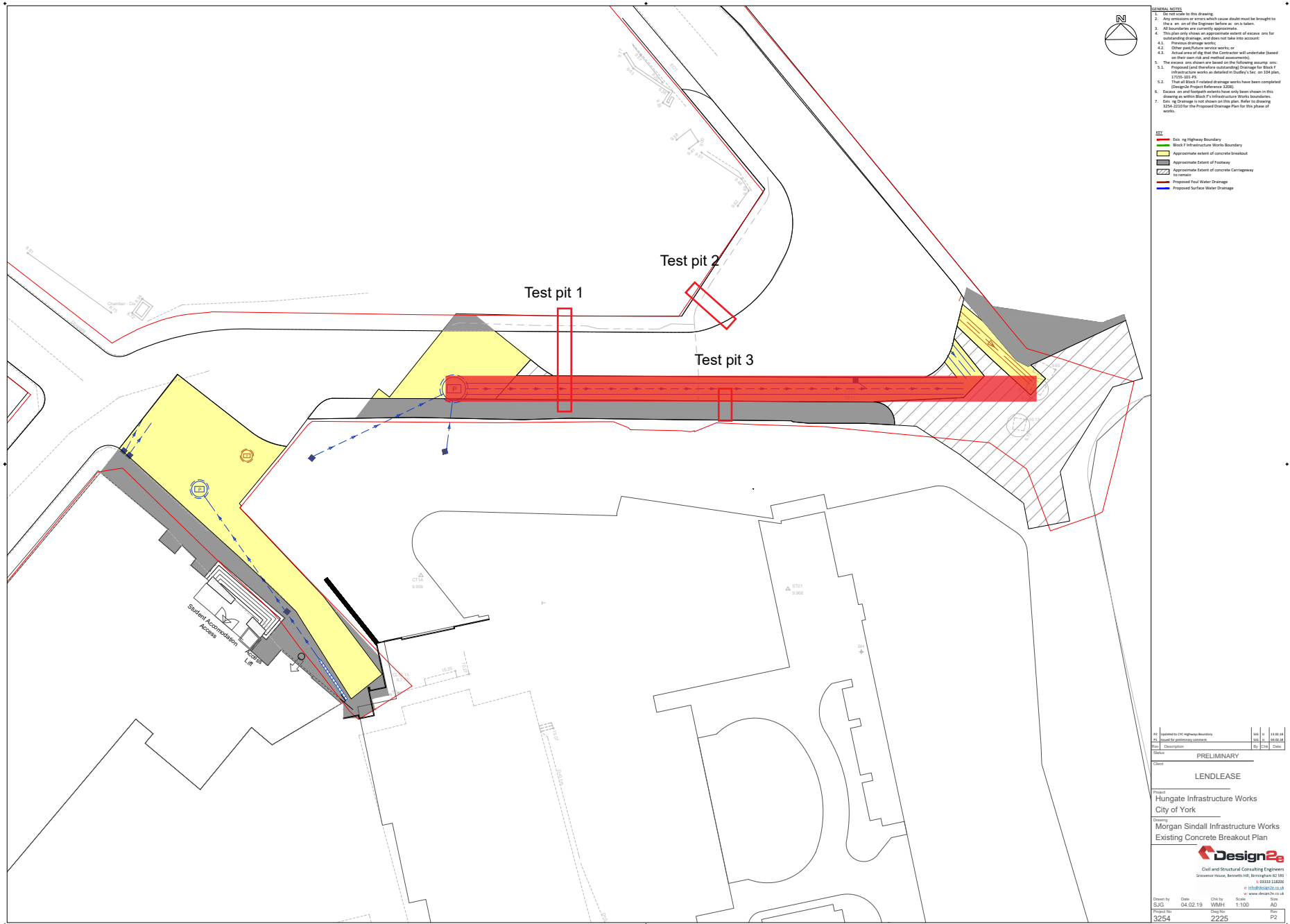

Fig. 1 Site location at 1:400 and 1:5000



Extent of attenuation drain trench

Fig. 2. Location of intrusive works (after drawing supplied by client)



YORK ARCHAEOLOGICAL TRUST

SITE	Palmer Lane, Hungate Development, York, YO1 7NZ		
CLIENT NAME	Hungate (York) Regeneration Ltd		
YAT PROJECT #	6128	YAT REPORT #	2019/56
MUSEUM ACCESSION #	N/A	GRID REFERENCE	SE 60741 51822
PLANNING REFERENCE #	17/03032/REMM	AAI OPS NOTICE #	N/A

This Report has been prepared solely for the person/party which commissioned it and for the specifically titled project or named part thereof referred to in the Report. The Report should not be relied upon or used for any other project by the commissioning person/party without first obtaining independent verification as to its suitability for such other project, and obtaining the prior written approval of York Archaeological Trust for Excavation & Research Limited ("YAT"). YAT accepts no responsibility or liability for the consequences of this Report being relied upon or used for any purpose other than the purpose for which it was specifically commissioned. Nobody is entitled to rely upon this Report other than the person/party which commissioned it. YAT accepts no responsibility or liability for any use of or reliance upon this Report by anybody other than the commissioning person/party.

COMPLETED BY	G Loffman	CHECKED BY	M. Slater	FINISHED	27/06/19		
FINDS	0	SAMPLES	0	PHOTOS	60	PAGE	9 of 9

Registered Charity in England & Wales (509060) & Scotland (SCO42846)



Registered Office:
47 Aldwark, York YO1 7BX
Tel: 01904 663000 Fax: 01904 663024



A Company Limited by Guarantee
Without Share Capital Registered
in England No. 1430801