



YORK ARCHAEOLOGICAL TRUST REPORT

SITE ADDRESS	6 Portland Street, York		
CLIENT NAME	Ann Holt		
YAT PROJECT #	5411	YAT REPORT #	2010/85
MUSEUM ACCESSION #	n/a	GRID REFERENCE	SE 6016 5245
PLANNING REFERENCE #	n/a	AAI OPS NOTICE #	10024

INTRODUCTION

On 14th July 2010 York Archaeological Trust undertook a watching brief at 6 Portland Street, York (Figure 1). The objective was to record any deposits, features or buried structures of archaeological interest encountered during remedial alterations in the basement. These alterations included modifications to part of the drainage system, the excavation of a sump for the installation of an automatic pump and the replacement of the lower part of the stairs leading down into the basement (Figure 2). Due to the restricted access to the basement all excavation work was by hand although machine tools were used to break up the concrete floor. Recording took the form of written notes and measured sketches together with a small number of colour digital photographs.

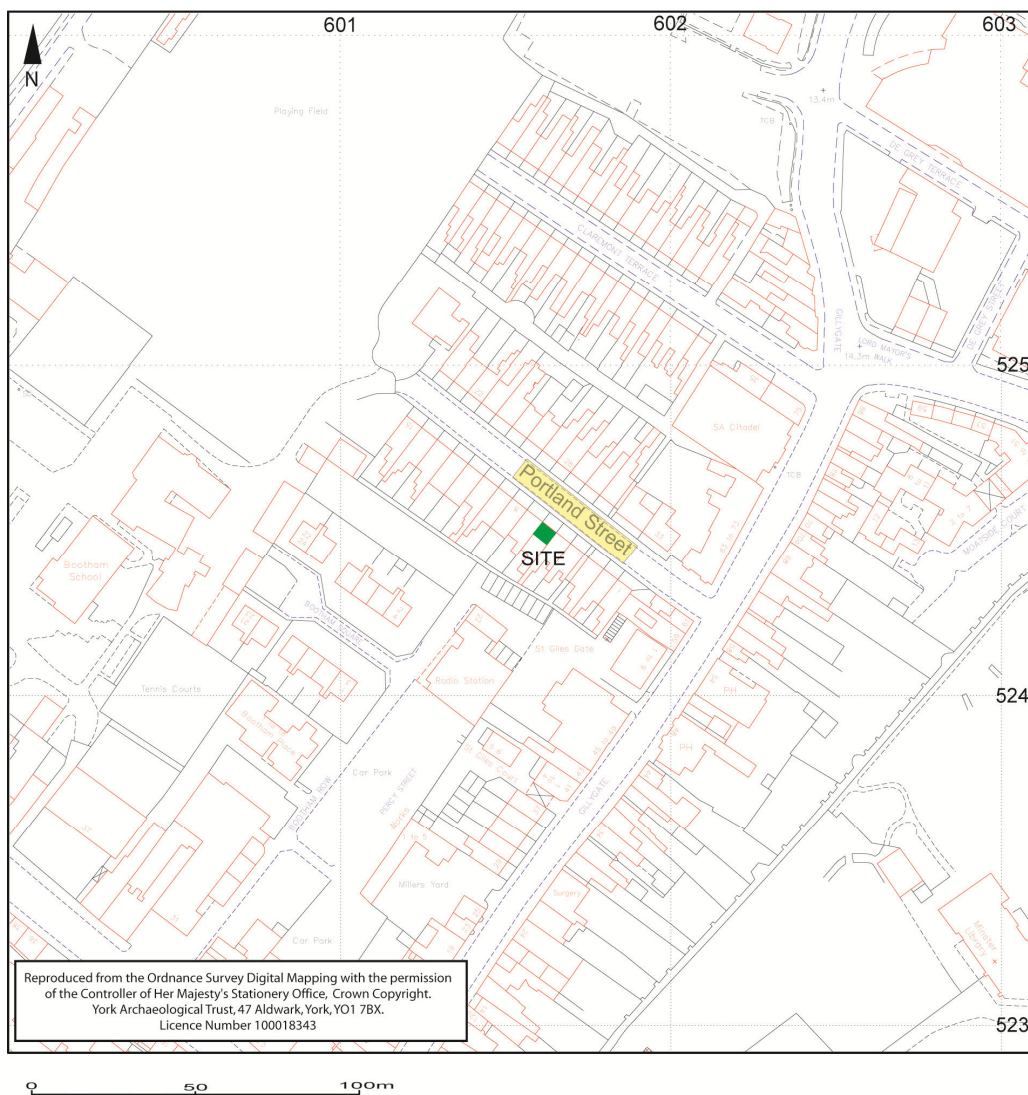

Figure 1 Location of Portland Street

COMPLETED BY	D.T. Evans	CHECKED BY	M.R. Stockwell	FINISHED	14/10/10
FINDS	No	SAMPLES	No	PHOTOS	Yes
				PAGE	1 of 5

York Archaeological Trust is a
Registered Charity
No. 509060



Registered Office:
47 Aldwark, York YO1 7BX
Tel: 01904 663000 Fax: 01904 663024



A Company Limited by Guarantee
Without Share Capital Registered
in England No. 1430801



YORK ARCHAEOLOGICAL TRUST REPORT

SITE ADDRESS	6 Portland Street, York		
CLIENT NAME	Ann Holt		
YAT PROJECT #	5411	YAT REPORT #	2010/85
MUSEUM ACCESSION #	n/a	GRID REFERENCE	SE 6016 5245
PLANNING REFERENCE #	n/a	AAI OPS NOTICE #	10024

RESULTS

The first recorded section was in a 1m x 0.8m hole dug against the south-west wall of the basement in order to expose the drains that required alteration. Between 0.1m below the basement floor and 0.5m below the floor there was a mixture of mid brown clay and mid brown silt containing moderate quantities of brick / tile (1000). This was sealed by the concrete floor (1001) of the basement.

The second section was in the northern corner of the basement where a trench measuring c.0.6m x 0.6m and 0.6m deep was dug to install the automatic pump. Here the earliest deposit seen, between 0.25m and 0.6m below the floor, was a firm, mid brown clay (1002). Overlying it was a 0.05m deep layer of soft, very pale brown mortar (1003) which formed the bedding for a horizontal surface of hollow land drain tiles (1004). This surface was sealed by the existing concrete floor (1005).

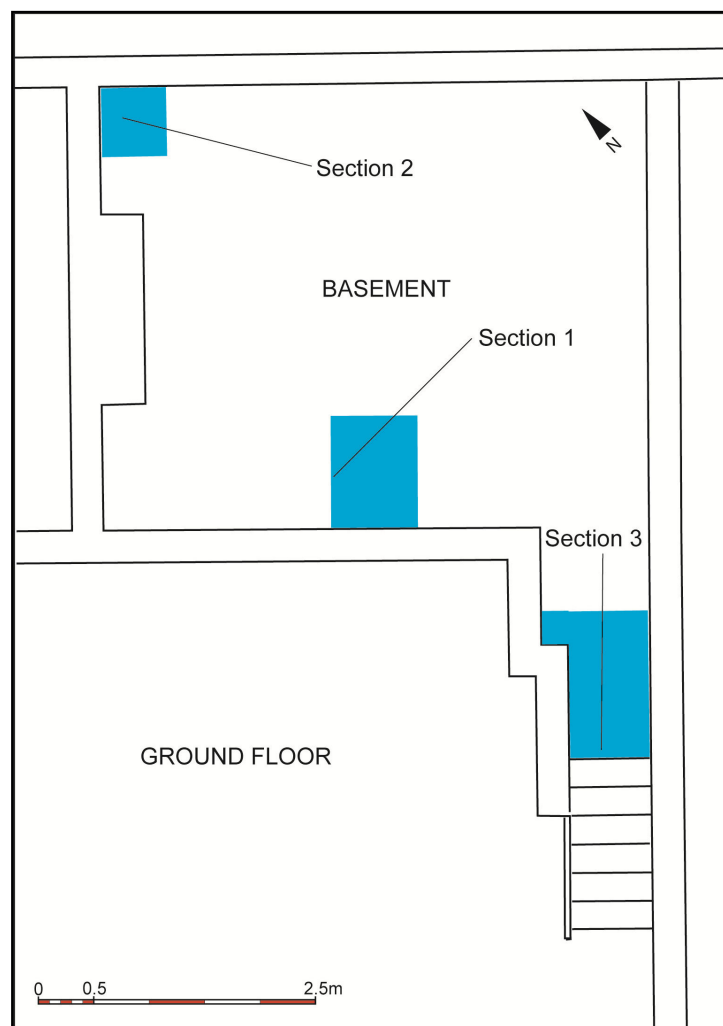

Figure 2 Location of recorded sections

COMPLETED BY	D.T. Evans	CHECKED BY	M.R. Stockwell	FINISHED	14/10/10
FINDS	No	SAMPLES	No	PHOTOS	Yes
				PAGE	2 of 5



YORK ARCHAEOLOGICAL TRUST REPORT

SITE ADDRESS	6 Portland Street, York		
CLIENT NAME	Ann Holt		
YAT PROJECT #	5411	YAT REPORT #	2010/85
MUSEUM ACCESSION #	n/a	GRID REFERENCE	SE 6016 5245
PLANNING REFERENCE #	n/a	AAI OPS NOTICE #	10024

The third section was towards the bottom of the steps down into the basement. The steps and underlying make-up were removed and the sloping surface revealed was cut back vertically to the lowest remaining step. In this vertical section the lowest deposit recorded was a firm, mid brown clay with occasional pebbles (1006). This extended upwards to c.0.95m above the basement floor. Above it was a 0.25m deep layer of dark greyish-brown silt with frequent brick / tile and plaster (1007) forming the make-up for the steps.



Plate 1 Section 1 trench during excavation, looking south-west

COMPLETED BY	D.T. Evans	CHECKED BY	M.R. Stockwell	FINISHED	14/10/10
FINDS	No	SAMPLES	No	PHOTOS	Yes
				PAGE	3 of 5

York Archaeological Trust is a
Registered Charity
No. 509060



Registered Office:
47 Aldwark, York YO1 7BX
Tel: 01904 663000 Fax: 01904 663024



A Company Limited by Guarantee
Without Share Capital Registered
in England No. 1430801



YORK ARCHAEOLOGICAL TRUST REPORT

SITE ADDRESS	6 Portland Street, York		
CLIENT NAME	Ann Holt		
YAT PROJECT #	5411	YAT REPORT #	2010/85
MUSEUM ACCESSION #	n/a	GRID REFERENCE	SE 6016 5245
PLANNING REFERENCE #	n/a	AAI OPS NOTICE #	10024



Plate 2 Section 2 trench during excavation, looking north-east



Plate 3 Section 3 after completion of excavation, looking south-west

COMPLETED BY	D.T. Evans	CHECKED BY	M.R. Stockwell	FINISHED	14/10/10
FINDS	No	SAMPLES	No	PHOTOS	Yes
				PAGE	4 of 5



YORK ARCHAEOLOGICAL TRUST REPORT

SITE ADDRESS	6 Portland Street, York		
CLIENT NAME	Ann Holt		
YAT PROJECT #	5411	YAT REPORT #	2010/85
MUSEUM ACCESSION #	n/a	GRID REFERENCE	SE 6016 5245
PLANNING REFERENCE #	n/a	AAI OPS NOTICE #	10024

CONCLUSIONS

It was clear that the basement had penetrated deeply enough into the natural subsoil to have removed any archaeological remains except for deeply cut features. None were observed in any of the standing sections but previous work in the vicinity has demonstrated that deposits and features of the Roman, medieval and later periods do survive in this part of York. The surface of probable field drain pipes is of some interest, perhaps suggesting that problems with water in the basement are not a recent development but it was not possible to establish if the drain pipes were an original part of the floor or, more probably, a later addition. No archaeological remains were disturbed during these works.

COMPLETED BY	D.T. Evans	CHECKED BY	M.R. Stockwell	FINISHED	14/10/10
FINDS	No	SAMPLES	No	PHOTOS	Yes
				PAGE	5 of 5

York Archaeological Trust is a
Registered Charity
No. 509060



Registered Office:
47 Aldwark, York YO1 7BX
Tel: 01904 663000 Fax: 01904 663024



A Company Limited by Guarantee
Without Share Capital Registered
in England No. 1430801