

**Report on Works Under Archaeological
Supervision and Control at
'111 Bishops Road, Gaywood, King's Lynn, Norfolk'**

ENF136852

Title:	Report on WUASC at '111 Bishops Road, Gaywood, King's Lynn, Norfolk'
Author(s):	Chris Birks, chris@chrisbirksarchaeology, 01603-737804/07963-969623
Derivation:	Initial draft CB411R Gaywood Draft, final report CB411R Gaywood Final
Origination Date:	July 2015
Reviser(s):	Chris Birks
Date of revision:	29 July 2015
Sequence:	CB411R Gaywood Draft, CB411R Gaywood Final
Version:	1.1
Status	Final copy
Summary of Changes	Update document control grid, confirm approval of draft copy,
Sections revised:	Document control grid, 1.2
Circulation:	Norfolk County Council Historic Environment Service, Client
Required Action:	None
File Name/Location:	C:\Users\Chris\Desktop\Chris Business\Year 11 Apr2014 to Apr2015\OngoinProjects\Gaywood\Report CB411R Gaywood FINAL.docx
Approval:	Kelly Powell 28 July 2015
Comments:	Draft report submitted to Norfolk County Council Historic Environment Service on 28 July 2015 and approved on same day.

Reference No. CB411R
© Chris Birks July 2015

All rights reserved

Archaeological Report

CB411R

**111 Bishops Road, Gaywood,
King's Lynn, Norfolk**

ENF136852

Prepared for:

Mr and Mrs Oliver
111 Bishops Road
Gaywood
King's Lynn
Norfolk
PE30 4NU

Reference No. CB411R
© Chris Birks July 2015

All rights reserved

Contents

<i>Section</i>	<i>Page</i>
<i>Summary</i>	1
1.0 Introduction	1
2.0 Project Background	1, 2
3.0 Archaeological and Historical Background	2
4.0 Geology and Topography	3
5.0 Observations	3
6.0 Conclusions	3

Acknowledgements

Bibliography

Appendix 1 OASIS Record

- Figure 1*** Site location plan
Figure 2 Site plan

Summary

Archaeological monitoring was carried out at '111 Bishops Road, Gaywood, King's Lynn, Norfolk' (Norfolk Historic Environment Record ENF136852) in May 2015 during groundworks associated with the construction of an extension to a residential building. No finds, features or deposits of archaeological significance were present.

1.0 Introduction

- 1.1 Archaeological monitoring ("Watching Brief") was carried out during ground works at '111 Bishops Road, Gaywood, King's Lynn, Norfolk' (grid reference TF 63717 20002, centred at) and was requested by the Norfolk County Council Historic Environment Service.
- 1.2 This report, CB411R, details how Chris Birks undertook these works and summarises the results. A copy has been submitted to the Norfolk County Council Historic Environment Service for consideration in accordance with the Historic Environment Service Brief and *Standard and guidance for commissioning work or providing consultancy advice on archaeology and the historic environment* by the Chartered Institute for Archaeologists (2014). Approval was received on 28 July 2015 prior to preparation of this *final* report.

Fig. 1. Site location plan



2.0 Project Background

- 2.1 A proposal for the construction of an extension to a residential building at '111 Bishops Road, Gaywood, King's Lynn, Norfolk' was approved subject to a condition for a Programme of

Archaeological work. Works Under Archaeological Supervision and Control ('Archaeological Monitoring'/Watching Brief') were required at a level of constant attendance. Borough Council of King's Lynn & West Norfolk planning number 14/01643/F applies.

- 2.2 Archaeological monitoring was undertaken in accordance with a Generic Brief issued by the Norfolk County Council Historic Environment Service (reference CNF45981_1) and a generic Project Design and Written Scheme of Investigation for Archaeological Monitoring ("Watching Briefs") by Chris Birks (Birks 2004 Apr13 rev). Specific aims of the project are to determine the presence/absence, date, extent, state of preservation and significance of any archaeological layers or subsoil archaeological features. This forms part of the research agenda for the eastern counties of England in *Research and Archaeology Revisited: A Revised Framework for the East of England* (Medlycott 2011). Contributions to environmental archaeology research aims (Murphy 2000) may also be made. Full details of research aims, methodology and standards are provided in the Project Design and Written Scheme of Investigation for Archaeological Monitoring.
- 2.3 Norfolk Historic & Environment Record (NHER) number ENF136852; Online Access to the Index of Archaeological Investigations (OASIS) ID: chrisbir-218972.
- 2.4 The site archive will be prepared in accordance with the principles of *Management of research projects in the historic environment. The MoRPHE Project Manager's Guide* (Historic England 2015) and submitted to the Norfolk Museums Service for long-term storage.

3.0 Archaeological and Historical Background

- 3.1 Entries exist in the Norfolk Historic Environment Record (NHER) for Gaywood and the surrounding area. A search of the entries produced 48 records within a radius of 250m of the site. Commensurate with the findings of the current excavations, only those records in closest proximity to the site are summarised in this report. Full details of these and all other entries can be seen in the NHER office based at Gressenhall near Dereham by prior appointment.
- 3.2 A Neolithic leaf flint arrowhead was found in Gaywood Park to the northwest of the development site in 1973 (NHER 5493).
- 3.3 St Faith's Church to the northwest of the development site has its origins in the Norman period but was substantially rebuilt in the 14th century (NHER 5556). In the 1920s, the nave was rebuilt, the aisles were added and the north porch was rebuilt incorporating a Norman arch. The church contains a late-14th century font and two 17th century painted panels. One of the panels depicts Queen Elizabeth's arrival at Tilbury, with the Spanish Armada in the background.
- 3.4 A large Post-medieval (17th century) buckle was found in the garden of 81 Bishop's Road to the north of the development site before 1986 (NHER 23157).
- 3.5 The Old Rectory lies to the north of the development site (NHER 20891). It is an early-18th century former rectory that was remodelled in the early-19th century. The east façade has a central pedimented bay and the south front has a two-storey box window. There is evidence of the practice of ruddling and lining to the rear of the house.
- 3.6 The site lies to the west of Gaywood Hall (NHER 5555); a hall of 1851, built on the site of a medieval moated Bishop's Palace. Excavations prior to building works in the late-20th century found traces of thick wall foundations and large quantities of medieval pottery, coins *etc.* Also found were fragments of a 14th century marble pillar. The house itself has had various uses since the 1930s including the Norfolk College of Arts and Technology and is currently a private dwelling that is for sale.
- 3.7 Archaeological monitoring of groundworks for the extension of a car park at King's Lynn Academy to the southeast of the development site in 2012 recorded no archaeological finds or features. It has been suggested that this area was marsh until relatively recent periods, and cropmarks visible on 1946-7 aerial photographs indicate the area of the school may have been a floated water meadow although no evidence for this was observed during the monitoring.

4.0 Geology and Topography

- 4.1 The parish of Gaywood lies to the east of King's Lynn upon a solid geology of Upper Jurassic in the west and Lower Cretaceous to the east (Funnell 2005). The soil landscape is also divided between Gault Clays in the west and West Norfolk Lowlands in the east (Williamson 2005).
- 4.2 The property is set-back from Bishops Road, to the east, on generally level ground at an elevation of c. 9m OD.

5.0 Observations

- 5.1 Monitoring was carried out in May 2015 during excavations associated with the construction of the new residential extension (*Fig. 2*). No context numbers were allocated due to the lack of archaeological remains.
- 5.2 Site conditions were good and access was gained from Bishops Road to the west of the site. The weather remained dry, sunny and warm.
- 5.3 An existing conservatory on the east side of the house was demolished. The footprint of the new extension was initially excavated to a depth of c. 0.5m beneath present ground level removing c. 0.3m of mid to dark grey brown silty sand with occasional small-sized brick fragments and rare small-sized subrounded flints and mid brown silty sand subsoil with rare small-sized subrounded flints. A former iron gas pipe was present and avoided during the excavations. No finds, features or deposits of archaeological significance were present.
- 5.4 Foundation trenches measured c. 0.6m wide and were excavated to a depth of c. 1m beneath present ground level. Initially, c. 0.3m of mid to dark grey brown silty sand with occasional small-sized brick fragments and occasional small-sized subrounded flints was removed that overlay c. 0.7m of mid brown silty sand subsoil with rare small-sized subrounded flints. Subsoil overlay light to mid brown clayey sand undisturbed 'natural' deposits and the water table was encountered at a depth of c. 0.9m beneath present ground level. No finds, features or deposits of archaeological significance were present.
- 5.5 A trench for a surface water drain measured c. 0.3m wide and was excavated to a maximum depth of 0.8m beneath present ground level removing c. 0.3m of mid to dark grey brown silty sand with occasional small-sized subrounded flints that overlay c. 0.5m of mid brown silty sand subsoil with rare small-sized subrounded flints. No finds, features or deposits of archaeological significance were present.
- 5.6 The trench for the surface water drain extended to a rain water soakaway to the southeast (not illustrated). The soakaway measured approximately 1.8m by 1.8m and was excavated to a depth of c. 1.8m beneath present ground level. Initially, c. 0.3m of mid to dark grey brown silty sand with occasional small-sized subrounded flints was removed that overlay c. 0.7m of mid brown silty sand subsoil with rare small-sized subrounded flints. Subsoil overlay light to mid brown clayey sand undisturbed 'natural' deposits. No finds, features or deposits of archaeological significance were present.

6.0 Conclusions

- 6.1 Archaeological monitoring carried out during groundworks associated with the construction of the new residential extension did not reveal any finds, features or deposits of archaeological significance. The exact reasons for this are unknown; any archaeological remains may be located beyond the minimal excavated areas or any such remains may simply lie beyond the boundaries of the site.

Acknowledgments

The project was undertaken by Chris Birks on behalf of Darren and Vicky Oliver. Many thanks to Vicky for the provision of drinks. Fieldwork was undertaken by Chris Birks. The report was written by Chris Birks.

Many thanks to Mark Cotton and his team who carried out the groundworks.

Thanks to Anj Beckham, Alice Cattermole, Zara Dack and Heather Hamilton at the Norfolk Historic and Environment Record office based at Gressenhall. Thanks also to James Albone, David Gurney, Ken Hamilton, Kelly Powell, Andrew Rogerson and David Robertson at the Norfolk County Council Historic Environment Service.

Bibliography

- Birks, C., 2004 *Generic Project Design and Written Scheme of Investigation for Archaeological Monitoring ("Watching Briefs")*. Chris Birks unpublished document Apr 2013 revision
- English Heritage 1991 *Management of Archaeological Projects (MAP2)*
- Funnell, B., 2005 'Solid Geology' in *An Historical Atlas of Norfolk*, edited by Ashwin, T., and Davison, A.
- Gurney, D., 2003 *Standards for Field Archaeology in the East Of England* (East Anglian Archaeology Occasional Papers 14)
- Medlycott, M., 2011 *Research and Archaeology Revisited: A Revised Framework for the East of England*. East Anglian Archaeology Occasional Paper 24
- MoRPHE 2015 *Management of Research Projects in the Historic Environment. The MoRPHE Project Manager's Guide* (Historic England)
- SCAUM 1997 *Health and Safety at Work Act 1974, The Management of Health and Safety Regulations 1992 and Health and Safety in Field Archaeology*
- Williamson, T., 2005 'Soil Landscapes', in *An Historical Atlas of Norfolk*, edited by Ashwin, T., and Davison, A.

Appendix 1 OASIS Record

OASIS ID: *chrisbir1-218972*

Project details

Project name	Archaeological monitoring at '111 Bishops Road, Gaywood'
Short description of the project	Archaeological monitoring was carried out at '111 Bishops Road, Gaywood, King's Lynn, Norfolk' in May 2015 during groundworks associated with the construction of an extension to a residential building. No finds, features or deposits of archaeological significance were present.
Project dates	Start: 08-05-2015 End: 27-05-2015
Previous/future work	No / Not known
Any associated project reference codes	ENF136852 - HER event no.
Type of project	Recording project
Current Land use	Residential 1 - General Residential
Monument type	NONE None
Significant Finds	NONE None
Investigation type	"Watching Brief"
Prompt	Direction from Local Planning Authority - PPS

Project location

Country	England
Site location	NORFOLK KINGS LYNN AND WEST NORFOLK KINGS LYNN 111 Bishops Road, Gaywood, King's Lynn, Norfolk
Study area	75.00 Square metres
Site coordinates	TF 63717 20002 52.7524139159 0.426095931056 52 45 08 N 000 25 33 E Point

Project creators

Name of Organisation	Chris Birks
Project brief originator	Local Authority Archaeologist and/or Planning Authority/advisory body
Project design originator	Chris Birks
Project director/manager	Chris Birks
Project supervisor	Chris Birks
Type of sponsor/funding body	Landowner
Name of sponsor/funding body	Mr and Mrs Oliver

Project archives

Physical Archive Exists?	No
Digital Archive Exists?	No
Paper Archive recipient	Norfolk Museums Service
Paper Archive ID	ENF136852
Paper Contents	"none"
Paper Media available	"Map","Plan","Report","Unpublished Text"

Project bibliography 1

Publication type	Grey literature (unpublished document/manuscript)
Title	Report on Works Under Archaeological Supervision and Control at '111 Bishops Road, Gaywood, King's Lynn, Norfolk'
Author(s)/Editor(s)	Birks, C.
Other bibliographic details	Report Number CB411R
Date	2015
Issuer or publisher	Chris Birks
Place of issue or publication	Contractor's Report
Description	Bound A4 single-side printed report with text, site location map and site plan drawing

Entered by	Chris Birks (chris@chrisbirksarchaeology.co.uk)
Entered on	28 July 2015

OASIS:

Please e-mail [Historic England](#) for OASIS help and advice

© ADS 1996-2012 Created by [Jo Gilham and Jen Mitcham, email](#) Last modified Wednesday 9 May 2012

Cite only: <http://www.oasis.ac.uk/form/print.cfm> for this page

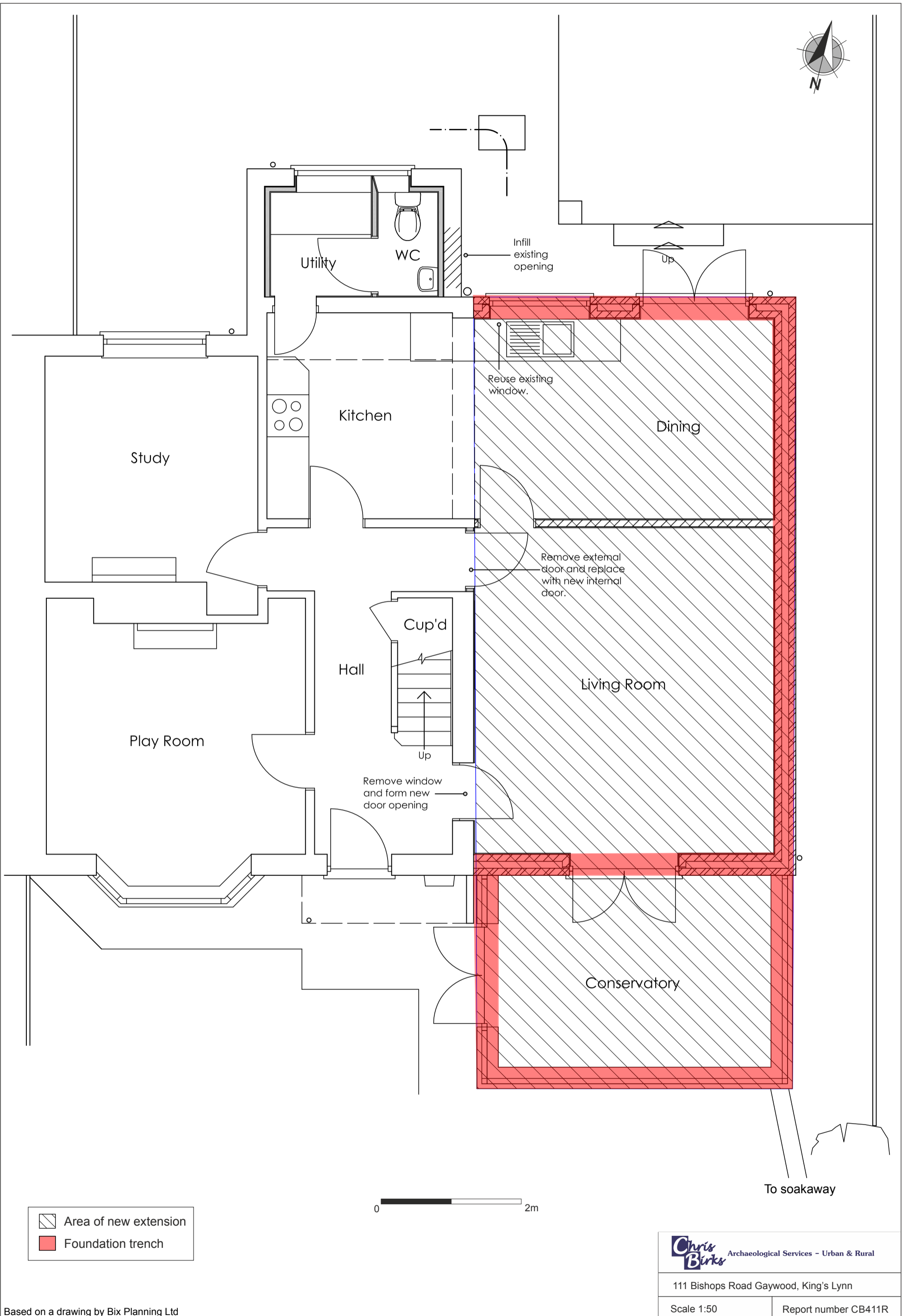

Based on a drawing by Bix Planning Ltd

Figure 2. Site plan