



Archaeological Services - Urban & Rural

T: 01603 737804

M: 07963 969623

E: enquiries@chrisbirksarchaeology.co.uk

**Report on Archaeological Monitoring at 'Land
to rear of 12-14 Raymond Street, Thetford,
Norfolk'**

ENF142479

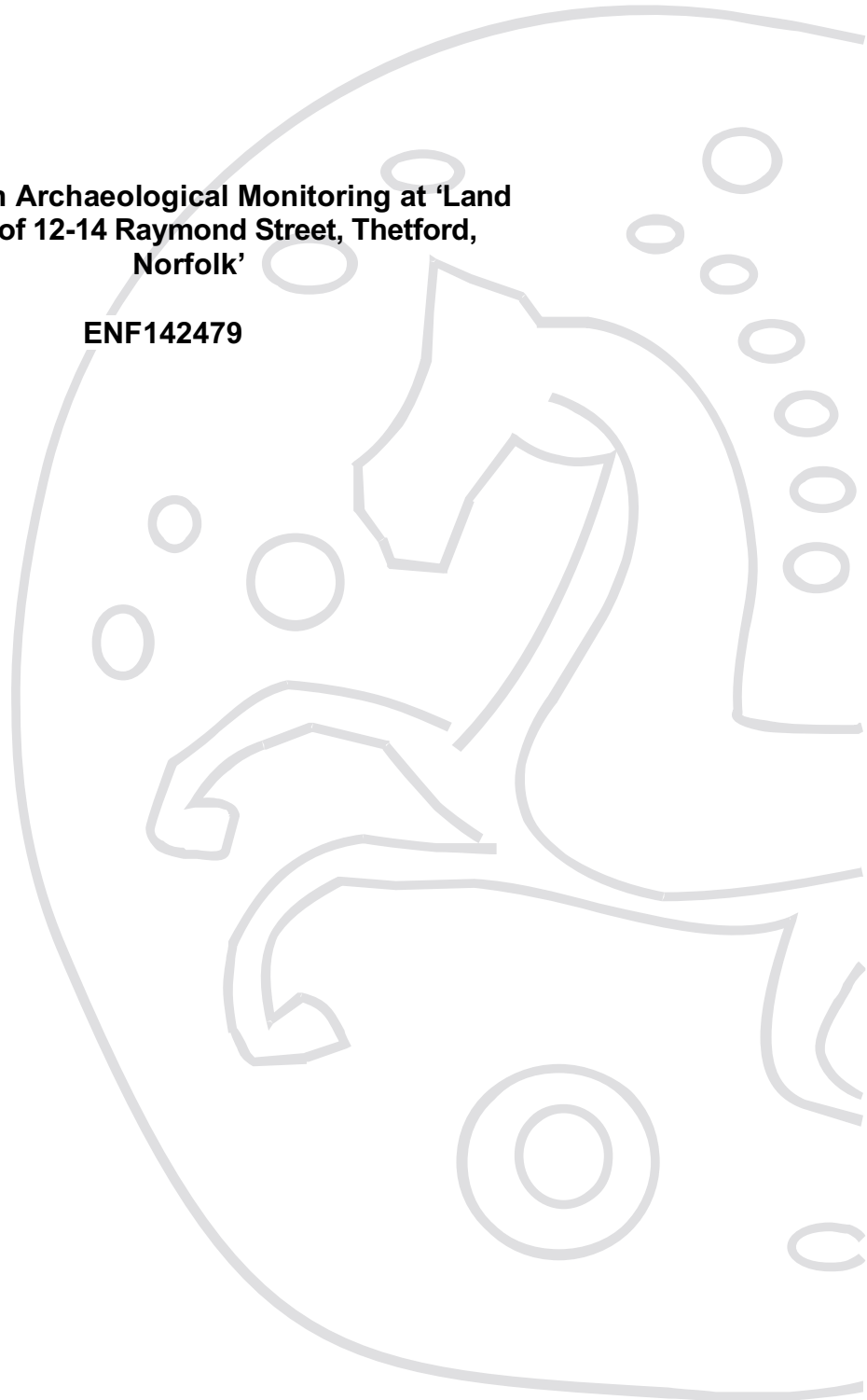

Reference No. CB404R
© Chris Birks August 2017

All rights reserved

**Report on Archaeological Monitoring at 'Land to rear of 12-14
Raymond Street, Thetford, Norfolk'**

ENF142479

Prepared for
Clayland Architects
Clayland House
1 Norwich Road
Watton
Norfolk
IP25 6DA

Reference No. CB404R
© Chris Birks August 2017

All rights reserved

Contents

<i>Section</i>	<i>Page</i>
<i>Summary</i>	<i>1</i>
1.0 Introduction	1
2.0 Project Background	1, 2
3.0 Archaeological & Historical Background	2, 3
4.0 Geology and Topography	3
5.0 Results	3
5.1 Introduction	
5.2 Observations	
6.0 Conclusions	4
 <i>Acknowledgements</i>	
<i>Bibliography</i>	
 <i>Appendix 1</i> OASIS Record	
 <i>Figure 1</i> Site location	
<i>Figure 2</i> Site plan	

Plate 1. General view of the excavations, looking southwest

Summary

Archaeological monitoring was carried out at 'Land to the rear of 12-14 Raymond Street, Thetford, Norfolk' (NHER ENF142479) in May 2017 during groundworks associated with the construction of a residential building. Despite the potential for archaeological remains, none were present.

1.0 Introduction

- 1.1 A programme of Archaeological Monitoring resulting from development proposals at 'Land to the rear of 12-14 Raymond Street, Thetford, Norfolk' (Grid refs. TL 87115 82927, Fig. 1) was requested by the Norfolk County Council Historic Environment Service. Works were undertaken according to a generic Brief (CNF45735_2) and generic Written Scheme of Investigation for Works Under Archaeological Supervision and Control (CBGen v.1.9).

Fig. 1. Site Location



2.0 Project Background

- 2.1 The proposed development site lies within a landscape of significant heritage assets with archaeological interest (buried archaeological remains). The site lies within the core of the Late Saxon and medieval town of Thetford. Previous excavations at 22 Raymond Street revealed activities during the Saxon and medieval periods and at the library site to the north/northwest, a defensive ditch enclosing a suburb of the Late Saxon town to the north of the River Thet was recorded. The area became incorporated into the medieval town as this expanded further north following the construction of Thetford Castle to the east. Consequently there is a high potential that important heritage assets with archaeological interest will be present at the proposed development site. Historic maps indicate that there have been no buildings on the site since at least 1840. It is

likely, therefore, that any buried archaeological remains at the proposed development site may be comparatively well preserved.

- 2.2 An archaeological evaluation by trial trenching was carried out at the development site (NHER ENF134941) in August 2014. Three finds were recovered from subsoil deposits and include 2 sherds of 10th/11th century pottery and a fragment of animal bone (Birks 2014). No further archaeological remains were present. A further phase of Archaeological Monitoring during the development was required.
- 2.3 Works under Archaeological Supervision and Control were required to record the presence/absence, date, extent, state of preservation and significance of any archaeological layers or subsoil archaeological features in accordance with *National Planning Policy Framework (2012)*, (paras 128, 129, 132, 134 and 141). They were undertaken in accordance with a generic Brief issued by the Norfolk County Council Historic Environment Service and a generic Written Scheme of Investigation for Works under Archaeological Supervision and Control (CBGenWB v.1.9). Specific aims of the project are to determine the presence/absence, date, extent, state of preservation and significance of any archaeological layers or subsoil archaeological features. This forms part of the research agenda for the eastern counties of England in *Research and Archaeology Revisited: A Revised Framework for the East of England* (Medlycott 2011). Full details of research aims, methodology and standards are provided in the Written Scheme of Investigation.
- 2.4 The *Code of Conduct (2014)*, *Regulations for Professional Conduct* (January 2015 revision) and *Standard and guidance for an archaeological watching brief (2014)* by the Chartered Institute of Field Archaeologists (CIFA) were adhered to. Works were carried out according to guidelines set out in *Standards for Field Archaeology in the East of England* (Gurney 2003) and *Management of research projects in the historic environment. The MoRPHE Project Manager's Guide* (Historic England 2015).
- 2.5 This report summarises the results of the archaeological evaluation by trial trenching. Norfolk Historic Environment Record (NHER) ENF142479 and Online Access to the Index of Archaeological Investigations (OASIS) id chrisbir1-346903 apply.

3.0 Archaeological & Historical Background

- 3.1 A search of Norfolk Historic Environment Records (NHER) for the site and within a radius of 250m of the site produced 110 entries. Commensurate with the findings of the archaeological monitoring, only those records in closest proximity to the site are summarised in this report. Full details of these and all other entries can be seen in the NHER office based at Gressenhall near Dereham by prior appointment.
- 3.2 Excavations in 1997 in advance of a proposed extension to Thetford Library (NHER 32339) to the north/northwest of the proposed development site recorded evidence for occupation from the Late Saxon to Post-medieval periods. The most significant feature was a ditch believed to form part of a 12th century defensive structure that ringed the northern part of the town during the Late Saxon period. Medieval activity was represented by several pits that contained bone and horn-working debris and the cellars of a 17th century building were encountered. The cellars are believed to have been associated with a building known as Manor House, a dwelling of medieval origins that stood at this location until the 1960's, when the current library was built.
- 3.3 Archaeological evaluation by trial trenching at the development site in 2014 (NHER ENF134941) revealed 2 sherds of 10th/11th century pottery and a fragment of animal bone, no significant archaeological remains were present (Birks 2014).
- 3.4 An archaeological evaluation was carried out to the rear of 22 Raymond Street, south of the proposed development site in January 2011 (NHER 56055, Thompson & Barlow 2011). The excavations revealed pits containing medieval pottery and a pit cut by the medieval pits, possibly of Saxon date.

- 3.5 Late-18th century buildings include present-day numbers 6, 6A to 6D and 8 Raymond Street (NHER 46492), a range of three houses to the immediate northwest of the development site (NHER 46394), and 4 Raymond Street to the north of the development site (NHER 46356). Number 10 Raymond Street to the north of the proposed development site dates to around 1820 (NHER 46357).
- 3.6 There was potential, therefore, that significant heritage assets with archaeological interest (buried archaeological remains) may be present at the site and that their significance may be affected by the proposed development. The recovery of such information would contribute greatly to Research Topics for the Eastern Counties.

4.0 Geology and Topography

- 4.1 Thetford lies upon a solid Lower, Middle and Upper Chalk geology with overlying glacial deposits (Funnell 2005) and within the Breckland soil landscape (Williamson 2005).
- 4.2 The site lies towards the southeast side of Thetford town centre at an elevation of c. 14m OD and the land falls slightly from northeast to southwest. It is currently used as a garden to 12-14 Raymond Street.

5.0 Results

5.1 Introduction

- 5.1.1 Fieldwork was carried out on 16 and 18 May 2017 and access was gained from Nether Row to the west of the site. The weather remained dry and sunny. No context numbers were allocated during fieldwork due to the lack of archaeological remains.

5.2 Observations

- 5.2.1 The site was excavated to a maximum depth of c. 1.5m beneath present ground level, deepest at the northeast side of the site to form a level pad for construction of the new building, removing c. 0.4m of dark greyish brown silty sand topsoil with occasional small-sized subangular flints and rare flecks of chalk and c. 0.9m of mid greyish brown silty sand subsoil with occasional small-sized subangular flints and occasional flecks of chalk and rare fragments of ceramic building material above mid brownish yellow sand undisturbed 'natural' deposits with frequent small-sized subangular flints and occasional medium-sized subangular flints and patches of off white chalk (*Fig. 2, Plate 1*). Towards the southwest end of the site, undisturbed 'natural' deposits were not exposed. No archaeological remains were present.

Plate 1. General view of the excavations, looking southwest



Scale is 2m in 0.5m increments

6.0 Conclusions

- 6.1 Despite the proximity of the development site to the centre of present-day Thetford town within the boundaries of the Saxon borough and the identification of archaeological finds and features through previous archaeological investigations in the area, no archaeological remains were encountered during the archaeological monitoring, the precise reasons for which are not known. The developer advised that no further excavations associated with the development were required.

Acknowledgments

The project was undertaken by Chris Birks for Clayland Architects who funded the work. Fieldwork was undertaken by John Simmons and the report was written by Chris Birks with contributions by John Simmons.

Many thanks to Peter Watkins at the Norfolk Historic Environment Record office based at Gressenhall. Thanks also to James Albone, David Gurney, Ken Hamilton, Kelly Powell, David Robertson and Andrew Rogerson at the Norfolk County Council Historic Environment Service and to John Percival at the Norfolk County Council Environment Service.

Bibliography

- Birks, C., 2014 *Report on Archaeological Evaluation by Trial Trenching a '12-14 Raymond Street, Thetford, Norfolk.'* Unpublished Chris Birks Report number CB389R
- Funnell, B., 2005 'Geological Background' in *An Historical Atlas of Norfolk*, edited by Ashwin, T., and Davison, A.
- Gurney, D., 2003 *Standards for Field Archaeology in the East Of England* (East Anglian Archaeology Occasional Papers 14
- Medlycott, M., 2011 *Research and Archaeology Revisited: A Revised Framework for the East of England*). East Anglian Archaeology Occasional Paper 24
- SCAUM 1997 *Health and Safety at Work Act 1974, The Management of Health and Safety Regulations 1992 and Health and Safety in Field Archaeology*

Appendix 1. OASIS Record

OASIS ID: chrisbir1-346903

Project details

Project name	WUASC at '12-14 Raymond Street, Thetford, Norfolk'
Short description of the project	Archaeological monitoring during residential development revealed no archaeological remains.
Project dates	Start: 16-05-2017 End: 18-05-2017
Previous/future work	Yes / Not known
Any associated project reference codes	ENF142479 - HER event no.
Type of project	Recording project
Current Land use	Other 5 - Garden
Monument type	NONE None
Significant Finds	NONE None
Investigation type	"Watching Brief"
Prompt	National Planning Policy Framework - NPPF

Project location

Country	England
Site location	NORFOLK BRECKLAND THETFORD 12-14 Raymond Street, Thetford, Norfolk
Study area	300 Square metres
Site coordinates	TL 8711 8292 52.411783268222 0.751395262935 52 24 42 N 000 45 05 E Point

Project creators

Name of Organisation	Chris Birks
Project brief originator	Local Authority Archaeologist and/or Planning Authority/advisory body
Project design originator	Chris Birks
Project director/manager	Chris Birks
Project supervisor	John Simmons
Type of sponsor/funding body	Developer

Project archives

Physical Archive Exists?	No
Digital Archive Exists?	No
Paper Archive recipient	Norfolk Historic Environment Record
Paper Archive ID	ENF142479
Paper Contents	"none"
Paper Media available	"Report"

Project bibliography 1

Publication type	Grey literature (unpublished document/manuscript)
Title	Report on Works under Archaeological Supervision and Control at '12-14 Raymond Street, Thetford, Norfolk'
Author(s)/Editor(s)	Birks, C.,
Other bibliographic details	Report Number CB404R
Date	2017
Issuer or publisher	Chris Birks
Place of issue or publication	Contractor's Report
Description	Unbound A4 report
Entered by	Chris Birks (chris.birks@chrisbirksarchaeology.co.uk)
Entered on	26 March 2019

OASIS:

Please e-mail [Historic England](#) for OASIS help and advice

© ADS 1996-2012 Created by [Jo Gilham and Jen Mitcham, email](#) Last modified Wednesday 9 May 2012

Cite only: <http://www.oasis.ac.uk/form/print.cfm> for this page

[Cookies](#) [Privacy Policy](#)

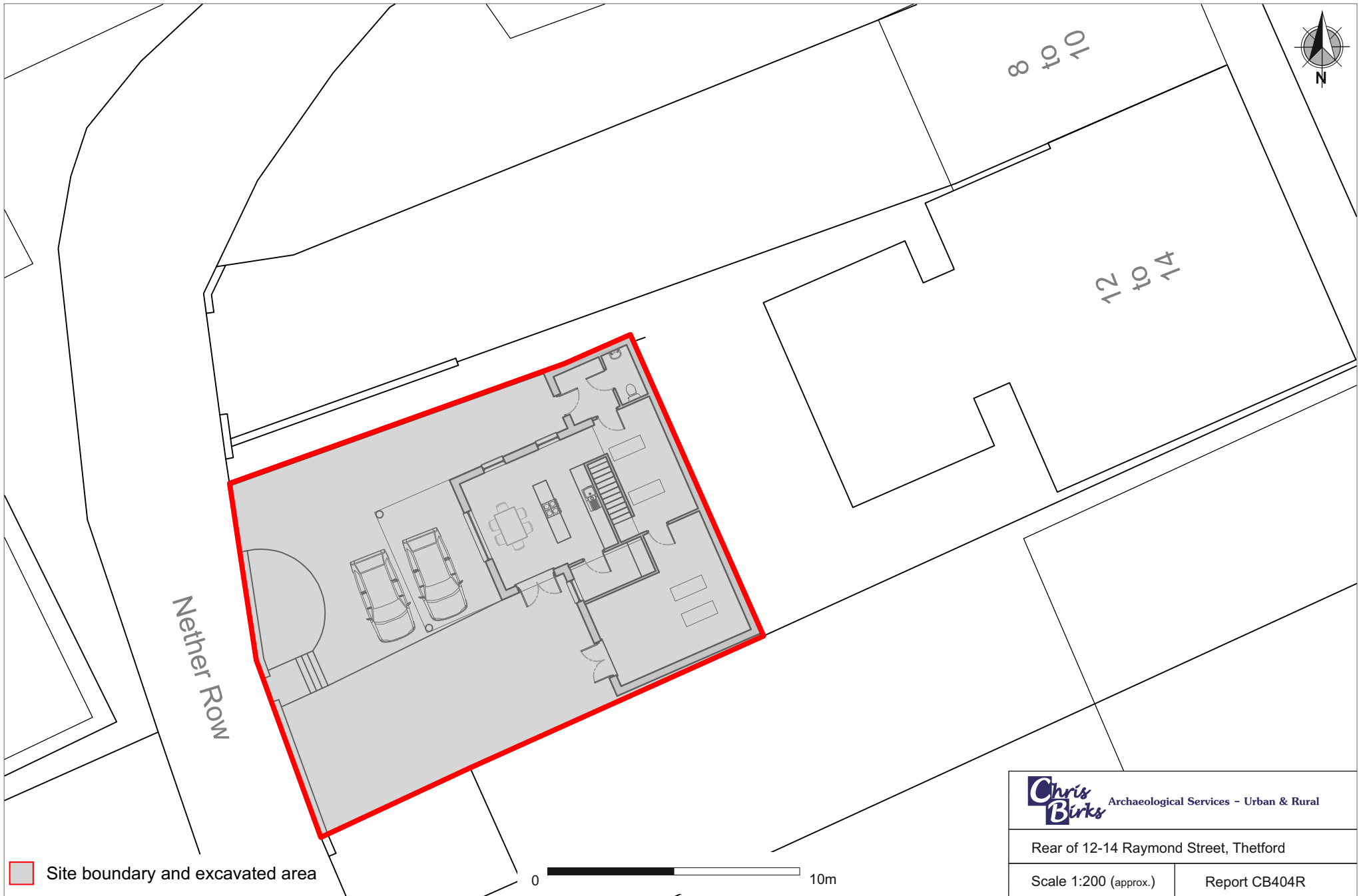

Figure 2. Site plan