

PHOTOGRAPHIC RECORDING
OF
MOORS FARM BARN,
WOODGATE, STOKE PRIOR,
WORCESTERSHIRE

Photographs taken and prepared by Shona Robson-Glyde

19th April 2004

© Historic Environment and Archaeology Service,
Worcestershire County Council

Historic Environment and Archaeology Service,
Worcestershire County Council,
Woodbury,
University College Worcester,
Henwick Grove,
Worcester WR2 6AJ



Project 2538
Report 1238
WSM 33584

Location and history

Moors Farm barn is located immediately adjacent to Moors Farmhouse at Woodgate in the parish of Stoke Prior near Bromsgrove. Moors Farmhouse is a grade II listed building dating from the 17th century. The barn probably dates from this time also but has been considerably altered.

The main section of the barn is of timber that originally had split wattle or lath panels. These have now been replaced with weatherboard and corrugated iron panels. The central section of the barn has had a breezeblock tack room built within it. The east section is of brick and is an extension. The addition of the section caused the original wall of the barn to be removed at ground floor level.

Information

The photographic recording of the barn took place on 16th April 2004. The photographs were taken with a Fujifilm Finepix S602zoom digital camera set 1M Fine. All of the photographs were taken by Shona Robson-Glyde and she also prepared the photograph document.

Nos 48-51 are of the house and barn.

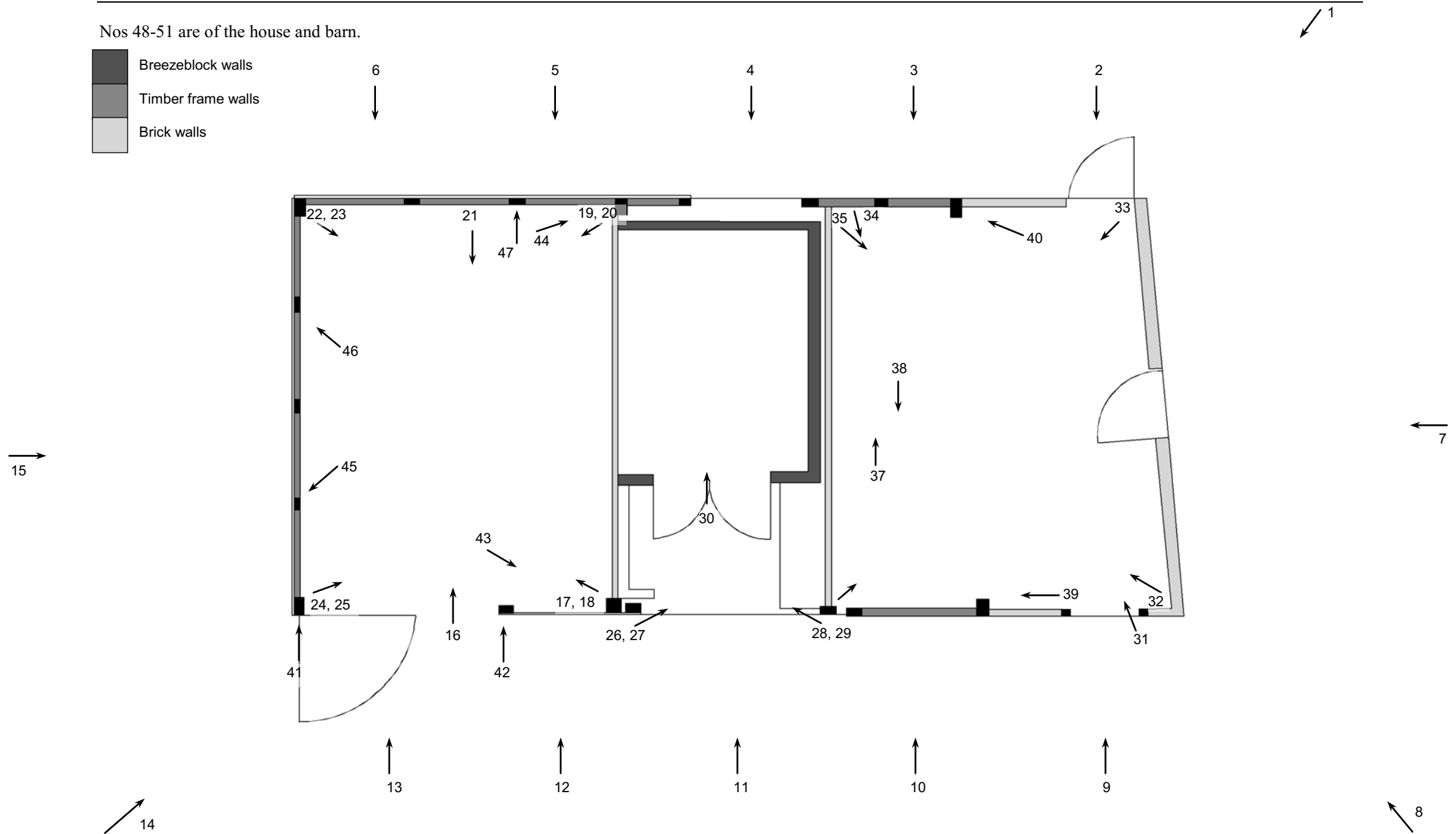

WSM 29879

NGR: SO9670 6649

[fieldwork ref: WSM33584]

Date of photography 16/4/04



Photograph no. 1 on plan



Photograph no. 2 on plan

WSM 29879

NGR: SO9670 6649

[fieldwork ref: WSM33584]

Date of photography 16/4/04



Photograph no. 3 on plan



Photograph no. 4 on plan

Photographs of an historic building as required as a condition of planning application **B/03/0513**
Moors Farm, Whitford Bridge Road, Stoke Prior.

WSM 29879

NGR: SO9670 6649

[fieldwork ref: WSM33584]

Date of photography 16/4/04



Photograph no. 5 on plan



Photograph no. 6 on plan

WSM 29879

NGR: SO9670 6649

[fieldwork ref: WSM33584]

Date of photography 16/4/04



Photograph no. 7 on plan



Photograph no. 8 on plan

Photographs of an historic building as required as a condition of planning application **B/03/0513**
Moors Farm, Whitford Bridge Road, Stoke Prior.

WSM 29879

NGR: SO9670 6649

[fieldwork ref: WSM33584]

Date of photography 16/4/04



Photograph no. 9 on plan



Photograph no. 10 on plan

WSM 29879

NGR: SO9670 6649

[fieldwork ref: WSM33584]

Date of photography 16/4/04



Photograph no. 11 on plan

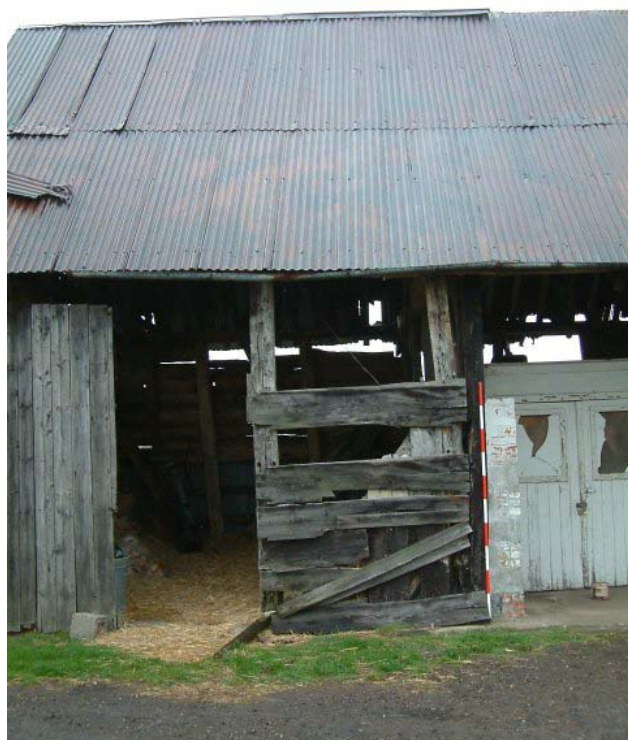

Photograph no. 12 on plan

WSM 29879

NGR: SO9670 6649

[fieldwork ref: WSM33584]

Date of photography 16/4/04

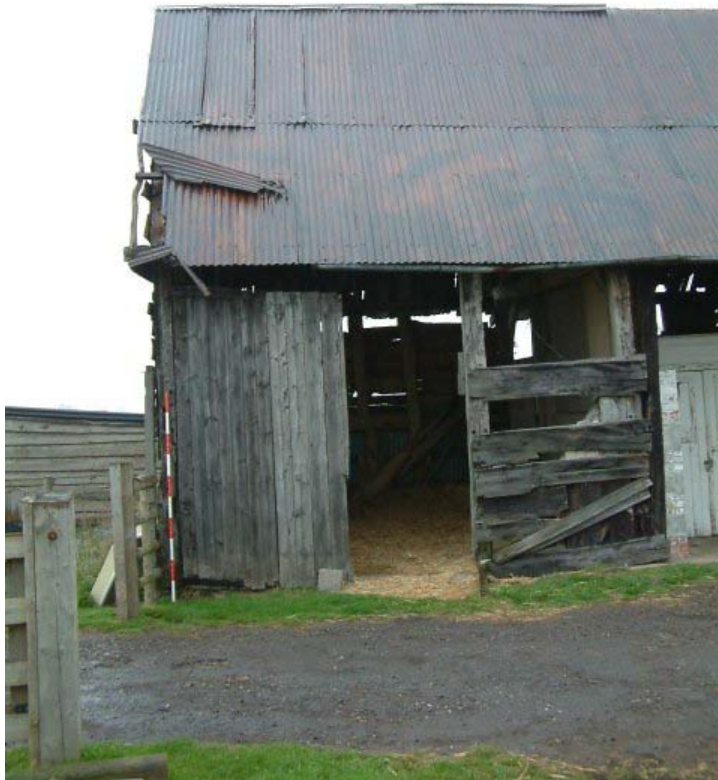

Photograph no. 13 on plan



Photograph no. 14 on plan

WSM 29879

NGR: SO9670 6649

[fieldwork ref: WSM33584]

Date of photography 16/4/04



Photograph no. 15 on plan



Photograph no. 16 on plan

WSM 29879

NGR: SO9670 6649

[fieldwork ref: WSM33584]

Date of photography 16/4/04



Photograph no. 17 on plan



Photograph no. 18 on plan

WSM 29879

NGR: SO9670 6649

[fieldwork ref: WSM33584]

Date of photography 16/4/04



Photograph no. 19 on plan



Photograph no. 20 on plan

WSM 29879

NGR: SO9670 6649

[fieldwork ref: WSM33584]

Date of photography 16/4/04



Photograph no. 21 on plan



Photograph no. 22 on plan

WSM 29879

NGR: SO9670 6649

[fieldwork ref: WSM33584]

Date of photography 16/4/04



Photograph no. 23 on plan



Photograph no. 24 on plan

WSM 29879

NGR: SO9670 6649

[fieldwork ref: WSM33584]

Date of photography 16/4/04



Photograph no. 25 on plan



Photograph no. 26 on plan

WSM 29879

NGR: SO9670 6649

[fieldwork ref: WSM33584]

Date of photography 16/4/04



Photograph no. 27 on plan



Photograph no. 28 on plan

WSM 29879

NGR: SO9670 6649

[fieldwork ref: WSM33584]

Date of photography 16/4/04



Photograph no. 29 on plan



Photograph no. 30 on plan

WSM 29879

NGR: SO9670 6649

[fieldwork ref: WSM33584]

Date of photography 16/4/04



Photograph no. 31 on plan

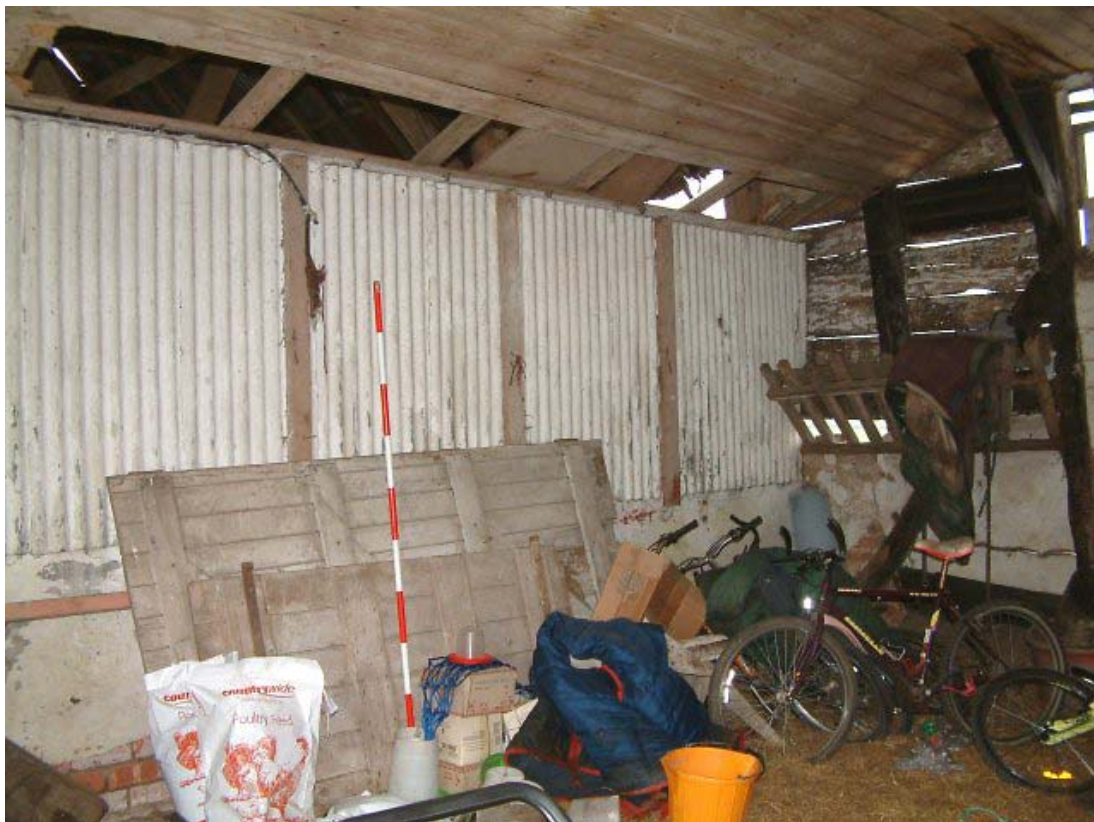

Photograph no. 32 on plan

WSM 29879

NGR: SO9670 6649

[fieldwork ref: WSM33584]

Date of photography 16/4/04



Photograph no. 33 on plan



Photograph no. 34 on plan

WSM 29879

NGR: SO9670 6649

[fieldwork ref: WSM33584]

Date of photography 16/4/04



Photograph no. 35 on plan



Photograph no. 36 on plan

WSM 29879

NGR: SO9670 6649

[fieldwork ref: WSM33584]

Date of photography 16/4/04



Photograph no. 37 on plan



Photograph no. 38 on plan

WSM 29879

NGR: SO9670 6649

[fieldwork ref: WSM33584]

Date of photography 16/4/04



Photograph no. 39 on plan



Photograph no. 40 on plan

WSM 29879

NGR: SO9670 6649

[fieldwork ref: WSM33584]

Date of photography 16/4/04



Photograph no. 41 on plan



Photograph no. 42 on plan

WSM 29879

NGR: SO9670 6649

[fieldwork ref: WSM33584]

Date of photography 16/4/04



Photograph no. 43 on plan



Photograph no. 44 on plan

WSM 29879

NGR: SO9670 6649

[fieldwork ref: WSM33584]

Date of photography 16/4/04



Photograph no. 45 on plan



Photograph no. 46 on plan

WSM 29879

NGR: SO9670 6649

[fieldwork ref: WSM33584]

Date of photography 16/4/04



Photograph no. 47 on plan



Photograph no. 48 on plan

WSM 29879

NGR: SO9670 6649

[fieldwork ref: WSM33584]

Date of photography 16/4/04



Photograph no. 49 on plan



Photograph no. 50 on plan

Photographs of an historic building as required as a condition of planning application **B/03/0513**
Moors Farm, Whitford Bridge Road, Stoke Prior.

WSM 29879

NGR: SO9670 6649

[fieldwork ref: WSM33584]

Date of photography 16/4/04



Photograph no. 51 on plan