



JOHN MOORE HERITAGE SERVICES

ARCHAEOLOGICAL WATCHING BRIEF

AT

**THE ATRIUM, THAMES STREET,
SONNING-ON-THAMES, WOKINGHAM,
BERKSHIRE RG4 6UR**

**NGR
SU 75830 75724**

JANUARY 2019

REPORT PREPARED BY Alessandro Guaggenti

ILLUSTRATION BY Autumn Robson

EDITED BY John Moore

AUTHORISED BY John Moore

FIELDWORK Alessandro Guaggenti, Stephanie Duensing,
Christopher Whitehead

FIELDWORK DATE 12th June – 27th November 2018

REPORT ISSUED 21st January 2019

ENQUIRES TO John Moore Heritage Services
Pasture Farmhouse
Boarstall
Aylesbury
HP18 9UR

Tel: 01865 358300
Email: info@jmheritageservices.co.uk

JMHS Project No: 3856
OASIS No: johnmoor1-339504
Site Code: SOTS17
Archive Location: The archive currently is maintained by John Moore Heritage Services until a suitable repository is available.



CONTENTS

	Page
<i>SUMMARY</i>	<i>1</i>
1 INTRODUCTION	1
1.1 Site Location	1
1.2 Planning Background	1
1.3 Archaeological Background	3
2 AIMS OF THE INVESTIGATION	5
3 STRATEGY	5
3.1 Research Design	5
3.2 Methodology	5
4 RESULTS	5
4.2 Reliability of Results	8
5 FINDS	8
6 DISCUSSION	8
7 ARCHIVE	9
8 BIBLIOGRAPHY	9
FIGURES AND PLATES	
Figure 1. Site Location	2
Figure 2. Site Plan and Sections	6
Plate 1. North-East Area. Looking North	7
Plate 2. Central Basement Area Stripped Down To Natural Horizon	7
APPENDICES	
Appendix 1. OASIS Report Form	10
Appendix 2. Primary Records	13
Appendix 3. Photographs	34

SUMMARY

John Moore Heritage Services carried out an archaeological watching brief at The Atrium, Thames Street, Sonning-On-Thames, Wokingham. The watching brief did not identify any evidence of archaeological activity at the site. A series of natural deposits were observed, demonstrating the geological processes which formed the landscape.

1 INTRODUCTION

1.1 Site Location (Figure 1)

The development site is located at The Atrium, Thames Street, Sonning-on-Thames, Berkshire (NGR SU 75830 75724). The site is bounded on the northeast by a meadow. On the southeast it borders up against Pool Court, the entrance road, and the north end of the properties of Elm House and Little Mede. On the southeast it bounds the domestic property of Meddelys. On the northwest side it bounds the property of Sonning Court.

Topographically the proposal site is located on the northwest facing slope on an east to west spur that approaches the River Thames. The site lies between 40m to 45m OD. The underlying geology (mapapps.bgs.ac.uk/geologyofbritain/home.html) is recorded as Seaford Chalk Formation and Newhaven Chalk Formation undifferentiated, which are sedimentary deposits laid down in the Cretaceous Period 71 to 89 million years ago. In this location it is capped by Head, a deposit of gravel, sand, silt and clay laid down 3 million years ago.

1.2 Planning Background

Wokingham District Council granted planning permission for the proposed erection of replacement dwelling with basement and detached double garage and store following the demolition of an existing building (173537). Due to the archaeological and historical importance of the surrounding area a condition was attached to the permission requiring a watching brief to be maintained during the course of building operations or construction works on the site:

8 Archaeological Investigations

No development shall take place within the site until the applicant, or their agents or their successors in title, has secured the implementation of a programme of archaeological work (which may comprise one phase of work) in accordance with a written scheme of investigation has been submitted by the applicant and approved in writing by the Local Planning Authority. The development shall only take place in accordance with the detailed scheme approved pursuant to this condition.

Reason: To ensure that any archaeological remains within the site are adequately investigated and recorded or preserved in situ in the interest in protecting the archaeological heritage of the borough. Relevant Policy: TB25 of the MDD Local Plan.

This was in line with NPPF and Local Planning policies.

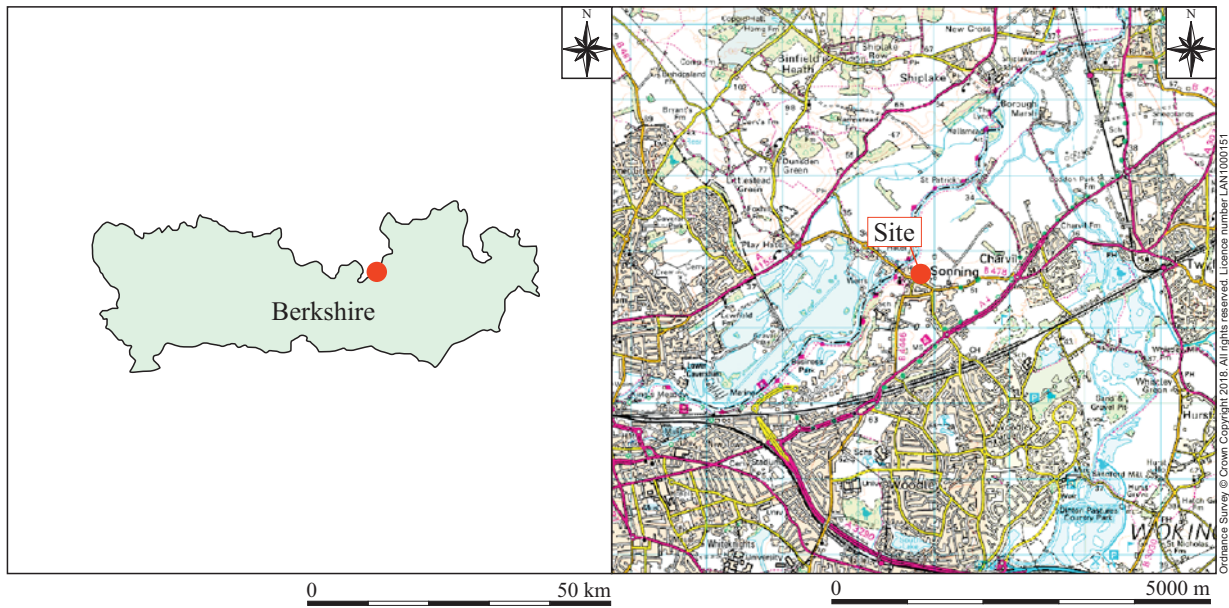

Key Site boundary Monitored area

Figure 1: Site location

1.3 Archaeological Background

A search of the Berkshire Historic Environment Record (HER) was carried out to establish the archaeological potential of the site. The search area encompassed a 750m radius centred on NGR SU 75830 75724. The results are discussed in chronological order.

Seventeen Lower Palaeolithic handaxes (HER No. MWK8819) of no exact provenance have been found in Sonning. A mace head of Lower Palaeolithic to Late Neolithic date was found at The Grove, Sonning (HER MWK8859; NGR 75710 75370).

A possible flint scatter of Early Mesolithic to Late Bronze Age date comprising 19 struck flints was found at Land at St Andrew's Church during an evaluation (HER MRM17502; SU 76136 75528). A Mesolithic tranche axe has been found in Sonning (HER MWK8844).

A Neolithic cursus (HER MWK1433; NGR SU 76500 75934) is a scheduled monument (Monument No. 1006962). A double ditched linear feature (HER MWK1436) that cuts the cursus is also within the scheduling. A Late Neolithic to Early Bronze Age mace head of fine-grained rock (MWK8831) has been dredged from the river Thames along with a Neolithic axe (MWK8856) and a Neolithic mace butt (MWK8857). Again from the river Thames has come a stone wrist guard of Late Neolithic to Early Bronze Age date (MWK8862)

A Bronze Age knife (MWK 8836) has come from the river Thames. Two Bronze Age spearheads (MWK8860) have been recovered from the river Thames.

Two Iron Age spearheads, the first of 6th or 7th century date (MWK8829 & 8830) have been dredged from the river Thames. An Iron Age ditch (MRM17500; SU 75535 75530) was discovered during an evaluation at Land at St Andrew's Church.

Prehistoric flints were recovered from a watching brief at the Blue Coats School (MWK10652; SU 75450 75200). Cropmarks are known of a rectangular enclosure, single circle bank, anvil track and single small circle in Straightanger Field (MWK1433; SU 76526 76000). Prehistoric pottery and struck flints were found redeposited in later features at Bishops Close (MRM 16485 SU 7544 7540).

A Romano British key has been recovered from the river Thames (MWK8868) while a Roman 1st century sestertius has been found in Sonning. Two residual sherds of Roman pottery were found in later features at Greendown, Pearson Lane ((MRM16772; SU7595 7538).

Saxon remains include at least 30 inhumations (MRM15998; SU75673 755111) at the Bull Public House along with a ditch and chalk surface (MRM16236). A minster church dating from AD901 (MRM16242) is known from documentary records and its location may be beneath St Andrew's church. A brooch of late 5th to early 6th century date (MWK8870) again has been recovered from the Thames as have two spearheads (MWK12017 & 12018). A Late Saxon/early medieval ditch has been found at St Andrew's Vicarage (MWK15505; SU 75549 75589).

The earliest recorded form of the place-name was written down in 1086 as Soninges (Gelling 1973, i.132). The name was, however, recorded as an earlier district name in about 675 where the monastery of Chertsey refers to the Sunningas. The name is a folk-name. It is often the case that early church sites and their accompanying settlements, such as that of Sonning share their name with folk-groups. In 1086 Sonning was held by Osmund, Bishop of Salisbury (Morgan 1979, 3.1). Before 1066 it contained 60 hides but in 1086 it had 24. The settlement had 40 villagers and 16 smallholders, 10 slaves, 2 mills, fisheries, meadow and woodland for 300 pigs.

The main manor of Sonning remained with the Bishops of Salisbury until 1574 when Bishop Edmund exchanged the estate with the queen for one in Wiltshire (VCH 1923, 210-225). The church must have originally been attached to the manor as in the reign of Henry II a hide of land within the manor was called 'the hide of Ailmar the Priest'. The Rectory Manor was later established and was vested in the Dean of Salisbury Cathedral.

The church of Sonning (MWK1278) is mentioned in the foundation grant of Salisbury Cathedral in 1091 (VCH 1923, 210-225). The church is further mentioned in the confirmation charter of 1146 by Pope Eugenius. There is some speculation that Sonning was the site of a bishopric, however, this is not confirmed and presumably relies on the fact that the church and manor were held by the bishop of Salisbury. Information provided in 1220 that Sonning had a perpetual vicar with altar offerings, mortuaries, along with tithes of wool and cheese, along with the chapels of Arborfield, Earley, Hurst, Ruscombe, Sandhurst and Wokingham; indicate that the church was a minster.

A plan of the residence of the Bishops of Salisbury was produced from excavations in 1912-14 (MWK1279; SU 75427 75513).

Medieval activity of 10th to 14th century date is known from St Andrew's Vicarage in the form of pits, postholes and linear features (MWK15504; SU 75549 75589) while medieval gullies have been found at Old Walls, Sonning Lane (MRM15948; SU 75444 75404). A medieval scabbard chape has been recovered by metal detecting in the village. A pit has been found at Greendown, Pearson Road (MRM 16474; SU 7592 7542) while medieval activity was uncovered at The Bull Public House (MRM16237 & 16238; SU 75673 75511) and at Bishops Close MRM16488; SU 7541 7541).

Undated remains within the village are known from cropmarks and archaeological investigations. These include features (some may be graves) found during geophysical survey near St Andrew's Church (MRM16456; SU 7552 7554), an undated ditch and chalk wall at Bishops Close (MWK15510; SU 75444 75404) and cropmark features at University Farm House (MWK1451; SU 76400 75700) although these are thought to be dubious.

Post-medieval remains and standing buildings are known within the village.

2 AIMS OF THE INVESTIGATION

The aims of the investigation as laid out in the Written Scheme of Investigation were as follows:

- To make a record of any significant remains revealed during the course of any operations that may disturb or destroy archaeological remains.

In particular to make a record of remains relating to the known prehistoric landscape, any Roman activity in the area, and the known medieval and post-medieval village.

3 STRATEGY

3.1 Research Design

John Moore Heritage Services carried out the work to a Written Scheme of Investigation agreed with Berkshire Archaeology, the archaeological advisors to Wokingham District Council.

The recording was carried out in accordance with the standards specified by the Chartered Institute for Archaeologists (2014).

3.2 Methodology

The area of impact, from demolition of the original building on the site and construction works for the new dwelling, was monitored for archaeological horizons but none were encountered. Standard John Moore Heritage Services techniques were employed throughout, involving the completion of a written record for each deposit encountered, with scale plans and section drawings compiled where appropriate. A photographic record was also produced.

The resultant spoil from the works was visually scanned, especially for finds relating to the Prehistoric, Roman, Medieval and Post-Medieval periods.

4 RESULTS (Figure 2. Plates 1 and 2)

All deposits and features were assigned individual context numbers. Context numbers without brackets indicate features i.e. pit cuts, numbers in () show feature fills or deposits of material, while numbers in bold indicate structural features.

A series of footing trenches (Figure 2; Plate 1) were observed, alongside the reduction of the whole basement area (Plate 2) down to the natural horizon. This took place over a period of roughly six months, during which no archaeology was identified.

The lowest deposit encountered was the natural chalk (08). Overlying this was (04)=(10); these comprised deposits varying from soft, to slightly more compact, mid to light orange-brown silty sand measuring 0.42m in thickness. These were considered to be Head deposits, some possibly disturbed by ancient colluvial activity.

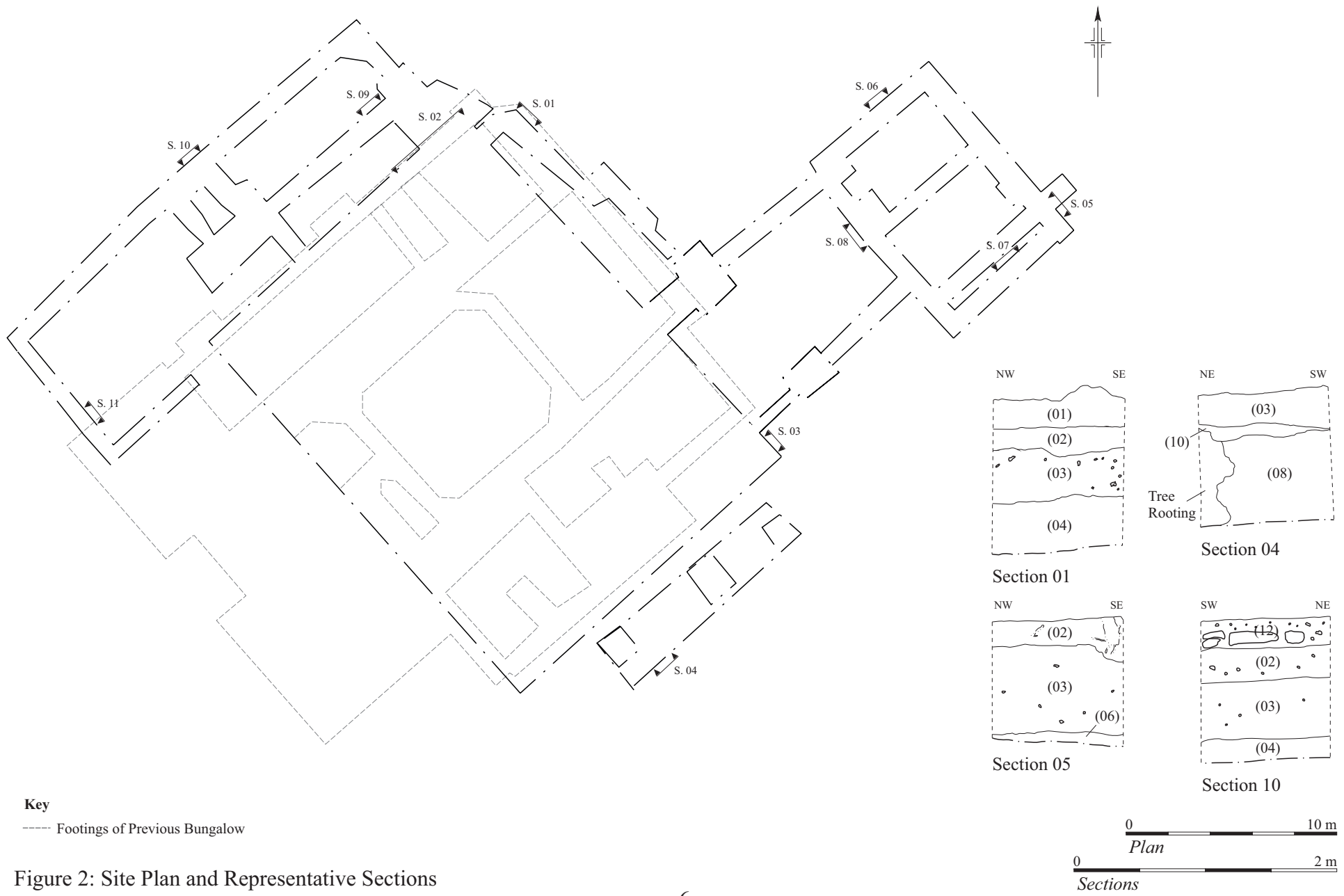

Key
----- Footings of Previous Bungalow

Figure 2: Site Plan and Representative Sections

Figure 2. Site Plan and Representative Sections



Plate 1: North-East Area of Footings, Looking North.



Plate 2: Central Basement Area Stripped Down To Natural Horizon.

Stratified above this was a natural deposit (07) of compact to firm, mid brown-orange sandy clay. It contained frequent small stone inclusions, and measured 0.50m in thickness. Ice wedges were visible in it.

Overlying this was a more recent Head (gravel) deposit (06). This consisted of soft to loose, mid brown orange, silty-sand gravel, and measured 0.44m in thickness.

A colluvial deposit (03), was seen to be above (06). This was similar to deposit (04)=(10), made up of a soft mid orange-brown, silty sand. This deposit measured 0.42m in thickness.

A buried garden soil (02), was stratified above deposit (03). This comprised of a mid-grey-brown sandy silt, and was seen to contain frequent inclusions of sub-rounded medium-sized stones. This deposit was measured to be 0.20m in thickness. No finds were associated with this deposit.

Overlying this was a series of modern deposits, associated with the recently demolished bungalow which, up until recently, previously occupied the site. Deposit (05) was the earliest of these modern deposits, being a made-ground/levelling deposit. Above this was another layer of made-ground (01), which lay directly beneath the concrete slab of the bungalow.

The final three most recent deposits (09)=(12) (11), comprised a series of demolition material and backfilled chalk deposit, associated with the demolition of the bungalow.

4.2 Reliability of Results

The reliability of the results is considered to be good, as archaeological observation took place in generally good conditions throughout the course of the fieldwork.

5 FINDS

No archaeological material was found during the course of the watching brief.

6 DISCUSSION

The watching brief did not identify any evidence of archaeological activity at the site. What was observed was a series of natural deposits, demonstrating the geological processes which formed the landscape. The variety of sand, silt, gravel and chalk deposits, are in keeping with a Head geology and associated processes of glacial erosion. Overlying this was a garden soil deposit, indicating that the site was an open area.

7 ARCHIVE

Archive Contents

The archive consists of the following:

Paper record

Written scheme of investigation

The project report

The primary site record

The archive currently is maintained by John Moore Heritage Services until further notice.

8 BIBLIOGRAPHY

Chartered Institute for Archaeologists, 2014 *Standard and Guidance for Archaeological Watching Briefs*

JMHS, 2017, 173537 – *The Atrium, Thames Street, Sonning-On-Thames, Wokingham RG46UR. Archaeological Watching Brief. Written Scheme of Investigation.*
Unpublished

APPENDIX 1: OASIS REPORT FORM

OASIS DATA COLLECTION FORM: England

[List of Projects](#) | [Manage Projects](#) | [Search Projects](#) | [New project](#) | [Change your details](#) | [HER coverage](#) | [Change country](#) | [Log out](#)

Printable version

OASIS ID: johnmoor1-339504

Project details

Project name	The Atrium, Thames Street
Short description of the project	John Moore Heritage Services undertook a watching brief at The Atrium, Thames Street, Sonning-on-Thames, from the 12th June to the 27th November 2018. The watching brief did not identify any evidence of archaeological activity on the site. What was observed was a series of natural deposits, demonstrating the geological processes which formed the landscape. The variety of sand, silt, gravel and chalk deposits, are in keeping with a Head geology and associated processes of glacial erosion.
Project dates	Start: 12-06-2018 End: 27-11-2018
Previous/future work	Not known / Not known
Any associated project reference codes	3856 - Contracting Unit No.
Any associated project reference codes	SOTS17 - Sitecode
Type of project	Recording project
Site status	None
Current Land use	Residential 1 - General Residential
Monument type	NONE None
Significant Finds	NONE None
Investigation type	""Watching Brief""
Prompt	National Planning Policy Framework - NPPF

Project location

Country	England
Site location	BERKSHIRE WOKINGHAM SONNING The Atrium, Thames Street, Sonning-On-Thames
Postcode	RG46UR
Study area	1019 Square metres
Site coordinates	SU 75830 75724 51.474901418172 -0.908029165508 51 28 29 N 000 54 28 W Point
Height OD / Depth	Min: 0.25m Max: 0.8m

Project creators

Name of Organisation	John Moore Heritage Services
Project brief originator	Berkshire Archaeology
Project design originator	JMHS
Project director/manager	John Moore
Project supervisor	Alessandro Guaggenti
Type of sponsor/funding body	client
Name of sponsor/funding body	Anderson Orr Architects

Project archives

Physical Archive Exists?	No
Digital Archive recipient	John Moore Heritage Services
Digital Archive ID	3856
Digital Contents	"Stratigraphic","other"
Digital Media available	"Images raster / digital photography","Images vector","Text"
Digital Archive notes	Primary records available as appendix to report
Paper Archive Exists?	No

Project bibliography 1

Publication type	Grey literature (unpublished document/manuscript)
Title	An Arcaheological Evaluation at the Atrium, Thames Street, Sonning-On-Thames. SOTS17
Author(s)/Editor(s)	Guaggenti, A
Author(s)/Editor(s)	Moore, J
Other bibliographic details	JMHS Report Number 3856
Date	2019
Issuer or publisher	JMHS
Place of issue or publication	Wheatley
Description	pdf report including primary records as appendix
Entered by	Simona Denis (admin@jmheritageservices)
Entered on	3 December 2019

APPENDIX 2. PRIMARY RECORDS

Site Name: The Annex, Joining-on-Thames Site Code: SOTS17

Context No.	Type	Relationships	Dug	Drawn		Levels	Comments
				Section	Plan		
(01)	DEPOSIT	OL UL	AG	S.01 S.02			MADE GROUND
(02)	"	OL UL	AG	S.01 S.02			B-horizon
(03)	"	OL UL	AG	S.01 S.02			Colluvium?
(04)	"	OL UL	AG	S.01 S.02			Colluvium?
(05)	"	OL UL	AG	S.02			MADE GROUND - LEVELING
(06)	"	OL UL	AG	S.02			B-Horizon
(07)	"	OL UL	AG	S.02			fill of Tree Rooting.
(08)	"	OL UL	AG	S.02			NATURAL CHALK OVERGROPS.
(09)	"	OL UL	AG	S.03			DEMOLITION MATERIAL
(10)	"	OL UL	AG	S.04			SANDY NATURAL DEPOSIT.
(11)	"	OL UL	SND	S.09			Chalky surface recent levelling
(12)	"	OL UL	SND	S.10			Demolition Layer

Grid Squares	Area/Trench NORTH CORNER OF PREVIOUS FOOTINGS.	Context Type DEPOSIT	Site Code SOTS17	Context (01)
--------------	--	-------------------------	---------------------	-----------------

Add. Sheets	Plan Nos.	Section Nos. S.01 ; S.02	Matrix Location
-------------	-----------	-----------------------------	-----------------

Photographs Slide B&W Film 1
DIGITAL #

DEPOSIT

1 Compaction	2 Colour
3 Composition	4 Inclusions
5 Thickness	6 Extent
7 Comments	
8 Method and Conditions	

Description

- 1) HARD.
- 2) MID YELLOW GREY
- 3) SANDY GRAVEL.
- 4) STONES - FREQUENT; RUBBLE - FREQUENT.
- 5) 0.32m thick
- 6)
- 7) /
- 8) Machine.

CUT

1 Shape in plan	2 Corners
3 Dimensions/Depth	
4 Break of slope-top	5 Sides
6 Break of slope-base	7 Base
8 Orientation	
9 Inclination of axis	
10 Truncation	11 Fill Nos.
12 Sketch profile	
13 Other comments	

Stratigraphic matrix

<input type="checkbox"/>	<input type="checkbox"/>	<input checked="" type="checkbox"/>	<input type="checkbox"/>	<input type="checkbox"/>
This context is		(01)		
<input type="checkbox"/>	<input type="checkbox"/>	(02)	(05)	<input type="checkbox"/>

Initials & Date
A.G
19.6.18

Checked by & Date

Interpretation: Internal External Structural Other (specify)

Discussion Made ground below concrete floor slab.

Context same as: Finds

Levels on plan sheet
Highest Lowest

none pot bone glass metal CBM wood leather burntmat.

 Other finds (specify)

Environmental Samples Nos.

Finds sample (BM) Nos.

Small finds Nos.
 Finds sieving: on-site off-site metal detecting: in situ on-site off-site

Checked Interpretation

Provisional Period Group Initials & Date

Grid Squares	Area/Trench NORTH CORNER OF PREVIOUS FOOTINGS	Context Type DEPOSIT.	Site Code SOTS 17.	Context (02)
--------------	--	--------------------------	-----------------------	-----------------

Add. Sheets /	Plan Nos.	Section Nos. S.01 ; S.02.	Matrix Location
------------------	-----------	------------------------------	-----------------

Photographs Slide DIGITAL:	B&W FILM 1 #	DEPOSIT 1 Compaction 3 Composition 5 Thickness 7 Comments 8 Method and Conditions	2 Colour 4 Inclusions 6 Extent
-------------------------------	-----------------	--	--------------------------------------

Description #

- 1) firm.
- 2) MUD GREY BROWN.
- 3) SANDY SILT.
- 4) SUBROUNDED STONES - MEDIUM - FREQUENT.
- 5) 0.2m thick.
- 6)
- 7)
- 8) Machine.

CUT

1 Shape in plan	2 Corners
3 Dimensions/Depth	5 Sides
4 Break of slope-top	7 Base
6 Break of slope-base	11 Fill Nos.
8 Orientation	
9 Inclination of axis	
10 Truncation	
12 Sketch profile	
13 Other comments	

Stratigraphic matrix

<input type="checkbox"/>	<input type="checkbox"/>	(01)	(05)	<input type="checkbox"/>
This context is		(02)		
<input type="checkbox"/>	<input type="checkbox"/>	(03)	<input type="checkbox"/>	<input type="checkbox"/>

Initials & Date
A.G
19.6.18

Checked by & Date

Interpretation: Internal External Structural Other (specify)

Discussion BURIED SUBSOIL? B-HORIZON - Buried garden soil.

Context same as:	Finds																		
Levels on plan <input type="checkbox"/> sheet Highest Lowest	<table border="0"> <tr> <td>none</td> <td>pot</td> <td>bone</td> <td>glass</td> <td>metal</td> <td>CBM</td> <td>wood</td> <td>leather</td> <td>burntmat.</td> </tr> <tr> <td><input checked="" type="checkbox"/></td> <td><input type="checkbox"/></td> <td><input type="checkbox"/></td> <td><input type="checkbox"/></td> <td><input type="checkbox"/></td> <td><input type="checkbox"/></td> <td><input type="checkbox"/></td> <td><input type="checkbox"/></td> <td><input type="checkbox"/></td> </tr> </table> Other finds (specify)	none	pot	bone	glass	metal	CBM	wood	leather	burntmat.	<input checked="" type="checkbox"/>	<input type="checkbox"/>	<input type="checkbox"/>	<input type="checkbox"/>	<input type="checkbox"/>	<input type="checkbox"/>	<input type="checkbox"/>	<input type="checkbox"/>	<input type="checkbox"/>
none	pot	bone	glass	metal	CBM	wood	leather	burntmat.											
<input checked="" type="checkbox"/>	<input type="checkbox"/>	<input type="checkbox"/>	<input type="checkbox"/>	<input type="checkbox"/>	<input type="checkbox"/>	<input type="checkbox"/>	<input type="checkbox"/>	<input type="checkbox"/>											

Environmental Samples Nos. Finds sample (BM) Nos.

Small finds Nos.
Finds sieving: on-site off-site metal detecting: in situ on-site off-site

Checked Interpretation

Provisional Period Group Initials & Date

Grid Squares /	Area/Trench NORTH COLLAGE OF PREVIOUS FOOTINGS	Context Type DEPOSIT.	Site Code SOTSIF.	Context (03)
-------------------	--	--------------------------	----------------------	-----------------

Add. Sheets /	Plan Nos.	Section Nos. S.01 ; S.02	Matrix Location
------------------	-----------	-----------------------------	-----------------

Photographs Slide B&W FILM 1
DIGITAL: #

DEPOSIT

1 Compaction	2 Colour
3 Composition	4 Inclusions
5 Thickness	6 Extent
7 Comments	
8 Method and Conditions	

Description

- 1) SOFT.
- 2) MID ORANGE BROWN.
- 3) SILTY SAND.
- 4) STONES - INFREQUENT/MODERATE-MEDIUM/SMALL - ^{30/35} ROUNDED
- 5) 0.42m thickness.
- 6)
- 7) /
- 8) MACHINE.

CUT

1 Shape in plan	2 Corners
3 Dimensions/Depth	
4 Break of slope-top	5 Sides
6 Break of slope-base	7 Base
8 Orientation	
9 Inclination of axis	
10 Truncation	11 Fill Nos.
12 Sketch profile	
13 Other comments	

Stratigraphic matrix

<input type="checkbox"/>	<input type="checkbox"/>	(02)	<input type="checkbox"/>	<input type="checkbox"/>
This context is		(03)		
<input type="checkbox"/>	<input type="checkbox"/>	(04)	<input type="checkbox"/>	<input type="checkbox"/>

Initials & Date
A.G

Checked by & Date

Interpretation: Internal External Structural Other (specify)

Discussion ~~subsoil~~ COLLUVIUM?

Context same as:	Finds																		
Levels on plan <input type="checkbox"/> sheet Highest Lowest	<table border="0"> <tr> <td>none</td> <td>pot</td> <td>bone</td> <td>glass</td> <td>metal</td> <td>CBM</td> <td>wood</td> <td>leather</td> <td>burntmat.</td> </tr> <tr> <td><input checked="" type="checkbox"/></td> <td><input type="checkbox"/></td> <td><input type="checkbox"/></td> <td><input type="checkbox"/></td> <td><input type="checkbox"/></td> <td><input type="checkbox"/></td> <td><input type="checkbox"/></td> <td><input type="checkbox"/></td> <td><input type="checkbox"/></td> </tr> </table> Other finds (specify)	none	pot	bone	glass	metal	CBM	wood	leather	burntmat.	<input checked="" type="checkbox"/>	<input type="checkbox"/>	<input type="checkbox"/>	<input type="checkbox"/>	<input type="checkbox"/>	<input type="checkbox"/>	<input type="checkbox"/>	<input type="checkbox"/>	<input type="checkbox"/>
none	pot	bone	glass	metal	CBM	wood	leather	burntmat.											
<input checked="" type="checkbox"/>	<input type="checkbox"/>	<input type="checkbox"/>	<input type="checkbox"/>	<input type="checkbox"/>	<input type="checkbox"/>	<input type="checkbox"/>	<input type="checkbox"/>	<input type="checkbox"/>											

Environmental Samples Nos. Finds sample (BM) Nos.

Small finds Nos.
Finds sieving: on-site off-site metal detecting: in situ on-site off-site

Checked Interpretation

Provisional Period Group Initials & Date

Grid Squares <u> </u>	Area/Trench <i>NORTH CORNER OF PREVIOUS FOOTINGS</i>	Context Type DEPOSIT	Site Code SOTS17.	Context (04)
----------------------------	---	--------------------------------	-----------------------------	------------------------

Add. Sheets <u> </u>	Plan Nos.	Section Nos. S.01 ; 8-02	Matrix Location
---------------------------	-----------	------------------------------------	-----------------

Photographs Slide B&W FILM 1
DIGITAL: #

DEPOSIT

1 Compaction	2 Colour
3 Composition	4 Inclusions
5 Thickness	6 Extent
7 Comments	
8 Method and Conditions	

Description

- 1) SOFT.
- 2) MID-LIGHT ORANGE BROWN.
- 3) SILTY SAND.
- 4)
- 5) 0.42m bluish
- 6)
- 7)
- 8) MACHINE.

CUT

1 Shape in plan	2 Corners
3 Dimensions/Depth	
4 Break of slope-top	5 Sides
6 Break of slope-base	7 Base
8 Orientation	
9 Inclination of axis	
10 Truncation	11 Fill Nos.
12 Sketch profile	
13 Other comments	

Stratigraphic matrix

<input type="checkbox"/>	<input type="checkbox"/>	<input type="checkbox" value="(03)"/>	<input type="checkbox" value="(04)"/>	<input type="checkbox"/>
This context is		<input type="checkbox" value="(04)"/>		
<input type="checkbox"/>	<input type="checkbox"/>	<input type="checkbox" value="(08)"/>	<input type="checkbox"/>	<input type="checkbox"/>

Initials & Date
AG -
19-6-18 -

Checked by & Date

Interpretation: Internal External Structural Other (specify)

Discussion COLUMNAR DEPOSIT?

Context same as:

Finds

Levels on plan sheet
Highest Lowest

none pot bone glass metal CBM wood leather burntmat.
Other finds (specify)

Environmental Samples Nos.

Finds sample (BM) Nos.

Small finds Nos.
Finds sieving: on-site off-site metal detecting: in situ on-site off-site

Checked Interpretation

Provisional Period Group Initials & Date

Grid Squares /	Area/Trench NORTH CORNER OF PREVIOUS FOOTINGS	Context Type DEPOSIT	Site Code SOTS 17.	Context (05)
---	--	--------------------------------	------------------------------	------------------------

Add. Sheets /	Plan Nos.	Section Nos. 8000 ; S-02.	Matrix Location
--	-----------	-------------------------------------	-----------------

Photographs Slide B&W FILM 1
 DIGITAL: #

DEPOSIT

1 Compaction	2 Colour
3 Composition	4 Inclusions
5 Thickness	6 Extent
7 Comments	
8 Method and Conditions	

Description

- 1) FIRM.
- 2) ~~SANDY GRAVEL~~. LIGHT GREY YELLOW
- 3) SANDY GRAVEL.
- 4) STONES SMALL.
- 5) 0.06m thick.
- 6) >1m x >3.5m
- 7) -
- 8) Machine.

CUT

1 Shape in plan	2 Corners
3 Dimensions/Depth	
4 Break of slope-top	5 Sides
6 Break of slope-base	7 Base
8 Orientation	
9 Inclination of axis	
10 Truncation	11 Fill Nos.
12 Sketch profile	
13 Other comments	

Stratigraphic matrix

<input type="text"/>	<input type="text"/>	(01)	<input type="text"/>	<input type="text"/>
This context is		(05)		
<input type="text"/>	<input type="text"/>	(02)	<input type="text"/>	<input type="text"/>

Initials & Date
 AG
 19.6.18.

Checked by & Date

Interpretation: Internal External Structural Other (specify)

Discussion made ground - leveling deposit

Context same as: Finds

Levels on plan sheet
 Highest Lowest

none pot bone glass metal CBM wood leather burntmat.

Other finds (specify)

Environmental Samples Nos.

Finds sample (BM) Nos.

Small finds Nos.
 Finds sieving: on-site off-site metal detecting: in situ on-site off-site

Checked Interpretation

Provisional Period Group Initials & Date

Grid Squares /	Area/Trench NORTH CORNER OF PREVIOUS FOOTINGS	Context Type DEPOSIT	Site Code SOTSIF	Context (06)
-------------------	---	-------------------------	---------------------	-----------------

Add. Sheets /	Plan Nos.	Section Nos. S.02 S.03	Matrix Location
------------------	-----------	---------------------------	-----------------

Photographs Slide B&W FILM 1
DIGITAL: #

DEPOSIT

1 Compaction	2 Colour
3 Composition	4 Inclusions
5 Thickness	6 Extent
7 Comments	
8 Method and Conditions	

Description

- 1) SOFT - LOOSE.
- 2) MID BROWN ORANGE.
- 3) SILTY SAND - (gravelly).
- 4) stones - small - medium - frequent.
- 5) 0.44m
- 6) >1m x >1.82m
- 7) -
- 8) MACHINE.

CUT

1 Shape in plan	2 Corners
3 Dimensions/Depth	
4 Break of slope-top	5 Sides
6 Break of slope-base	7 Base
8 Orientation	
9 Inclination of axis	
10 Truncation	11 Fill Nos.
12 Sketch profile	
13 Other comments	

Stratigraphic matrix

<input type="checkbox"/>	<input type="checkbox"/>	(03)	<input type="checkbox"/>	<input type="checkbox"/>
This context is		(06)		
<input type="checkbox"/>	(07)	(08)	<input type="checkbox"/>	<input type="checkbox"/>

Initials & Date
AG
19.6.18

Checked by & Date

Interpretation: Internal External Structural Other (specify)

Discussion ^{NATURAL GRAVELS} Similar to deposit (04), however with frequent stone inclusions as opposed to (04). This may be a deposit accumulated upland of the rooting seen in S.02. Also very similar to fill (07) - fill (07) excluded as a majority of clay in its composition however. Seen to drop away across the site to the NW towards river - overlying chalk outcrops.

Context same as: Finds

Levels on plan sheet
Highest Lowest

none pot bone glass metal CBM wood leather burntmat.

Environmental Samples Nos. Finds sample (BM) Nos.

Small finds Nos. Finds sieving: on-site off-site metal detecting: in situ on-site off-site

Checked Interpretation

Provisional Period Group Initials & Date

Grid Squares —	Area/Trench NORTH AREA OF PREVIOUS FOOTINGS	Context Type DEPOSIT.	Site Code SOTS17.	Context (07)
-------------------	---	--------------------------	----------------------	-----------------

Add. Sheets /	Plan Nos.	Section Nos. S.02.	Matrix Location /
------------------	-----------	-----------------------	----------------------

Photographs Slide B&W FILM #
DIGITAL:

DEPOSIT

1 Compaction	2 Colour
3 Composition	4 Inclusions
5 Thickness	6 Extent
7 Comments	
8 Method and Conditions	

Description

- 1) COMPACT - FIRM.
- 2) ~~RED~~ MID BROWN BRNNGE.
- 3) SANDY CLAY.
- 4) STONES - SMALL - FREQUENT.
- 5) 0.5m
- 6) >1m x 2.07m.
- 7) —
- 8) MACHINE.

CUT

1 Shape in plan	2 Corners
3 Dimensions/Depth	
4 Break of slope-top	5 Sides
6 Break of slope-base	7 Base
8 Orientation	
9 Inclination of axis	
10 Truncation	11 Fill Nos.
12 Sketch profile	
13 Other comments	

Stratigraphic matrix

<input type="checkbox"/>	<input type="checkbox"/>	(06)	<input type="checkbox"/>	<input type="checkbox"/>
This context is		(07)		
<input type="checkbox"/>	<input type="checkbox"/>	(08)	(04)	<input type="checkbox"/>

Initials & Date
AG
19.6.18.

Checked by & Date

Interpretation: Internal External Structural Other (specify)

Discussion Seen in section of previous footing trench for the lounge. Is a homogenous fill seen sitting in what seems to be ~~ice wedges/erosion~~ and underlying a mound of natural (08), ~~which suggests that it is the base former location of a tree.~~

Context same as:

Levels on plan <input type="checkbox"/> sheet	Findings
Highest Lowest	none <input checked="" type="checkbox"/> pot <input type="checkbox"/> bone <input type="checkbox"/> glass <input type="checkbox"/> metal <input type="checkbox"/> CBM <input type="checkbox"/> wood <input type="checkbox"/> leather <input type="checkbox"/> burntmat. <input type="checkbox"/>
	Other finds (specify)

Environmental Samples Nos. Finds sample (BM) Nos.

Small finds Nos. Finds sieving: on-site off-site metal detecting: in situ on-site off-site

Checked Interpretation

Provisional Period Group Initials & Date

Grid Squares /	Area/Trench	Context Type DEMOLITION LAYER	Site Code SOTS17	Context (09)
-------------------	-------------	---	----------------------------	------------------------

Add. Sheets /	Plan Nos. /	Section Nos. S.03	Matrix Location
------------------	----------------	-----------------------------	-----------------

Photographs Slide **DIGITAL** B&W **film** #

DEPOSIT

1 Compaction	2 Colour
3 Composition	4 Inclusions
5 Thickness	6 Extent
7 Comments	
8 Method and Conditions	

Description

- 1) ~~loose~~ loose.
- 2) Mid grey brown.
- 3) Rubble in silty loam.
- 4) Rubble.
- 5)
- 6)
- 7) -
- 8) Marlstone.

CUT

1 Shape in plan	2 Corners
3 Dimensions/Depth	
4 Break of slope-top	5 Sides
6 Break of slope-base	7 Base
8 Orientation	
9 Inclination of axis	
10 Truncation	11 Fill Nos.
12 Sketch profile	
13 Other comments	

Stratigraphic matrix

<input type="checkbox"/>	<input type="checkbox"/>	<input checked="" type="checkbox"/>	<input type="checkbox"/>	<input type="checkbox"/>
This context is		(09)		
<input type="checkbox"/>	<input type="checkbox"/>	(06)	<input type="checkbox"/>	<input type="checkbox"/>

Initials & Date
AG

Checked by & Date

Interpretation: Internal External Structural Other (specify)

Discussion Modern demolition material

Context same as:

Levels on plan	<input type="checkbox"/>	sheet
Highest		Lowest

Finds

none	pot	bone	glass	metal	CBM	wood	leather	burntmat.
<input type="checkbox"/>	<input type="checkbox"/>	<input type="checkbox"/>	<input type="checkbox"/>	<input type="checkbox"/>	<input type="checkbox"/>	<input type="checkbox"/>	<input type="checkbox"/>	<input type="checkbox"/>

Other finds (specify)

Environmental Samples Nos.

Finds sample (BM) Nos.

Small finds Nos.
Finds sieving: on-site off-site metal detecting: in situ on-site off-site

Checked Interpretation

Provisional Period

Group

Initials & Date

Grid Squares /	Area/Trench <i>Eastern Footing.</i>	Context Type <i>DEPOSIT</i> BRICK	Site Code <i>SOTS17.</i>	Context <i>(10)</i>
-------------------	--	--	-----------------------------	------------------------

Add. Sheets /	Plan Nos. /	Section Nos. <i>S.04.</i>	Matrix Location
------------------	----------------	------------------------------	-----------------

Photographs Slide B&W *FILM*
DIGITAL: #

DEPOSIT

1 Compaction	2 Colour
3 Composition	4 Inclusions
5 Thickness	6 Extent
7 Comments	
8 Method and Conditions	

Description

- 1) *slightly compact.*
- 2) *mid brown yellow.*
- 3) *silty sand.*
- 4) *-*
- 5) *-*
- 6) *-*
- 7) *-*
- 8) *Marlstone.*

CUT

1 Shape in plan	2 Corners
3 Dimensions/Depth	
4 Break of slope-top	5 Sides
6 Break of slope-base	7 Base
8 Orientation	
9 Inclination of axis	
10 Truncation	11 Fill Nos.
12 Sketch profile	
13 Other comments	

Stratigraphic matrix

--	--	--	--	--

This context is *(10)*

--	--	--	--	--

Initials & Date
A.G.
13/11/18.

Checked by & Date

Interpretation: Internal External Structural Other (specify)

Discussion *Sandy deposit between gravels and lower chalk.*
Natural. Associated with geology of valley.

Context same as:	Finds																		
Levels on plan <input type="checkbox"/> sheet Highest Lowest	<table border="0"> <tr> <td>none</td> <td>pot</td> <td>bone</td> <td>glass</td> <td>metal</td> <td>CBM</td> <td>wood</td> <td>leather</td> <td>burntmat.</td> </tr> <tr> <td><input type="checkbox"/></td> <td><input type="checkbox"/></td> <td><input type="checkbox"/></td> <td><input type="checkbox"/></td> <td><input type="checkbox"/></td> <td><input type="checkbox"/></td> <td><input type="checkbox"/></td> <td><input type="checkbox"/></td> <td><input type="checkbox"/></td> </tr> </table> Other finds (specify)	none	pot	bone	glass	metal	CBM	wood	leather	burntmat.	<input type="checkbox"/>	<input type="checkbox"/>	<input type="checkbox"/>	<input type="checkbox"/>	<input type="checkbox"/>	<input type="checkbox"/>	<input type="checkbox"/>	<input type="checkbox"/>	<input type="checkbox"/>
none	pot	bone	glass	metal	CBM	wood	leather	burntmat.											
<input type="checkbox"/>	<input type="checkbox"/>	<input type="checkbox"/>	<input type="checkbox"/>	<input type="checkbox"/>	<input type="checkbox"/>	<input type="checkbox"/>	<input type="checkbox"/>	<input type="checkbox"/>											

Environmental Samples Nos. Finds sample (BM) Nos.

Small finds Nos.
 Finds sieving: on-site off-site metal detecting: in situ on-site off-site

Checked Interpretation

Provisional Period	Group	Initials & Date
--------------------	-------	-----------------

SITE: THE ATRIUM, THAMES ST. JOINING ON - THAMES			SITE CODE: SOTS17		SHEET No: 1	
TBM	Backsight	Instrument Height (IH) (TBM+ Backsight)	Level No	Foresight	Reduced Level (IH - Foresight)	Comments/ Context Nos/ Small find Nos/ Plan or Section Nos
43.5m	1.49	44.99m.	1	2.10	42.89m	S.03 TOP.
43.5m	1.49	44.99m	2	2.58m	42.41m	SITE - CENTRE/EAST OF BASEMENT STRIP
43.5m	1.49	44.99m	3	2.80m	42.19m	SITE - CENTRE OF BASEMENT STRIP
43.5m.	1.49	44.99m	4	3.46m.	41.53m.	SITE - CENTRE/WEST OF BASEMENT STRIP.

ON DRAIN SOUTH OF BUILDING ENTRANCE →

SOTS17

S.O.1
REP SCL

N CORNER OF BUNGALOW FOOTINGS

1:20

↑ Hard Ground - hard-sandy gravel and yellow grey

↑ Buried surface? - firm - sandy silt - mid grey brown inclusions - stones - frequent

↑ Silty sand, mid orange brown, soft (coloured deposit?) stones infrequent - moderate

56

↑ silty sand, mid-light orange brown, soft (coloured deposit?) inclusions none

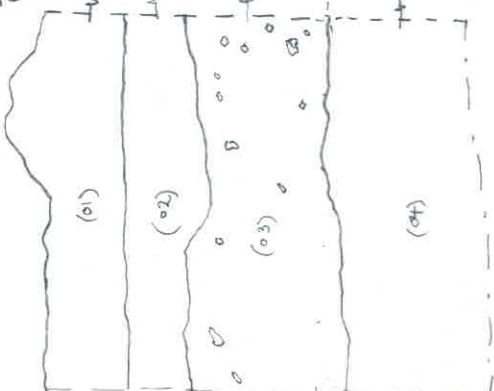

SOTS17

S.O.2

- Rep Sec + Tree Band + Rooting
- N. CORNER OF BUNGALOW FOOTINGS

- 1, 20

- 11.5

- 19.6, 18

NE

SOTS17
S.O.2

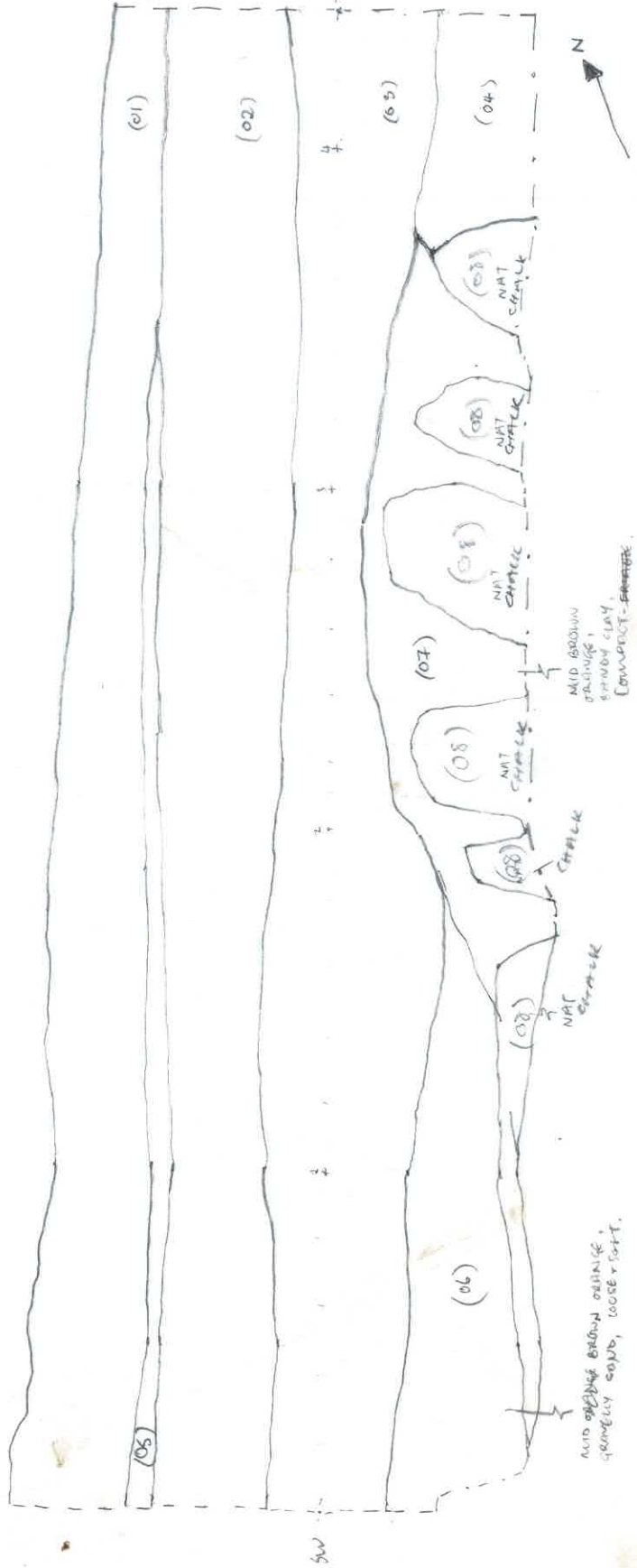

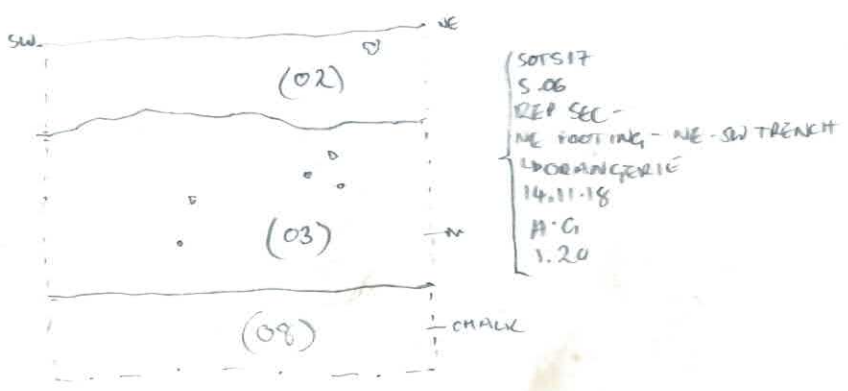
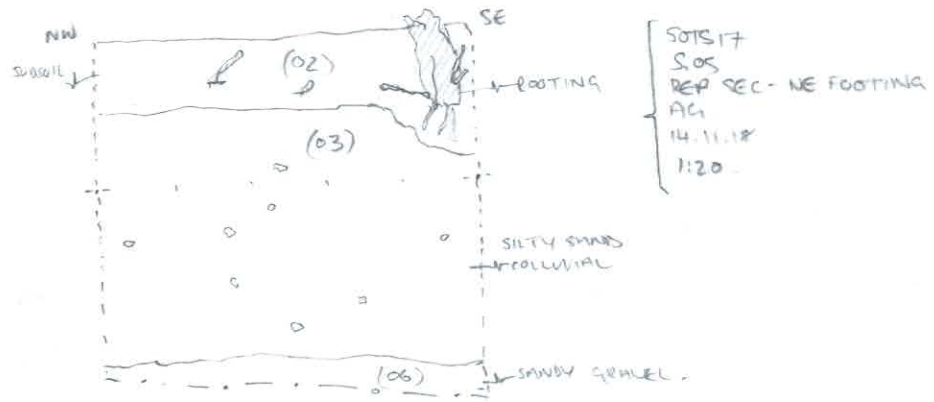
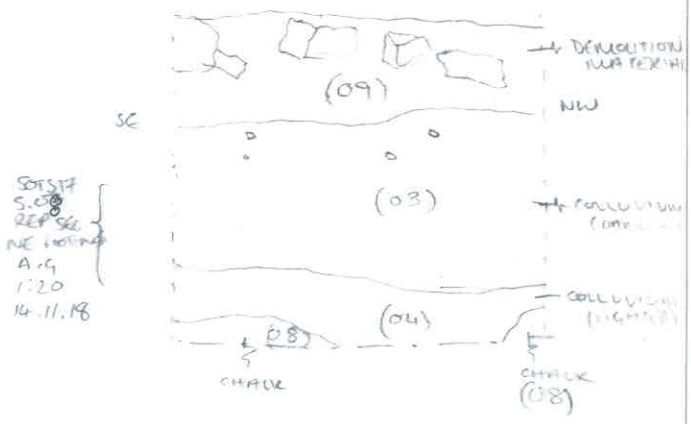
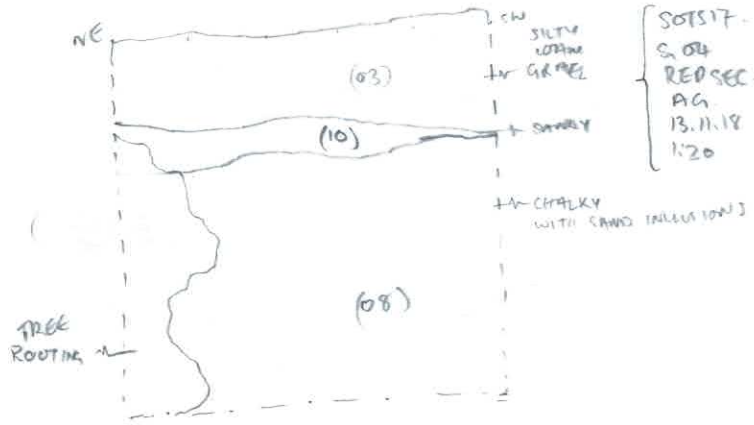
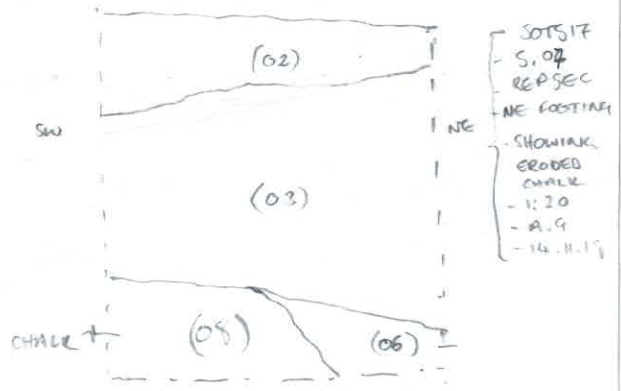
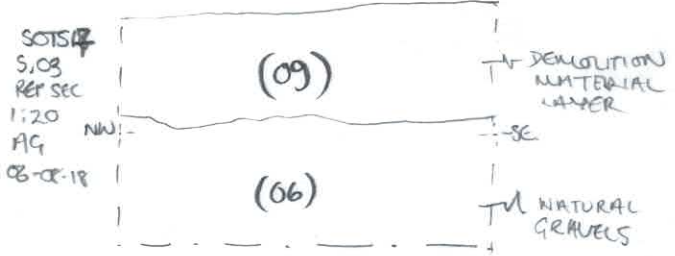

SOTS17 S.10 Rep Sec.
1:20 21/11/18 SNO

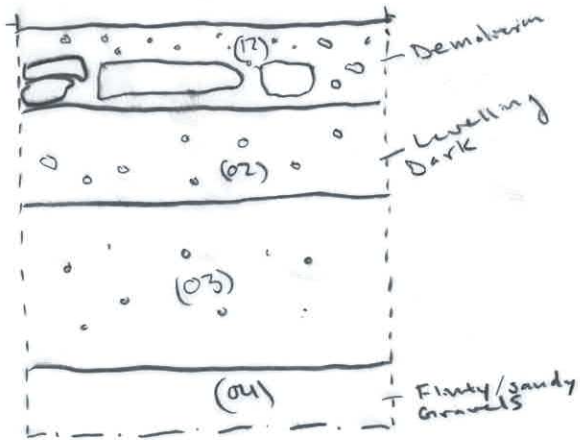

SOTS17 S.09 Rep Sec
1:20 21/11/18 SNO

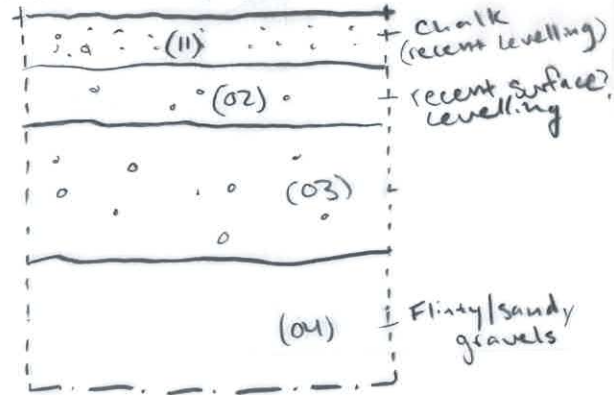

SOTS17 S.11 Rep Sec
1:20 27/11/18 CW

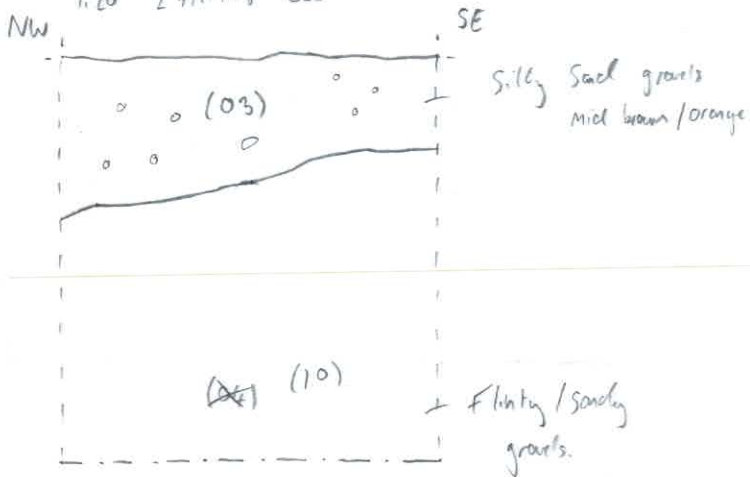

Key - = gravels.

SITE NAME: The Atrium, Souning on Thames | SITE CODE: SOTS 17

Black and white/colour: _____ | Film No: 1

Date	Neg No.	View	Scale(s)	Context/Comment
12/06/18	0	N/A	N/A	ID start
12/06/18	1	N/A	N/A	ID start
12/06/18	2	East	N/A	Site shot
12/06/18	3	North	N/A	Site shot
12/06/18	4	North	N/A	East corner of building
18/06/18	5	SE	1x1m	WORKING SHOT - PREVIOUS TRENCH PULLED TO REMOVE FOOTINGS.
19/06/18	6	NW	1x0.5m 1x1m	TRENCH REMOVING PREVIOUS FOOTINGS WORKING NW TOWARDS N. CORNER.
19/06/18	7	NW NE	1x1m	S.01 REP SEC
19/06/18	8	NE	1x1m; 1x0.5m	TRENCH REMOVING PREVIOUS FOOTINGS LOOKING TOWARDS N. CORNER
19/06/18	9	NW	2x1m; 1x0.5m	S.02 REP SEC + TREE ROOTING.
20/06/18	10	NE	2x1m	Extension of footings removed
20/06/18	11	NE	2x1m	Central Extension of footings removal.
06/08/18	12	NE	1x1m	S.03 Rep sec
	13			
	14			
	15			
	16			
	17			
	18			
	19			
	20			
	21			
	22			
	23			
	24			
	25			
	26			
	27			
	28			
	29			
	30			
	31			
	32			
	33			
	34			
	35			
	36			
	37			

SITE NAME: The Atrium, forming on-Thames SITE CODE: SOTS17

Memory Card No. FUJIFILM XPE0 Sheet 3 of

Date	Image number(s)	View	Scale(s)	Context/Comment	Film Neg No.
12/06/18	DSCF8001	—	—	ID SHOT.	
"	-002	NE ^{SE}	—	SITE SHOT.	
"	-003	ENE	—	" "	
"	-004	ENE	—	" "	
18/06/18	-4051	—	—	ID SHOT.	
	4052	N	—	SITE SHOT.	
	4053	N	—	" "	
	4054	N	—	" "	
	4055	SW	—	" "	
	4056	W	—	" "	
	4057	W	—	Removal of NE footings (earlier)	
	4058	NE	—	SITE SHOT FROM SPOIL HEAP	
	4059	N	—	" " " " "	
	4060	W	—	" " " " "	
	4061	SW	—	" " " " "	
	4062	SSW	—	" " " " "	
	4063	S	—	" " " " "	
	4064	E	—	" " " " "	
	4065	W	2x1m	oblique photo - previous footings (earlier)	
	4066	NE	2x1m	Working shot - previous footings to NE.	
	4067	SW	2x1m	" " - trench of removed previous footings.	
	4068	SW	—	Site shot from north east.	
	4069	SW	—	" " " " "	
	4070	S	—	View site shot - showing spoil & hazards	
	4071	SW	—	" " " " "	
	4072	"	—	" " " " "	
	4073	"	✓	" " " " "	
	4074	"	✓	" " " " "	
	4075	"	—	" " " " "	
	4076	"	—	" " " " "	
	4077	"	—	Working shot - beginning of footing removal	
	4078	W	—	" " " " "	
	4079	W	—	" " " " "	
	4080	SW	—	Section - working shot - footing removal	
	4081	"	—	" " " " "	
19/06/18	4082	NW	1x1m 2x0.5m	Footing Trench - (Removal of earlier footings)	
	4083	NW	"	" " " " "	
	4084	NE	1x1m	8/20/2 Rep Sec. - S.01	

SITE NAME: The Atrium, Joining-on-Thames. SITE CODE: SOTS17.

Memory Card No. FUJIFILM XPG0 Sheet 2 of

Date	Image number(s)	View	Scale(s)	Context/Comment	Film Neg No.
19/06/18	DSCF - 4085	NE	1x1m 1x0.5m	Removal of previous footings-trench-	
↓	-4086	NW	2x1m 1x0.5m	S.02. - Periglacial features ^{cutting} chalk outcrop	
	-4087	"	"	" " " "	
	-4088	N	"	" " " "	
20/06/18	-4089	NE	2x1m.	Removal of previous footings - trench shot	
"	-4090	NE	1x1m	" " " "	
08/08/18	-4106	N	—	Stripping of area of basement - ^{working} shot	
↓	-4107	N	—	" " " "	
	-4108	NE	1x1m.	S.03	
	-4109	N	2x1m.	General shot - Fully stripped area.	
	-4110	N	2x1m	" " " "	
13/11/18	-4312	NE	2x1m	Eastern footing - General shot	
↓	-4313	"	"	" " " "	
	4314	"	"	" " " "	
	4315	SE	1x1m	Rep Sec - E. footing - S.04.	
	4316	"	"	" " " "	
	4318	NW	2x1m	Western area - footing - Gen. shot	
	4315	SW	1x1m	Rep Sec. E footing - S.04.	
	4319	NNW	—	Working shot - NE FOOTINGS - ^{-NW-SE FOOTINGS} - ^{OBSCURE} - WORKING SHOT	
	4320	NNW	—	" " " " " "	
	4321	NE	2x1m	S.05 - REP SEC IN NE FOOTINGS OF ABOVE ^{FOOTINGS}	
	4322	NE	2x1m	" " " " " "	
	4323	NE	1x1m	" " " " " "	
	4324	NE	1x1m	" " " " " "	
	4325	NW	2x1m	NE TRENCH - OBSCURE - NW-SE - WORKING SHOT	
	4326	SW	1x1m	" " " " " "	
4327	NW	1x1m	" " " " " "		
4328	NW	1x1m	" " " " " "		
4329	NW	1x1m	" " " " " "		
4330	NW	1x1m	" " " " " "		
4331	NW	1x1m	" " " " " "		
4332	NW	1x1m	" " " " " "		

SITE NAME: The Atrium, Bonning - On - Thames | SITE CODE: S055 17

Memory Card No. CAM F 2 | Sheet of

Date	Image number(s)	View	Scale(s)	Context/Comment	Film Neg No.
26/11/18	0840	NE	1x1	Working shot, attempted footing bench	/
	0841	"	"	" " "	/
	0842	N	"	" " "	/
	0843	N	"	" " "	/
	0844	N	/	General shot, beginning of ground reduction.	/
	0845	"	/	" " "	/
	0846	NE	/	" " "	/
27/11/18	0847	N	/	" " "	/
	0848	NW	/	General shot, finished ground reduction	/
	0849	N	/	" " "	/
	0850	N/NE	/	" " "	/
	0851	N	/	" " "	/
	0852	SW	/	General, working shot	/
	0853	W/SW	/	" " "	/
	0854	NW	/	" " "	/
	0855	W	/	" " "	/
	0856	N/NW.	/	" " "	/
	0857	NE	1x2m.	Rep Sec. S.11	/
	0858	N	1x2m.	Rep Sec. S.11 (oblique)	/

APPENDIX 3. PHOTOGRAPHS





