

ARCHAEOLOGICAL WATCHING BRIEF

AT

ST MARY THE VIRGIN CHURCH,

CHURCH LANE, ASHBURY,

OXFORDSHIRE

NGR SU26535 84920

JANURARY 2020

REPORT PREPARED BY	Steffan Klemenic
ILLUSTRATION BY	Steffan Klemenic
EDITED BY	John Moore
AUTHORISED BY	John Moore
FIELDWORK	Steffan Klemenic
FIELDWORK DATE	21-23 rd January 2020
REPORT ISSUED	27 th January 2020
ENQUIRES TO	John Moore Heritage Services Pasture Farmhouse Boarstall Aylesbury HP18 9UR Tel: 01865 358300 Email: info@jmheritageservices.co.uk
JMHS Project No:	4150
OASIS No:	johnmoor1-382407
Site Code:	ASCL 19
Archive Location:	A copy of the digital archive is maintained by John Moore Heritage Services (ID 4150) Digitised copies of the primary records are available on OASIS



CONTENTS

	Page
SUMMARY	1
1 INTRODUCTION	1
1.1 Site Location	1
1.2 Planning Background	1
1.3 Archaeological Background	1
2 AIMS OF THE INVESTIGATION	1
3 STRATEGY	3
3.1 Research Design	3
3.2 Methodology	3
4 RESULTS	3
5 FINDS	8
6 DISCUSSION	9
7 ARCHIVE	9
8 BIBLIOGRAPHY	9

FIGURES AND PLATES

Figure 1. Site Location	2
Figure 2. Site Plan	4
Figure 3. West Facing Section of Pipe Trench	5
Plate 1. Section 1 looking east	6
Plate 2. Path (05) looking southeast	6
Plate 3. Brick Gutter (03) looking east	7
Plate 4. Path (04) looking east	7

APPENDICES

Appendix 1. OASIS Report Form	9
-------------------------------	---

SUMMARY

John Moore Heritage Services carried out an archaeological watching brief at St Mary the Virgin Church, Church Lane, Ashbury, Oxfordshire (NGR SU 26535 84915). Excavation of a service trench took place in the north of the churchyard, and due to the shallow nature of the excavation no archaeological features were observed. A small quantity of disarticulated human bone was recovered.

1 INTRODUCTION

1.1 Site Location (Figure 1)

The site of St Mary the Virgin Church is located off Church Lane, in the south-east of the village of Ashbury (SU 26535 84915). The site lies between 136m and 162m AOD. The underlying geology is Zig Zag chalk formation. No superficial deposits are recorded (<http://mapapps.bgs.ac.uk/geologyofbritain/home.html>)

1.2 Planning Background

The Vale of the White Horse District Council granted planning permission for an underground drainage connection from the church to a mains sewer (P19/V0027/FUL). Due to the potential to disturb archaeological remains conditions were attached to the permission requiring a watching brief to be maintained during the course of all groundworks taking place on site. This was in accordance with Saved Policy HE11 of the Local Plan 2011, and provisions of the NPPF 2018.

1.3 Archaeological Background

The Church of St Mary the Virgin, Ashbury is a twelfth century church and the graveyard would have been utilised for burials since its construction and therefore this development was considered very likely to encounter medieval and later burials. The development connects to the west end of the church and so it was possible that it could encounter any surviving remains of any earlier church buildings. (The above is taken from an advice note issued by the Oxfordshire County Archaeological Service)

2 AIMS OF THE INVESTIGATION

The aims of the investigation as laid out in the Written Scheme of Investigation were as follows:

- To make a record of any significant archaeological remains revealed during the course of any operations that may disturb or destroy archaeological remains.

In particular:

- To record any remains of an earlier church remains and/or burials.

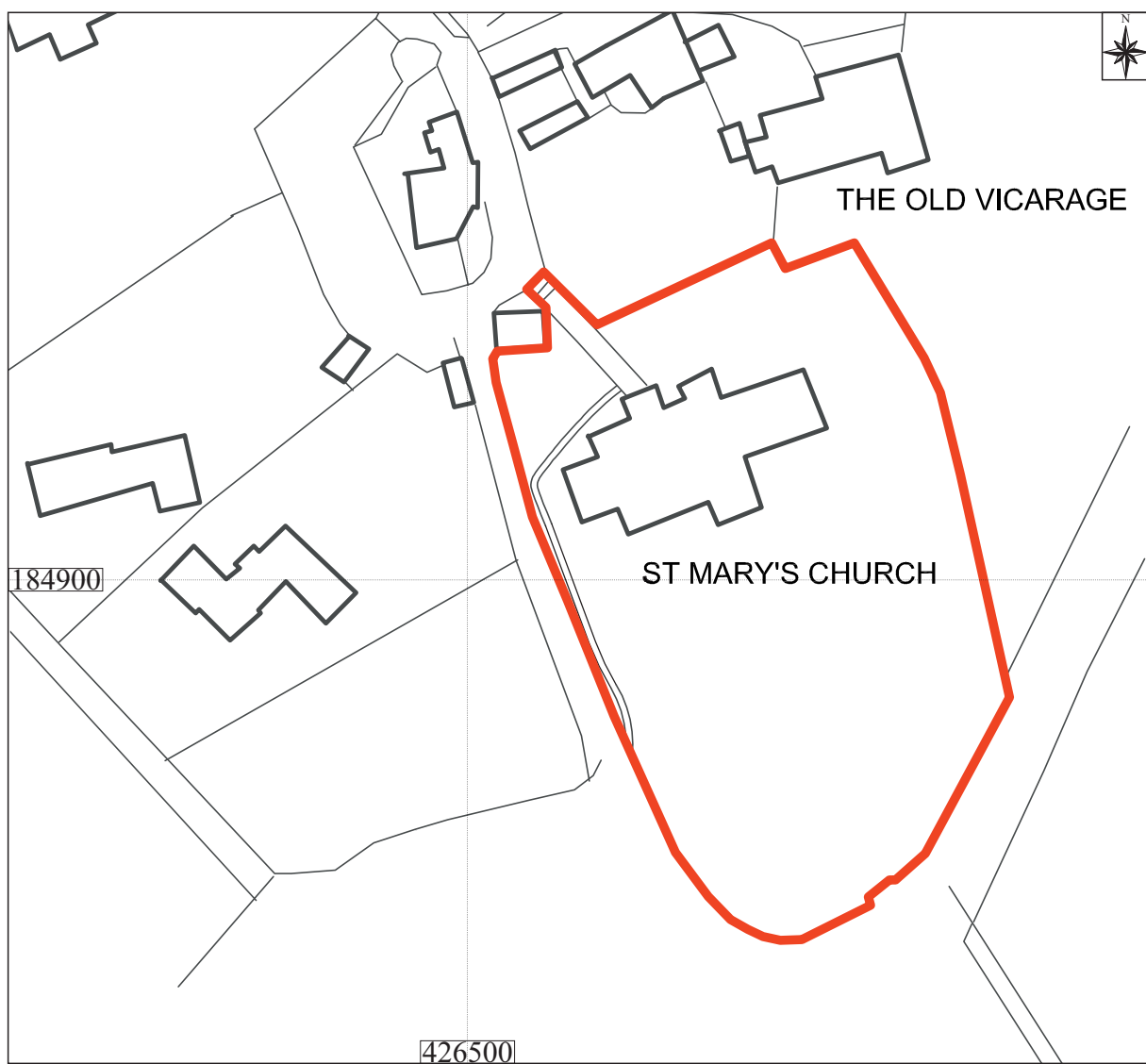
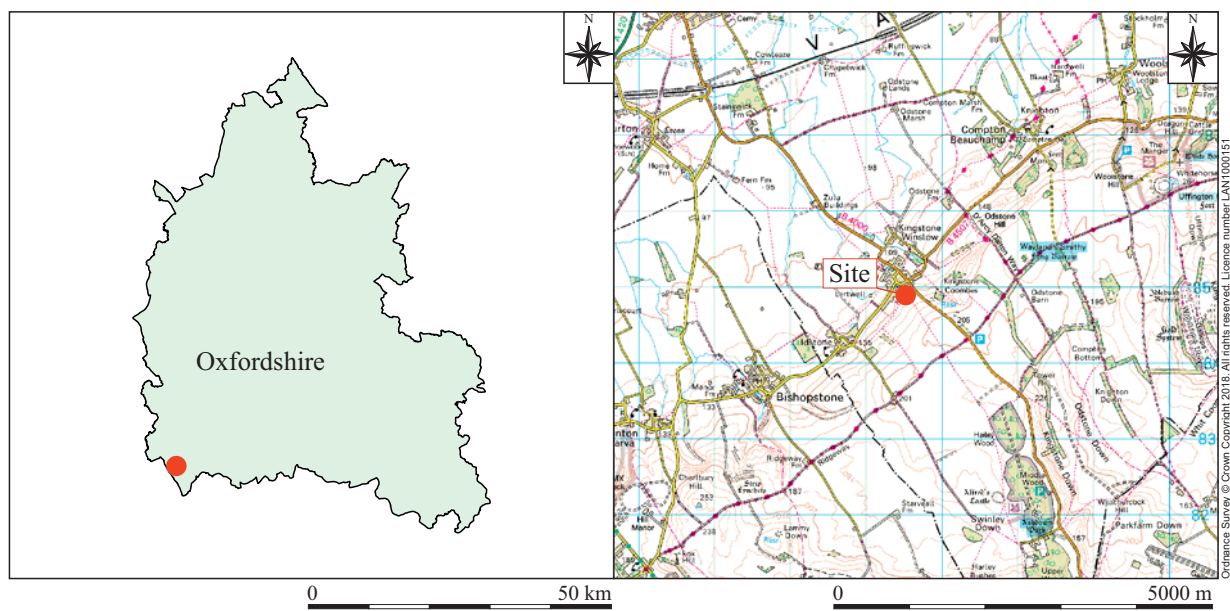

Key Site boundary Evaluation trenches
 Archaeological features Study Building

Figure 1: Site location

3 STRATEGY

3.1 Research Design

John Moore Heritage Services carried out the work to a Written Scheme of Investigation agreed with Oxfordshire County Archaeological Service, the archaeological advisors to the Vale of the White Horse District Council. The recording was carried out in accordance with the standards specified by the Chartered Institute for Archaeologists (2014).

3.2 Methodology

Where archaeological horizons were encountered they were cleaned by hand and excavated appropriately. Standard John Moore Heritage Services techniques were employed throughout, involving the completion of a written record for each deposit encountered, with scale plans and section drawings compiled where appropriate. A photographic record was also produced.

Machine excavation of the foul pipe trench was monitored for the extent of the north to south portion of the trench. This was undertaken using a 0.3m flat bladed bucket, excavating in 50mm spits. The pipe was then laid, outside of archaeological monitoring, and the trench backfilled. Monitoring resumed for the hand excavation of the trench through the cobbled path and up to the boundary fence.

The resultant spoil from the works was visually scanned, especially for human bone which may have been disturbed.

4 RESULTS (Figures 2 & 3)

All deposits and features were assigned individual context numbers. Context numbers without brackets indicate features i.e. pit cuts, numbers in () show feature fills or deposits of material, while numbers in bold indicate structural features.

The lowest deposit encountered was a graveyard soil (02) of chalk clay; a reworked mixture of subsoil and degraded geology from constant excavation within the graveyard (Plate 1). This was present throughout the foul pipe trench, with a maximum thickness of 0.4m to the limit of excavation.

Two paths and a brick gutter were laid directly onto the graveyard soil (02). The path from the road to the main entrance of the church (05) consisted of flint and sarsen cobbles 0.16m in thickness. This path (05) was set also directly into the graveyard soil (02), which can be seen between the cobbles (Plate 2).

A brick gutter (03) ran round the edge of the church. This consisted of grey bricks, and was 50mm, or one brick thick (Plate 3).

An asphalt path (04) branches off path (05) on a NE-SW orientation. This consisted of a 0.2m thick sandy gravel bedding, and a 40mm thick asphalt pathway, with concrete curb edging (Plate 4). The paths and gutter all cut the topsoil (01), which was a loose mid grey brown clay silt, 0.16m in thickness, with light rooting inclusions.

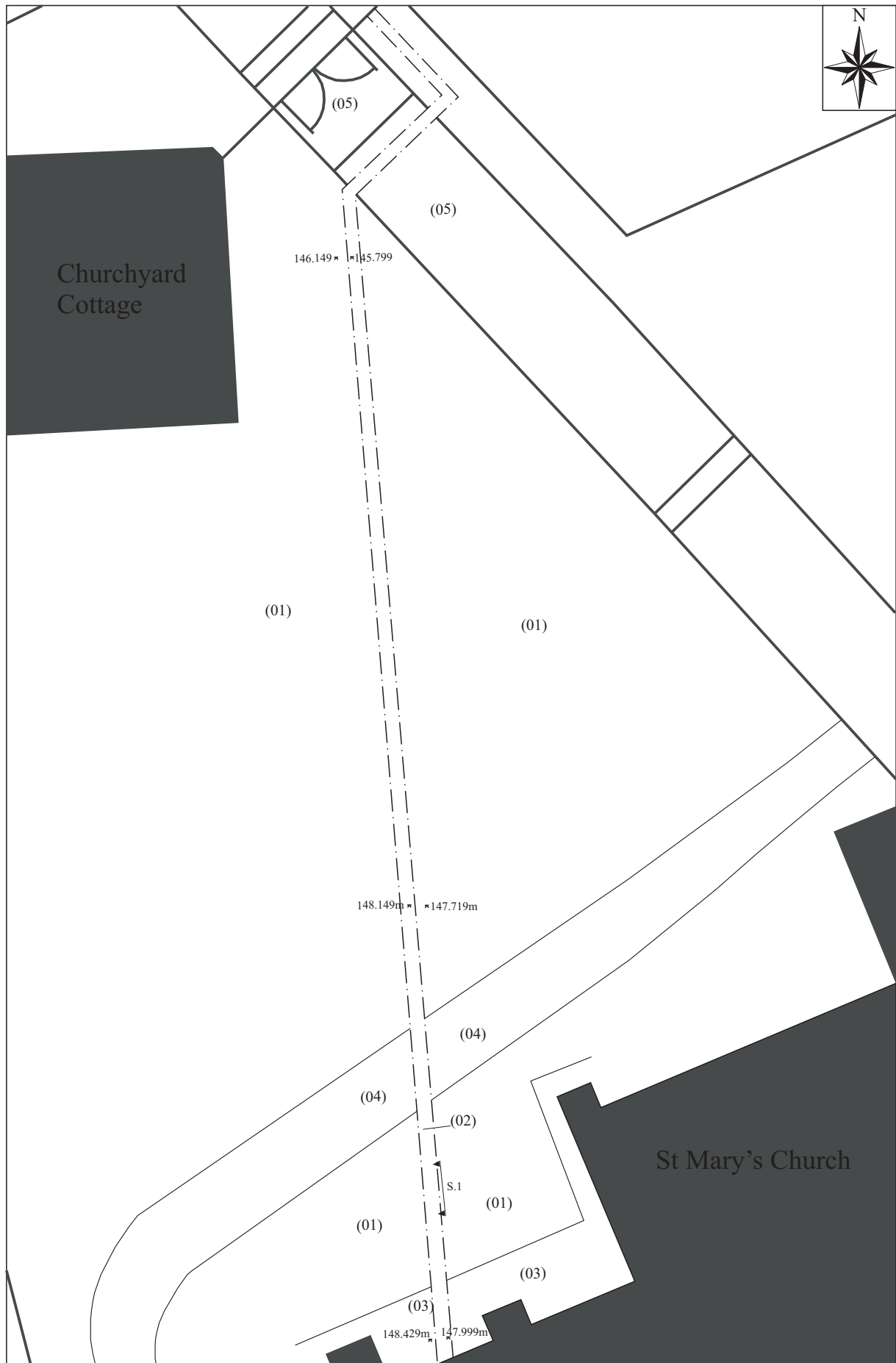

Figure 2: Site Plan

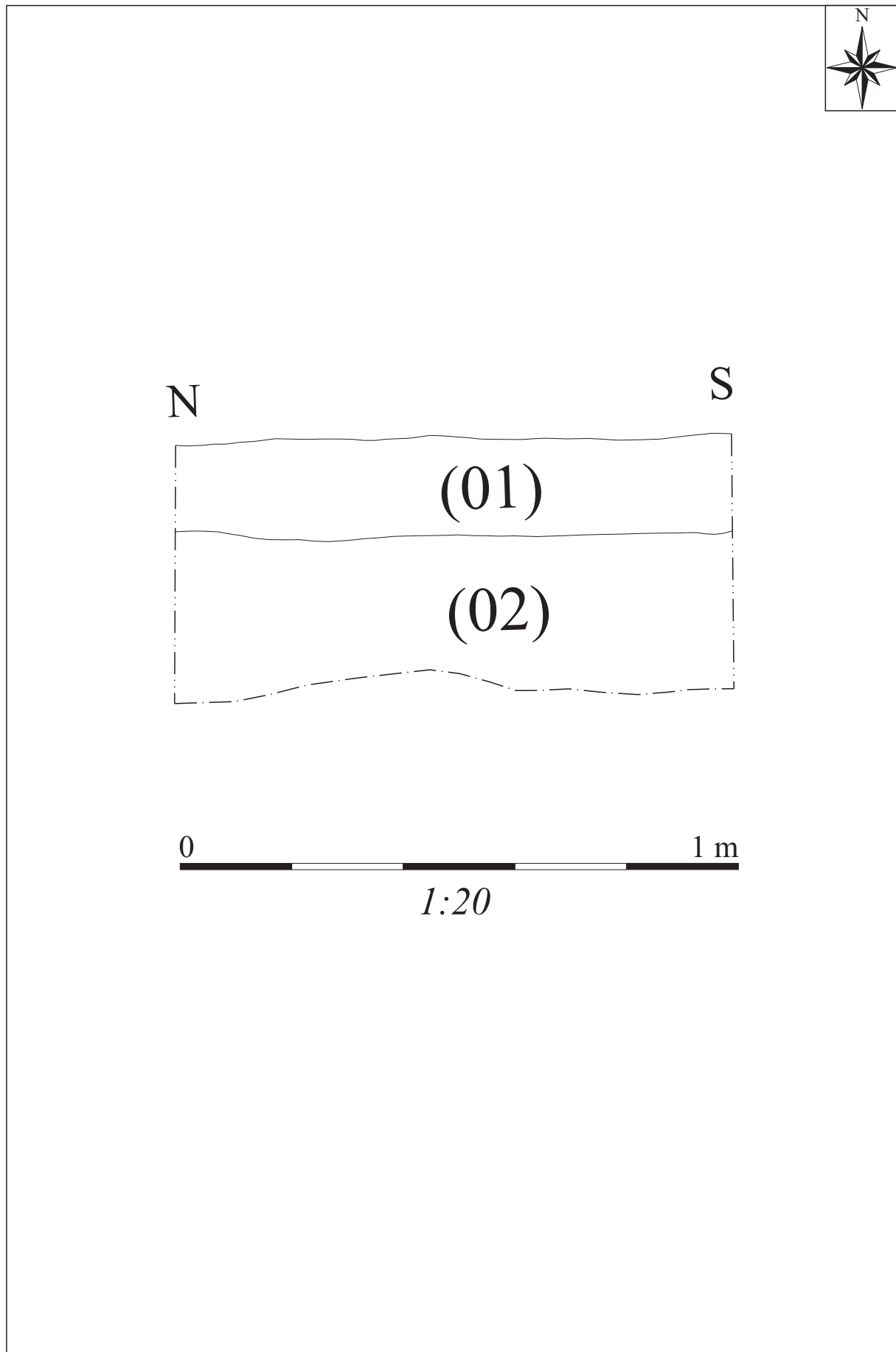

Figure 2: West Facing
Section of Pipe Trench



Plate 1: Section 1 looking east



Plate 2: Path (05) looking southeast



Plate 3: Brick Gutter (03) looking east



Plate 4: Path (04) looking east

Reliability of Results

The monitored work was undertaken in frosty, but dry conditions, with excellent cooperation from site staff, ensuring that the archaeological investigation could be undertaken without impediment.

5 FINDS

As Specified in the Written Scheme of Investigation:

Finds and human remains will be dealt with in accordance with schedule 2 to 4 of the faculty no 2018-020178 issued by the Consistory Court of the Diocese of Oxford which states that:

2. If any articulated human remains are discovered, they are not to be removed or otherwise disturbed, all work in the immediate area of the remains must cease forthwith and the applicants must apply to the Court for directions.

3. If any disarticulated human remains are discovered, they must be reverently reburied in the churchyard as soon as reasonably practicable

4. No artefact or ecofact is to be removed from the church or churchyard without further Order of the Court or an order of the Archdeacon under Section 21 of Care of Churches and Ecclesiastical Jurisdiction Measure 1991.

No artefacts were found during the Watching Brief, however a small quantity of disarticulated human bone was recovered. This was left in a safe place at the church, following direction on where would be appropriate from Maggie Simons (Church Warden).

6 DISCUSSION

Other than the small quantity of disarticulated human bone mentioned in section 5 above, there were no other finds or features observed during the groundworks at St Mary the Virgin Church, Ashbury. While it is certain that there are burials present in the area of the churchyard in which the watching brief took place, the shallow depth of the excavations did not disturb any, with only previously disturbed bones being retrieved. These bones having been disturbed by later burials cutting through earlier graves, and the bones being mixed up in the later grave fills.

7 ARCHIVE

A Digital Archive is maintained by John Moore Heritage Services (ID 4150) and will be made available upon request (to admin@jmheritageservices.co.uk). Digitised copies of all the primary records will be made publicly available as appendix to the Final Report submitted to OASIS (ID johnmoor1-382407).

8 BIBLIOGRAPHY

Chartered Institute for Archaeologists, 2014 *Standard and Guidance for Archaeological Watching Briefs*

OASIS DATA COLLECTION FORM: England

[List of Projects](#) | [Manage Projects](#) | [Search Projects](#) | [New project](#) | [Change your details](#) | [HER coverage](#) | [Change country](#) | [Log out](#)

Printable version

OASIS ID: johnmoor1-382407

Project details

Project name	St Mary the Virgin Church, Ashbury
Short description of the project	John Moore Heritage Services carried out an archaeological watching brief on/at St Mary the Virgin Church, Church Lane, Ashbury, Oxfordshire (NGR SU 26535 84915). Excavation of a service trench took place in the north of the church yard, and due to the shallow nature of the excavation no archaeological features were observed. A small quantity of disarticulated human bone was recovered.
Project dates	Start: 21-01-2020 End: 23-01-2020
Previous/future work	Not known / Not known
Any associated project reference codes	4150 - Contracting Unit No.
Any associated project reference codes	P19/V0027/FUL - Planning Application No.
Any associated project reference codes	ASCL 19 - Sitecode
Type of project	Recording project
Site status	Listed Building
Current Land use	Other 4 - Churchyard
Monument type	CHURCH Medieval
Significant Finds	NONE None
Investigation type	""Watching Brief""
Prompt	National Planning Policy Framework - NPPF

Project location

Country	England
Site location	OXFORDSHIRE VALE OF WHITE HORSE ASHBURY St Mary the Virgin Church, Ashbury
Postcode	SN6 8LN
Study area	44 Square metres
Site coordinates	SU 26535 84915 51.562012413862 -1.617164344061 51 33 43 N 001 37 01 W Point
Height OD / Depth	Min: 0.18m Max: 0.18m

Project creators

Name of Organisation	John Moore Heritage Services
Project brief originator	Vale of White Horse District Council
Project design originator	John Moore
Project director/manager	John Moore
Project supervisor	Steffan Klemenic
Type of sponsor/funding body	Client

Project archives

Physical Archive Exists?	No
Digital Archive recipient	OASIS
Digital Contents	"Stratigraphic", "other"
Digital Media available	"Text"
Digital Archive notes	digitised versions of the primary records and digital photos are attached to the final report as appendix. All digital files are maintained by JMHS and are publicly available upon request
Paper Archive Exists?	No

Project bibliography 1

Publication type	Grey literature (unpublished document/manuscript)
Title	ARCHAEOLOGICAL WATCHING BRIEF AT ST MARY THE VIRGIN CHURCH, CHURCH LANE, ASHBURY, OXFORDSHIRE
Author(s)/Editor(s)	Klemenic, S.
Author(s)/Editor(s)	Moore, J.
Other bibliographic details	JMHS report no.4150
Date	2020
Issuer or publisher	John Moore Heritage Services
Place of issue or publication	Wheatley
Entered by	Simona Denis (admin@jmheritageservices.co.uk)
Entered on	27 January 2020

OASIS:

Please e-mail [Historic England](#) for OASIS help and advice

© ADS 1996-2012 Created by [Jo Gilham and Jen Mitcham, email](#) Last modified Wednesday 9 May 2012
Cite only: <http://www.oasis.ac.uk/form/print.cfm> for this page

[Cookies](#) [Privacy Policy](#)

Grid Squares		Area/Trench		Context Type LAYER	Site Code ASCL19	Context 01
Add. Sheets	Plan Nos. P-I SH1-2		Section Nos. S-I SH1		Matrix Location	
Photographs Slide D141 700-0088, 0009				B&W		
Description 1 LOOSE 2 MID GREY BROWN 3 CLAY SILT 4 LIGHT ROOTING 5 0-16m 6 ACROSS SITE 8 MACHINE				DEPOSIT 1 Compaction 2 Colour 3 Composition 4 Inclusions 5 Thickness 6 Extent 7 Comments 8 Method and Conditions		
				CUT 1 Shape in plan 2 Corners 3 Dimensions/Depth 4 Break of slope-top 5 Sides 6 Break of slope-base 7 Base 8 Orientation 9 Inclination of axis 10 Truncation 12 Sketch profile 13 Other comments		
Stratigraphic matrix <div style="display: flex; justify-content: space-around; align-items: center;"> <div style="border: 1px solid black; width: 40px; height: 40px; margin: 5px;"></div> <div style="border: 1px solid black; width: 40px; height: 40px; margin: 5px;"></div> <div style="border: 1px solid black; width: 40px; height: 40px; margin: 5px; text-align: center;">1031</div> <div style="border: 1px solid black; width: 40px; height: 40px; margin: 5px; text-align: center;">(04)</div> <div style="border: 1px solid black; width: 40px; height: 40px; margin: 5px;"></div> </div> <p style="text-align: center;">This context is</p> <div style="display: flex; justify-content: space-around; align-items: center;"> <div style="border: 1px solid black; width: 40px; height: 40px; margin: 5px;"></div> <div style="border: 1px solid black; width: 40px; height: 40px; margin: 5px;"></div> <div style="border: 1px solid black; width: 40px; height: 40px; margin: 5px; text-align: center;">(01)</div> <div style="border: 1px solid black; width: 40px; height: 40px; margin: 5px;"></div> <div style="border: 1px solid black; width: 40px; height: 40px; margin: 5px;"></div> </div> <div style="display: flex; justify-content: space-around; align-items: center; margin-top: 10px;"> <div style="border: 1px solid black; width: 40px; height: 40px; margin: 5px;"></div> <div style="border: 1px solid black; width: 40px; height: 40px; margin: 5px;"></div> <div style="border: 1px solid black; width: 40px; height: 40px; margin: 5px; text-align: center;">(02)</div> <div style="border: 1px solid black; width: 40px; height: 40px; margin: 5px;"></div> <div style="border: 1px solid black; width: 40px; height: 40px; margin: 5px;"></div> </div>					Initials & Date SK 21/1/20	
Interpretation: Internal <u>External</u> Structural Other (specify)					Checked by & Date	
Discussion <div style="text-align: center; font-size: 1.2em; margin-top: 20px;">TOP SOIL</div>						
Context same as:				Finds		
Levels on plan P-I sheet 1-2				none <input checked="" type="checkbox"/> pot <input type="checkbox"/> bone <input type="checkbox"/> glass <input type="checkbox"/> metal <input type="checkbox"/> CBM <input type="checkbox"/> wood <input type="checkbox"/> leather <input type="checkbox"/> burntmat. <input type="checkbox"/> Other finds (specify)		
Environmental Samples Nos.				Finds sample (BM) Nos.		
Small finds Nos. Finds sieving: on-site <input type="checkbox"/> off-site <input type="checkbox"/> metal detecting: in situ <input type="checkbox"/> on-site <input type="checkbox"/> off-site <input type="checkbox"/>						
Checked Interpretation						
Provisional Period		Group		Initials & Date		

Grid Squares	Area/Trench	Context Type LAYER	Site Code ASCL19	Context 02
Add. Sheets	Plan Nos. P-1 SH 1-2	Section Nos. S-I SH1	Matrix Location	
Photographs Slide 700-0006-0011 B&W			DEPOSIT 1 Compaction 2 Colour 3 Composition 4 Inclusions 5 Thickness 6 Extent 7 Comments 8 Method and Conditions	
Description 1 COMPACT 2 LIGHT BROWN GREY 3 CHALK CLAY 4 C. 15% SUBANG CHALK > 70mm 5 0.3-0.4m 6 ACROSS SITE 8 MACHINE			CUT 1 Shape in plan 2 Corners 3 Dimensions/Depth 4 Break of slope-top 5 Sides 6 Break of slope-base 7 Base 8 Orientation 9 Inclination of axis 10 Truncation 12 Sketch profile 13 Other comments 11 Fill Nos.	
Stratigraphic matrix <div style="display: flex; justify-content: space-around;"> <div style="border: 1px solid black; width: 40px; height: 20px;"></div> <div style="border: 1px solid black; width: 40px; height: 20px;"></div> <div style="border: 1px solid black; width: 40px; height: 20px; text-align: center;">(01)</div> <div style="border: 1px solid black; width: 40px; height: 20px;"></div> <div style="border: 1px solid black; width: 40px; height: 20px;"></div> </div> <p style="text-align: center;">This context is</p> <div style="display: flex; justify-content: space-around;"> <div style="border: 1px solid black; width: 40px; height: 20px;"></div> <div style="border: 1px solid black; width: 40px; height: 20px;"></div> <div style="border: 1px solid black; width: 40px; height: 20px; text-align: center;">(02)</div> <div style="border: 1px solid black; width: 40px; height: 20px;"></div> <div style="border: 1px solid black; width: 40px; height: 20px;"></div> </div>			Initials & Date SK 21/01/20 Checked by & Date	
Interpretation: Internal <u>External</u> Structural Other (specify)				
Discussion <div style="text-align: center; font-size: 1.2em;">SUBSOIL / DEGRADED NATURAL THROUGH REPEATED DURAL ACTION</div>				
Context same as: Levels on plan P1 sheet 1-2			Finds none pot bone glass metal CBM wood leather burntmat. <div style="display: flex; justify-content: space-around;"> <input type="checkbox"/> <input checked="" type="checkbox"/> <input checked="" type="checkbox"/> <input type="checkbox"/> <input type="checkbox"/> <input type="checkbox"/> <input type="checkbox"/> <input type="checkbox"/> <input type="checkbox"/> </div> Other finds (specify) → HUMAN BONE, REDURIED	
Environmental Samples Nos.			Finds sample (BM) Nos.	
Small finds Nos. Finds sieving: on-site <input type="checkbox"/> off-site <input type="checkbox"/> metal detecting: in situ <input type="checkbox"/> on-site <input type="checkbox"/> off-site <input type="checkbox"/>				
Checked Interpretation				
Provisional Period		Group		Initials & Date

Grid Squares	Area/Trench	Context Type DEPOSIT	Site Code ASCL19	Context 03
Add. Sheets	Plan Nos. 1SH1	Section Nos.	Matrix Location	
Photographs Slide 161 700-005-007			B&W	
Description BRICK GUTTER ALONG CHURCH WALL 1 BRICK THICK (BRICK DIMENSIONS) : L 232mm B 118mm T 50mm GUTTER DIMENSIONS : (SURROUND CHURCH), 1.3m WIDE, 850mm THICK			DEPOSIT 1 Compaction 2 Colour 3 Composition 4 Inclusions 5 Thickness 6 Extent 7 Comments 8 Method and Conditions	
			CUT 1 Shape in plan 2 Corners 3 Dimensions/Depth 4 Break of slope-top 5 Sides 6 Break of slope-base 7 Base 8 Orientation 9 Inclination of axis 10 Truncation 11 Fill Nos. 12 Sketch profile 13 Other comments	
Stratigraphic matrix <div style="display: flex; justify-content: space-around; align-items: center;"> <div style="border: 1px solid black; width: 40px; height: 20px; margin: 5px;"></div> <div style="border: 1px solid black; width: 40px; height: 20px; margin: 5px;"></div> <div style="border: 1px solid black; width: 40px; height: 20px; margin: 5px; text-align: center;">(03)</div> <div style="border: 1px solid black; width: 40px; height: 20px; margin: 5px;"></div> <div style="border: 1px solid black; width: 40px; height: 20px; margin: 5px;"></div> </div> <p style="text-align: center;">This context is</p> <div style="display: flex; justify-content: space-around; align-items: center;"> <div style="border: 1px solid black; width: 40px; height: 20px; margin: 5px;"></div> <div style="border: 1px solid black; width: 40px; height: 20px; margin: 5px;"></div> <div style="border: 1px solid black; width: 40px; height: 20px; margin: 5px; text-align: center;">(04)</div> <div style="border: 1px solid black; width: 40px; height: 20px; margin: 5px;"></div> <div style="border: 1px solid black; width: 40px; height: 20px; margin: 5px;"></div> </div>			Initials & Date SK 21/9/20	
Interpretation: Internal External Structural Other (specify)			Checked by & Date	
Discussion BRICK GUTTER				
Context same as:			Finds	
Levels on plan 7-1 sheet 1			none <input checked="" type="checkbox"/> pot <input type="checkbox"/> bone <input type="checkbox"/> glass <input type="checkbox"/> metal <input type="checkbox"/> CBM <input type="checkbox"/> wood <input type="checkbox"/> leather <input type="checkbox"/> burntmat. <input type="checkbox"/> Other finds (specify)	
Environmental Samples Nos.			Finds sample (BM) Nos.	
Small finds Nos. Finds sieving: on-site <input type="checkbox"/> off-site <input type="checkbox"/> metal detecting: in situ <input type="checkbox"/> on-site <input type="checkbox"/> off-site <input type="checkbox"/>				
Checked Interpretation				
Provisional Period		Group	Initials & Date	

Grid Squares		Area/Trench		Context Type <i>04 Deposits</i>	Site Code <i>ASCL19</i>	Context <i>04</i>																		
Add. Sheets	Plan Nos. <i>P-I SHI</i>		Section Nos.		Matrix Location																			
Photographs Slide <i>D141</i> <i>700-0010-0011</i>				B&W																				
Description <i>Y</i> <i>1 ASPHALT PATHWAY ON</i> <i>3 SANDY GRAVEL BEDDING</i> <i>4 w/ RUBB EDGING</i> <i>5</i> <i>6 > 30m long, 1.3m w, 0.24m T</i> <i>8</i>				DEPOSIT 1 Compaction 3 Composition 5 Thickness 7 Comments 8 Method and Conditions 2 Colour 4 Inclusions 6 Extent																				
				CUT 1 Shape in plan 3 Dimensions/Depth 4 Break of slope-top 6 Break of slope-base 8 Orientation 9 Inclination of axis 10 Truncation 12 Sketch profile 13 Other comments 2 Corners 5 Sides 7 Base 11 Fill Nos.																				
Stratigraphic matrix <table style="width: 100%; text-align: center;"> <tr> <td><input type="text"/></td> <td><input type="text"/></td> <td><input type="text"/></td> <td><input type="text"/></td> <td><input type="text"/></td> <td><input type="text"/></td> </tr> <tr> <td colspan="2">This context is</td> <td><i>(04)</i></td> <td></td> <td></td> <td></td> </tr> <tr> <td><input type="text"/></td> <td><input type="text"/></td> <td><i>(01)</i></td> <td><input type="text"/></td> <td><input type="text"/></td> <td><input type="text"/></td> </tr> </table>						<input type="text"/>	<input type="text"/>	<input type="text"/>	<input type="text"/>	<input type="text"/>	<input type="text"/>	This context is		<i>(04)</i>				<input type="text"/>	<input type="text"/>	<i>(01)</i>	<input type="text"/>	<input type="text"/>	<input type="text"/>	Initials & Date <i>SA 21/01/20</i>
<input type="text"/>	<input type="text"/>	<input type="text"/>	<input type="text"/>	<input type="text"/>	<input type="text"/>																			
This context is		<i>(04)</i>																						
<input type="text"/>	<input type="text"/>	<i>(01)</i>	<input type="text"/>	<input type="text"/>	<input type="text"/>																			
Interpretation: Internal External <u>Structural</u> Other (specify)						Checked by & Date																		
Discussion <i>PATH AROUND W OF CHURCH</i>																								
Context same as:				Finds																				
Levels on plan <input type="text"/> sheet				none <input checked="" type="checkbox"/> pot <input type="checkbox"/> bone <input type="checkbox"/> glass <input type="checkbox"/> metal <input type="checkbox"/> CBM <input type="checkbox"/> wood <input type="checkbox"/> leather <input type="checkbox"/> burntmat. <input type="checkbox"/> Other finds (specify)																				
Environmental Samples Nos.				Finds sample (BM) Nos.																				
Small finds Nos. Finds sieving: on-site <input type="checkbox"/> off-site <input type="checkbox"/> metal detecting: in situ <input type="checkbox"/> on-site <input type="checkbox"/> off-site <input type="checkbox"/>																								
Checked Interpretation																								
Provisional Period		Group		Initials & Date																				

Grid Squares	Area/Trench	Context Type <u>DEPOSIT</u>	Site Code <u>ASCL19</u>	Context <u>05</u>
Add. Sheets	Plan Nos. <u>9-1 SH 2</u>	Section Nos.	Matrix Location	
Photographs Slide <u>700-0019-0021</u>		B&W		
Description <u>COBBLE PATH FROM ROAD TO</u> <u>CHURCH FLINT & SARSEN > 50mm</u> <u>L 20m W 1.95m</u> <u>D 0.16m</u>		DEPOSIT 1 Compaction 2 Colour 3 Composition 4 Inclusions 5 Thickness 6 Extent 7 Comments 8 Method and Conditions		
		CUT 1 Shape in plan 2 Corners 3 Dimensions/Depth 4 Break of slope-top 5 Sides 6 Break of slope-base 7 Base 8 Orientation 9 Inclination of axis 10 Truncation 12 Sketch profile 13 Other comments		
		Stratigraphic matrix <div style="display: flex; justify-content: space-around;"> <div style="border: 1px solid black; width: 40px; height: 20px;"></div> <div style="border: 1px solid black; width: 40px; height: 20px;"></div> <div style="border: 1px solid black; width: 40px; height: 20px;"></div> <div style="border: 1px solid black; width: 40px; height: 20px;"></div> <div style="border: 1px solid black; width: 40px; height: 20px;"></div> </div> <p style="text-align: center;">This context is</p> <div style="display: flex; justify-content: space-around;"> <div style="border: 1px solid black; width: 40px; height: 20px;"></div> <div style="border: 1px solid black; width: 40px; height: 20px;"></div> <div style="border: 1px solid black; width: 40px; height: 20px; text-align: center;"><u>(05)</u></div> <div style="border: 1px solid black; width: 40px; height: 20px;"></div> <div style="border: 1px solid black; width: 40px; height: 20px;"></div> </div> <div style="display: flex; justify-content: space-around;"> <div style="border: 1px solid black; width: 40px; height: 20px;"></div> <div style="border: 1px solid black; width: 40px; height: 20px;"></div> <div style="border: 1px solid black; width: 40px; height: 20px; text-align: center;"><u>(01)</u></div> <div style="border: 1px solid black; width: 40px; height: 20px;"></div> <div style="border: 1px solid black; width: 40px; height: 20px;"></div> </div>		
		Initials & Date <u>SM 23/1/20</u>		
Checked by & Date				
Interpretation: Internal <u>External</u> Structural Other (specify)				
Discussion <u>PATH TO CHURCH ENTRANCE</u>				
Context same as:		Finds		
Levels on plan sheet		none <input checked="" type="checkbox"/> pot <input type="checkbox"/> bone <input type="checkbox"/> glass <input type="checkbox"/> metal <input type="checkbox"/> CBM <input type="checkbox"/> wood <input type="checkbox"/> leather <input type="checkbox"/> burntmat. <input type="checkbox"/>		
		Other finds (specify)		
Environmental Samples Nos.		Finds sample (BM) Nos.		
Small finds Nos. Finds sieving: on-site <input type="checkbox"/> off-site <input type="checkbox"/> metal detecting: in situ <input type="checkbox"/> on-site <input type="checkbox"/> off-site <input type="checkbox"/>				
Checked Interpretation				
Provisional Period		Group		Initials & Date

BS @ BASE OF THIS OF 1-96 GIVES 0.08m BELOW ODDATUM
John Moore HERITAGE SERVICES LEVELS REGISTER

[illegible]

John Moore HERITAGE SERVICES

DRAWING SHEET CHECKLIST

SITE NAME: ST MARKS CHURCH	SITE CODE: ASCL19	SHEET No: 1/1
----------------------------	-------------------	---------------

[illegible]

[illegible]

[illegible]

SH2
↑

N
↑

ASCL19

1:50
23/1/20

P-1 SH 1

S-1 W.F. REP SEC.
1:20 SK 21/1/20

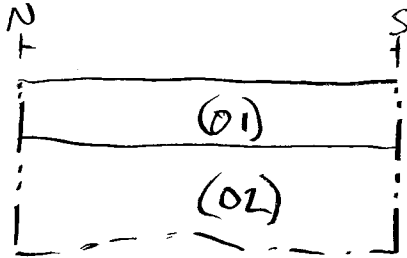

4 K SK

(01)

(04)

S-1

(01)

(03)

2 K

3 K

ASCL19

P-1 SH2

N
↑

1:50 23/1/20

6K7K

↓
SH1



West Facing Section of Pipe Trench



West Facing Section of Pipe Trench



West Facing Section of Pipe Trench



View across the church yard from the south



NW Facing Section of Pipe Trench



Pipe trench to main gate



Pipe trench to main gate