



JOHN MOORE HERITAGE SERVICES

ARCHAEOLOGICAL WATCHING BRIEF

AT

LAND ADJACENT TO THE GREEN

GARSINGTON

OXFORDSHIRE

NGR: SP 580 022 Centred

AUGUST 2020

REPORT PREPARED BY Gavin Davis

ILLUSTRATION BY Christopher Whitehead & Iwona Brodzka

EDITED BY John Moore

AUTHORISED BY John Moore

FIELDWORK Natasha Djukic

FIELDWORK DATE 19th June 2019 to 27th June 2019

REPORT ISSUED 14th August 2020

ENQUIRES TO John Moore Heritage Services
Pasture Farmhouse
Boarstall
Aylesbury
HP18 9UR

Tel: 01865 358300
Email: info@jmheritageservices.co.uk

JMHS Project No: 4132
OASIS No: johnmoor1-401331
Site Code: GATG 18
Archive Location: A copy of the digital archive is maintained by John Moore Heritage Services (ID 4132)
Digitised copies of the primary records are available on OASIS



CONTENTS

	Page
<i>SUMMARY</i>	1
1 INTRODUCTION	1
1.1 Site Location	1
1.2 Planning Background	1
1.3 Archaeological Background	3
2 AIMS OF THE INVESTIGATION	3
3 STRATEGY	3
3.1 Research Design	3
3.2 Methodology	4
4 RESULTS	4
5 FINDS	4
6 DISCUSSION	4
7 ARCHIVE	4
8 BIBLIOGRAPHY	6
 FIGURES AND PLATES	
Figure 1. Site Location	2
Figure 2. Plan and Section	5
 APPENDICES	
Appendix 1. Primary Records	7
Appendix 2. OASIS Report Form	23

SUMMARY

John Moore Heritage Services carried out an archaeological watching brief on Land adjacent to The Green, Garsington, Oxfordshire during the excavations of the foundations for a new build. No archaeological features, deposits or finds were identified.

1 INTRODUCTION

1.1 Site Location (Figure 1)

The site lies between the west side of The Green and the east side of The Hill in Garsington (SP580022 centred) and is currently enclosed on three sides by trees and shrubs with the occasional small tree within it. It lies at approximately 120m - 124m AOD and the geology is Portland Formation – Sands and limestones (BGS, Sheet 237, Solid and Drift Geology)

1.2 Planning Background

South Oxfordshire District Council granted planning permission for a proposed family dwelling and garage on vacant land. The application represented an amendment to approved application reference; (APP/Q3115/W/16/3148649). (As amended and supported by revised plans and arboricultural report received on 13 March 2017, Site Plan Landscaping Plan Addendum to Arboriculture Impact Assessment and Landscaping Plan March 2017 accompanying e-mail from agent received 3 April 2017 and amended Site Plan received 05 April 2017) (P16/S3989/FUL). Due to the potential of the site to contain archaeological remains two conditions have been attached. Condition 4 stated that:

A full archaeological watching brief shall be carried out during the period of construction works by a professionally competent archaeological organisation in accordance with a Written Scheme of Investigation which shall have been submitted to and approved in writing by the Local Planning Authority prior to the commencement of development. The brief shall include the recording of any archaeological features revealed, limited archaeological excavation and the retrieval of artefactual evidence.

Reason: To secure the protection of and proper provision for any archaeological remains in accordance with Policy CSEN3 of the South Oxfordshire Core Strategy 2027 and Policies CON11, CON13 and CON14 of the South Oxfordshire Local Plan 2011.

Condition 4 stated that:

Following the approval of the Written Scheme of Investigation referred to in Condition 4, no development shall commence on site without the appointed archaeologist being present. Once the watching brief has been completed its findings shall be reported to the Local Planning Authority, as agreed in the Written Scheme of Investigation, including all processing, research and analysis necessary to produce an accessible and useable archive and a full report for publication.

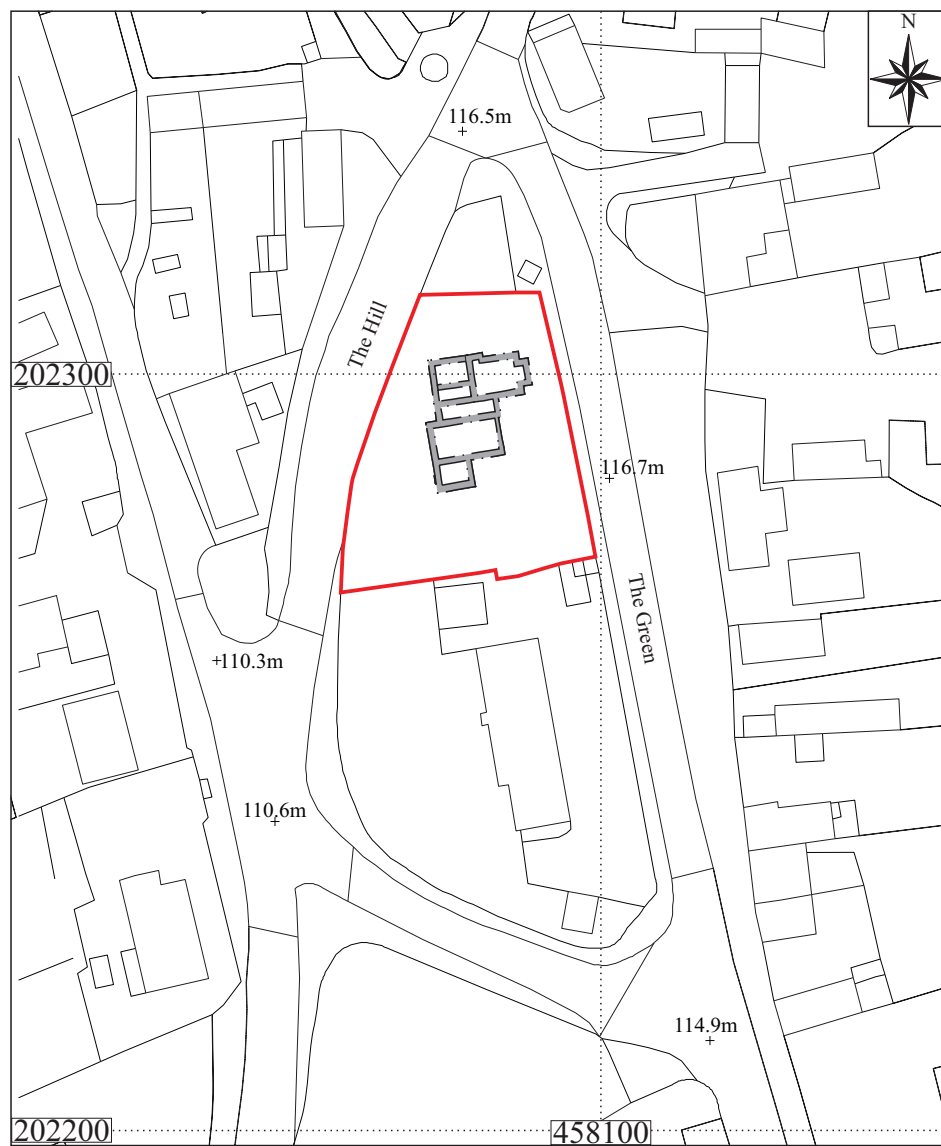
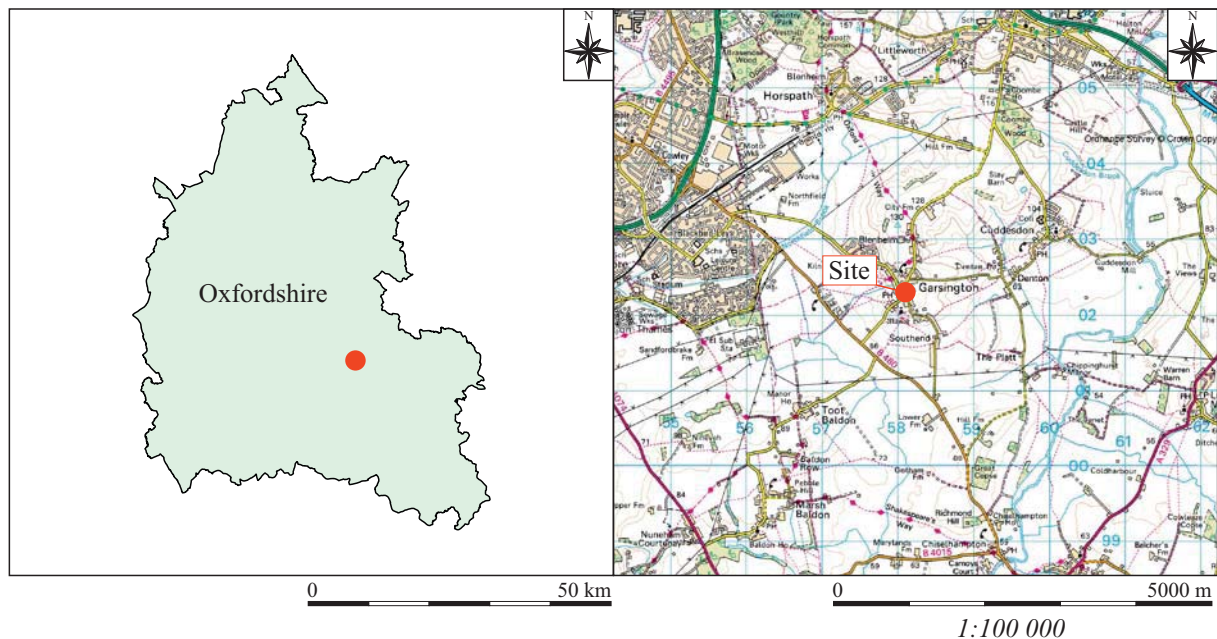

Key  Site boundary
 Excavated areas

Figure 1: Site location

Reason: To enable an appropriate level of archaeological investigation of the area including excavation and recording, post excavation analysis and the publication of results in accordance with Policy CSEN3 of the South Oxfordshire Core Strategy 2027 and Policies CON11, CON13 and CON14 of the South Oxfordshire Local Plan 2011.

1.3 Archaeological Background

The site lies in close proximity to the Scheduled Monument of Garsington village cross (No. 1015175). The scheduled area extends 10m from the base of the cross and is partly within the proposed development area. The cross itself is screened by a stone wall and larger conifer hedge from the proposed new build. The cross would have held a prominent position within the medieval settlement with space around it for public gatherings. The village stocks also used to be located close to the cross in Garsington, highlighting this as an important public area of the village in the medieval and later periods.

The site is located in an area of archaeological potential within the historic core of the settlement. Earthworks of a shrunken medieval village have been recorded 150m south of the application site immediately north of the medieval parish Church. A number of late 16th and early 17th century listed buildings are located in the vicinity of the Cross and it is likely that this area was utilised in the medieval period. It is therefore possible that this development will encounter archaeological deposits related to the medieval development of the village.

The above archaeological background has been taken from the Historic England's and Oxfordshire Historic Environment Team's (OHET) advice to the LPA.

2 AIMS OF THE INVESTIGATION

The aims of the investigation as laid out in the Written Scheme of Investigation were as follows:

- To make a record of any significant archaeological remains revealed during the course of any operations that may disturb or destroy archaeological remains.

In particular:

- To record any evidence for medieval and later activity known in the area.

3 STRATEGY

3.1 Research Design

John Moore Heritage Services carried out the work to a Written Scheme of Investigation agreed with OHET, the archaeological advisors to the South Oxfordshire District Council.

The recording was carried out in accordance with the standards specified by the Chartered Institute for Archaeologists (2014).

3.2 Methodology

An archaeologist was present on site during the course of any significant groundwork that had the potential to reveal or disturb archaeological remains. This included for general stripping of the new build footprints and the excavations for new foundations, services and access/parking area.

If archaeological horizons were encountered they were to be cleaned by hand and excavated appropriately. Standard John Moore Heritage Services techniques were employed throughout, involving the completion of a written record for each deposit encountered, with scale plans and section drawings compiled where appropriate. A photographic record was also produced.

The resultant spoil from the works was visually scanned for finds.

4 RESULTS

All deposits and features were assigned individual context numbers. Context numbers without brackets indicate features i.e. pit cuts, numbers in () show feature fills or deposits of material, while numbers in bold indicate structural features.

The lowest deposit identified during the excavations was a deposit of light greyish yellow and darker yellow clayey sand (3) which was identified as the natural geology. Deposited above this was a 0.16m deposit of mid-greyish brown sandy loam (2). The deposit contained modern rubbish in places and which was probably related to the area being used as a dump. Above this deposit was a 0.28m thick deposit of mid to dark greyish brown sandy loam topsoil (1). No Archaeological finds or features were identified during the excavations.

Further work included the construction of a patio area further towards the area of the scheduled monument. The impact of the groundworks were minimal removing only topsoil and building up from the top of the subsoil.

5 FINDS

No finds were recovered from the site

6 DISCUSSION

No archaeological finds, features or deposits were identified during the excavations.

7 ARCHIVE

A Digital Archive is maintained by John Moore Heritage Services (ID 4132) and will be made available upon request (to admin@jmheritageservices.co.uk). Digitised copies of all the primary records will be made publicly available as appendix to the Final Report submitted to OASIS (ID johnmoor1-401331).

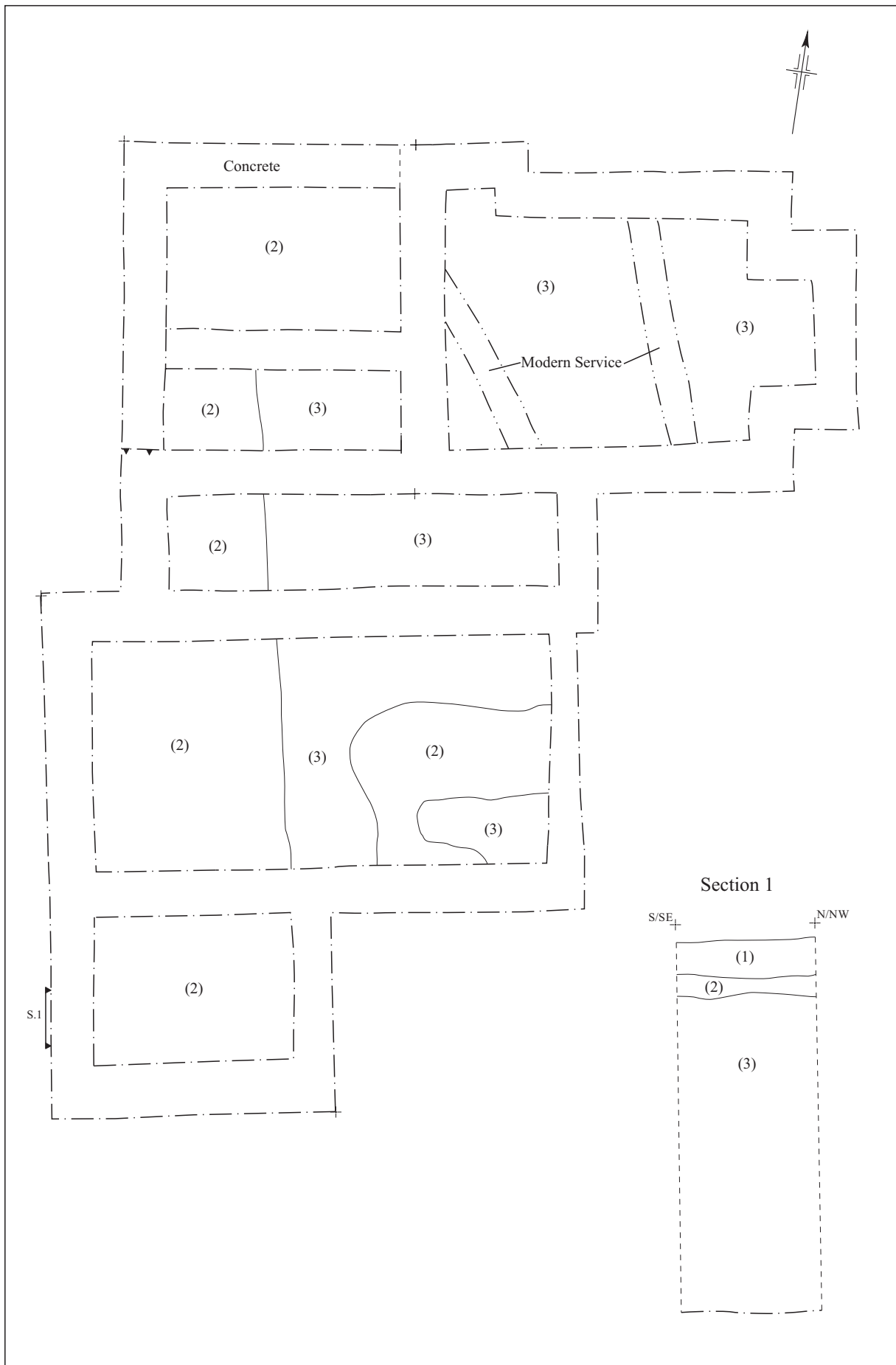
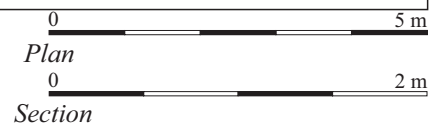

Figure 2: Site Plan and Section.



8 BIBLIOGRAPHY

Chartered Institute for Archaeologists, 2014 *Standard and Guidance for Archaeological Watching Briefs*

John Moore Heritage Services 2018 *P16/S3989?FUL - Land Adj The Green, Garsington, Oxfordshire OX44 9DF. Archaeologica Watching Brief, Written Scheme of Investigation*

Grid Squares —	Area/Trench NW corner of Trench	Context Type Layer	Site Code GATG18	Context (1)
-------------------	------------------------------------	-----------------------	---------------------	----------------

Add. Sheets (1)	Plan Nos. P1	Section Nos. S1	Matrix Location —
--------------------	-----------------	--------------------	----------------------

Photographs Slide 5951 → 60 B&W FI#24

DEPOSIT

<input checked="" type="checkbox"/> Compaction	<input checked="" type="checkbox"/> Colour
<input checked="" type="checkbox"/> Composition	<input checked="" type="checkbox"/> Inclusions
<input checked="" type="checkbox"/> Thickness	<input checked="" type="checkbox"/> Extent
<input checked="" type="checkbox"/> Comments	
<input checked="" type="checkbox"/> Method and Conditions	

Description 1) friable 2) Mid-dark greyish brown 3) silty clayey silt 4) occ. mod. amounts of small sub-angular stones. 5) L: 0.28m; 4.5-4.0m; W: > 10.6m 7) see add. sheet for sketches. 8) Excavated by

NB. covered by grass; mod. amount of rooting.

CUT

1 Shape in plan	2 Corners
3 Dimensions/Depth	5 Sides
4 Break of slope-top	7 Base
6 Break of slope-base	
8 Orientation	
9 Inclination of axis	
10 Truncation	11 Fill Nos.
12 Sketch profile	
13 Other comments	

Stratigraphic matrix

<input type="checkbox"/>	<input type="checkbox"/>	<input type="checkbox"/>	<input type="checkbox"/>	<input type="checkbox"/>
This context is		(1)		
<input type="checkbox"/>	<input type="checkbox"/>	(2)	<input type="checkbox"/>	<input type="checkbox"/>

Initials & Date
ND 19/6/19

Checked by & Date

Interpretation: Internal External Structural Other (specify)

Discussion top soil.

Context same as: Finds

Levels on plan <input type="checkbox"/> sheet	none <input checked="" type="checkbox"/> pot <input type="checkbox"/> bone <input type="checkbox"/> glass <input type="checkbox"/> metal <input type="checkbox"/> CBM <input type="checkbox"/> wood <input type="checkbox"/> leather <input type="checkbox"/> burntmat. <input type="checkbox"/>
Highest <input type="checkbox"/> Lowest <input type="checkbox"/>	Other finds (specify)

Environmental Samples Nos. Finds sample (BM) Nos.

Small finds Nos. Finds sieving: on-site off-site metal detecting: in situ on-site off-site

Checked Interpretation

Provisional Period Group Initials & Date

Grid Squares /	Area/Trench NW Corner of Trench System	Context Type Layer	Site Code GATG18	Context (2)
-------------------	--	-----------------------	---------------------	----------------

Add. Sheets —	Plan Nos. P1	Section Nos. S1	Matrix Location —
------------------	-----------------	--------------------	----------------------

Photographs Slide 5951 → 60 B&W FI#24

DEPOSIT

<input checked="" type="checkbox"/> 1 Compaction	<input checked="" type="checkbox"/> 2 Colour
<input checked="" type="checkbox"/> 3 Composition	<input checked="" type="checkbox"/> 4 Inclusions
<input checked="" type="checkbox"/> 5 Thickness	<input checked="" type="checkbox"/> 6 Extent
<input checked="" type="checkbox"/> 7 Comments	
8 Method and Conditions	

Description 1) friable 2) Mid greyish brown
3) clayey silt 4) mod. amounts of
rooting; mod. amounts of small sub-
rounded stones. 5) 0.16 m 6)
~~L: 1.2m W: 0.2m~~ C: 5.40m; W: 10.60m
7) See Add. sheet for (1).
8) Excavated by machine during
driest conditions.

CUT

1 Shape in plan	2 Corners
3 Dimensions/Depth	5 Sides
4 Break of slope-top	7 Base
6 Break of slope-base	
8 Orientation	
9 Inclination of axis	11 Fill Nos.
10 Truncation	
12 Sketch profile	
13 Other comments	

Stratigraphic matrix

<input type="checkbox"/>	<input type="checkbox"/>	(1)	<input type="checkbox"/>	<input type="checkbox"/>
This context is		(2)	<input type="checkbox"/>	<input type="checkbox"/>
<input type="checkbox"/>	<input type="checkbox"/>	(3)	<input type="checkbox"/>	<input type="checkbox"/>

Initials & Date
ND 19/6/19

Checked by & Date

Interpretation: Internal External Structural Other (specify)

Discussion

Cohuvium
→ some mod. rubbish, likely mix of from when this area was used as a dump.

Context same as:

Levels on plan sheet Highest Lowest

Findings: none pot bone glass metal CBM wood leather burntmat.

Other finds (specify)

Environmental Samples Nos.

Finds sample (BM) Nos.

Small finds Nos.

Finds sieving: on-site off-site metal detecting: in situ on-site off-site

Checked Interpretation

Provisional Period

Group

Initials & Date

Grid Squares —	Area/Trench NW Corners of Trench Systems.	Context Type Layer	Site Code GATG18	Context (3)
-------------------	---	-----------------------	---------------------	----------------

Add. Sheets —	Plan Nos. P1	Section Nos. S1	Matrix Location /
------------------	-----------------	--------------------	----------------------

Photographs Slide
5951 → 60

B&W
F1 #24

DEPOSIT

<input checked="" type="checkbox"/> 1 Compaction	<input checked="" type="checkbox"/> 2 Colour
<input checked="" type="checkbox"/> 3 Composition	<input checked="" type="checkbox"/> 4 Inclusions
<input checked="" type="checkbox"/> 5 Thickness	<input checked="" type="checkbox"/> 6 Extent
<input checked="" type="checkbox"/> 7 Comments	
<input type="checkbox"/> 8 Method and Conditions	

Description 1) compact 2) light greenish yellow w/ darker yellow streaks & streaks of lighter grey. 3) sandy clay 4) > 2.26 m. 5) occ. small sub-round stones. 6) < 5.40 m W > 10.60 m. 7) see add sh. for (1). 8) excavated by machine during dement conditions.

CUT

<input type="checkbox"/> 1 Shape in plan	<input checked="" type="checkbox"/> 2 Corners
<input type="checkbox"/> 3 Dimensions/Depth	
<input type="checkbox"/> 4 Break of slope-top	<input type="checkbox"/> 5 Sides
<input type="checkbox"/> 6 Break of slope-base	<input type="checkbox"/> 7 Base
<input type="checkbox"/> 8 Orientation	
<input type="checkbox"/> 9 Inclination of axis	
<input type="checkbox"/> 10 Truncation	<input type="checkbox"/> 11 Fill Nos.
<input type="checkbox"/> 12 Sketch profile	
<input type="checkbox"/> 13 Other comments	

Stratigraphic matrix

<input type="checkbox"/>	<input type="checkbox"/>	(2)	<input type="checkbox"/>	<input type="checkbox"/>
This context is		(3)	<input type="checkbox"/>	<input type="checkbox"/>
<input type="checkbox"/>	<input type="checkbox"/>	—	<input type="checkbox"/>	<input type="checkbox"/>

Initials & Date
ND 19/6/19.

Checked by & Date

Interpretation: Internal External Structural Other (specify)

Discussion

Nat

Context same as:

Levels on plan	<input type="checkbox"/>	sheet
Highest		Lowest

Findings: none pot bone glass metal CBM wood leather burntmat.

Other finds (specify)

Environmental Samples Nos.

Finds sample (BM) Nos.

Small finds Nos.

Finds sieving: on-site off-site metal detecting: in situ on-site off-site

Checked Interpretation

Provisional Period	Group	Initials & Date
--------------------	-------	-----------------



CATG18

Plan of west annex + 1st tiered up for building *trenching dug + filled by concrete in sections.

Scale 1:50 N/A 19/6/19

P.1



← N



CATG18 | S.1
Section drawing Page W
SI rep SEC.
Scale 1:20  0.4m



P.3 GATG 18 CONTINUED

Show how the site has changed by the end of day 2

NO 20/6/19 Scale 1:50

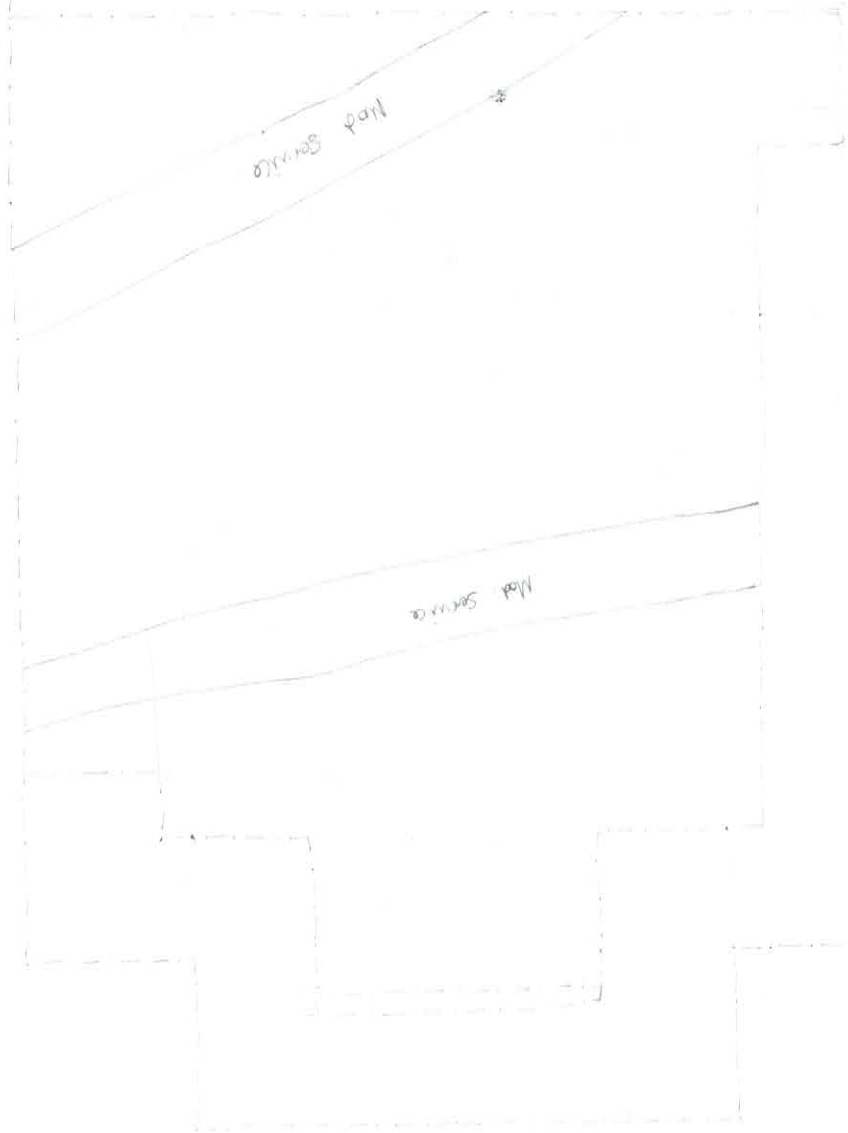

F3 ON SHEETS 3, 5, 6

3 he
GATG

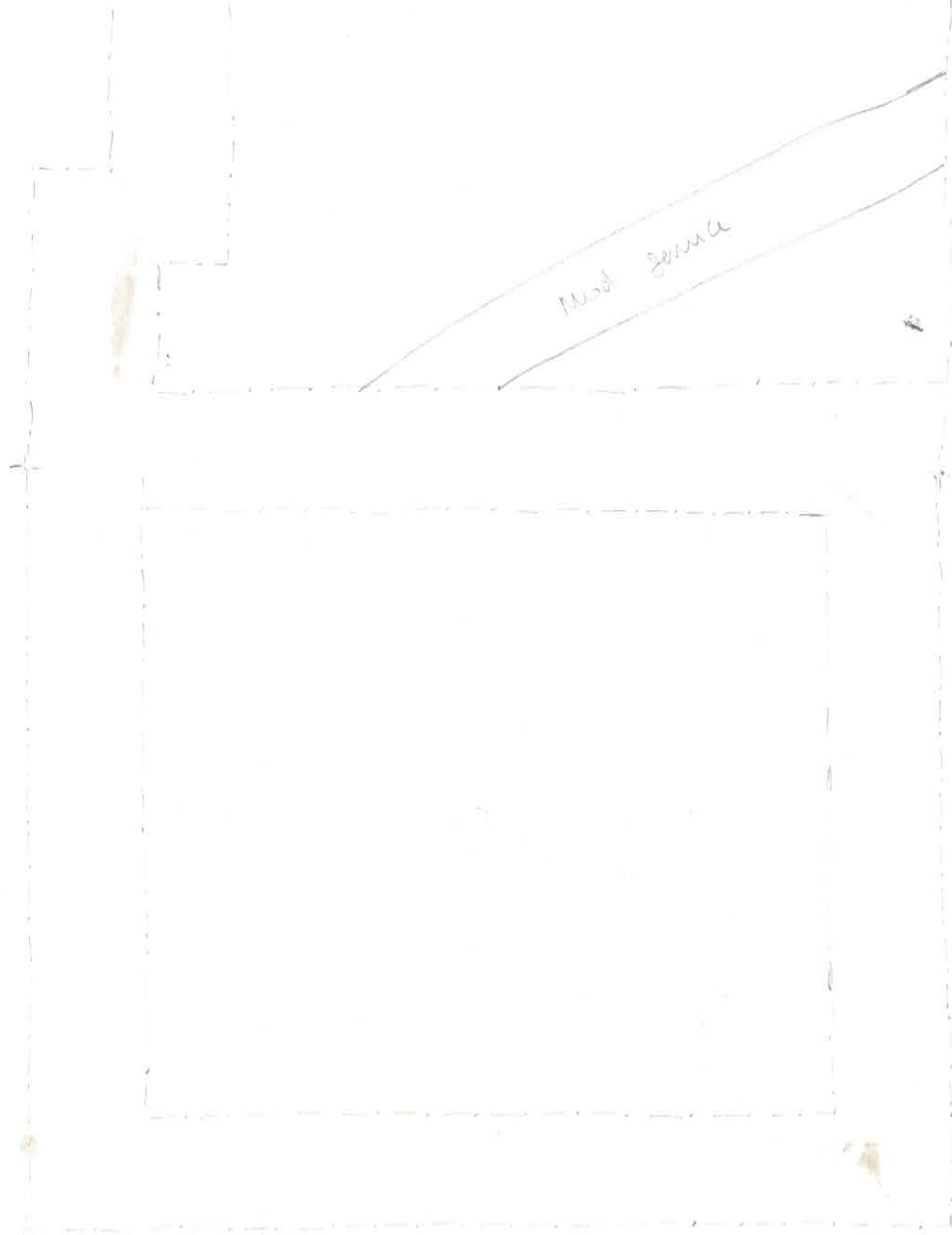

N →

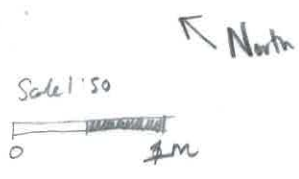

GATG 18 P.2

Site plan of P1 Scale 1:50

Showing how the site has progressed by day

AD 20/6/19

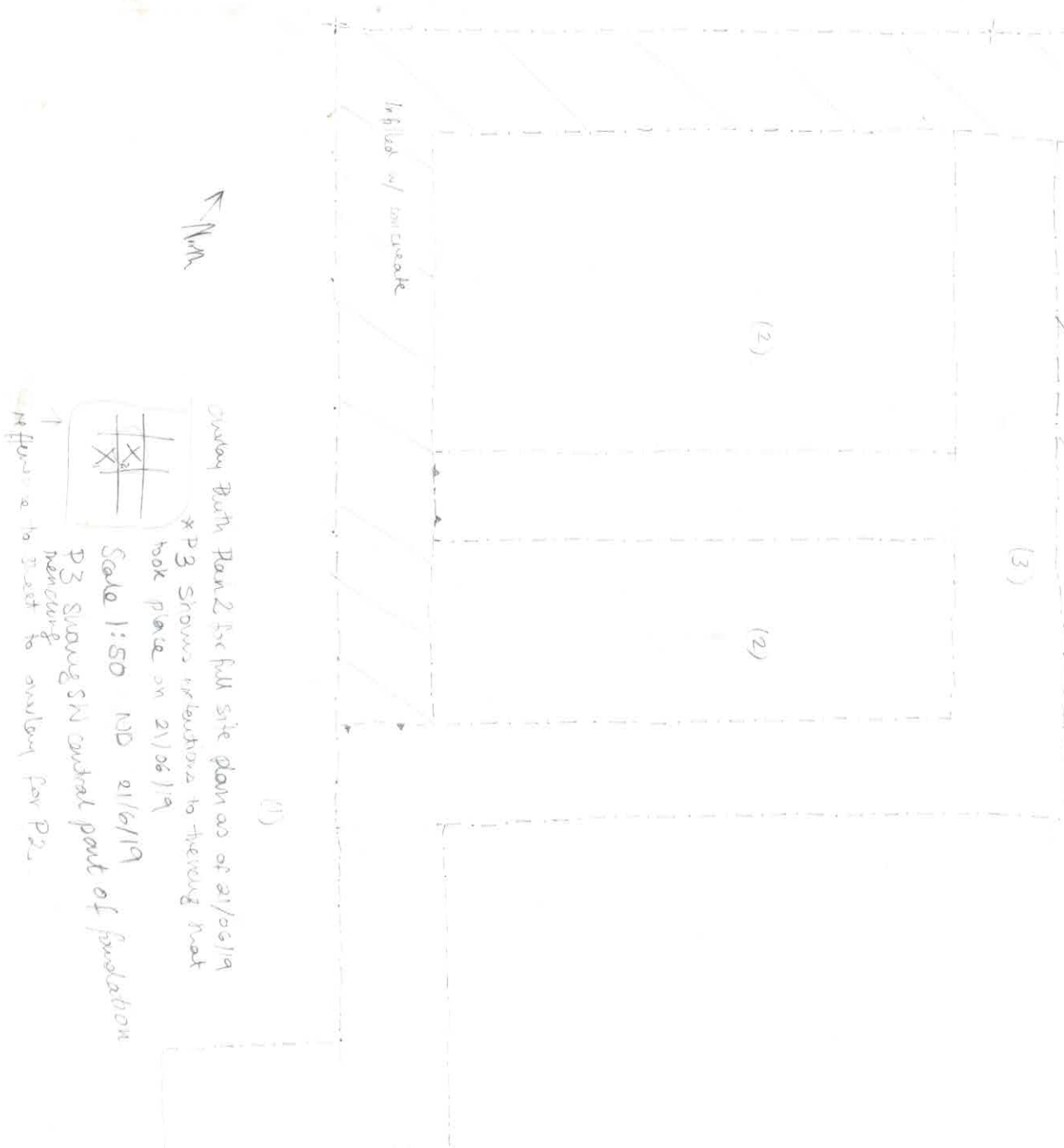

P.3 CONTINUED
 P.3 ON SHEETS 3, 5, 6



P.3 CONTINUED

Scale: 1:50 update
of site plan with
sheet 315.

~~P.4~~ ND

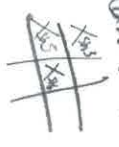

ND

CONTINUED

P.1

PS Scale:

ND

1 of 2



full plan of site
@ end of Trend

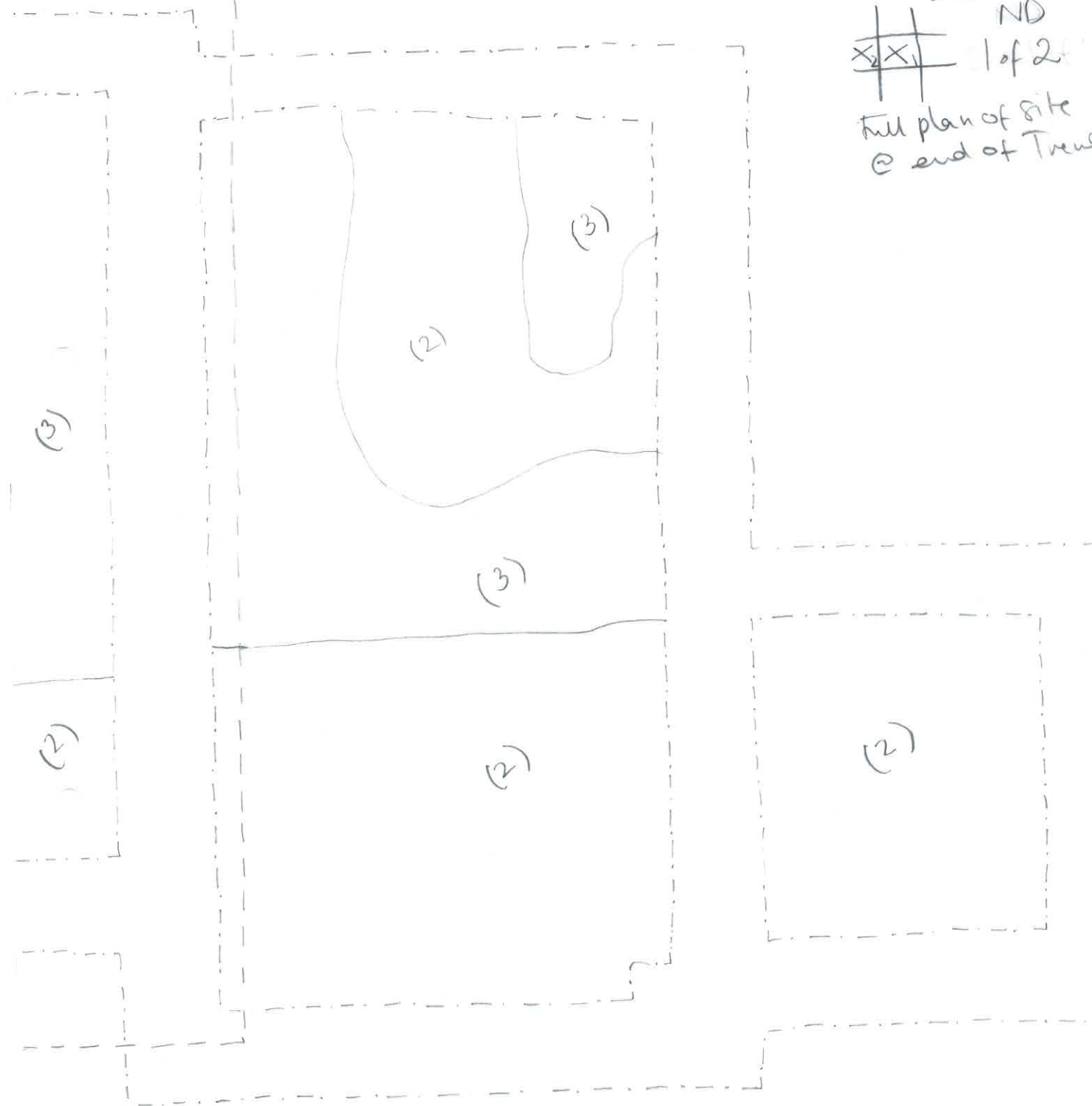

PS Scale 1:50
Full plan of site @
end of trench



2 of 2

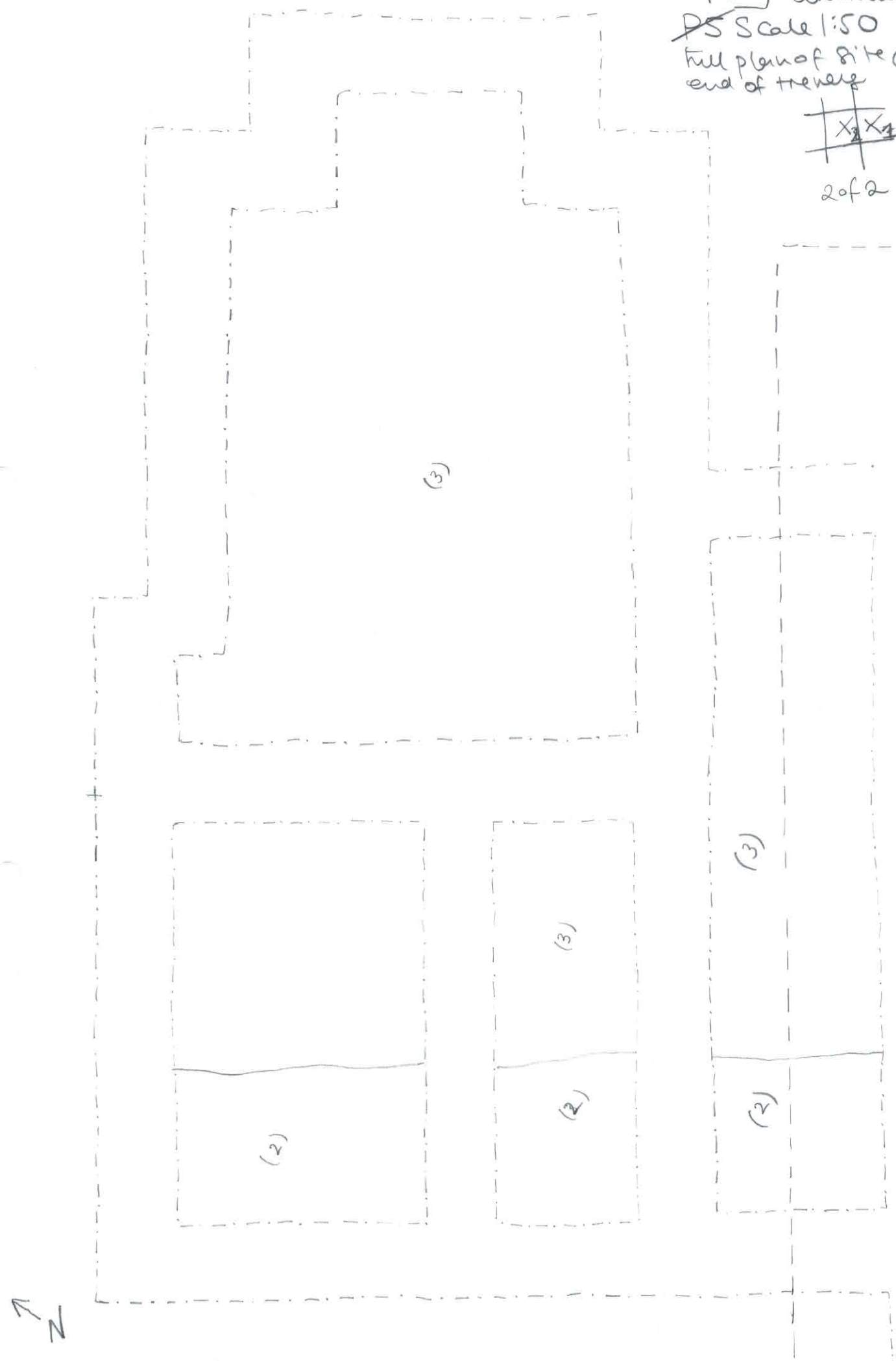

Summary for johnmoor1-401331

OASIS ID (UID)	johnmoor1-401331
Project Name	Land Adj. to The Green, Garsington
Activity type	WATCHING BRIEF
Project Identifier(s)	4132, 3847, GATG 18
Planning Id	APP/Q3115/W/16/3148649, P16/S3989/FUL
Reason For Investigation	Planning requirement, Scheduled monument consent
Organisation Responsible for work	John Moore Heritage Services
Project Dates	19-Jun-2019 - 27-Jun-2019
Location	Land Adjacent to The Green, Garsington NGR : SP 58084 02289 LL : 51.7163306457519, -1.16063954630442 12 Fig : 458084,202289
Administrative Areas	Country : England County : Oxfordshire District : South Oxfordshire Parish : Garsington
Project Methodology	No archaeological features, deposits or finds were identified during the excavations of the foundations for a new build.
Project Results	The lowest deposit identified during the excavations was a deposit of light greyish yellow and darker yellow clayey sand (3) which was identified as the natural geology. Deposited above this was a 0.16m deposit of mid-greyish brown sandy loam (2). The deposit contained modern rubbish in places and which was probably related to the area being used as a dump. Above this deposit was a 0.28m thick deposit of mid to dark greyish brown sandy loam topsoil (1). No Archaeological finds or features were identified during the excavations. Further work included the construction of a patio area further towards the area of the scheduled monument. The impact of the groundworks were minimal removing only topsoil and building up from the top of the subsoil.
Keywords	
HER	Oxfordshire HER - unRev - STANDARD
HER Identifiers	
Archives	