



JOHN MOORE HERITAGE SERVICES

**ARCHAEOLOGICAL WATCHING BRIEF**

**AT**

**LAND AT BYES LANE,  
SILCHESTER, HAMPSHIRE**

**NGR**

**SU6249560821**

**AUGUST 2020**

**REPORT PREPARED BY**                      Steffan Klemenic

**ILLUSTRATION BY**                         Iwona Brodzka and Steffan Klemenic

**EDITED BY**                                  John Moore

**AUTHORISED BY**                         John Moore

**FIELDWORK**                                Steffan Klemenic

**FIELDWORK DATE**                        10<sup>th</sup>-11<sup>th</sup> August 2020

**REPORT ISSUED**                          18<sup>th</sup> August 2020

**ENQUIRES TO**                              John Moore Heritage Services  
Pasture Farmhouse  
Boarstall  
Aylesbury  
HP18 9UR

    Tel: 01865 358300  
    Email: [info@jmheritageservices.co.uk](mailto:info@jmheritageservices.co.uk)

**JMHS Project No:**                        4221  
**OASIS No:**                                 johnmoor1-401665  
**Site Code:**                                 SIBL20  
**Archive Location:**                        A copy of the digital archive is maintained by  
John Moore Heritage Services (ID 4221).  
Digitised copies of the primary records are  
available on OASIS



**CONTENTS**

	<b>Page</b>
<b>SUMMARY</b>	1
<b>1 INTRODUCTION</b>	1
1.1 Site Location	1
1.2 Planning Background	1
1.3 Archaeological Background	1
<b>2 AIMS OF THE INVESTIGATION</b>	<b>1</b>
<b>3 STRATEGY</b>	3
3.1 Research Design	3
3.2 Methodology	3
<b>4 RESULTS</b>	3
<b>5 DISCUSSION</b>	<b>5</b>
<b>6 ARCHIVE</b>	6
<b>7 BIBLIOGRAPHY</b>	6
 <b>FIGURES AND PLATES</b>	
Figure 1.	2
Figure 2.	4
Plate 1.	5
Plate 2.	5
 <b>APPENDICES</b>	
Appendix 1. Primary Records	7
Appendix 2. OASIS Report Form	13

## **SUMMARY**

*John Moore Heritage Services carried out an archaeological watching brief on the north side of Byes Lane, Silchester, Hampshire (NGR SU6249560821). No archaeological materials, features or deposits were observed during the ground reduction for the building footprint and excavation for foundations.*

## **1 INTRODUCTION**

### **1.1 Site Location (Figure 1)**

The site is located on the north side of Byes Lane, Silchester, 109.7m east of the south junction of Byes Lane and Little London Road (NGR SU6249560821 centred).

The site lies at approximately 73m AOD. The underlying geology is London Clay Formation. The site is used as a storage yard.

### **1.2 Planning Background**

Basingstoke and Deane Borough Council granted planning permission for the erection of **1 no. new dwelling**. Due to the archaeological and historical importance of the surrounding area a condition was attached to the permission requiring a watching brief to be maintained during the course of building operations or construction works on the site. This was in line with NPPF (*February 2019*) and *Policy EM11 of the Basingstoke and Deane Local Plan 2011-2029*.

### **1.3 Archaeological Background**

The site of the proposed new house is located c.17 meters to the north of a linear earthwork, one of several such earthworks associated with the Late Iron Age precursor of the Roman town of Calleva Atrebatum that is situated c. 2km to the north east. This earthwork is a Scheduled Monument (1008727). The archaeological potential of a site so close to a Scheduled Monument is sufficient to consider the chances of exposing hitherto unrecorded archaeological features associated with the nearby earthwork are good. Similar small-scale development in the area over the past 40 years has provided very useful evidence in understanding the nature of later Iron Age and Romano-British activity.<sup>1</sup>

## **2 AIMS OF THE INVESTIGATION**

The aims of the investigation as laid out in the Written Scheme of Investigation were as follows:

- To make a record of any significant remains revealed during the course of any operations that may disturb or destroy archaeological remains.

---

<sup>1</sup> Archaeological background has been obtained from the Historic Environment, Hampshire County Council advice note.

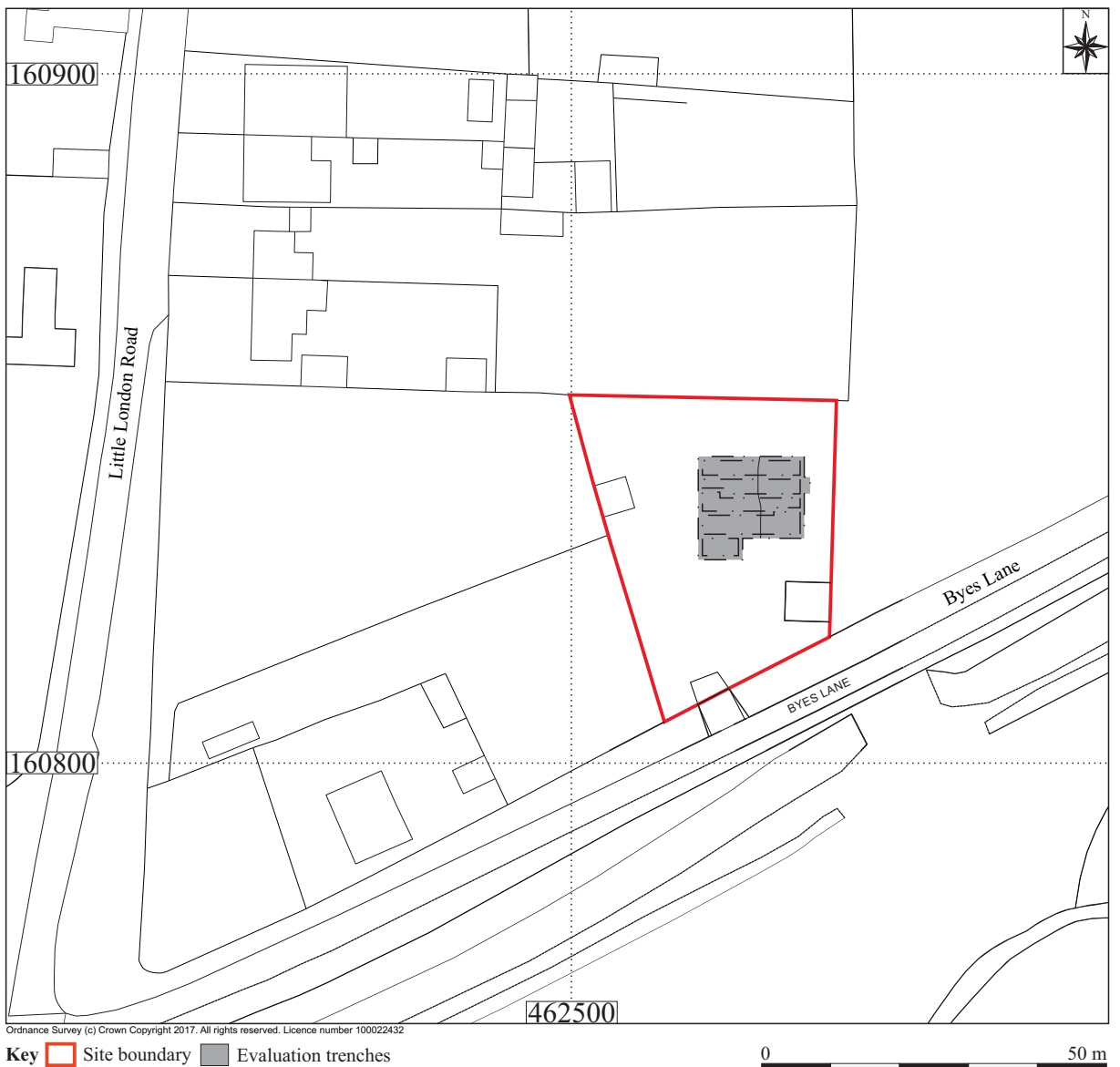
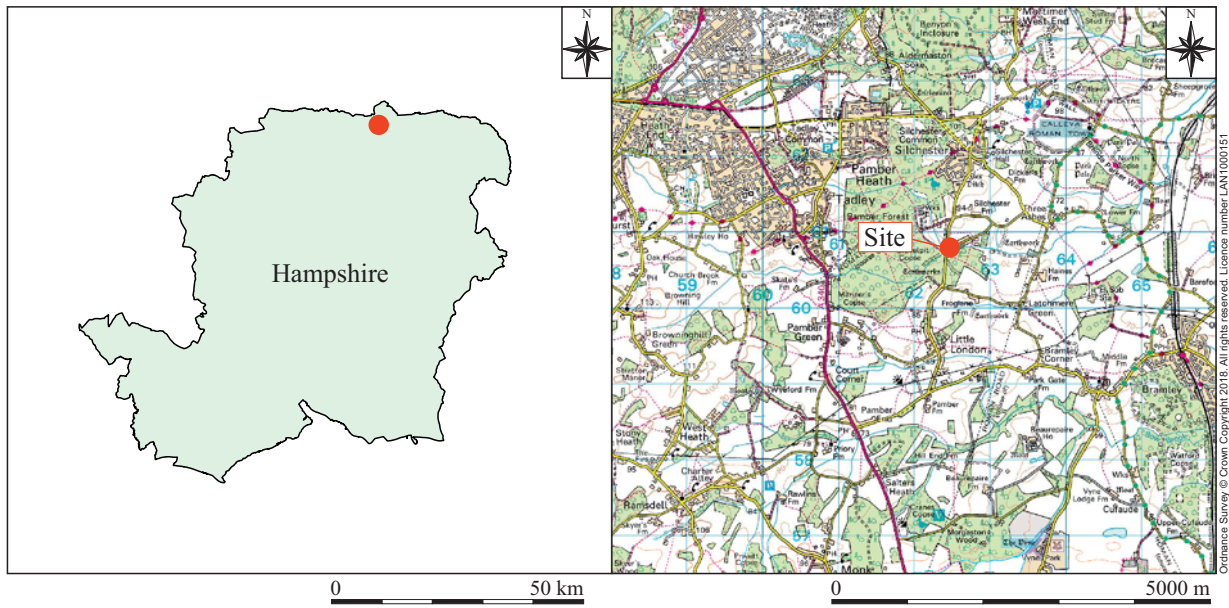

Figure 1: Site location

In particular:

- To identify, investigate at an appropriate level, and record and report on any remains associated with the Late Iron Age and Roman activity known in the vicinity

### **3 STRATEGY**

#### **3.1 Research Design**

John Moore Heritage Services carried out the work to a Written Scheme of Investigation agreed with Hampshire County Council Economy, Transport and Environment Department, the archaeological advisor to Basingstoke and Deane Borough Council.

The recording was carried out in accordance with the standards specified by the Chartered Institute for Archaeologists (2020).

#### **3.2 Methodology**

Standard John Moore Heritage Services techniques were employed throughout, involving the completion of a written record for each deposit encountered, with scale plans and section drawings compiled where appropriate. A photographic record was also produced.

Monitored works involved excavation of footings trenches for the proposed dwelling. There was no excavation for associated services, as these would be situated within a layer of made up ground, and below the finished floor level of the dwelling.

The resultant spoil from the works was visually scanned, especially for finds relating to the Iron Age and Romano British occupation.

### **4 RESULTS (Figure 2)**

All layers were assigned individual context numbers. Context numbers without brackets indicate features i.e. pit cuts, numbers in ( ) show feature fills or deposits of material, while numbers in bold indicate structural features.

The lowest deposit encountered was the geological horizon (003); this was present throughout the footings trenches, with a maximum thickness of 1.5m. Above the natural geology on the eastern side of the site was subsoil layer (002); a compact, mid green grey silt clay layer. This contained light rooting and a single ceramic land drain, it was found to be 0.46m thick at the eastern end of the excavated area, and petered out to nothing 7.5m west of the eastern edge of excavation (Plate 1, Figures 2).

Above the subsoil (002) was a topsoil (001); a loose, mid grey brown clay silt, with *c.*20% sub angular flint, and substantial rooting inclusions. The topsoil was recorded to a thickness of 0.35m and was present across site (Plates 1 & 2, Figure 2).

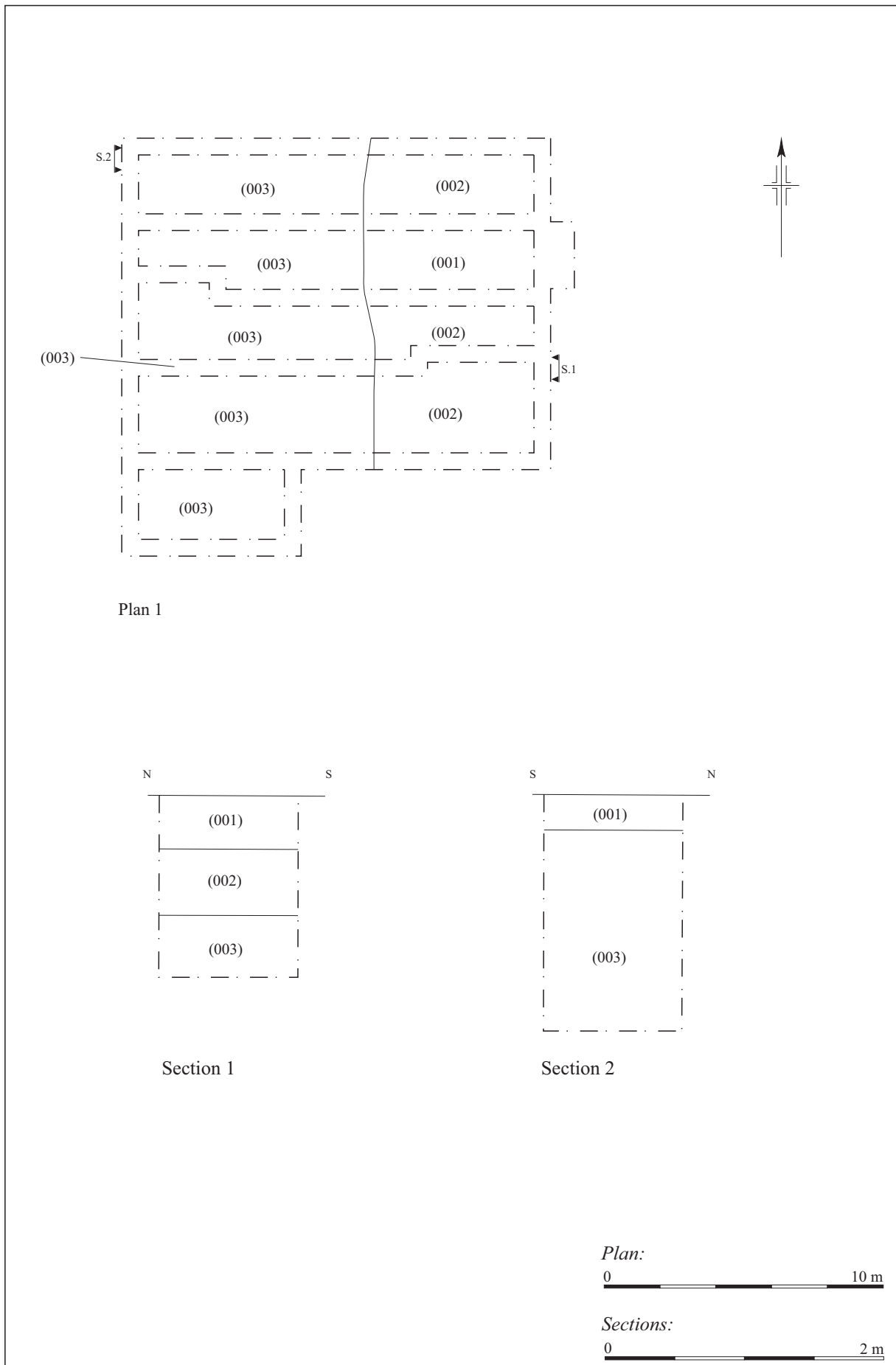

Figure 2: Site plan and Sections



Plate 1: Representative Section 1 facing east



Plate 2: Representative Section 2 facing west

No finds were recovered during the Archaeological Watching Brief.

### **Reliability of Results**

The monitored work was undertaken in extremely hot conditions with excellent cooperation from site staff, ensuring that the archaeological investigation could be undertaken without impediment.

## **5 DISCUSSION**

No archaeological materials, features or deposits were found during monitoring of the ground reduction for the building footprint and excavation for foundations.



## **6 ARCHIVE**

A Digital Archive composed of the most recent version of all digital files is maintained by John Moore Heritage Services (ID 4221) and will be made available upon request (to admin@jmheritageservices.co.uk).

The archive includes:

- Digitised primary records
- Digitised versions of primary drawings
- Digital photographs
- Report text files

Additionally, digitised copies of all the primary records and drawings will be made publicly available as an appendix to the Final Report submitted to OASIS (ID johnmoor1-401665).

## **7 BIBLIOGRAPHY**

Chartered Institute for Archaeologists, 2020 *Standard and Guidance for Archaeological Watching Briefs*



Grid Squares	Area/Trench	Context Type <b>LAYER</b>	Site Code <b>SBC20</b>	Context <b>001</b>
--------------	-------------	------------------------------	---------------------------	-----------------------

Add. Sheets	Plan Nos. <b>P.1</b>	Section Nos. <b>S.1-S.3</b>	Matrix Location
-------------	-------------------------	--------------------------------	-----------------

Photographs Slide **701-1049-1054** B&W

DEPOSIT

1 Compaction	2 Colour
3 Composition	4 Inclusions
5 Thickness	6 Extent
7 Comments	
8 Method and Conditions	

Description

- 1 LOOSE
- 2 MID GREY DRAY
- 3 CLAY SILT
- 4 c. 20% S&B ANG FLINTS, ROOTING
- 5 0.35m
- 6 ACROSS SITE
- 7
- 8 MACHINES EXCAVATED FOOTINGS

CUT

1 Shape in plan	2 Corners
3 Dimensions/Depth	
4 Break of slope-top	5 Sides
6 Break of slope-base	7 Base
8 Orientation	
9 Inclination of axis	
10 Truncation	11 Fill Nos.
12 Sketch profile	
13 Other comments	

Stratigraphic matrix

<input type="checkbox"/>	<input type="checkbox"/>	<input type="checkbox"/>	<input type="checkbox"/>	<input type="checkbox"/>
This context is		(001)		
<input type="checkbox"/>	<input type="checkbox"/>	(002)	<input type="checkbox"/>	<input type="checkbox"/>

Initials & Date  
**SK 10/8/20**

Checked by & Date  
**SK 10/8/20**

Interpretation: Internal  **External**  Structural  Other (specify)

Discussion

**TOPSOIL**

Context same as:  Finds

Levels on plan <input type="checkbox"/> sheet	none <input checked="" type="checkbox"/>	pot <input type="checkbox"/>	bone <input type="checkbox"/>	glass <input type="checkbox"/>	metal <input type="checkbox"/>	CBM <input type="checkbox"/>	wood <input type="checkbox"/>	leather <input type="checkbox"/>	burntmat. <input type="checkbox"/>
Highest <input type="checkbox"/> Lowest <input type="checkbox"/>	Other finds (specify)								

Environmental Samples Nos.  Finds sample (BM) Nos.

Small finds Nos. Finds sieving: on-site  off-site  metal detecting: in situ  on-site  off-site

Checked Interpretation

Provisional Period  Group  Initials & Date

Grid Squares	Area/Trench	Context Type <b>LAYER</b>	Site Code <b>SIBL20</b>	Context <b>002</b>
--------------	-------------	------------------------------	----------------------------	-----------------------

Add. Sheets	Plan Nos. <b>P.1</b>	Section Nos. <b>S.1</b>	Matrix Location
-------------	-------------------------	----------------------------	-----------------

Photographs Slide <b>701-1049-1050</b>	B&W	DEPOSIT
---	-----	---------

- 1 Compaction
- 2 Colour
- 3 Composition
- 4 Inclusions
- 5 Thickness
- 6 Extent
- 7 Comments
- 8 Method and Conditions

Description

1 COMPACT

2 MID GREEN GREY

3 SILT CLAY

4 LIGHT FOOTING

5 ~~0.46m~~ 0.46m

6 ~~ACROSS SITE~~ PRESENT TO 7.5m FROM ELOB

8 MACHING DUG

- CUT
- 1 Shape in plan
  - 2 Corners
  - 3 Dimensions/Depth
  - 4 Break of slope-top
  - 5 Sides
  - 6 Break of slope-base
  - 7 Base
  - 8 Orientation
  - 9 Inclination of axis
  - 10 Truncation
  - 11 Fill Nos.
  - 12 Sketch profile
  - 13 Other comments

Stratigraphic matrix

<input type="checkbox"/>	<input type="checkbox"/>	<input checked="" type="checkbox"/> (001)	<input type="checkbox"/>	<input type="checkbox"/>
This context is		<input checked="" type="checkbox"/> (002)	<input type="checkbox"/>	<input type="checkbox"/>
<input type="checkbox"/>	<input type="checkbox"/>	<input checked="" type="checkbox"/> (003)	<input type="checkbox"/>	<input type="checkbox"/>

Initials & Date  
**SK**  
**10/8/20**

Checked by & Date  
**SK**  
**10/8/20**

Interpretation: Internal  External  Structural  Other (specify)

Discussion

**subsoil**

Context same as:	Finds
Levels on plan <input type="checkbox"/> sheet	none <input checked="" type="checkbox"/> pot <input type="checkbox"/> bone <input type="checkbox"/> glass <input type="checkbox"/> metal <input type="checkbox"/> CBM <input type="checkbox"/> wood <input type="checkbox"/> leather <input type="checkbox"/> burntmat. <input type="checkbox"/>
Highest <input type="checkbox"/> Lowest <input type="checkbox"/>	Other finds (specify) <input type="checkbox"/>

Environmental Samples Nos.  Finds sample (BM) Nos.

Small finds Nos. Finds sieving: on-site  off-site  metal detecting: in situ  on-site  off-site

Checked Interpretation

Provisional Period	Group	Initials & Date
--------------------	-------	-----------------

Grid Squares <hr/>	Area/Trench <hr/>	Context Type <b>LAYER</b>	Site Code <b>SIL 20</b>	Context <b>003</b>
-----------------------	----------------------	------------------------------	----------------------------	-----------------------

Add. Sheets <hr/>	Plan Nos. <b>P-1</b>	Section Nos. <b>S.1-S.3</b>	Matrix Location <hr/>
----------------------	-------------------------	--------------------------------	--------------------------

Photographs Slide <b>701-1069-1054</b>	B&W	DEPOSIT
---	-----	---------

Description

**1 COMPACT**

**2 LIGHT MOTTLED YELLOW GREY w/ BLUE GREY BANDS**

**3 SANDY CLAY w/ GRAVEL**

**4 a. PATCHES OF GRAVEL**

**5 1.19m TO LOG**

**6 ACROSS SITE**

**8 MACHINE**

DEPOSIT

1 Compaction                      2 Colour

3 Composition                    4 Inclusions

5 Thickness                        6 Extent

7 Comments

8 Method and Conditions

CUT

1 Shape in plan                    2 Corners

3 Dimensions/Depth

4 Break of slope-top              5 Sides

6 Break of slope-base            7 Base

8 Orientation

9 Inclination of axis

10 Truncation                      11 Fill Nos.

12 Sketch profile

13 Other comments

Stratigraphic matrix

<input type="checkbox"/>	<input type="checkbox"/>	<input checked="" type="checkbox"/> (002)	<input type="checkbox"/>	<input type="checkbox"/>
This context is		<input checked="" type="checkbox"/> (003)	<input type="checkbox"/>	<input type="checkbox"/>
<input type="checkbox"/>	<input type="checkbox"/>	<input type="checkbox"/>	<input type="checkbox"/>	<input type="checkbox"/>

Initials & Date  
**SA**  
**10/8/20**

Checked by & Date  
**SA**  
**10/8/20**

Interpretation: Internal  **External**  Structural  Other (specify)

Discussion

**NATURAL**

Context same as:	Finds
Levels on plan <input type="checkbox"/> sheet	none <input checked="" type="checkbox"/> pot <input type="checkbox"/> bone <input type="checkbox"/> glass <input type="checkbox"/> metal <input type="checkbox"/> CBM <input type="checkbox"/> wood <input type="checkbox"/> leather <input type="checkbox"/> burntmat. <input type="checkbox"/>
Highest <input type="checkbox"/> Lowest <input type="checkbox"/>	Other finds (specify) <input type="checkbox"/>

Environmental Samples Nos. **X** Finds sample (BM) Nos.

Small finds Nos. Finds sieving: on-site  off-site  metal detecting: in situ  on-site  off-site

Checked Interpretation

Provisional Period	Group	Initials & Date
--------------------	-------	-----------------



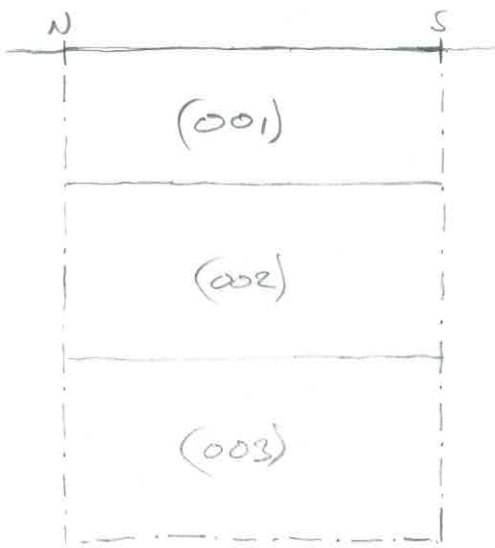

S-1: WEST FACING  
REP. SEC. 1:20  
10/8/20 SK

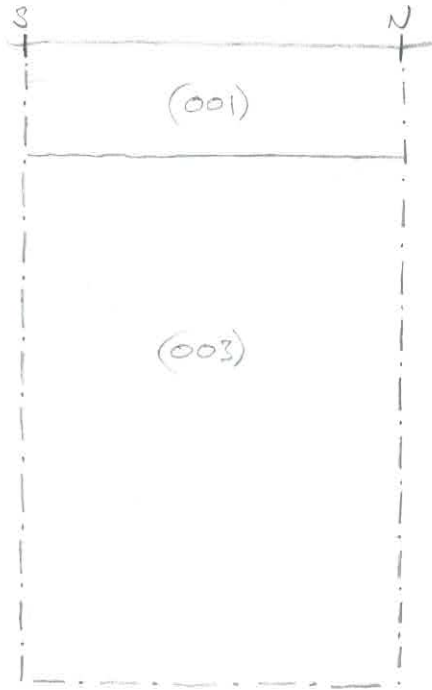

S-2: EAST FACING  
REP. SEC. 1:20  
11/8/20 SK

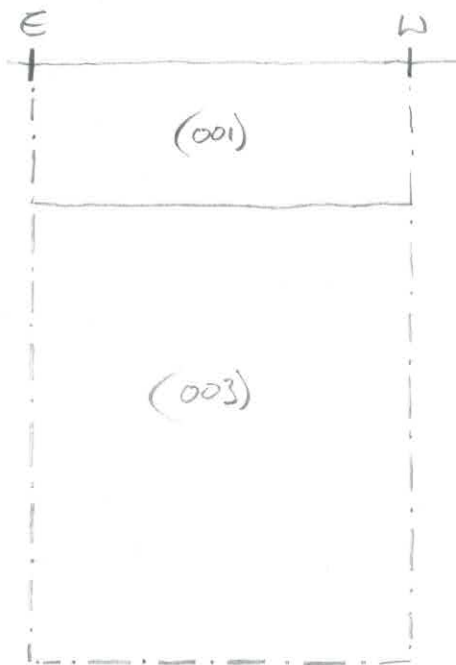

S-3: NORTH FACING  
REP. SEC. 1:20  
11/8/20 SK

# Summary for johnmoor1-401665

OASIS ID (UID)	johnmoor1-401665
Project Name	Land at Byes Lane, Silchester, Hampshire
Activity type	WATCHING BRIEF
Project Identifier(s)	4221
Planning Id	19/02239/FUL
Reason For Investigation	Planning requirement
Organisation Responsible for work	John Moore Heritage Services
Project Dates	10-Aug-2020 - 11-Aug-2020
Location	Land at Byes Lane, Silchester, Hampshire NGR : SU 62495 60821 LL : 51.3430472458242, -1.10414425308415 12 Fig : 462495,160821
Administrative Areas	Country : England County : Hampshire District : Basingstoke and Deane Parish : Silchester
Project Methodology	No archaeological materials, features or deposits were observed during the ground reduction for the building footprint and excavation for foundations.
Project Results	No archaeological materials, features or deposits were found during monitoring of the ground reduction for the building footprint and excavation for foundations.
Keywords	
HER	Hampshire Archaeology and Historic Buildings Record (AHBR) - unRev - STANDARD
HER Identifiers	
Archives	