



JOHN MOORE HERITAGE SERVICES

ARCHAEOLOGICAL WATCHING BRIEF

AT

SEACOURT PARK AND RIDE,

BOTLEY ROAD, OXFORD

NGR

SP 4929506463

AUGUST 2020

REPORT PREPARED BY Steffan Klemenic

ILLUSTRATION BY Chris Whitehead

EDITED BY John Moore

AUTHORISED BY John Moore

FIELDWORK Steffan Klemenic, Chris Whitehead

FIELDWORK DATE 26th August 2019 - 1st June 2020

REPORT ISSUED 20th August 2020

ENQUIRES TO John Moore Heritage Services
Pasture Farmhouse
Boarstall
Aylesbury
HP18 9UR

Tel: 01865 358300
Email: info@jmheritageservices.co.uk

JMHS Project No: 3955
OASIS No: johnmoor1-401854
Site Code: OXSPR 17
Archive Location: A copy of the digital archive is maintained by
John Moore Heritage Services (ID 3955)
Digitised copies of the primary records are
available on OASIS

.



CONTENTS

	Page
SUMMARY	1
1 INTRODUCTION	1
1.1 Site Location	1
1.2 Planning Background	1
1.3 Archaeological Background	1
2 AIMS OF THE INVESTIGATION	3
3 STRATEGY	3
3.1 Research Design	3
3.2 Methodology	3
4 RESULTS	3
5 DISCUSSION	6
6 ARCHIVE	7
7 BIBLIOGRAPHY	7
 FIGURES AND PLATES	
Figure 1.	2
Figure 2.	5
Plate 1.	4
Plate 2.	6
 APPENDICES	
Appendix 1. Primary Records	8
Appendix 2. Selected Digital Photographs	17
Appendix 3. OASIS Form	20

SUMMARY

John Moore Heritage Services carried out an archaeological watching brief to the east side of the existing Seacourt Park and Ride (NGR SP 4929506463). A number of deep services were monitored, before agreement with the City Archaeological Officer to cease monitoring of these. The site was then shut down over the winter of 2019 due to flooding. In the summer of 2020 JMHS was informed by the developer that work had finished on site.

1 INTRODUCTION

1.1 Site Location (Figure 1)

The proposed development site is located immediately to east of the Seacourt Park and Ride, Botley Road, Oxford, Oxfordshire (NGR SP 4929506463).

The site lies *c.* 57m OD. The underlying geology is Alluvium overlying 1st (Flood Plain) Terrace Deposits.

1.2 Planning Background

Oxford City Council has granted planning permission **16/02745/CT3** for **extension to the existing Seacourt Park and Ride to accommodate new car parking, a single storey building to provide a waiting area and toilets for customers, cycle parking, lighting, CCTV, ticket machines, new pedestrian and cycle access, landscaping together with reorganisation of the layout of existing car parking spaces, repositioning of turning circle, bus pickup and drop-off and other works incidental to the development. (additional information)**. Due to the archaeological and historical importance of the surrounding area a condition was attached to the permission requiring a watching brief to be maintained during the course of building operations or construction works on the site. This was in line with Oxford Local Plan Policy HE2.

1.3 Archaeological Background

In general terms the alluvium has the potential to seal Neolithic-Bronze Age archaeology from when the climate was dryer and the higher gravel islands between the former braided channels of the Thames. The alluvium is likely to have been deposited from the Middle Iron Age onwards and this has the potential to seal Neolithic through to Iron Age or Roman activity. A circular feature was seen on aerial photographs taken during the First World War 50-60m west of the extension footprint and has been interpreted as a possible Bronze Age barrow (HER PRN6255).

An archaeological evaluation was undertaken on the south-west part of the site by John Moore Heritage Services (JMHS 2017). The site was found to be largely truncated by a modern 19th-20th century area of dumping activity, which contained large amounts of ceramics and glass. The areas of the two trenches which were unaffected by this modern activity proved to have no archaeological features within them. One trench only showed evidence of earlier natural features below an overlying alluvial deposit, one of which contained fragments of pottery (probably later prehistoric) and animal bone.

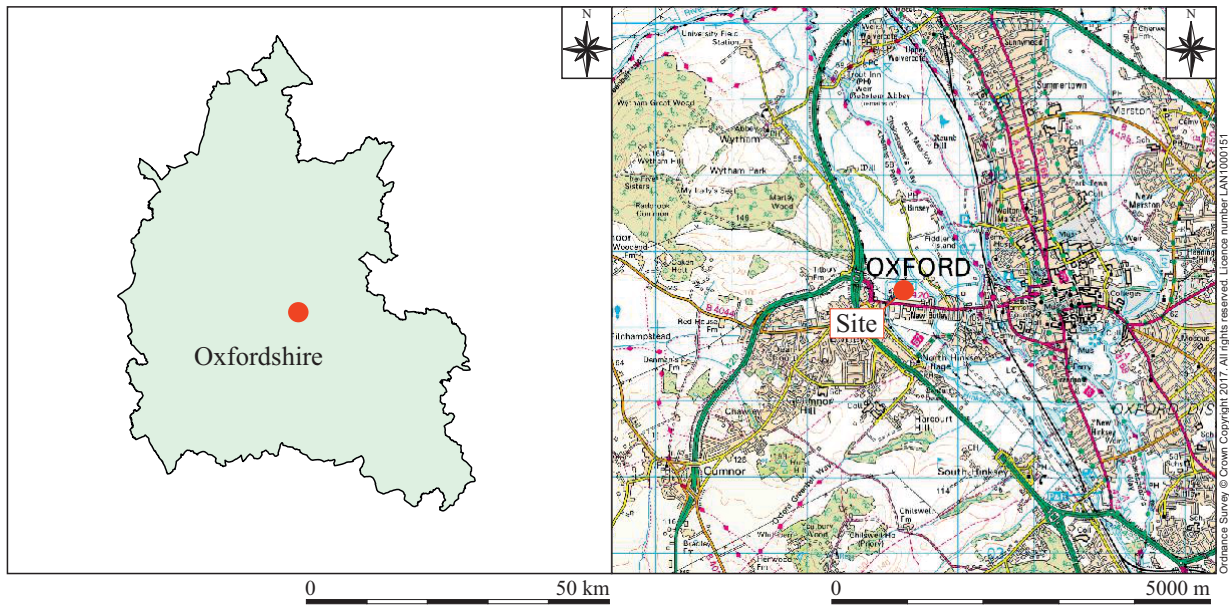

Figure 1: Site location

2 AIMS OF THE INVESTIGATION

The aims of the investigation as laid out in the Written Scheme of Investigation were as follows:

- To make a record of any significant archaeological remains revealed by the ground works.

In particular:

- To record any evidence for prehistoric activity on the site.
- Where applicable the report on the results will refer to the city, county and regional period based resource assessments and research agendas.

3 STRATEGY

3.1 Research Design

John Moore Heritage Services carried out the work to a Written Scheme of Investigation agreed with the Oxford City Archaeological Officer.

The recording was carried out in accordance with the standards specified by the Chartered Institute for Archaeologists (2014).

3.2 Methodology

Standard John Moore Heritage Services techniques were employed throughout, involving the completion of a written record for each deposit encountered. A photographic record was also produced.

Monitored works involved a small area of turf removal at the southern end of the site, the excavation of a pond in the field to the north of the site, and several service trenches on a north south alignment. The service trenches were largely at least 3m deep, and therefore mostly beyond the scope of archaeological monitoring. It was therefore agreed with the Oxford City Archaeological Officer that these services need not be monitored, and that just the subsoil/alluvium reduction to formation level across site would be necessary. The developer omitted to inform JMHS of when this phase of excavation would be carried out, and no archaeological monitoring was undertaken.

The resultant spoil from the works was visually scanned, especially for finds relating to the Prehistoric activity on site.

4 RESULTS (Figure 2)¹

All layers were assigned individual context numbers. Context numbers without brackets indicate features i.e. pit cuts, numbers in () show feature fills or deposits of material, while numbers in bold indicate structural features.

¹ It was noticed that in the report from the evaluation phase (JMHS 2017) the orientation of Trench 1 was wrong on the site plan. This has been corrected here.

The lowest deposit recorded was the geological horizon (10); this was present throughout the service trenches in the north and south fields, with a maximum thickness of 1.25m to the limit of excavation. Above context (10) was a further geological layer (06); a loose, mottled blue grey, well sorted gravel layer; 0.85m thick. Above the natural geology was an alluvial layer (09); a compact, mid yellow brown sandy clay layer. This contained bands of yellow clay and brown grey gravel and was found to be 0.5m thick (Plate 1, Figure 2). Above context (09) was an alluvial layer (03); a compact, light brown yellow silt clay layer. This contained around 2% sub rounded stone inclusions and was found to be 0.7m thick.

A late 19th-20th century dumping area [04] was exposed during the turf removal in the south portion of the site (Plate 1). The rubbish dump [04] had a single fill observed during the watching brief. This fill (05) was a mid grey brown silt clay, with common sub-rounded stone rubble inclusions measuring 20-70mm in diameter. It also contained frequent 19th-20th century ceramic and glass. This was recorded in Trench 2 during the evaluation phase on site. The full extent of the cut [04] remains unclear. A test pit excavated on the 3rd of September 2019 to gauge the stability of the deposit at the formation level extended 0.4m into fill (05) and did not find a base of cut [04]. The full extent of this feature may have been seen during the ground reduction to the formation level, however as JMHS was not informed of this it will remain unknown. A rough plan, projected from the evaluation results can be seen in Figure 2.



Plate 1: Working shot of dumping pit [04], facing east

A possible cut feature [07] was observed along the length of a service trench (Plate 2, Figure 2), however given that the service trench was 0.3m wide it was impossible to assess the form of this feature. The fill (08) of feature [07] was a waterlogged one, comprising a dark blue grey clay silt with degraded shell and round wood inclusions. It was recorded to a depth of 0.7m to the limit of excavation. It was hoped that a better understanding of this would be obtained during the ground reduction to the formation level, however as JMHS was not informed of this it will remain unknown.

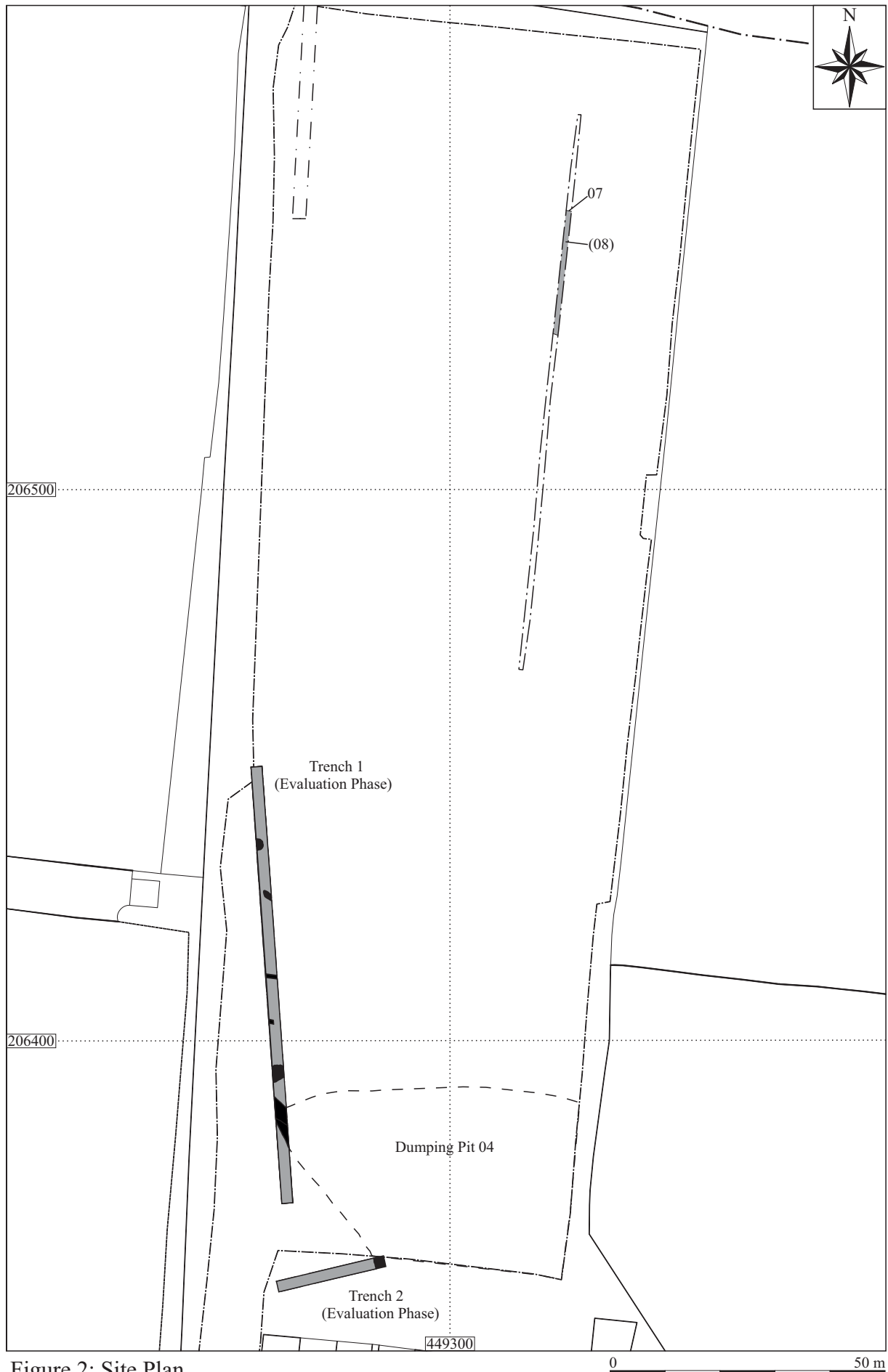

Figure 2: Site Plan



Plate 2: Unknown Feature [07] facing north east

The subsoil layer (02) was present above the dumping area [04], and the unidentified feature [07]. This was a compact, light brown grey silt clay with around 2% sub round flint inclusions. It was recorded to a depth of 0.38m across site. Above the subsoil (02) was the topsoil (01). This was a friable, mid grey brown silt loam with around 2% sub round stone inclusions up to 30mm in diameter. It was recorded to a depth of 0.2m across site.

No finds were recovered during the Archaeological Watching Brief.

Reliability of Results

The monitored work took place over a period of several months in a variety of conditions. While monitoring was underway there was generally good cooperation from site staff, however the lack of notification prior to the period of work whose monitoring would have been of most archaeological use meant that only a very limited understanding of the activity present on this site could be achieved.

5 DISCUSSION

While the scope of this report was limited by the commencement of the main phase of ground reduction with no archaeologists present on site, the relatively low impact of the ground reduction needed for a car park means that any archaeology present on site has a fair chance of survival. Any further works on this site should therefore require archaeological monitoring to mitigate against this eventuality.

6 ARCHIVE

A Digital Archive is maintained by John Moore Heritage Services (ID 3955) and will be made available upon request (to admin@jmheritageservices.co.uk). Digitised copies of all the primary records will be made publicly available as appendix to the Final Report submitted to OASIS (ID johnmoor1-302771).

7 BIBLIOGRAPHY

Chartered Institute for Archaeologists, 2020 *Standard and Guidance for Archaeological Watching Briefs*

John Moore Heritage Services, 2017 *An Archaeological Evaluation at Seacourt Park and Ride, Botley Road, Oxford*

Grid Squares	Area/Trench	Context Type LAYER	Site Code OXSPR17	Context 01
--------------	-------------	------------------------------	-----------------------------	----------------------

Add. Sheets	Plan Nos.	Section Nos.	Matrix Location
-------------	-----------	--------------	-----------------

Photographs Slide **121-1483-5** **B&W**

DEPOSIT

1 Compaction	2 Colour
3 Composition	4 Inclusions
5 Thickness	6 Extent
7 Comments	
8 Method and Conditions	

Description

- 1 **FRIABLE**
- 2 **MID GREY BROWN**
- 3 **SILT LOAM**
- 4 **ca. 2% SUBROUND STONE ≥ 30mm**
- 5 **NO. 2M**
- 6 **ACROSS SITE**
- 8 **MACHINE EXCAVATED**

CUT

1 Shape in plan	2 Corners
3 Dimensions/Depth	
4 Break of slope-top	5 Sides
6 Break of slope-base	7 Base
8 Orientation	
9 Inclination of axis	
10 Truncation	11 Fill Nos.
12 Sketch profile	
13 Other comments	

Stratigraphic matrix

<input type="checkbox"/>	<input type="checkbox"/>	<input type="checkbox"/>	<input type="checkbox"/>	<input type="checkbox"/>
This context is		<input type="checkbox" value="01"/>	<input type="checkbox"/>	<input type="checkbox"/>
<input type="checkbox"/>	<input type="checkbox"/>	<input type="checkbox" value="02"/>	<input type="checkbox"/>	<input type="checkbox"/>

Initials & Date
JK 20/9/19

Checked by & Date

Interpretation: Internal **External** Structural Other (specify)

Discussion

TOPSOIL

Context same as: **Finds**

Levels on plan <input type="checkbox"/> sheet	none <input checked="" type="checkbox"/> pot <input type="checkbox"/> bone <input type="checkbox"/> glass <input type="checkbox"/> metal <input type="checkbox"/> CBM <input type="checkbox"/> wood <input type="checkbox"/> leather <input type="checkbox"/> burntmat. <input type="checkbox"/>
	Other finds (specify)

Environmental Samples Nos. Finds sample (BM) Nos.

Small finds Nos.

Finds sieving: on-site off-site metal detecting: in situ on-site off-site

Checked Interpretation

Provisional Period	Group	Initials & Date
--------------------	-------	-----------------

Grid Squares	Area/Trench	Context Type LAYER	Site Code OXSPR17	Context 02
--------------	-------------	------------------------------	-----------------------------	----------------------

Add. Sheets	Plan Nos.	Section Nos.	Matrix Location
-------------	-----------	--------------	-----------------

Photographs Slide **121-1483-1485 B&W**

Description

1 ~~compact~~ COMPACT

2 LIGHT ~~GREY~~ BROWN ~~CLAY~~ BROWN GREY

3 SILT CLAY

4 c. 2% SUB SAND FINE

5 0-38m

6 ACROSS SITE

8 MACHINE EXCAVATED

DEPOSIT

1 Compaction	2 Colour
3 Composition	4 Inclusions
5 Thickness	6 Extent
7 Comments	
8 Method and Conditions	

CUT

1 Shape in plan	2 Corners
3 Dimensions/Depth	
4 Break of slope-top	5 Sides
6 Break of slope-base	7 Base
8 Orientation	
9 Inclination of axis	
10 Truncation	11 Fill Nos.
12 Sketch profile	
13 Other comments	

Stratigraphic matrix

<input type="checkbox"/>	<input type="checkbox"/>	<input checked="" type="checkbox"/> (01)	<input type="checkbox"/>	<input type="checkbox"/>
This context is		<input checked="" type="checkbox"/> (02)	<input type="checkbox"/>	<input type="checkbox"/>
<input type="checkbox"/>	<input type="checkbox"/>	<input checked="" type="checkbox"/> (03)	<input type="checkbox"/>	<input type="checkbox"/>

Initials & Date

SK 20/9/19

Checked by & Date

Interpretation: Internal **External** Structural Other (specify)

Discussion

SUBSOIL

Context same as:	Finds
Levels on plan <input type="checkbox"/> sheet	none <input type="checkbox"/> pot <input type="checkbox"/> bone <input checked="" type="checkbox"/> glass <input type="checkbox"/> metal <input type="checkbox"/> CBM <input checked="" type="checkbox"/> wood <input type="checkbox"/> leather <input type="checkbox"/> burntmat. <input type="checkbox"/> Other finds (specify) NONE RETAINED

Environmental Samples Nos. Finds sample (BM) Nos.

Small finds Nos. Finds sieving: on-site off-site metal detecting: in situ on-site off-site

Checked Interpretation

Provisional Period	Group	Initials & Date
--------------------	-------	-----------------

Grid Squares <i>/</i>	Area/Trench <i>/</i>	Context Type <i>LAYER</i>	Site Code <i>OXSPR17</i>	Context <i>03</i>
--------------------------	-------------------------	------------------------------	-----------------------------	----------------------

Add. Sheets <i>/</i>	Plan Nos. <i>/</i>	Section Nos.	Matrix Location
-------------------------	-----------------------	--------------	-----------------

Photographs Slide *121-1483-1485 B&W*
121-1496 - 1500

DEPOSIT

1 Compaction	2 Colour
3 Composition	4 Inclusions
5 Thickness	6 Extent
7 Comments	
8 Method and Conditions	

Description *1 COMPACT*
2 LIGHT BROWN SUELLA
3 SILTCLAY
4 c. 2% SUBROUND STONE > 30mm
5 c. 0.7m
6 SEEN W SERVICES N. FIELD
& POND
8 MACHINE

CUT

1 Shape in plan	2 Corners
3 Dimensions/Depth	
4 Break of slope-top	5 Sides
6 Break of slope-base	7 Base
8 Orientation	
9 Inclination of axis	
10 Truncation	11 Fill Nos.
12 Sketch profile	
13 Other comments	

Stratigraphic matrix

<input type="checkbox"/>	<input type="checkbox"/>	<input checked="" type="checkbox"/> (02)	<input type="checkbox"/>	<input type="checkbox"/>
This context is		<input checked="" type="checkbox"/> (03)		
<input type="checkbox"/>	<input type="checkbox"/>	<input checked="" type="checkbox"/> (06)	<input type="checkbox"/>	<input type="checkbox"/>

Initials & Date
SLC 24/9/19

Checked by & Date

Interpretation: Internal **External** Structural Other (specify)

Discussion
ALLUVIUM

Context same as:	Finds																		
Levels on plan <input type="checkbox"/> sheet	<table border="0"> <tr> <td>none</td> <td>pot</td> <td>bone</td> <td>glass</td> <td>metal</td> <td>CBM</td> <td>wood</td> <td>leather</td> <td>burntmat.</td> </tr> <tr> <td><input checked="" type="checkbox"/></td> <td><input type="checkbox"/></td> <td><input type="checkbox"/></td> <td><input type="checkbox"/></td> <td><input type="checkbox"/></td> <td><input type="checkbox"/></td> <td><input type="checkbox"/></td> <td><input type="checkbox"/></td> <td><input type="checkbox"/></td> </tr> </table>	none	pot	bone	glass	metal	CBM	wood	leather	burntmat.	<input checked="" type="checkbox"/>	<input type="checkbox"/>	<input type="checkbox"/>	<input type="checkbox"/>	<input type="checkbox"/>	<input type="checkbox"/>	<input type="checkbox"/>	<input type="checkbox"/>	<input type="checkbox"/>
none	pot	bone	glass	metal	CBM	wood	leather	burntmat.											
<input checked="" type="checkbox"/>	<input type="checkbox"/>	<input type="checkbox"/>	<input type="checkbox"/>	<input type="checkbox"/>	<input type="checkbox"/>	<input type="checkbox"/>	<input type="checkbox"/>	<input type="checkbox"/>											
	Other finds (specify)																		

Environmental Samples Nos. */* Finds sample (BM) Nos. */*

Small finds Nos. Finds sieving: on-site off-site metal detecting: in situ on-site off-site

Checked Interpretation

Provisional Period	Group	Initials & Date
--------------------	-------	-----------------

Grid Squares	Area/Trench	Context Type <i>LAYER</i>	Site Code <i>OXSPR17</i>	Context <i>06</i>
--------------	-------------	------------------------------	-----------------------------	----------------------

Add. Sheets	Plan Nos.	Section Nos.	Matrix Location
-------------	-----------	--------------	-----------------

Photographs Slide *121-1496-1500* B&W

DEPOSIT

1 Compaction	2 Colour
3 Composition	4 Inclusions
5 Thickness	6 Extent
7 Comments	
8 Method and Conditions	

Description *1 LOOSE*

2 MOTTLED BLUE/GREY

3 SILT SAND

4 c. 80% WELL SORTED SUBROUND GRAVEL > 20mm

5 UNKNOWN ORIGIN TO LOE

6 SEEN IN SERVICES ~~IN FIELD~~

7 NR S FIELDS

8 MACHINE

CUT

1 Shape in plan	2 Corners
3 Dimensions/Depth	
4 Break of slope-top	5 Sides
6 Break of slope-base	7 Base
8 Orientation	
9 Inclination of axis	
10 Truncation	11 Fill Nos.
12 Sketch profile	
13 Other comments	

Stratigraphic matrix

<input type="checkbox"/>	<input type="checkbox"/>	<input checked="" type="checkbox"/> <i>(03)</i>	<input type="checkbox"/>	<input type="checkbox"/>
This context is		<input checked="" type="checkbox"/> <i>(06)</i>	<input type="checkbox"/>	<input type="checkbox"/>
<input type="checkbox"/>	<input type="checkbox"/>	<input type="checkbox"/>	<input type="checkbox"/>	<input type="checkbox"/>

Initials & Date

SR 24/9/19

Checked by & Date

Interpretation: Internal External Structural Other (specify)

Discussion

NATURAL GRAVEL

Context same as:	Finds																		
Levels on plan <input type="checkbox"/> sheet	<table border="0"> <tr> <td>none</td> <td>pot</td> <td>bone</td> <td>glass</td> <td>metal</td> <td>CBM</td> <td>wood</td> <td>leather</td> <td>burntmat.</td> </tr> <tr> <td><input checked="" type="checkbox"/></td> <td><input type="checkbox"/></td> <td><input type="checkbox"/></td> <td><input type="checkbox"/></td> <td><input type="checkbox"/></td> <td><input type="checkbox"/></td> <td><input type="checkbox"/></td> <td><input type="checkbox"/></td> <td><input type="checkbox"/></td> </tr> </table>	none	pot	bone	glass	metal	CBM	wood	leather	burntmat.	<input checked="" type="checkbox"/>	<input type="checkbox"/>	<input type="checkbox"/>	<input type="checkbox"/>	<input type="checkbox"/>	<input type="checkbox"/>	<input type="checkbox"/>	<input type="checkbox"/>	<input type="checkbox"/>
none	pot	bone	glass	metal	CBM	wood	leather	burntmat.											
<input checked="" type="checkbox"/>	<input type="checkbox"/>	<input type="checkbox"/>	<input type="checkbox"/>	<input type="checkbox"/>	<input type="checkbox"/>	<input type="checkbox"/>	<input type="checkbox"/>	<input type="checkbox"/>											
Environmental Samples Nos.	Other finds (specify)																		

Finds sample (BM) Nos.

Small finds Nos.

Finds sieving: on-site off-site metal detecting: in situ on-site off-site

Checked Interpretation

Provisional Period	Group	Initials & Date
--------------------	-------	-----------------

Grid Squares	Area/Trench	Context Type Context FTU	Site Code OXSPR17	Context 0708
--------------	-------------	--	----------------------	-----------------

Add. Sheets	Plan Nos. 1	Section Nos.	Matrix Location
-------------	----------------	--------------	-----------------

Photographs Slide 121-1504-1510 B&W	DEPOSIT 1 Compaction 2 Colour 3 Composition 4 Inclusions 5 Thickness 6 Extent 7 Comments 8 Method and Conditions
Description 1 SOFT 2 DARK BLUE GREY 3 CLAY SILT 4 DEGRADED SHELL, SMALL ROUND WOOD. 5 0-7m TO LOG (NOT FULLY EXL) 6 7 8	CUT 1 Shape in plan 2 Corners 3 Dimensions/Depth 4 Break of slope-top 5 Sides 6 Break of slope-base 7 Base 8 Orientation 9 Inclination of axis 10 Truncation 12 Sketch profile 13 Other comments 11 Fill Nos.

Stratigraphic matrix This context is <table style="margin-left: 20px;"> <tr> <td><input type="checkbox"/></td> <td><input type="checkbox"/></td> <td><input checked="" type="checkbox"/> (08)</td> <td><input checked="" type="checkbox"/> (02)</td> <td><input type="checkbox"/></td> </tr> <tr> <td><input type="checkbox"/></td> <td><input type="checkbox"/></td> <td><input checked="" type="checkbox"/> (04)</td> <td><input checked="" type="checkbox"/> (08)</td> <td><input type="checkbox"/></td> </tr> <tr> <td><input type="checkbox"/></td> <td><input type="checkbox"/></td> <td><input checked="" type="checkbox"/> (09)</td> <td><input checked="" type="checkbox"/> (07)</td> <td><input type="checkbox"/></td> </tr> </table>	<input type="checkbox"/>	<input type="checkbox"/>	<input checked="" type="checkbox"/> (08)	<input checked="" type="checkbox"/> (02)	<input type="checkbox"/>	<input type="checkbox"/>	<input type="checkbox"/>	<input checked="" type="checkbox"/> (04)	<input checked="" type="checkbox"/> (08)	<input type="checkbox"/>	<input type="checkbox"/>	<input type="checkbox"/>	<input checked="" type="checkbox"/> (09)	<input checked="" type="checkbox"/> (07)	<input type="checkbox"/>	Initials & Date Checked by & Date
<input type="checkbox"/>	<input type="checkbox"/>	<input checked="" type="checkbox"/> (08)	<input checked="" type="checkbox"/> (02)	<input type="checkbox"/>												
<input type="checkbox"/>	<input type="checkbox"/>	<input checked="" type="checkbox"/> (04)	<input checked="" type="checkbox"/> (08)	<input type="checkbox"/>												
<input type="checkbox"/>	<input type="checkbox"/>	<input checked="" type="checkbox"/> (09)	<input checked="" type="checkbox"/> (07)	<input type="checkbox"/>												

Interpretation: Internal External Structural Other (specify)

Discussion

Context same as:	Finds
Levels on plan <input type="checkbox"/> sheet	none pot bone glass metal CBM wood leather burntmat. <input type="checkbox"/> <input type="checkbox"/> <input type="checkbox"/> <input type="checkbox"/> <input type="checkbox"/> <input type="checkbox"/> <input type="checkbox"/> <input type="checkbox"/> <input type="checkbox"/>
	Other finds (specify)

Environmental Samples Nos.	Finds sample (BM) Nos.
----------------------------	------------------------

Small finds Nos.
 Finds sieving: on-site off-site metal detecting: in situ on-site off-site

Checked Interpretation

Provisional Period	Group	Initials & Date
--------------------	-------	-----------------

Grid Squares	Area/Trench	Context Type LAYER	Site Code OxSPR19	Context 09
--------------	-------------	------------------------------	-----------------------------	----------------------

Add. Sheets	Plan Nos. 1	Section Nos.	Matrix Location
-------------	-----------------------	--------------	-----------------

Photographs Slide B&W

DEPOSIT

1 Compaction	2 Colour
3 Composition	4 Inclusions
5 Thickness	6 Extent
7 Comments	
8 Method and Conditions	

Description

1 **COMPACT**

2 **MID YELLOW BROWN**

3 **SANDY CLAY**

4 **BANDS OF YELLOW CLAY & BROWN/GREY**

5 **c. 0.5m GRAVEL**

6 **AG**

7

8 **MACH. NE**

CUT

1 Shape in plan	2 Corners
3 Dimensions/Depth	
4 Break of slope-top	5 Sides
6 Break of slope-base	7 Base
8 Orientation	
9 Inclination of axis	
10 Truncation	11 Fill Nos.
12 Sketch profile	
13 Other comments	

Stratigraphic matrix

<input type="checkbox"/>	<input type="checkbox"/>	<input checked="" type="checkbox"/> (03)	<input type="checkbox"/>	<input type="checkbox"/>
This context is		<input checked="" type="checkbox"/> (09)	<input type="checkbox"/>	<input type="checkbox"/>
<input type="checkbox"/>	<input type="checkbox"/>	<input checked="" type="checkbox"/> (06)	<input type="checkbox"/>	<input type="checkbox"/>

Initials & Date

sk 26/9/19

Checked by & Date

Interpretation: Internal External Structural Other (specify)

Discussion

SANDY CLAY NAT

(LIKELY LOWER ALLUVIUM LAYER)

Context same as:	Finds																		
Levels on plan <input type="checkbox"/> sheet	<table border="0"> <tr> <td>none</td> <td>pot</td> <td>bone</td> <td>glass</td> <td>metal</td> <td>CBM</td> <td>wood</td> <td>leather</td> <td>burntmat.</td> </tr> <tr> <td><input checked="" type="checkbox"/></td> <td><input type="checkbox"/></td> <td><input type="checkbox"/></td> <td><input type="checkbox"/></td> <td><input type="checkbox"/></td> <td><input type="checkbox"/></td> <td><input type="checkbox"/></td> <td><input type="checkbox"/></td> <td><input type="checkbox"/></td> </tr> </table>	none	pot	bone	glass	metal	CBM	wood	leather	burntmat.	<input checked="" type="checkbox"/>	<input type="checkbox"/>	<input type="checkbox"/>	<input type="checkbox"/>	<input type="checkbox"/>	<input type="checkbox"/>	<input type="checkbox"/>	<input type="checkbox"/>	<input type="checkbox"/>
none	pot	bone	glass	metal	CBM	wood	leather	burntmat.											
<input checked="" type="checkbox"/>	<input type="checkbox"/>	<input type="checkbox"/>	<input type="checkbox"/>	<input type="checkbox"/>	<input type="checkbox"/>	<input type="checkbox"/>	<input type="checkbox"/>	<input type="checkbox"/>											
	Other finds (specify)																		

Environmental Samples Nos. Finds sample (BM) Nos.

Small finds Nos.

Finds sieving: on-site off-site metal detecting: in situ on-site off-site

Checked Interpretation

Provisional Period	Group	Initials & Date
--------------------	-------	-----------------

Grid Squares <i>[Handwritten scribble]</i>	Area/Trench <i>[Handwritten scribble]</i>	Context Type LAYER	Site Code OXSPR19	Context 10
---	--	-----------------------	----------------------	---------------

Add. Sheets <i>[Handwritten scribble]</i>	Plan Nos.	Section Nos.	Matrix Location
--	-----------	--------------	-----------------

Photographs Slide	B&W	DEPOSIT
-------------------	-----	---------

Description

1 LOOSE

2 MID BLUE GRAY

3 SILT SAND

4 c. 70% GRAVEL (SUBANG 2 70mm)

5

6

7

8

DEPOSIT

1 Compaction 2 Colour

3 Composition 4 Inclusions

5 Thickness 6 Extent

7 Comments

8 Method and Conditions

CUT

1 Shape in plan 2 Corners

3 Dimensions/Depth

4 Break of slope-top 5 Sides

6 Break of slope-base 7 Base

8 Orientation

9 Inclination of axis

10 Truncation 11 Fill Nos.

12 Sketch profile

13 Other comments

Stratigraphic matrix

<input type="checkbox"/>	<input type="checkbox"/>	(06)	<input type="checkbox"/>	<input type="checkbox"/>
This context is		(10)	<input type="checkbox"/>	<input type="checkbox"/>
<input type="checkbox"/>	<input type="checkbox"/>	<input type="checkbox"/>	<input type="checkbox"/>	<input type="checkbox"/>

Initials & Date

SR 26/9/19

Checked by & Date

Interpretation: Internal External Structural Other (specify)

Discussion

LOWER LAYER OF NAT. GRAVEL

Context same as:	Finds
Levels on plan <input type="checkbox"/> sheet	none <input checked="" type="checkbox"/> pot <input type="checkbox"/> bone <input type="checkbox"/> glass <input type="checkbox"/> metal <input type="checkbox"/> CBM <input type="checkbox"/> wood <input type="checkbox"/> leather <input type="checkbox"/> burntmat. <input type="checkbox"/> Other finds (specify)

Environmental Samples Nos. Finds sample (BM) Nos.

Small finds Nos.

Finds sieving: on-site off-site metal detecting: in situ on-site off-site

Checked Interpretation

Provisional Period	Group	Initials & Date
--------------------	-------	-----------------

SITE NAME: SEACOURT PARK RIDE SITE CODE: OXSPR17

Memory Card No. Sheet 1 of

Date	Image number(s)	View	Scale(s)	Context/Comment	Film Neg No.
27/8/19	121-1460			GEN SHOTS OF SITE	
	1464			PRE-EXC.	
3/9/19	1465			TOPOF BOTTLE DUMP	
12/9/19	1466			GEN SHOTS OF SITE AFTER	
	1			TURF STRIP.	
	1482			↓	
17/9/19	1483	E	1m	W-FACING REP SEC. AT	
	1484	E	1m	DEEPEST PART OF POND	
	1485	NE	1m	OBLIQUE " "	
	1486		2x1m	GEN SHOTS AROUND	
	1	JARROWS		DEEPEST (ONLY WATCHED)	
	1491			POND AREA	
	1492			WORKING SHOTS PUMPING	
20/9/19	1494			STN.	
	1495			GRAVEL NATURAL PUMPING STN	
	1496-7			E.F.S. PUMPING STN.	
24/9/19	1498			GEN SHOT MANHOLE NHT TO ↑	
	1499			" "	
	1500			WORKING SHOT DRAINAGE TR.	
	1501			WORKING SHOT ELECTRIC TR	
	1		1m	REP. SECs. ALONG "	
	1511	JARROWS			
	1512			DRAINAGE MANIFOLD	
26/9/19	1513			WORKING SHOT DRAINAGE DITCH	
	1514			WORKING SHOT DRAIN TR	
	1515			WORKING SHOT DRAINAGE DITCH	
	1516			" "	
	1517			WORKING SHOT DRAINAGE TR.	
27/9/19	1518			" "	
	1520			" "	



Modern dumping area



Representative section



Section of pond



Service trench



Representative section of service trench



Drainage ditch

OASIS DATA COLLECTION FORM: England

[List of Projects](#) | [Manage Projects](#) | [Search Projects](#) | [New project](#) | [Change your details](#) | [HER coverage](#) | [Change country](#) | [Log out](#)

Printable version

OASIS ID: johnmoor1-401854

Project details

Project name	Seacourt Park and Ride, Botley Road, Oxford
Short description of the project	John Moore Heritage Services carried out an archaeological watching brief to the east side of the existing Seacourt Park and Ride (NGR SP 4929506463). A number of deep services were monitored, before agreement with the County Archaeological Representative to cease monitoring of these. The site was then shut down over the winter of 2019 due to flooding. In the summer of 2020 JMHS was informed by the developer that work had finished on site.
Project dates	Start: 26-08-2019 End: 01-06-2020
Previous/future work	Yes / No
Any associated project reference codes	OXSPR 17 - Sitecode
Any associated project reference codes	3955 - Contracting Unit No.
Any associated project reference codes	16/02745/CT3 - Planning Application No.
Type of project	Recording project
Site status	None
Current Land use	Grassland Heathland 3 - Disturbed
Monument type	RUBBISH DUMP Modern
Significant Finds	POTTERY Modern
Investigation type	""Watching Brief""
Prompt	Planning condition

Project location

Country	England
Site location	OXFORDSHIRE OXFORD OXFORD Seacourt Park and Ride, Botley Road, Oxford
Postcode	OX2 0HP
Study area	29525 Square metres
Site coordinates	SP 49295 06463 51.754231971272 -1.285774376121 51 45 15 N 001 17 08 W Point
Height OD / Depth	Min: 2.05m Max: 3.3m

Project creators

Name of Organisation	John Moore Heritage Services
Project brief originator	Oxford City Council
Project design originator	John Moore
Project director/manager	John Moore
Project supervisor	Steffan Klemenic
Type of sponsor/funding body	City Council
Name of sponsor/funding body	Oxford City Council

Project archives

Physical Archive Exists?	No
Digital Archive recipient	OASIS
Digital Archive ID	3955
Digital Contents	"Stratigraphic","other"
Digital Media available	"GIS","Images raster / digital photography","Text"
Digital Archive notes	Digital files related to the project are maintained by John Moore Heritage Services (ID 3955) and will be made available upon request (to admin@jmheritageservices.co.uk).
Paper Archive Exists?	No

Project bibliography 1

Publication type	Grey literature (unpublished document/manuscript)
Title	ARCHAEOLOGICAL WATCHING BRIEF AT SEACOURT PARK AND RIDE, BOTLEY ROAD, OXFORD
Author(s)/Editor(s)	Klemenic, S.
Author(s)/Editor(s)	Moore, J.
Other bibliographic details	JMHS report no.3955
Date	2020
Issuer or publisher	John Moore Heritage Services
Place of issue or publication	Boarstall
Description	22 A4 pages PDF including primary records and a selection of digital photographs
Entered by	Simona Denis (admin@jmheritageservices.co.uk)
Entered on	4 September 2020

OASIS:

Please e-mail [Historic England](#) for OASIS help and advice

© ADS 1996-2012 Created by [Jo Gilham](#) and [Jen Mitcham](#), [email](#) Last modified Wednesday 9 May 2012

Cite only: <http://www.oasis.ac.uk/form/print.cfm> for this page

[Cookies](#) [Privacy Policy](#)