



JOHN MOORE HERITAGE SERVICES

AN ARCHAEOLOGICAL EVALUATION

AT

LAND BEHIND HOME FARM CLOSE,

AMBROSDEN, OXFORDSHIRE

NGR: SP 6006 1926

JANUARY 2021

REPORT PREPARED BY Gavin Davis

ILLUSTRATION BY Iwona Brodzka and Chris Whitehead

EDITED BY John Moore

AUTHORISED BY John Moore

FIELDWORK 11th January 2021

REPORT ISSUED 15th January 2021

ENQUIRES TO John Moore Heritage Services
Pasture Farmhouse
Boarstall
Aylesbury
HP18 9UR

Tel: 01865 358300
Email: info@jmheritageservices.co.uk

JMHS Project No: 4391
OASIS No: johnmoor1-412529
Site Code: AMBHFC 20
Archive Location: A copy of the digital archive is maintained by John Moore Heritage Services (4391). Digitised copies of the primary records are available on OASIS



CONTENTS

	Page
<i>SUMMARY</i>	1
1 INTRODUCTION	1
1.1 Site Location	1
1.2 Planning Background	1
1.3 Archaeological and Historical Background	1
2 AIMS OF THE INVESTIGATION	3
3 STRATEGY	3
3.1 Research Design	3
3.2 Methodology	3
4 RESULTS	4
5 FINDS	4
6 DISCUSSION	4
7 ARCHIVE	4
8 BIBLIOGRAPHY	4
FIGURES	
Figure 1. Site location	2
Figure 2. Trench Plans and Sections	5
PLATES	
Plate 1. Trenches 5 and 6	4
APPENDICES	
Appendix 1. Context Inventory	6
Appendix 2. Primary Records	7
Appendix 3. Selected Photographs	12
Appendix 4. OASIS Report Form	14

Summary

John Moore Heritage Services carried out an evaluation at land behind Home Farm Close, Ambrosden, Oxfordshire. No archaeological finds or features were identified on the site.

1 INTRODUCTION

1.1 Site Location (Figure 1)

The site is located behind Home Farm Close on the south west side of Ambrosden (SP 6006 1926). The application site is currently in agricultural use. The site is situated at approximately 60 metres OD and the underlying geology is shown as Cornbrash. The site is 0.214ha in size.

1.2 Planning Background

Planning permission is to be applied for from Cherwell District Council for a small housing scheme. Due to the potential of the site to contain archaeological remains an archaeological evaluation is to be carried out prior to the application being made.

1.3 Archaeological and Historical Background

The site is located in an area of archaeological potential located 180m to the north west of a medieval Manor House (PRN5657); a substantial building which returned 13 hearths in 1665, during the ownership of Francis Mildmay, and was still extant when a new house was built to the north in 1673. The exact location of the manor house is unknown and it is therefore possible that aspects of this Manor and could be disturbed by this development. The site of a second large house, Ambrosden Hall, is located 110m north of the proposal site. This Hall was constructed after 1673 and pulled down in 1768.

The site is also located 120m south of a series of undated features that were recorded, along with Neolithic and Bronze Age flint tools, during a pipeline excavation (PRN 16825). Recent archaeological work 650m to the north-west of the site has recorded a series of Iron Age roundhouses and Roman and Saxon ditches (PRN 27985).

The above has been taken from the Oxfordshire County Archaeological Services' advice note for an adjacent planning application (20/01707/F).

An evaluation immediately to the east of the site found an undated ditch and postmedieval pits (JMHS 2019).

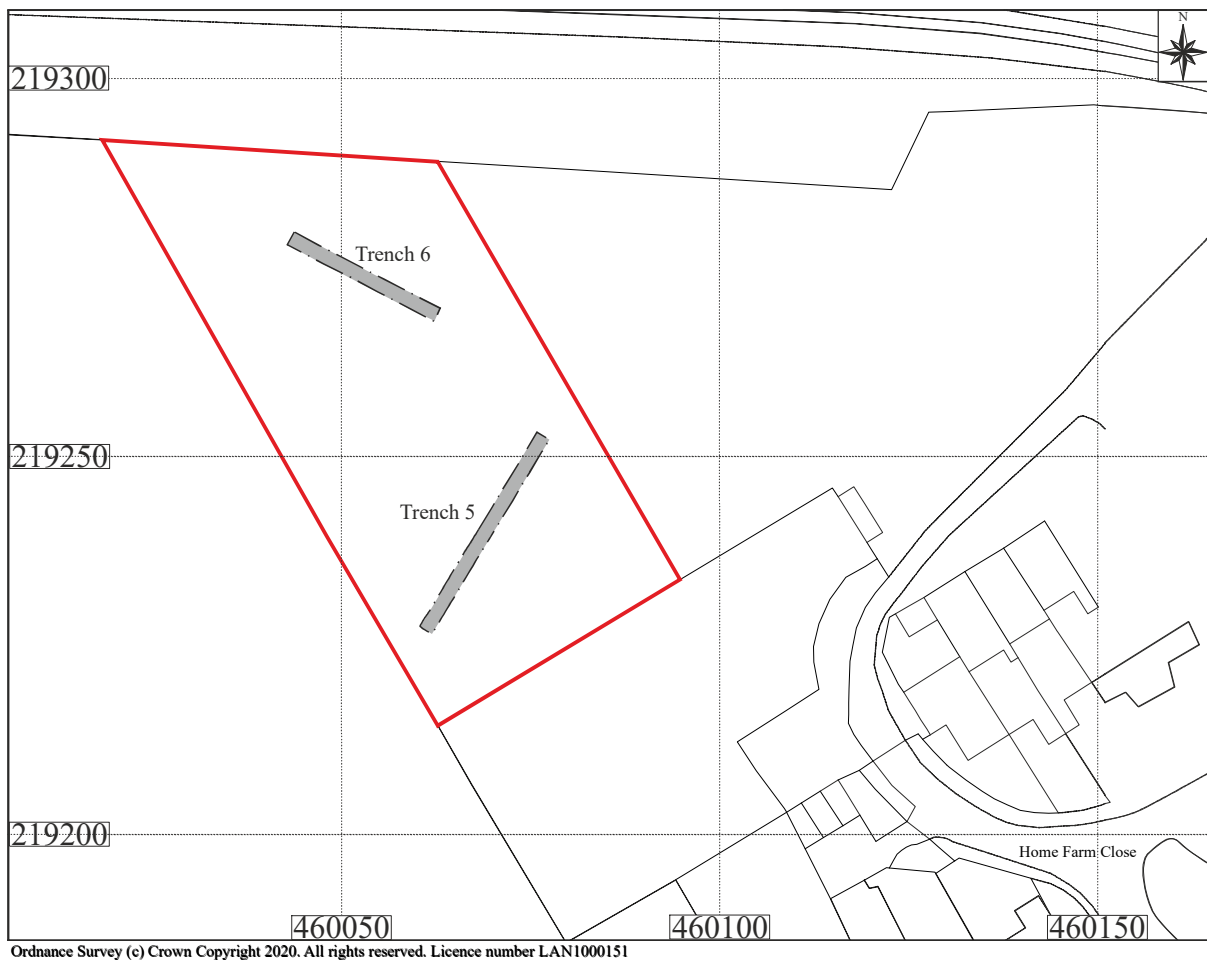
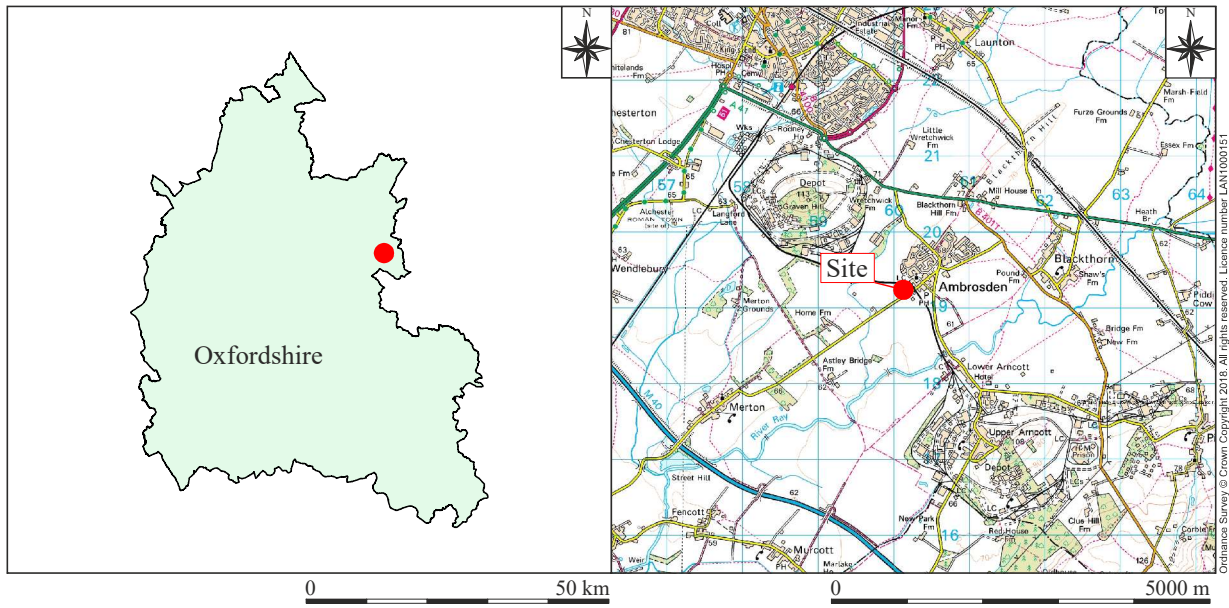

Key Site boundary Evaluation trenches

0 50 m

Figure 1: Site location

2 AIMS OF THE INVESTIGATION

The Written Scheme of Investigation detailed an archaeological evaluation to be undertaken of the site with the following aims:

- To establish the presence or absence of archaeological remains within the site and the depth of soil deposits that overlie any remains.
- To determine the extent, condition, nature, character, quality and date of any archaeological remains encountered.
- To determine the degree of complexity of any horizontal and/or vertical stratigraphy present.
- To determine the impact of the proposed development on any remains present.

In particular

- To determine whether any remains relating to the medieval manor house are present.
- To determine whether any remains relating to prehistoric, Roman and Saxon activity in the vicinity are present on the site.

3 STRATEGY

3.1 Research Design

John Moore Heritage Services carried out the work to a Written Scheme of Investigation (JMHS 2020).

The recording was carried out in accordance with the standards specified by the Chartered Institute for Archaeologists (2020).

3.2 Methodology

The archaeological investigation involved the mechanical excavation of 1no. 30m x 1.9m and 1no. 22m x 1.9m trenches. The trenches were excavated under archaeological supervision using a standard toothless ditching bucket fitted to an appropriate hydraulic tracked machine.

The trenches were numbered 5 and 6; numbers 1 to 4 were excavated as part of a separate planning application (20/01707/F – Parts Of OS Parcels 1125 & 1621, North and East of Home Farm Close).

Standard John Moore Heritage Services techniques were employed throughout, involving the completion of a written record for each deposit encountered, with scale plans and section drawings compiled where appropriate. A photographic record was also produced.

4 RESULTS (Figure 2 and Plate 1)

Excavations on the site revealed an orange-brown and white cornbrash limestone natural across the site (5/03) and (6/03). Deposited above this was a reddish brown silty loam subsoil with moderate to frequent limestone inclusions which was 0.07m thick in the south of the site and 0.14m thick in the north, (5/02) (6/02). The uppermost deposit across the site was a dark brown silty loam topsoil which was between 0.14m and 0.16m thick (5/01) and (6/01).



Plate 1. Trenches 5 and 6

5 FINDS

No finds were recovered from the site.

6 DISCUSSION

No archaeological finds or features were identified at the site.

7 ARCHIVE

A Digital Archive is maintained by John Moore Heritage Services (4391) and will be made available upon request (to admin@jmheritageservices.co.uk). Digitised copies of all the primary records will be made publicly available as appendix to the Final Report submitted to OASIS (johnmoor1-412529).

8 BIBLIOGRAPHY

Chartered Institute for Archaeologists. 2020 *Standard and Guidance for Archaeological Evaluation*.

John Moore Heritage Services 2019 *An Archaeological Evaluation at Meadow Barn, Merton Road, Ambrosden, Oxfordshire*. Unpublished

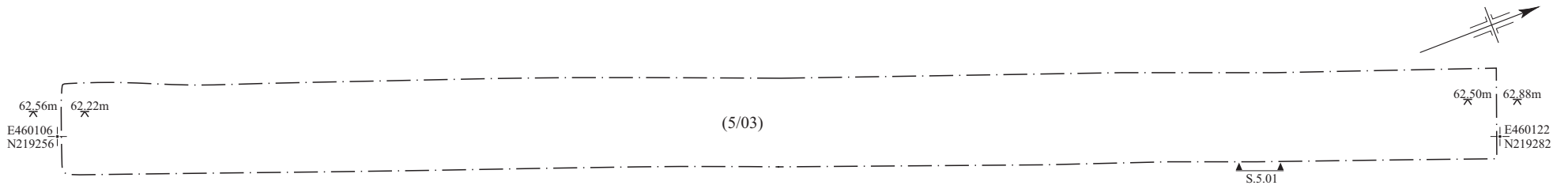

Trench 5

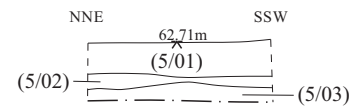

Section 5.01

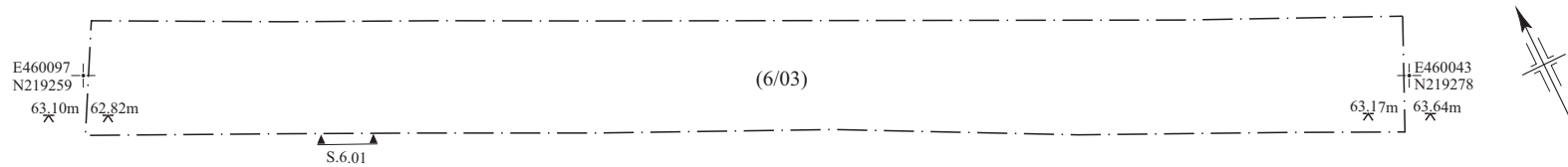

Trench 6

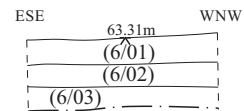

Section 6.01

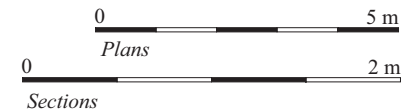

Figure 2: Trench Plans and Sections

Appendix 1: Context Inventory

Context	Type	Description	Depth	Width	Length	Finds	Interpretation	Date
Trench 1								
5/01	Deposit	Dark brown silty loam	0.16m	>1.9m	> 30m	None	Topsoil	Modern
5/02	Deposit	Reddish-brown silty loam with moderate to frequent limestone inclusions	0.07m	>1.9m	> 30m	None	Subsoil	Undated
5/05	Deposit	Orange brown silty clay with very frequent white limestone	>0.08 m	>1.9m	> 30m	-	Cornbrash Formation - Limestone. Sedimentary Bedrock	Formed Approx. 164 to 168 million years ago in the Jurassic Period
Trench 2								
6/01	Deposit	Dark brown silty loam	0.14m	>1.9m	> 22m	None	Topsoil	Modern
6/02	Deposit	Reddish-brown silty loam with moderate to frequent limestone inclusions	0.14m	>1.9m	> 22m	None	Subsoil	Undated
6/03	Deposit	Orange brown silty clay with very frequent white limestone	>0.13 m	>1.9m	> 22m	-	Cornbrash Formation - Limestone. Sedimentary Bedrock	Formed Approx. 164 to 168 million years ago in the Jurassic Period

AMBHFC20
P.6.01 TR6 PLAN 1:100 1m GG 11/1/21



AMBHFC20
S.6.01 TR 6 REP SEC 1:20 20cm SG 11/1/21

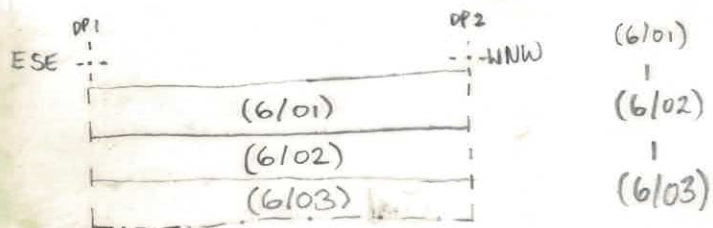

AMBHFC20
P.5.01 TR5 PLAN 1:100 1m GG 11/1/21

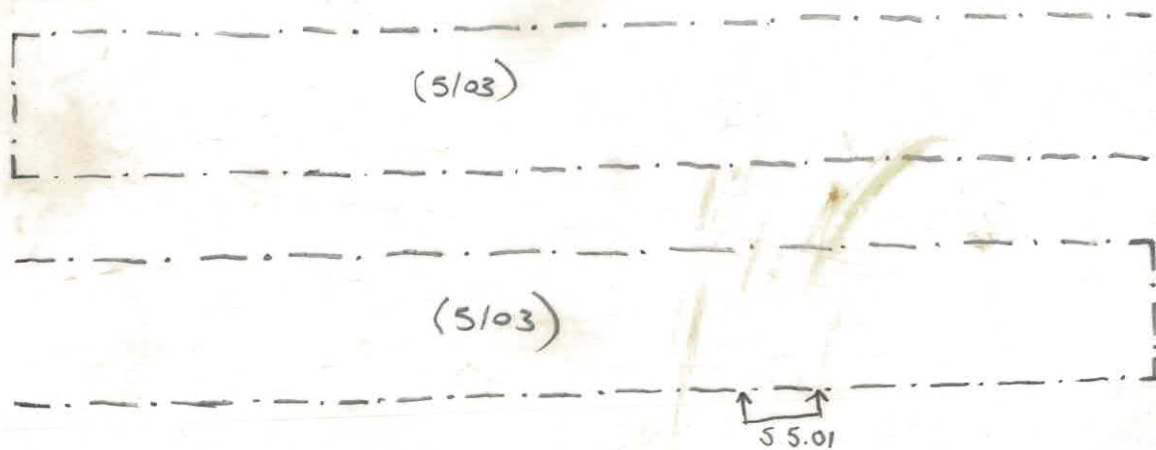

AMBHFC20
S.5.01 TR5 REP SEC 1:20
SG 11/1/21 20cm

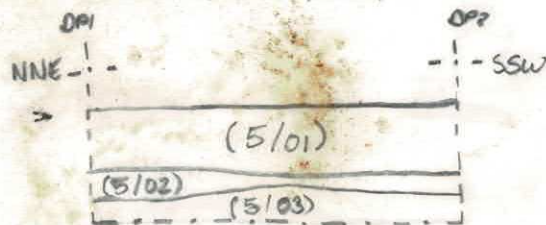

(5/01)
|
(5/02)
|
(5/03)



Trench 5



Trench 5 representative section S5.01



Trench 6



Trench 6 representative section S6.01

OASIS DATA COLLECTION FORM: England

[List of Projects](#) | [Manage Projects](#) | [Search Projects](#) | [New project](#) | [Change your details](#) | [HER coverage](#) | [Change country](#) | [Log out](#)

Printable version

OASIS ID: johnmoor1-412529

Project details

Project name	Land Behind Home Farm Close, Ambrosden
Short description of the project	John Moore Heritage Services carried out an evaluation at land to the north-west of Home Farm Close, Ambrosden, Oxfordshire. No archaeological finds or features were identified on the site.
Project dates	Start: 11-01-2021 End: 11-01-2021
Previous/future work	No / Not known
Any associated project reference codes	AMBHFC 20 - Sitecode
Any associated project reference codes	4391 - Contracting Unit No.
Any associated project reference codes	johnmoor1-412529 - OASIS form ID
Any associated project reference codes	20/01707/F - Planning Application No.
Type of project	Field evaluation
Site status	None
Current Land use	Cultivated Land 4 - Character Undetermined
Monument type	NONE None
Significant Finds	NONE None
Methods & techniques	""Targeted Trenches""
Development type	Housing estate
Prompt	National Planning Policy Framework - NPPF
Position in the planning process	Pre-application

Project location

Country	England
Site location	OXFORDSHIRE CHERWELL AMBROSDEN Land Behind Home Farm Close, Ambrosden
Postcode	OX25 2NP
Study area	0.21 Hectares

Site coordinates	SP 60060 19260 51.868238183574 -1.12760127575 51 52 05 N 001 07 39 W Point
Lat/Long Datum	Unknown
Height OD / Depth	Min: 62.22m Max: 63.64m

Project creators

Name of Organisation	John Moore Heritage Services
Project brief originator	Oxfordshire County Archaeological Services
Project design originator	JMHS
Project director/manager	John Moore
Project supervisor	Gavin Davis
Type of sponsor/funding body	Client

Project archives

Physical Archive Exists?	No
Digital Archive recipient	John Moore Heritage Services
Digital Archive ID	4391
Digital Contents	"Stratigraphic","other"
Digital Media available	"GIS","Images raster / digital photography","Images vector","Text"
Digital Archive notes	Digital files related to the project are maintained by John Moore Heritage Services (ID 4391) and will be made available upon request (to admin@jmheritageservices.co.uk).
Paper Archive Exists?	No

Project bibliography 1

Publication type	Grey literature (unpublished document/manuscript)
Title	AN ARCHAEOLOGICAL EVALUATION AT LAND BEHIND HOME FARM CLOSE, AMBROSDEN, OXFORDSHIRE
Author(s)/Editor(s)	Davis, G.
Author(s)/Editor(s)	Moore, J.
Other bibliographic details	JMHS report no.4391
Date	2021
Issuer or publisher	John Moore Heritage Services
Place of issue or publication	Boarstall
Description	19 A4 pages pdf including primary records and selected digital photos
Entered by	Simona Denis (admin@jmheritageservices.co.uk)
Entered on	2 February 2021