



JOHN MOORE HERITAGE SERVICES

**ARCHAEOLOGICAL OBSERVATION,  
INVESTIGATION, RECORDING, ANALYSIS AND  
PUBLICATION OF WORKS**

**AT**

**DANVERS HOUSE, HIGH STREET, CULWORTH,**

**NORTHAMPTONSHIRE OX17 2BD**

**NGR SP 5408847056**

**NOVEMBER 2021**

**REPORT PREPARED BY** Povilas Cepauskas

**ILLUSTRATION BY** Iwona Brodzka

**EDITED BY** John Moore

**AUTHORISED BY** John Moore

**FIELDWORK** Povilas Cepauskas

**FIELDWORK DATE** 4<sup>th</sup> & 5<sup>th</sup> October 2021

**REPORT ISSUED** 18<sup>th</sup> November 2021

**ENQUIRES TO** John Moore Heritage Services  
Unit 16, Wheatley Business Centre,  
Old London Road,  
Wheatley  
OX33 1XW

Tel: 01865 358300  
Email: [info@jmheritageservices.co.uk](mailto:info@jmheritageservices.co.uk)

**JMHS Project No:** 4560  
**OASIS No:** **johnmoor1-502878**  
**Site Code:** CUHS 21  
**Archive Location:** A copy of the digital archive is maintained by  
John Moore Heritage Services (ID 4560).  
Digitised copies of the primary records are  
available on OASIS



**CONTENTS**

	<b>Page</b>
<b>SUMMARY</b>	<b>1</b>
<b>1 INTRODUCTION</b>	<b>1</b>
1.1 Site Location	1
1.2 Planning Background	1
1.3 Archaeological Background	1
<b>2 AIMS OF THE INVESTIGATION</b>	<b>4</b>
<b>3 STRATEGY</b>	<b>5</b>
3.1 Research Design	5
3.2 Methodology	5
<b>4 RESULTS</b>	<b>6</b>
<b>5 FINDS</b>	<b>8</b>
<b>6 DISCUSSION</b>	<b>8</b>
<b>7 ARCHIVE</b>	<b>9</b>
<b>8 BIBLIOGRAPHY</b>	<b>9</b>
 <b>FIGURES AND PLATES</b>	
Figure 1. Site Location	2
Figure 2. Plan and Section	7
 Plate 1. Stone rubble deposit (03)	6
Plate 2. Limestone wall 05	8
 <b>APPENDICES</b>	
Appendix 1. Primary Records	10
Appendix 2. OASIS Report Form	23

## 1 INTRODUCTION

*John Moore Heritage Services carried out an archaeological investigation at Danvers House, Culworth (NGR SP 54088 47056) which revealed evidence of landscaping and other gardening related activities carried out in the 19th-20th centuries. No earlier archaeological remains were observed.*

### 1.1 Site Location (Figure 1)

Danvers House is located on the south side of High Street, Culworth and the proposed swimming pool will be to the rear of the house at National Grid Reference (NGR SP 54088 47056). The underlying geology of the site is Upper Estuarine Series – Limestone.

### 1.2 Planning Background

West Northamptonshire Council granted planning consent for Construction of external swimming pool at Danvers House, High Street, Culworth OX17 2BD (WNS/2021/0276/FUL). A condition relating to archaeology was attached:

*3. No development shall take place until the applicant has secured the implementation of a programme of archaeological work in accordance with a written scheme of investigation which has been submitted by the applicant and approved by the Planning Authority.*

*This written scheme will include the following components, completion of each of which will trigger the phased discharging of the condition:*

- (i) fieldwork in accordance with the agreed written scheme of investigation;*
- (ii) post-excavation assessment (to be submitted within six months of the completion of fieldwork, unless otherwise agreed in advance with the Planning Authority);*
- (iii) completion of post-excavation analysis, preparation of site archive ready for deposition at a store (Northamptonshire ARC) approved by the Planning Authority, completion of an archive report, and submission of a publication report to be completed within two years of the completion of fieldwork, unless otherwise agreed in advance with the Planning Authority.*

*Reason: To ensure that features of archaeological interest are properly examined and recorded and the results made available, in accordance with NPPF Paragraph 199.*

### 1.3 Archaeological Background

#### **Iron Age**

An area of Iron Age settlement was recorded during excavations approximately 320m east of the site (MNN2145: centred SP 544 470). Part of a large enclosure, a single pit and a probable roundhouse, all dating to the mid to late Iron Age were encountered. The enclosure ditch was substantial, measuring 5m wide and over 4m deep. Also excavated were a cluster of 50 postholes and a metallised trackway

#### **Roman**

High Street, the main route through the village, is the route of a very tentative Roman road (MNN14764: centred SP 54686 46793). The route, Margery 166, is conjectured

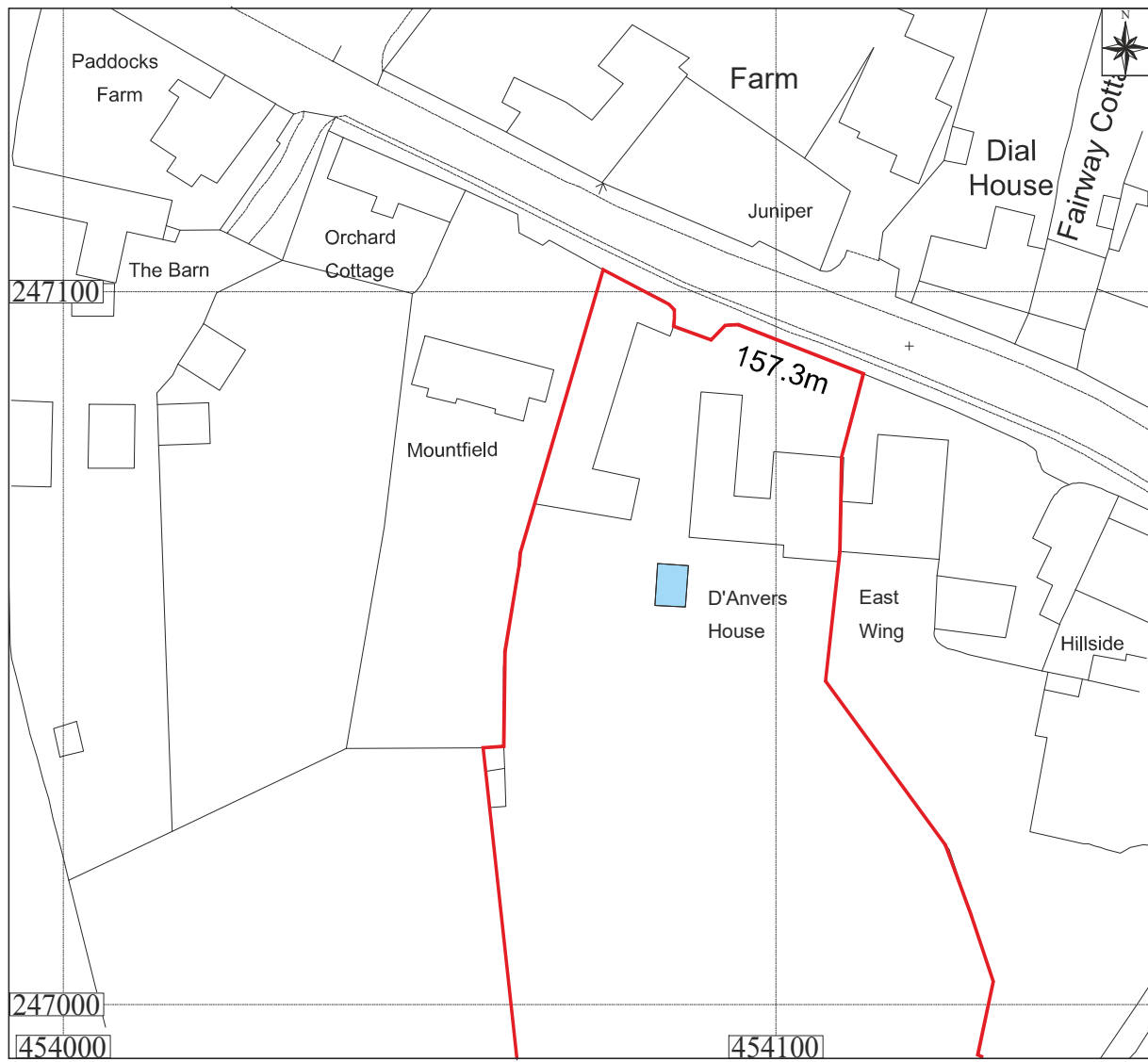
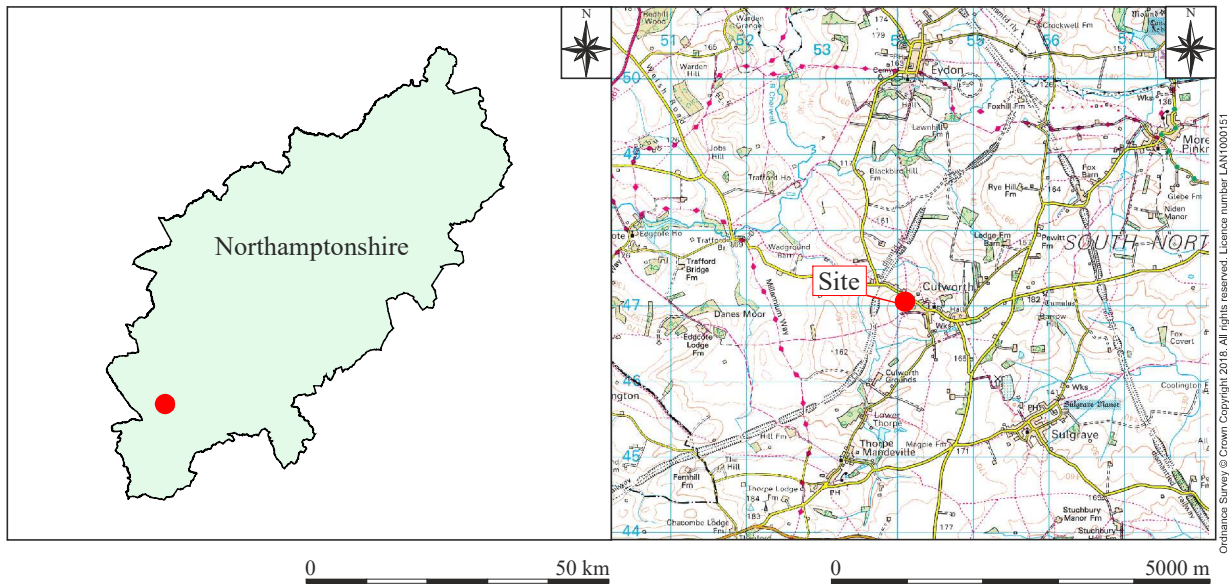

Key  Site boundary  Study Building

Figure 1: Site location

to be part of a road that ran from Bletchley in Buckinghamshire to Wormleighton in Warwickshire. Though of uncertain Roman origin, the route was clearly established by the medieval period, when it was a drove road.

A Roman coin dating to the 3rd century AD, an Antonianus of Quintillus, was found approximately 400m south east of the site (MNN35003: SP 5436 4675).

### **Early Medieval**

The village had been established by the time of the Domesday survey in 1086 where it is recorded as a small manor with a population of 15 (MNN280). Two further settlements, Brime and Coten, are recorded in early historical documents, though neither survive at the present day. This either suggests that these settlements were deserted at an early date or that the three separate settlements have been subsumed within the existing village of Culworth. No archaeological evidence has been recorded of these, despite investigations by RCHM and Ordnance Survey.

Archaeological evidence dating to the early medieval period is relatively limited; early to mid-Saxon boundary ditches were recorded during excavations approximately 320m east of the site in the area of the earlier Iron Age settlement (MNN2145: centred SP 544 470).

### **Medieval**

The core of the medieval village is located approximately 360m east-south east of the site, focused around the Church of St Mary's and former castle ringwork. The existing Church of St Mary's was established in the early 13th century (MNN105621: centred SP 54435 46937). The ringwork, located immediately north of the church, has a roughly circular bank approximately 3m in height enclosing a central area 25m in width (MNN8240: centred SP 5445 4698). The monument is likely to date to the 11th or 12th century, and with the church would have been the manorial centre of the village. The extant remains are a scheduled monument (SAM 13664).

An area of earthworks is located on the south side of Queens Road, south of the church and castle earthworks (MNN18225: centred SP 5448 4687). These are considered to be the remains of buildings associated with the medieval village. A further area of former settlement may be located on the western side of the village, 150m north west of the site (MNN144518, MNN18226: Centred SP 5389 4717); significant quantities of 12th-18th century pottery have been found in the area. A small portion of the medieval village green survives to the west of the church (MNN144519: centred SP 5427 4699); this was originally thought to extend to the east, but has since been subject to infill. A 13th century cross base is located to the south of the surviving green (MNN105584: Centred SP 54272 46975).

The village is surrounded by elements of the medieval open field system, surviving as earthworks (MNN2012). An area of rectilinear earthworks are located approximately 170m south west of the site (MNN125586: centred SP 5392 4698). Further earthworks are located to the north of the site, north and north west of High Street (MNN125585, MNN132541: centred SP 5402 4737; MNN125584, MNN133496: centred SP 5394 4738) and to the north east (MNN125587: centred SP 5443 4724). Features associated with the field system include a holloway (MNN25377: SP 542 473) and a possible trackway, also surviving as an earthwork and located 480m south

east of the site, extending south from Queens Street (MNN125589: centred SP 5450 4675).

Within the wider area a possible medieval wall and culvert were found at Gate House Farm, 250m north west of the site (MNN166327: SP 5392 4728). The structure was dated to the period based on sherds of pottery found within the backfill of the construction cut.

### **Post-medieval**

Within the search area the post-medieval period is represented predominantly by extant buildings, many of which are listed due to their historic significance. The site is located within the rear garden of Danvers House (MNN105635: SP 54106 47074). The house was built in the early 18<sup>th</sup> century by Sir John D'Anvers. The western wing of the existing building is early 18<sup>th</sup> century in date, though may have been built on earlier foundations; the eastern wing is a 19<sup>th</sup> century edition. Though built as one house, the building has since been subdivided into two separate dwellings. An archaeological watching brief undertaken in the rear garden of Danvers House, 130m south of the site, did not result in the discovery of any archaeological deposits or artefacts (ENN106919: SP 54139 46916).

### **Undated**

A number of undated features are located within the search area; these typically comprise earthworks or cropmarks, recorded through aerial photographs. A possible medieval or post-medieval earthen bank is located 150m north east of the site (MNN26332: SP 5418 4715); a possible pond, also of the medieval or post-medieval period, is located 225m north of the site (MNN18224: SP 5405 4727). An undated linear ditch, identified as a cropmark, is located 180m south of the site (MNN125583: centred SP 5402 4683).

An undated ditch was recorded at Gate House Farm during the works that resulted in the discovery of the medieval culvert noted above (MNN166326: SP 5392 4727).

## **2 AIMS OF THE INVESTIGATION**

The aims of the investigation as laid out in the Written Scheme of Investigation (JMHS 2021) were as follows:

- To make a record of any significant archaeological remains revealed during the course of any operations that may disturb or destroy archaeological remains.
- To record the extent, nature, and date of any archaeological features or deposits that may be present.
- Record any evidence relating to medieval activity in this part of the village.
- Are any archaeological features relating to the post-medieval use of the site for Danvers House present?

### **3 STRATEGY**

#### **3.1 Research Design**

John Moore Heritage Services carried out the work to a Written Scheme of Investigation agreed with NNC the archaeological advisors to the West Northamptonshire District Council.

#### **3.2 Methodology**

All aspects of the fieldwork were conducted in accordance with the Chartered Institute for Archaeologists' 'Code of Conduct' (CIfA 2019) and the 'Standard and Guidance for an Archaeological Watching Brief' (CIfA 2020).

Excavation works were carried out with a five ton tracked excavator suitably equipped with a 1.6m wide toothless ditching bucket. Prior to the excavation, tree stumps were removed from the marked out swimming pool area. Additional areas, measuring 2.5m wide, were excavated in the western and eastern side of the swimming pool to allow decking and other infrastructure to be installed. The impact level of these additional areas was 0.25-0.30m below ground level (BGL). The maximum depth of excavation was 1.7m BGL in the northern part of the swimming pool sloping southwards to 1.8m BGL in the centre reaching 2.2m BGL in the southern end of the excavation area.

Machine excavations were carried out under constant archaeological monitoring. Where archaeological horizons were encountered they were cleaned by hand and excavated appropriately. Standard John Moore Heritage Services techniques were employed throughout, involving the completion of a written record for each deposit encountered, with scale plans and section drawings compiled where appropriate. A photographic record was also produced. The resultant spoil from the works was visually scanned, especially for finds relating to Medieval, Post-Medieval activity at Danvers House. Post-medieval and Modern finds were noted and discarded on site.

All recording followed CIfA's 'Standard and Guidance for an Archaeological Watching Brief' (2020) and the methodology outlined in the Written Scheme of Investigation (John Moore Heritage Services 2021) All contexts were given unique numbers. All excavated contexts were recorded in plan and section with details of location, composition, shape, dimensions, relationships, finds and samples, and cross-referenced to other contexts where appropriate. All recording was undertaken on John Moore Heritage Services pro forma paper sheets.

Digital images were taken with a camera with a resolution of at least 10 Megapixels and followed Historic England guidance (2015).

The post-excavation plan of the swimming pool, including spot heights and an overall site plan, were recorded digitally using differential GPS. The site plan is accurately linked to the National Grid.



#### 4 RESULTS (Figure 2, Plates 1-3)

All deposits and features were assigned individual context numbers. Context numbers without brackets indicate features i.e. pit cuts, numbers in ( ) show feature fills or deposits of material, while numbers in bold indicate structural features.

The natural geology of light orange mottled and mid to light brown, compact coarse sands (04) was encountered at 1.3m below ground level (BGL) in the northern end of the swimming pool and at 0.70m BGL in the southern extent of the excavation area. No archaeological remains were recorded cut into the geology.

Natural geology (04) was overlain in the northern end by 0.60m thick deposit of stone rubble (03) (Figure 2, Section 1, Plate 1). Deposit (03) is part of the latest phase of garden landscaping seen throughout the extent of the garden; it contained fragments of 19<sup>th</sup>-20<sup>th</sup> century glass and ceramic building material.



*Plate 1. Northern end of the excavated area, showing stone rubble deposit (03)*

Limestone wall **05** (Figure 2, Plate 2), part of a garden feature, was uncovered in the south-western part of the excavated area. The wall, aligned North-South, measured 2.34m in length by 0.33m in width, and was uncovered to a maximum height of 0.15m. The exposed masonry consisted of a single course of roughly squared limestone, bonded with sand and mortar. The feature was not further investigated as it lay below the impact level of 0.25-0.30m BGL.

Stone rubble deposit (03) and wall **05** were overlain by a 0.40m thick deposit of mid-brown yellowish sand and loam (02) (Figure 2, Section 1).

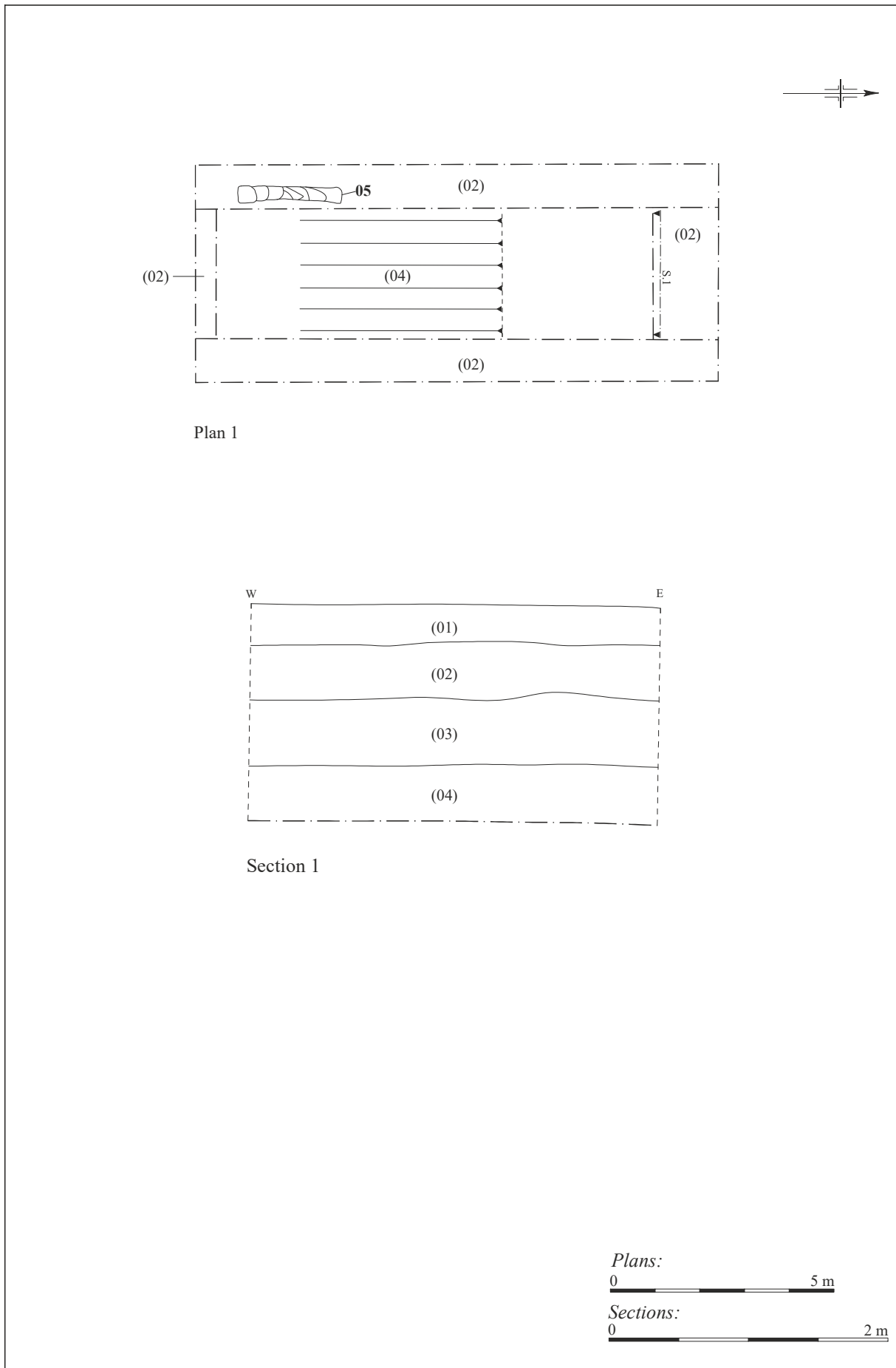

Figure 2: Plan and Section



*Plate 2. Limestone wall 05, looking north*

The uppermost deposit was a 0.30m thick layer of topsoil (01), containing fragments of 19<sup>th</sup>-20<sup>th</sup> ceramic building material and glass, overlaying deposit (02) (Figure 2, Section 1).

## **5 FINDS**

Ceramic building material and glass fragments were observed in deposits (02) and (03); the material was spot-dated to the 19<sup>th</sup>-20<sup>th</sup> century and not collected for further analysis.

## **6 DISCUSSION**

Evidence of gardening related activities, represented by garden feature wall **05** and by rubble deposit (02), possibly resulting from landscaping, were uncovered at Danvers House. The fragments of ceramic building material and glass recovered during the archaeological works indicate a date of the 19<sup>th</sup>-20<sup>th</sup> century for such activities.

No earlier archaeological remains were observed.

## **7 ARCHIVE**

A Digital Archive is maintained by John Moore Heritage Services (ID 4560) and will be made available upon request (to admin@jmheritageservices.co.uk). Digitised copies of all the primary records will be made publicly available as appendix to the Final Report submitted to OASIS (ID OASIS johnmoor1-502878).

## **8 BIBLIOGRAPHY**

Chartered Institute for Archaeologists, 2020 *Standard and Guidance for Archaeological Watching Briefs*

Chartered Institute for Archaeologists 2014 *Code of Conduct*

Historic England, 2015. *Digital Image Capture and File Storage: Guidelines for Best Practice.*

John Moore Heritage Services, 2021 *Danvers House, High Street, Culworth, Northamptonshire OX17 8BD Archaeological Investigation, Recording, Analysis and Publication of Works, Written Scheme of Investigation.* (Unpublished client report)



Sketch Profile/Plan Context: (04)

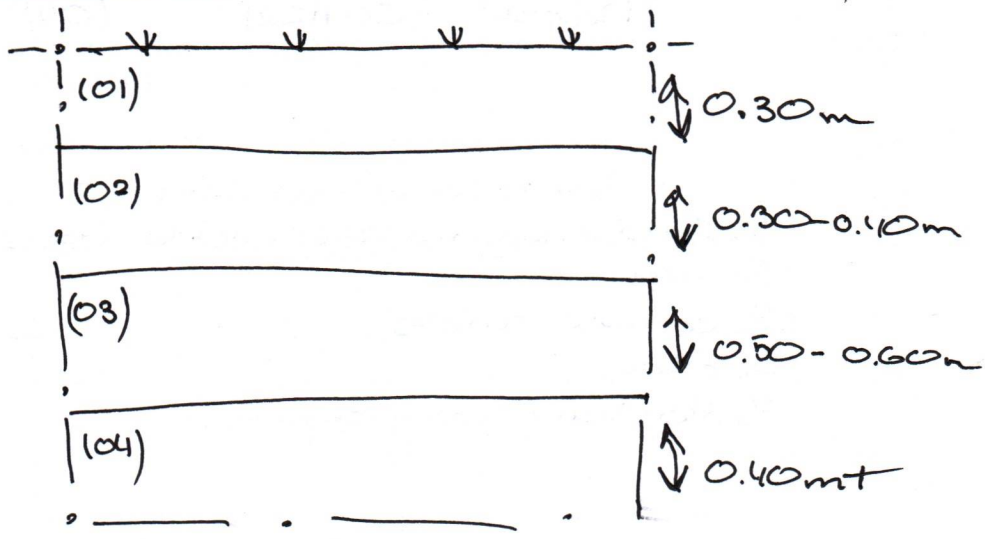

**LEVELS**

On Plan: On Section: Drawing Sheet Nos:

**PHOTOS**

Digital Nos: B&W (Please use the following conventions: F= film no. & No.=frame no.)

Grid Squares	Area/Trench	Context Type <i>Deposit</i>	Site Code <i>CUHS21</i>	Context <i>(04)</i>
--------------	-------------	--------------------------------	----------------------------	------------------------

Plan No. <i>P.1</i> on Drawing Sheet No. <i>1</i>	Section No. <i>S.1</i> on Drawing Sheet No. <i>1</i>	Add. Sheet
--	---	------------

<b>DEPOSIT</b> 1 Compaction            2 Colour 3 Composition        4 Inclusions 5 Horizon clarity      6 Comments 7 Method & Conditions	<b>Description</b> <i>1, low compacted compact</i> <i>2, light orange mottled mid to light brown</i> <i>3, coarse sands</i> <i>5, clean</i> <i>7, machine, dry sunny</i>
<b>CUT</b> 1 Shape in plan            2 Corners 3 Break of slope-top      4 Sides 5 Break of slope-base    6 Base 7 Orientation            8 Inclination of axis 9 Truncation              10 Fill Nos. 11 Other comments	
<b>Dimensions</b> Length: <i>&gt;12m</i> Thickness/Depth: <i>0.40m+</i> Width: <i>&gt;5m</i>	

Stratigraphic matrix	<input type="checkbox"/> <input type="checkbox"/> <input type="checkbox"/> <i>03</i> <input type="checkbox"/> <input type="checkbox"/>	Physical Relationship
	This context is: <input type="checkbox"/> <i>04</i> <input type="checkbox"/>	
	<input type="checkbox"/> <input type="checkbox"/> <input type="checkbox"/> <i>/</i> <input type="checkbox"/> <input type="checkbox"/>	
	<b>BELOW</b> Under: <i>03</i> Filled by:   Cut by:	
	<b>CONTEMPORARY</b> Group No.:   Same as:	
	<b>ABOVE</b> Over:   Fill of:   Cuts:	

<b>Interpretation &amp; Discussion:</b> Internal   External   Structural   Other (specify)
<i>Natural sands,</i>

<b>Environmental Samples</b> Nos:	<b>FINDS</b> none   pot   CBM   fauna   flora   flint   glass   metal   burntmat. <input checked="" type="checkbox"/> <input type="checkbox"/> <input type="checkbox"/> <input type="checkbox"/> <input type="checkbox"/> <input type="checkbox"/> <input type="checkbox"/> <input type="checkbox"/> <input type="checkbox"/>
<b>Small Finds:</b>	Other finds (specify):

<b>Provisional Date:</b>	Checked by (on site): <i>PC</i> Date: <i>5/10/21</i>
Completed by: <i>PC</i> Date: <i>05/10/21</i>	Checked by (office):   Date:

Sketch Profile / Plan Context: (03)

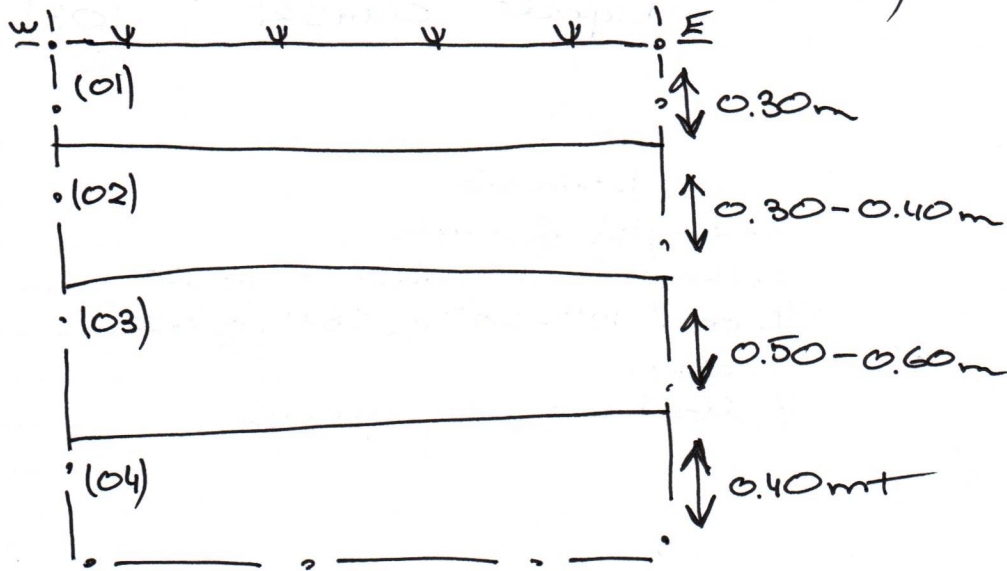

**LEVELS**

On Plan:

On Section:

Drawing Sheet Nos:

**PHOTOS**

Digital Nos:

B&W (Please use the following conventions: F= film no. & No.=frame no.)



Grid Squares	Area/Trench	Context Type <i>Deposit</i>	Site Code <i>CUHS21</i>	Context <i>(03)</i>
--------------	-------------	--------------------------------	----------------------------	------------------------

Plan No. <i>/</i> on Drawing Sheet No. <i>/</i>	Section No. <i>S.1</i> on Drawing Sheet No. <i>2</i>	Add. Sheet
--	---	------------

<b>DEPOSIT</b> 1 Compaction      2 Colour 3 Composition    4 Inclusions 5 Horizon clarity   6 Comments 7 Method & Conditions	<b>Description</b> <i>1. Friable</i> <i>2. greyish brown</i> <i>3. limestone rubble deposit</i> <i>4. occ' 19<sup>th</sup>-20<sup>th</sup> c. CBM, glass.</i> <i>5. clean</i> <i>7. Machine, dry sunny</i>
<b>CUT</b> 1 Shape in plan      2 Corners 3 Break of slope-top   4 Sides 5 Break of slope-base   6 Base 7 Orientation      8 Inclination of axis 9 Truncation      10 Fill Nos. 11 Other comments	
<b>Dimensions</b> Length: <i>UNK</i> Thickness/Depth: <i>0.50-0.60</i> Width: <i>UNK</i>	

Stratigraphic matrix	<input type="checkbox"/> <input type="checkbox"/> <input type="checkbox"/> <i>02</i> <input type="checkbox"/> <input type="checkbox"/>	Physical Relationship
	This context is: <input type="checkbox"/> <i>03</i>	
	<input type="checkbox"/> <input type="checkbox"/> <input type="checkbox"/> <i>04</i> <input type="checkbox"/> <input type="checkbox"/>	
	<b>BELOW</b> Under:      Filled by:      Cut by:	
	<b>CONTEMPORARY</b> Group No.:      Same as:	
	<b>ABOVE</b> Over:      Fill of:      Cuts:	

<b>Interpretation &amp; Discussion:</b> Internal      External      Structural      Other (specify)
<i>19<sup>th</sup>-20<sup>th</sup> c. garden landscaping deposit.</i>

<b>Environmental Samples</b> Nos:	<b>FINDS</b> none   pot   CBM   fauna   flora   flint   glass   metal   burntmat. <input type="checkbox"/> <input type="checkbox"/> <input checked="" type="checkbox"/> <input type="checkbox"/> <input type="checkbox"/> <input type="checkbox"/> <input checked="" type="checkbox"/> <input type="checkbox"/> <input type="checkbox"/>
<b>Small Finds:</b>	Other finds (specify):

<b>Provisional Date:</b> <i>19<sup>th</sup>-20<sup>th</sup> c.</i>	<b>Checked by (on site):</b> <i>PC</i> <b>Date:</b> <i>5/10/21</i>
--	--

<b>Completed by:</b> <i>PC</i> <b>Date:</b> <i>5/10/21</i>	<b>Checked by (office):</b> <b>Date:</b>
--	--

Sketch Profile/Plan

Context: (02)

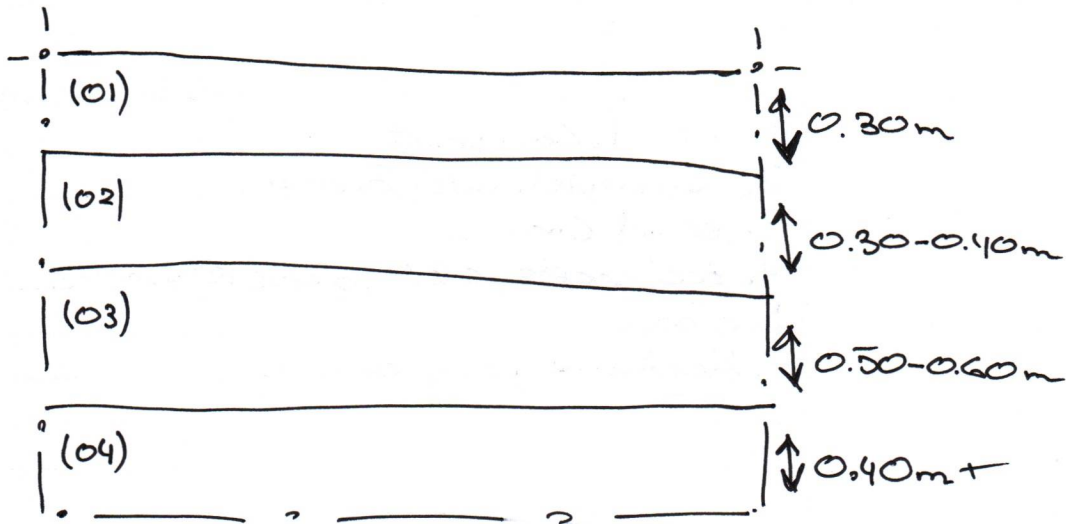

**LEVELS**

On Plan:

On Section:

Drawing Sheet Nos:

**PHOTOS**

Digital Nos:

B&W (Please use the following conventions: F= film no. & No.=frame no.)

Grid Squares	Area/Trench	Context Type <b>Deposit</b>	Site Code <b>CUHS 21</b>	Context <b>(02)</b>
--------------	-------------	--------------------------------	-----------------------------	------------------------

Plan No. <b>P.1</b> on Drawing Sheet No. <b>1</b>	Section No. <b>S.1</b> on Drawing Sheet No. <b>2</b>	Add. Sheet
--	---	------------

<p><b>DEPOSIT</b></p> <p>1 Compaction      2 Colour 3 Composition      4 Inclusions 5 Horizon clarity    6 Comments 7 Method &amp; Conditions</p> <p><b>CUT</b></p> <p>1 Shape in plan      2 Corners 3 Break of slope-top    4 Sides 5 Break of slope-base    6 Base 7 Orientation      8 Inclination of axis 9 Truncation      10 Fill Nos. 11 Other comments</p>	<p><b>Description</b> <b>1. Compact</b></p> <p><b>2. yellowish mid brown</b></p> <p><b>3. sand loam</b></p> <p><b>4. occ' rosetts, CBM, glass 19<sup>th</sup>-20<sup>th</sup> c.</b></p> <p><b>5. clean</b></p> <p><b>7. Machine, chg scanning</b></p>
<p><b>Dimensions</b></p> <p>Length: <b>&gt;12m</b></p> <p>Thickness/Depth: <b>0.30-0.40m</b></p> <p>Width: <b>&gt;5m</b></p>	

<b>Stratigraphic matrix</b>	<table border="1"> <tr> <td><input type="checkbox"/></td> <td><input type="checkbox"/></td> <td><input type="checkbox" value="01"/></td> <td><input type="checkbox"/></td> <td><input type="checkbox"/></td> </tr> <tr> <td colspan="2">This context is:</td> <td><input type="checkbox" value="02"/></td> <td><input type="checkbox"/></td> <td><input type="checkbox"/></td> </tr> <tr> <td><input type="checkbox"/></td> <td><input type="checkbox"/></td> <td><input type="checkbox" value="03"/></td> <td><input type="checkbox"/></td> <td><input type="checkbox"/></td> </tr> </table>	<input type="checkbox"/>	<input type="checkbox"/>	<input type="checkbox" value="01"/>	<input type="checkbox"/>	<input type="checkbox"/>	This context is:		<input type="checkbox" value="02"/>	<input type="checkbox"/>	<input type="checkbox"/>	<input type="checkbox"/>	<input type="checkbox"/>	<input type="checkbox" value="03"/>	<input type="checkbox"/>	<input type="checkbox"/>	<p><b>BELOW</b></p> <p>Under: <b>01</b>      Filled by:      Cut by:</p> <p><b>CONTEMPORARY</b></p> <p>Group No.:      Same as:</p> <p><b>ABOVE</b></p> <p>Over: <b>03</b>      Fill of:      Cuts:</p>	<b>Physical Relationship</b>
	<input type="checkbox"/>	<input type="checkbox"/>	<input type="checkbox" value="01"/>	<input type="checkbox"/>	<input type="checkbox"/>													
	This context is:		<input type="checkbox" value="02"/>	<input type="checkbox"/>	<input type="checkbox"/>													
<input type="checkbox"/>	<input type="checkbox"/>	<input type="checkbox" value="03"/>	<input type="checkbox"/>	<input type="checkbox"/>														

**Interpretation & Discussion:**      Internal      External      Structural      Other (specify)

**Post-med / Modern archaeological horizon.**

---

---

---

---

---

---

---

---

---

---

<p><b>Environmental Samples</b></p> <p>Nos:</p>	<p><b>FINDS</b></p> <p>none   pot   CBM   fauna   flora   flint   glass   metal   burntmat.</p> <p><input type="checkbox"/>   <input type="checkbox"/>   <input checked="" type="checkbox"/>   <input type="checkbox"/>   <input type="checkbox"/>   <input type="checkbox"/>   <input checked="" type="checkbox"/>   <input type="checkbox"/>   <input type="checkbox"/></p> <p>Other finds (specify):</p>
<p><b>Small Finds:</b></p>	

<p><b>Provisional Date:</b> <b>19<sup>th</sup>-20<sup>th</sup> c.</b></p>	<p><b>Checked by (on site):</b> <b>PE</b>      <b>Date:</b> <b>5/10/21</b></p>
<p><b>Completed by:</b> <b>PE</b>      <b>Date:</b> <b>5/10/21</b></p>	<p><b>Checked by (office):</b>      <b>Date:</b></p>

Sketch Profile/Plan

Context: (01)

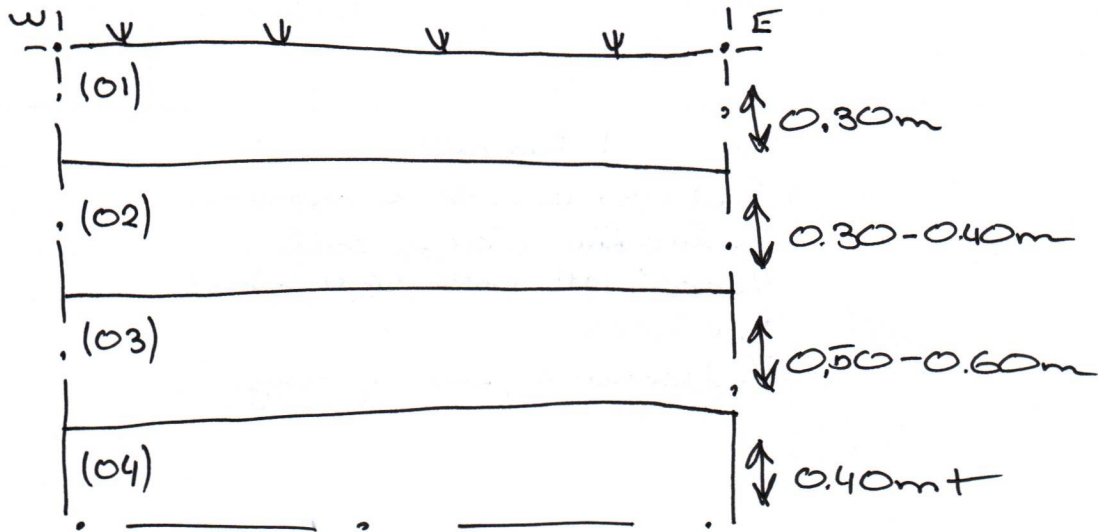

**LEVELS**

On Plan:

On Section:

Drawing Sheet Nos:

**PHOTOS**

Digital Nos:

B&W (Please use the following conventions: F= film no. & No.=frame no.)

Grid Squares	Area/Trench	Context Type <i>Deposit</i>	Site Code <i>CUHS21</i>	Context <i>(01)</i>
--------------	-------------	--------------------------------	----------------------------	------------------------

Plan No. <i>✓</i> on Drawing Sheet No. <i>✓</i>	Section No. <i>S.1</i> on Drawing Sheet No. <i>2</i>	Add. Sheet
--	---	------------

<b>DEPOSIT</b> 1 Compaction            2 Colour 3 Composition        4 Inclusions 5 Horizon clarity      6 Comments 7 Method & Conditions	<b>Description 1, Friable</b> 2. greyish very dark brown 3. loamy clayey soil 4. occ' 18 <sup>th</sup> -20 <sup>th</sup> CBM, glass 5. clear 7. Machine, sunny day
<b>CUT</b> 1 Shape in plan            2 Corners 3 Break of slope-top      4 Sides 5 Break of slope-base    6 Base 7 Orientation            8 Inclination of axis 9 Truncation              10 Fill Nos. 11 Other comments	
<b>Dimensions</b> Length: <i>&gt; 12m</i> Thickness/Depth: <i>0.30</i> Width: <i>&gt; 5m</i>	

Stratigraphic matrix	This context is: <input type="checkbox"/> <input type="checkbox"/> <input checked="" type="checkbox"/> <input type="checkbox"/> <input type="checkbox"/> <input type="checkbox"/> <input type="checkbox"/> <input checked="" type="checkbox"/> <input type="checkbox"/> <input type="checkbox"/>	<b>BELOW</b> Under:                      Filled by:                      Cut by: <hr/> <b>CONTEMPORARY</b> Group No.:                      Same as: <hr/> <b>ABOVE</b> Over: <i>02</i> Fill of:                      Cuts:	Physical Relationship
----------------------	---	---	-----------------------

<b>Interpretation &amp; Discussion:</b> <i>Topsoil.</i>	Internal	External	Structural	Other (specify)
--	----------	----------	------------	-----------------

<b>Environmental Samples</b> Nos:	<b>FINDS</b> none   pot   CBM   fauna   flora   flint   glass   metal   burntmat. <input type="checkbox"/> <input type="checkbox"/> <input checked="" type="checkbox"/> <input type="checkbox"/> <input type="checkbox"/> <input type="checkbox"/> <input checked="" type="checkbox"/> <input type="checkbox"/> <input type="checkbox"/>
<b>Small Finds:</b>	Other finds (specify):

<b>Provisional Date:</b> <i>19<sup>th</sup>-20<sup>th</sup> c.</i>	<b>Checked by (on site):</b> <i>PE</i>	<b>Date:</b> <i>5/10/21</i>
--	--	-----------------------------

<b>Completed by:</b> <i>PE</i>	<b>Date:</b> <i>5/10/21</i>	<b>Checked by (office):</b>	<b>Date:</b>
--------------------------------	-----------------------------	-----------------------------	--------------

Grid Squares	Area/Trench	MASONRY	Site Code CUHS21	Context 05
--------------	-------------	---------	---------------------	---------------

Add. Sheets	Plan Nos. P.1	Section Nos. /	Matrix Location
-------------	------------------	-------------------	-----------------

Photographs Slide 2264-2266	DIGITAL	B&W	1 Materials 2 Size of materials (brick: BLT in mm) 3 Finish of stones 4 Coursing/bond 5 Form 6 Direction of face(s) 7 Bonding material 8 Dimensions as found 9 Other comments
--------------------------------	---------	-----	---

Description 1, limestone 2, 0.50-0.70m 3, coarse faced 4, sand mortar / B single course 5, linear NS 6, N-S 7, sandy mortar 8, 2, 34m l x 0.33m w x 0.10-0.15m d.	
--	--

Stratigraphic matrix <input type="checkbox"/> <input type="checkbox"/> 01 <input type="checkbox"/> <input type="checkbox"/> This context is <input type="checkbox"/> 05 <input type="checkbox"/> <input type="checkbox"/> <input type="checkbox"/> 02 <input type="checkbox"/> <input type="checkbox"/>	Initials & Date PE 5/10/21 Checked by & Date PE 5/10/21
--	--

Interpretation: Internal External <u>single course wall, possible garden facade / tally.</u>
--

Associated contexts: \_\_\_\_\_

Context same as: \_\_\_\_\_

Worked stones: \_\_\_\_\_

Levels on plan sheet Highest Lowest	Samples Petrological: Regular bricks Mortar: Special bricks
--	--

Checked Interpretation _____
------------------------------

Provisional period 19 <sup>th</sup> -20 <sup>th</sup> c.	Group	Structure No 05	Initials & Date PE 5/10/21
--	-------	-----------------	----------------------------

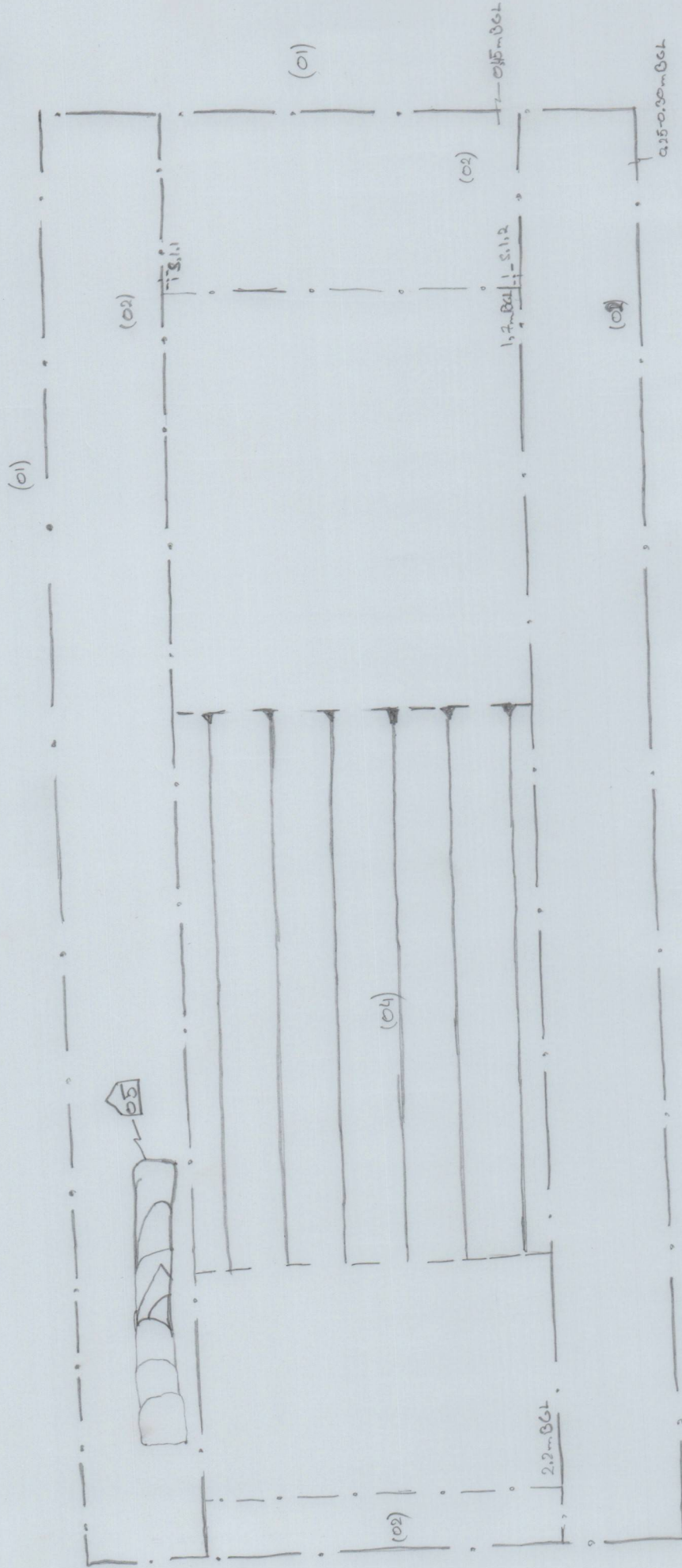

a CUHS 21 P.1  
 WB Post-Fix PLAN  
 Scale 1:50  
 DE 18/11/2021  
 BPLAN. NO. 1

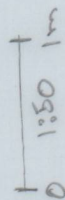

CUHS 21 S.1  
WB S FACING SECTION  
SEC. NO. 1  
SCALE: 1:20  
PE 18/11/21

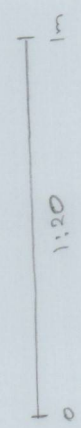



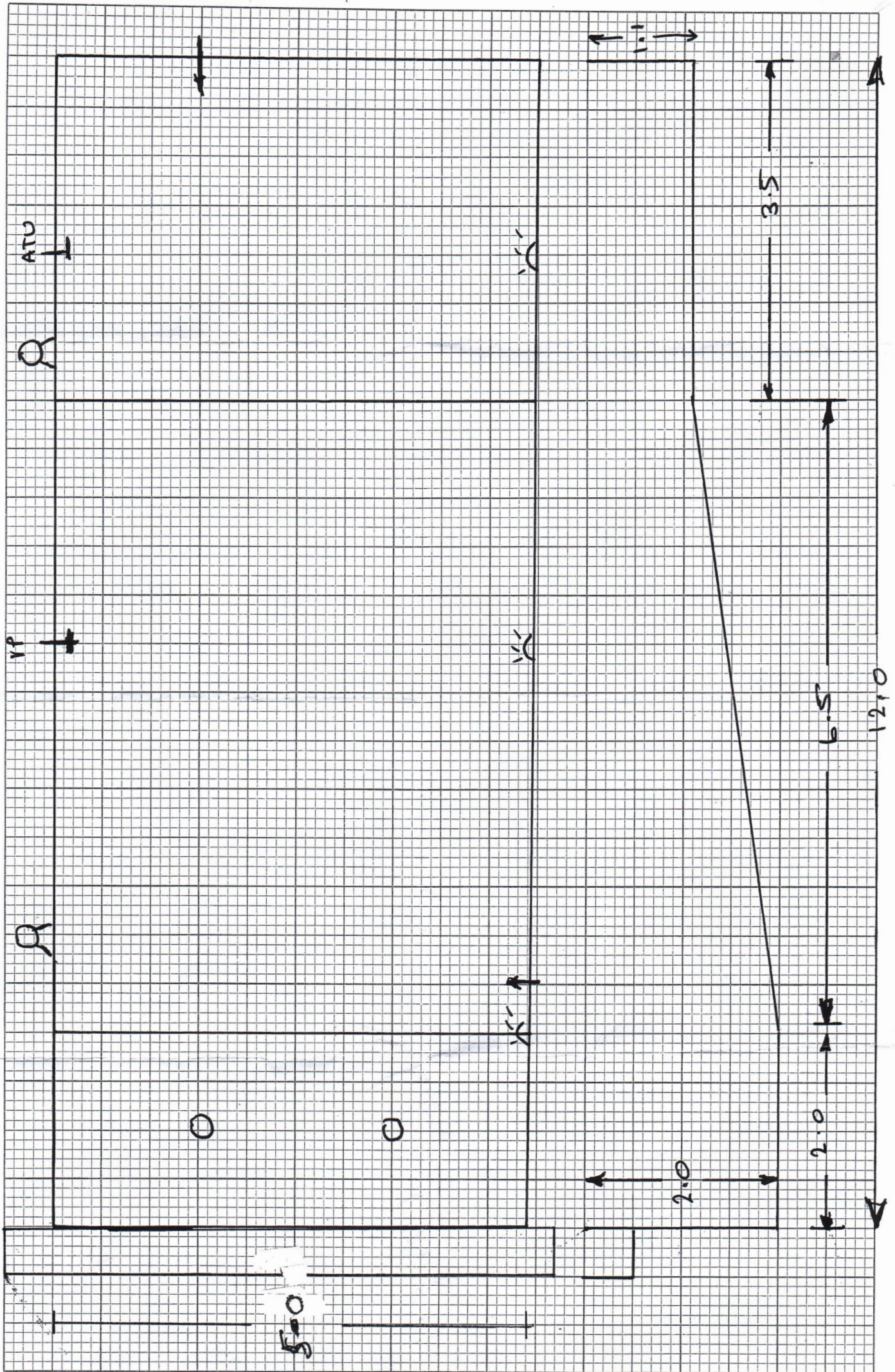

# Summary for johnmoor1-502878

OASIS ID (UID)	johnmoor1-502878
Project Name	Watching Brief at Danvers House, High Street, Culworth
Activity type	Watching Brief
Project Identifier(s)	CUHS 21, 4560
Planning Id	WNS/2021/0276/FUL
Reason For Investigation	Planning requirement
Organisation Responsible for work	John Moore Heritage Services
Project Dates	04-Oct-2021 - 05-Oct-2021
Location	Danvers House, High Street, Culworth NGR : SP 54088 47056 LL : 52.1191836620763, -1.21145814738981 12 Fig : 454088,247056
Administrative Areas	Country : England County : Northamptonshire District : South Northamptonshire Parish : Culworth
Project Methodology	Excavation works were carried out with a five ton tracked excavator suitably equipped with a 1.6m wide toothless ditching bucket. Prior to the excavation, tree stumps were removed from the marked out swimming pool area. Additional areas, measuring 2.5m wide, were excavated in the western and eastern side of the swimming pool to allow decking and other infrastructure to be installed. The impact level of these additional areas was 0.25-0.30m below ground level (BGL). The maximum depth of excavation was 1.7m BGL in the northern part of the swimming pool sloping southwards to 1.8m BGL in the centre reaching 2.2m BGL in the southern end of the excavation area. Machine excavations were carried out under constant archaeological monitoring and supplemented by hand sampling of archaeological features and deposits.
Project Results	Evidence of gardening related activities, represented by garden feature wall 05 and by rubble deposit (02), possibly resulting from landscaping, were uncovered at Danvers House. The fragments of ceramic building material and glass recovered during the archaeological works indicate a date of the 19th-20th century for such activities. No earlier archaeological remains were observed.
Keywords	Garden Wall - 20TH CENTURY - FISH Thesaurus of Monument Types
HER	Northamptonshire SMR - unRev - STANDARD
HER Identifiers	
Archives	