



JOHN MOORE HERITAGE SERVICES

**ARCHAEOLOGICAL MONITORING**

**AT**

**41 CORINIUM GATE, CIRENCESTER,**

**GLOUCESTERSHIRE**

**NGR SP 02698 02143**

**MARCH 2022**

**REPORT PREPARED BY** Christopher Whitehead

**ILLUSTRATION BY** Christopher Whitehead

**EDITED BY** John Moore

**AUTHORISED BY** John Moore

**FIELDWORK** Christopher Whitehead

**FIELDWORK DATE** 2<sup>nd</sup> and 3<sup>rd</sup> March 2022

**REPORT ISSUED** 17<sup>th</sup> March 2022

**ENQUIRES TO** John Moore Heritage Services  
Unit 16, Wheatley Business Centre,  
Old London Road,  
Wheatley  
OX33 1XW

Tel: 01865 358300  
Email: [info@jmheritageservices.co.uk](mailto:info@jmheritageservices.co.uk)

**JMHS Project No:** 4636  
**OASIS No:** johnmoor1-505400  
**Archive Location:** A copy of the digital archive is maintained by  
John Moore Heritage Services (ID 4636).  
Digitised copies of the primary records are  
available on OASIS.



**CONTENTS**

	<b>Page</b>
<b>SUMMARY</b>	<b>1</b>
<b>1 INTRODUCTION</b>	<b>1</b>
1.1 Site Location	1
1.2 Planning Background	1
1.3 Archaeological Background	3
<b>2 METHODOLOGY</b>	<b>3</b>
<b>3 RESULTS</b>	<b>3</b>
<b>4 FINDS</b>	<b>5</b>
<b>5 DISCUSSION</b>	<b>5</b>
<b>6 ARCHIVE</b>	<b>5</b>
<b>7 BIBLIOGRAPHY</b>	<b>6</b>
 <b>FIGURES AND PLATES</b>	
Figure 1: Site Location	2
Figure 2: Plan of excavated areas and sections	4
Plate 1: Section 2. Looking north-west	5
 <b>APPENDICES</b>	
Appendix 1. Primary Records	7
Appendix 2. OASIS Report Form	18

## **SUMMARY**

*John Moore Heritage Services carried out an archaeological monitoring visit at 41 Corinium Gate, Cirencester (NGR 402695 202148). The purpose of the visit was for the monitoring of foundation excavations for front and rear extensions. 41 Corinium Gate lies within the area of a scheduled monument: SM GC 361, HA 1003426. During the course of the excavations, a series of modern made-ground and levelling deposits were observed. No archaeological features or deposits were uncovered.*

## **1 INTRODUCTION**

### **1.1 Site Location (Figure 1)**

The development site is located at 41 Corinium Gate, Cirencester, Gloucestershire GL7 2PX (NGR SP 02698 02143). It is within the area of a Scheduled Monument, number: SM GC 361, HA 1003426.

The site lies at approximately 111m aOD. The underlying geology is part of the Forest Marble Foundation dated 166 million to 168 million years ago, which formed part of the Jurassic period. The site lies on the boundary of the superficial river terrace deposits consisting of gravel laid down 3 million years ago.

### **1.2 Planning Background**

Cotswold District Council granted planning permission for erection of front and rear extensions (21/03392/FUL). Due to the archaeological and historical importance of the surrounding area conditions were attached to the permission requiring monitoring to be maintained during the course of building operations or construction works on the site.

*Prior to commencement of the development evidence shall be submitted to and approved in writing by the Local Authority to ensure that Scheduled Ancient Monument (SAM) Consent has been granted.*

*Reason - To ensure there is no damage to the significance of the SAM in accordance with the provisions of the National Planning Policy Framework (2021) and policies EN1, EN4 and EN10 of the Cotswolds District Local Plan (2018).*

*No development shall take place within the application site until the applicant, or their agents or successors in title, has secured the implementation of a programme of archaeological work in accordance with a written scheme of investigation which has been submitted by the applicant and approved in writing by the local planning authority*

*Reason - It is important to agree a programme of archaeological work in advance of the commencement of development, so as to make provision for the investigation and recording of any archaeological remains that may be destroyed by ground works required for the scheme. The archaeological programme will advance understanding of any heritage assets which will be lost, in accordance with paragraph 205 of the National Planning Policy Framework.*

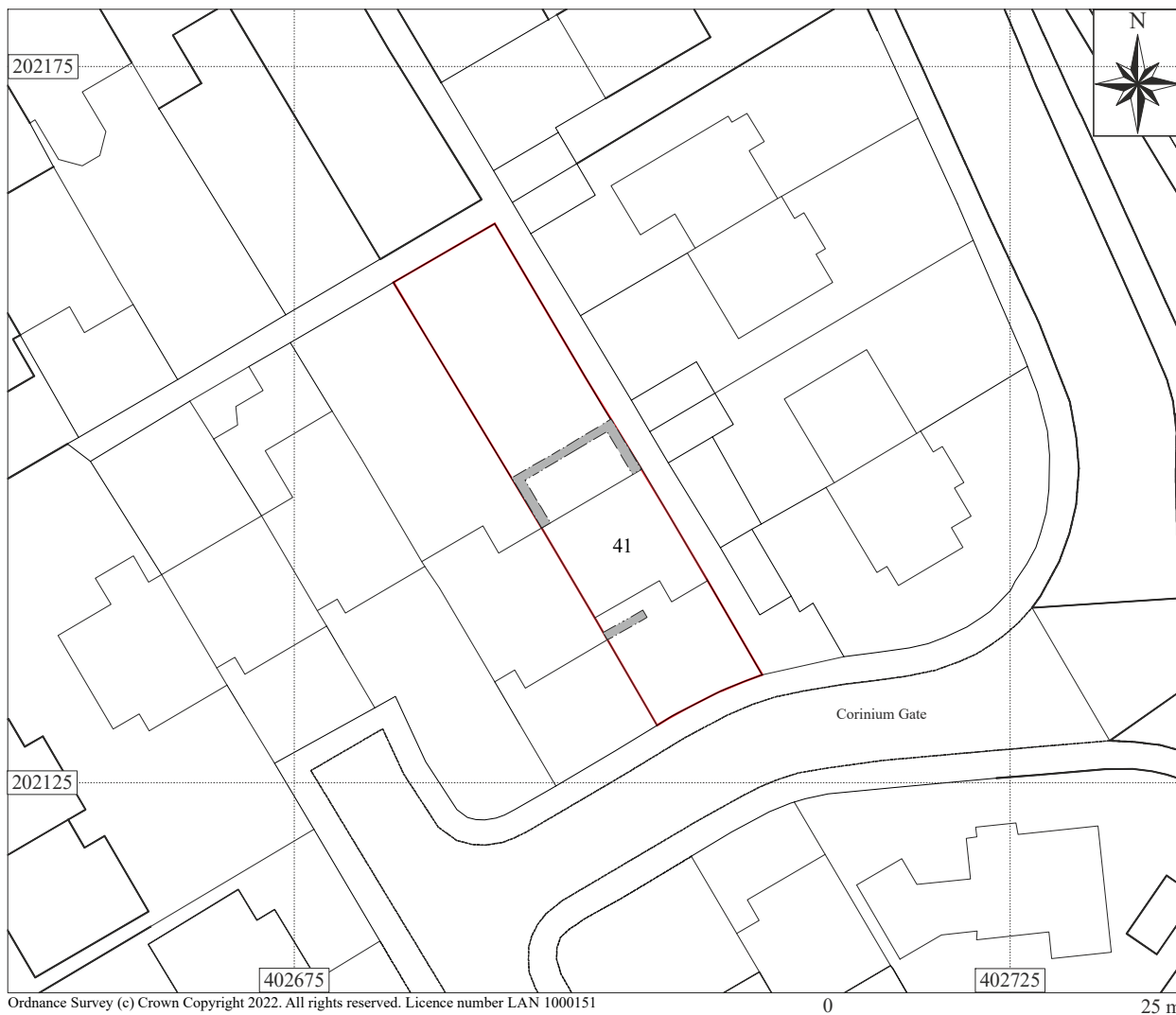
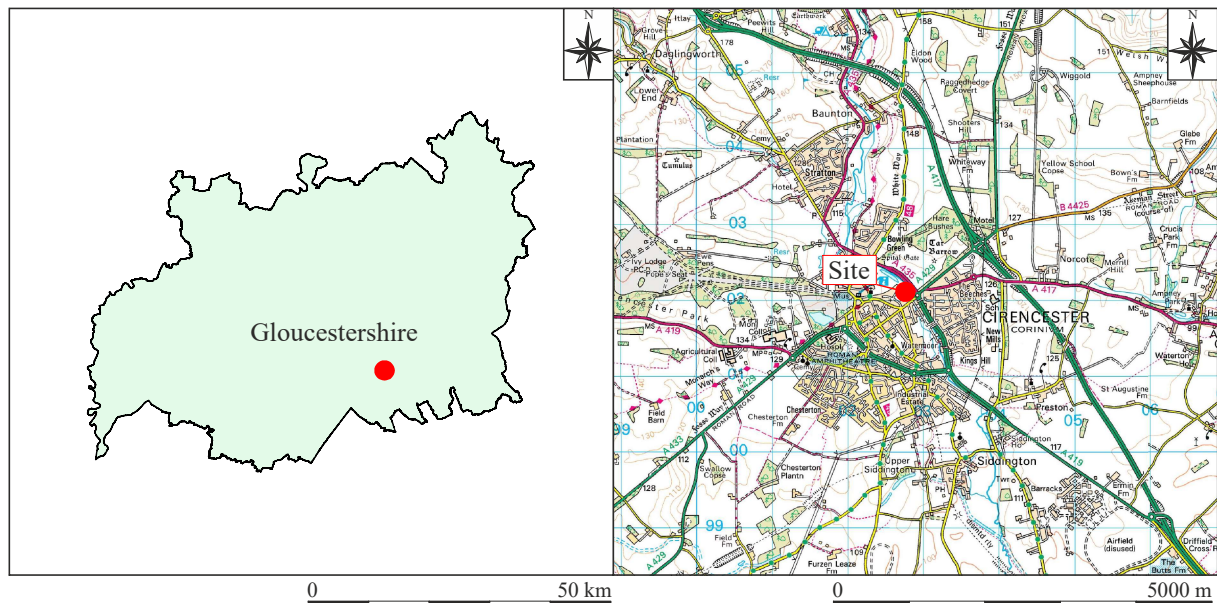

Key  Site boundary  Foundation trenches

Figure 1: Site location

Scheduled Monument Consent (S00242159) was granted for the works.

### **1.3 Archaeological Background**

The known archaeology in a 100m radius covers 18 cases on the Gloucestershire HER according to Heritage Gateway (one of which is not relevant). The NMR has 19 recorded sites. Some of these references refer to features on the same site. A search on the HER produced some 86 sites (much of which appears to be repetition, and many referring to the Roman City rampart. The sites are predominantly of a Roman date although some of these sites are medieval and post-medieval or later. A significant number in Corinium Gate produced negative evidence.

The full archaeological background has been detailed within the Heritage (Archaeological) Impact Assessment (JMHS, 2021).

## **2 METHODOLOGY**

The work was carried out in the manner that was required in the Scheduled Monument Consent. The groundwork contractor was told before commencement of on-site works that the site was within a scheduled monument. During the course of the groundworks an archaeologist visited to ensure that the ground reduction for the extensions was to the agreed depth (450mm) as specified in the Typical Slab Detail drawing. No ground reduction below this level was allowed.

Foundation trenches were excavated to the south-east and north-west of 41 Corinium Gate. The foundation trench to the south-east measured 3.20m by 0.60m and reached the agreed depth of 0.45m. The foundation trench to the north-west covered an area measuring 8.10m by 4.10m. After removal of the paving slabs and associated levelling material for them it too reached the agreed depth of 0.45m. The depths of the excavations did not exceed the agreed limit.

Where archaeological horizons were encountered they were cleaned by hand and excavated appropriately. Standard John Moore Heritage Services techniques were employed throughout, involving the completion of a written record for each deposit encountered, with scale plans and section drawings compiled where appropriate. A photographic record was also produced.

The resultant spoil from the works was visually scanned, especially for finds relating to the Roman period.

## **3 RESULTS**

All deposits and features were assigned individual context numbers. Context numbers without brackets indicate features i.e. pit cuts, numbers in ( ) show feature fills or deposits of material, while numbers in bold indicate structural features. Foundation trenches were excavated to the south-east and north-west of 41 Corinium Gate.

To the south-east, a foundation trench was excavated measuring 3.20m by 0.60m and reached a maximum depth of 0.45m. A made-ground deposit of friable, mid to dark-grey silty-clay (02) was observed (Fig 2, Plan 1 and Section 1). It was underlying a

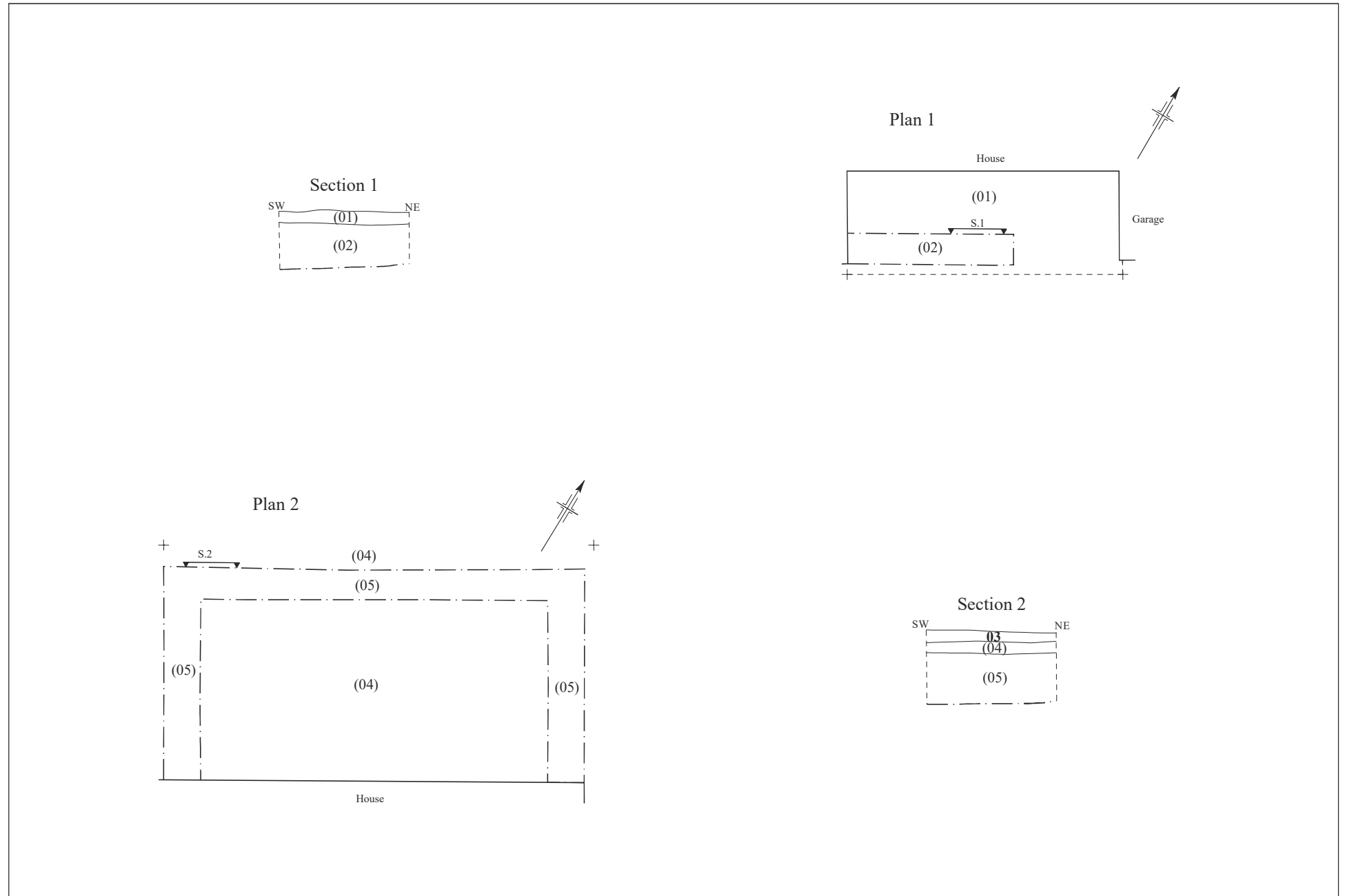

Figure 2: Plans of excavated areas and Sections

Sections 0 2 m

Plans 0 10 m



Plate 1: Section 2. Looking north-west.

loose, mid yellowy-grey sand (01). Deposit (01) was a levelling layer underlying a pre-existing tarmac surface.

To the north-west of 41 Corinium Gate, a foundation trench measuring 8.10m by 4.10m by 0.60m was excavated down to a maximum depth of 0.45m. The earliest deposit was a friable, mixed dark-grey and yellowy-brown silty-clay-sand (05) (Fig 2, Plan 2 and Section 2; Plate 1). Deposit (05) was a made-ground deposit that was associated with the construction of the house, side-alley and garden plot. Deposit (05) was underlying a levelling deposit comprised of a loose, light yellowy-brown sand (04). Deposit (04) was an underlying layer for the existing paving-slab surface **03**.

#### **4 FINDS**

No archaeological material relating to the Roman period or any other period was uncovered.

#### **5 DISCUSSION**

Archaeological monitoring of the foundation trench excavations uncovered a series of modern made-ground and levelling deposits. No archaeological features or deposits from any other period were observed.

#### **6 ARCHIVE**

A Digital Archive is maintained by John Moore Heritage Services (ID 4636) and will be made available upon request (to [admin@jmheritageservices.co.uk](mailto:admin@jmheritageservices.co.uk)). Digitised copies of all the primary records will be made publicly available as appendix to the Final Report submitted to OASIS (ID johnmoor1-505400).



## **7 BIBLIOGRAPHY**

Chartered Institute for Archaeologists, 2020 *Standard and Guidance for Archaeological Watching Brief.*

John Moore Heritage Services, 2021 – *41 Corinium Gate, Cirencester, Gloucestershire GL7 2PX, Heritage (Archaeological) Impact Assessment.*



Grid Squares <input checked="" type="checkbox"/>	Area/Trench <input checked="" type="checkbox"/>	Context Type Deposit	Site Code 4636	Context (01)
--	---	-------------------------	-------------------	-----------------

Plan No. P.1 on Drawing Sheet No. 1	Section No. S.1 on Drawing Sheet No. 1	Add. Sheet
--	---	------------

<b>DEPOSIT</b> 1 Compaction      2 Colour 3 Composition      4 Inclusions 5 Horizon clarity    6 Comments 7 Method & Conditions	<b>Description</b> 1.) loose 2.) mid yellow-gray 3.) sand 4.) 5.) 6.) 7.)
<b>CUT</b> 1 Shape in plan      2 Corners 3 Break of slope-top    4 Sides 5 Break of slope-base    6 Base 7 Orientation      8 Inclination of axis 9 Truncation      10 Fill Nos. 11 Other comments	
<b>Dimensions</b> Length: 3.20m Thickness/Depth: 0.11m Width: 0.60m	

Stratigraphic matrix	This context is: <input type="checkbox"/> <input type="checkbox"/> <input type="checkbox"/> <input type="checkbox"/> <input type="checkbox"/> <input checked="" type="checkbox"/> <input type="checkbox"/> <input type="checkbox"/> <input type="checkbox"/> <input type="checkbox"/>	<b>BELOW</b> Under: _____ Filled by: _____ Cut by: _____	Physical Relationship
	This context is: <input type="checkbox"/> <input type="checkbox"/> <input type="checkbox"/> <input type="checkbox"/> <input type="checkbox"/> <input type="checkbox"/> <input type="checkbox"/> <input type="checkbox"/> <input type="checkbox"/> <input type="checkbox"/>	<b>CONTEMPORARY</b> Group No.: _____ Same as: _____	
	This context is: <input type="checkbox"/> <input type="checkbox"/> <input type="checkbox"/> <input type="checkbox"/> <input type="checkbox"/> <input type="checkbox"/> <input type="checkbox"/> <input type="checkbox"/> <input type="checkbox"/> <input type="checkbox"/>	<b>ABOVE</b> Over: (02) Fill of: _____ Cuts: _____	

**Interpretation & Discussion:**      Internal      External      Structural      Other (specify)

levelling deposit underlying pre-existing damac.

<b>Environmental Samples</b> Nos: <input checked="" type="checkbox"/>	<b>FINDS</b> none <input checked="" type="checkbox"/> pot <input type="checkbox"/> CBM <input type="checkbox"/> fauna <input type="checkbox"/> flora <input type="checkbox"/> flint <input type="checkbox"/> glass <input type="checkbox"/> metal <input type="checkbox"/> burntmat. <input type="checkbox"/>
<b>Small Finds:</b> <input checked="" type="checkbox"/>	Other finds (specify): _____

<b>Provisional Date:</b> Modern	<b>Checked by (on site):</b> _____ <b>Date:</b> _____
<b>Completed by:</b> CW <b>Date:</b> 2/3/22	<b>Checked by (office):</b> _____ <b>Date:</b> _____

Grid Squares /	Area/Trench /	Context Type Deposit	Site Code 4636	Context (02)
-------------------	------------------	-------------------------	-------------------	-----------------

Plan No. P.1 on Drawing Sheet No. 1	Section No. S.1 on Drawing Sheet No. 1	Add. Sheet
--	---	------------

<b>DEPOSIT</b> 1 Compaction      2 Colour 3 Composition    4 Inclusions 5 Horizon clarity   6 Comments 7 Method & Conditions	<b>Description</b> 1.) mid to dark grey 2.) friable 3.) silty-clay 4.) fragments small to large stones. 5.) rock 6.) 7.)
<b>CUT</b> 1 Shape in plan      2 Corners 3 Break of slope-top   4 Sides 5 Break of slope-base   6 Base 7 Orientation      8 Inclination of axis 9 Truncation      10 Fill Nos. 11 Other comments	
<b>Dimensions</b> Length: 3.20m > Thickness/Depth: 0.34m > Width: 0.60m >	

Stratigraphic matrix	(01)	Physical Relationship
	This context is: (02)	
	(01)	
<b>BELOW</b> Under: (01) Filled by: Cut by:		
<b>CONTEMPORARY</b> Group No.: Same as:		
<b>ABOVE</b> Over: Fill of: Cuts:		

**Interpretation & Discussion:**      Internal      External      Structural      Other (specify)

Made-ground underlying laullying layer (01)  
 Associated with construction of house.

<b>Environmental Samples</b> Nos:	<b>FINDS</b> none pot CBM fauna flora flint glass metal burntmat. <input checked="" type="checkbox"/> <input type="checkbox"/> <input type="checkbox"/> <input type="checkbox"/> <input type="checkbox"/> <input type="checkbox"/> <input type="checkbox"/> <input type="checkbox"/> <input type="checkbox"/>
<b>Small Finds:</b>	Other finds (specify):

<b>Provisional Date:</b> Mochen	<b>Checked by (on site):</b>	<b>Date:</b>	
<b>Completed by:</b> CW	<b>Date:</b> 2/3/22	<b>Checked by (office):</b>	<b>Date:</b>

Grid Squares <input checked="" type="checkbox"/>	Area/Trench <input checked="" type="checkbox"/>	MASONRY	Site Code 4636	Context 103
--	---	---------	-------------------	----------------

Add. Sheets	Plan Nos. P.2	Section Nos. S.2	Matrix Location
-------------	------------------	---------------------	-----------------

Photographs Slide	B&W	<ol style="list-style-type: none"> <li>1 Materials</li> <li>2 Size of materials (brick: BLT in mm)</li> <li>3 Finish of stones</li> <li>4 Coursing/bond</li> <li>5 Form</li> <li>6 Direction of face(s)</li> <li>7 Bonding material</li> <li>8 Dimensions as found</li> <li>9 Other comments</li> </ol>
-------------------	-----	---

<p>Description</p> <p>1.) Stone</p> <p>2.) /</p> <p>3.) /</p> <p>4.) /</p> <p>5.) Rectangular floor surface</p> <p>6.) /</p> <p>7.) /</p> <p>8.) 8.10m x 4.10m x 0.08m</p>	
--	--

<p>Stratigraphic matrix</p> <table style="width:100%; text-align: center;"> <tr> <td><input type="checkbox"/></td> <td><input type="checkbox"/></td> <td><input type="checkbox"/></td> <td><input type="checkbox"/></td> <td><input type="checkbox"/></td> </tr> <tr> <td colspan="2">This context is</td> <td>103</td> <td></td> <td></td> </tr> <tr> <td><input type="checkbox"/></td> <td><input type="checkbox"/></td> <td>(04)</td> <td><input type="checkbox"/></td> <td><input type="checkbox"/></td> </tr> </table>	<input type="checkbox"/>	<input type="checkbox"/>	<input type="checkbox"/>	<input type="checkbox"/>	<input type="checkbox"/>	This context is		103			<input type="checkbox"/>	<input type="checkbox"/>	(04)	<input type="checkbox"/>	<input type="checkbox"/>	<p>Initials &amp; Date CW 3/3/22</p> <p>Checked by &amp; Date</p>
<input type="checkbox"/>	<input type="checkbox"/>	<input type="checkbox"/>	<input type="checkbox"/>	<input type="checkbox"/>												
This context is		103														
<input type="checkbox"/>	<input type="checkbox"/>	(04)	<input type="checkbox"/>	<input type="checkbox"/>												

Interpretation:	Internal	<del>External</del>
<p>Stone-built paving slab surface</p>		
Associated contexts: _____		
Context same as: _____		
Worked stones: _____		

Levels on plan	sheet	Samples Petrological:	Regular bricks
Highest	Lowest	Mortar: <input checked="" type="checkbox"/>	Special bricks <input checked="" type="checkbox"/>

Checked Interpretation	

Provisional period	Group	Structure No	Initials & Date
--------------------	-------	--------------	-----------------

Grid Squares /	Area/Trench /	Context Type Deposit	Site Code 4636	Context (04)
-------------------	------------------	-------------------------	-------------------	-----------------

Plan No. P.2 on Drawing Sheet No. 1	Section No. S.2 on Drawing Sheet No. 1	Add. Sheet
--	---	------------

<b>DEPOSIT</b> 1 Compaction      2 Colour 3 Composition    4 Inclusions 5 Horizon clarity   6 Comments 7 Method & Conditions	<b>Description</b> 1.) loose 2.) light yellow-brown 3.) sand 4.) ✓ 5.) good 6.) ✓ 7.) ✓
<b>CUT</b> 1 Shape in plan      2 Corners 3 Break of slope-top   4 Sides 5 Break of slope-base   6 Base 7 Orientation      8 Inclination of axis 9 Truncation      10 Fill Nos. 11 Other comments	
<b>Dimensions</b> Length: 8.10m Thickness/Depth: 0.09m Width: 4.10m	

Stratigraphic matrix	Under: <u>103</u> Filled by:      Cut by:	Physical Relationship
	<b>CONTEMPORARY</b> Group No.:      Same as:	
	<b>ABOVE</b> Over: <u>105</u> Fill of:      Cuts:	

**Interpretation & Discussion:**      Internal      External      Structural      Other (specify)

levelling layer including paving slabs 103

<b>Environmental Samples</b> Nos: /	<b>FINDS</b> none   pot   CBM   fauna   flora   flint   glass   metal   burntmat. <input checked="" type="checkbox"/> <input type="checkbox"/> <input type="checkbox"/> <input type="checkbox"/> <input type="checkbox"/> <input type="checkbox"/> <input type="checkbox"/> <input type="checkbox"/> <input type="checkbox"/>
<b>Small Finds:</b> /	Other finds (specify):

<b>Provisional Date:</b> Madam	<b>Checked by (on site):</b>	<b>Date:</b>
<b>Completed by:</b> CW <b>Date:</b> 3/3/22	<b>Checked by (office):</b>	<b>Date:</b>

Grid Squares /	Area/Trench /	Context Type Deposit	Site Code 4636	Context (05)
-------------------	------------------	-------------------------	-------------------	-----------------

Plan No. P.2 on Drawing Sheet No. 1	Section No. S2 on Drawing Sheet No. 1	Add. Sheet
--	--	------------

<b>DEPOSIT</b> 1 Compaction      2 Colour 3 Composition    4 Inclusions 5 Horizon clarity   6 Comments 7 Method & Conditions	<b>Description</b> 1.) Fossil 2.) clean grey mixed with yellow-brown 3.) silty-clay w/ sand 4.) frequent small to medium Stags. frequent rooty. 5.) Good 6.) / 7.) /
<b>CUT</b> 1 Shape in plan      2 Corners 3 Break of slope-top   4 Sides 5 Break of slope-base   6 Base 7 Orientation      8 Inclination of axis 9 Truncation      10 Fill Nos. 11 Other comments	
<b>Dimensions</b> Length: 8.10m > Thickness/Depth: 0.28m > Width: 4.10m >	

Stratigraphic matrix	Under: (de)      Filled by:      Cut by:	Physical Relationship
	<b>CONTEMPORARY</b> Group No.:      Same as:	
	<b>ABOVE</b> Over:      Fill of:      Cuts:	

<b>Interpretation &amp; Discussion:</b>	Internal	External	Structural	Other (specify)
Made gravel layer. Mixed deposit associated with lamination of base + pebbly slabs				

<b>Environmental Samples</b> Nos: /	<b>FINDS</b> none   pot   CBM   fauna   flora   flint   glass   metal   burntmat. <input checked="" type="checkbox"/> <input type="checkbox"/> <input type="checkbox"/> <input type="checkbox"/> <input type="checkbox"/> <input type="checkbox"/> <input type="checkbox"/> <input type="checkbox"/> <input type="checkbox"/>
<b>Small Finds:</b> /	Other finds (specify):

<b>Provisional Date:</b> March	<b>Checked by (on site):</b> <b>Date:</b>
--------------------------------	---

<b>Completed by:</b> MW <b>Date:</b> 3/3/22	<b>Checked by (office):</b> <b>Date:</b>
---	--









S.1 Rep Sec 1:20 CW 2/3/22

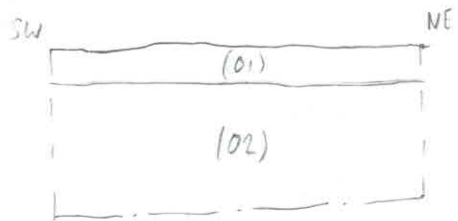

P.1 1:50

CW 2/3/22

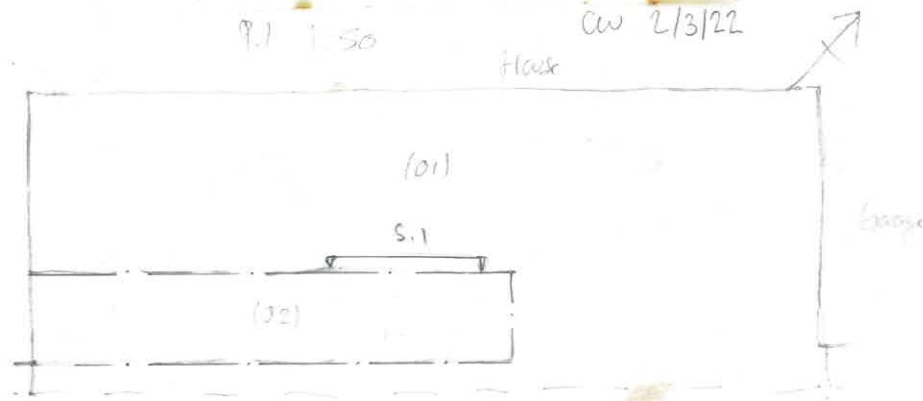

S.2 Rep Sec 1:20 CW 2/3/22

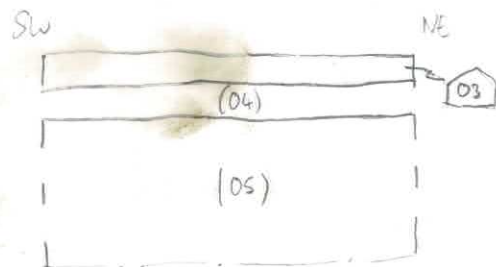

P.2 1:50

CW 3/3/22

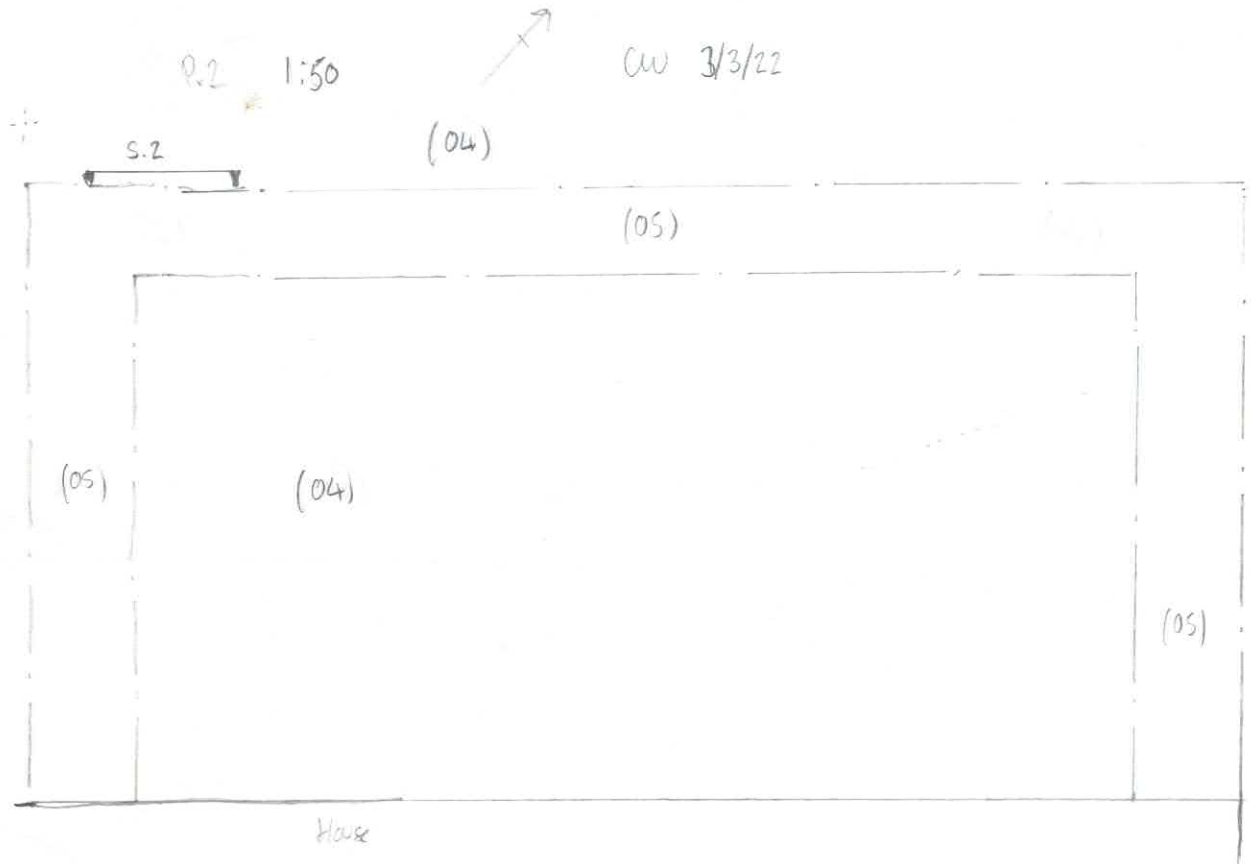

## Summary for johnmoor1-505400

OASIS ID (UID)	johnmoor1-505400
Project Name	41 Corinium Gate, Cirencester
Sitename	
Activity type	Field Observation (Monitoring)
Project Identifier(s)	4636
Planning Id	21/03392/FUL
Reason For Investigation	Planning requirement
Organisation Responsible for work	John Moore Heritage Services
Project Dates	02-Mar-2022 - 03-Mar-2022
Location	41 Corinium Gate, Cirencester NGR : SP 02698 02143 LL : 51.7180078624023, -1.96234559838169 12 Fig : 402698,202143
Administrative Areas	Country : England County : Gloucestershire District : Cotswold Parish : Cirencester
Project Methodology	<p>The work was carried out in the manner that was required in the Scheduled Monument Consent. The groundwork contractor was told before commencement of on-site works that the site was within a scheduled monument. During the course of the groundworks an archaeologist visited to ensure that the ground reduction for the extensions was to the agreed depth (450mm) as specified in the Typical Slab Detail drawing. No ground reduction below this level was allowed.</p> <p>Foundation trenches were excavated to the south-east and north-west of 41 Corinium Gate. The foundation trench to the south-east measured 3.20m by 0.60m and reached the agreed depth of 0.45m. The foundation trench to the north-west covered an area measuring 8.10m by 4.10m. After removal of the paving slabs and associated levelling material for them it too reached the agreed depth of 0.45m. The depths of the excavations did not exceed the agreed limit.</p> <p>Where archaeological horizons were encountered they were cleaned by hand and excavated appropriately. Standard John Moore Heritage Services techniques were employed throughout, involving the completion of a written record for each deposit encountered, with scale plans and section drawings compiled where appropriate. A photographic record was also produced.</p> <p>The resultant spoil from the works was visually scanned, especially for finds relating to the Roman period</p>
Project Results	Archaeological monitoring of the foundation trench excavations uncovered a series of modern made-ground and levelling deposits. No archaeological features or deposits from any other period were observed.
Keywords	
Funder	
HER	City of Gloucester and Gloucestershire HER - noRev - LITE
Person Responsible for work	C, Whitehead

HER Identifiers	
Archives	