

**Bishop Grosseteste College,
Newport/Longdales Road
Lincoln**

**Archaeological Attendance and Recording
(Archaeological Watching Brief)
of Geotechnical Evaluation Pits**

**LCC Accession No : 2001.170
Site Code : BGCA01**

Network Archaeology Report No : 164

CONTENTS

1.	Summary	1
2.	Introduction	1
3.	The Site	1
4.	Archaeological Background	1
5.	Objectives	2
6.	Archaeological Procedures	2
7.	Results	3
8.	Conclusion	3
9.	Project Archive	3
10.	Acknowledgements	3
Appendices		4
I	Context Summary	
II	Archive Index	
III	UAD data	

1. SUMMARY

- 1.1 *Four geotechnical evaluation pits were machine-excavated within the grounds of Bishop Grosseteste College, Newport, Lincoln. It is proposed to construct a new teaching block on the land. Archaeological supervision of the evaluation pits revealed nothing of archaeological significance.*

2. INTRODUCTION

- 2.1 Network Archaeology Ltd were commissioned in June 2001 by LKR Design Group (on behalf of Bishop Grosseteste College) to carry out an archaeological watching brief during the excavation of four geotechnical pits at Bishop Grosseteste College, Newport, Lincoln (Figure 1).
- 2.2 The results of the archaeological watching brief will enable the Department of Planning (Lincoln City Council) to make an informed decision on the archaeological implications of a proposed application for Planning Permission to construct a new teaching block on the College site.

3. THE SITE

- 3.1 The College is situated towards the northern part of Lincoln, on the east side of the A15 (Ermine Street Roman road).
- 3.2 Within the College, the development site is located on land which is now partly grass, partly road, and partly tennis courts. It lies to the south-east of Bishop Greaves Lecture Theatre, and is centred at NGR SK 97870 72850.
- 3.3 The ground is flat and lies at around 60m AOD.
- 3.4 The dominant local geology is Middle Jurassic Lincolnshire Limestone. The site itself sits on the 'Crossi Bed' division. The upper surface of the limestone tends to be a weathered brash.

4. ARCHAEOLOGICAL BACKGROUND

- 4.1 The area has produced evidence of occupation from the Roman period onwards. The remains of Roman properties fronting on to the major Roman road of Ermine Street have been investigated within the College grounds west of the site, as well as 580m to the south at Lilly's Road. Roman burials have also been found in the area of Broadway.
- 4.2 The site lies between 50m and 125m east of the boundary bank and ditch of the medieval suburb of Newport. Excavations of the medieval bank and ditch at its north-east corner took place in 1937.

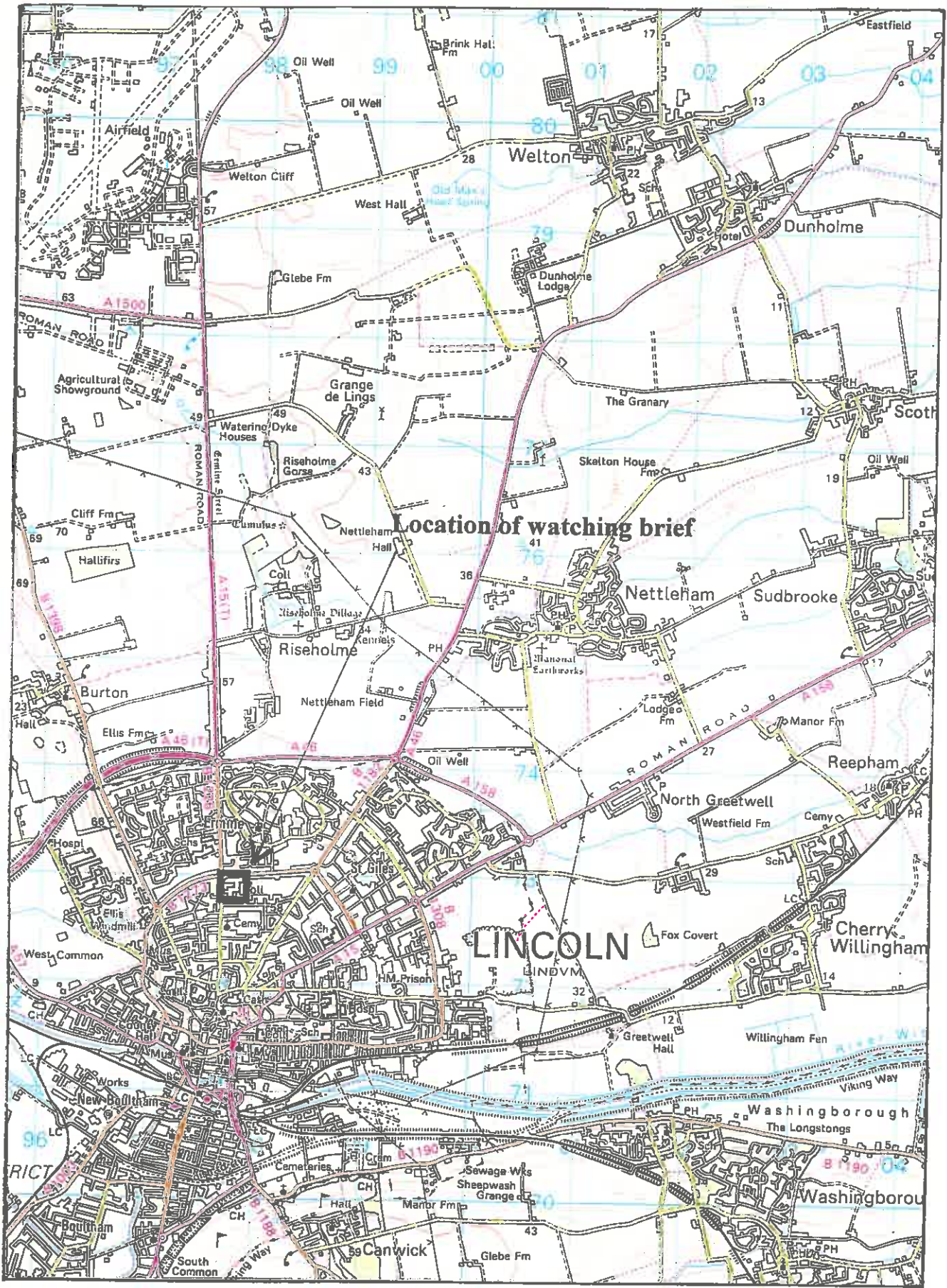

Figure 1: Plan showing location of watching brief (Scale 1:50 000)

(Reproduced from the OS Landranger Series, Sheet 121 (Lincoln) with the permission of the Controller of her Majesty's Stationary Office. NAL licence number AL 52256A)

4.3 No investigations or finds appear to have been reported from the evaluation pit site itself.

5. OBJECTIVES

5.1 The objectives of the watching brief were to:

- provide a permanent-presence watching brief during all ground disturbing activities;
- gather sufficient information to establish the presence or absence, extent, condition, character, quality and date of archaeological remains;
- locate, recover, identify, and conserve (as appropriate) any archaeological artefacts;
- locate, sample, interpret and record archaeological deposits;
- recommend mitigatory measures for preservation *in situ* of archaeological deposits (where feasible and desirable);
- determine the palaeo-environmental and palaeo-economic potential of any archaeological remains;
- assess the overall archaeological significance of any archaeological remains;
- produce and submit a suitable archive;
- produce a report that addresses the above
- provide information for accession to the County Sites and Monuments Record (SMR) and the Lincoln Urban Archaeological Database (UAD)
- publish significant results in an appropriate journal (if appropriate).

6. ARCHAEOLOGICAL PROCEDURES

6.1 The approximate location for each of the four evaluation pits was determined by LKR Design Group prior to the evaluation. Each pit was then positioned accurately in relation to existing college buildings and other fixed points such as roadside kerbs (Figure 2).

6.2 A mechanical excavator fitted with a 1m-wide toothless ditching bucket was used to open the pits. Each pit was approximately 1m square, and was excavated to a depth of between 650mm and 1100mm.

6.3 The excavation of each of the geotechnical evaluation pits was monitored by a qualified archaeologist on Friday 22nd June 2001. The spoil from each pit was searched for artefacts.

6.4 After the excavation of each pit, the sections and base were cleaned, and a photographic, drawn and written record made of all deposits exposed.

6.5 After the pits had been recorded archaeologically, they were inspected for geotechnical purposes, prior to being backfilled on the 22nd June 2001.

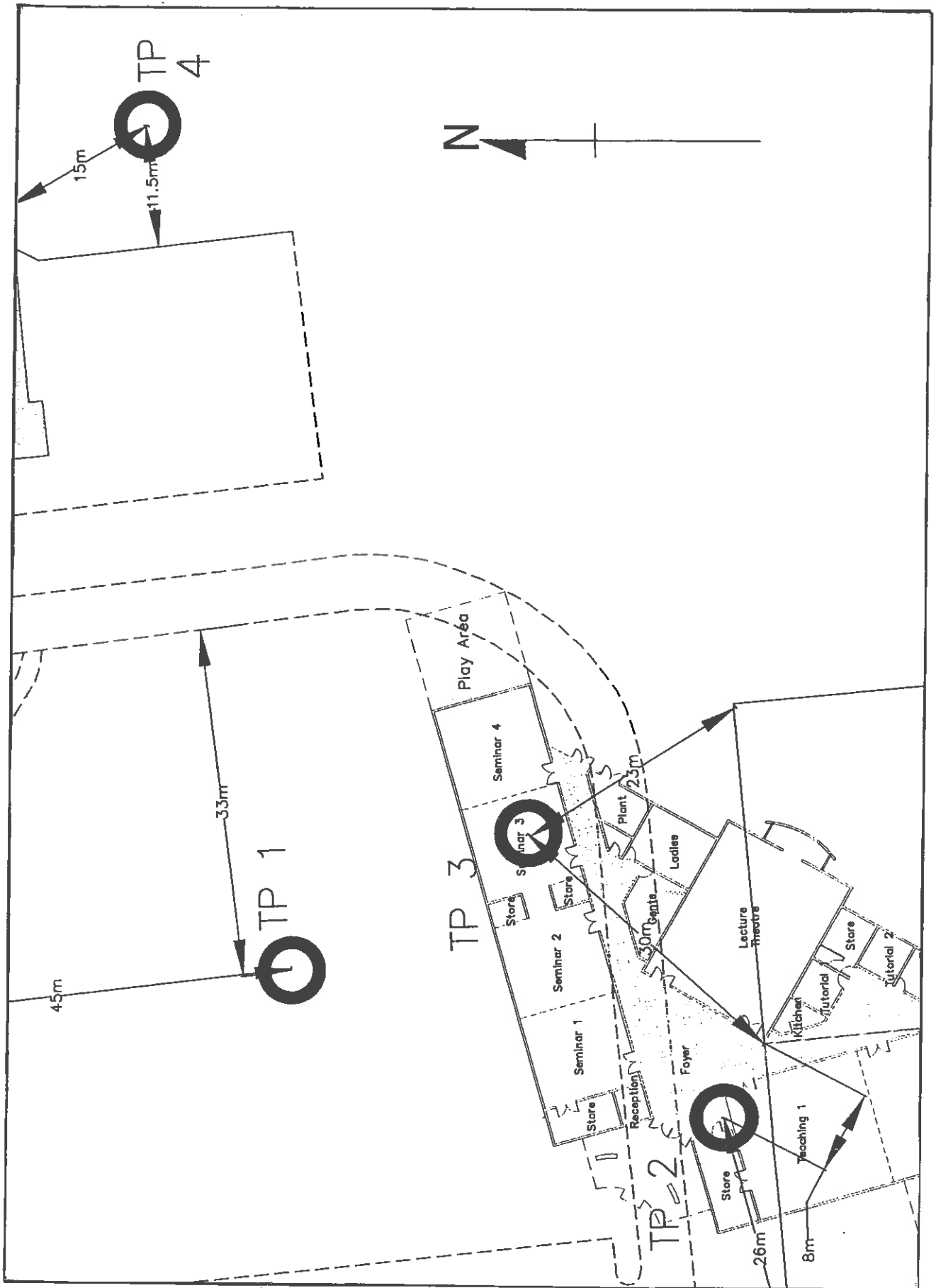

Figure 2: Location of geotechnical evaluation pits (Scale 1:500)

(Reproduced from LKR Design Group Plan: LK/225 110A)

7. RESULTS

- 7.1 None of the evaluation pits revealed any deposits of archaeological significance.
- 7.2 No artefacts were found except for small quantities of modern brick, pottery and glass in the topsoil, none of which was retained.
- 7.3 Each evaluation pit contained a darkish brown sandy loam topsoil, generally 0.3m thick and containing occasional small limestone fragments (less than 0.05m across) and modern artefacts (see 7.2 above).
- 7.4 Below the topsoil in each pit was a pale brown silty sand, at least 0.4m thick and containing moderate quantities of larger limestone fragments (up to 0.15m across). This 'subsoil' deposit is assumed to be the uppermost weathered surface of the Lincolnshire Limestone geology.

8. CONCLUSION

- 8.1 The geotechnical evaluation pits contained nothing of archaeological significance. This suggests that the development site as a whole contains little or no significant archaeology.

9. PROJECT ARCHIVE

- 9.1 The project archive will be prepared in accordance with the guidelines outlined in *Management of Archaeological Projects*, Appendix 3, English Heritage, 1991.
- 9.2 A copy of the project archive will be deposited with the City and County Museum. Network Archaeology Ltd will ensure that the project archive conforms with the City and County Museum's '*Conditions for the Acceptance of Project Archives*', and relevant national guidelines (UKIC 1990, MGC 1992).
- 9.3 Copies of this report will be made available to LKR Design Group, Lincolnshire SMR (subject to any agreed timescales for confidentiality) and the Director of Planning (Lincolnshire City Council). A copy will also be deposited with the City and County Museum, as part of the project archive.

10. ACKNOWLEDGEMENTS

- 10.1 Thanks are due to Dale Lui of LKR Design Group for commissioning the work.
- 10.2 For Network Archaeology, Chris Taylor acted as Project Manager and wrote this report; Jim Collins carried out the watching brief, and Geraint Franklin produced the figures.

APPENDICES

I Context Summary

100	topsoil
101	subsoil (weathered Lincolnshire Limestone)
200	topsoil
201	subsoil (weathered Lincolnshire Limestone)
202	subsoil (weathered Lincolnshire Limestone)
300	topsoil
301	subsoil (weathered Lincolnshire Limestone)
400	topsoil
401	subsoil (weathered Lincolnshire Limestone)

II Archive Index

The following will be deposited with the City and County Museum, Lincoln :

Context index (1)
Context sheets (9)
Photographic indices (2 - colour slide and black & white)
Colour slides (8)
Black & white negatives (4)
Drawing index (1)
A3 drawing sheet (1) with section drawings (4)

III UAD data

Summary for Recognition Events Database

Name	Bishop Grosseteste College
Code	BGCA01
Address	Bishop Grosseteste College, Newport, Lincoln
NGR	SK 97870 72850 (centre of site)
Type of Intervention	Watching Brief
Start-end dates	22/07/01 - 22/07/01
Field Officer	Jim Collins
Organisation	Network Archaeology Ltd
Archive location	City and County Museum, Lincoln
Artefacts location	no artefacts found
Accession Number	2001.170