



-  Proposed re-route
-  Proposed pipeline route

[Reproduced from Ordnance Survey Data with permission of the controller of her Majesty's Stationery Office. © Crown copyright reserved. Licence number ES 100018275



2.00	23/03/07	First issue	SAF	DB	CT
Ver	Date	Description	Drn	Chk	App





King's Lynn to Wisbech Pipeline
(Fox Hill re-route)

Figure 1
Location of Fox Hill reroute

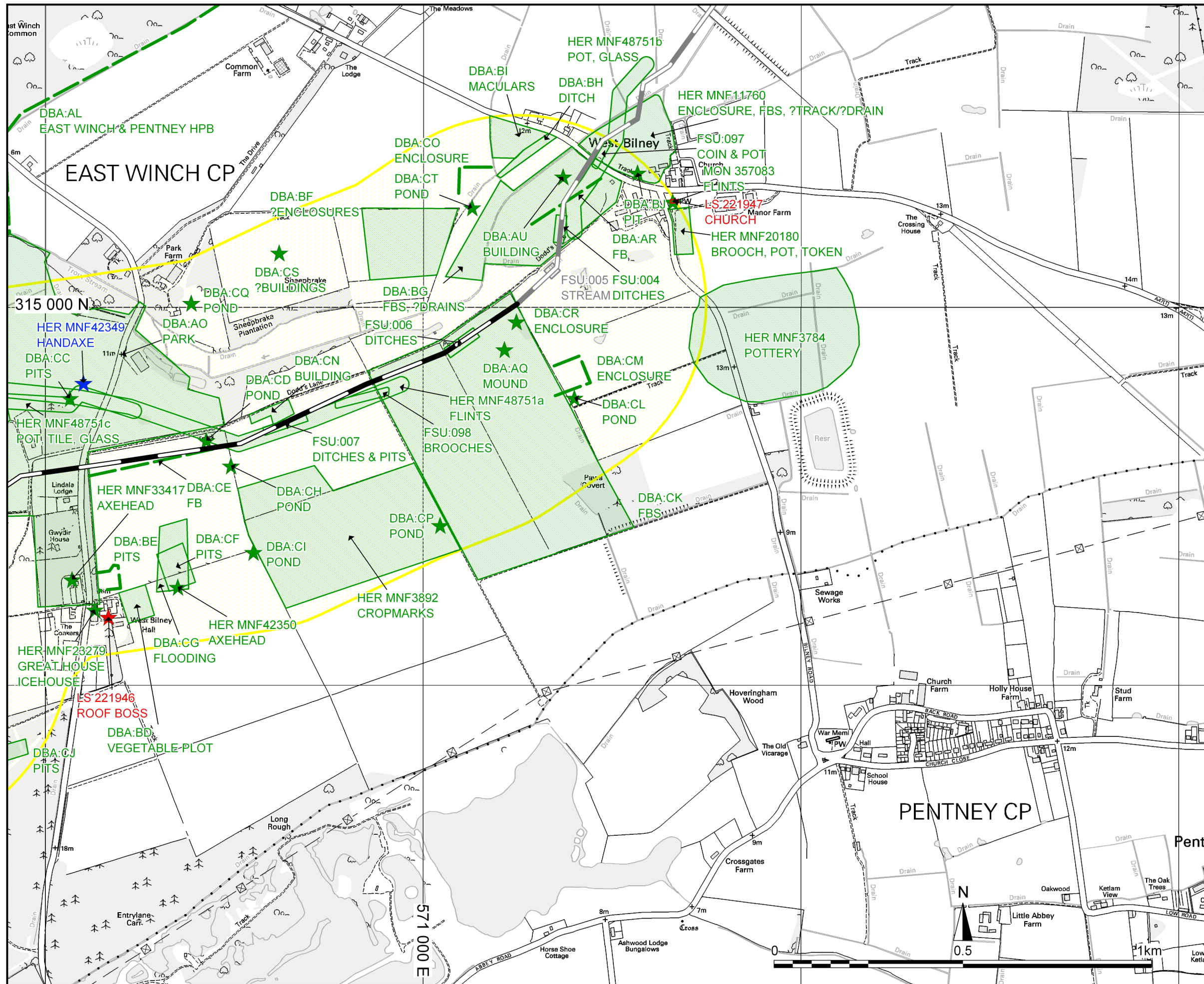
Scale: 1:100 000



-  Proposed re-route
-  Proposed pipeline route
-  Study Area

Archaeological constraints

-  A grade
-  B grade
-  C grade
-  D grade
-  U grade

[Reproduced from Ordnance Survey Data with permission of the controller of her Majesty's Stationary Office. © Crown copyright reserved. Licence number ES 100018275]

2.00	23/03/07	First issue	SAF	DB	CT
Ver	Date	Description	Drn	Chk	App



King's Lynn to Wisbech Pipeline
(Fox Hill re-route)

Figure 2
Archaeological constraints

Scale: 1:10 000

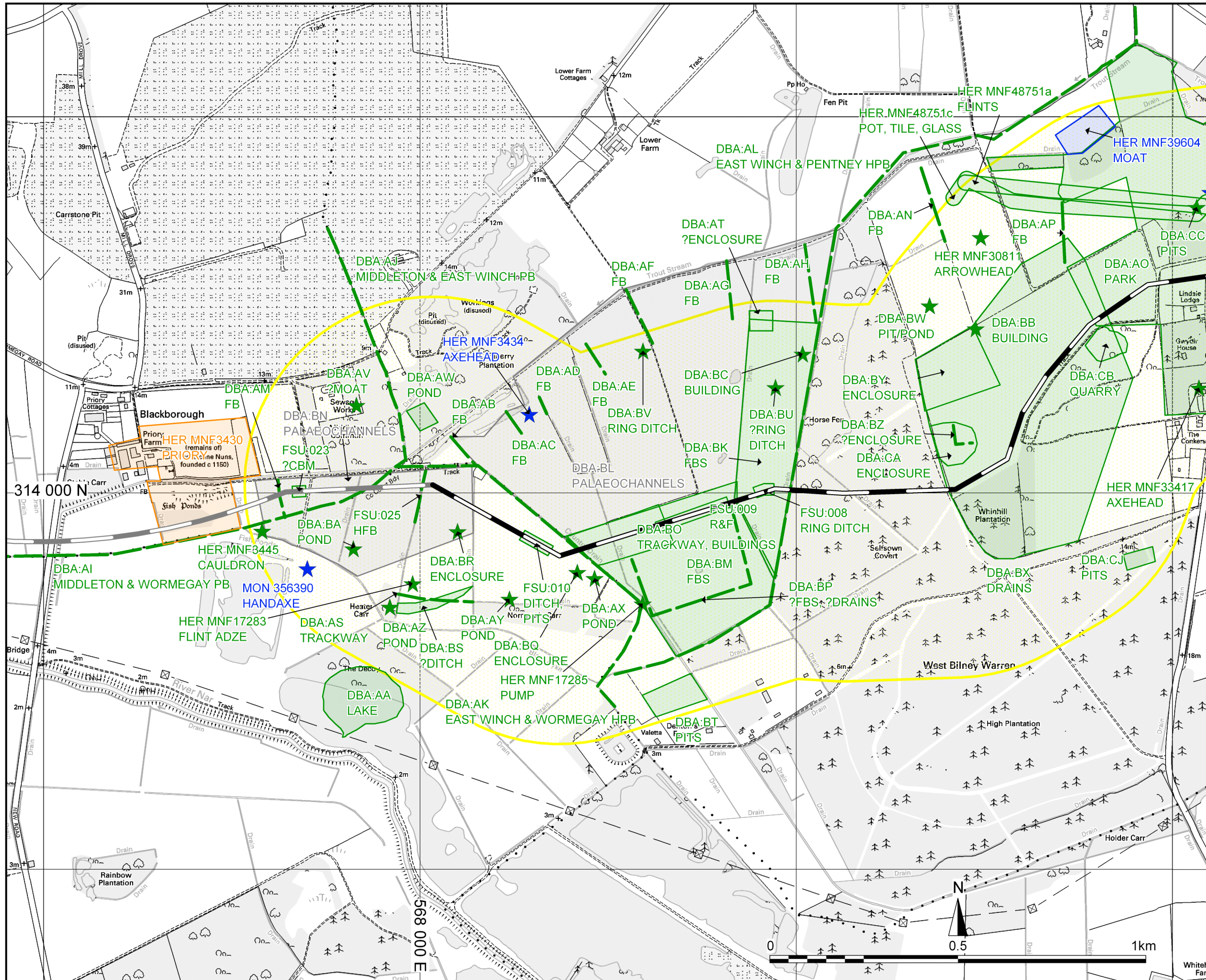

- Proposed re-route
 - Proposed pipeline route
 - Study Area
- Archaeological constraints**
- A grade
 - B grade
 - C grade
 - D grade
 - U grade

[Reproduced from Ordnance Survey Data with permission of the controller of her Majesty's Stationary Office. © Crown copyright reserved. Licence number ES 100018275]

Ver	Date	Description	Drn	Chk	App
2.00	23/03/07	First issue	SAF	DB	CT



King's Lynn to Wisbech Pipeline
(Fox Hill re-route)

Figure 3
Archaeological constraints

Scale: 1:10 000