

Archaeological Watching Brief
Land adjacent to 30 Holdings,
Campmuir, Perth and Kinross

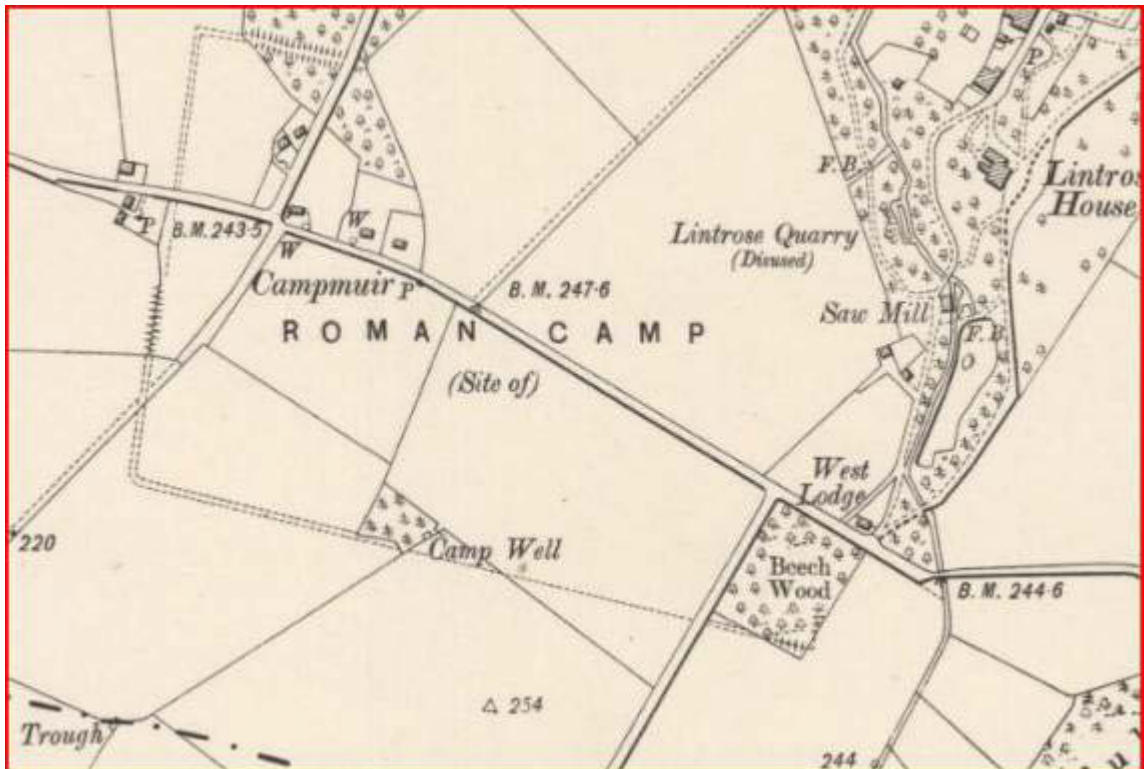

2nd edition Ordnance Survey map of Campmuir (1903) showing defences of Roman temporary camp
(© Trustees of the National Library of Scotland)



3rd May 2017

Introduction

This archaeological watching brief was carried out for Mr W McAllister to satisfy the outstanding archaeological condition on the planning consent for this development, as noted by Perth and Kinross Heritage Trust in the Terms of Reference to Planning Application 16/01060/FLL dated 21st September 2016. This work was carried out by the author on Friday 28th April and Monday 1st May 2017 (site code LINT05). Weather conditions were fine, dry and overcast on both days.

Archaeological Background (Illus 1, 2)

The proposed development site lies within an area that is considered to have archaeological potential given its location within the Roman Temporary Camp of Lintrose (Campmuir). The temporary camp consists of a large rectangular enclosure (approx. 32 hectares) defined by a ditch and bank and would have been used by the Roman Army nearly 2000 years ago.

Part of the defensive bank survives on the northern side of the camp, and other sections of the boundary ditch have been traced as cropmarks by aerial photography. A section of ditch and associated features within the camp were excavated at Muirside in 2003-04 (Cachart 2004, 107) and parts of the camp interior were examined during Watching Briefs at land West of Hillview in 2011, at 30 Holding in 2012 and North of Harris in 2016 (Hall 2011, Hall 2012, Hall 2016). In 2015 an evaluation was carried out in the vicinity of the western defence line at Tradewinds (Hall 2015). Recent archaeological investigations of a temporary camp at Kintore (Aberdeenshire) has revealed that the name 'camp' is misleading, and that the camps could be in use for much longer periods of time than the name might suggest, however, to date, from the small number of investigations that have taken place at Campmuir, including at Broadwood - to the north of the current plot - little relating to the Roman occupation has been recovered.

Watching Brief

Perth and Kinross Heritage Trust requested that all below ground excavations associated with the construction of the new house should be monitored by an archaeologist.

Footprint for House and garage (Illustration 3 to 8)

As a first step the proposed house plot was stripped of topsoil. A dark brown well sorted topsoil (100) was excavated to a depth of 0.52m at the Eastern end of the site and this overlay a dark brown sandy clay with occasional small, medium and large green sandstones (101). This pattern was repeated across the stripped area with the topsoil becoming steadily shallower the further West that the machining took place. At the Western limit of the plot a depth of 0.20m of topsoil was recorded. Nothing archaeological was located during this topsoil strip and there were no finds. On the next visit to site all of the foundation trenches for the new house were dug by machine as strip trenches 0.80m wide and 0.35m deep. These trenches were dug through 101 and bottomed on 102 a natural hard red brown clay and stone. No finds were recovered.

Recommendations

Monitoring of the excavations of the plot and house foundations located no evidence relating to the Roman temporary camp. Following this watching brief it is recommended that no further archaeological works are required.

Acknowledgements

The author would like Mr McAllister for his interest in this project and the machine driver and his sons for the efficient excavation and removal of the soil.

Reference

Cachart, R 2004 '30 Holding, Coupar Angus' *Discover Excav Scot* Vol 5, 107

Hall, D W 2011 'Watching Brief on new house West of Hillview, Campmuir'

Hall, D W 2012 'Archaeological watching brief, 30 Holding, Lintrose, Perth and Kinross'

Hall, D W 2015 'Archaeological Evaluation New house site 50m SW of Tradewinds, Campmuir, Perth and Kinross

Hall, D W 2016 'Archaeological watching brief on land North of Harris, Campmuir, Perth and Kinross'

The above client reports are available at

[http://archaeologydataservice.ac.uk/archives/view/greylit/browse.cfm?unit=Derek Hall](http://archaeologydataservice.ac.uk/archives/view/greylit/browse.cfm?unit=Derek%20Hall)

Context List*Development Plot and House foundations*

100 Dark brown topsoil and turf

101 Dark brown sandy clay with occasional small, medium and large green sandstones

102 Red brown clay and stones (natural)

Discovery & Excavation in Scotland Entry

LOCAL AUTHORITY:	Perth and Kinross
PROJECT TITLE/SITE NAME:	Land adjacent to 30 Holdings, Campmuir, Perth and Kinross
PROJECT CODE:	LINT05
PARISH:	Kettins
NAME OF CONTRIBUTOR(S):	Derek Hall
NAME OF ORGANISATION:	Derek Hall, archaeologist and ceramic specialist
TYPE(S) OF PROJECT:	Archaeological Watching Brief
NMRS NO(S):	NO23NW 5
SITE/MONUMENT TYPE(S):	Roman Temporary Camp
SIGNIFICANT FINDS:	None
NGR (2 letters, 6 figures)	NO 2218 3746
START DATE	28 th April 2017
END DATE	1 st May 2017
PREVIOUS WORK (incl. <i>DES</i> ref.)	None
MAIN (NARRATIVE) DESCRIPTION: (May include information from other fields)	Watching briefs were carried out on topsoil stripping and excavation of foundation trenches for a new house within the Roman Temporary Camp of Lintrose. Nothing of archaeological interest was located.
PROPOSED FUTURE WORK:	None
SPONSOR OR FUNDING BODY:	Mr W McAllister
CAPTIONS FOR ILLUSTRS	N/A
ADDRESS OF MAIN CONTRIBUTOR:	34 Glenfarg Terrace, Perth, PH2 0AP
ARCHIVE LOCATION (intended)	NMRS
EMAIL ADDRESS:	Derek.hall1@blueyonder.co.uk

Illustration List

Illustration 1 Site Location (red circle) (based on Ordnance Survey map Crown Copyright 2014. All Rights Reserved. Licence number 100049628)

Illustration 2 Location of site on General Roys map of 1747-1755 (© Trustees of the National Library of Scotland)

Illustration 3 Site location plan (based on supplied architects plan)

Illustration 4 Plan of trenches monitored (topsoil strip in green, house footprint in red, existing house at 30 Holding shown as solid black) Scale 1:250

Illustration 5 Plot stripped of topsoil looking East

Illustration 6 General view of excavated foundation trenches looking North West

Illustration 7 North facing section showing topsoil (100) above dark brown sandy clay (101)

Illustration 8 East facing section of foundation trench for front of house showing typical site pattern of dark brown sandy clay (101) over lying natural red brown clay and stone (102)

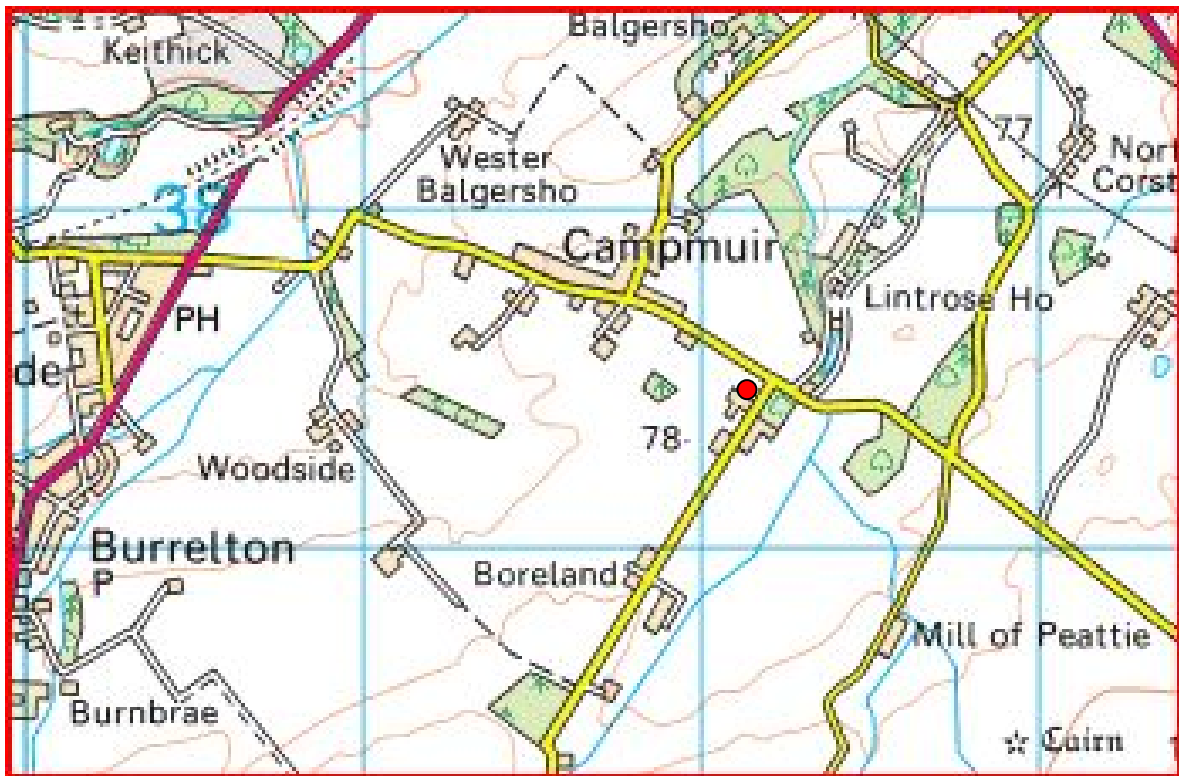

Illustration 1 Site Location (red circle) (based on Ordnance Survey map Crown Copyright 2014. All Rights Reserved. Licence number 100049628)

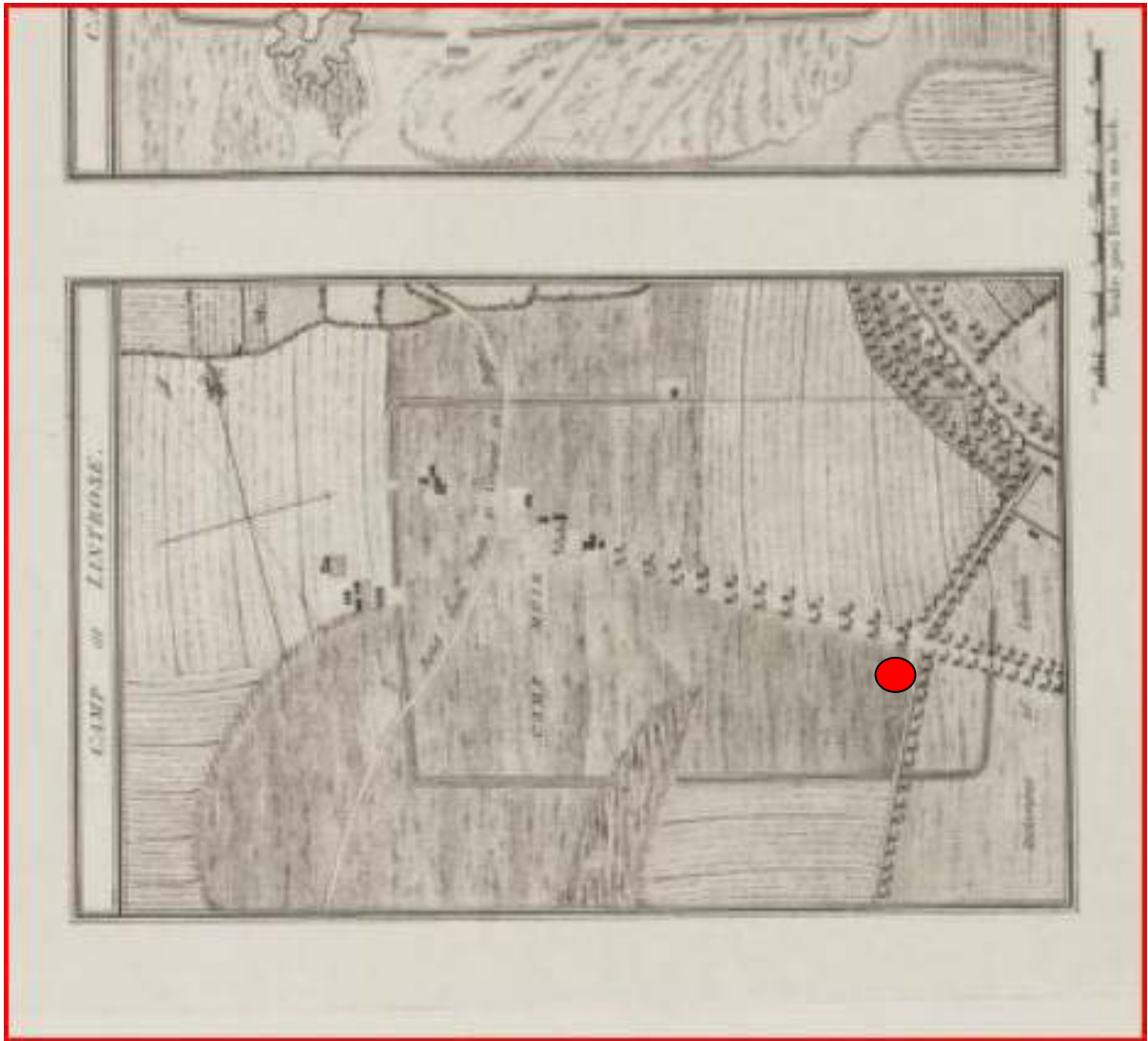

Illustration 2 Location of site on General Roys map of 1747-1755 (© Trustees of the National Library of Scotland)



Illustration 3 Site location plan (based on supplied architects plan) 1:1250

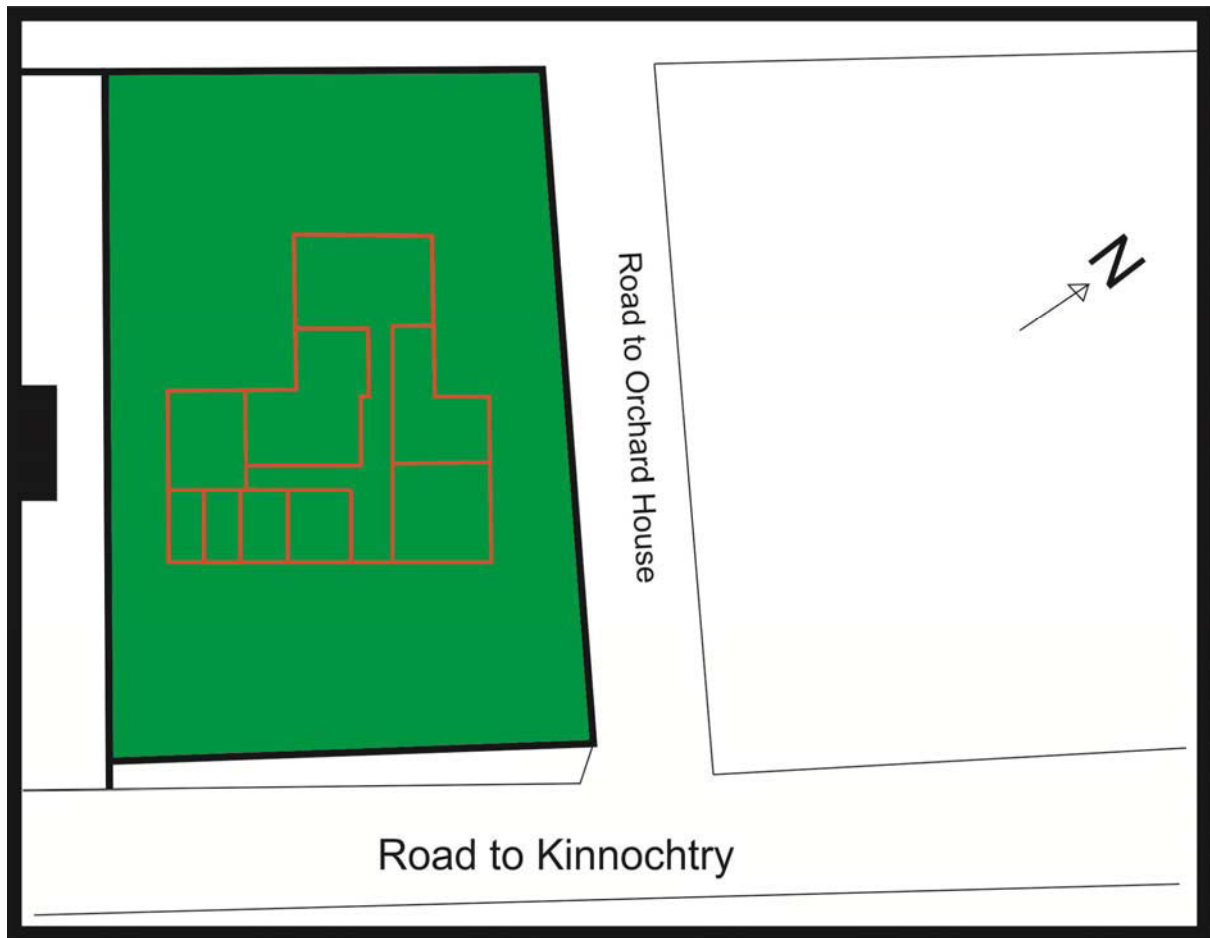

Illustration 4 Plan of trenches monitored (topsoil strip in green, house footprint in red, existing house at 30 Holding shown as solid black) Scale 1:250



Illustration 5 Plot stripped of topsoil looking East



Illustration 6 General view of excavated foundation trenches looking North West



Illustration 7 North facing section showing topsoil (100) above dark brown sandy clay (101)



Illustration 8 East facing section of foundation trench for front of house showing typical site pattern of dark brown sandy clay (101) over lying natural red brown clay and stone (102)